

- LEGEND**
- PROPERTY BOUNDARY
 - LIMIT OF HAZARD LANDS
 - 15.0m TOP OF SLOPE SETBACK
 - TURTLE HABITAT SETBACK (AS PER EIS)
 - EXISTING HYDRANT
 - EXISTING CATCH BASIN
 - EXISTING WATERMAIN
 - ⊕ EXISTING VALVE & VALVE BOX
 - EXISTING SANITARY SEWER & MANHOLE
 - EXISTING STORM SEWER & MANHOLE
 - EXISTING LIGHT STANDARD
 - PROPOSED HYDRANT
 - WATERMAIN
 - V&VB
 - PRV
 - Y
 - CATCH BASIN
 - SANITARY SEWER & MANHOLE
 - STORM SEWER & MANHOLE
 - CS
 - sc
 - ▽ BUILDING ENTRANCE
 - CROSSING NUMBER
 - ▨ INSULATION (AS PER CITY STD. W22/S35)
 - ⊕ BOREHOLE (REFER TO GEOTECHNICAL REPORT)

CROSSING TABLE			
CROSSING No.	SERVICE	TOP/BOTTOM OF PIPE (m)	SEPARATION (m)
1	STORM	101.05	0.73
	SANITARY	100.32	
2	WATER	101.72	0.50
	STORM	101.22	

NOTES:
1. SEPARATIONS ARE MEASURED TO OUTSIDE OF PIPE DIMENSIONS.

203mm WATERMAIN GRADE TABLE - BUILDING SERVICE				
STATION	FINISHED GRADE (m)	TOP OF WATER (m)	COVER DEPTH (m)	COMMENTS
0+000	104.10	101.73	2.37	CONNECT TO EXISTING STUB
0+001.8	104.35	101.95	2.40	STORM CROSSING
0+005.6	104.63	102.23	2.40	45° HORZ. BEND
0+006.6	104.73	102.33	2.40	45° HORZ. BEND
0+007.9	104.87	102.47	2.40	CAP

19mm WATERMAIN GRADE TABLE - CLUB HOUSE SERVICE				
STATION	FINISHED GRADE (m)	TOP OF WATER (m)	COVER DEPTH (m)	COMMENTS
1+000	104.67	102.27	2.40	MECHANICAL ROOM
1+010	103.62	101.22	2.40	TOP OF WATERMAIN
1+020	103.44	101.04	2.40	TOP OF WATERMAIN
1+021.2	103.51	101.11	2.40	CAP

NOTES:
1. CONNECTIONS TO LIVE WATERMAINS TO BE COMPLETED BY CITY FORCES. CONTRACTOR TO PROVIDE EXCAVATION, MATERIAL, BACKFILL AND ASSISTANCE AS REQUIRED.

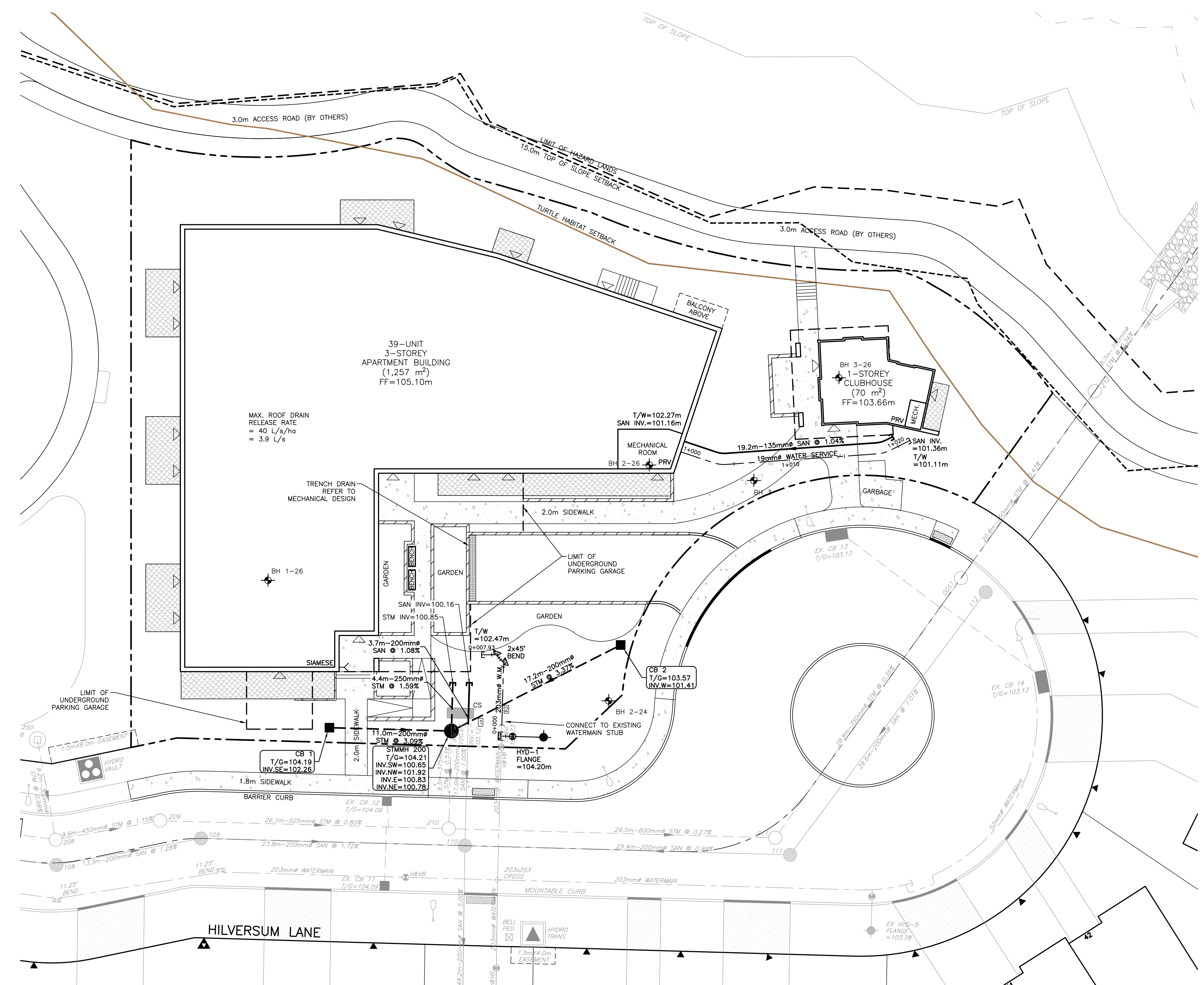

NOT FOR CONSTRUCTION

NOTES
THE POSITION OF ALL POLE LINES, CONDUITS, WATERMANS, SEWERS AND OTHER UNDERGROUND AND OVERGROUND UTILITIES AND STRUCTURES IS NOT NECESSARILY SHOWN ON THE CONTRACT DRAWINGS, AND WHERE SHOWN, THE ACCURACY OF THE POSITION OF SUCH UTILITIES AND STRUCTURES IS NOT GUARANTEED. BEFORE STARTING WORK, DETERMINE THE EXACT LOCATION OF ALL SUCH UTILITIES AND STRUCTURES AND ASSUME ALL LIABILITY FOR DAMAGE TO THEM.

GEODETIC SURVEY DERIVED FROM COSINE STATION 0011968U054. LOCATION DESCRIPTION: OLD HIGHWAY 17 BRIDGE OVER CARP RIVER ON CARP-STITTSVILLE ROAD, 0.2 KM SOUTH OF C.N.R. CROSSING IN VILLAGE OF CARP. TABLE IN TOP OF WEST WALL, 30 CM FROM NORTH END, 24 CM FROM WEST EDGE. VERTICAL CONTROL DATA, DATUM: CGVD28:78, FIRST ORDER, ELEVATION: 93.861. COORDINATE SYSTEM: MTM ZONE 9; NAD 83 DATUM (CAN83-9)

NO.	REVISION DESCRIPTION	DATE	BY
3	REVISED PER CITY/MVCA COMMENTS	08/04/26	BLM
2	REVISED PER CITY COMMENTS	12/02/26	BLM
1	ISSUED FOR REVIEW	21/11/25	BLM

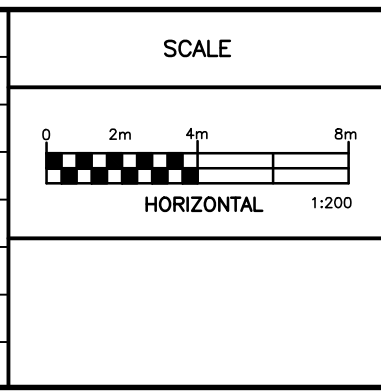

Robinson Land Development

2936 Baseline Road,
Suite 200, Ottawa, ON
K2H 1B3
(613) 592-6060 rcli.com

DESIGN	BLM
CHECKED	SG
DRAWN	BLM
CHECKED	SG
APPROVED	BLM

INVERNESS HOMES
38 AURIGA DRIVE, SUITE 200
OTTAWA, ON K2E 8A6

391 HILVERSUM LANE
CARP, ON

SERVICING PLAN

PROJECT No.	25094
SURVEY DATED	ROBINSON CONSULTANTS
DWG. No.	APRIL 2026
	25094-S1

FILE No. D07-12-25-0155 PLAN No. 19486