

NOTES:
1. REFER TO GEOTECHNICAL INVESTIGATION PREPARED BY PATERSON GROUP, DATED FEBRUARY 11, 2026.
2. GEOTECHNICAL CONSULTANT TO REVIEW SUBGRADE PRIOR TO PLACEMENT OF GRANULARS.

PARKING GARAGE RAMP STRUCTURE DETAIL
N.T.S.

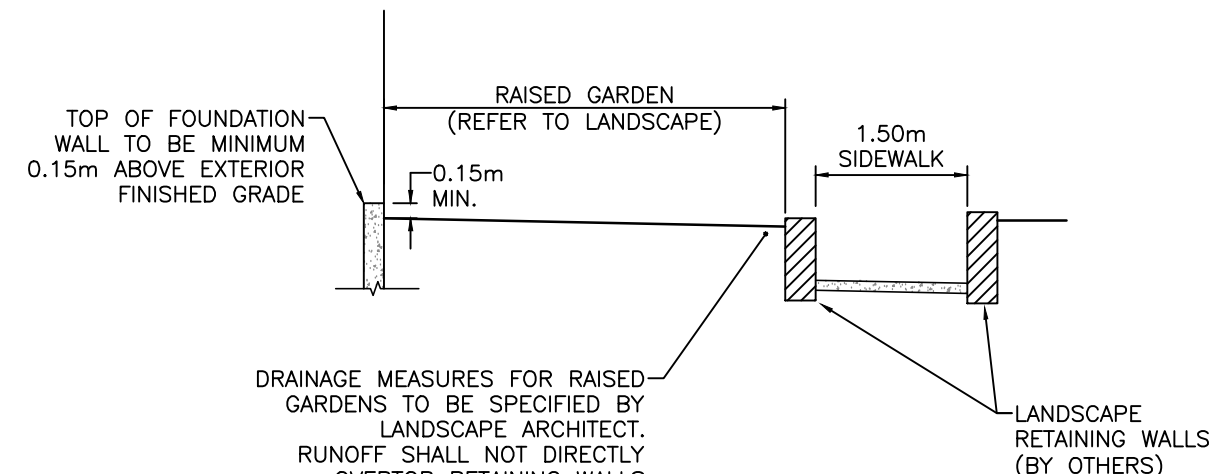

SECTION D-D (TYP.)
N.T.S.

TYPICAL FOUNDATION DETAIL
N.T.S.

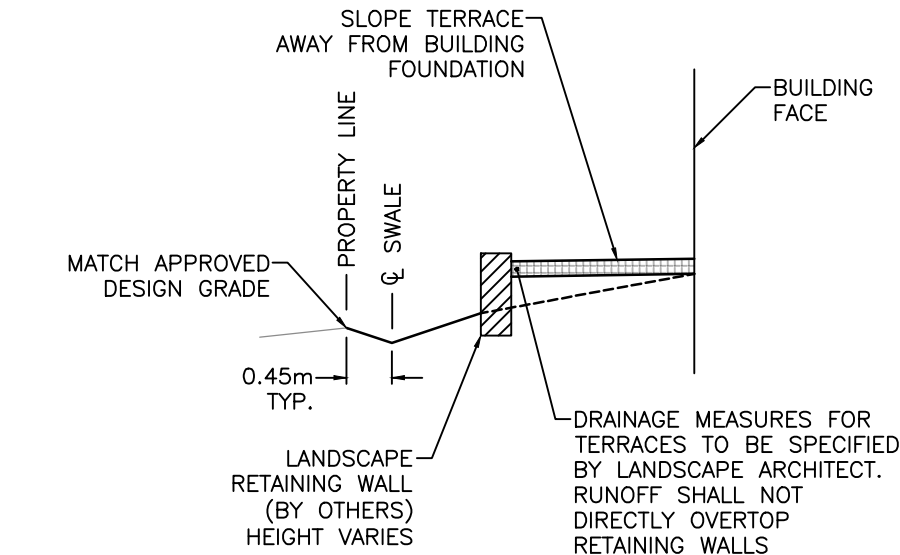

SECTION A-A (TYP.)
N.T.S.

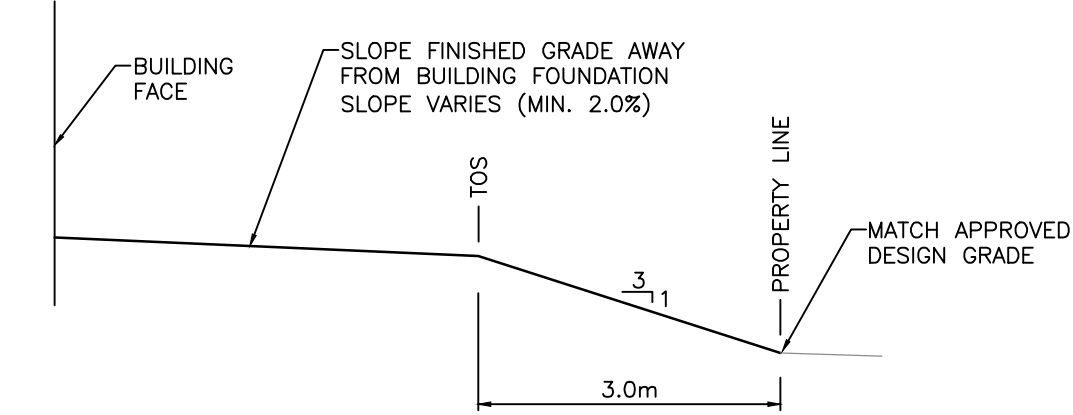

SECTION B-B (TYP.)
N.T.S.

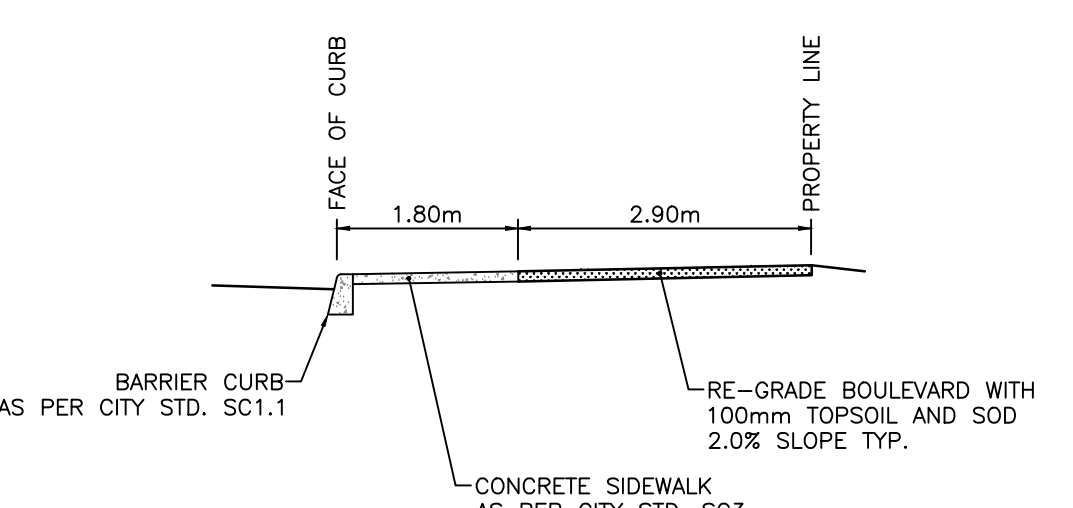

SECTION C-C (TYP.)
N.T.S.

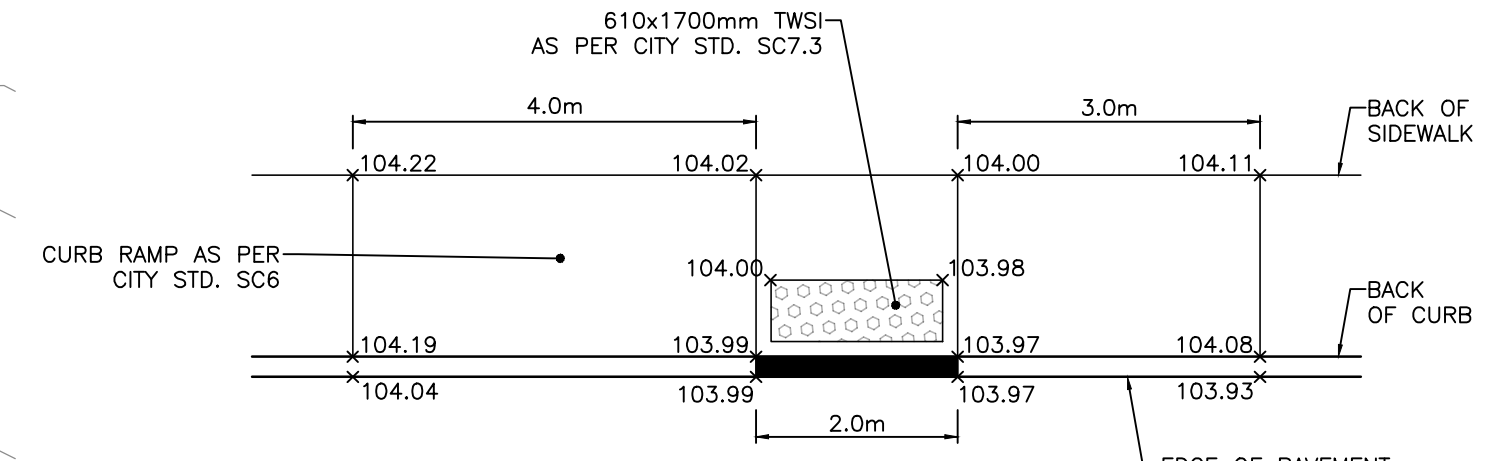

TWSI DETAIL 1
N.T.S.

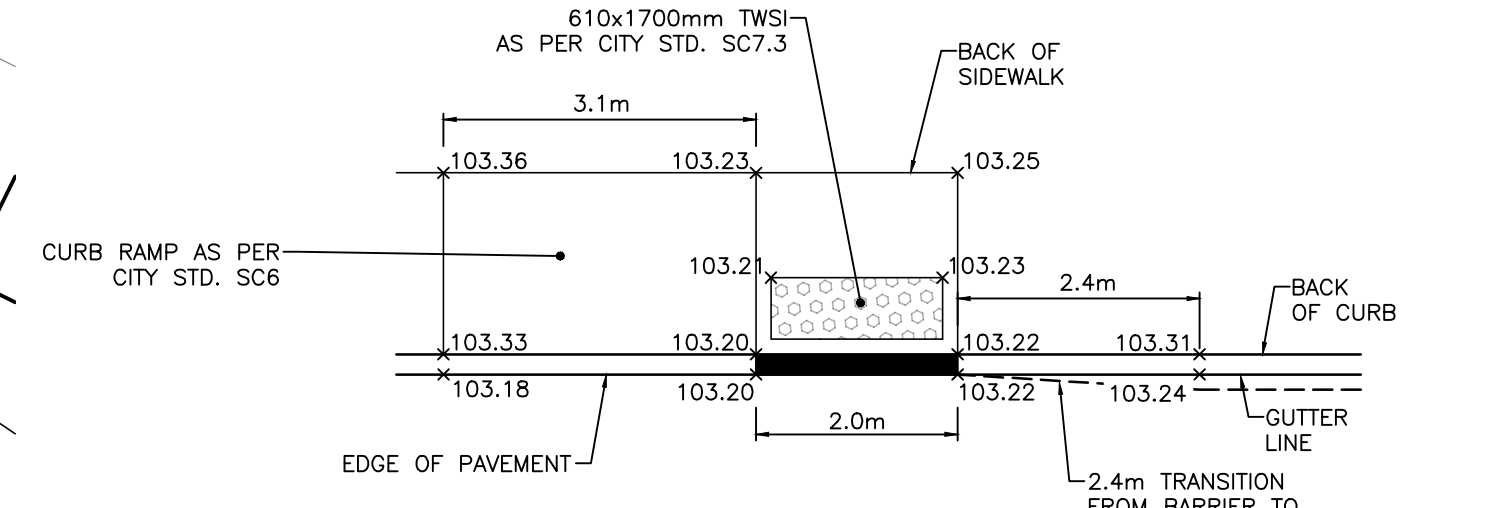

TWSI DETAIL 2
N.T.S.

LEGEND

- PROPERTY BOUNDARY
- LIMIT OF HAZARD LANDS
- 15.0m TOP OF SLOPE SETBACK
- TURTLE HABITAT SETBACK (AS PER EIS)
- EXISTING ELEVATION
- PROPOSED GRADE
- APPROVED DESIGN GRADE
- PROPOSED DRAINAGE SLOPE & DIRECTION
- PROPOSED NUMBER OF RISERS
- EXISTING HYDRANT
- EXISTING CATCH BASIN
- EXISTING SANITARY MANHOLE
- EXISTING STORM MANHOLE
- EXISTING LIGHT STANDARD
- PROPOSED HYDRANT
- CATCH BASIN
- STORM MANHOLE
- BUILDING ENTRANCE
- BOREHOLE (REFER TO GEOTECHNICAL REPORT)
- TERRACING (3H:1V MAX.)
- SWALE
- RETAINING WALL
- H.P.
- HIGH POINT
- DEPRESSED CURB WITH TWSI
- MAJOR OVERLAND FLOW ROUTE
- MAX. STATIC PONDING LIMIT
- PA-1 PONDING AREA ID
- MAXIMUM STATIC PONDING ELEVATION
- MAXIMUM AVAILABLE SURFACE STORAGE
- MAXIMUM STATIC PONDING DEPTH
- SNOW STORAGE (REFER TO SITE PLAN)

NOTE: NO SURFACE PONDING OCCURS DURING THE 2-YEAR THROUGH 100-YEAR DESIGN EVENTS.

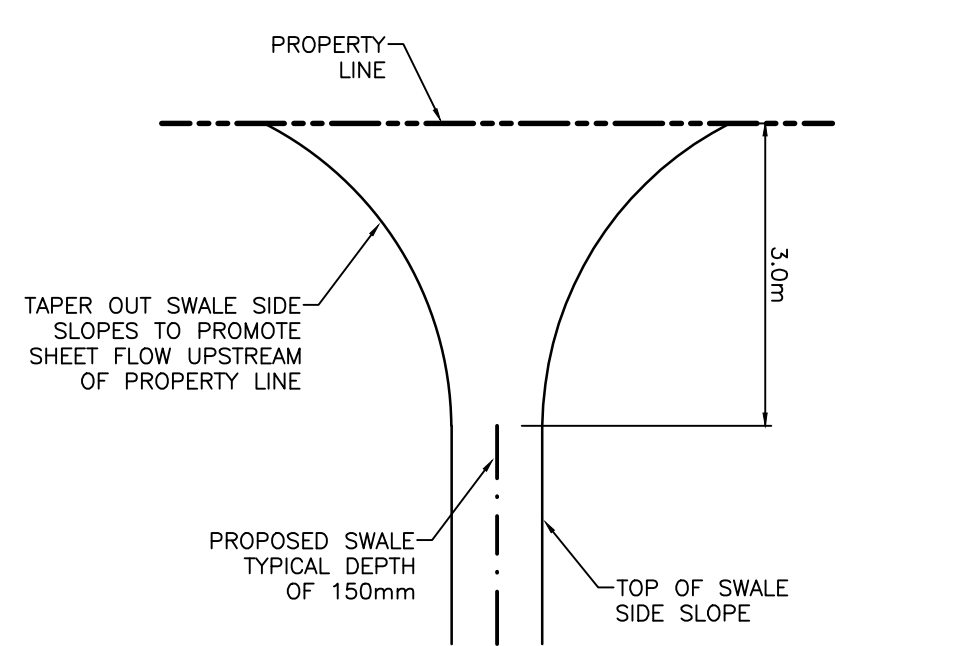

REAR SWALE TERMINATION (TYP.)
N.T.S.

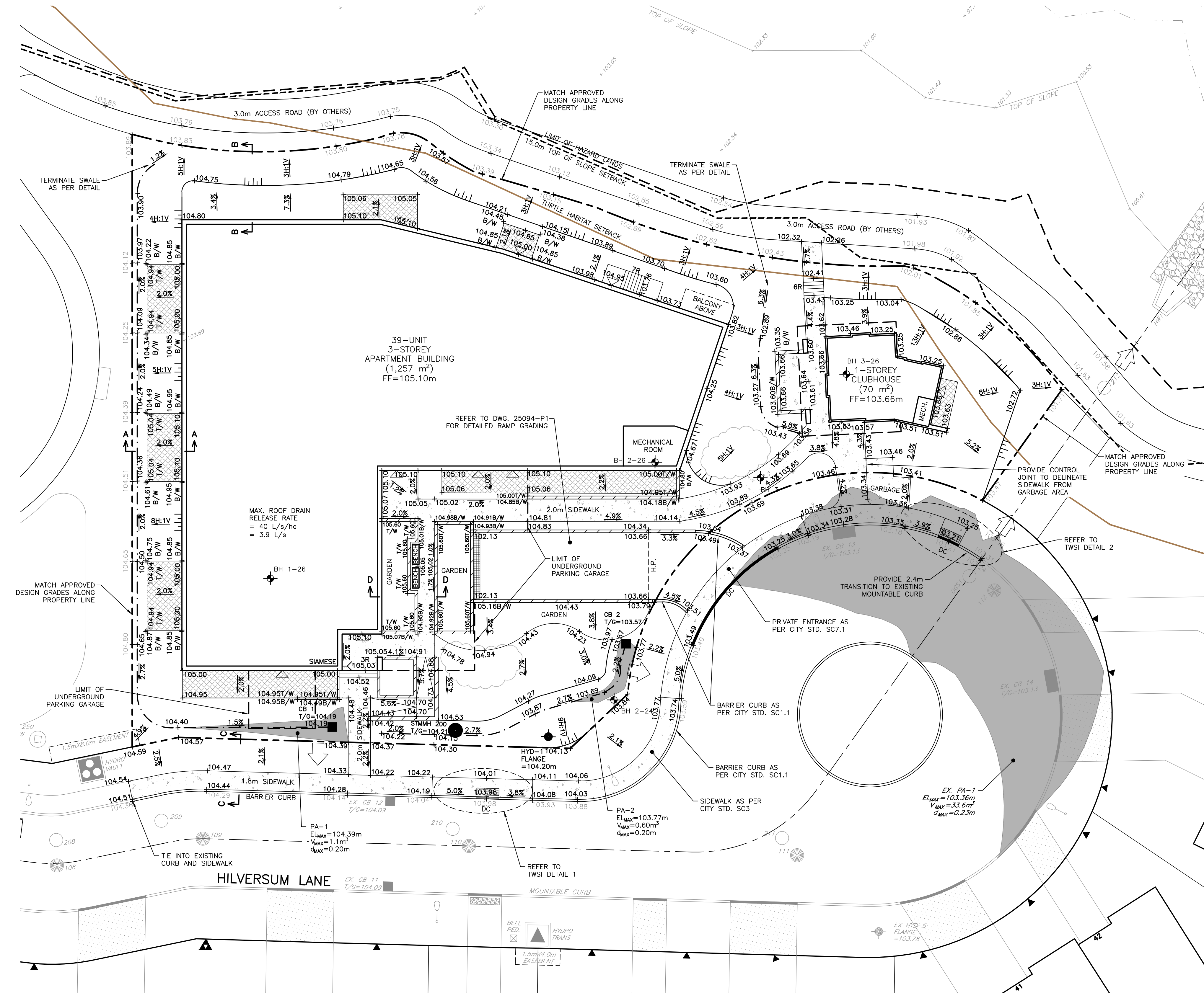

NOT FOR CONSTRUCTION

NOTES
THE POSITION OF ALL POLE LINES, CONDUITS, WATERMANS, SEWERS AND OTHER UNDERGROUND AND OVERGROUND UTILITIES AND STRUCTURES IS NOT NECESSARILY SHOWN ON THE CONTRACT DRAWINGS, AND WHERE SHOWN, THE ACCURACY OF THE POSITION OF SUCH UTILITIES AND STRUCTURES IS NOT GUARANTEED. BEFORE STARTING WORK, DETERMINE THE EXACT LOCATION OF ALL SUCH UTILITIES AND STRUCTURES AND ASSUME ALL LIABILITY FOR DAMAGE TO THEM.
GEODETIC SURVEY DERIVED FROM COSINE STATION 0011968U054. LOCATION DESCRIPTION: OLD HIGHWAY 17 BRIDGE OVER CARP RIVER ON CARP-STITTSVILLE ROAD, 0.2 KM SOUTH OF C.N.R. CROSSING IN VILLAGE OF CARP. TABLE IN TOP OF WEST WALL, 30 CM FROM NORTH END, 24 CM FROM WEST EDGE. VERTICAL CONTROL DATA, DATUM: CGVD2878, FIRST ORDER, ELEVATION: 93.661. COORDINATE SYSTEM: MTM ZONE 9; NAD 83 DATUM (CAN83-9)

NO.	REVISION DESCRIPTION	DATE	BY
3	REVISED PER CITY/MVCA COMMENTS	08/04/26	BLM
2	REVISED PER CITY COMMENTS	12/02/26	BLM
1	ISSUED FOR REVIEW	21/11/25	BLM

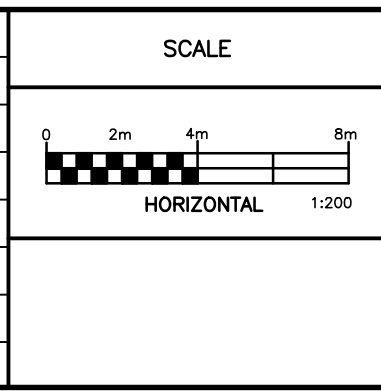

Robinson
Land Development

2936 Baseline Road,
Suite 200, Ottawa, ON
K2H 1B3
(613) 592-6060 rcii.com

DESIGN	BLM
CHECKED	SG
DRAWN	BLM
CHECKED	SG
APPROVED	BLM

INVERNESS HOMES
38 AURIGA DRIVE, SUITE 200
OTTAWA, ON K2E 8A6
391 HILVERSUM LANE
CARP, ON

GRADING AND DRAINAGE PLAN

PROJECT No.	25094
SURVEY	ROBINSON CONSULTANTS
DATED	APRIL 2026
DWG. No.	25094-GR1