

April 8th, 2026

Attention: **Jerrica Gilbert**
 Planner II
 Development Review - Rural
 City of Ottawa

Reference: **Construction Management Plan**
 391 Hilversum Lane, Carp
 City File Number: D07-12-25-0155
 RLD File Number: 25094

Dear Jerrica Gilbert:

Please find below, a Preliminary Construction Management Plan for the proposed site development located at 391 Hilversum Lane in the Village of Carp.

Section 1

The approximate limits of the construction area for the proposed development are shown on **Figure 1.0**.

Section 2

With respect to the City of Ottawa's terms of reference for a Preliminary Construction Management Plan, please see responses below:

1. *Will construction require the temporary detour of a bus route?*

Response: No existing bus routes will be impacted.

2. *Will this work block a bike lane?*

Response: No existing bike lanes will be impacted.

3. *Will this work block a sidewalk?*

Response: No existing sidewalks will be impacted. The construction of the proposed development is expected to occur concurrently with the construction of Phase 1 of the Huntley Hollow Subdivision. Note that there is a municipal sidewalk proposed across the frontage of the subject site, however, it will be constructed as part of this development.

4. *Will this work require a lane of traffic to be closed?*

Response: No existing traffic lanes will be required to be closed.

Proposed Construction Management Plan

No portion of the municipal right-of-way will need to be closed for the duration of the project. As demonstrated under Section 2, no existing municipal transportation services (e.g. bus routes, bike lanes, sidewalks, traffic lanes) will be impacted by the construction works. The Contractor shall implement appropriate traffic control signage (in accordance with OTM Book 7) any make provision for the use of designated traffic control personnel (i.e. flag person(s)) as required to provide for safe access in and out of the subject site, with minimal impacts to the municipal right-of-way, for the duration of the project.

If you have any questions, please do not hesitate to contact the undersigned.

Yours truly,

ROBINSON LAND DEVELOPMENT

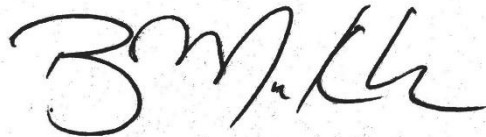
A handwritten signature in black ink, appearing to read 'B MacKechnie', written over a light grey grid background.

Brandon MacKechnie, P.Eng.
Project Engineer

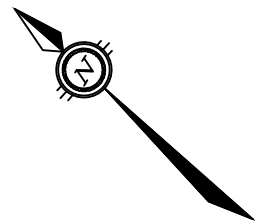
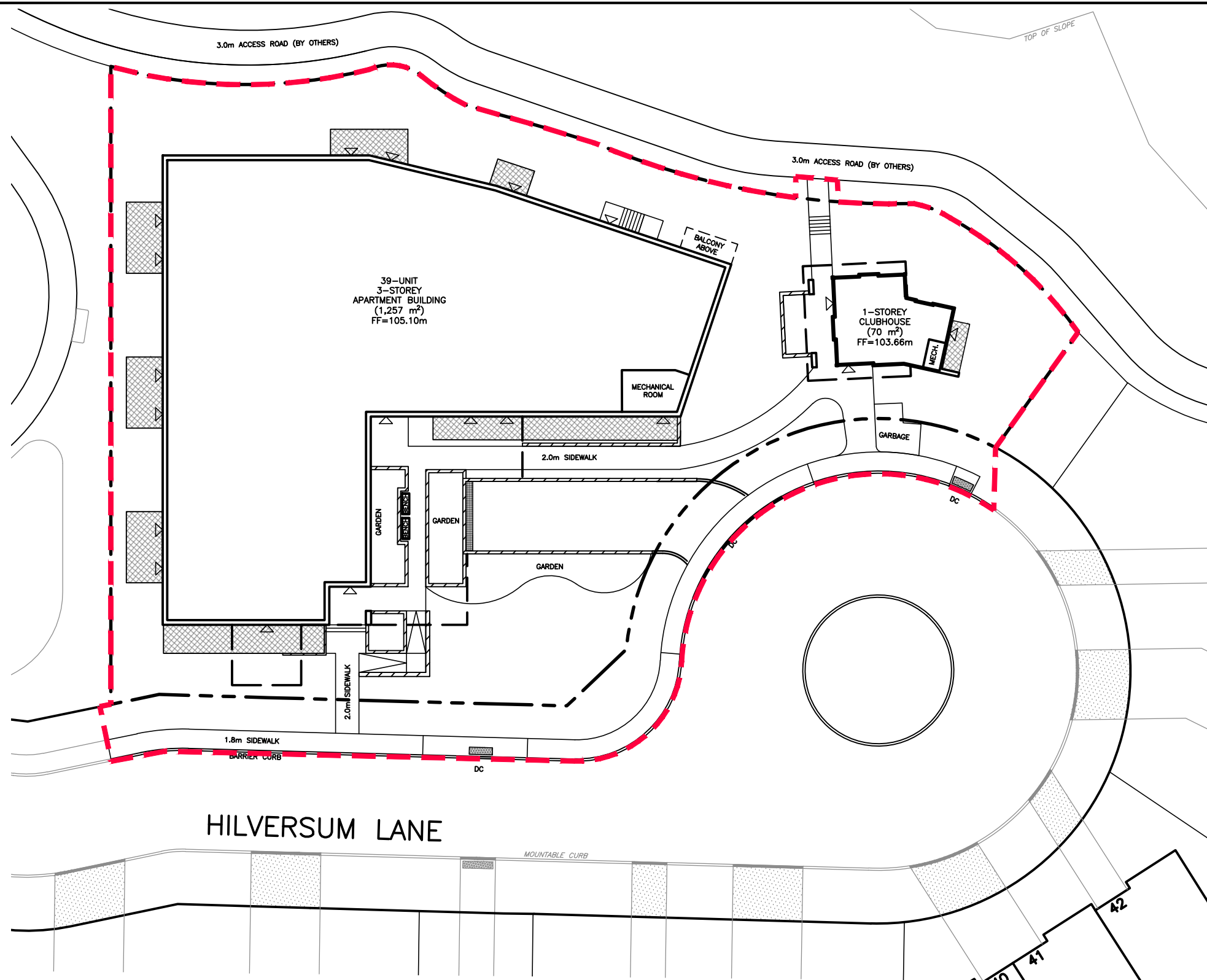

LEGEND

- — — — — PROPERTY BOUNDARY
- - - - - PROPOSED CONSTRUCTION AREA

Robinson

Land Development

scale	N.T.S.	391 HILVERSUM LANE, CARP	project no.	25094
date	08/04/26		PROPOSED CONSTRUCTION AREA	FIG 1.0
drawn by	BLM			