

Copyright Reserved

The Contractor shall verify and be responsible for all dimensions. DO NOT scale the drawing - any errors or omissions shall be reported to Stantec without delay.
The Copyrights to all designs and drawings are the property of Stantec. Reproduction or use for any purpose other than that authorized by Stantec is forbidden.

Legend

- PROPOSED WATERMAIN
- PROPOSED VALVE AND VALVE BOX
- PROPOSED VALVE CHAMBER
- PROPOSED REDUCER
- PROPOSED FIRE HYDRANT
- PROPOSED SANITARY SEWER
- PROPOSED STORM SEWER
- PROPOSED CATCH BASIN MANHOLE
- PROPOSED CATCH BASIN
- EXISTING/FUTURE WATERMAIN
- EXISTING/FUTURE VALVE AND VALVE BOX
- EXISTING/FUTURE VALVE CHAMBER
- EXISTING/FUTURE REDUCER
- EXISTING/FUTURE FIRE HYDRANT
- EXISTING/FUTURE SANITARY SEWER
- EXISTING/FUTURE STORM SEWER
- EXISTING/FUTURE CATCH BASIN MANHOLE
- EXISTING/FUTURE CATCH BASIN
- PROPOSED DEPRESSED CURB LOCATIONS
- PROPOSED BARRIER CURB
- THERMAL INSULATION ON STORM SEWER WHERE COVER IS LESS THAN 1.5m. THERMAL INSULATION ON WATERMAIN WHERE COVER IS LESS THAN 2.4m AS PER W22.
- NUMBER OF WATER METERS
- NUMBER OF REMOTE WATER METER
- PROPOSED COMMON MAILBOX LOCATIONS
- PROPOSED 2hr RATED FIRE WALL LOCATION
- BACK TO BACK TERRACE HOME SERVICES
200mm STORM SERVICE PVC SDR 26 @ 1% MIN
150mm SANITARY SERVICE PVC SDR 26 @ 1% MIN
19mm PEX TUBING WATER SERVICE C/W CURB STOP AND SERVICE POST
- PROPOSED EXTERIOR HOSE BB LOCATION, CONNECTED TO INTERNAL PLUMBING

Notes

- MAINTENANCE HOLES LOCATED IN PONDING AREAS SHALL HAVE WATER TIGHT FRAME AND COVERS AS PER CITY STANDARD S24, S24.1 AND S25.
- SITE PLAN PREPARED BY KORSIAK URBAN PLANNING, DATED DECEMBER 16, 2025

Revision	By	Appd.	YY.MM.DD
4	JP	SG/DT	26.01.09
3	JP	SG	25.11.21
2	JP	SG	25.11.07
1	JP	SG	25.09.05
0	JP	SG	25.05.13
1	By	Appd.	YY.MM.DD

File Name:	JP	SG	JP	25.04.17
160402143-HMB5-PH7-DB	Dwn.	Chkd.	Dgn.	YY.MM.DD

Permit-Seal

Client/Project

Mattamy Homes

HMB PHASE 7

OTTAWA, ON

Title

SITE SERVICING PLAN

Project No. 160402143 Scale 1:300

Drawing No. SSP-1 Sheet 3 of 9 Revision 4

DOT-12-25-0068

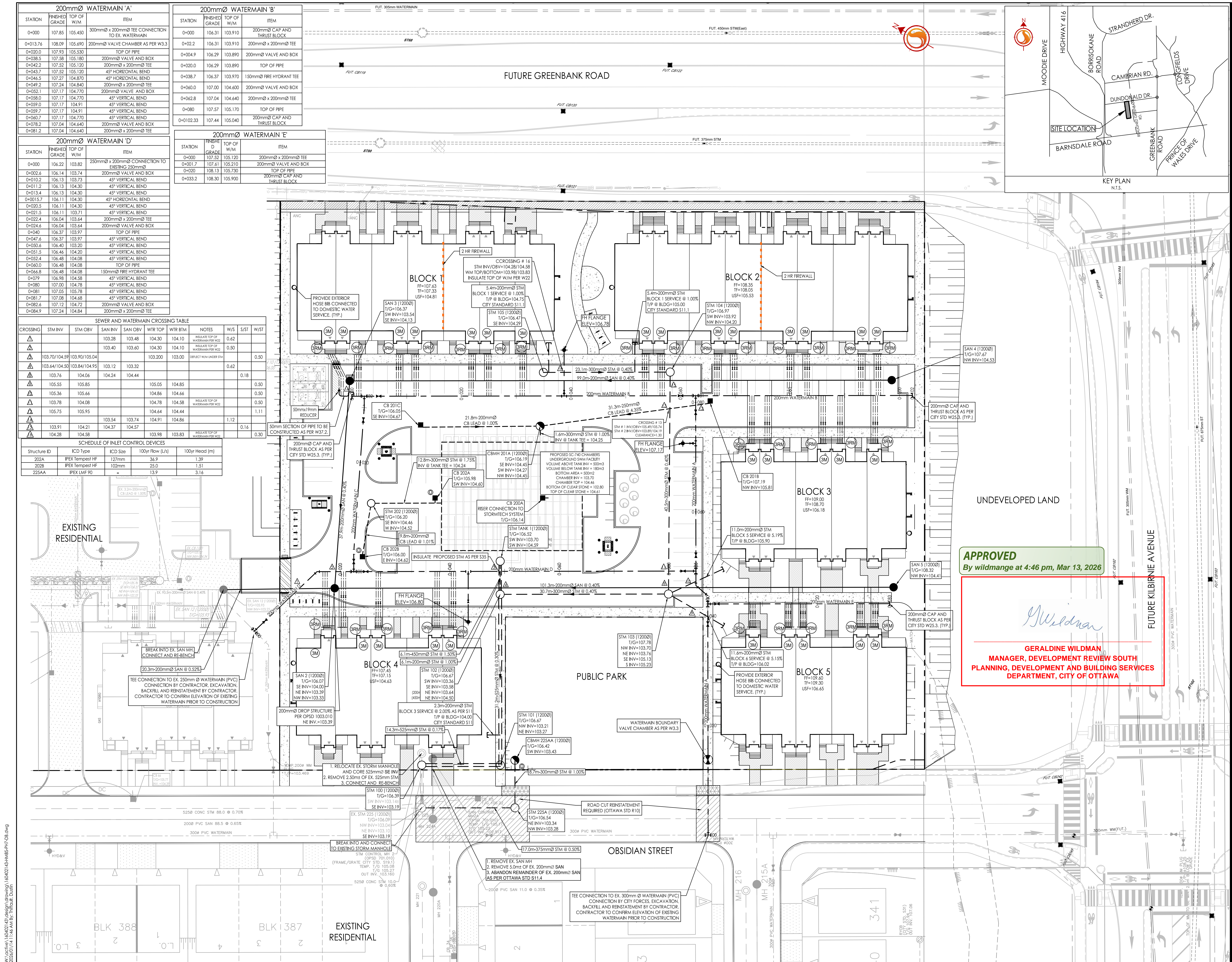

APPROVED
By wildmange at 4:46 pm, Mar 13, 2026

G. Wildman
GERALDINE WILDMAN
MANAGER, DEVELOPMENT REVIEW SOUTH
PLANNING, DEVELOPMENT AND BUILDING SERVICES
DEPARTMENT, CITY OF OTTAWA

W:\active\160402143\design\dwg\160402143-HMB5-PH7-CB.dwg
25/04/2025 11:14:14 AM by: m.fidellari, D:\m