

PROPOSED TREE SOIL VOLUME CHART

Soil Area	Location	Soil Area (m ²)	Soil Depth (m*)	Soil Volume (m ³)	Tree Quantity	Soil Volume per tree (m ³)
1	Private property	20.46	1.6	32.74	1	32.74
2	Private property	23.86	1.6	38.18	1	38.18
3	Private property	202.09	1.2	242.51	5	48.50
4	Private property	39.8	1.2	47.76	1	47.76

Tree Type/Size	Single Tree Soil Volume (m ³)	Multiple Tree Soil Volume (m ³ /tree)
Ornamental	15	9
Columnar	15	9
Small	20	12
Medium	25	15
Large	30	18
Conifer	25	15

TREE CANOPY COVERAGE LEGEND AND INFORMATION

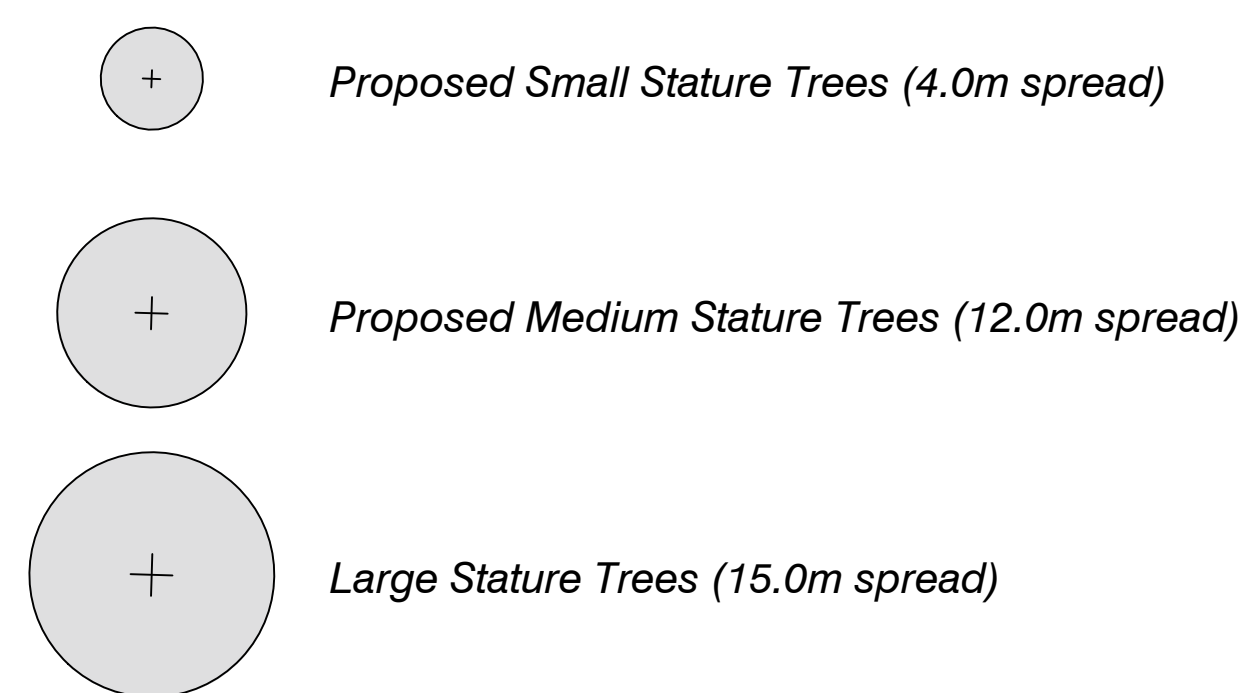

40 Year Canopy Cover: 2062.18 m²

*canopy overlap is only counted once

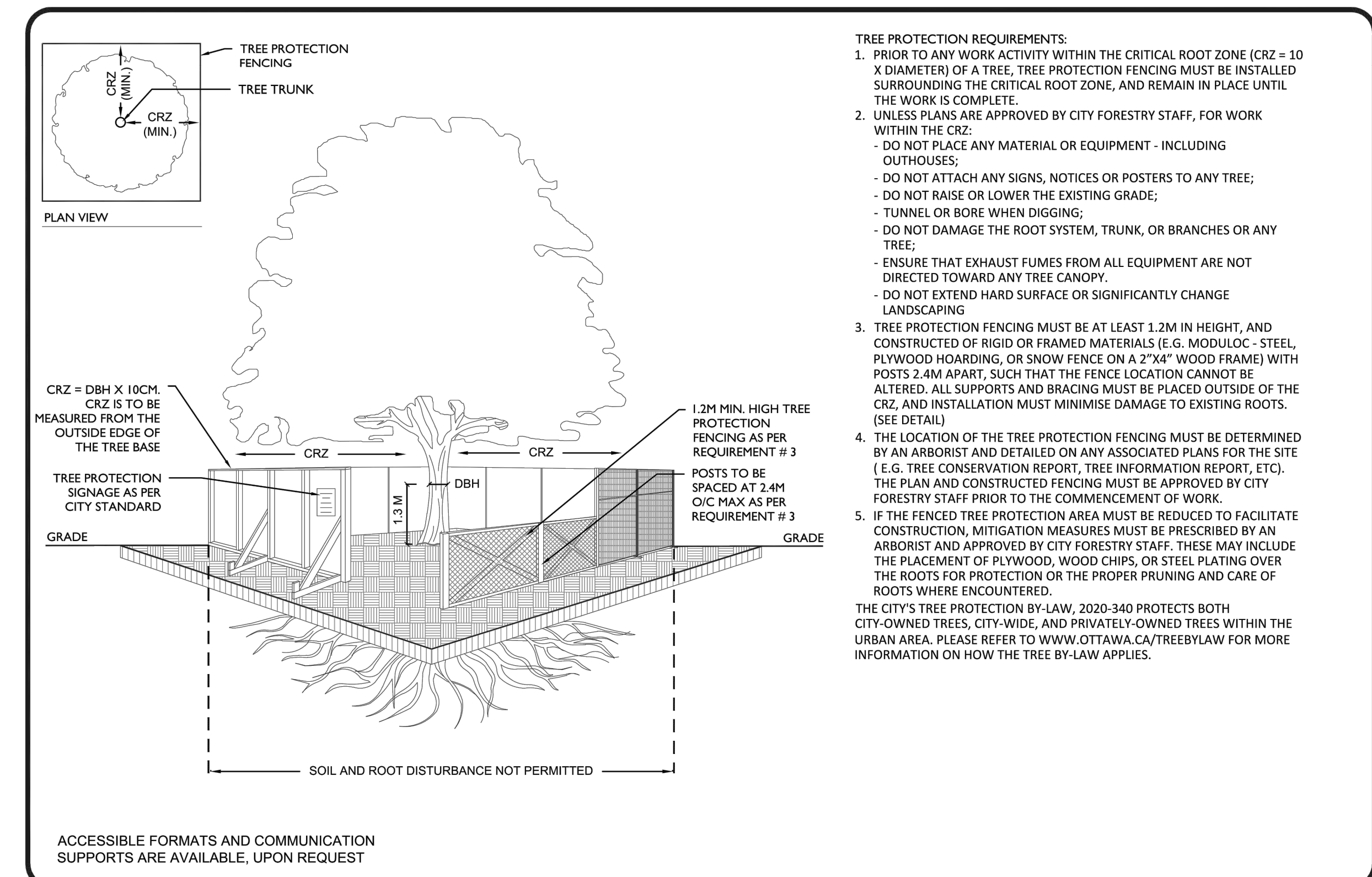
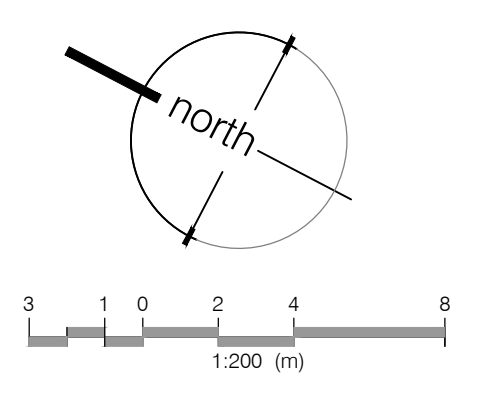

TREE PROTECTION SPECIFICATION

TO BE IMPLEMENTED FOR RETAINED TREES, BOTH ON SITE AND ON ADJACENT SITES, PRIOR TO ANY TREE REMOVAL OR SITE WORKS AND MAINTAINED FOR THE DURATION OF WORK ACTIVITIES ON SITE.

SCALE: NTS

DATE: MARCH 2021

DRAWING NO.: 1 of 1

City of Ottawa Tree protection detail

MBR-2300-00001

QUANTITY: 4

Sustainability Facts

Unit Size: One (1) MBR-2300-00001 Bike Rack

Carbon footprint (GWP): 139 kg CO₂-Eq
Measured in kilograms of carbon dioxide equivalent

Total energy use (TPE): 2480 MJ-Eq
Measured in megajoules of energy equivalent

Waster use (WDP): 1.9 m³ water
Measured in cubic metres of water

Material recyclability: 100%

LEED v4.1 Credits

Type III Environmental Product Declaration

Material Inventory

Low VOC finishes

Free of Red List substances

*UL EPC can be referenced for more information: <https://www.epcglobal.com/maglin/>

DESCRIPTION: 2300 Series - Iconic Bike Rack: Cast Aluminum, Surface Mount, 2 Bike Configuration

FINISH: The Maglin Powdercoat System provides a durable finish on all aluminum castings.

INSTALLATION: The bike rack is delivered in parts. Reference INSTALL_MBR-2300-00001 PDF for more information.

TO SPECIFY: Select MBR-2300-00001
Choose:
- Powdercoat Color

HEIGHT: 26 1/2" (67.3cm) LENGTH: 20 1/2" (52cm) WIDTH: 2" (5.1cm) WEIGHT: 18 lbs (8kg)

T 800 716 5506
F 517 249 3393
www.maglin.com
sales@maglin.com

- All drawings, specifications, design and details on this page remain the property of Maglin Site Furniture Inc. and may not be used without Maglin authorization.
- Details and specifications may vary due to continuing improvements of our products.

Bike rack by Maglin (or approved equal)

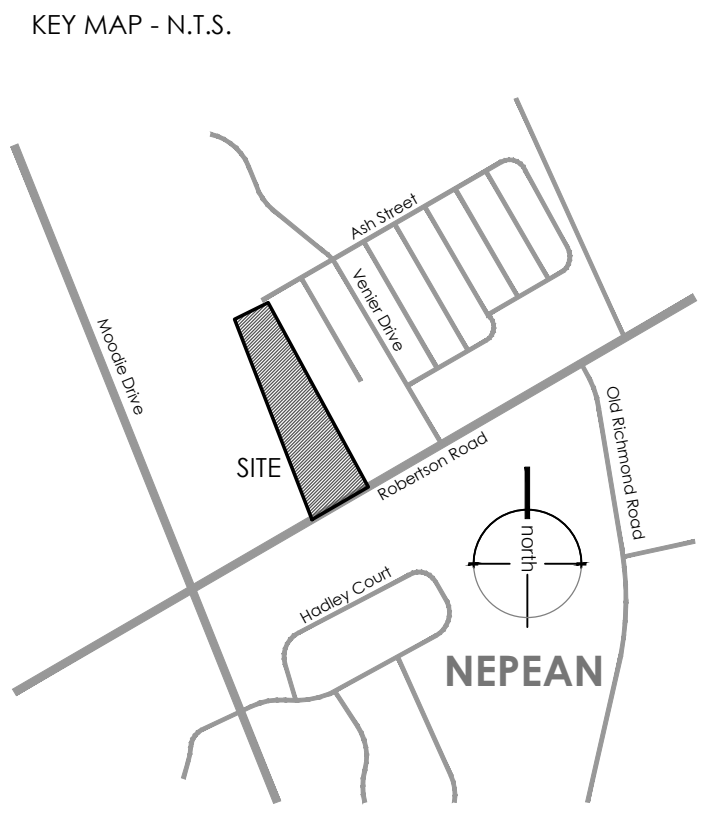

ISSUED FOR BUILDING PERMIT & TENDER

REVISIONS/ SUBMISSIONS

#	DATE	DESCRIPTION
1	2025-07-18	Issued for Client Review & Coordination
2	2025-11-28	Issued for SPA Submission
3	2026-01-20	Issued for Building Permit and Tender
4	2026-03-27	Issued for SPA Submission

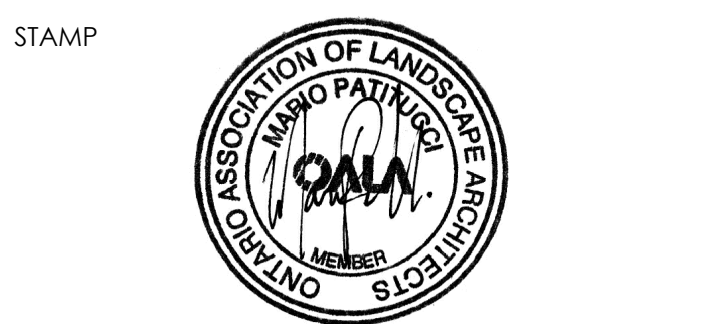

CLIENT
Kingslake Projects Inc.
MUNICIPALITY
City of Ottawa (Nepean)

PROJECT
Holiday Inn Express Hotel Addition
2055 Robertson Road

MUNICIPAL FILE NUMBER
D07-12-25-0176

SHEET
Soil Volume and
Canopy Cover Plan

adesso design inc.
landscape architecture

69 John Street South, Suite 250
Hamilton, ON L8N 2B9
t. 905.526.8876
www.adessodesigninc.ca