

**LEGEND**

- SITE BOUNDARY
- PROPOSED STORM MANHOLE & SEWER
- PROPOSED SANITARY MANHOLE & SEWER
- PROPOSED WATERMAIN
- PROPOSED VALVE & VALVE BOX
- PROPOSED CURB STOP LOCATION
- PROPOSED DISTRICT METERING AREA (DMA) CHAMBER (AS PER CITY OF OTTAWA DETAIL W3.3)
- PROPOSED HYDRANT AND VALVE & VALVE BOX
- PROPOSED TWSI AS PER CITY OF OTTAWA DETAIL SC7.2
- PROPOSED TREES
- PROPOSED CURB INLET CATCHBASIN
- PROPOSED CATCHBASIN
- PROPOSED CATCHBASIN MANHOLE
- PROPOSED REAR YARD ELBOW
- PROPOSED REAR YARD TEE
- PROPOSED PRESSURE REDUCING VALVE
- PROPOSED RETAINING WALL
- EXISTING STORM MANHOLE AND SEWER
- EXISTING SANITARY MANHOLE AND SEWER
- EXISTING WATERMAIN
- EXISTING UNDERGROUND GAS
- EXISTING VALVE AND VALVE BOX
- EXISTING FIRE HYDRANT
- EXISTING CATCHBASIN
- EXISTING TOP OF GRATE
- EXISTING HYDRAULIC GRADE LINE
- EXISTING UTILITY POLE C/W/G WIRES
- EXISTING STREETLIGHT

NOTE:  
BUILDING SERVICES TO BE 135mmØ SANITARY,  
150mmØ STORM AND 38mmØ WATERMAIN

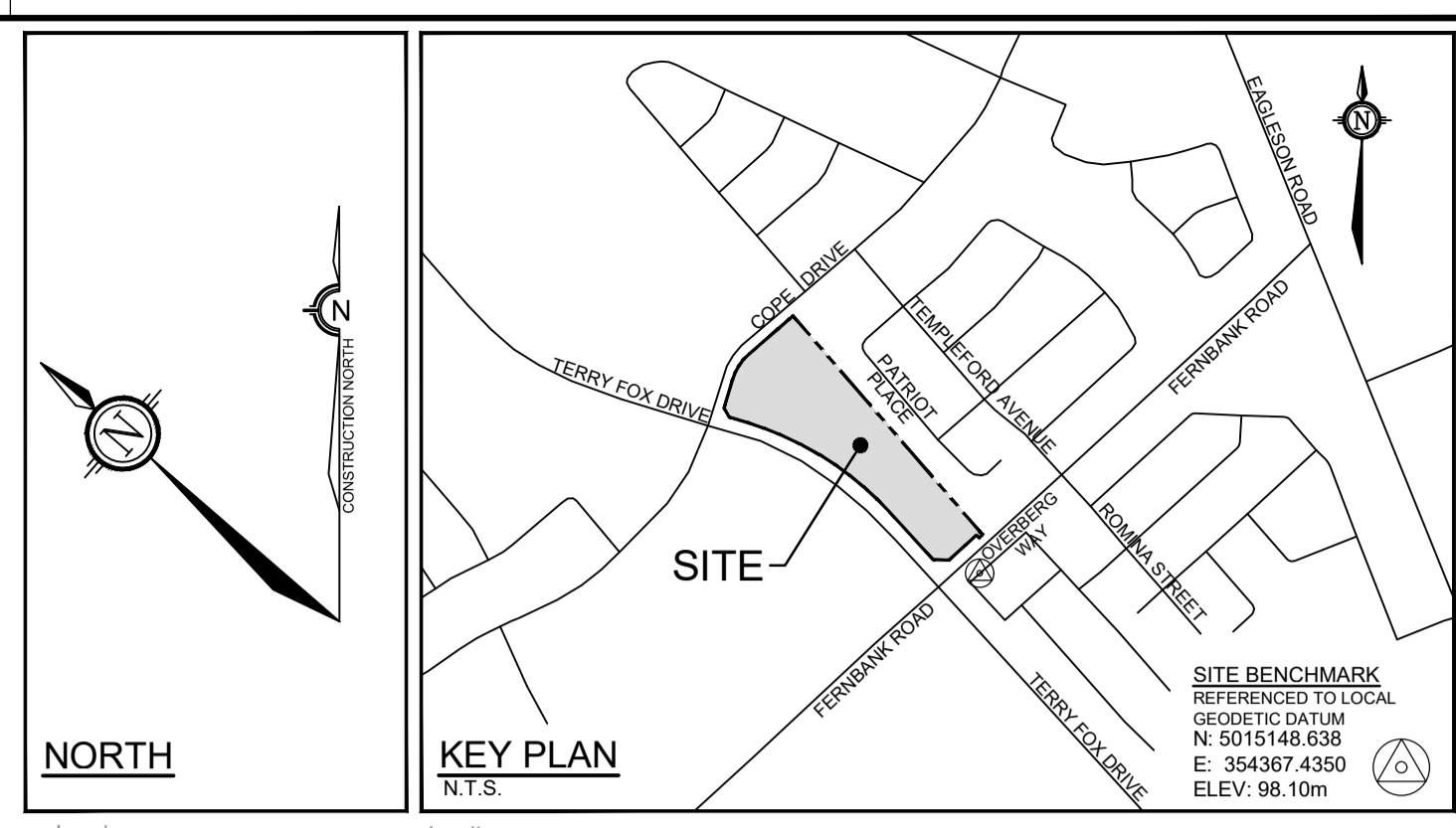

**KEY PLAN**  
N.T.S.

SAN MANHOLE TABLE				
MANHOLE ID	SIZE(mm)	STATION	T/G ELEV(m)	INVERT(m)
109	1200	1+210.01	97.35	SE=94.20 NW=94.17 NE=94.23
111	1200	1+282.11	97.43	SE=94.47 NW=94.44 NE=94.50
113	1200	1+340.05	97.54	NW=94.66 SE=94.69
115	1200	1+351.12	97.60	NE=94.77 NW=94.74
117	1200	1+359.04	97.67	SW=94.80 SE=94.86 NE=94.83
211	1200	6+040.80	97.33	SW=94.66
213	1200	8+040.80	97.50	SW=94.93
215	1200	9+031.37	97.51	SW=95.12
217	1200	1+403.45	97.70	NW=95.30

STM MANHOLE TABLE				
MANHOLE ID	SIZE(mm)	STATION	T/G ELEV(m)	INVERT(m)
108	1200	1+187.05	97.28	SE=94.60 SW=94.83 NW=94.53
110	1200	1+208.53	97.36	SE=94.65 NE=94.88 NW=94.68 SW=94.89
112	1200	1+280.61	97.47	SE=94.94 NE=95.02 NW=94.79
114	1200	1+339.26	97.55	NW=95.09 SE=95.06
116	1200	1+351.13	97.61	NE=95.12 NW=95.12
118	1200	1+358.97	97.67	SE=95.23 NE=95.50 SW=95.15
206	1200	1+407.25	97.76	NW=95.48 SW=95.75

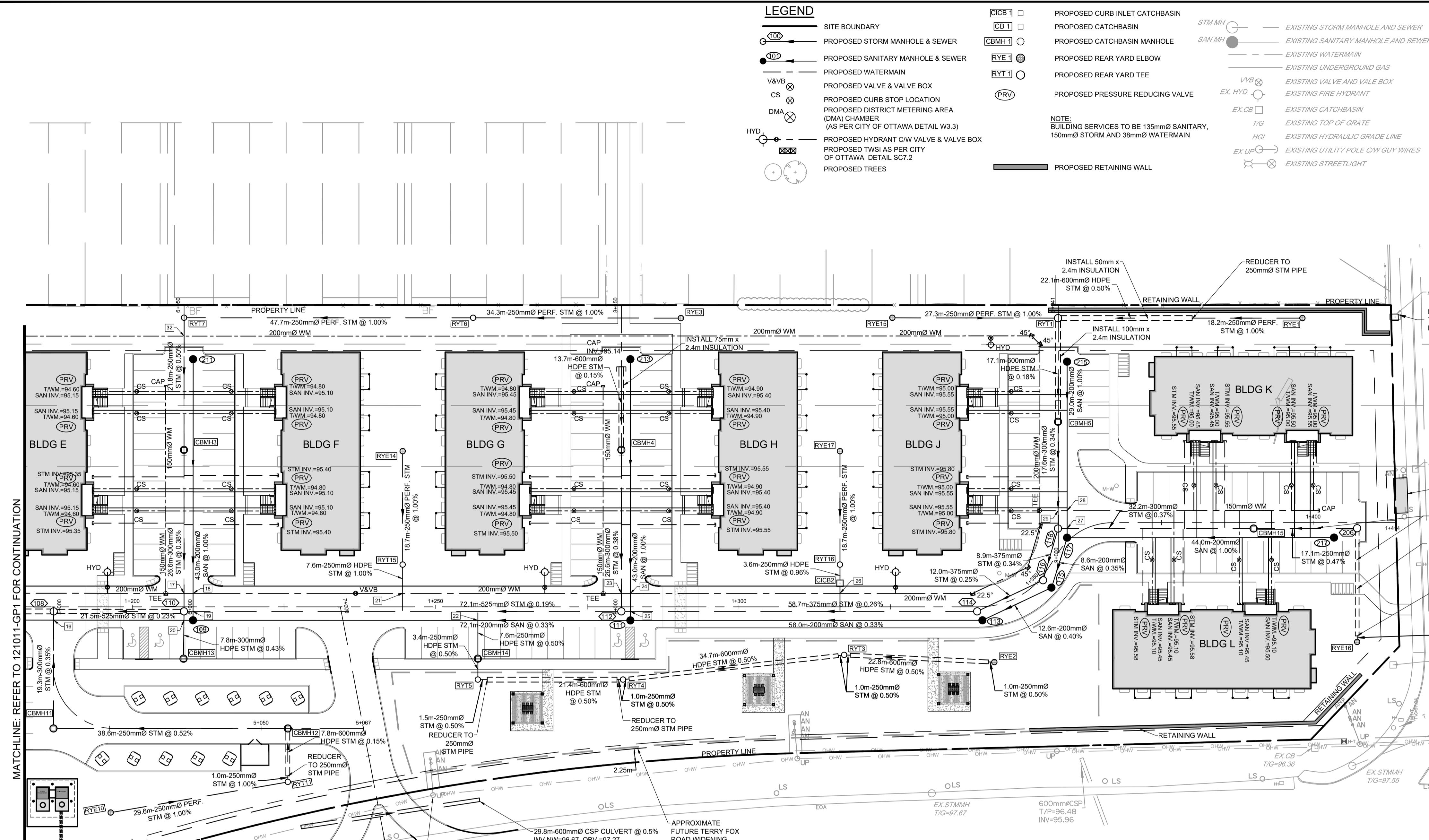

MATCHLINE: REFER TO 121011-GP1 FOR CONTINUATION

PIPE CROSSING TABLE			
CROSSING #	WATERMAIN	SANITARY	STORM
16		INV = 94.09 OBV = 94.29	INV = 94.83 OBV = 95.13
17	INV = 93.53 OBV = 93.73	INV = 94.27 OBV = 94.47	INV = 94.65 OBV = 95.15
18	INV = 93.53 OBV = 93.73	INV = 94.17 OBV = 94.37	INV = 94.89 OBV = 95.19
19	INV = 94.78 OBV = 94.98	INV = 94.36 OBV = 94.56	INV = 95.87 OBV = 96.12
20	INV = 93.80 OBV = 94.00	INV = 94.54 OBV = 94.74	INV = 95.03 OBV = 95.33
21	INV = 93.80 OBV = 94.00	INV = 94.51 OBV = 94.71	INV = 94.94 OBV = 95.32
22	INV = 94.87 OBV = 95.07	INV = 94.84 OBV = 95.04	INV = 96.03 OBV = 96.28
23	INV = 94.25 OBV = 94.35	INV = 94.87 OBV = 95.07	INV = 95.51 OBV = 95.81
24	INV = 94.25 OBV = 94.35	INV = 94.84 OBV = 95.04	INV = 95.13 OBV = 95.38
25	INV = 94.40 OBV = 94.60		INV = 95.13 OBV = 95.38

\* WATERMAIN CROSSING AS PER W25 & W25.2  
PROVIDE THERMAL INSULATION AS PER W22  
WHERE THERE IS LESS THAN 2.4m COVER.

CATCHBASIN TABLE					
CB No.	SIZE(mm)	STATION	T/G ELEV(m)	INVERT(m)	ICD DIA.(mm)
CBM3	1200	6+025.86	97.10	SW=94.98 NE=95.03	83mmØ PLATE
CBM4	1500	8+025.86	97.31	SW=95.12 NE=95.20	TEMPEST LMF VORTEX 80
CBM5	1500	9+021.47	97.38	SW=95.56 NE=95.56	TEMPEST LMF VORTEX 40
CBM11	1800	5+017.92	97.08	NE=94.90 SE=94.95	83mmØ PLATE
CBM12	1200	5+054.40	97.55	NW=95.15 SW=95.15	
CBM13	1200	1+208.45	97.23	NE=94.91	83mmØ PLATE
CBM14	1200	1+256.96	97.23	NE=95.09 SW=95.09	TEMPEST LMF VORTEX 40
CBM15	1200	1+390.18	97.50	SE=95.40 NW=95.35	TEMPEST LMF VORTEX 45
CICB2	600Ø600	1+316.65	97.44	NE=96.04 SW=96.04	83mmØ PLATE

SANITARY MANHOLES THAT REQUIRE WATERTIGHT LIDS AS PER CITY SPEC MS-22.15	
MH ID	
109	
113	
115	
213	
215	

STORM MANHOLES THAT REQUIRE WATERTIGHT LIDS AS PER CITY SPEC MS-22.15	
MH ID	
106	
204	

REAR YARD CATCHBASIN TABLE				
CB No.	SIZE(mm)	T/G ELEV(m)	INVERT(m)	ICD SIZE (mm)
RYE1	300	97.47	NW=95.88	
RYE2	300	97.50	NW=95.51	
RYE3	300	97.40	NW=95.96	
RYE10	300	97.37	SE=95.47	
RYE14	300	97.50	SW=96.10	
RYE15	300	97.38	SE=95.86	
RYE16	300	97.58	NE=95.79	
RYE17	300	97.66	SW=96.26	
RYT1	1200	97.35	SW=95.59 SE=95.59 NW=95.59	
RYT3	300	97.44	SE=96.39 NW=95.41	
RYT4	300	97.26	SE=95.23 NW=95.23	
RYT5	300	97.23	NE=95.11 SE=95.11	
RYT6	300	97.18	NW=95.62 SE=95.62	
RYT7	300	97.15	SW=95.14 SE=95.14	
RYT11	300	97.58	NW=95.17 NE=95.17	
RYT15	300	97.48	NE=95.91 SW=95.91	83mmØ PLATE
RYT16	300	97.64	SW=96.07 NE=96.07	

NOTE:  
THE POSITION OF ALL POLE LINES, CONDUITS,  
WATERMANS, SEWERS AND OTHER  
UNDERGROUND AND OVERGROUND UTILITIES AND  
STRUCTURES IS NOT NECESSARILY SHOWN ON  
THE CONTRACT DRAWINGS, AND WHERE SHOWN,  
THE ACCURACY OF THE POSITION OF SUCH  
UTILITIES AND STRUCTURES IS NOT GUARANTEED.  
BEFORE STARTING WORK, DETERMINE THE EXACT  
LOCATION OF ALL SUCH UTILITIES AND  
STRUCTURES AND ASSUME ALL LIABILITY FOR  
DAMAGE TO THEM.

No.	REVISION	DATE	BY
7.	REVISED PER CITY COMMENTS	MAR 18/26	DOB
6.	REVISED SITE PLAN SUBMISSION	NOV 14/25	DOB
5.	RE-ISSUED FOR TENDER	JAN 18/24	DOB
4.	ISSUED FOR TENDER	MAY 20/22	DOB
3.	REVISED PER CITY COMMENTS	FEB 17/22	DOB
2.	REVISED PER CITY COMMENTS	NOV 5/21	DOB
1.	ISSUED FOR CITY OF OTTAWA REVIEW	JUN 2/21	DOB

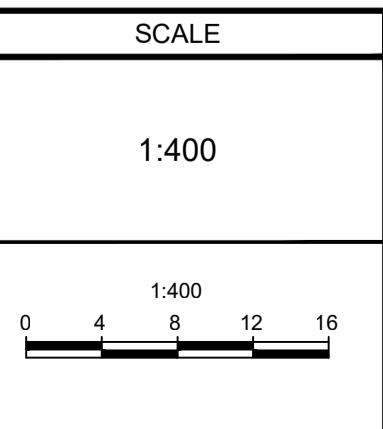

**FOR REVIEW ONLY**

DESIGN: BM  
CHECKED: DDB  
DRAWN: ATE  
CHECKED: BM  
APPROVED: DDB



**N VATECH**  
Engineers, Planners & Landscape Architects  
Suite 200, 240 Michael Cowpland Drive  
Ottawa, Ontario, Canada K2M 1P6  
Telephone: (613) 254-9643  
Facsimile: (613) 254-5867  
Website: www.novatech-eng.com

CITY OF OTTAWA  
5331 FERNBANK ROAD  
IRON VALLEY 2

DRAWING NAME: GENERAL PLAN OF SERVICES

PROJECT No.: 121011-00  
REV: REV #7  
DRAWING No.: 121011-GP2  
#18539

M:\2021\121011-GP1\121011-GP1.dwg, GP2, Mar 18, 2026 - 5:11pm, chahna