

REFER TO DETAILS ON DRAWING No. C-11
REFER TO NOTES ON DRAWING No. C-22

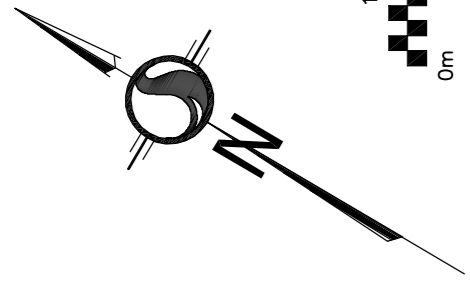

RETAINING WALL
(REINFORCED)
(T.O.W. VARIES)
±88.02 TO ±87.81
B.O.W. VARIES
87.36 TO 87.65
HEIGHT VARIES
±0.66m TO ±0.16m

RETAINING WALL
(REINFORCED)
(T.O.W. VARIES)
±87.81 TO ±87.41
B.O.W. VARIES
87.65 TO 87.41
HEIGHT VARIES
±0.16m TO 0m

PROPOSED 4-STORY
APARTMENT BUILDING 1

FFL = 87.69
TOF = 88.07
USF = 85.69

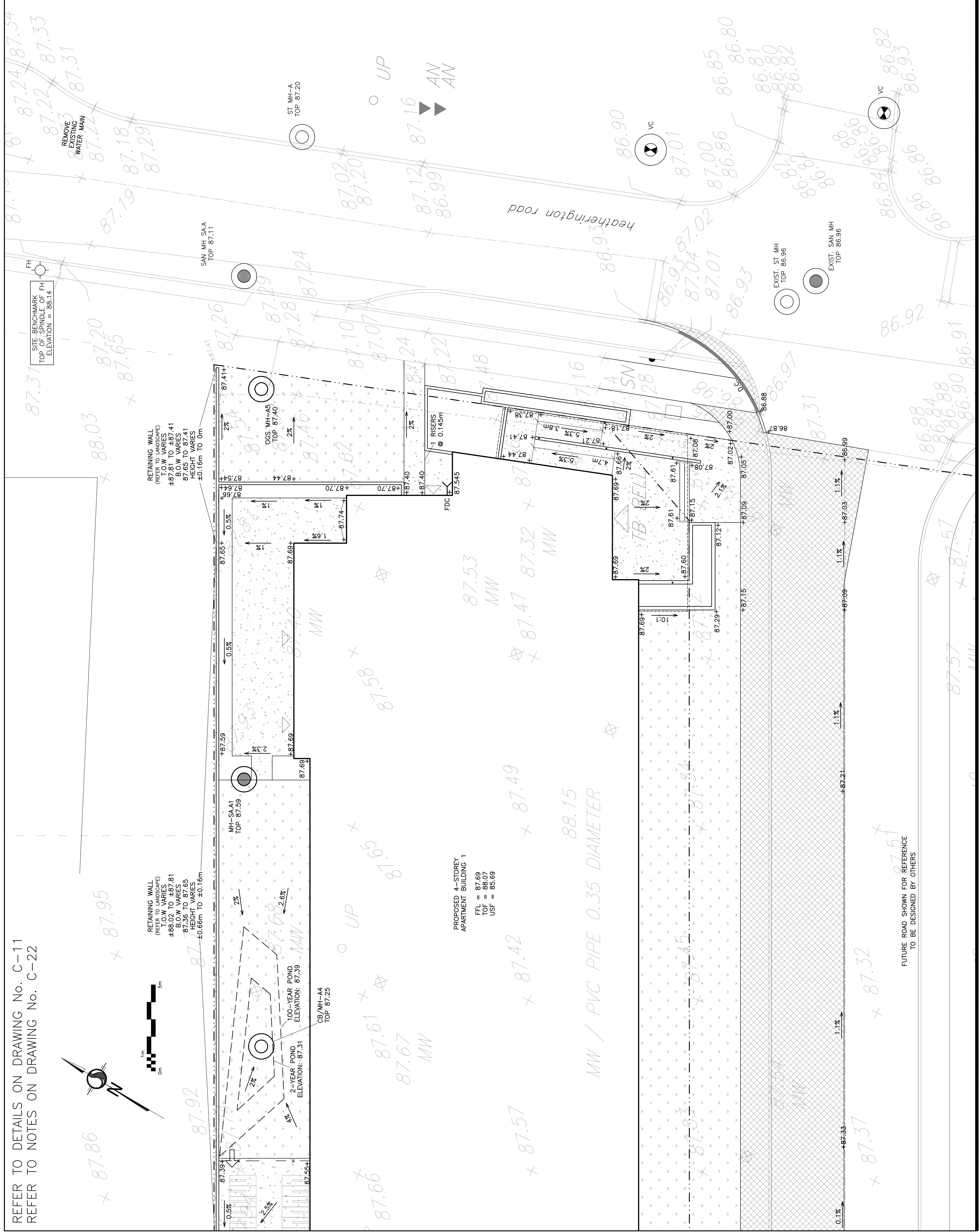

KEY PLAN



LEGEND

- FFL FIRST FLOOR ELEVATION
- TOF TOP OF FOUNDATION
- USF UNDERSIDE OF FOOTING
- PROPERTY LINE
- CB CATCH BASIN
- MH STORM MANHOLE
- CB/MH CATCH BASIN/MANHOLE
- MH SANITARY MANHOLE
- VC VALVE CHAMBER
- FH FIRE HYDRANT
- FDC FIRE DEPARTMENT CONNECTION
- EXISTING GRADE ELEVATION
- PROPOSED GRADE ELEVATION
- PROPOSED SLOPE OF GRADE
- EMERGENCY OVERLAND FLOW
- 150mm BARRIER CURB
- D.C. DEPRESSED CURB
- LIGHT-DUTY PAVEMENT
- HEAVY-DUTY PAVEMENT
- CONCRETE
- LANDSCAPE

No.	DATE	REVISION
2	MAR 5-26	ISSUED FOR APPROVAL
1	JAN 30-26	ISSUED FOR COORDINATION

D.B. GRAY ENGINEERING INC.
Professional Engineer - Ontario
700 Long Point Circle
Ottawa, Ontario
d.gray@dbgrayengineering.com

Project
PROPOSED 4-STORY APARTMENT BUILDINGS
1770 HEATHERINGTON ROAD
OTTAWA, ONTARIO

Drawing Title
GRADING PLAN
(BUILDING 1 EAST)

Engineer's Seal

 Drawn: D.B.G.
 H. Scale: 1:100
 V. Scale: 1:20
 Date: JAN 30-26
 Job No.: 24135
 Drawing No.: C-7
 of 22
 NOT VALID UNLESS SIGNED & DATED