

Copyright Reserved

The Contractor shall verify and be responsible for all dimensions. DO NOT scale the drawing - any errors or omissions shall be reported to Stantec without delay.
The Copyrights to all designs and drawings are the property of Stantec. Reproduction or use for any purpose other than that authorized by Stantec is forbidden.

Legend

- PROPOSED WATERMAIN
- PROPOSED VALVE AND VALVE BOX
- PROPOSED REDUCER
- PROPOSED FIRE HYDRANT
- PROPOSED SANITARY SEWER
- PROPOSED STORM SEWER AND ETOBICOKE SYSTEM
- PROPOSED CATCH-BASIN MANHOLE
- PROPOSED CATCH-BASIN
- EXISTING WATERMAIN
- EXISTING VALVE AND VALVE BOX
- EXISTING REDUCER
- EXISTING FIRE HYDRANT
- EXISTING SANITARY SEWER
- EXISTING STORM SEWER
- EXISTING CATCH-BASIN MANHOLE
- EXISTING CATCH-BASIN
- PROPOSED DEPRESSED CURB LOCATIONS
- PROPOSED BARRIER CURB
- THERMAL INSULATION ON STORM SEWER WHERE COVER IS LESS THAN 1.5m. THERMAL INSULATION ON WATERMAIN WHERE COVER IS LESS THAN 2.4m AS PER W22.
- PROPOSED 2H RATED FIRE WALL LOCATION

- SCUPPER LOCATIONS
TYPICAL ROAD CROSS-SECTION
REFER TO D02 FOR MORE DETAILS
- SERVICE LATERAL LOCATION (SANITARY AND WATER ONLY)
150mm SANITARY SERVICE PVC SDR 26 @ 15.4m
150mm PE TUBING WATER SERVICE C/W CURB STOP AND SERVICE POST, WATER AND REARCE METER
STANDPOST ON PRIVATE SIDE TO BE LOCATED 0.5m FROM FACE OF CURB, STANDPOST ON PUBLIC SIDE TO BE ON PROPERTY
 - SERVICE LATERAL LOCATION (SANITARY, WATER AND STORM)
100mm STORM SERVICE PVC SDR 26 @ 15.4m
150mm SANITARY SERVICE PVC SDR 26 @ 15.4m
150mm PE TUBING WATER SERVICE C/W CURB STOP AND SERVICE POST, WATER AND REARCE METER
STANDPOST ON PRIVATE SIDE TO BE LOCATED 0.5m FROM FACE OF CURB, STANDPOST ON PUBLIC SIDE TO BE ON PROPERTY

Revision	By	Appd.	YY.MM.DD
1	JP	PM	26.03.23
Permit-Seal			
File Name: 160402276-D8	JP	PM	26.02.05
	Dwn.	Chkd.	Dsgn.
			YY.MM.DD



Client/Project
MATTAMY HOMES

WATERIDGE VILLAGE
BLOCK 23
OTTAWA, ON, CANADA

Title
PLAN AND PROFILE
STREET 7
STA. 0+000 TO STA. 0+320

Project No. 160402276	Scale 1:500H 1:500V
Drawing No. PP-5	Sheet 12 of 14
	Revision 1

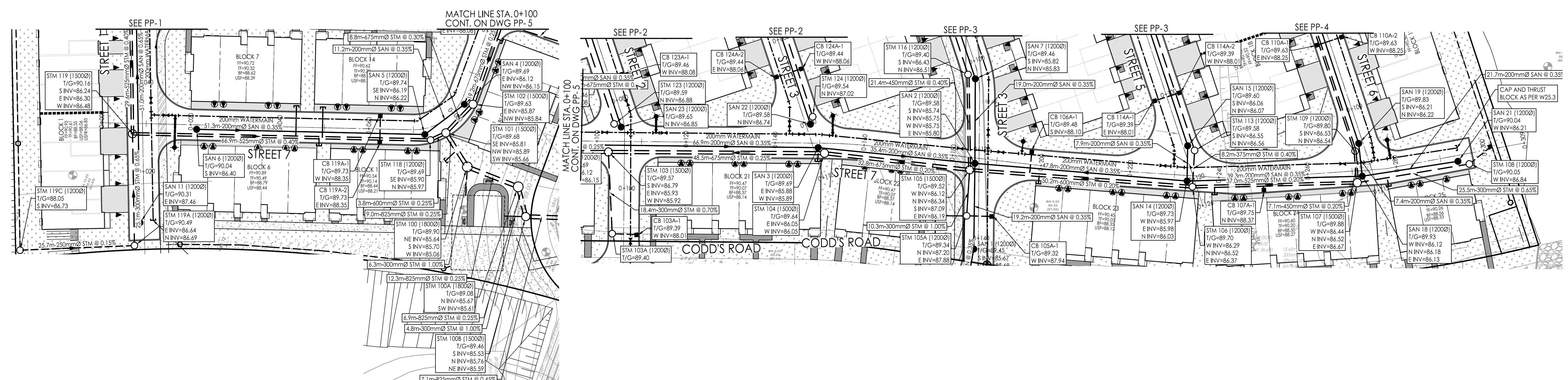

PROPOSED ROAD	TOP OF WATERMAIN	PROPOSED ROAD	TOP OF WATERMAIN
94	87.74	94	87.74
93	87.46	93	87.46
92	87.62	92	87.62
91	87.50	91	87.50
90	87.39	90	87.39
89	87.28	89	87.28
88	87.15	88	87.15
87	87.14	87	87.14
86	87.19	86	87.19
85	87.29	85	87.29
84	87.20	84	87.20
83	87.24	83	87.24
82	87.30	82	87.30
81	87.34	81	87.34
80	87.45	80	87.45
79	87.52	79	87.52
78	87.55	78	87.55
77	87.62	77	87.62

V:\1\1604\160402276\160402276.dwg
 2023/03/24 10:41:06
 160402276-08_PP.dwg
 ORIGINAL SHEET - ARCH D