

**PROPOSED PLANT LIST**



KEY	QTY.	BOTANICAL NAME	COMMON NAME	SIZE	CONDITION	REMARKS
<b>DECIDUOUS TREES</b>						
* AF	2	<i>Acer x freemanii</i>	Freeman's Maple	50mm ø	B&B	
* AR	2	<i>Acer rubrum</i>	Red Maple	50mm ø	B&B	
* AS	2	<i>Acer saccharum</i>	Sugar Maple	50mm ø	B&B	
* CO	4	<i>Celtis occidentalis</i>	Common Hackberry	50mm ø	B&B	
CS	3	<i>Picea pungens</i>	Colorado Spruce	2.0m Ht.	B&B	
* QM	3	<i>Quercus macrocarpa</i>	Bur Oak	50mm ø	B&B	
* QR	3	<i>Quercus rubra</i>	Red Oak	50mm ø	B&B	
* SI	3	<i>Acer saccharinum</i>	Silver Maple	50mm ø	B&B	
* TA	3	<i>Tilia americana</i>	American Basswood	50mm ø	B&B	
* WS	1	<i>Picea glauca</i>	White Spruce	2.0m Ht.	B&B	

**SHRUBS**

* Cs	42	<i>Cornus sericea</i>	Red Osier Dogwood	800mm ht.	Potted	Space 1000mm o.c.
* FS	42	<i>Rhus aromatica</i>	Fragrant Sumac	600mm ht.	Potted	Space 1000mm o.c.
* Mg	42	<i>Myrica gale</i>	Sweet Gale	600mm ht.	Potted	Space 1000mm o.c.
* Mp	40	<i>Myrica pensylvanica</i>	Northern Bayberry	600mm ht.	Potted	Space 1800mm o.c.

**ORNAMENTAL GRASSES**

BL	65	<i>Leymus arenarius 'Blue Dune'</i>	Blue Lyme Grass	250mm pot	Potted	Space 800mm o.c.
KF	76	<i>Calamagrostis 'Karl Foerster'</i>	Feather Reed Grass	250mm pot	Potted	Space 800mm o.c.
OD	39	<i>Calamagrostis 'Overdam'</i>	Overdam Grass	250mm pot	Potted	Space 800mm o.c.

**REFORESTATION TREES**

* AA	8	<i>Acer saccharum</i>	Sugar Maple	3.0m ht.	Potted	Space 3.0m o.c.
* AC	8	<i>Acer x freemanii</i>	Freeman's Maple	3.0m ht.	Potted	Space 3.0m o.c.
* AI	8	<i>Acer saccharinum</i>	Silver Maple	3.0m ht.	Potted	Space 3.0m o.c.
* BP	8	<i>Betula papyrifera</i>	Paper Birch	3.0m ht.	Potted	Space 3.0m o.c.
* CE	8	<i>Celtis occidentalis</i>	Common Hackberry	3.0m ht.	Potted	Space 3.0m o.c.
* PT	8	<i>Populus tremuloides</i>	Quaking Aspen	3.0m ht.	Potted	Space 3.0m o.c.
* PG	8	<i>Picea glauca</i>	White Spruce	3.0m ht.	Potted	Space 3.0m o.c.
* PS	8	<i>Pinus strobus</i>	Eastern White Pine	3.0m ht.	Potted	Space 3.0m o.c.
* TI	8	<i>Tilia americana</i>	American Basswood	3.0m ht.	Potted	Space 3.0m o.c.

\* SPECIES IS NATIVE TO ONTARIO

**40 YEAR CANOPY CALCULATION**

- 65,978m<sup>2</sup> site area

- 78 Large trees proposed (154m<sup>2</sup> ea.),  
- 4 medium trees proposed (79m<sup>2</sup> ea.)  
- 20 large coniferous trees proposed (79m<sup>2</sup> ea.)

=13,908m<sup>2</sup> canopy cover = 21.1% canopy cover

\*Large deciduous trees calculated at 14m spread, medium deciduous at 10m spread and large coniferous at 10m spread

**KEY PLAN**

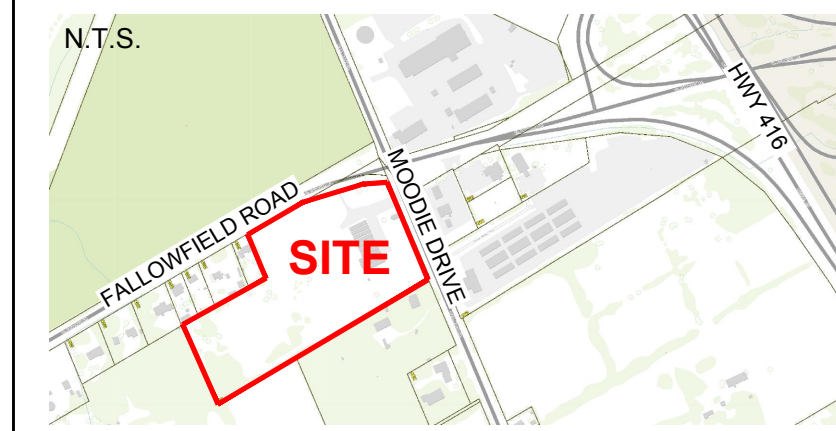

**LEGAL DESCRIPTION:**  
PART OF LOT 20 (RIDEAU FRONT)  
GEOGRAPHIC TOWNSHIP OF NEPEAN  
CITY OF OTTAWA

**GENERAL NOTES**

- IT IS THE RESPONSIBILITY OF THE APPROPRIATE CONTRACTOR OR OFFICIAL TO REPORT ANY ERRORS, OMISSIONS OR DISCREPANCIES ON THIS PLAN WITH ACTUAL SITE CONDITIONS TO THE LANDSCAPE ARCHITECT BEFORE PROCEEDING WITH CONSTRUCTION.
  - THE CONTRACTOR IS TO NOTIFY ALL UTILITY COMPANIES AND AUTHORITIES PRIOR TO ANY EXCAVATION AND ASCERTAIN LOCATIONS OF UNDERGROUND SERVICES.
  - THE CONTRACTOR IS TO REINSTATE ALL AREAS AND ITEMS DAMAGED AS A RESULT OF CONSTRUCTION ACTIVITY.
  - THE CONTRACTOR IS TO COMPLY WITH ALL PERTINENT CODES AND BY-LAWS.
  - THE CONTRACTOR IS TO MAINTAIN A POSITIVE SURFACE RUN-OFF THROUGHOUT THE ENTIRE CONSTRUCTION PERIOD.
  - THE LANDSCAPE ARCHITECT IS NOT RESPONSIBLE FOR SUBSURFACE CONDITIONS.
  - THE CONTRACTOR IS TO IDENTIFY ALL EXISTING TREES TO REMAIN ON SITE WITH THE LANDSCAPE ARCHITECT PRIOR TO CONSTRUCTION.
  - THE CONTRACTOR IS TO STAKE THE PROPOSED LOCATION OF ALL PLANT MATERIAL IN CONJUNCTION WITH THE LANDSCAPE ARCHITECT PRIOR TO EXCAVATION.
  - MINIMUM DISTANCES FOR SELECTED DECIDUOUS TREES ARE AS FOLLOWS:
    - BUILDING FOUNDATIONS - 7.5M
    - SIDEWALKS - 1.5M
    - PUBLIC STREETS - 2.5M
    - UNDERGROUND INFRASTRUCTURE - 2.0M
  - ALL TREES WITHIN 1M OF UNDERGROUND UTILITY TRENCHES ARE TO BE EXCAVATED BY HAND.
  - REMOVE ALL PROTECTIVE WRAPPING FROM TREE TRUNKS AFTER INSTALLATION.
  - STAKING OF TREES SHALL ONLY BE PERFORMED IF NECESSARY.
  - ENSURE THAT MULCH IS PULLED BACK A MINIMUM DISTANCE OF 75MM FROM BASE OF TREE TRUNK.
  - ENSURE THAT TREES PLANTED IN THE REFORESTATION AREA ARE IN GROUPS OF TWO OR THREE OF THE SAME SPECIES.
- \* PLEASE REFER TO "ENVIRONMENTAL IMPACT STUDY AND TREE CONSERVATION REPORT" PREPARED BY MUNCASTER ENVIRONMENTAL PLANNING INC. JULY 4TH, 2023 FOR INFORMATION REGARDING EXISTING TREES ON SITE AND REQUIRED PROTECTION MEASURES.

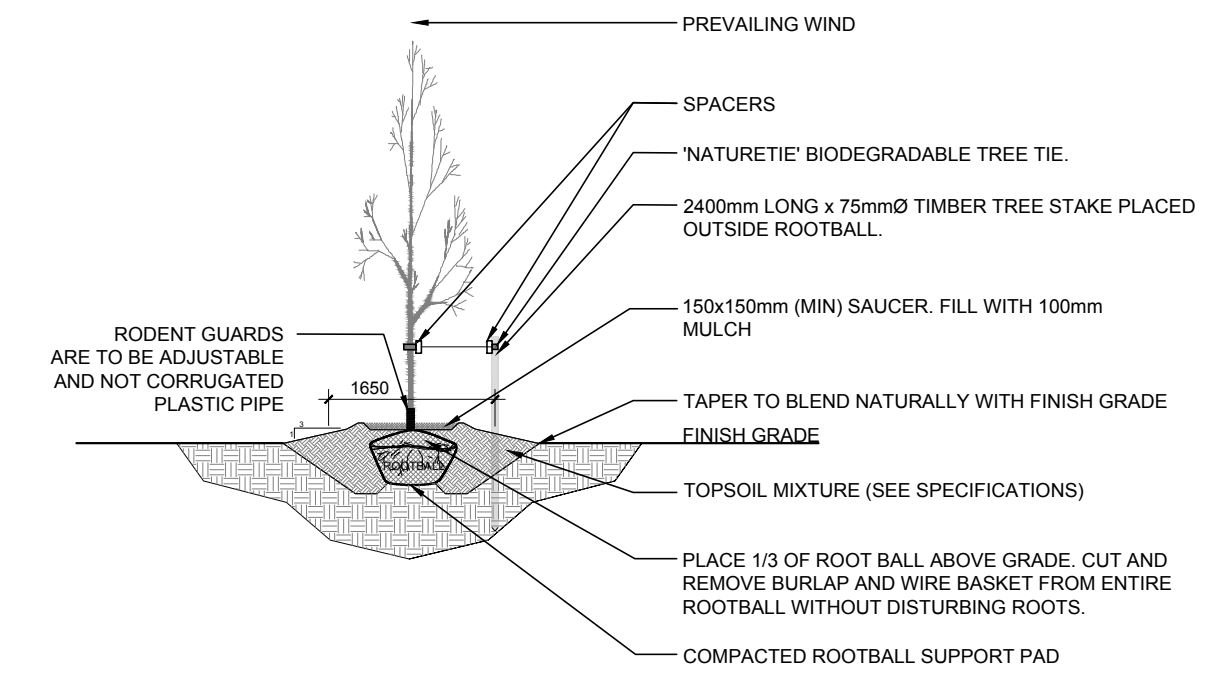

**2 DECIDUOUS TREE PLANTING**  
SCALE: NTS

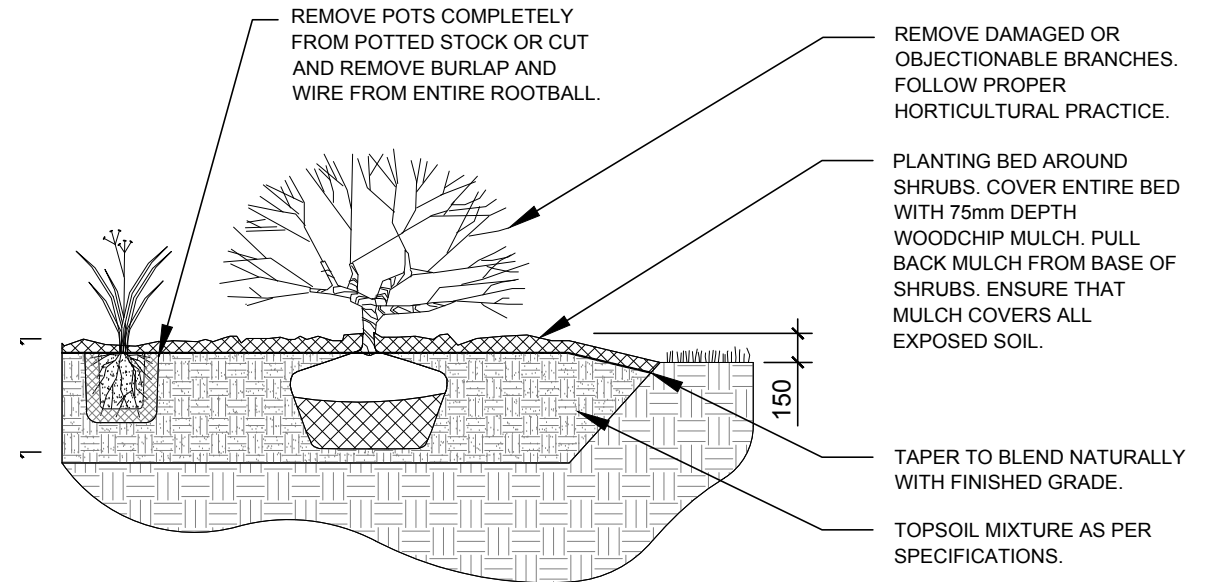

**3 SHRUB / ORNAMENTAL GRASS PLANTING**  
SCALE: NTS

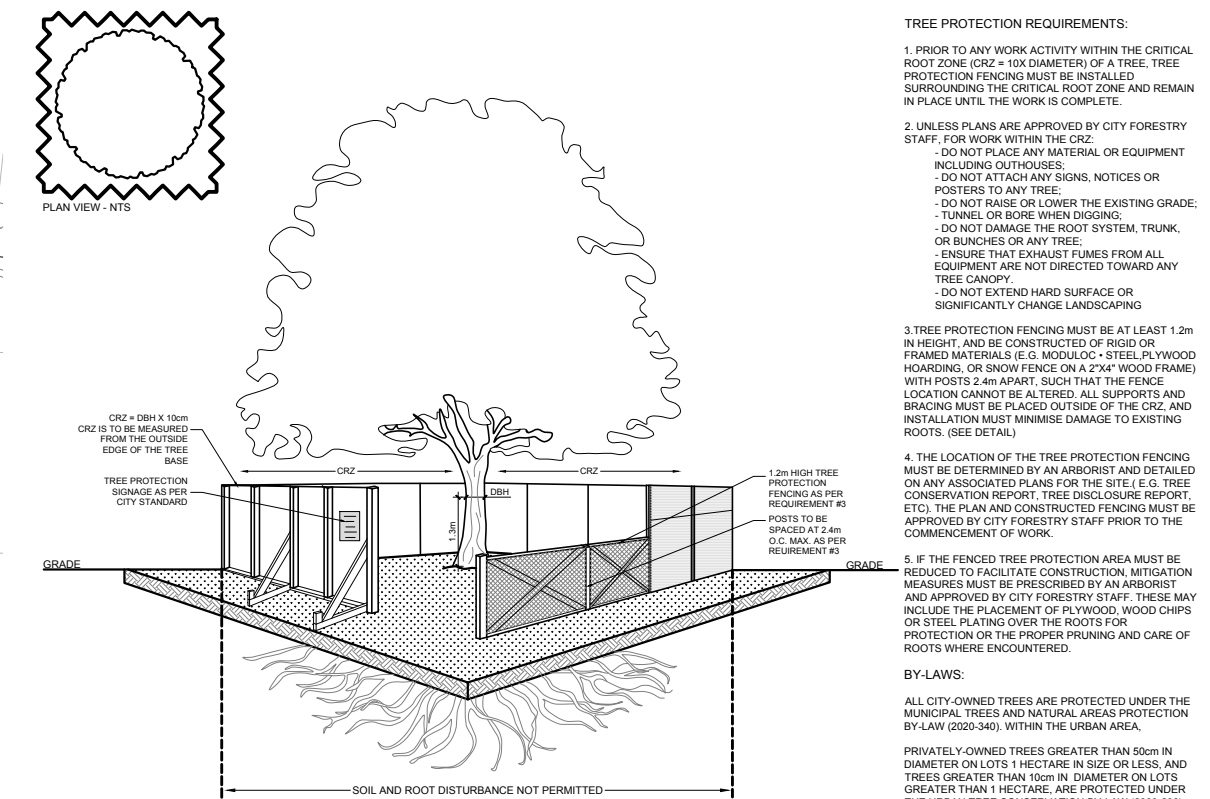

**4 TREE PROTECTION FENCING**  
SCALE: NTS

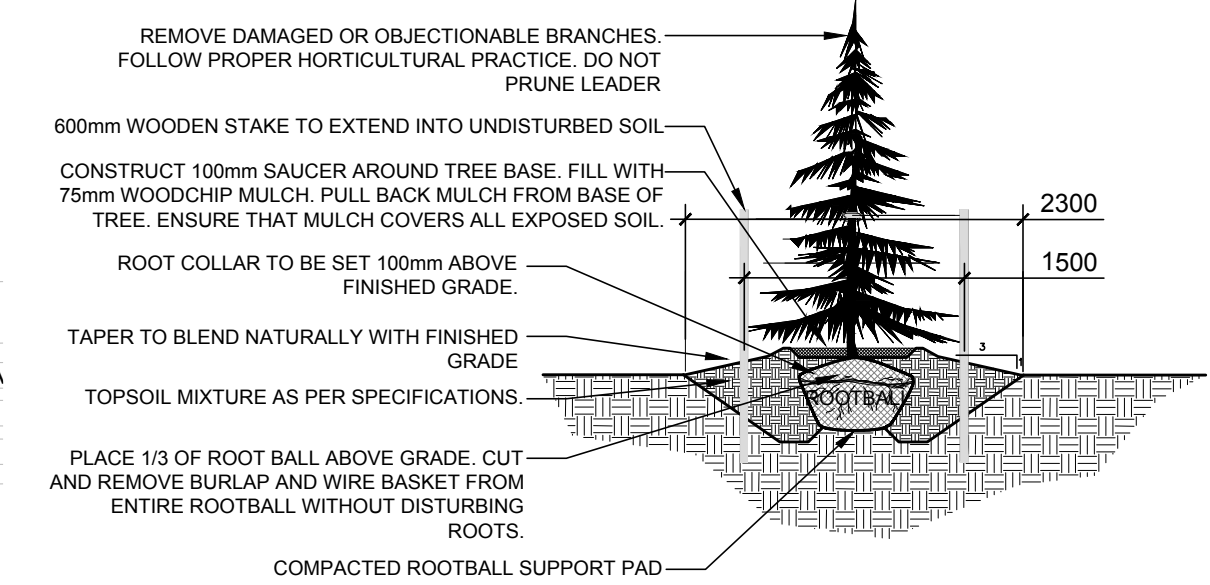

**5 CONIFEROUS TREE PLANTING**  
SCALE: NTS

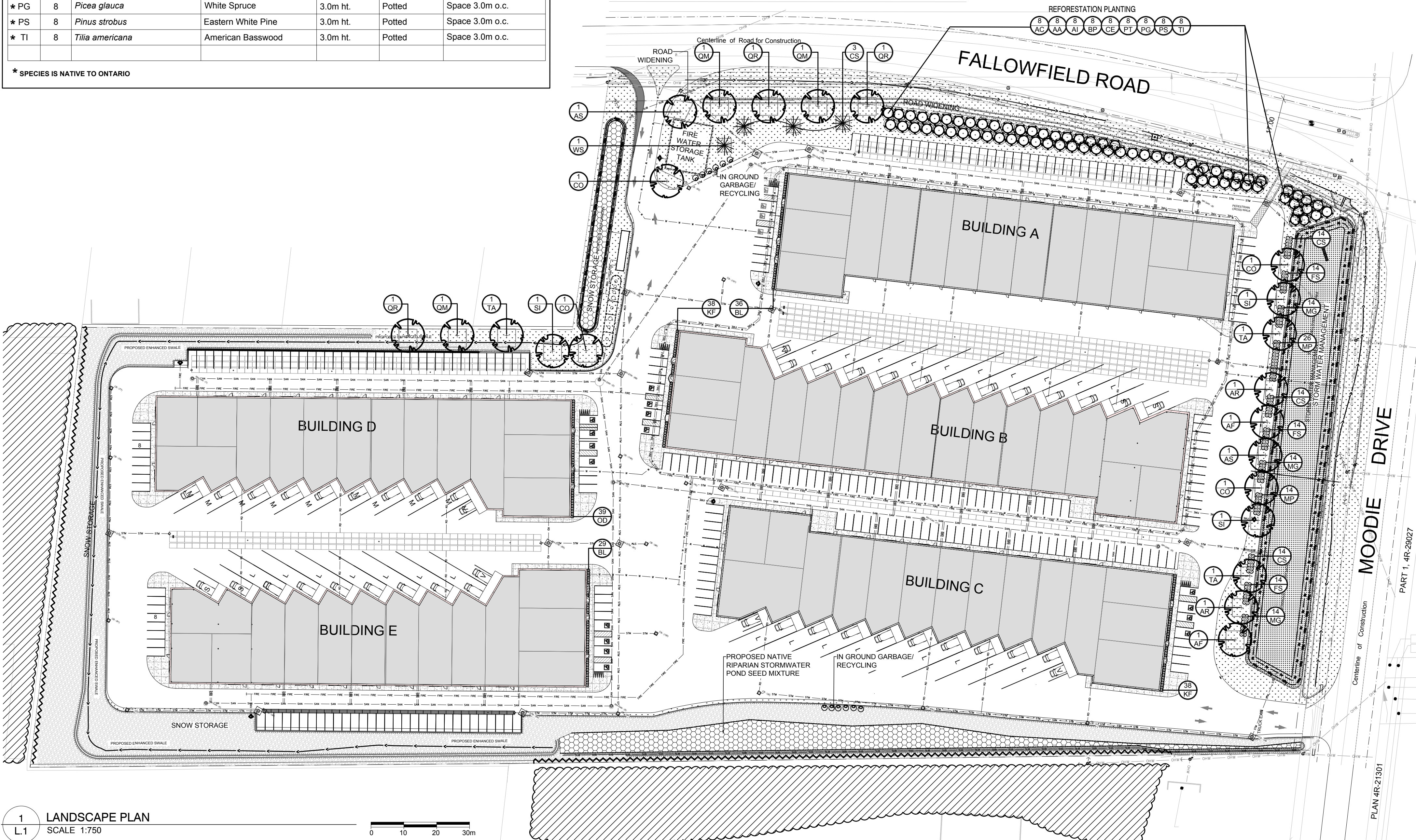

**1 LANDSCAPE PLAN**  
SCALE: 1:750



CLIENT

**HIE OTTAWA**

CONSULTANTS

ARCHITECTS:



CIVIL ENGINEERS:



LEGEND

- PROPOSED SEEDED GRASS AREA
- PROPOSED RAIN GARDEN SEED MIXTURE
- PROPOSED NATIVE RIPARIAN STORMWATER POND SEED MIXTURE
- PROPOSED RIP-RAP (REFER TO CIVIL DRAWING FOR DETAILS)
- PROPOSED DECIDUOUS TREE
- 30m<sup>3</sup> SOIL VOLUME AT A 1.5m DEPTH
- PROPOSED CONIFEROUS TREE
- 25m<sup>3</sup> SOIL VOLUME AT A 1.5m DEPTH
- PROPOSED REFORESTATION TREE 20m<sup>3</sup> SINGLE TREE SOIL VOLUME AT A 1.5m DEPTH
- PROPOSED SHRUBS/ORNAMENTAL GRASSES
- GROUP OF EXISTING TREES TO REMAIN
- TREE PROTECTION FENCING

14	REVISED PER NEW CIVIL DRAWING	03/16/2026	WF	JL
13	REVISED PER NEW SITE PLAN	01/29/2026	ML	JL
12	REVISED PER NEW SITE PLAN	01/07/2026	WF	JL
11	REVISED PER NEW CIVIL DRAWING	10/29/2025	ML	JL
10	REVISED PER NEW CIVIL DRAWING	06/17/2024	ML	JL
9	REVISED PER NEW SITE PLAN	05/01/2024	CM	JL
8	REVISED PER CITY COMMENTS	04/18/2024	ML	JL
7	REVISED PER NEW SITE PLAN	01/02/2024	ML	JL
6	ISSUED FOR SITE PLAN CONTROL	10/12/2023	LC	JL
5	UPDATED PER NEW SITE PLAN	06/08/2023	CM	JL
4	UPDATED PER EIS	05/31/2023	CM	JL
3	ISSUED FOR DISCUSSION AND REVIEW	05/17/2023	CM	JL
2	ISSUED FOR DISCUSSION AND REVIEW	05/10/2023	CM	JL
1	ISSUED FOR DISCUSSION AND REVIEW	03/22/2023	ML	JL

**JAMES B. LENNOX & ASSOCIATES INC.**  
LANDSCAPE ARCHITECTS  
3332 CARLING AVE. OTTAWA, ONTARIO K2H 5A8  
Tel. (613) 722-5168 Fax. (1866) 343-3942

PROJECT  
2726 MOODIE DRIVE DEVELOPMENT  
2726 MOODIE DRIVE, OTTAWA, ON

DRAWING  
LANDSCAPE PLAN

SCALE	AS SHOWN
START DATE	MARCH, 2023
PROJECT NO.	23MIS2326

PROJECT NORTH  
DRAWING NO.  
**L.1**  
PLOT SIZE ARCH-D