



LEGEND

- FFL FINISHED FLOOR ELEVATION
- TOF TOP OF FOUNDATION
- BFL BASEMENT FLOOR ELEVATION
- USF UNDERSIDE OF FOOTING
- PROPERTY LINE
- - - - - CRITICAL ROOT ZONE
- CB [] CATCH-BASIN
- MH (○) STORM MANHOLE
- CB/MH (○) CATCH-BASIN/MANHOLE
- MH (○) SANITARY MANHOLE
- FH (⊕) FIRE HYDRANT
- FDC (Y) FIRE DEPARTMENT CONNECTION
- VB (■) VALVE & VALVE BOX
- (M) WATER METER
- (R) REMOTE WATER METER
- SAN ——— SANITARY SEWER
- ST ——— STORM SEWER
- WS/WM ——— WATER SERVICE/WATERMAIN

KEY PLAN



No.	DATE	REVISION
7	FEB 24-26	RE-ISSUED FOR APPROVAL
6	JAN 27-26	ISSUED FOR TENDER
5	DEC 10-25	RE-ISSUED FOR APPROVAL
4	JAN 17-25	ISSUED FOR ZONING
3	DEC 6-24	ISSUED FOR BUILDING PERMIT
2	DEC 21-22	ISSUED FOR APPROVAL
1	DEC 19-22	ISSUED FOR COORDINATION

D. B. GRAY ENGINEERING INC.
Stormwater Management - Grading & Drainage - Storm & Sanitary Sewers - Watermain
 700 Long Point Circle 613-425-8044
 Ottawa, Ontario d.gray@dbgrayengineering.com

Project
PROPOSED 6-STORY MIXED-USE BUILDING
2040 ARROWSMITH DRIVE
 OTTAWA, ONTARIO

Drawing Title
**OVERALL
 SERVICING PLAN**

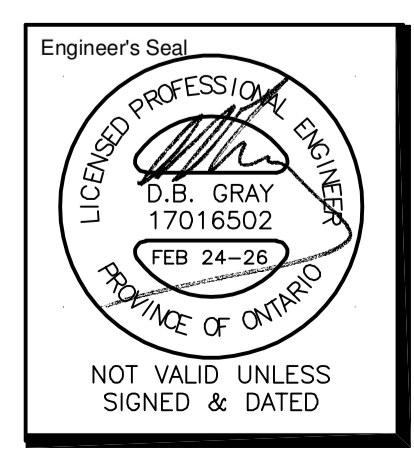

Drawn D.B.G.
 H. Scale 1:400
 V. Scale
 Date NOV 29-22
 Job No. 22062

Drawing No.
C-1
 of 18

REFER TO NOTES, DETAILS &
 SCHEDULES ON DRAWINGS C-10, C-11 & C-12

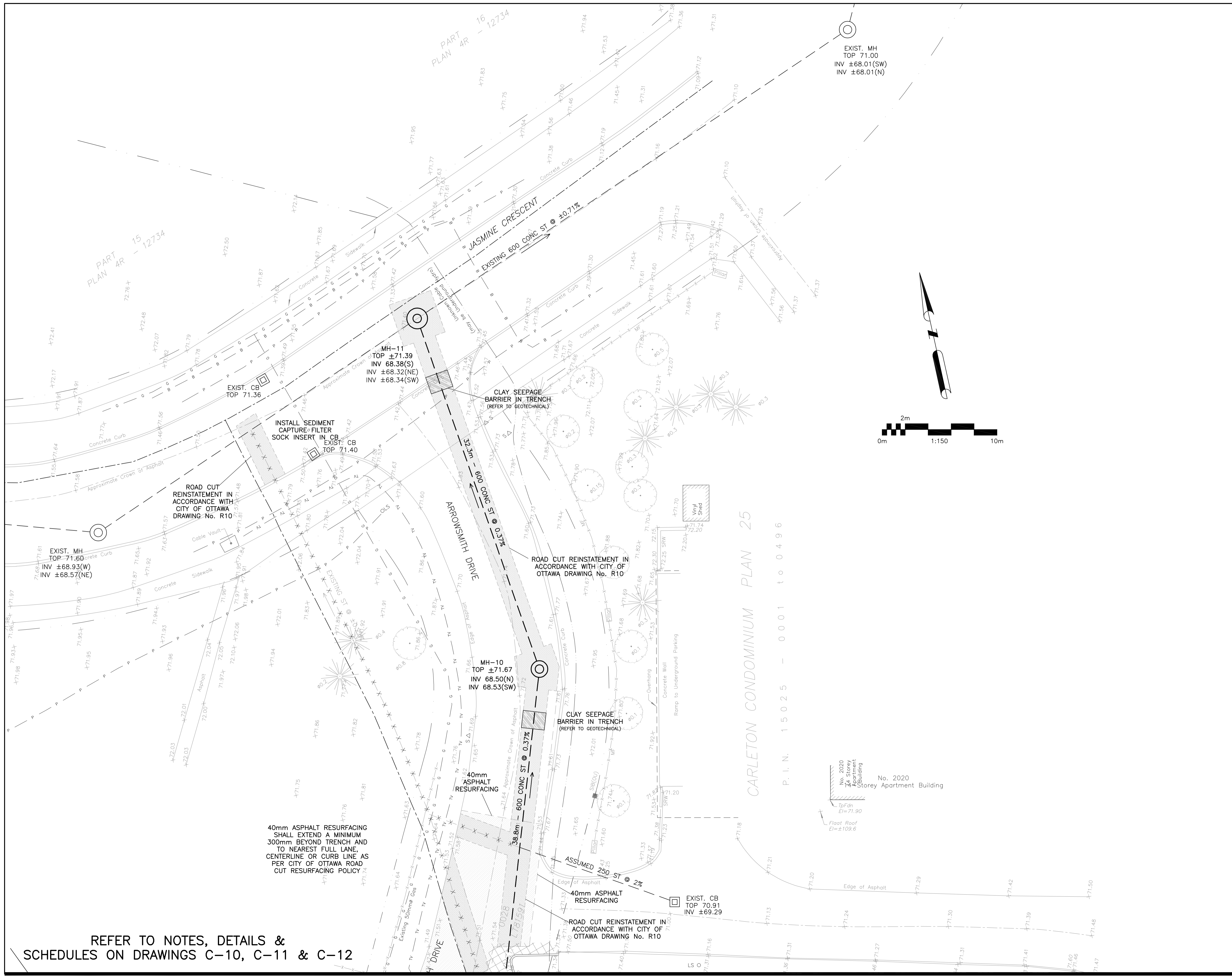

LEGEND

- FFL FINISHED FLOOR ELEVATION
- TOF TOP OF FOUNDATION
- BFL BASEMENT FLOOR ELEVATION
- USF UNDERSIDE OF FOOTING
- PROPERTY LINE
- C.R.Z CRITICAL ROOT ZONE
- CB CATCH-BASIN
- MH STORM MANHOLE
- CB/MH CATCH-BASIN/MANHOLE
- MH SANITARY MANHOLE
- FH FIRE HYDRANT
- FDC FIRE DEPARTMENT CONNECTION
- VB VALVE & VALVE BOX
- Ⓜ WATER METER
- Ⓡ REMOTE WATER METER
- SAN SANITARY SEWER
- ST STORM SEWER
- WS/WM WATER SERVICE/WATERMAIN
- OBV OBVERT OF PIPE
- SPL SPRINGLINE OF PIPE
- INV INVERT OF PIPE
- ROAD CUT REINSTATEMENT
- ASPHALT RESURFACING
- LIGHT-DUTY PAVEMENT
- HEAVY-DUTY PAVEMENT

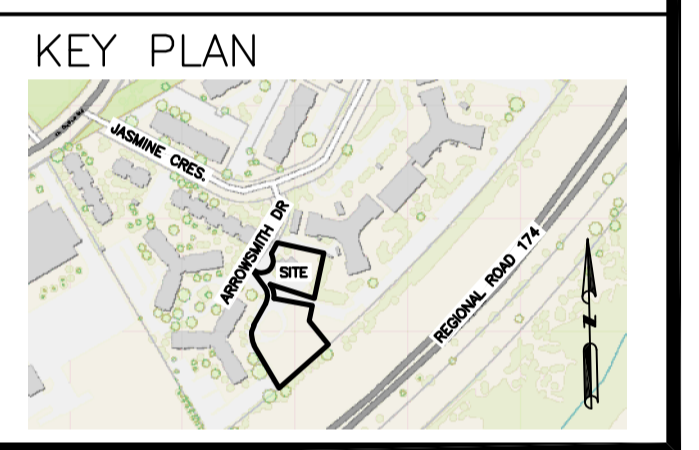

No.	DATE	REVISION
7	FEB 24-26	RE-ISSUED FOR APPROVAL
6	JAN 27-26	ISSUED FOR TENDER
5	DEC 10-25	RE-ISSUED FOR APPROVAL
4	JAN 17-25	ISSUED FOR ZONING
3	DEC 6-24	ISSUED FOR BUILDING PERMIT
2	DEC 21-22	ISSUED FOR APPROVAL
1	DEC 19-22	ISSUED FOR COORDINATION

D. B. GRAY ENGINEERING INC.
 Stormwater Management - Grading & Drainage - Storm & Sanitary Sewers - Watermain
 700 Long Point Circle 613-425-8044
 Ottawa, Ontario d.gray@dbgrayengineering.com

Project
PROPOSED 6-STORY MIXED-USE BUILDING
2040 ARROWSMITH DRIVE
 OTTAWA, ONTARIO

Drawing Title
SITE SERVICING PLAN
 (ARROWSMITH DR STORM SEWER)

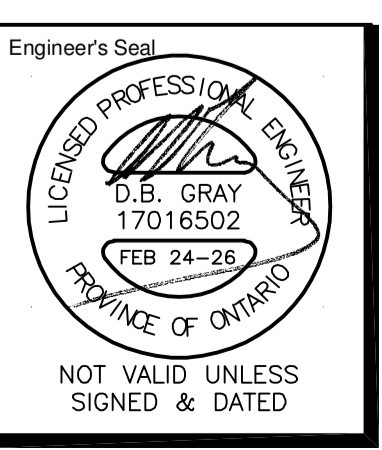

Engineer's Seal
 Drawn D.B.G.
 H. Scale 1:150
 V. Scale
 Date NOV 29-22
 Job No. 22062
 Drawing No.
C-2
 of 18

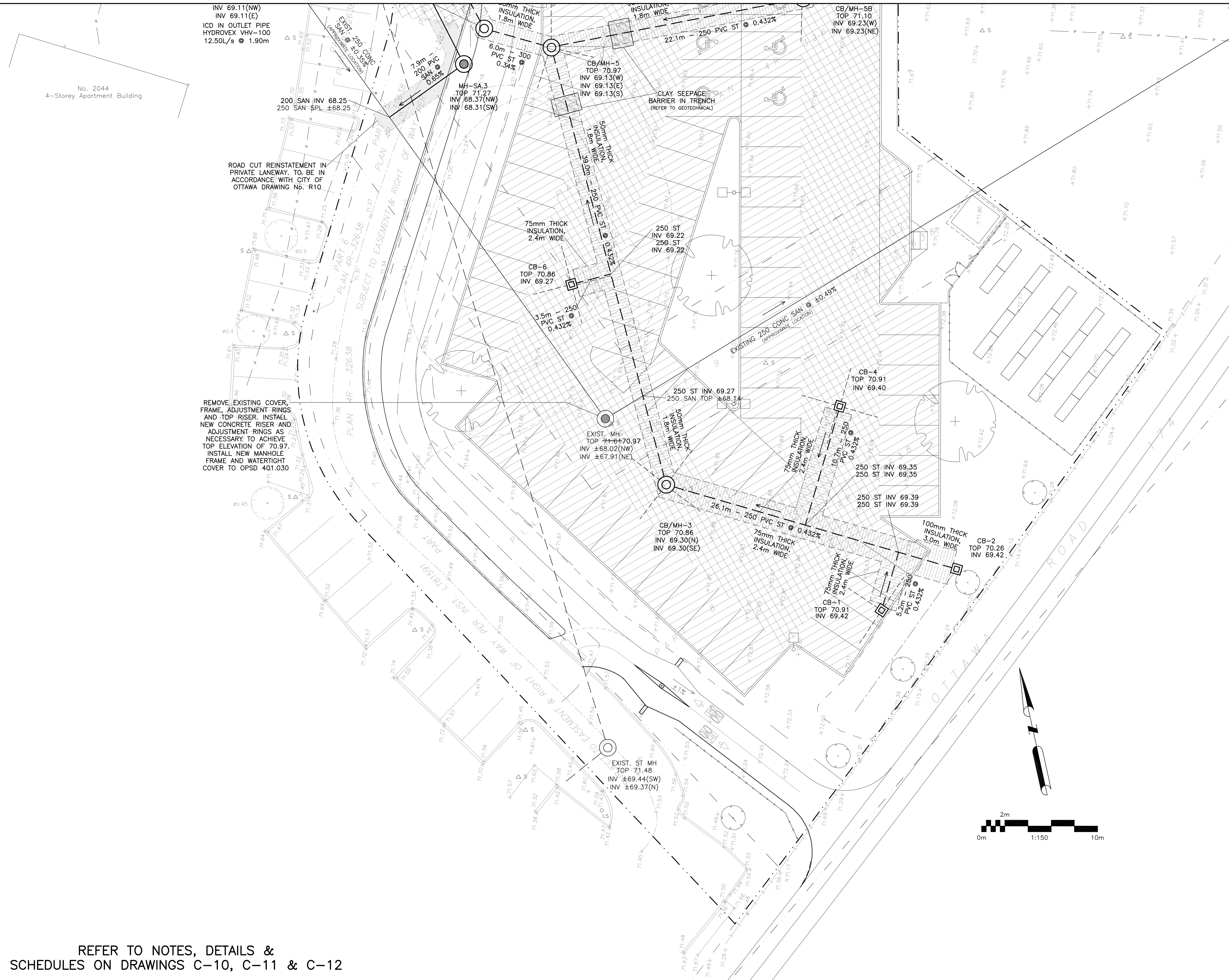

REFER TO NOTES, DETAILS & SCHEDULES ON DRAWINGS C-10, C-11 & C-12

LEGEND

F.F.L.	FINISHED FLOOR ELEVATION
T.O.F.	TOP OF FOUNDATION
B.F.L.	BASEMENT FLOOR ELEVATION
U.S.F.	UNDERSIDE OF FOOTING
---	PROPERTY LINE
C.R.Z.	CRITICAL ROOT ZONE
CB	CATCH-BASIN
MH	STORM MANHOLE
CB/MH	CATCH-BASIN/MANHOLE
MH	SANITARY MANHOLE
FH	FIRE HYDRANT
FDC	FIRE DEPARTMENT CONNECTION
VB	VALVE & VALVE BOX
(M)	WATER METER
(R)	REMOTE WATER METER
SAN	SANITARY SEWER
ST	STORM SEWER
WS/WM	WATER SERVICE/WATERMAIN
OBV	OBVERT OF PIPE
SPL	SPRINGLINE OF PIPE
INV	INVERT OF PIPE
[Hatched Box]	ROAD CUT REINSTATEMENT
[Dotted Box]	ASPHALT RESURFACING
[Diagonal Lines]	LIGHT-DUTY PAVEMENT
[Cross-hatched Box]	HEAVY-DUTY PAVEMENT

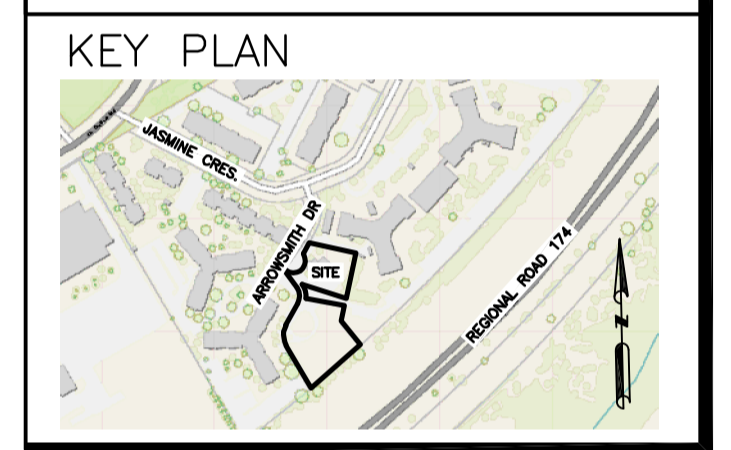

No.	DATE	REVISION
7	FEB 24-26	RE-ISSUED FOR APPROVAL
6	JAN 27-26	ISSUED FOR TENDER
5	DEC 10-25	RE-ISSUED FOR APPROVAL
4	JAN 17-25	ISSUED FOR ZONING
3	DEC 6-24	ISSUED FOR BUILDING PERMIT
2	DEC 21-22	ISSUED FOR APPROVAL
1	DEC 19-22	ISSUED FOR COORDINATION

D. B. GRAY ENGINEERING INC.
 Stormwater Management - Grading & Drainage - Storm & Sanitary Sewers - Watermain
 700 Long Point Circle 613-425-8044
 Ottawa, Ontario d.gray@dbgrayengineering.com

Project
PROPOSED 6-STORY MIXED-USE BUILDING
2040 ARROWSMITH DRIVE
 OTTAWA, ONTARIO

Drawing Title
SITE SERVICING PLAN
 (SOUTH)

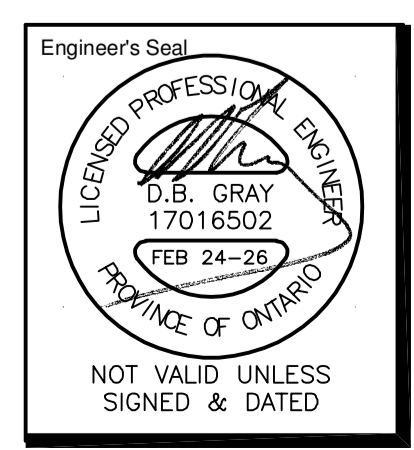

Drawn	D.B.G.
H. Scale	1:150
V. Scale	
Date	NOV 29-22
Job No.	22062

Drawing No.
C-4
 of 18

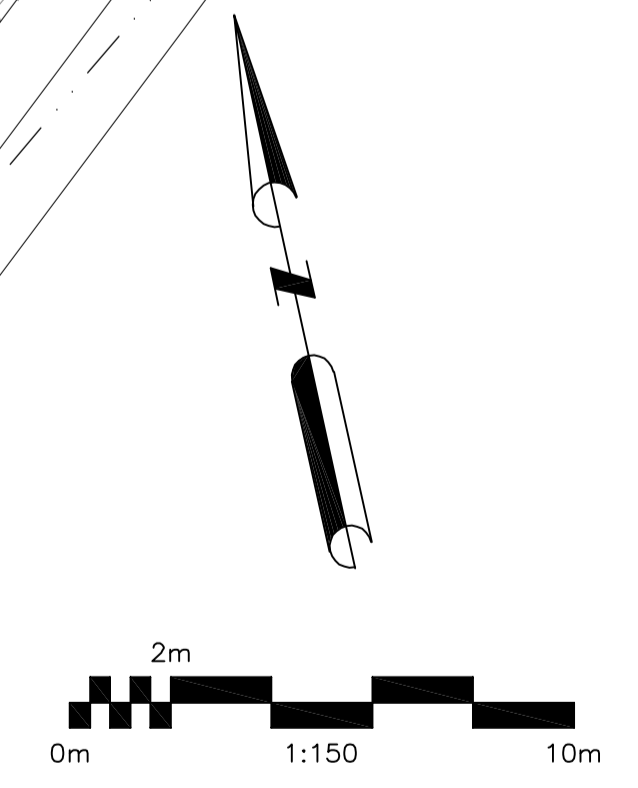

#18936