

**LEGEND**

- FFL FINISHED FLOOR ELEVATION
- TOF TOP OF FOUNDATION
- BFL BASEMENT FLOOR ELEVATION
- USF UNDERSIDE OF FOOTING
- PROPERTY LINE
- C.R.Z CRITICAL ROOT ZONE
- CB CATCH-BASIN
- MH STORM MANHOLE
- CB/MH CATCH-BASIN/MANHOLE
- MH SANITARY MANHOLE
- FH FIRE HYDRANT
- FDC FIRE DEPARTMENT CONNECTION
- VB VALVE & VALVE BOX
- WATER METER
- RMW REMOTE WATER METER
- SAN SANITARY SEWER
- ST STORM SEWER
- WS/WM WATER SERVICE/WATERMAIN
- OBV OBVERT OF PIPE
- SPL SPRINGLINE OF PIPE
- INV INVERT OF PIPE

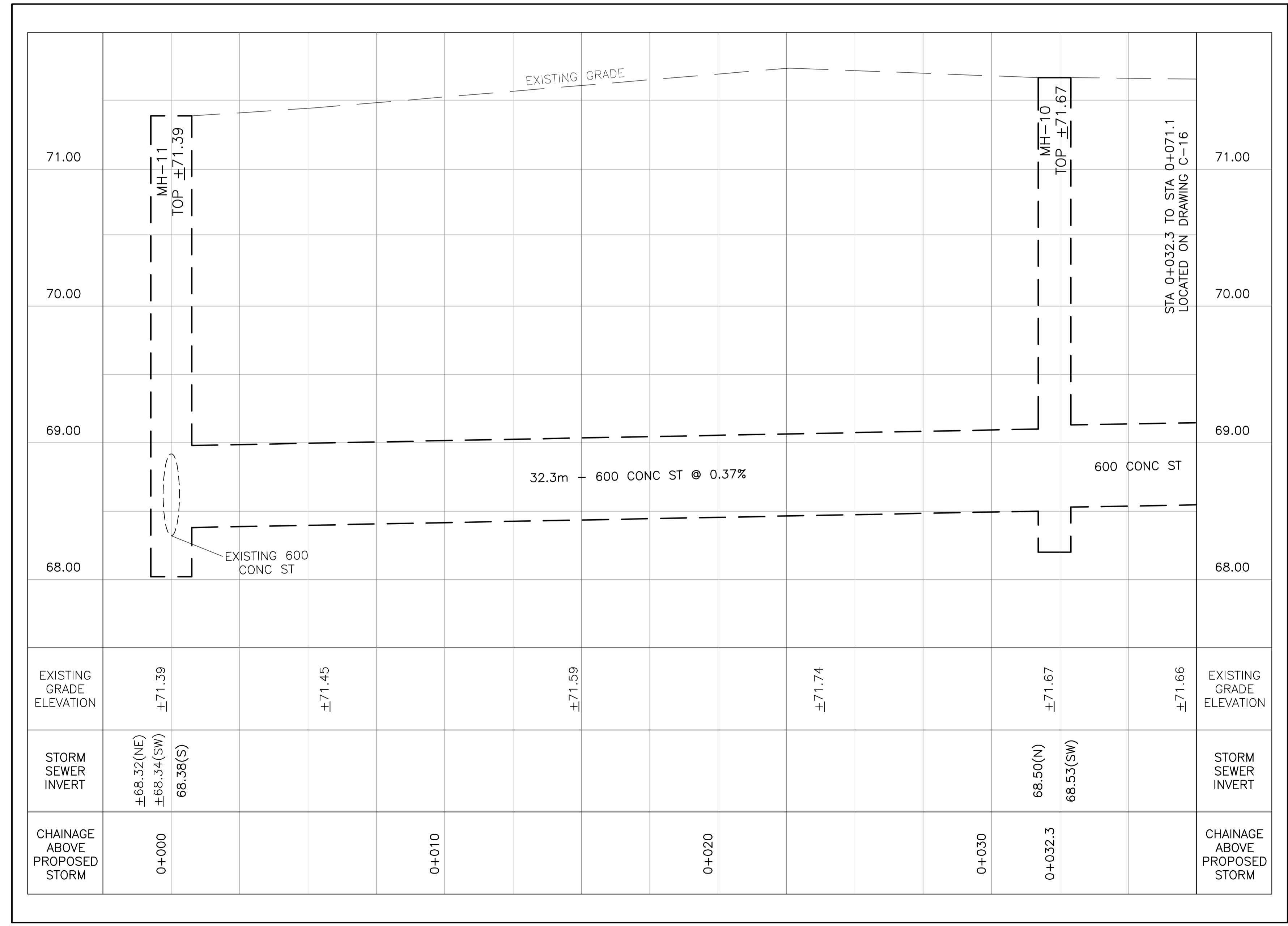
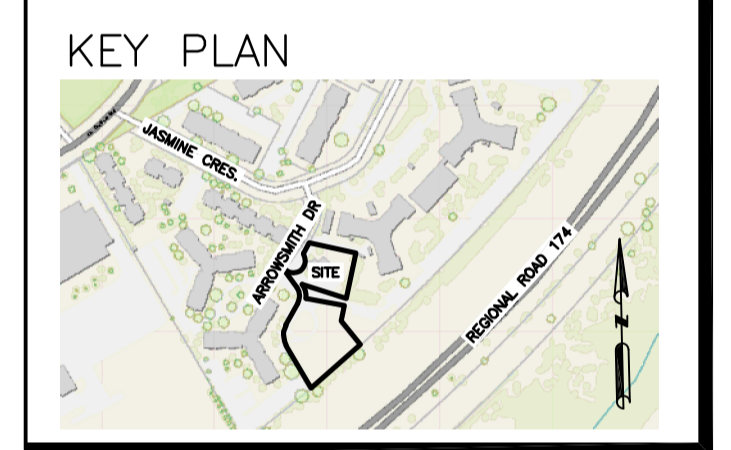

No.	DATE	REVISION
5	FEB 24-26	RE-ISSUED FOR APPROVAL
4	JAN 27-26	ISSUED FOR TENDER
3	DEC 10-25	RE-ISSUED FOR APPROVAL
2	JAN 17-25	ISSUED FOR ZONING
1	DEC 6-24	ISSUED FOR BUILDING PERMIT

**D. B. GRAY ENGINEERING INC.**  
 Stormwater Management - Grading & Drainage - Storm & Sanitary Sewers - Watermain  
 700 Long Point Circle 613-425-8044  
 Ottawa, Ontario d.gray@dbgrayengineering.com

Project  
**PROPOSED 6-STORY MIXED-USE BUILDING**  
**2040 ARROWSMITH DRIVE**  
 OTTAWA, ONTARIO

Drawing Title  
**PLAN AND PROFILE**  
 STA 0+000.0 TO 0+032.3

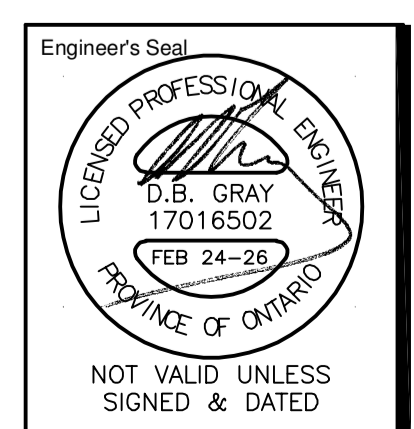

Drawn D.B.G.  
 H. Scale 1:100  
 V. Scale 1:20  
 Date NOV 29-22  
 Job No. 22062

Drawing No.  
**C-16**  
 of 18

REFER TO NOTES, DETAILS & SCHEDULES ON DRAWINGS C-10 & C-11

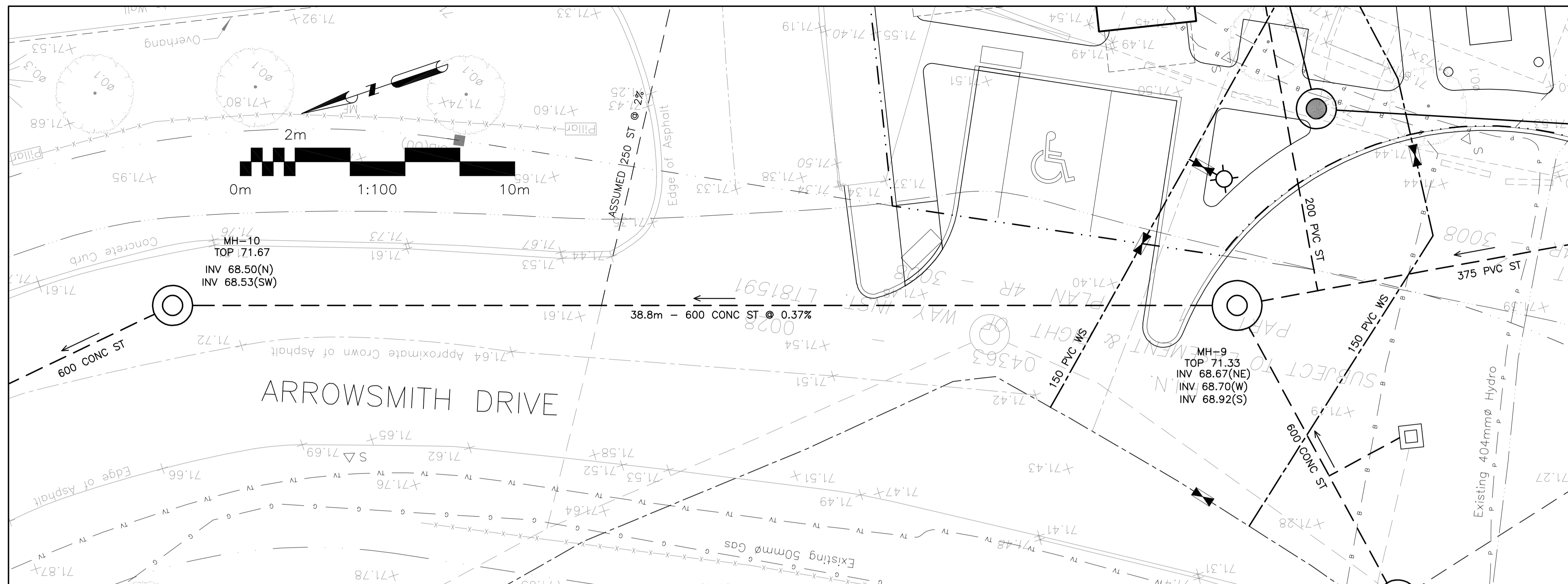

**LEGEND**

- FFL FINISHED FLOOR ELEVATION
- TOF TOP OF FOUNDATION
- BFL BASEMENT FLOOR ELEVATION
- USF UNDERSIDE OF FOOTING
- PROPERTY LINE
- C.R.Z. CRITICAL ROOT ZONE
- CB CATCH-BASIN
- MH STORM MANHOLE
- CB/MH CATCH-BASIN/MANHOLE
- MH SANITARY MANHOLE
- FH FIRE HYDRANT
- FDC FIRE DEPARTMENT CONNECTION
- VB VALVE & VALVE BOX
- ⊕ WATER METER
- ⊖ REMOTE WATER METER
- SAN SANITARY SEWER
- ST STORM SEWER
- WS/WM WATER SERVICE/WATERMAIN
- OBV OBVERT OF PIPE
- SPL SPRINGLINE OF PIPE
- INV INVERT OF PIPE

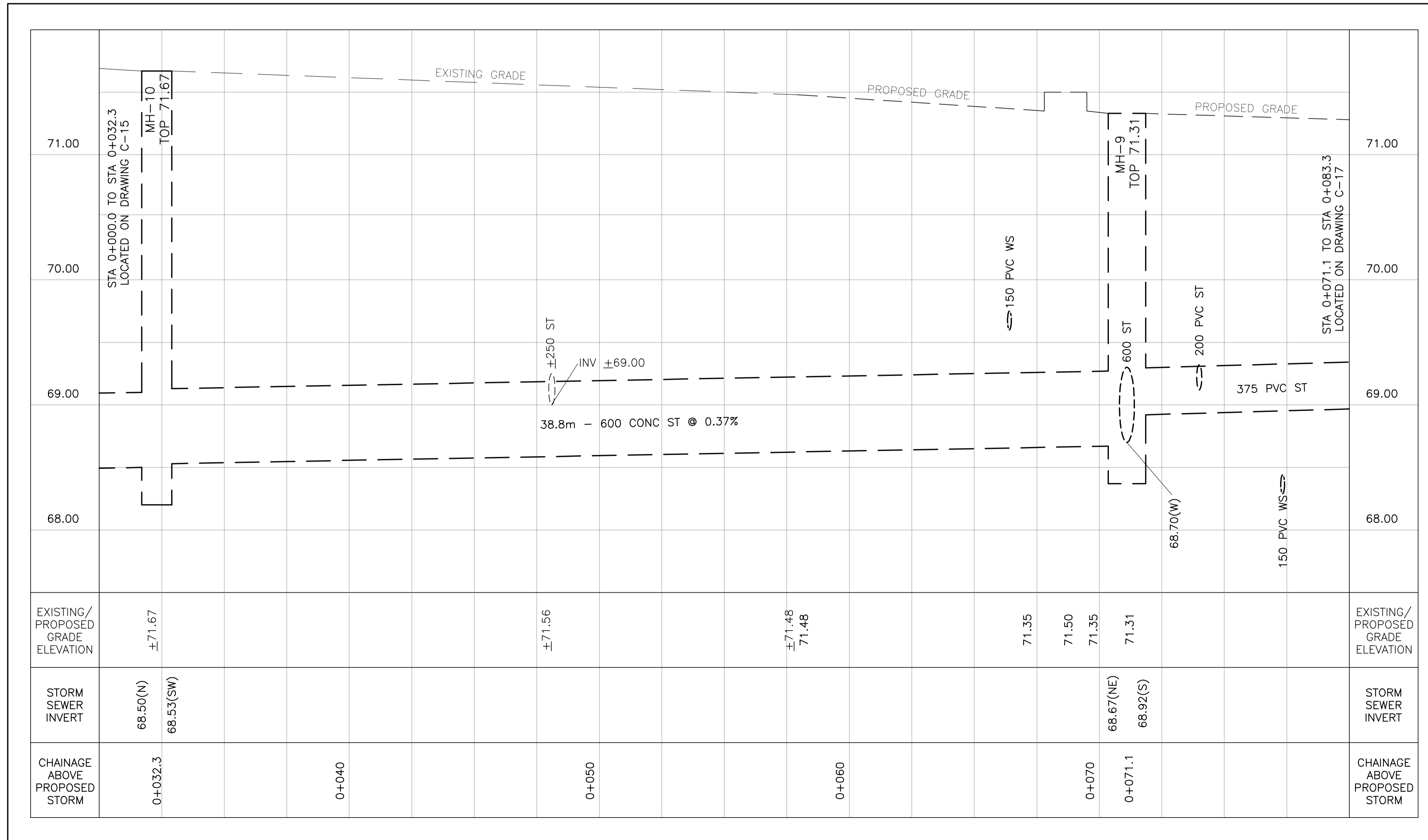
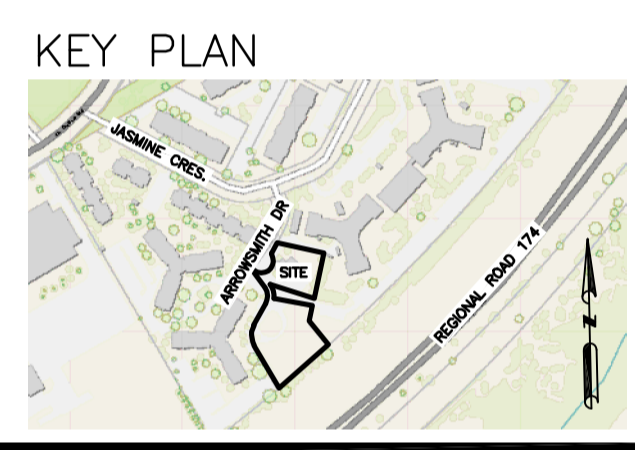

No.	DATE	REVISION
5	FEB 24-26	RE-ISSUED FOR APPROVAL
4	JAN 27-26	ISSUED FOR TENDER
3	DEC 10-25	RE-ISSUED FOR APPROVAL
2	JAN 17-25	ISSUED FOR ZONING
1	DEC 6-24	ISSUED FOR BUILDING PERMIT

**D. B. GRAY ENGINEERING INC.**  
 Stormwater Management - Grading & Drainage - Storm & Sanitary Sewers - Watermain  
 700 Long Point Circle 613-425-8044  
 Ottawa, Ontario d.gray@dbgrayengineering.com

Project  
**PROPOSED 6-STORY MIXED-USE BUILDING**  
**2040 ARROWSMITH DRIVE**  
 OTTAWA, ONTARIO

Drawing Title  
**PLAN AND PROFILE**  
 STA 0+032.3 TO 0+071.1

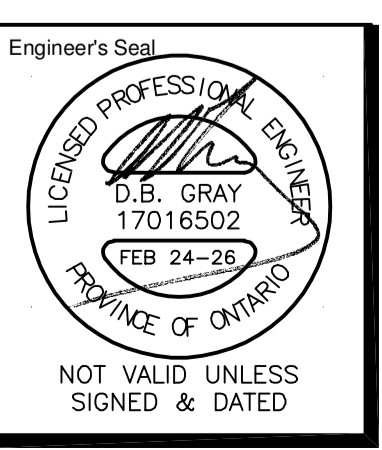

Drawn D.B.G.  
 H. Scale 1:100  
 V. Scale 1:20  
 Date NOV 29-22  
 Job No. 22062

Drawing No.  
**C-17**  
 of 18

REFER TO NOTES, DETAILS & SCHEDULES ON DRAWINGS C-10 & C-11

