

**LEGEND**

	BOREHOLE		PROPOSED SAND FILL MATERIAL
	TEST PIT		PROPOSED ELEVATION
	PROPERTY LINE		EXISTING ELEVATION
	PROPOSED SECURITY FENCE (REFER TO LANDSCAPE)		PROPOSED SWALE ELEVATION
	PROPOSED CURB		PROPOSED TOP OF CURB ELEVATION
	PROPOSED DEPRESSED CURB		PROPOSED TOP OF WALL ELEVATION
	PROPOSED CURB DRAIN (REFER TO DETAIL)		PROPOSED BOTTOM OF WALL ELEVATION
	TACTILE WALKING SURFACE INDICATOR (UNLESS OTHERWISE INDICATED)		PROPOSED BUILDING ENTRANCE
	SWALE AND DIRECTION OF FLOW		DIRECTION OF MAJOR OVERLAND FLOW
	TERRACING 2:1 SLOPE MAX (UNLESS OTHERWISE INDICATED)		PROPOSED RIP RAP $\phi$ 150 WOVEN GEOTEXTILE
	BOTTOM OF SLOPE AND DIRECTION		PROPOSED STORM SEWER AND MANHOLE
	PROPOSED SITE LIGHTING (REFER TO ARCHITECTURAL DRAWINGS)		PROPOSED CATCHBASIN MANHOLE
			PROPOSED INLET CONTROL DEVICE
			100-YEAR PONDING LIMITS

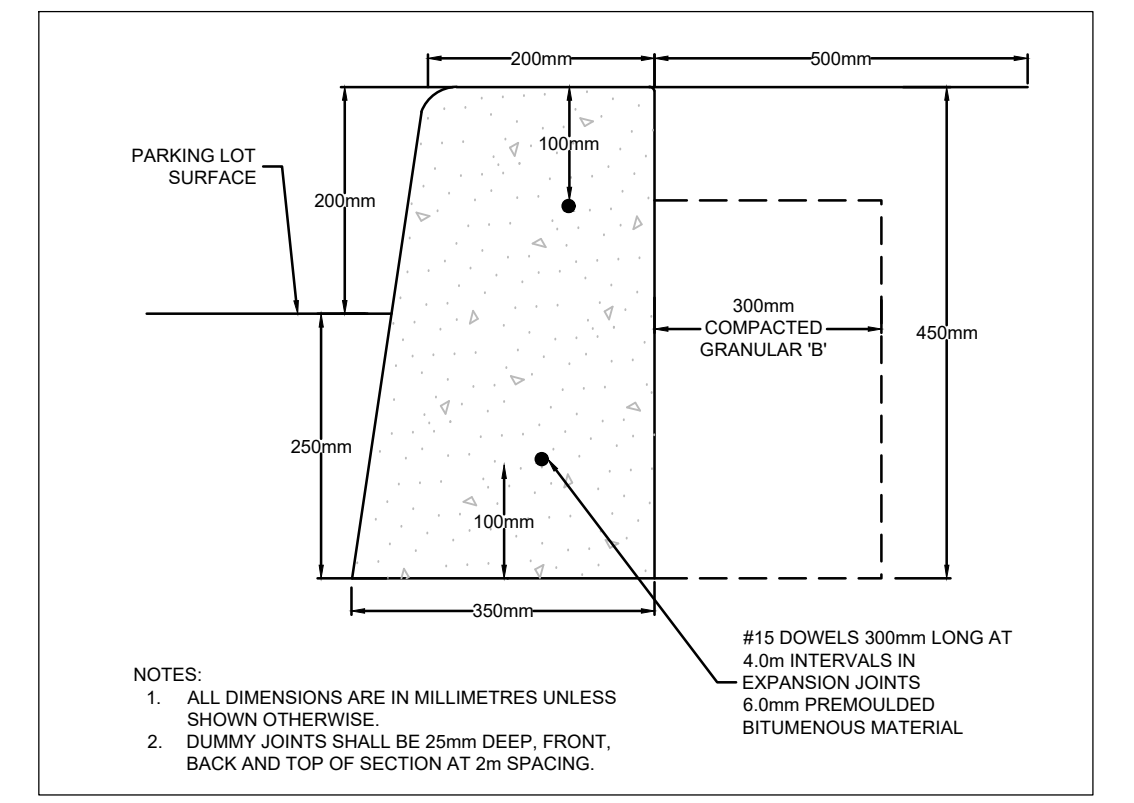
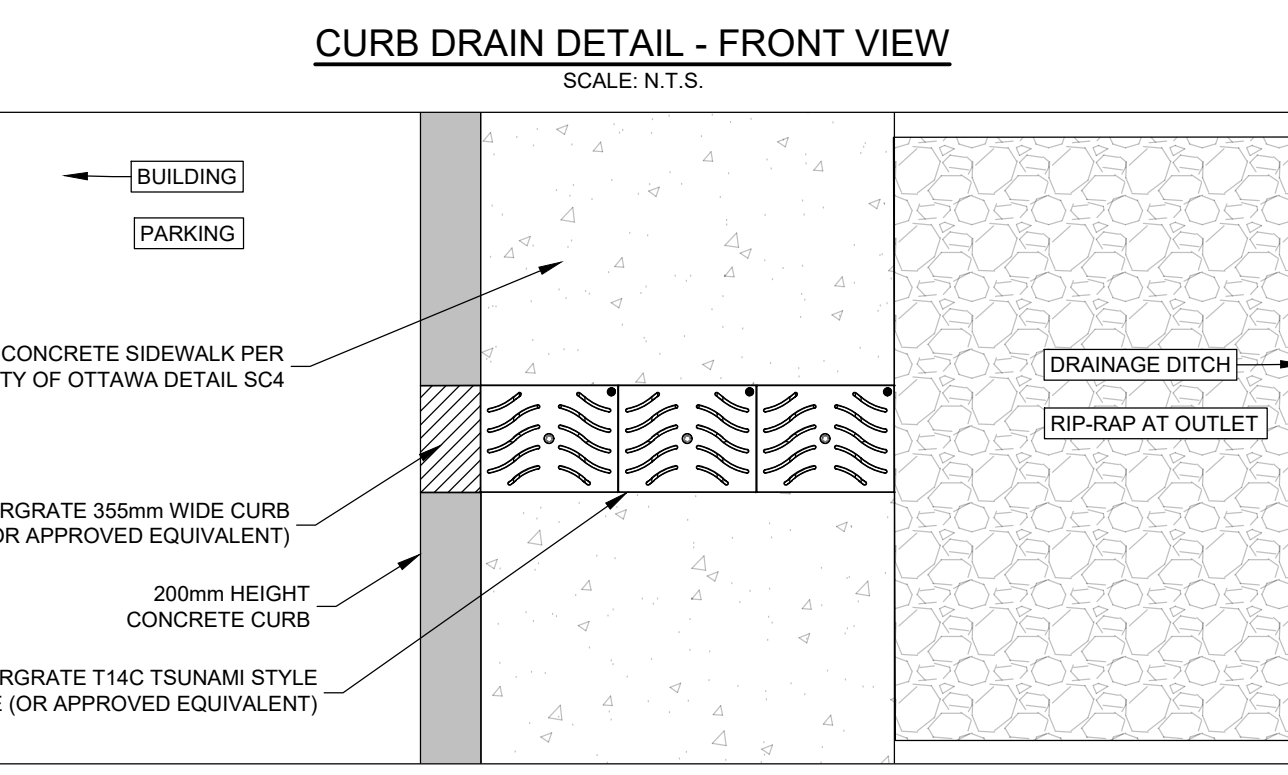
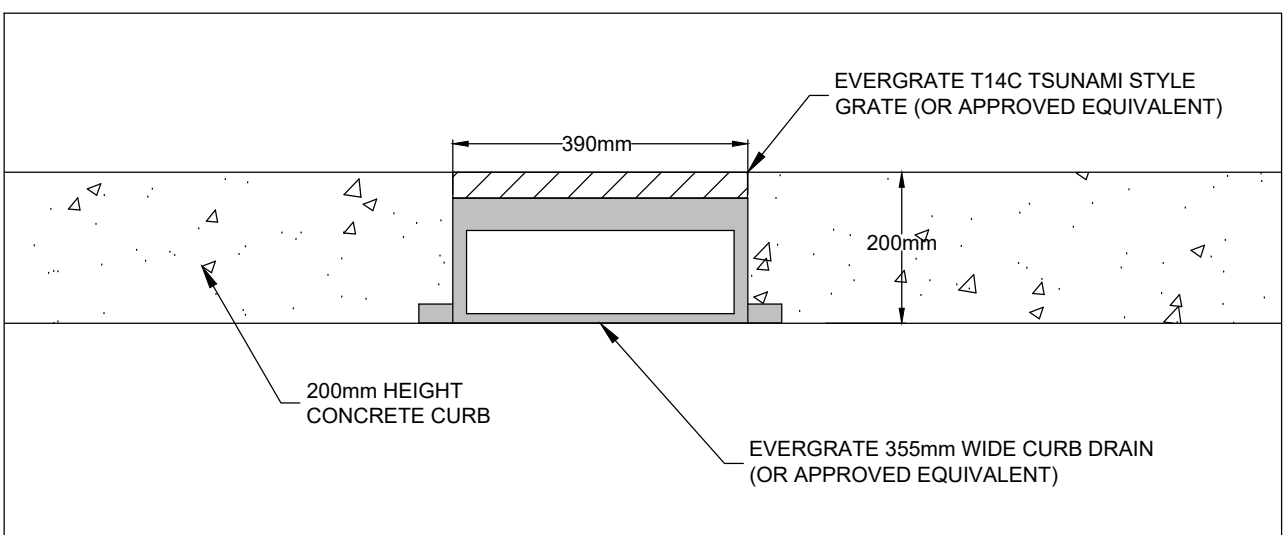
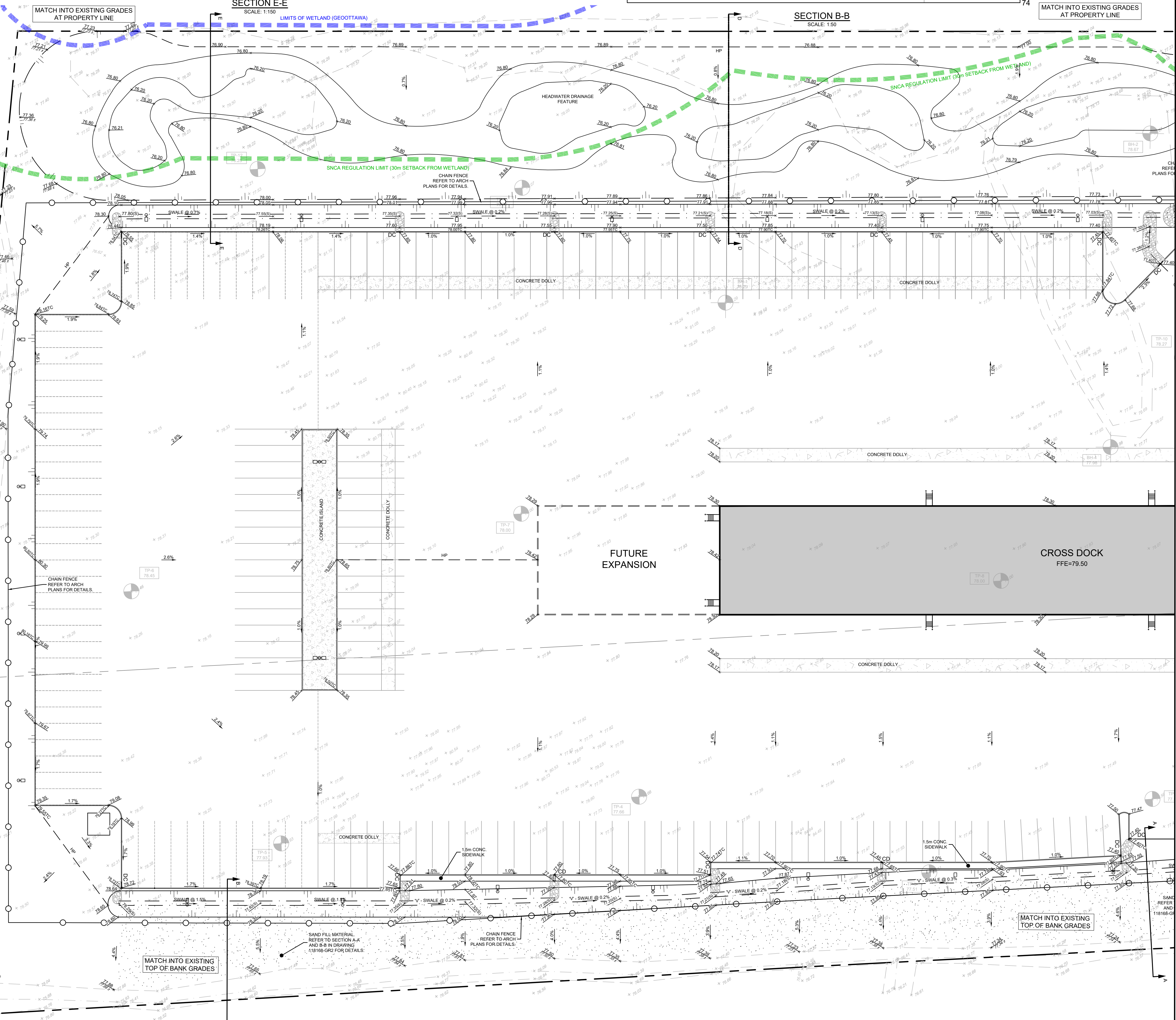

NOTES:  
 1. ALL DIMENSIONS ARE IN MILLIMETRES UNLESS SHOWN OTHERWISE.  
 2. DUMMY JOINTS SHALL BE 25mm DEEP, FRONT, BACK AND TOP OF SECTION AT 2m SPACING.

NOTE:  
 THE POSITION OF ALL POLE LINES, CONDUITS, WATERMANS, SEWERS AND OTHER UNDERGROUND AND OVERGROUND UTILITIES AND STRUCTURES IS NOT NECESSARILY SHOWN ON THE CONTRACT DRAWINGS, AND WHERE SHOWN, THE ACCURACY OF THE POSITION OF SUCH UTILITIES AND STRUCTURES IS NOT GUARANTEED. BEFORE STARTING WORK, DETERMINE THE EXACT LOCATION OF ALL SUCH UTILITIES AND STRUCTURES AND ASSUME ALL LIABILITY FOR DAMAGE TO THEM.

No.	REVISION	DATE	BY	No.	REVISION	DATE	BY
8.	REVISED PER BUILDING PERMIT COMMENTS	APR 22/2025	MJH	8.	REVISED PER BUILDING PERMIT COMMENTS	APR 22/2025	MJH
7.	RE-ISSUED FOR BUILDING PERMIT	FEB 26/2025	MJH	7.	RE-ISSUED FOR BUILDING PERMIT	FEB 26/2025	MJH
6.	ISSUED FOR BUILDING PERMIT	OCT 24/2024	MJH	6.	ISSUED FOR BUILDING PERMIT	OCT 24/2024	MJH
5.	ISSUED FOR 90% SUBMISSION	OCT 4/2024	MJH	5.	ISSUED FOR 90% SUBMISSION	OCT 4/2024	MJH
4.	ISSUED FOR SPA	OCT 3/2024	MJH	4.	ISSUED FOR SPA	OCT 3/2024	MJH
3.	ISSUED FOR 60% SUBMISSION	AUG 16/2024	MJH	3.	ISSUED FOR 60% SUBMISSION	AUG 16/2024	MJH
2.	ISSUED FOR 30% SUBMISSION	JUNE 27/2024	MJH	2.	ISSUED FOR 30% SUBMISSION	JUNE 27/2024	MJH
1.	COORDINATION	MAR 7/2024	MJH	1.	COORDINATION	MAR 7/2024	MJH
10.	REVISED PER CITY COMMENTS	FEB 20/2026	MJH				
9.	REVISED PER CITY AND SNCA COMMENTS	NOV 14/2025	MJH				

SCALE: 1:400

FOR REVIEW ONLY

PROVINCE OF ONTARIO

**NOVATECH**  
 Engineers, Planners & Landscape Architects  
 Suite 200, 240 Michael Cowpland Drive  
 Ottawa, Ontario, Canada K2M 1P6  
 Telephone: (613) 254-9643  
 Facsimile: (613) 254-5867  
 Website: www.novatech-eng.com

LOCATION:  
 CITY OF OTTAWA  
 5110 BOUNDARY ROAD

DRAWING NAME:  
 GRADING PLAN

PROJECT No.: 118168-GR1  
 REV: REV #10  
 DRAWING No.: 118168-GR2  
 PLAN # 19296