

GENERAL NOTES:

- ALL DIMENSIONS IN MILLIMETERS UNLESS SPECIFIED OTHERWISE. DO NOT SCALE DRAWING. ALL DRAWINGS TO BE READ IN CONJUNCTION WITH WRITTEN SPECIFICATIONS.
- THIS DRAWING MAY NOT BE USED FOR CONSTRUCTION UNTIL SIGNED BY THE LANDSCAPE ARCHITECT. IT IS THE RESPONSIBILITY OF THE CONTRACTOR TO:
  - CHECK AND VERIFY ALL DIMENSIONS ON SITE
  - REPORT ALL ERRORS AND/OR OMISSIONS TO THE CONTRACT ADMINISTRATOR
  - COMPLY WITH ALL PERTINENT CODES AND BY-LAWS
  - CHECK AND VERIFY LOCATIONS OF ALL UNDERGROUND SERVICES WITH ALL LOCAL UTILITIES PRIOR TO ANY DIGGING
- ANY AREAS BEYOND THE LIMIT OF THE SITE DISTURBED DURING CONSTRUCTION SHALL BE RESTORED TO ORIGINAL CONDITION OR BETTER TO THE SATISFACTION OF THE AUTHORITY HAVING JURISDICTION AT THE CONTRACTOR'S EXPENSE.
- ALL WORK SHALL BE COMPLETED IN ACCORDANCE WITH THE 'OCCUPATIONAL HEALTH AND SAFETY ACT AND REGULATIONS FOR CONSTRUCTION PROJECTS'. THE GENERAL CONTRACTOR SHALL BE DEEMED TO BE THE 'CONSTRUCTOR' AS DEFINED IN THE ACT.
- THERE WILL BE NO SUBSTITUTION OF MATERIALS UNLESS PRIOR WRITTEN APPROVAL IS RECEIVED FROM THE CONTRACT ADMINISTRATOR.
- THE CONTRACTOR IS RESPONSIBLE FOR OBTAINING ALL PERMITS REQUIRED AND TO BEAR THE COST OF THE SAME.
- BENCHMARKS: IT IS THE RESPONSIBILITY OF THE CONTRACTOR TO VERIFY THAT THE SITE BENCHMARK(S) HAS NOT BEEN ALTERED OR DISTURBED AND THAT ITS RELATIVE ELEVATION AND DESCRIPTION AGREES WITH THE INFORMATION DEPICTED ON THIS PLAN.

THE LANDSCAPE PLAN WAS PREPARED IN CONJUNCTION WITH THE GEOTECHNICAL REPORT PREPARED BY PINCHIN AND THE WIND STUDY PREPARED BY GRADIENT WIND:

- PINCHIN FILE#: 267991.001, DATED MARCH 2, 2020.
- GRADIENT WIND REPORT#: 24-031-PLW, DATED MARCH 20, 2024.

ALL EXISTING SITE INFORMATION AS PER SITE SURVEY PLAN DATED JAN 21, 2020 AND PREPARED BY ANNIS O'SULLIVAN, VOLLEBEKK LTD.

TREE PRESERVATION / REMOVAL NOTES:

- TREE INVENTORY AND SITE ASSESSMENT CONDUCTED BY CERTIFIED ARBORIST AT NAK DESIGN STRATEGIES ON APRIL 9, 2024. NO IMPACT TO EXISTING TREE CANOPIES OR CRZ ON THE SOUTH SIDE OF THE PROPERTY BOUNDARY IS EXPECTED AS PART OF THIS PROPOSED DEVELOPMENT.
- A QUALIFIED ARBORIST (ISA CERTIFIED) OR OTHER TREE PROFESSIONAL AS APPROVED BY THE CITY OF OTTAWA MUST PRUNE ROOTS OR BRANCHES THAT EXTEND BEYOND PRESCRIBED TREE PROTECTION ZONE AS REQUIRED. ALL PRUNING OF TREE ROOTS AND BRANCHES MUST BE IN ACCORDANCE WITH GOOD ARBORICULTURAL STANDARDS.
- TREES SHALL BE INSPECTED BY THE LANDSCAPE ARCHITECT OR CITY FORESTER REGULARLY FOR DAMAGE INCURRED DURING CONSTRUCTION TO ENSURE APPROPRIATE PRUNING OR OTHER MEASURES ARE IMPLEMENTED.
- THE AREAS WITHIN THE TREE PROTECTION ZONE MUST REMAIN UNDISTURBED AT ALL TIMES. NO WORK OR MATERIAL STORAGE IS PERMITTED WITHIN THE TREE PROTECTION ZONE.
- TREES THAT HAVE DIED OR HAVE BEEN DAMAGED BEYOND REPAIR WILL BE REMOVED AND REPLACED WITH TREES OF AN EQUIVALENT SIZE AND SPECIES AS APPROVED BY THE LANDSCAPE ARCHITECT OR CITY OF OTTAWA.
- TREE PROTECTION FENCE MUST NOT BE REMOVED WITHOUT THE WRITTEN AUTHORIZATION OF THE LANDSCAPE ARCHITECT.
- ALL DISTURBED AREAS TO BE RESTORED TO FINISHED CONDITION WITH 150mm TOPSOIL AND SOD OR SEED AS INDICATED.

Tree #	Botanical Name	Common Name	DBH (cm)	Ownership	Condition	Notes	To Be Preserved
1	Acer saccharum	Sugar Maple	45	Private - Neighbour	GOOD	Symmetrical canopy, Die Back: ~5% @ canopy, Single stem, Co-dominant Leaders: 2@ ~2m above grade	YES
2	Picea glauca	White Spruce	15	Private - Neighbour	MODERATE	Asymmetrical canopy, Die Back ~15% @ limbs, Broken Limbs, Single Stem.	YES
3	Picea glauca	White Spruce	25	Private - Neighbour	MODERATE	Asymmetrical canopy, Die Back ~5% @ limbs, Broken Limbs, Single Stem, Pruned: Limbed-Up	YES
4	Ulmus spp.	Elm	25	Private - Neighbour	GOOD	Symmetrical canopy, Single Stem, Included Bark	YES
5	Ulmus spp.	Elm	2@10	Private - Neighbour	MODERATE	Asymmetrical canopy, Single Stem, Co-dominant Leaders: 2@ ~0.5m above grade	YES
6	Acer saccharum	Sugar Maple	90	Private - Neighbour	MODERATE	Symmetrical canopy, Die Back: ~20% @ canopy, Broken Limbs, Single Stem, Included Bark	YES
7	Ulmus spp.	Elm	35	Private - Neighbour	GOOD	Asymmetrical canopy, Single Stem	YES
8	Acer ginnala	Amur Maple	100	Private - Neighbour	POOR	Asymmetrical canopy, Die Back: ~60% @ canopy, Broken Limbs, Multi-stem: 3, Bark Rot @ Trunk, Leaning	YES
9	Acer ginnala	Amur Maple	50	Private - Neighbour	MODERATE	Asymmetrical canopy, Die Back: ~30% @ canopy, Broken Limbs, Pruned Limbs, Single Stem, Co-dominant Leaders: 2@ ~1m above grade	YES
10	Acer ginnala	Amur Maple	50	Private - Neighbour	MODERATE	Asymmetrical canopy, Die Back: ~40% @ canopy, Broken Limbs, Single Stem, Co-dominant Leaders: 2@ ~1m above grade	YES
11	Acer saccharum	Sugar Maple	40	Private - Neighbour	MODERATE	Asymmetrical canopy, Die Back: ~5% @ canopy, Broken Limbs, Single Stem, Broken Leader	YES
12	Acer saccharum	Sugar Maple	30	Private - Neighbour	GOOD	Asymmetrical canopy, Die Back: ~5% @ canopy, Single Stem	YES
13	Acer saccharum	Sugar Maple	50	Private - Neighbour	GOOD	Asymmetrical canopy, Die Back: ~5% @ limbs, Broken Limbs, Single Stem	YES
14	Ulmus spp.	Elm	10	Private - Neighbour	GOOD	Symmetrical canopy, Single Stem	YES

Contractor shall check all dimensions on the work and report any discrepancy to the Landscape Architect before proceeding. All drawings and specifications are the property of the Landscape Architect and must be returned at the completion of the work. This drawing is not to be used for construction until signed by the Landscape Architect.

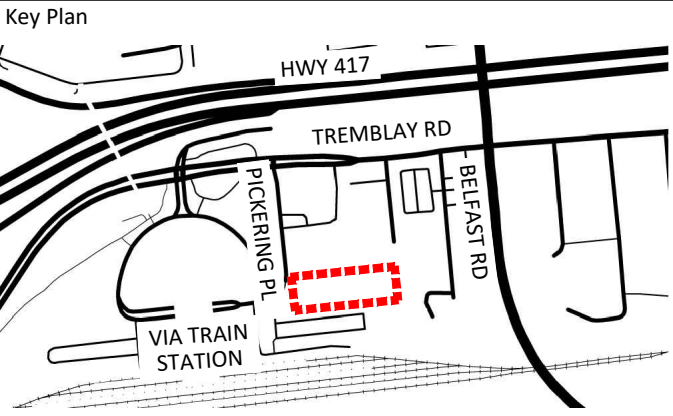

**LEGEND**

**PLANTING**

- LARGE DECIDUOUS TREE
- MEDIUM DECIDUOUS TREE
- SMALL DECIDUOUS TREE
- CONIFEROUS TREE
- TREE CANOPY PROJECTION
- CONIFEROUS SHRUB
- PLANTING BED
- SODDING

**PAVING**

- CIP CONCRETE PAVING
- PEDESTRIAN UNIT PAVING
- VEHICULAR UNIT PAVING
- RIVERSTONE PAVING
- PRECAST CURB

**DETAIL KEY**

- DETAIL NO.
- SHEET NO.

No.	Description	Date
5	Re-issued for Site Plan Approval	25-09-11
4	Re-issued for Site Plan Approval	25-07-22
3	Re-issued for Site Plan Approval	25-05-15
2	Issued for Site Plan Approval	25-05-02
1	Issued for Site Plan Phase 2	24-05-10

Revision  
City Approval Stamp

**APPROVED**  
By Geraldine Wildman at 10:25 pm, Dec 08, 2025

*G. Wildman*

**GERALDINE WILDMAN**  
MANAGER, DEVELOPMENT REVIEW SOUTH  
PLANNING, DEVELOPMENT AND BUILDING SERVICES  
DEPARTMENT, CITY OF OTTAWA

ASSOCIATION OF LANDSCAPE ARCHITECTS  
MEMBER  
ONARIO  
SICUTICS

N

**NAK**  
design strategies

1285 WELLINGTON STREET, OTTAWA, ON K1Y 3A8 CANADA  
T 413.237.2345  
NAKDESIGNSTRATEGIES.COM

**PICKERING PLACE**  
700 & 720 BANNERMOUNT AVE.  
OTTAWA, ON

Title

LANDSCAPE PLAN /  
TREE INVENTORY REPORT

Date 2024-04-01  
Scale 1:200  
Drawn SW  
Checked SC  
Job No. 24-043

Sheet  
**L01**



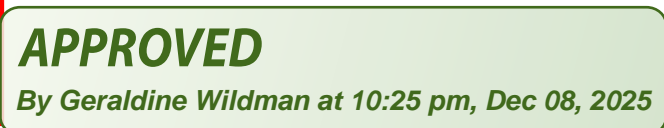



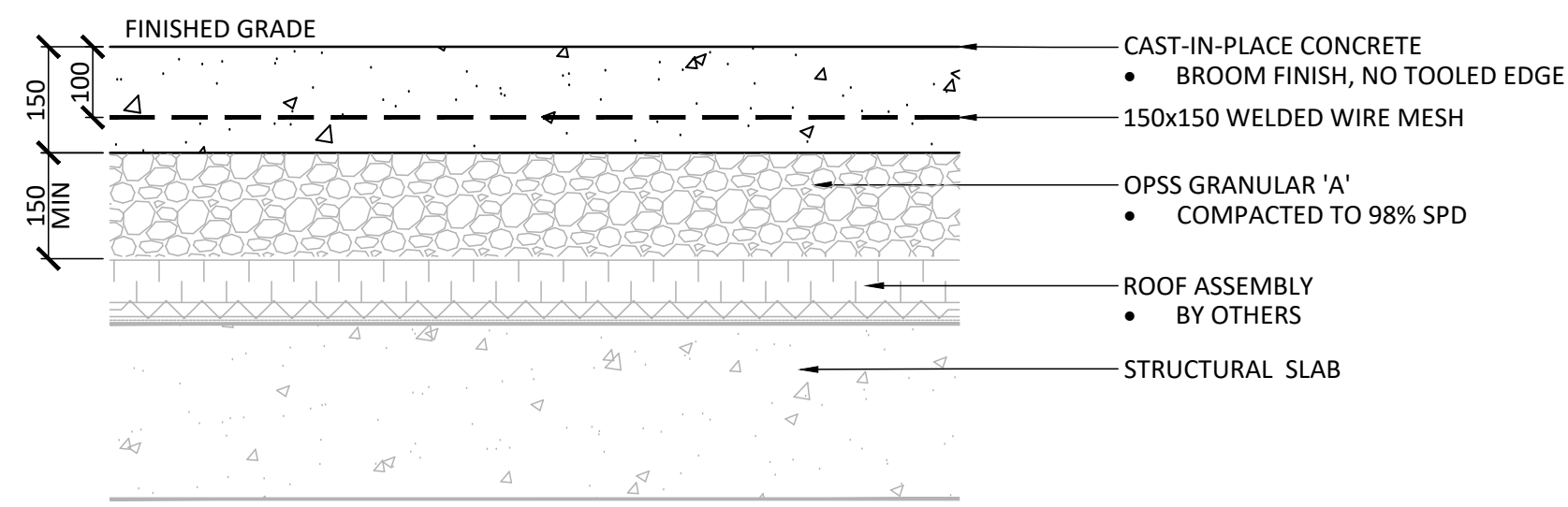

- NOTES:
1. REFER TO DRAWINGS FOR JOINT LAYOUT
  2. SAWCUT WITHIN 48 HOURS OF POUR
  3. BROOM FINISH, NO TOOLED EDGE

CONTROL JOINT (CJ)

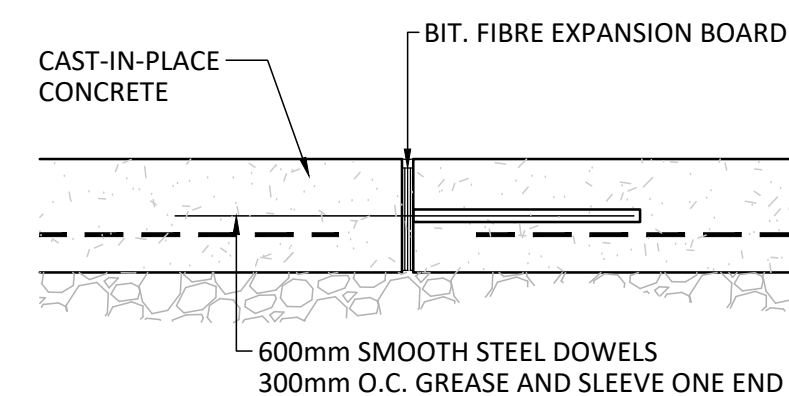

- NOTES:
1. REFER TO DRAWINGS FOR JOINT LAYOUT
  2. BROOM FINISH, NO TOOLED EDGE
  3. NO CAULKED JOINTS

EXPANSION JOINT (EJ)

## 1 PEDESTRIAN CONCRETE PAVING & JOINTING

1:10

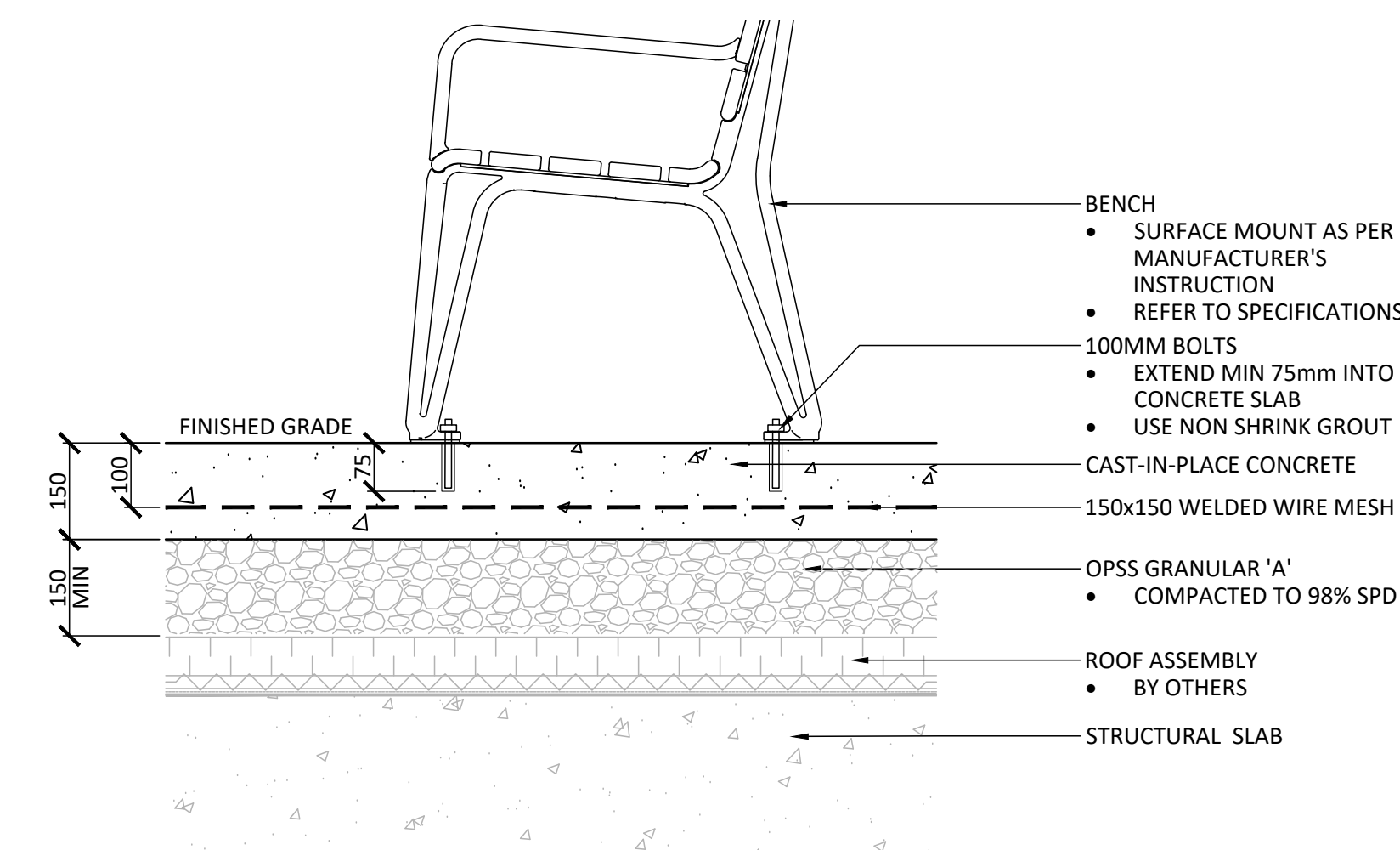

## 5 BENCH

1:10

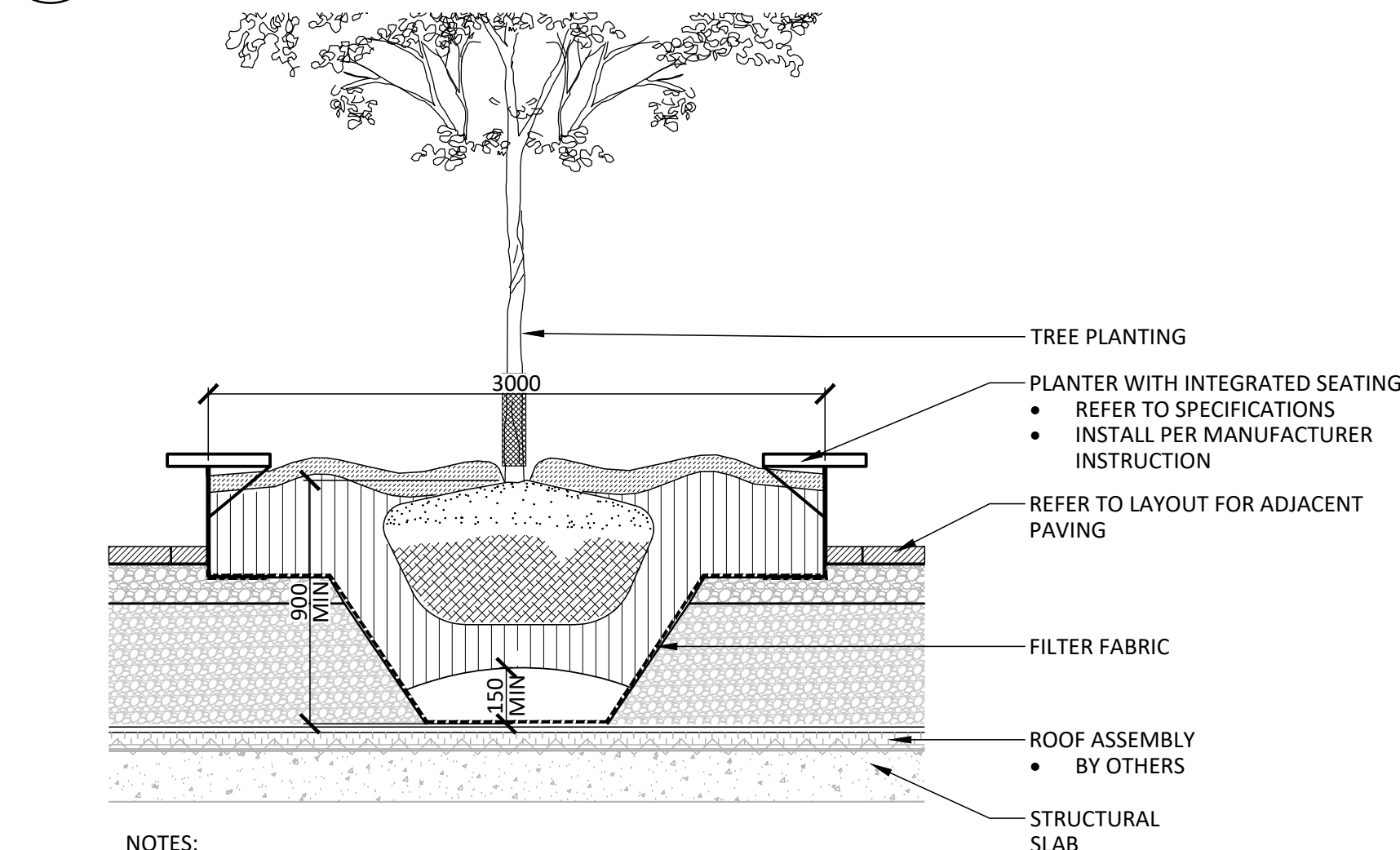

- NOTES:
1. CONTRACTOR TO PROVIDE ENGINEER STAMPED SHOP DRAWINGS FOR APPROVAL PRIOR TO INSTALLATION
  2. REFER TO SPECIFICATIONS

## 7 PLANTER WITH INTEGRATED SEATING

1:30

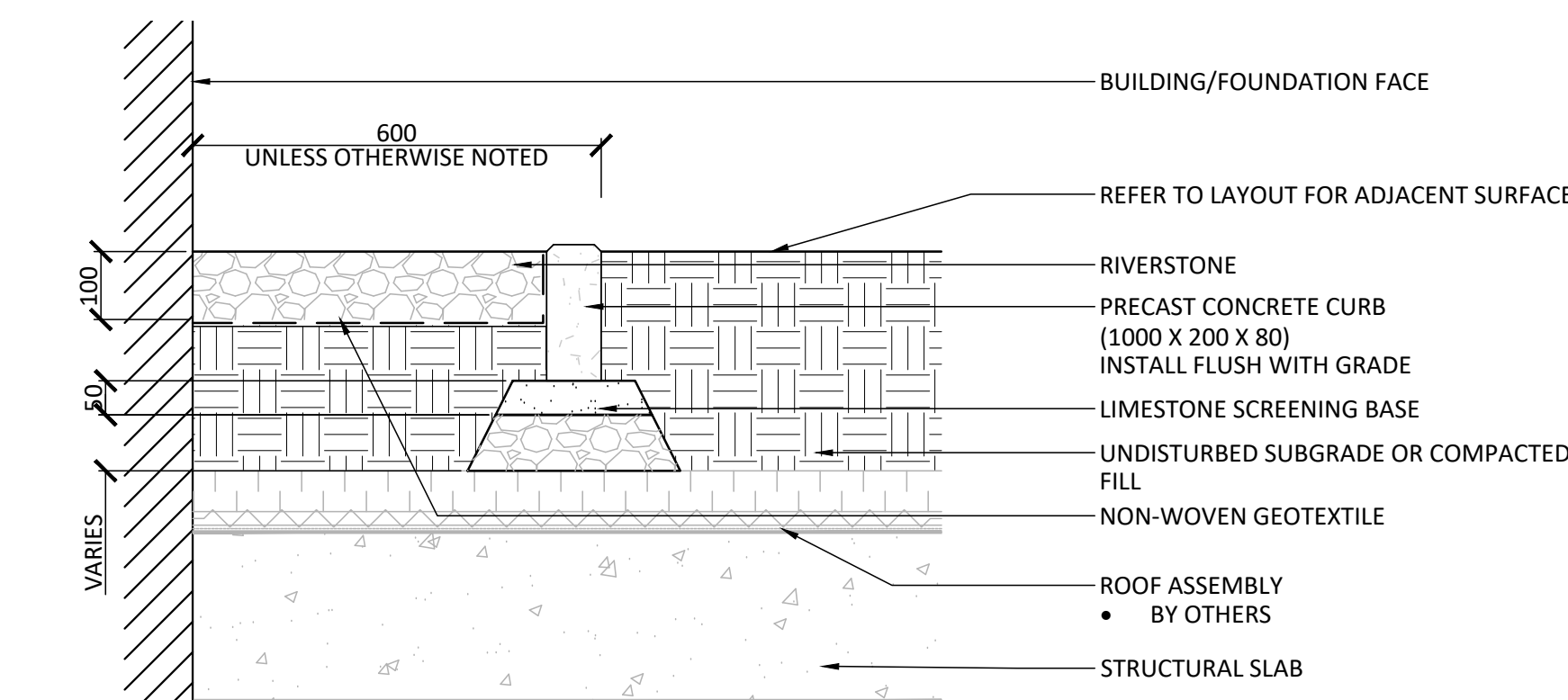

## 2 MAINTENANCE EDGE

1:10

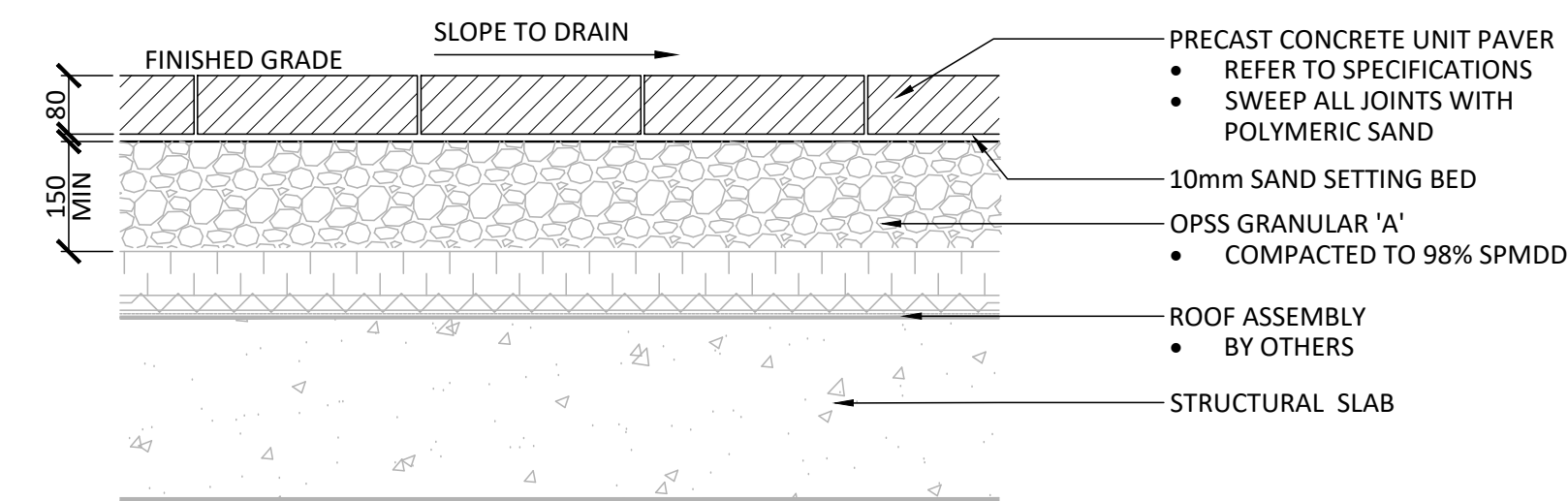

## 3 PEDESTRIAN UNIT PAVING

1:10

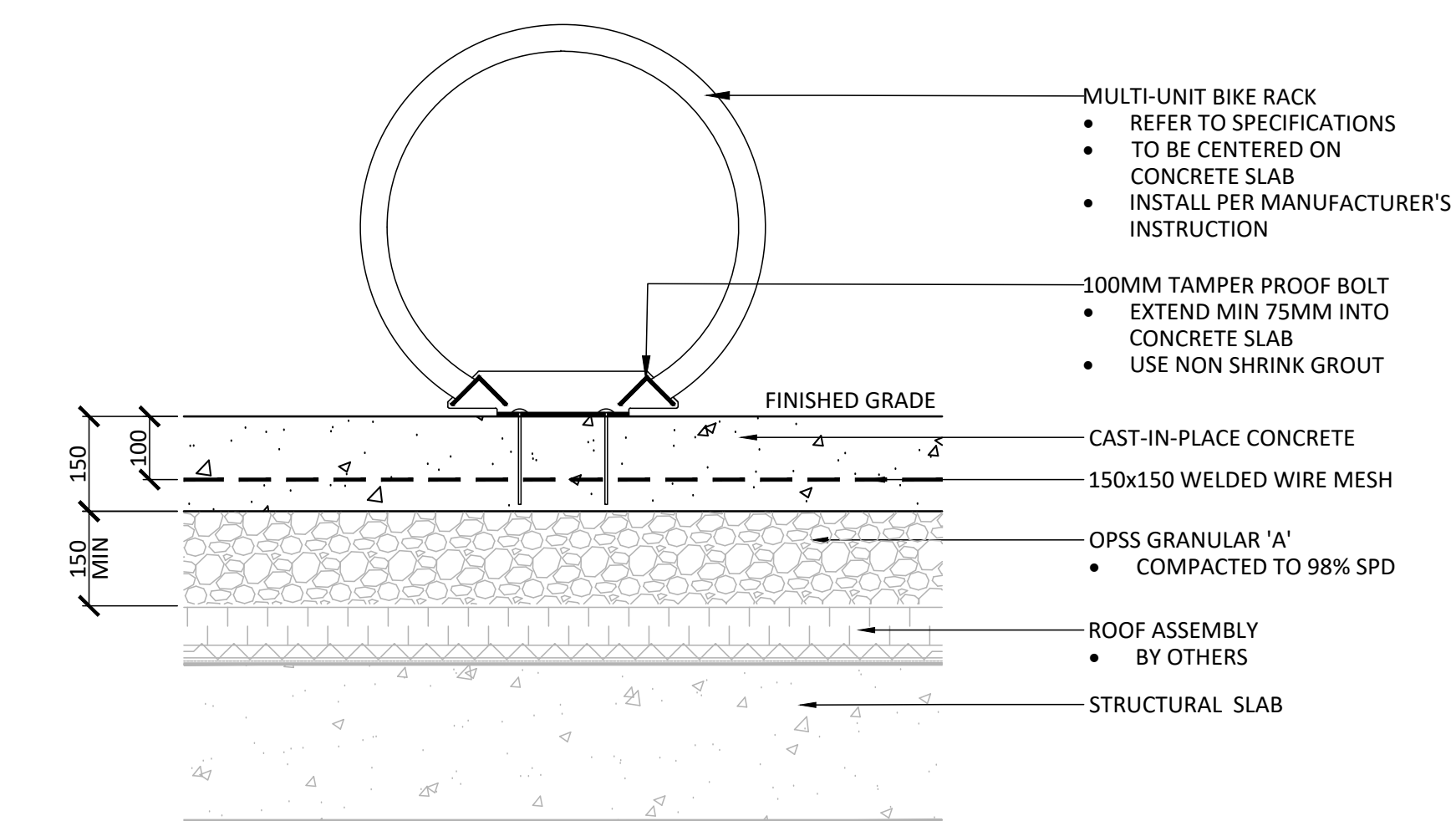

## 6 BIKE PARKING

1:10

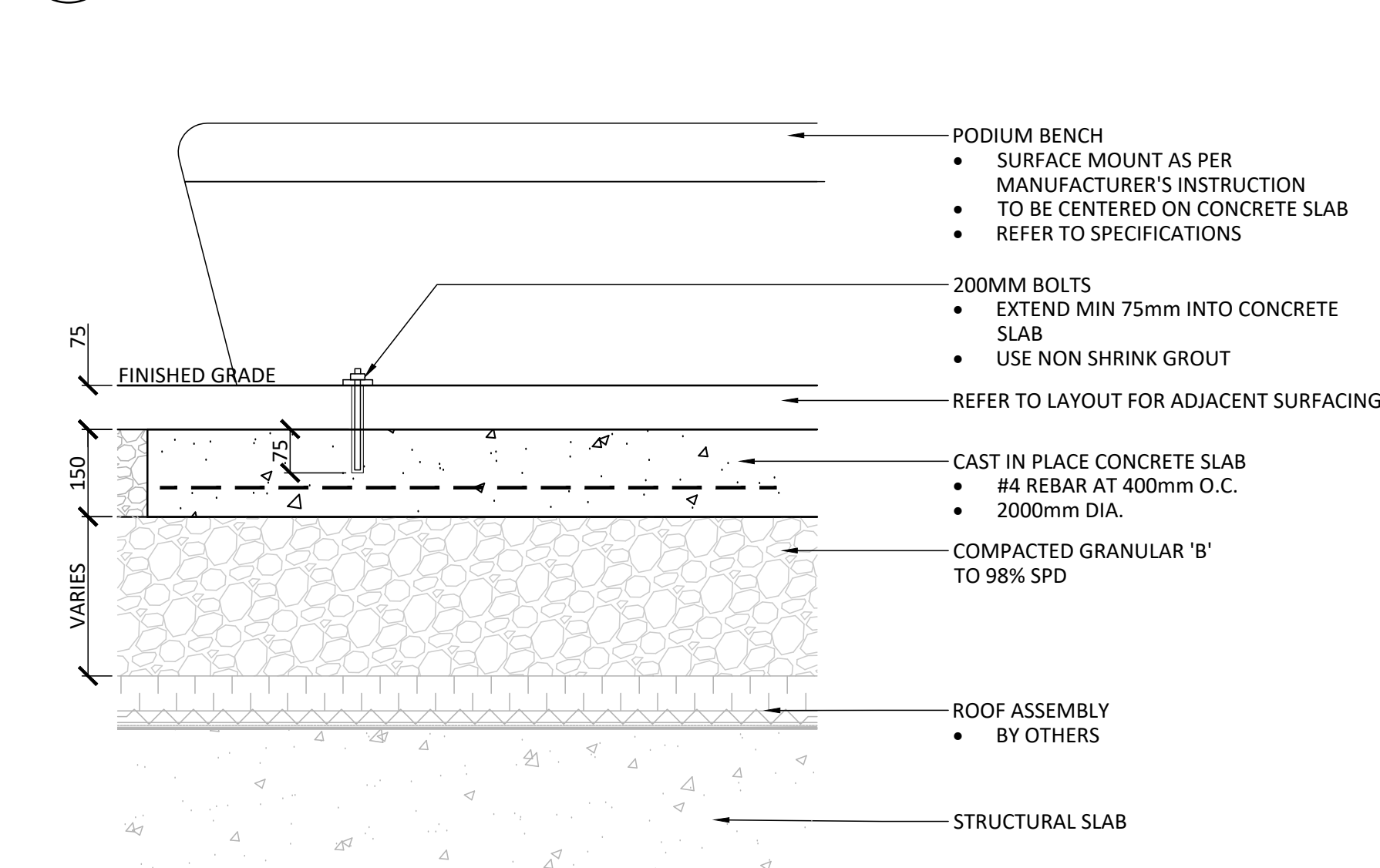

## 8 PODIUM BENCH

1:10

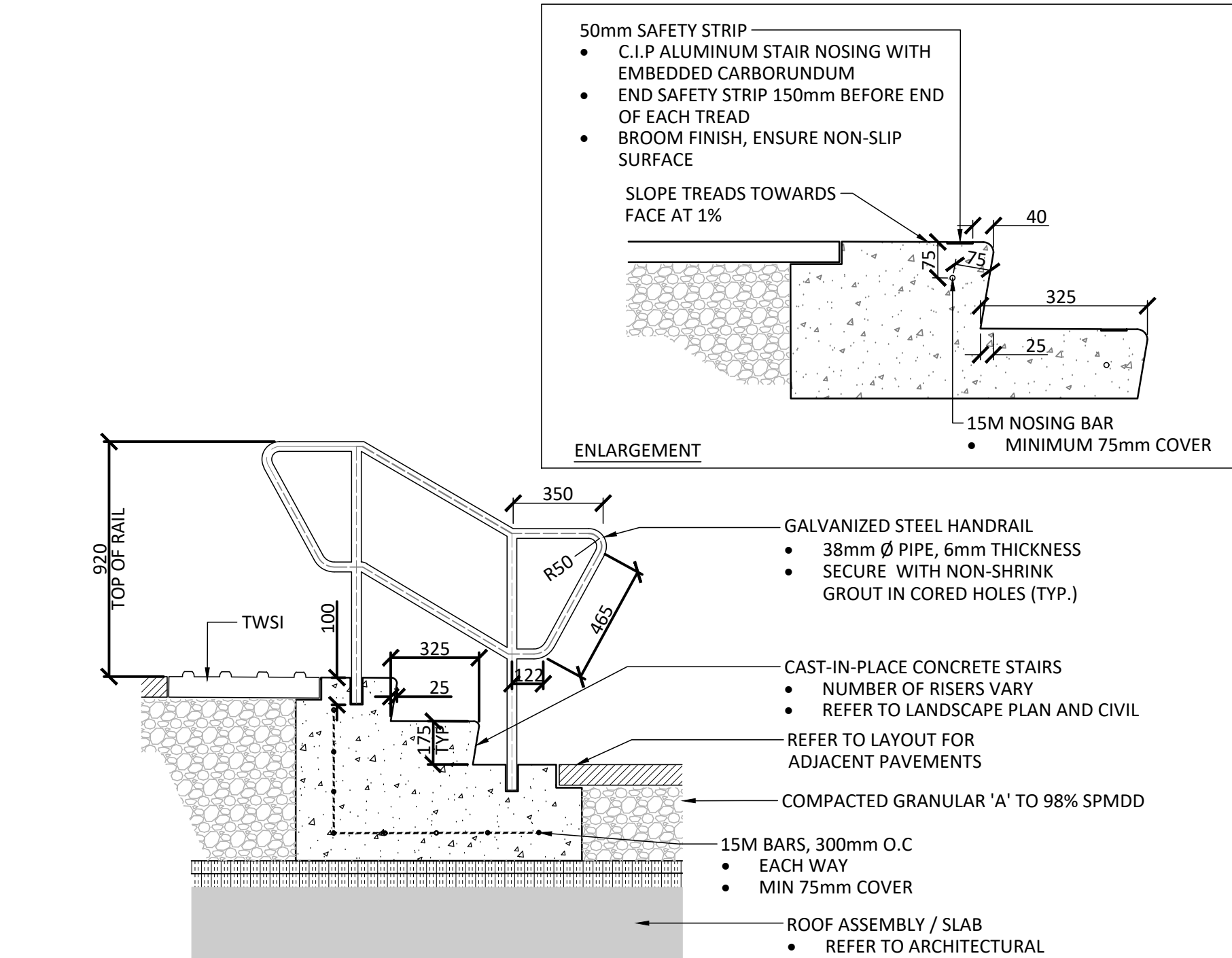

- NOTES:
1. CONTRACTOR TO PROVIDE ENGINEER STAMPED SHOP DRAWINGS FOR APPROVAL PRIOR TO INSTALLATION

## 4 CIP CONCRETE STAIRS & HANDRAIL

1:10

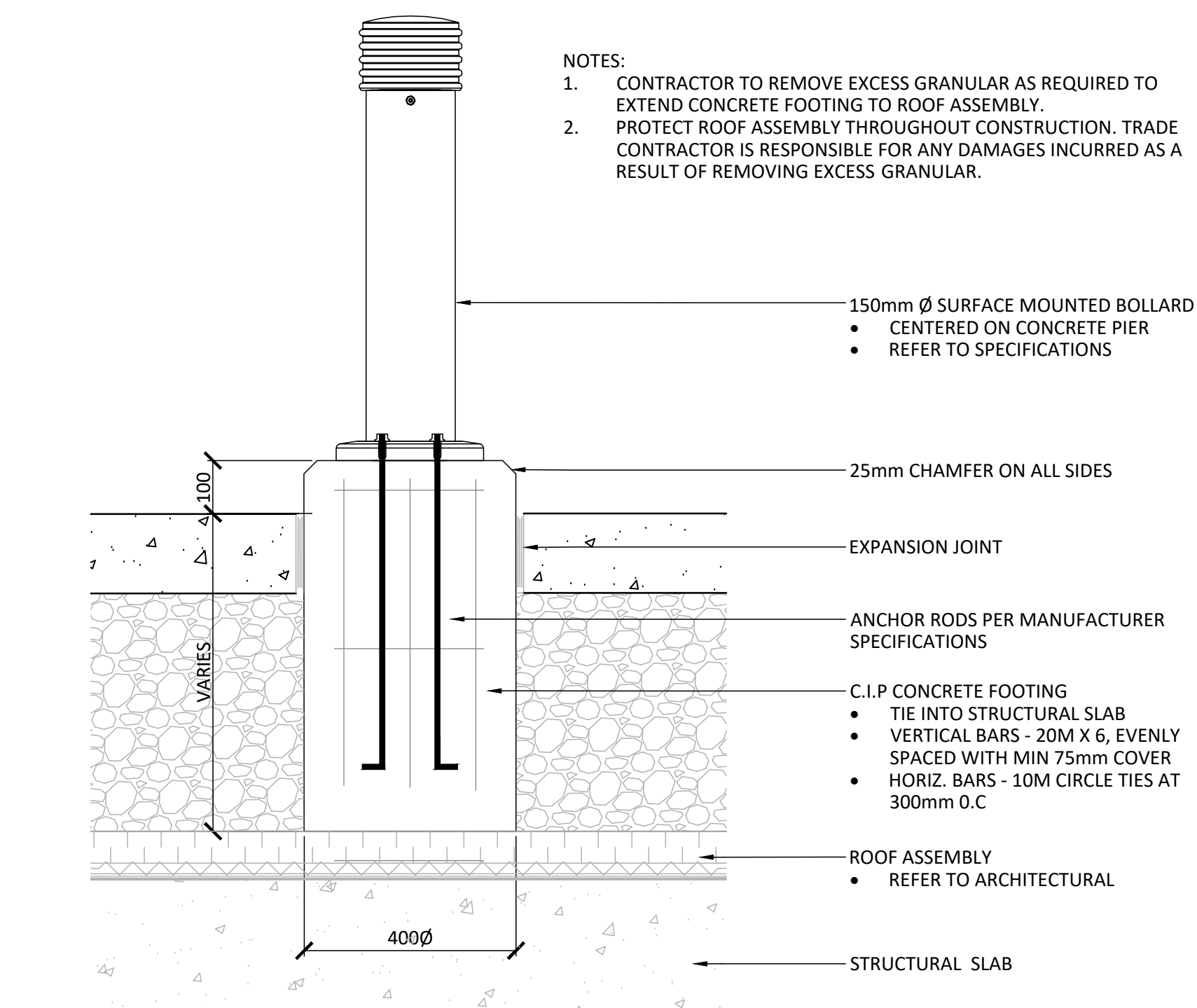

## 9 TRAFFIC BOLLARD

1:10

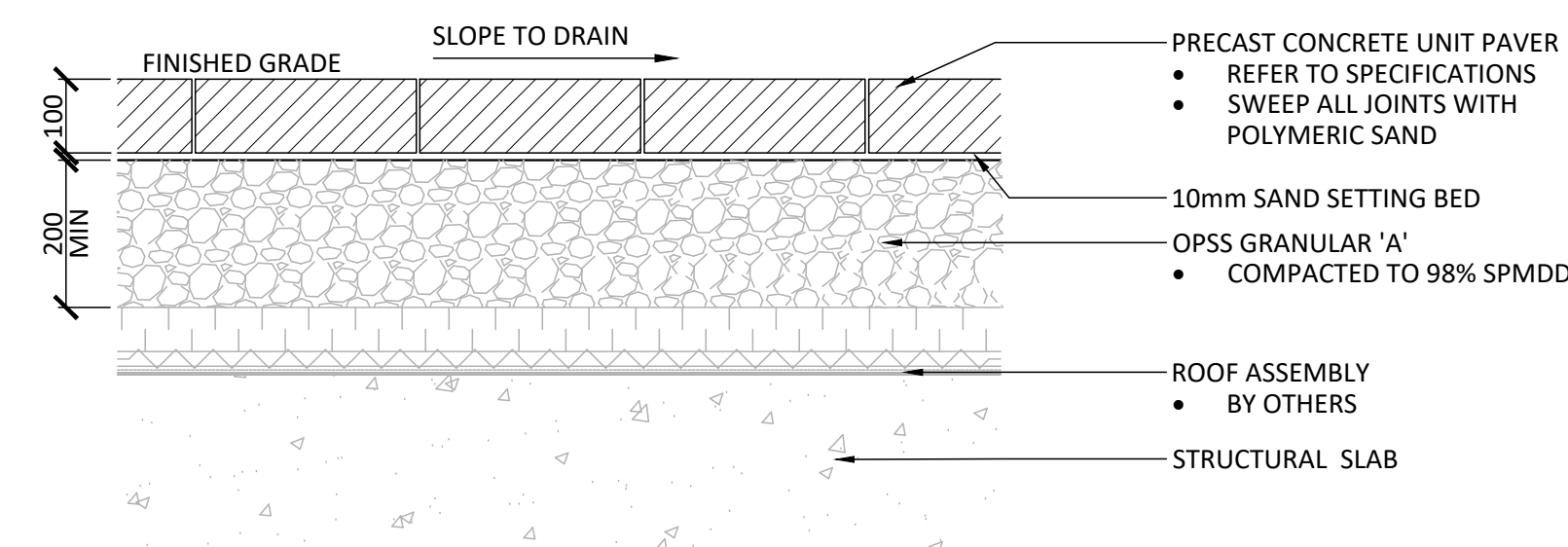

## 10 VEHICULAR UNIT PAVING

1:10

Contractor shall check all dimensions on the work and report any discrepancy to the Landscape Architect before proceeding. All drawings and specifications are the property of the Landscape Architect and must be returned at the completion of the work. This drawing is not to be used for construction until signed by the Landscape Architect.

*G. Wildman*

GERALDINE WILDMAN  
MANAGER, DEVELOPMENT REVIEW SOUTH  
PLANNING, DEVELOPMENT AND BUILDING SERVICES  
DEPARTMENT, CITY OF OTTAWA

APPROVED

By Geraldine Wildman at 10:26 pm, Dec 08, 2025

-		
-		
-		
-		
-		
2	Re-issued for Site Plan Approval	25-09-11
1	Issued for Site Plan Approval	25-05-15
No.	Description	Date
Revision		
City Approval Stamp		



**NAK**  
design strategies

1285 WELLINGTON STREET, OTTAWA, ON K1Y 3A8 CANADA  
T 613.237.2345 NAKDESIGNSTRATEGIES.COM

Project

PICKERING PLACE  
700 & 720 BANNERMOUNT AVE.  
OTTAWA, ON

Title		DETAILS	
Date	2025-05-02	Sheet	L05
Scale	AS SHOWN	Drawn	SW
Checked	SC	Job No.	24-043

PLAN N° 18865

CITY FILE N° D07-12-24-0077



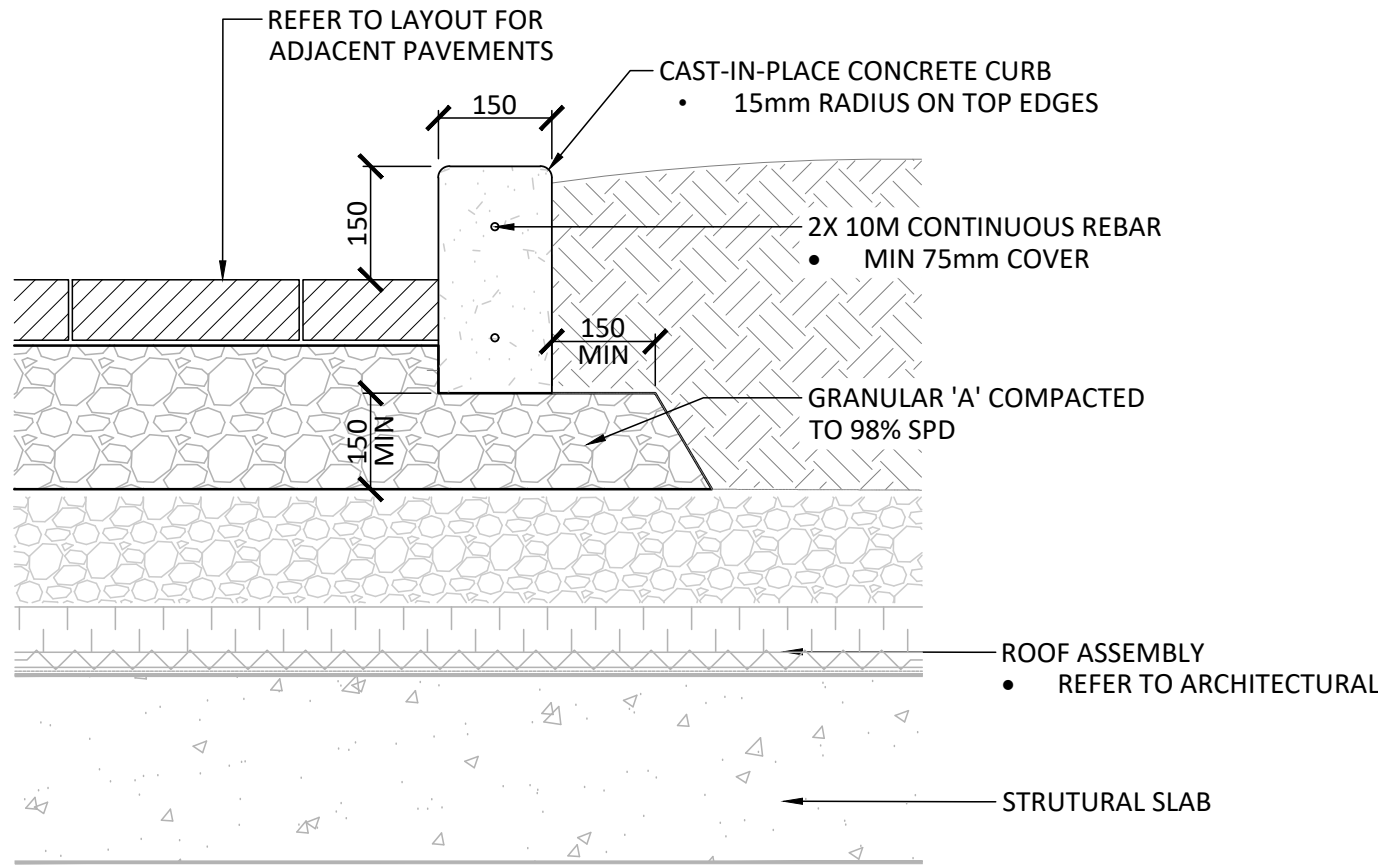

1 C.I.P. CONCRETE PLANTER CURB  
1:10

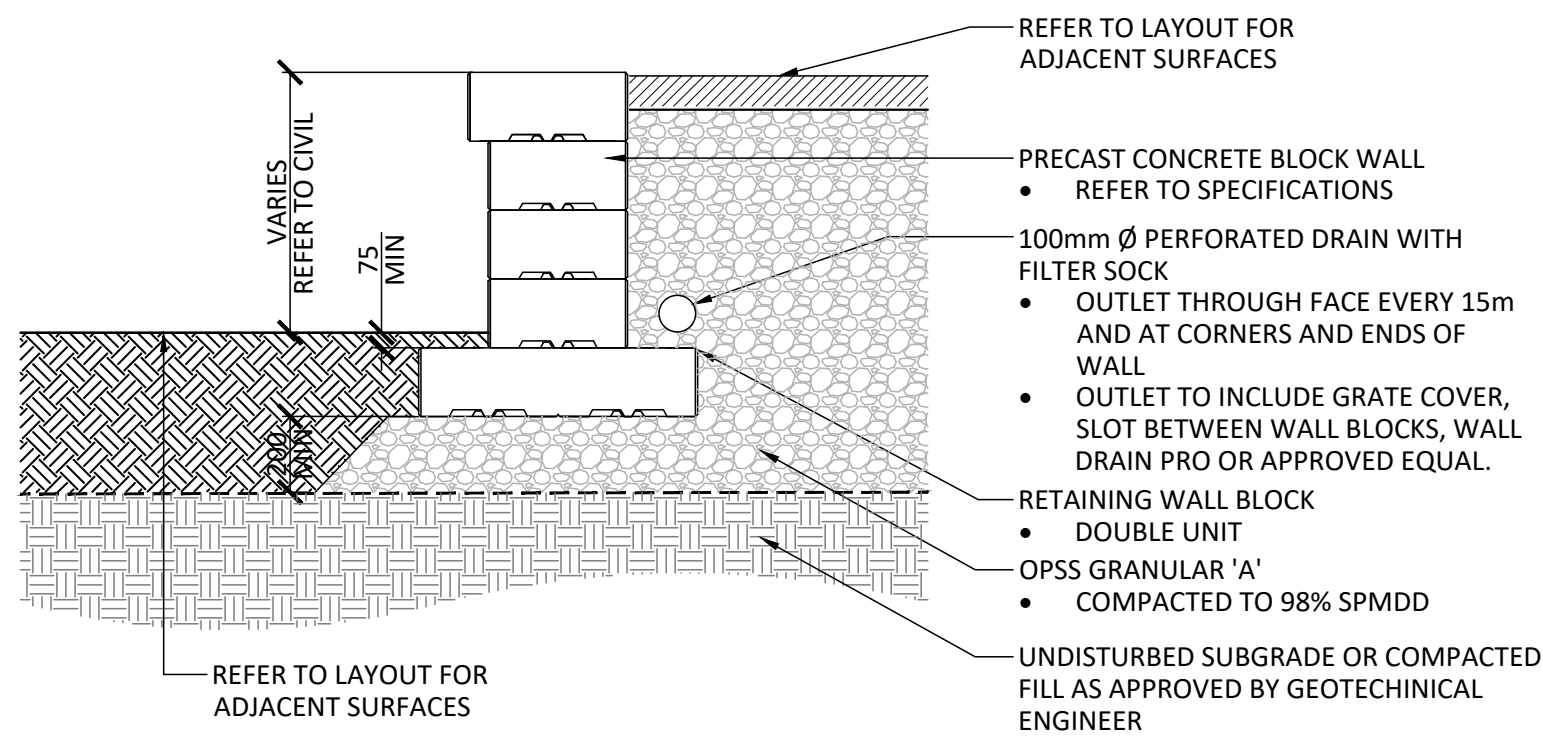

2 PRECAST CONCRETE RETAINING WALL  
1:10

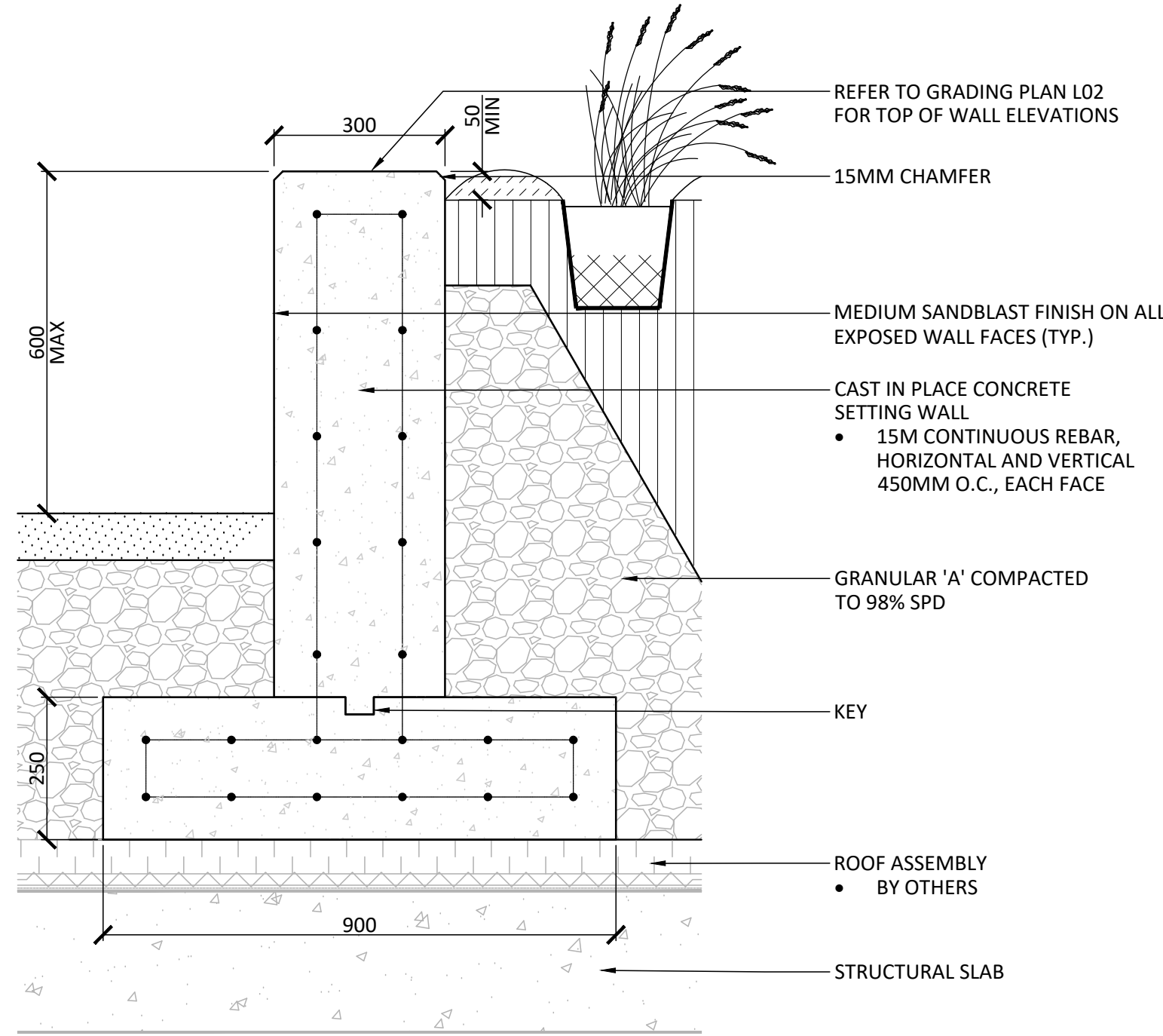

3 C.I.P. CONCRETE RETAINING WALL  
1:10

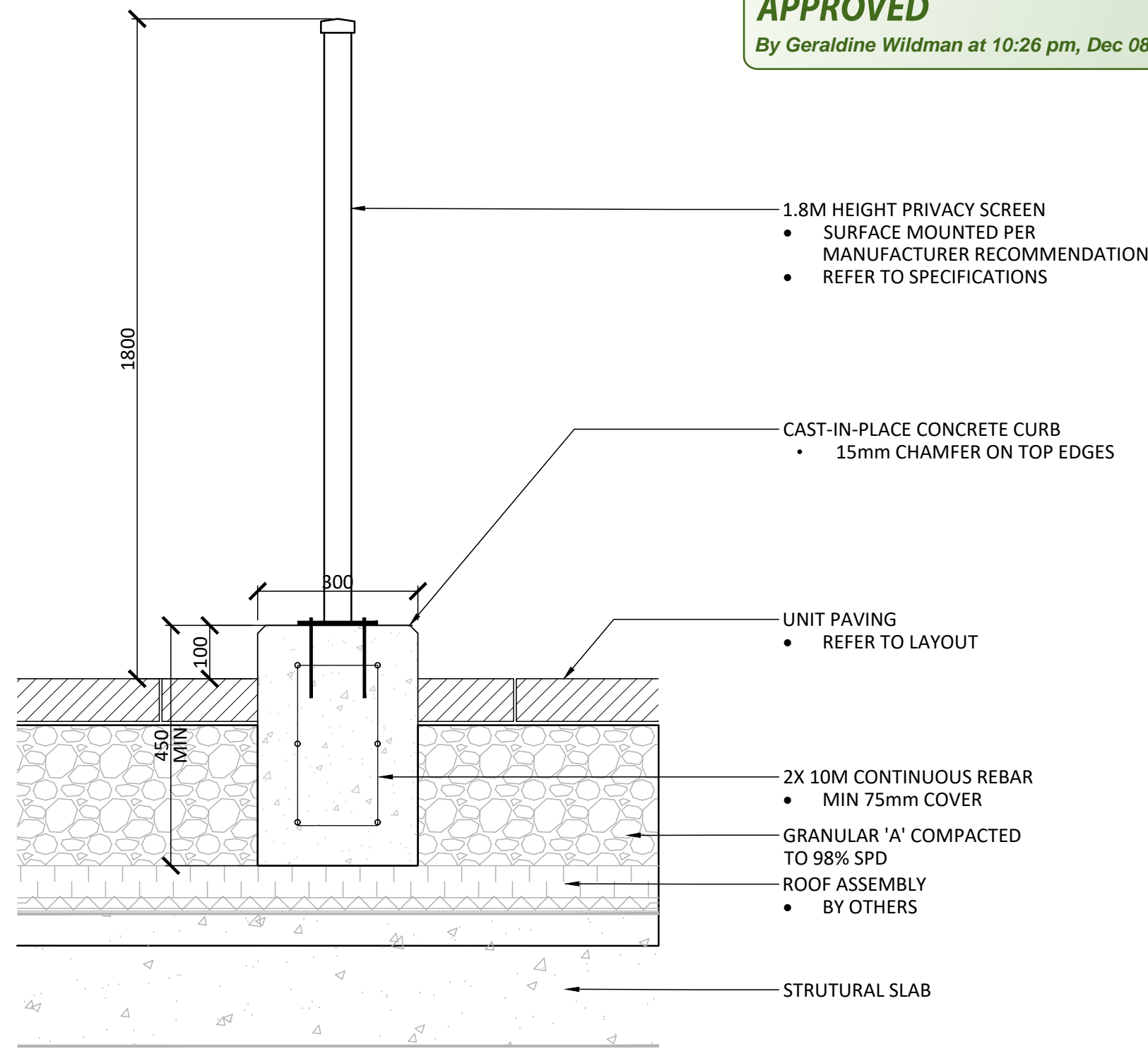

4 1.8M HEIGHT PRIVACY SCREEN  
1:10

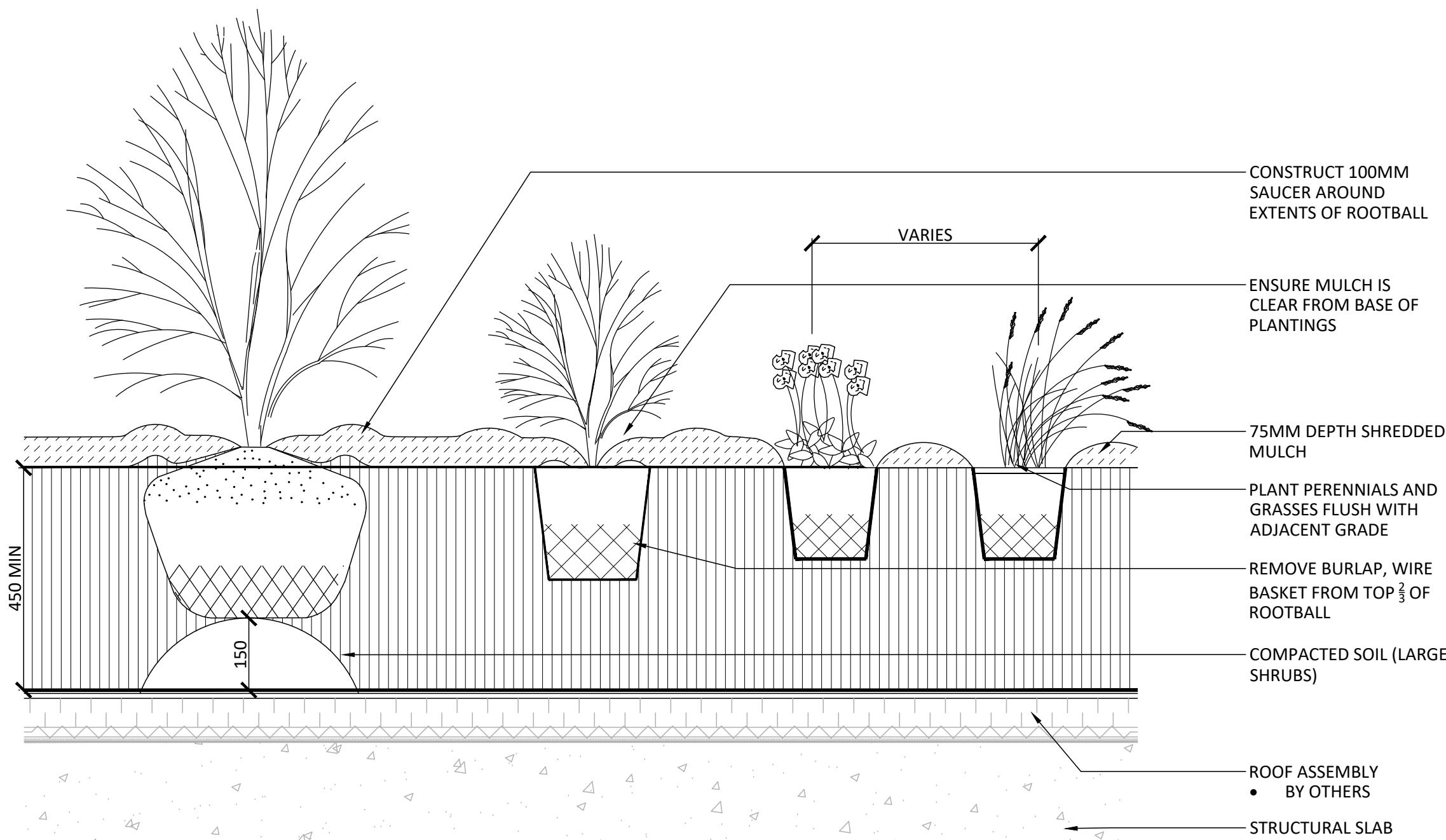

5 SHRUB AND PERENNIAL PLANTING - OVER SLAB  
1:10

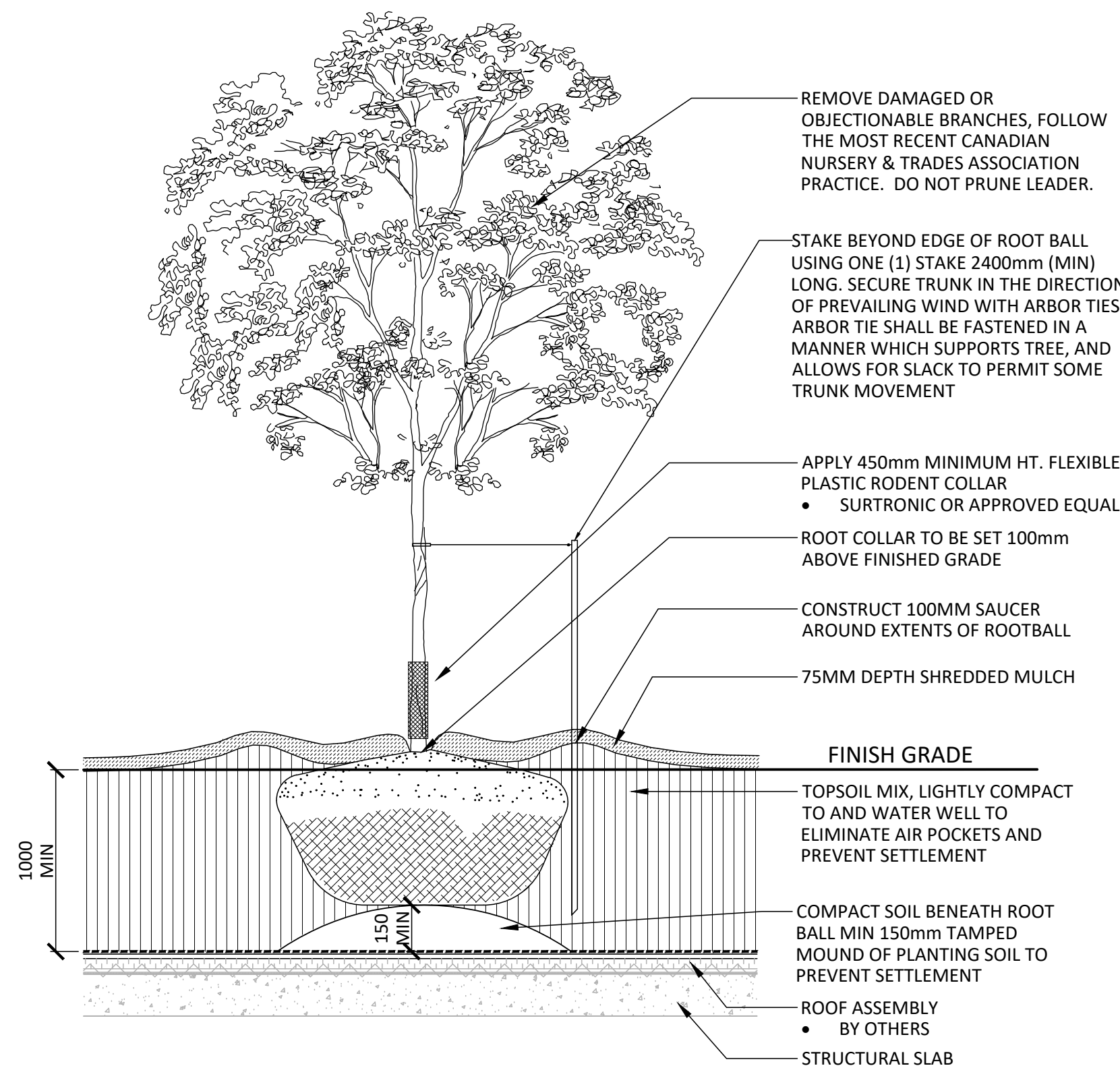

6 DECIDUOUS TREE PLANTING - OVER SLAB  
1:30

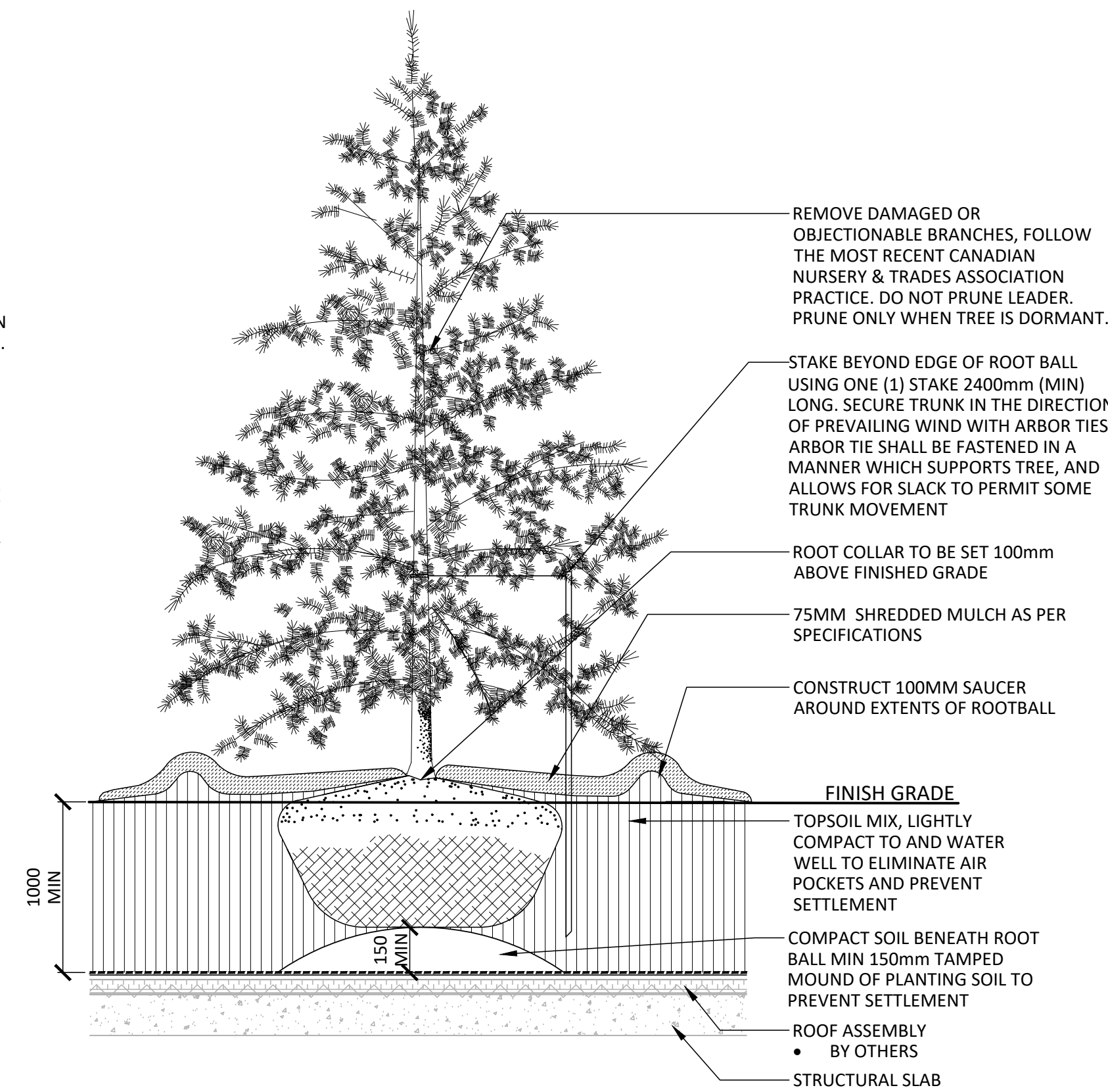

7 CONIFEROUS TREE PLANTING - OVER SLAB  
1:30

*G. Wildman*  
**GERALDINE WILDMAN**  
MANAGER, DEVELOPMENT REVIEW SOUTH  
PLANNING, DEVELOPMENT AND BUILDING SERVICES  
DEPARTMENT, CITY OF OTTAWA  
**APPROVED**  
By Geraldine Wildman at 10:26 pm, Dec 08, 2025

Contractor shall check all dimensions on the work and report any discrepancy to the Landscape Architect before proceeding. All drawings and specifications are the property of the Landscape Architect and must be returned at the completion of the work. This drawing is not to be used for construction until signed by the Landscape Architect.

-		
-		
-		
-		
-		
2	Re-issued for Site Plan Approval	25-09-11
1	Issued for Site Plan Approval	25-05-15
No.	Description	Date
Revision		
City Approval Stamp		

**ASSOCIATION OF LANDSCAPE ARCHITECTS ONTARIO**  
**MEMBER**  
**NAK**  
**design strategies**  
1285 WELLINGTON STREET, OTTAWA, ON K1Y 3A8 CANADA  
T 613.237.2345 [NAKDESIGNSTRATEGIES.COM](http://NAKDESIGNSTRATEGIES.COM)  
Project

**PICKERING PLACE**  
700 & 720 BANNERMOUNT AVE.  
OTTAWA, ON

Title	DETAILS
Date	2025-05-02
Scale	AS SHOWN
Drawn	SW
Checked	SC
Job No.	24-043
Sheet	L06