

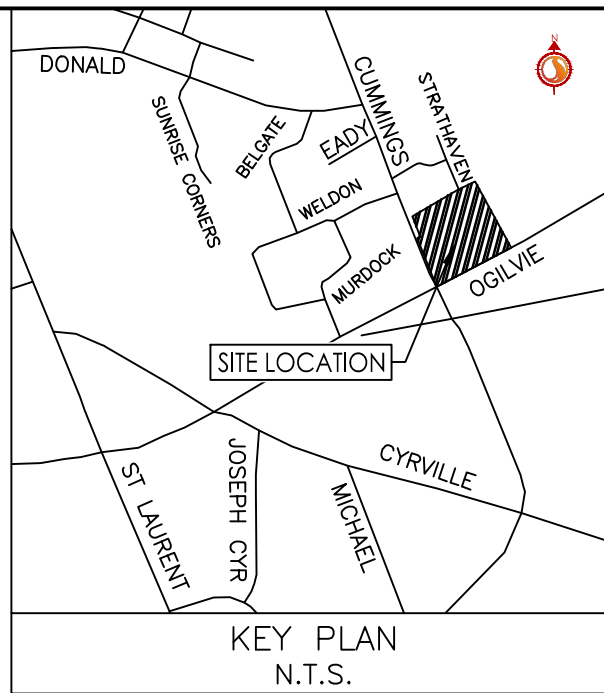

1. ALL WORK SHALL BE CARRIED OUT IN COMPLIANCE WITH THE ONTARIO OCCUPATIONAL HEALTH AND SAFETY ACT AND REGULATIONS FOR CONSTRUCTION PROJECTS.
2. ALL WORK AND MATERIALS TO CONFORM WITH CURRENT MINISTRY OF THE ENVIRONMENT & ENERGY OF ONTARIO, CITY OF OTTAWA AND ONTARIO PROVINCIAL STANDARDS AND SPECIFICATIONS. LOCAL UTILITY STANDARDS AND MINISTRY OF TRANSPORTATION STANDARDS WILL APPLY WHERE REQUIRED.
3. THE CONTRACTOR IS ADVISED THAT WORKS BY OTHERS MAY BE ONGOING DURING THE PERIOD OF THIS CONTRACT. THE CONTRACTOR SHALL COORDINATE CONSTRUCTION ACTIVITIES AND COORDINATION WITH ALL OTHER CONTRACTORS AND PREVENT CONSTRUCTION CONFLICTS.
4. THE INFORMATION SHOWN FOR EXISTING SERVICES AND UTILITIES WAS PROVIDED BY OTHERS. THE CONTRACTOR IS RESPONSIBLE FOR LOCATING AND PROTECTING ALL SERVICES AND UTILITIES DURING CONSTRUCTION. ALL EXISTING UTILITIES MUST BE LOCATED AND VERIFIED BY EACH UTILITY PRIOR TO COMMENCEMENT OF WORK. ANY VARIANCE TO BE IMMEDIATELY REPORTED TO THE ENGINEER. LOST TIME DUE TO FAILURE OF THE CONTRACTOR TO CONFIRM SERVICE AND UTILITY LOCATIONS AND NOTIFY THE ENGINEER OF POSSIBLE CONFLICTS PRIOR TO CONSTRUCTION WILL BE AT THE CONTRACTORS EXPENSE.
5. ALL CONSTRUCTION SHALL BE CARRIED OUT IN ACCORDANCE WITH THE RECOMMENDATIONS MADE IN THE GEOTECHNICAL REPORT.
6. THE CONTRACTOR IS RESPONSIBLE FOR OBTAINING ALL PERMITS REQUIRED AND TO BEAR THE COST OF SAME INCLUDING WATER PERMIT AND ASSOCIATED COSTS.
7. ALL DISTURBED AREAS SHALL BE RESTORED TO EQUAL OR BETTER CONDITION TO THE SATISFACTION THE ENGINEER AND THE CITY OF OTTAWA. PAVEMENT REINSTATEMENT FOR SERVICE AND UTILITY CUTS SHALL BE IN ACCORDANCE WITH CITY OF OTTAWA STANDARD R10, OPSD 509.010 AND OPSD 310.
8. BENCHMARKS: IT IS THE RESPONSIBILITY OF THE CONTRACTOR TO VERIFY THAT THE SITE BENCHMARK(S) HAS NOT BEEN ALTERED OR DISTURBED AND THAT ITS RELATIVE ELEVATION AND DESCRIPTION AGREES WITH THE INFORMATION SHOWN ON DRAWING GP-1.
9. THE CONTRACTOR SHALL PROVIDE TO THE ENGINEER 1 (ONE) SET OF AS CONSTRUCTED SITE SERVING, GRADING, AND SITE ELECTRICAL DWGS.
10. CONTRACTOR TO LOCATE EXISTING SERVICE LATERALS PRIOR TO CONSTRUCTION. EXISTING STORM AND SANITARY SERVICE LATERALS TO BE ABANDONED PER S11.4. EXISTING WATER SERVICE TO BE BLANKED AT THE MAIN (TYP.)
11. TOPOGRAPHIC SURVEY SUPPLIED BY: ANNIS, O'SULLIVAN, VOLLEBEKK LTD. PROJECT NO. 24453-23. TOPOGRAPHIC PLAN OF SURVEY PART OF LOT 18 REGISTERED PLAN 217 CITY OF OTTAWA DATED NOVEMBER 19, 2024.
12. SITE PLAN PREPARED BY RODERICK LAHEY ARCHITECT INC. DATED NOVEMBER 21, 2025.
13. GEOTECHNICAL INVESTIGATION PG57/G57-1 PREPARED BY PATERSON GROUP DATED FEBRUARY 3, 2025. GEOTECHNICAL INFORMATION PRESENTED ON THESE DRAWINGS MAY BE INTERFERED BY OTHERS PRIOR TO OR DURING PROJECT. IT IS THE RESPONSIBILITY OF THE CONTRACTOR TO VERIFY THE ACCURACY OF THE INFORMATION PROVIDED.



Stantec Consulting Ltd.
400 - 1331 Clyde Avenue
Ottawa ON
Tel. 613.722.4420
www.stantec.com

The Contractor shall verify and be responsible for all dimensions. DO NOT scale the drawing - any errors or omissions shall be reported to Stantec without delay.

The Copyrights to all designs and drawings are the property of Stantec. Reproduction or use for any purpose other than that authorized by Stantec is forbidden.

	PROPOSED WATERMAIN
	PROPOSED VALVE AND VALVE BOX
	PROPOSED VALVE CHAMBER
	PROPOSED W3 CHAMBER
	PROPOSED REDUCER
	PROPOSED FIRE HYDRANT
	PROPOSED SANITARY SEWER
	PROPOSED STORM SEWER
	PROPOSED CATCHBASIN MANHOLE
	PROPOSED CATCHBASIN
	EXISTING WATERMAIN
	EXISTING VALVE AND VALVE BOX
	EXISTING VALVE CHAMBER
	EXISTING REDUCER
	EXISTING FIRE HYDRANT
	EXISTING COMBINED SEWER
	EXISTING STORM SEWER
	EXISTING CATCHBASIN MANHOLE
	EXISTING CATCHBASIN
	PROPOSED DEPRESSED CURB LOCATIONS
	PROPOSED BARRIER CURB
	Thermal INSULATION ON STORM SEWER WHERE COVER IS LESS THAN 2.0m AS PER S33.
	Thermal INSULATION ON WATERMAIN WHERE COVER IS LESS THAN 2.4m AS PER W22.
	WATER METER
	REMOTE WATER METER
	APPROX. LOCATION OF ROOF DRAIN AS PER ARCHITECTURAL PLANS PREPARED BY RLA ARCHITECTURE
	APPROX. LOCATION OF OCCUPIES WITHIN ROOFTOP STORM WATER STORAGE AREAS AS PER ARCHITECTURAL PLANS PREPARED BY RLA ARCHITECTURE

1. ALL AREA AND TRENCH DRAINS TO BE CONNECTED TO INTERNAL PLUMBING AND COLLECTED IN STORM WATER MANAGEMENT CISTERN, DESIGN AND INSTALLATION BY OTHERS.
2. FINAL SERVICE LATERAL SEE LOCATION AND ELEVATION AND REMOTE METEROTE METER LOCATION TO BE PROVIDED BY MECHANICAL CONSULTANT.
3. SUMP PUMP REQUIRED TO DISCHARGE INTERNAL STORM AND SANITARY SERVICES. TO BE DESIGNED BY THE MECHANICAL CONSULTANT.
4. STORMWATER MANAGEMENT TO BE PROVIDED THROUGH A CISTERN LOCATED IN THE UNDERGROUND PARKING.
5. BOOSTER PUMPS TO BE PROVIDED TO MAINTAIN MINIMUM PRESSURES FOR TOWERS 6-STORIES AND HIGHER.
6. FLOOR DRAINS LOCATED INSIDE PARKING GARAGE TO BE CONNECTED TO BUILDING INTERNAL SANITARY SERVICE.
7. USE TO BE CONFIRMED BY THE STRUCTURAL CONSULTANT.

5	ISSUED FOR 66% DESIGN DEVELOPMENT	WAJ	KJK	25.11.25
4	REVISED SITE PLAN	WAJ	KJK	25.09.04
3	REVISED AS PER CITY COMMENTS	WAJ	KJK	25.08.29
2	ISSUED FOR CLIENT COST ESTIMATE	WAJ	KJK	25.08.22
1	ISSUED FOR REVIEW	WAJ	KJK	25.04.16
Revision		By	Appd.	YY.MM.DD

File Name: 160402095-DB-1137 Ogilvie.dwg	WAJ	KJK	WAJ	25.04.08
	Dwn.	Chkd.	Dsn.	YY.MM.DD

Permit-Seal

TC UNITED DEVELOPMENT CORPORATION

1137 OGILVIE ROAD

OTTAWA, ON

Title
SITE SERVICING PLAN

16040209

Drawing No.

Scale 0 2.5 7.5 12.5m
1:250

Sheet Revision

SSP-1

2 of 7

5

PLAN # 19283

D07-12-25-0054