



Chick-fil-A

Chick-fil-A
5200 Buffington Road
Atlanta, Georgia 30349-2998

exp Services Inc.
T: +1.905.793.9800 | F: +1.905.793.0641
1595 Clark Boulevard
Brampton, ON L6T 4V1
Canada
www.exp.com



• BUILDINGS • EARTH & ENVIRONMENT • ENERGY •
• INDUSTRIAL • INFRASTRUCTURE • SUSTAINABILITY



CHICK-FIL-A COLLEGE SQUARE

1984 Baseline Road
Ottawa, ON

FSR#30088

BUILDING TYPE / SIZE: IP02 SE
RELEASE: XXXXXXXX

REVISION SCHEDULE

NO.	DATE	DESCRIPTION
A	2025-09-16	FOR SPA
B	2025-11-07	FOR SPA

CITY # SPA xx REGION # Cxx
CONSULTANT PROJECT # RM0023002042-WO
PROJECT STATUS SPA
DATE SEPTEMBER 2025
DRAWN BY T.M.

Information contained on this drawing and in all digital files produced for above named project may not be reproduced in any manner without express written or verbal consent from authorized project representatives.

SHEET
CONSTRUCTION
MANAGEMENT PLAN

SHEET NUMBER

CMP1

Issued for SPA

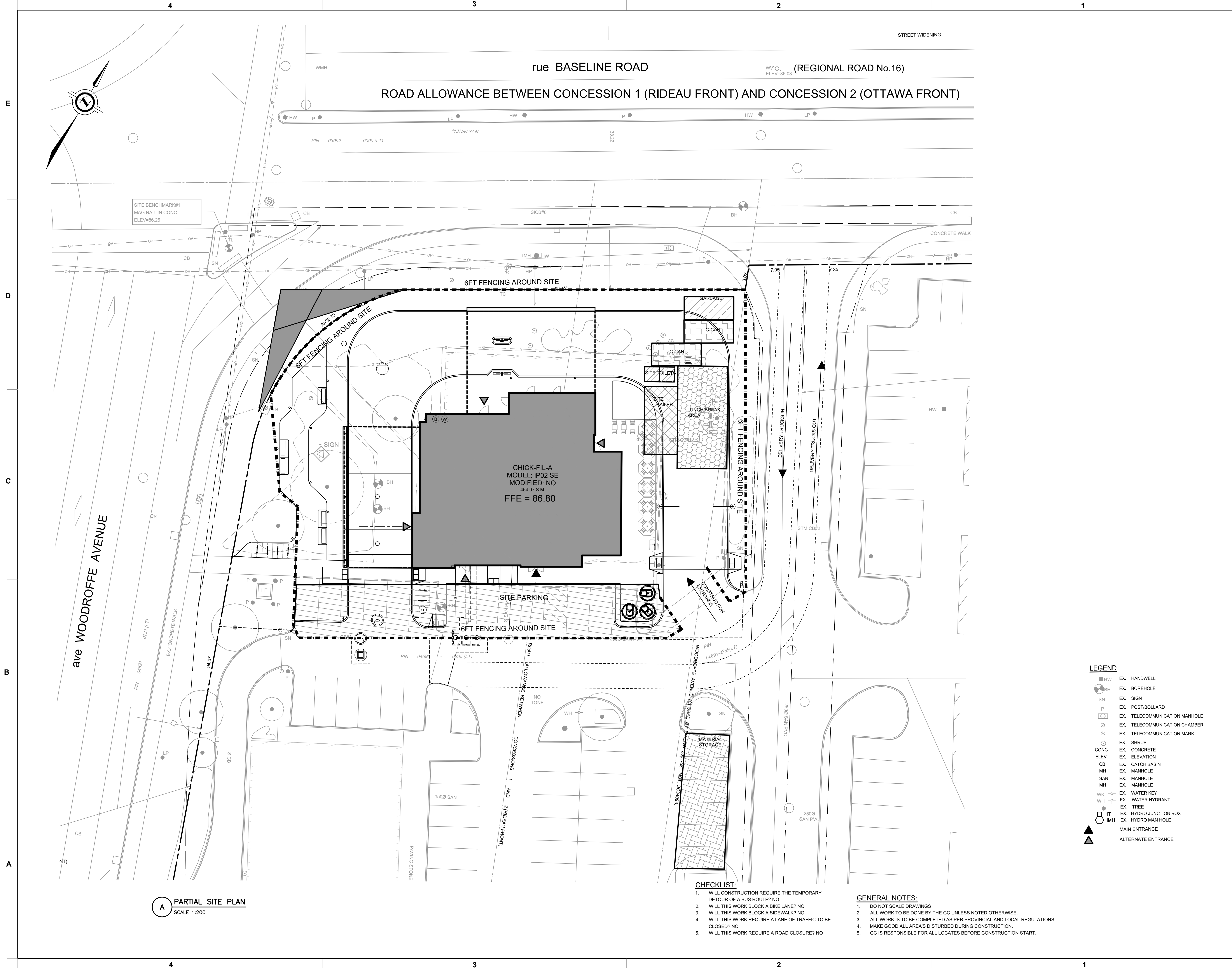

A PARTIAL SITE PLAN
SCALE 1:200

- CHECKLIST:**
1. WILL CONSTRUCTION REQUIRE THE TEMPORARY DETOUR OF A BUS ROUTE? NO
 2. WILL THIS WORK BLOCK A BIKE LANE? NO
 3. WILL THIS WORK BLOCK A SIDEWALK? NO
 4. WILL THIS WORK REQUIRE A LANE OF TRAFFIC TO BE CLOSED? NO
 5. WILL THIS WORK REQUIRE A ROAD CLOSURE? NO

- GENERAL NOTES:**
1. DO NOT SCALE DRAWINGS
 2. ALL WORK IS TO BE DONE BY THE GC UNLESS NOTED OTHERWISE.
 3. ALL WORK IS TO BE COMPLETED AS PER PROVINCIAL AND LOCAL REGULATIONS.
 4. MAKE GOOD ALL AREA'S DISTURBED DURING CONSTRUCTION.
 5. GC IS RESPONSIBLE FOR ALL LOCATES BEFORE CONSTRUCTION START.

E:\B\M\B\M-23002042-WO\60 Execution\65 Drawings\10-30096-CMP1-RB.dwg
7 November 2025