

NOTES:

1. CONCRETE SHALL BE ARCHITECTURAL FINISH.
2. TYPICAL 450MM HEIGHT x 1,200mm x WIDTH 1,200mm DEPTH
3. OPTIONAL ARMS AND WOOD TOPPING

PRE-CAST CONCRETE BLOCK (O'CONNOR EDGE)

SCALE: 1/200

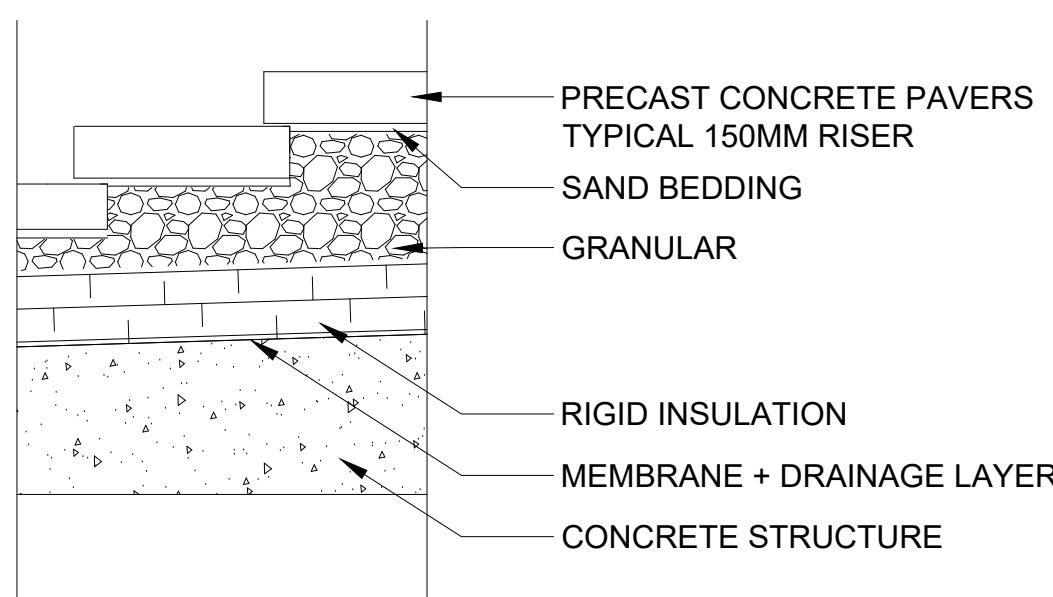

TYPICAL PRECAST TREAD DETAIL

SCALE: 1/200

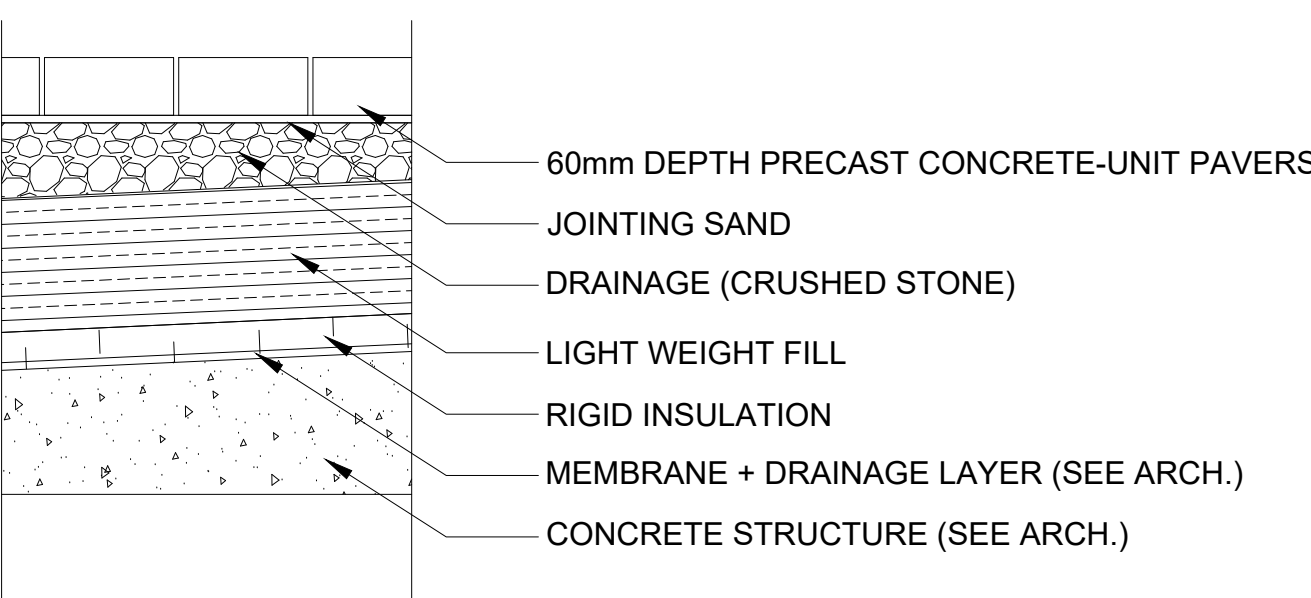

TYPICAL PAVER DETAIL

SCALE: 1/200

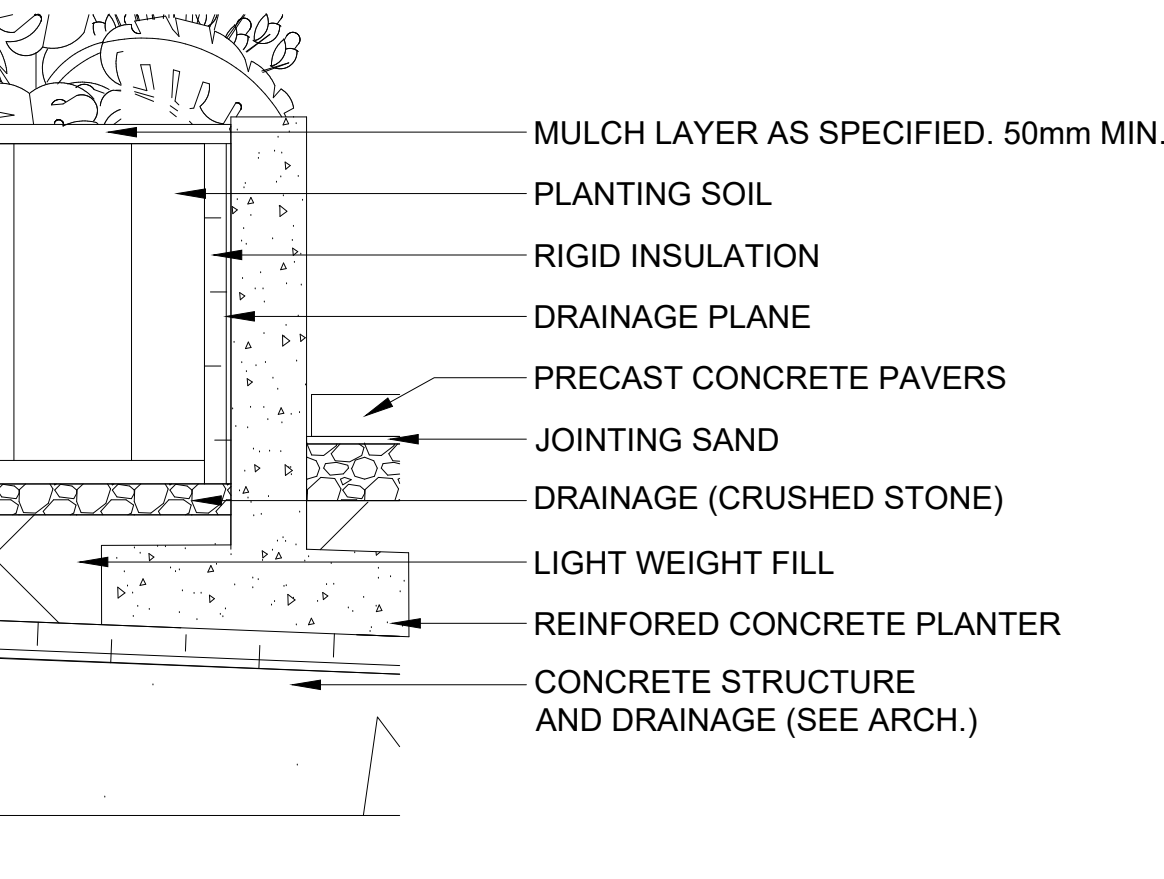

TYPICAL CAST-IN-PLACE PLANTER

SCALE: 1/200

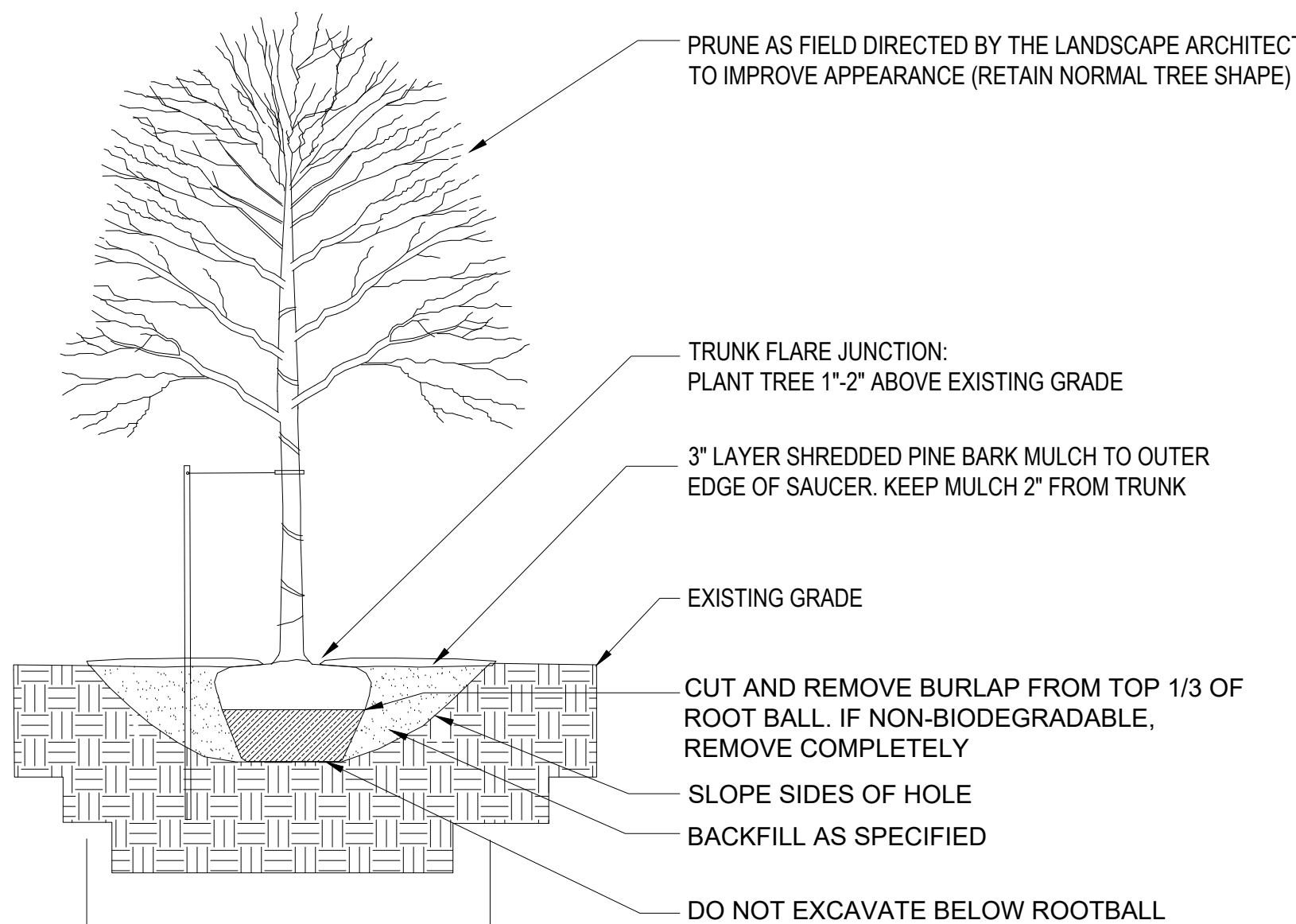

TREE PLANTING - DECIDUOUS

SCALE: 1/200

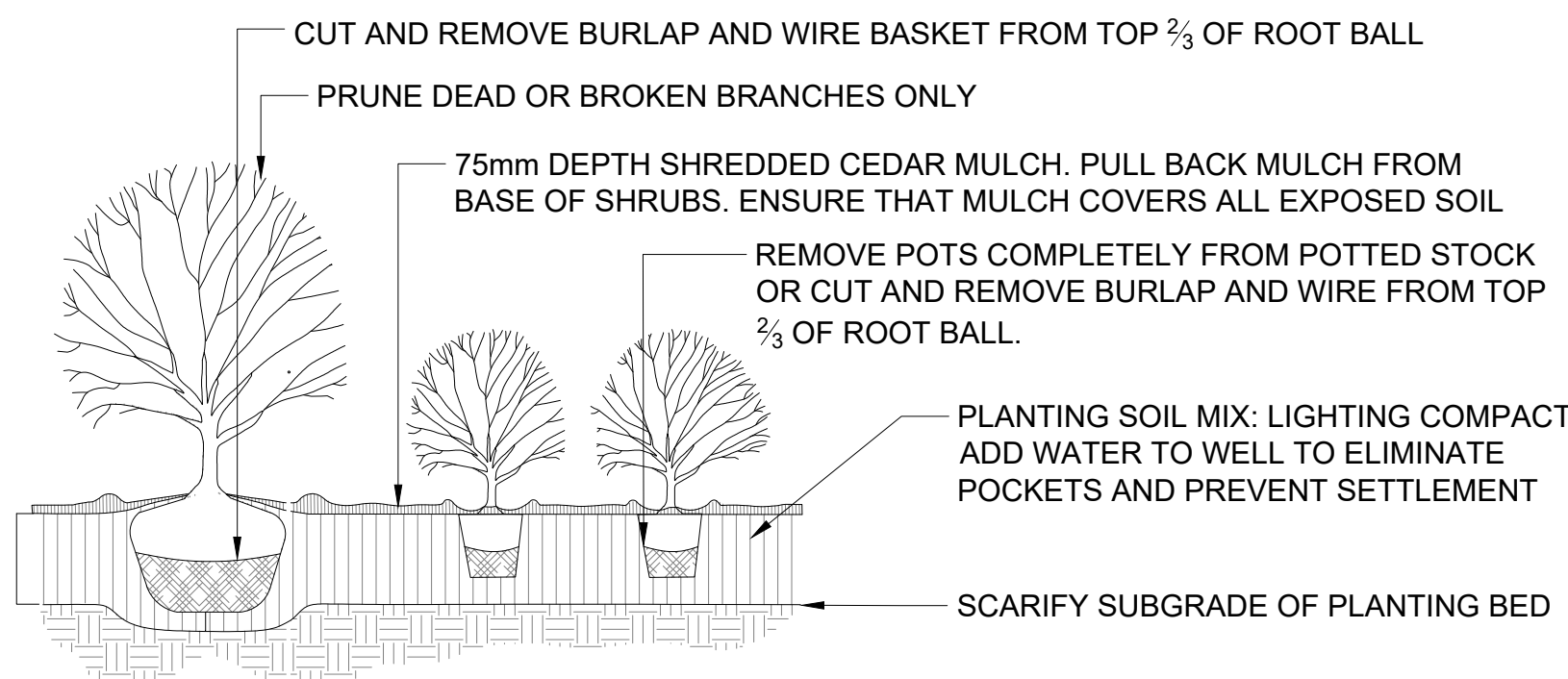

NOTES:

1. ALL MEASUREMENTS IN MILLIMETRES UNLESS OTHERWISE NOTED.
2. LOCATION AS SPECIFIED ON THE CONTRACT DRAWINGS.
3. PLANTING SOIL MIXTURE AS PER SPECIFICATION
4. SHRUBS SPECIFIED BARE ROOTS (B.R.) TO BE PLANTED TO THAT ROOTS ARE FULLY EXTENDED IN PLANTING HOLE WITH SOIL MIX BACKFILLED CAREFULLY TO PREVENT ROOT DAMAGE
5. PROVIDE 100mm HIGH EARTH SAUCER AROUND SHRUB BED
6. STAKES TO BE REMOVED AT COMPLETION OF TWO YEAR WARRANTY PERIOD

SHRUB PLANTING - CONTINUOUS

SCALE: 1/200

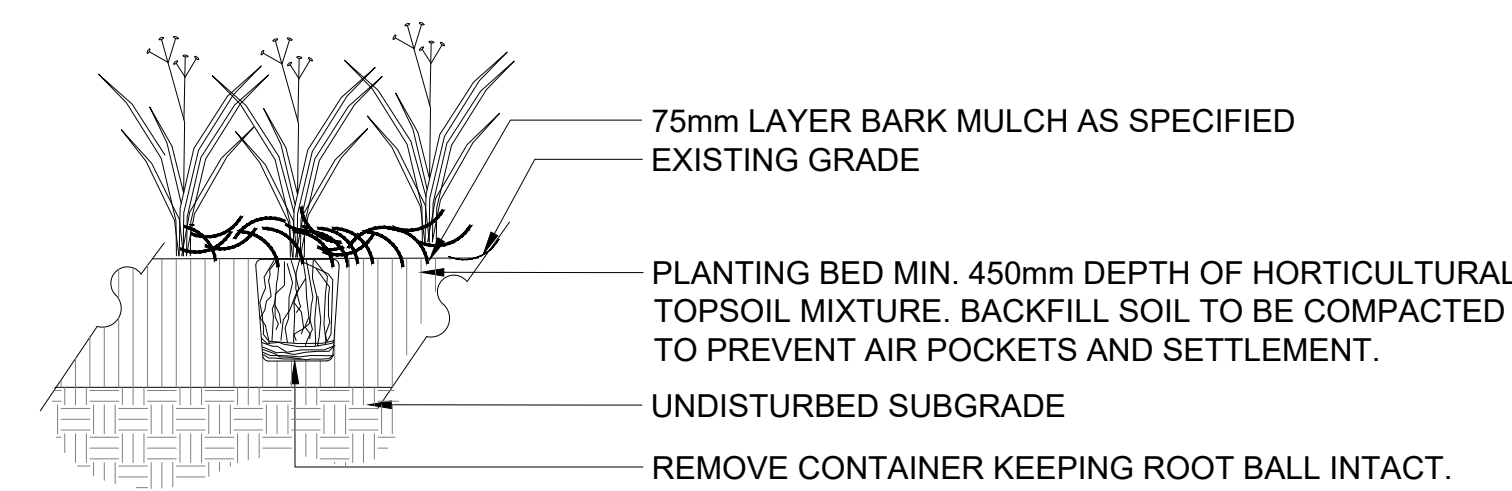

NOTES:

1. ALL MEASUREMENTS IN MILLIMETRES UNLESS OTHERWISE NOTED.
2. LOCATION AS SPECIFIED ON THE CONTRACT DRAWINGS.
3. PLANTING SOIL MIXTURE AS PER SPECIFICATION.

PERENNIAL AND ORNAMENTAL GRASS PLANTING

SCALE: 1/200

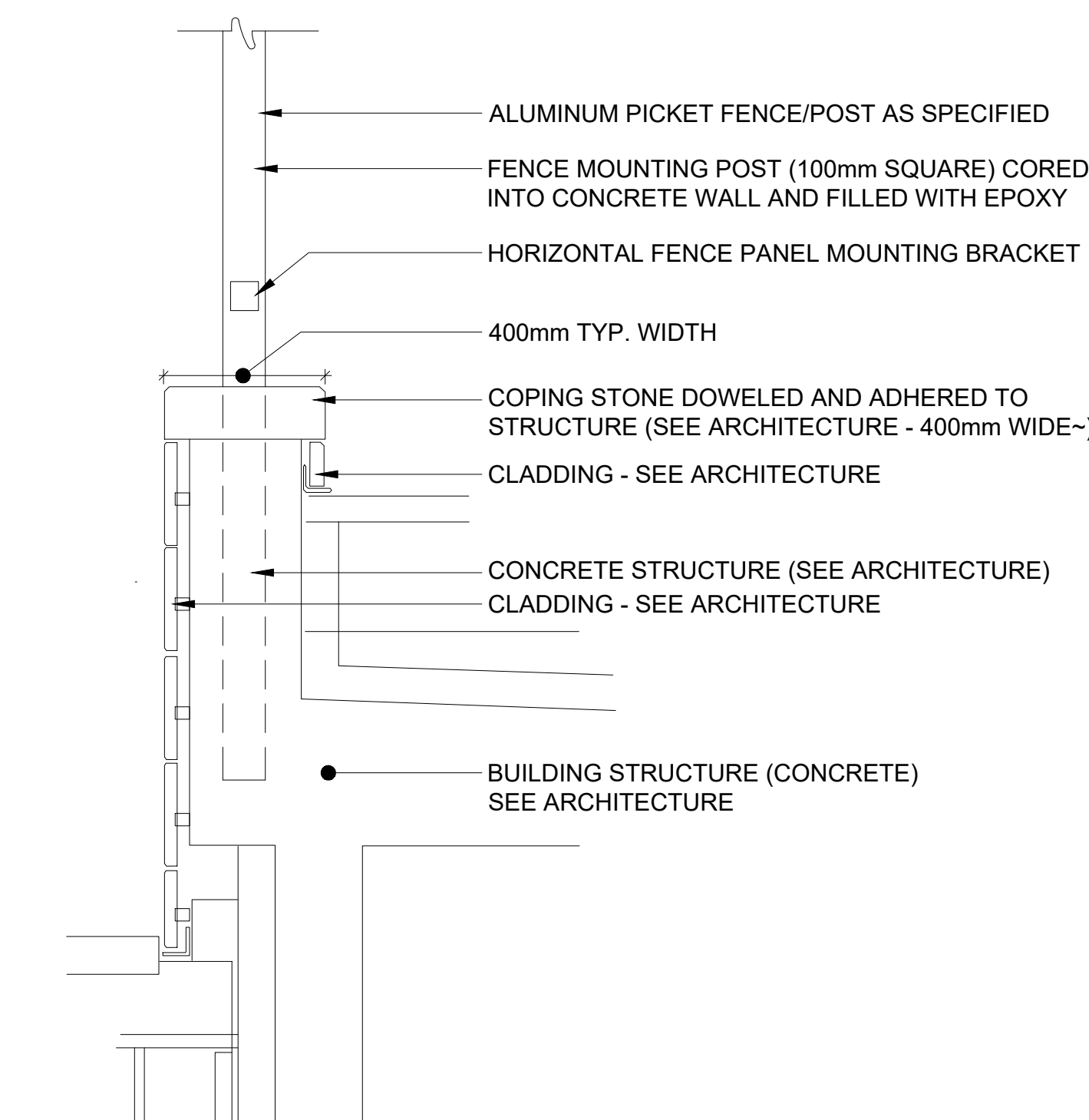

TYPICAL FENCE AT EXTERIOR CONCRETE BUILDING

SCALE: 1/200

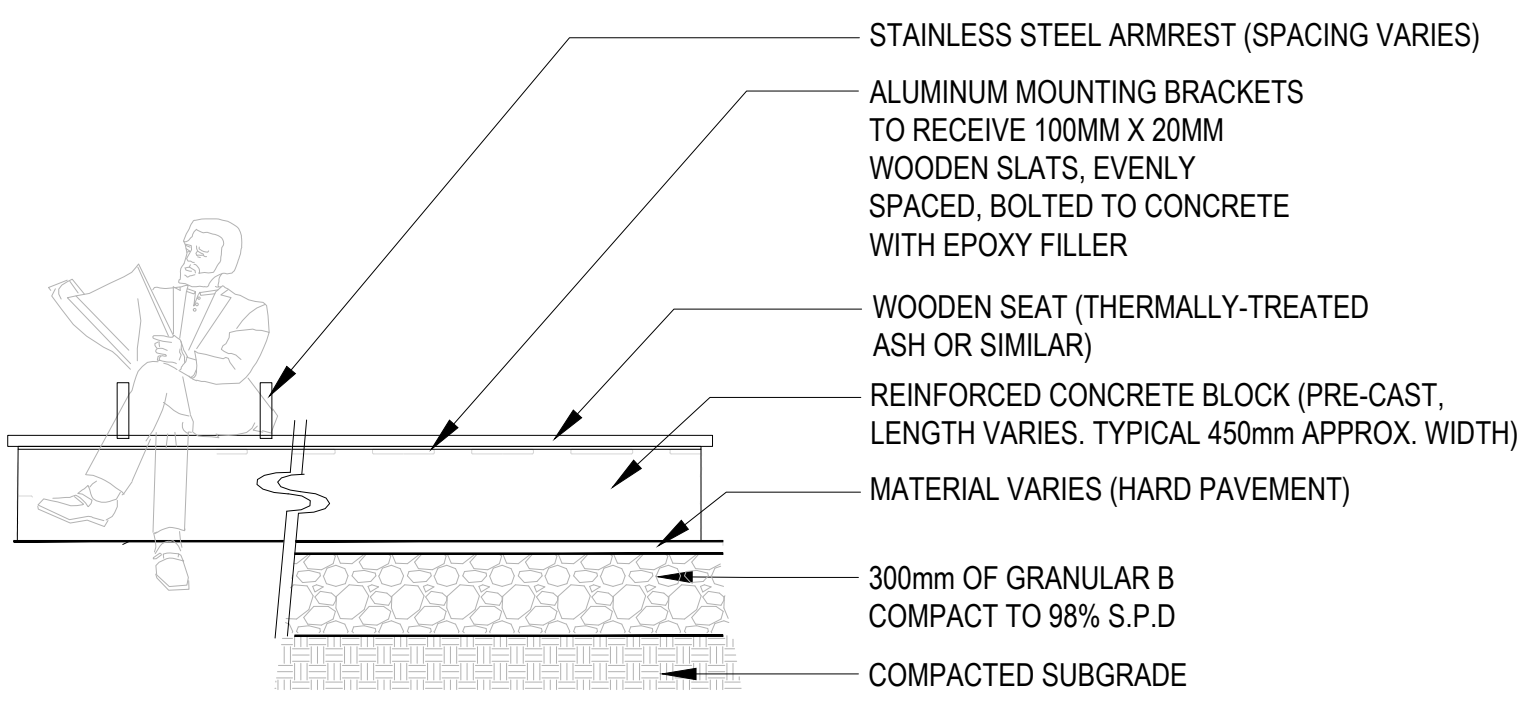

NOTES:

1. CONCRETE REINFORCING SHALL SUBMITTED TO THE LANDSCAPE ARCHITECT FOR REVIEW PRIOR TO ORDERING.

PRE-CAST PLINTH SEATING BLOCK (SLATER EDGE)

SCALE: 1/200

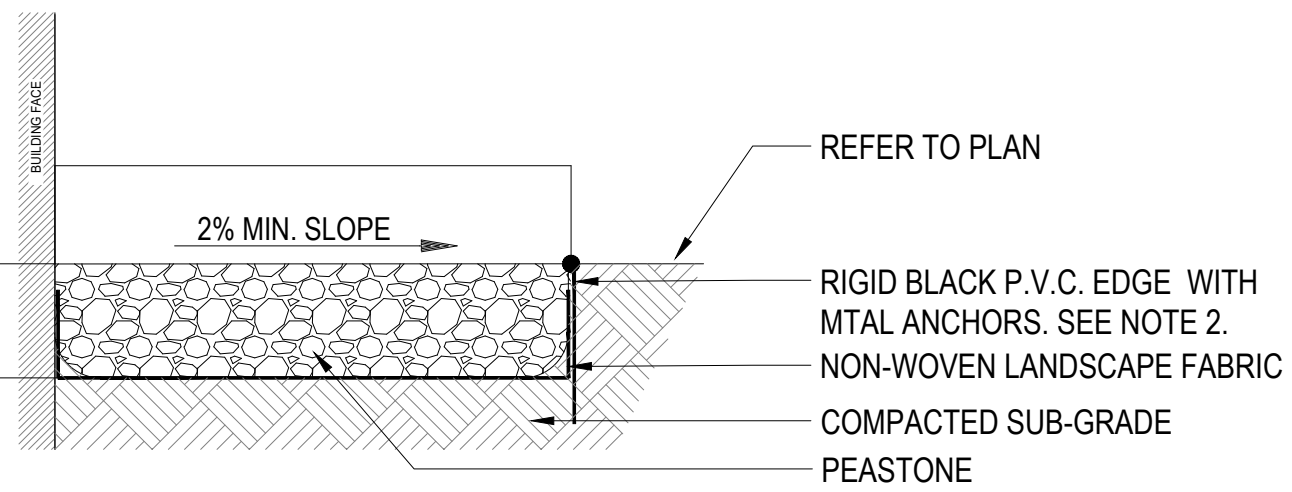

NOTES:

1. PEASTONE SHALL BE COLOURED RIVERWASH STONE, 3/8" TO 5/8", AVAILABLE FROM GREELY SAND & GRAVEL, OR APPROVED EQUAL.
2. RIGID EDGING SHALL BE PERMALOC (1-800-356-9660) OR APPROVED EQUAL.

DECORATIVE PEASTONE

SCALE: 1/200

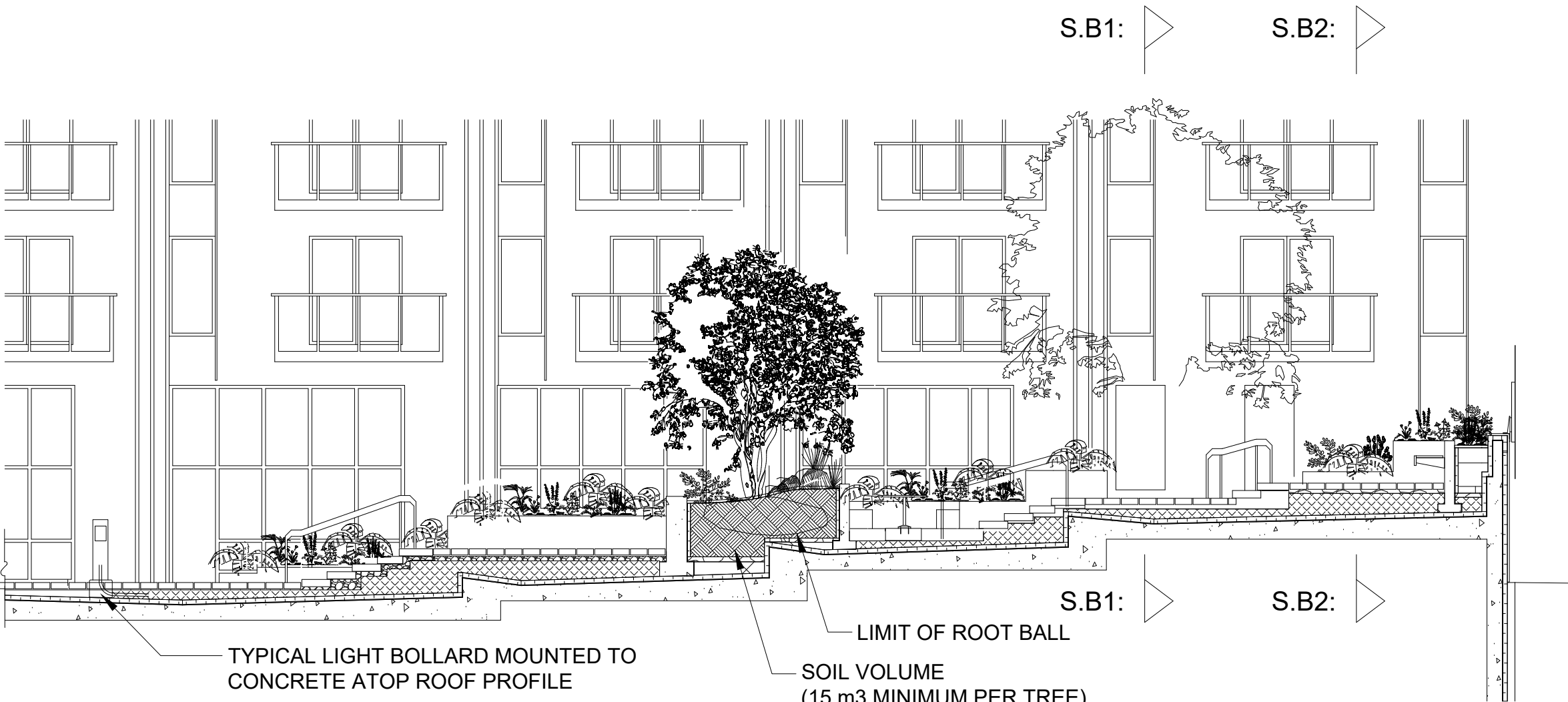

SECTION ELEVATION: REAR OUTDOOR AMENITY AREA 'AT-GRADE' VIEWING EAST

SCALE: 1/200

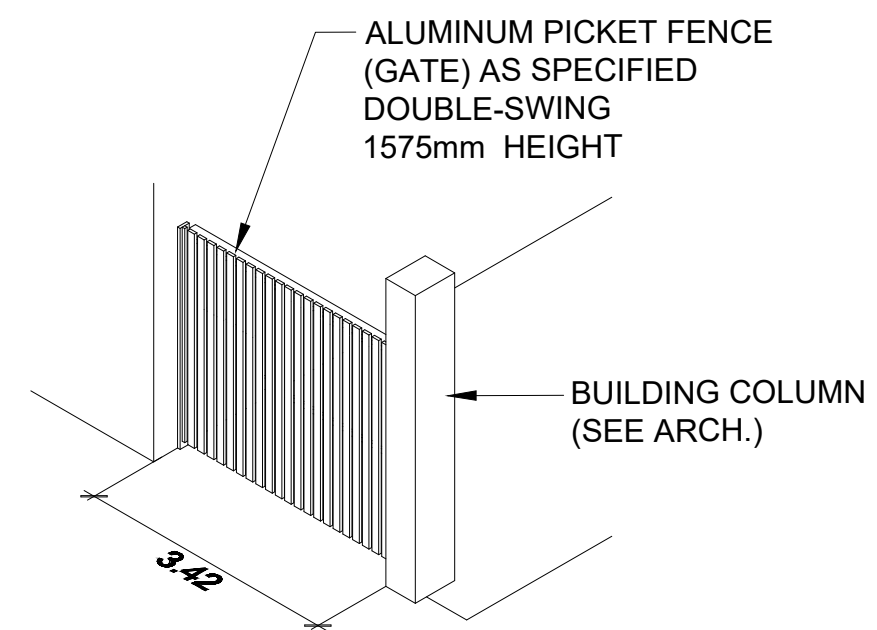

MAINTENANCE GATE (SLATER ACCESS)

SCALE: 1/200

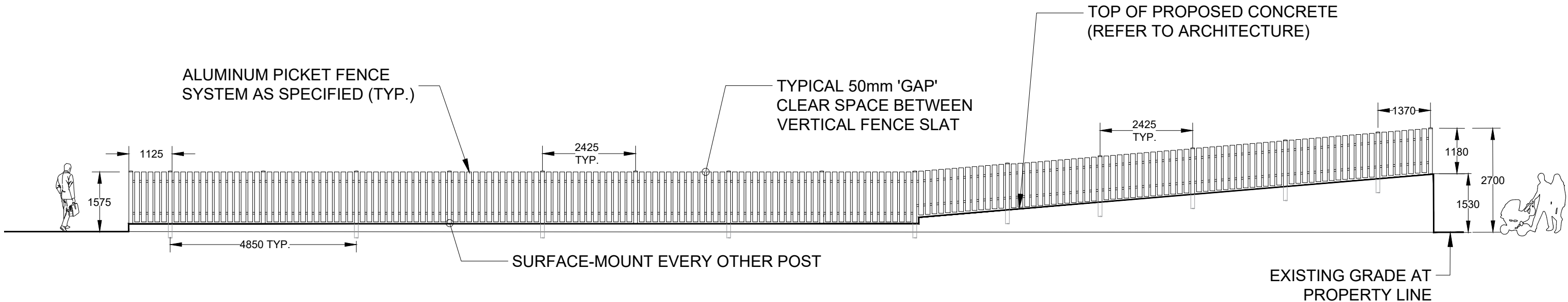

EXTERIOR REAR AMENITY PERIMETER FENCE: ELEVATION VIEWING EAST

SCALE: 1/200

GENERAL NOTES:

Do not measure directly on the plans.
All dimensions and general conditions are to be verified before the beginning of work.
Never proceed with uncertainty.
This drawing must be read carefully with the architectural specifications as well as the general notes.

LEGAL DESCRIPTION OF THE LANDS

Lot 43 and Part of Lot 42 (South Silver Street)
Part of Lot 42 and 43 (North Laurier Avenue) Registered Plan 2022
City of Ottawa

Architect

Client/Applicant



Key Plan

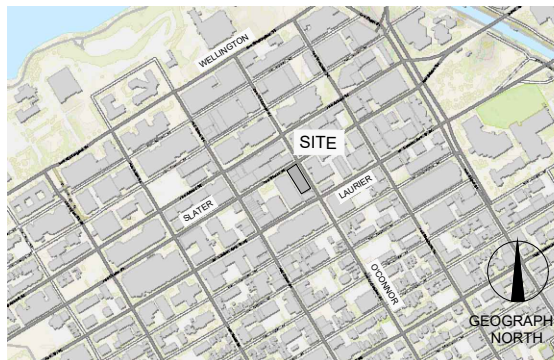

REVISIONS	DESCRIPTION	DATE
1		



2023-10-16	ISSUED FOR SITE PLAN APPLICATION (REV. 1)	J.L.
2023-10-16	ISSUED FOR CLIENT REVIEW (REV. 2)	J.L.
2023-10-16	ISSUED FOR BUILDING PERMIT (REV. 3)	J.L.
2024-10-16	ISSUED FOR SITE PLAN APPLICATION (REV. 4)	J.L.

2023-10-16	ISSUED FOR SITE PLAN APPLICATION (REV. 1)	J.L.
2023-10-16	ISSUED FOR CLIENT REVIEW (REV. 2)	J.L.
2023-10-16	ISSUED FOR BUILDING PERMIT (REV. 3)	J.L.
2024-10-16	ISSUED FOR SITE PLAN APPLICATION (REV. 4)	J.L.

2023-10-16	ISSUED FOR SITE PLAN APPLICATION (REV. 1)	J.L.
2023-10-16	ISSUED FOR CLIENT REVIEW (REV. 2)	J.L.
2023-10-16	ISSUED FOR BUILDING PERMIT (REV. 3)	J.L.
2024-10-16	ISSUED FOR SITE PLAN APPLICATION (REV. 4)	J.L.

2023-10-16	ISSUED FOR SITE PLAN APPLICATION (REV. 1)	J.L.
2023-10-16	ISSUED FOR CLIENT REVIEW (REV. 2)	J.L.
2023-10-16	ISSUED FOR BUILDING PERMIT (REV. 3)	J.L.
2024-10-16	ISSUED FOR SITE PLAN APPLICATION (REV. 4)	J.L.

2023-10-16	ISSUED FOR SITE PLAN APPLICATION (REV. 1)	J.L.
2023-10-16	ISSUED FOR CLIENT REVIEW (REV. 2)	J.L.
2023-10-16	ISSUED FOR BUILDING PERMIT (REV. 3)	J.L.
2024-10-16	ISSUED FOR SITE PLAN APPLICATION (REV. 4)	J.L.

2023-10-16	ISSUED FOR SITE PLAN APPLICATION (REV. 1)	J.L.
2023-10-16	ISSUED FOR CLIENT REVIEW (REV. 2)	J.L.
2023-10-16	ISSUED FOR BUILDING PERMIT (REV. 3)	J.L.
2024-10-16	ISSUED FOR SITE PLAN APPLICATION (REV. 4)	J.L.

2023-10-16	ISSUED FOR SITE PLAN APPLICATION (REV. 1)	J.L.
2023-10-16	ISSUED FOR CLIENT REVIEW (REV. 2)	J.L.
2023-10-16	ISSUED FOR BUILDING PERMIT (REV. 3)	J.L.
2024-10-16	ISSUED FOR SITE PLAN APPLICATION (REV. 4)	J.L.

2023-10-16	ISSUED FOR SITE PLAN APPLICATION (REV. 1)	J.L.
2023-10-16	ISSUED FOR CLIENT REVIEW (REV. 2)	J.L.
2023-10-16	ISSUED FOR BUILDING PERMIT (REV. 3)	J.L.
2024-10-16	ISSUED FOR SITE PLAN APPLICATION (REV. 4)	J.L.

2023-10-16	ISSUED FOR SITE PLAN APPLICATION (REV. 1)	J.L.
2023-10-16	ISSUED FOR CLIENT REVIEW (REV. 2)	J.L.
2023-10-16	ISSUED FOR BUILDING PERMIT (REV. 3)	J.L.
2024-10-16	ISSUED FOR SITE PLAN APPLICATION (REV. 4)	J.L.

2023-10-16	ISSUED FOR SITE PLAN APPLICATION (REV. 1)	J.L.
2023-10-16	ISSUED FOR CLIENT REVIEW (REV. 2)	J.L.
2023-10-16	ISSUED FOR BUILDING PERMIT (REV. 3)	J.L.
2024-10-16	ISSUED FOR SITE PLAN APPLICATION (REV. 4)	J.L.

2023-10-16	ISSUED FOR SITE PLAN APPLICATION (REV. 1)	J.L.
2023-10-16	ISSUED FOR CLIENT REVIEW (REV. 2)	J.L.
2023-10-16	ISSUED FOR BUILDING PERMIT (REV. 3)	J.L.
2024-10-16	ISSUED FOR SITE PLAN APPLICATION (REV. 4)	J.L.

2023-10-16	ISSUED FOR SITE PLAN APPLICATION (REV. 1)	J.L.
2023-10-16	ISSUED FOR CLIENT REVIEW (REV. 2)	J.L.
2023-10-16	ISSUED FOR BUILDING PERMIT (REV. 3)	J.L.
2024-10-16	ISSUED FOR SITE PLAN APPLICATION (REV. 4)	J.L.

2023-10-16	ISSUED FOR SITE PLAN APPLICATION (REV. 1)	J.L.
2023-10-16	ISSUED FOR CLIENT REVIEW (REV. 2)	J.L.
2023-10-16	ISSUED FOR BUILDING PERMIT (REV. 3)	J.L.
2024-10-16	ISSUED FOR SITE PLAN APPLICATION (REV. 4)	J.L.

2023-10-16	ISSUED FOR SITE PLAN APPLICATION (REV. 1)	J.L.
2023-10-16	ISSUED FOR CLIENT REVIEW (REV. 2)	J.L.
2023-10-16	ISSUED FOR BUILDING PERMIT (REV. 3)	J.L.
2024-10-16	ISSUED FOR SITE PLAN APPLICATION (REV. 4)	J.L.

2023-10-16	ISSUED FOR SITE PLAN APPLICATION (REV. 1)	J.L.
2023-10-16	ISSUED FOR CLIENT REVIEW (REV. 2)	J.L.
2023-10-16	ISSUED FOR BUILDING PERMIT (REV. 3)	J.L.
2024-10-16	ISSUED FOR SITE PLAN APPLICATION (REV. 4)	J.L.

2023-10-16	ISSUED FOR SITE PLAN APPLICATION (REV. 1)	J.L.
2023-10-16	ISSUED FOR CLIENT REVIEW (REV. 2)	J.L.
2023-10-16	ISSUED FOR BUILDING PERMIT (REV. 3)	J.L.
2024-10-16	ISSUED FOR SITE PLAN APPLICATION (REV. 4)	J.L.

2023-10-16	ISSUED FOR SITE PLAN APPLICATION (REV. 1)	J.L.
2023-10-16	ISSUED FOR CLIENT REVIEW (REV. 2)	J.L.
2023-10-16	ISSUED FOR BUILDING PERMIT (REV. 3)	J.L.
2024-10-16	ISSUED FOR SITE PLAN APPLICATION (REV. 4)	J.L.

2023-10-16	ISSUED FOR SITE PLAN APPLICATION (REV. 1)	J.L.
2023-10-16	ISSUED FOR CLIENT REVIEW (REV. 2)	J.L.
2023-10-16	ISSUED FOR BUILDING PERMIT (REV. 3)	J.L.
2024-10-16	ISSUED FOR SITE PLAN APPLICATION (REV. 4)	J.L.

2023-10-16	ISSUED FOR SITE PLAN APPLICATION (REV. 1)	J.L.
2023-10-16	ISSUED FOR CLIENT REVIEW (REV. 2)	J.L.
2023-10-16	ISSUED FOR BUILDING PERMIT (REV. 3)	J.L.
2024-10-16	ISSUED FOR SITE PLAN APPLICATION (REV. 4)	J.L.

2023-10-16	ISSUED FOR SITE PLAN APPLICATION (REV. 1)	J.L.
2023-10-16	ISSUED FOR CLIENT REVIEW (REV. 2)	J.L.
2023-10-16	ISSUED FOR BUILDING PERMIT (REV. 3)	J.L.
2024-10-16	ISSUED FOR SITE PLAN APPLICATION (REV. 4)	J.L.

2023-10-16	ISSUED FOR SITE PLAN APPLICATION (REV. 1)	J.L.
2023-10-16	ISSUED FOR CLIENT REVIEW (REV. 2)	J.L.
2023-10-16	ISSUED FOR BUILDING PERMIT (REV. 3)	J.L.
2024-10-16	ISSUED FOR SITE PLAN APPLICATION (REV. 4)	J.L.

2023-10-16	ISSUED FOR SITE PLAN APPLICATION (REV. 1)	J.L.
2023-10-16	ISSUED FOR CLIENT REVIEW (REV. 2)	J.L.
2023-10-16	ISSUED FOR BUILDING PERMIT (REV. 3)	J.L.
2024-10-16	ISSUED FOR SITE PLAN APPLICATION (REV. 4)	J.L.

2023-10-16	ISSUED FOR SITE PLAN APPLICATION (REV. 1)	J.L.
2023-10-16	ISSUED FOR CLIENT REVIEW (REV. 2)	J.L.
2023-10-16	ISSUED FOR BUILDING PERMIT (REV. 3)	J.L.
2024-10-16	ISSUED FOR SITE PLAN APPLICATION (REV. 4)	J.L.

2023-10-16	ISSUED FOR SITE PLAN APPLICATION (REV. 1)	J.L.
2023-10-16	ISSUED FOR CLIENT REVIEW (REV. 2)	J.L.
2023-10-16	ISSUED FOR BUILDING PERMIT (REV. 3)	J.L.
2024-10-16	ISSUED FOR SITE PLAN APPLICATION (REV. 4)	J.L.

2023-10-16	ISSUED FOR SITE PLAN APPLICATION (REV. 1)	J.L.
2023-10-16	ISSUED FOR CLIENT REVIEW (REV. 2)	J.L.
2023-10-16	ISSUED FOR BUILDING PERMIT (REV. 3)	J.L.
2024-10-16	ISSUED FOR SITE PLAN APPLICATION (REV. 4)	J.L.

2023-10-16	ISSUED FOR SITE PLAN APPLICATION (REV. 1)	J.L.
2023-10-16	ISSUED FOR CLIENT REVIEW (REV. 2)	J.L.
2023-10-16	ISSUED FOR BUILDING PERMIT (REV. 3)	J.L.
2024-10-16	ISSUED FOR SITE PLAN APPLICATION (REV. 4)	J.L.

2023-10-16	ISSUED FOR SITE PLAN APPLICATION (REV. 1)	J.L.
2023-10-16	ISSUED FOR CLIENT REVIEW (REV. 2)	J.L.
2023-10-16	ISSUED FOR BUILDING PERMIT (REV. 3)	J.L.
2024-10-16	ISSUED FOR SITE PLAN APPLICATION (REV. 4)	J.L.

2023-10-16	ISSUED FOR SITE PLAN APPLICATION (REV. 1)	J.L.
2023-10-16	ISSUED FOR CLIENT REVIEW (REV. 2)	J.L.
2023-10-16	ISSUED FOR BUILDING PERMIT (REV. 3)	J.L.
2024-10-16	ISSUED FOR SITE PLAN APPLICATION (REV. 4)	J.L.

2023-10-16	ISSUED FOR SITE PLAN APPLICATION (REV. 1)	J.L.
2023-10-16	ISSUED FOR CLIENT REVIEW (REV. 2)	J.L.
2023-10-16	ISSUED FOR BUILDING PERMIT (REV. 3)	J.L.
2024-10-16	ISSUED FOR SITE PLAN APPLICATION (REV. 4)	J.L.