

## KEY PLAN

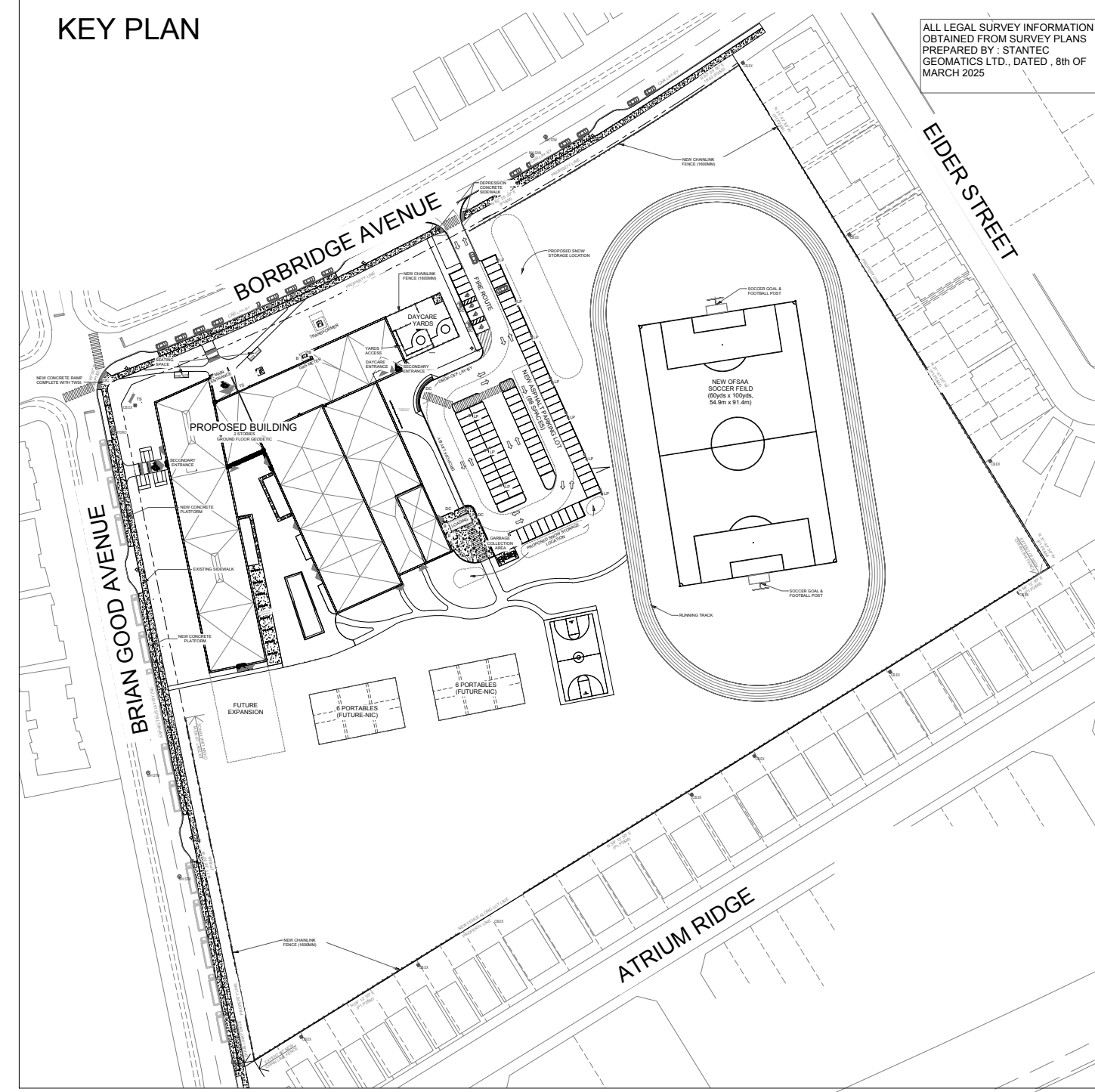

## LEGAL DESCRIPTION:

BLOCK 220  
REGISTERED PLAN 4M-1641  
CITY OF OTTAWA

ALL LEGAL SURVEY INFORMATION  
OBTAINED FROM SURVEY PLANS  
PREPARED BY : STANTEC  
GEOMATICS LTD., DATED , 8th OF  
MARCH 2025

**NOTE:**  
ALL FILL MATERIAL TO BE PLACED  
WITHIN ALL TREE AREAS INCLUDING  
THE EAST SIDE OF THE SITE IS TO  
BE CONDUCTIVE TO TREE  
PLANTING. THIS MATERIAL SHOULD  
EITHER BE SANDY LOAM OR  
APPROVED EQUAL. CONTRACTORS  
TO PROVIDE SAMPLES FOR  
APPROVAL.

PROPOSED PLANT LIST		QTY					
KEY	QTY	BOTANICAL NAME	COMMON NAME	SIZE	CONDITION	COMMENTS	
TREES							
• AM	5	<i>Acer campestre</i>	Hedge Maple	50mm cal.	B&B		
• BB	8	<i>Carpinus caroliniana</i>	Blue Beech	50mm cal.	B&B		
• BO	8	<i>Quercus macrocarpa</i>	Bur Oak	50mm cal.	B&B		
• FM	13	<i>Acer x freemanii</i>	Freeman's Maple	50mm cal.	B&B		
• HB	14	<i>Celtis occidentalis</i>	Hackberry	50mm cal.	B&B		
• HL	10	<i>Gleditsia triacanthos 'Shademaster'</i>	Shademaster Honeylocust	50mm cal.	B&B		
• RM	4	<i>Acer rubrum</i>	Red Maple	50mm cal.	B&B		
• RO	18	<i>Quercus rubra</i>	Red Oak	50mm cal.	B&B		
• SK	2	<i>Gleditsia triacanthos var. inermis 'Draves'</i>	Street Keeper Honeylocust	60mm cal.	B&B		
• SM	20	<i>Acer saccharum</i>	Sugar Maple	50mm cal.	B&B		
• SR	5	<i>Syringa reticulata</i>	Japanese Lilac Tree	50mm cal.	B&B	Tree Form	
• WP	5	<i>Pinus strobus</i>	White Pine	1800 mm ht.	B&B		
• WS	10	<i>Picea glauca</i>	White Spruce	1800 mm ht.	B&B		
• WB	9	<i>Abies balsamea</i>	Balsam Fir	1800 mm ht.	B&B		
• WC	5	<i>Tsuga canadensis</i>	Canadian Hemlock	1800 mm ht.	B&B		
SHRUBS							
• BH	36	<i>Juniperus chinensis 'Hetz Blue'</i>	Hetz Blue Juniper	800mm spr.	Potted	1500mm o.c.	
• BD	38	<i>Juniperus sabina 'Blue Danube'</i>	Blue Danube Juniper	600mm spr.	Potted	1000mm o.c.	
• CU	31	<i>Rhus typhina 'Laciniata'</i>	Cutleaf Staghorn Sumac	800mm ht.	Potted	1200mm o.c.	
• FS	67	<i>Sorbaria sorbifolia</i>	Ural False Spirea	800mm ht.	Potted	1500mm o.c.	
• FR	45	<i>Rhus aromatica</i>	Fragrant Sumac	800mm ht.	Potted	800mm o.c.	
• GS	87	<i>Spiraea x arguta</i>	Garland Spirea	800mm ht.	Potted	1000mm o.c.	
• SE	116	<i>Sorbaria sorbifolia 'Sem'</i>	Sem False Spirea	800mm ht.	Potted	800mm o.c.	
• ST	82	<i>Rhus typhina</i>	Staghorn Sumac	800mm ht.	Potted	1200mm o.c.	
PERENNIALS/ GRASSES							
• BL	66	<i>Leymus arenarius</i>	Blue Lyme Grass	250mm pot	Potted	1000mm o.c.	
• HM	146	<i>Panicum virgatum 'Heavy Metal'</i>	Heavy Metal Switch Grass	250mm pot	Potted	800mm o.c.	
• KF	384	<i>Calamagrostis 'Karl Foerster'</i>	Karl Foerster Grass	250mm pot	Potted	800mm o.c.	
• SG	56	<i>Miscanthus sinensis 'Cabaret'</i>	Cabaret Japanese Silver Grass	250mm pot	Potted	1000mm o.c.	
* INDICATES PRIVATELY OWNED VEGETATION							

## LEGEND



ALLISON HAMLIN  
MANAGER, DEVELOPMENT REVIEW ALL WARDS  
PLANNING, DEVELOPMENT & BUILDING SERVICES  
DEPARTMENT, CITY OF OTTAWA

APPROVED  
By Allison Hamlin at 4:20 pm, Sep 24, 2025

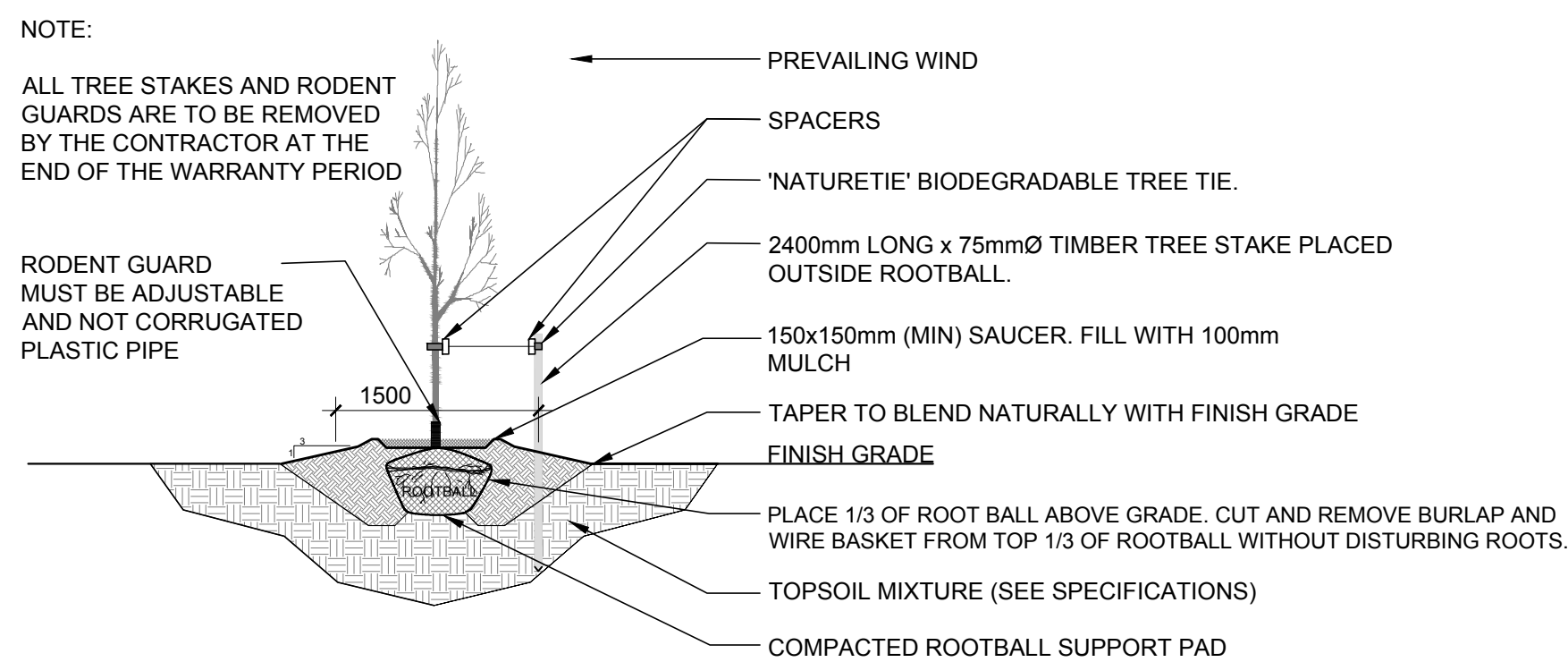
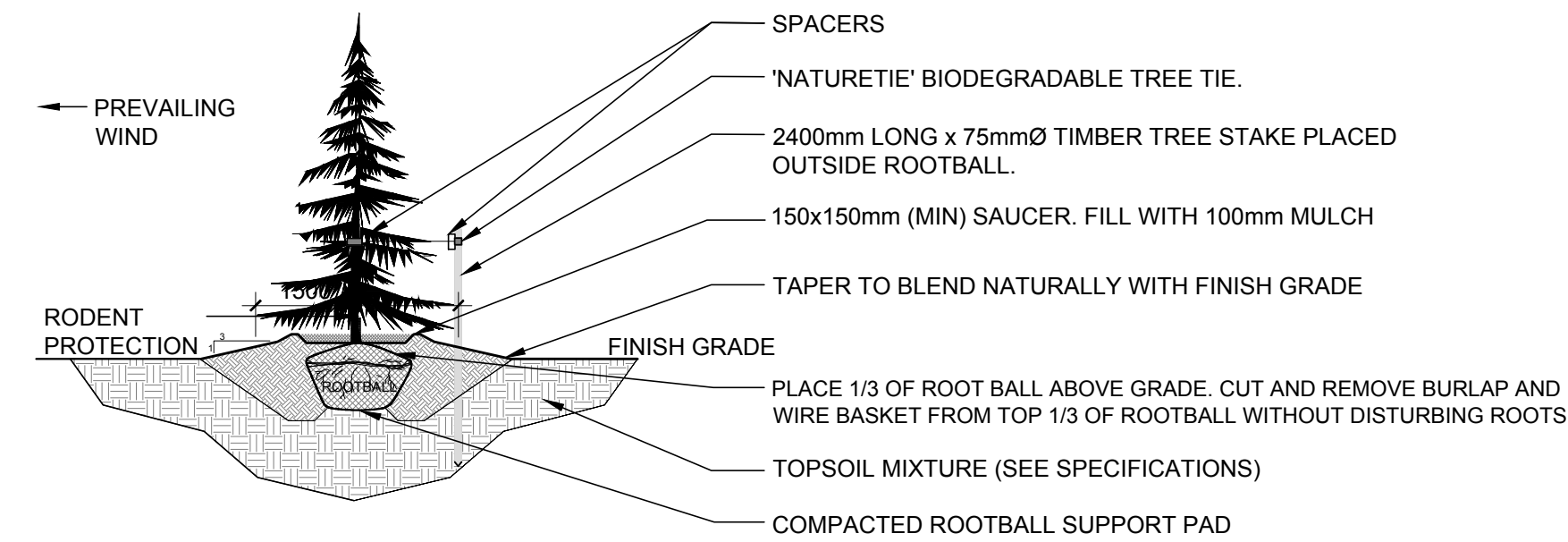
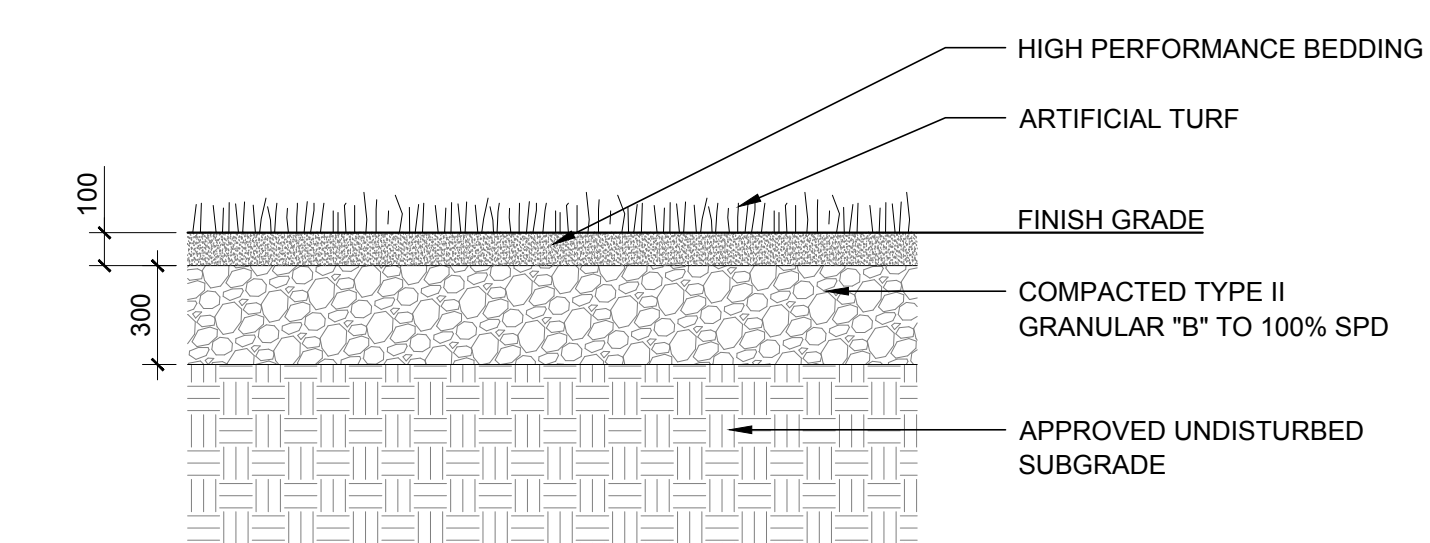
2 DECIDUOUS TREE PLANTING  
SCALE: NTS3 CONIFEROUS TREE PLANTING  
SCALE: NTS6 CUSTOM SECONDARY ENTRANCE PRECAST CONCRETE PAVER PATTERN  
SCALE: NTS5 ARTIFICIAL TURF  
SCALE: NTS4 SHRUB AND PERENNIAL PLANTING  
SCALE: NTS1 LANDSCAPE PLAN  
SCALE: 1:500

## GENERAL NOTES

- IT IS THE RESPONSIBILITY OF THE APPROPRIATE CONTRACTOR OR OFFICIAL TO REPORT ANY ERRORS, OMISSIONS OR DISCREPANCIES ON THIS PLAN WITH ACTUAL SITE CONDITIONS TO THE LANDSCAPE ARCHITECT BEFORE PROCEEDING WITH CONSTRUCTION.
- THE CONTRACTOR IS TO NOTIFY ALL UTILITY COMPANIES AND AUTHORITIES PRIOR TO ANY EXCAVATION AND ASCERTAIN LOCATIONS OF UNDERGROUND SERVICES.
- THE CONTRACTOR IS TO REINSTATE ALL AREAS AND ITEMS DAMAGED AS A RESULT OF CONSTRUCTION ACTIVITY.
- THE CONTRACTOR IS TO COMPLY WITH ALL PERTINENT CODES AND BY LAWS.
- THE CONTRACTOR IS TO MAINTAIN A POSITIVE SURFACE RUN-OFF THROUGHOUT THE ENTIRE CONSTRUCTION PERIOD.
- THE LANDSCAPE ARCHITECT IS NOT RESPONSIBLE FOR SUBSURFACE CONDITIONS.
- THE CONTRACTOR IS TO IDENTIFY ALL EXISTING TREES TO REMAIN ON SITE WITH THE LANDSCAPE ARCHITECT PRIOR TO CONSTRUCTION.
- THE CONTRACTOR IS TO STAKE THE PROPOSED LOCATION OF ALL PLANT MATERIAL IN CONJUNCTION WITH THE LANDSCAPE ARCHITECT PRIOR TO CONSTRUCTION.
- MINIMUM DISTANCES FOR SELECTED DECIDUOUS TREES ARE AS FOLLOWS:
  - 9.1. BUILDING FOUNDATIONS - 7.5M
  - 9.2. SIDEWALKS - 1.5M
  - 9.3. PUBLIC STREETS - 2.5M
  - 9.4. UNDERGROUND INFRASTRUCTURE - 2.0M
- ALL TREES WITHIN 1M OF UNDERGROUND UTILITY TRENCHES ARE TO BE EXCAVATED BY HAND.
- REMOVE ALL PROTECTIVE WRAPPINGS FROM TREE TRUNKS AFTER INSTALLATION.
- STAKING OF TREES SHALL ONLY BE PERFORMED IF NECESSARY.
- ENSURE THAT MULCH IS PULLED BACK A MINIMUM DISTANCE OF 75MM FROM BASE OF TREE TRUNK.

10 17/09/2025 REVISED AS PER CDD FORESTRY COMMENTS CAT

9 11/09/2025 ISSUED FOR ADDENDUM ML

8 09/03/2025 REVISED PER CITY COMMENTS ML

7 31/07/2025 ISSUED FOR PERMIT LC

6 07/07/2025 ISSUED FOR 99% CLIENT REVIEW LC

5 13/06/2025 ISSUED FOR SITE PLAN CONTROL LC

4 02/06/2025 REVISED AS PER COMMENTS CAT

3 09/05/2025 ISSUED FOR 66% CLIENT REVIEW LC

2 04/04/2025 ISSUED FOR SITE PLAN CONTROL LC

1 14/03/2025 ISSUED FOR 33% CLIENT REVIEW LC

no. date revision / issue by

grc architects  
A PROVENCHER ROY COMPANY  
47 Clarence Street, Suite 401  
Ottawa, Ontario K1N 9K1  
Tel: (613) 722-5168 Fax: (613) 722-5168  
info@grcarchitects.com www.grcarchitects.com

consultant  
JAMES B. LENOX & ASSOCIATES INC.  
LANDSCAPE ARCHITECTS  
312 CARRINGTON AVE. OTTAWA, ONTARIO K2H 6M8  
Tel: (613) 722-5168 Fax: (613) 722-5168

professional stamp  
N  
W E S  
J.B. LENOX  
LANDSCAPE ARCHITECT  
ON

project title  
NEW CATHOLIC HIGH SCHOOL RIVERSIDE SOUTH  
675 Borbridge Ave. Ontario

drawing title  
LANDSCAPE PLAN

date SEPTEMBER, 2024 job no. 24GRC2437  
scale 1 : 500  
drawn LC  
approved JL  
plot date JUNE 6<sup>th</sup>, 2025  
file no. 007-12-25-0045 plan no. #19337

DO NOT SCALE FROM THIS DRAWING  
2. CONTRACTOR TO VERIFY ALL DIMENSIONS AND NOTIFY THE ARCHITECT OF ANY DISCREPANCIES BEFORE WORK COMMENCES  
3. THIS DRAWING TO BE READ IN CONJUNCTION WITH THE FOLLOWING DRAWINGS: STRUCTURAL, MECHANICAL, ELECTRICAL