



SCHEDULE OF CONTROLLED ROOF RELEASE RATES					
DRAINAGE AREA ID	DRAIN TYPE	# DRAINS	100 YEAR HEAD [m]	100 YEAR RELEASE RATE [L/s]	
BLDG (1030m ² CONTROLLED PORTION OF ROOF)	WATTS ACCUTROL (CLOSED)	9	0.134	5.68	

SEWER AND WATERMAIN CROSSING TABLE									
CROSSING	STM INV	STM OBV	SAN INV	SAN OBV	WTR TOP	WTR BTM	ABANDONED WTR TOP	ABANDONED WTR BTM	NOTES
1	±68.92 [68.82]	±69.52 [69.62]	67.43	67.68					
2			67.50	67.75	±69.15	±68.85			
3	69.65	69.95			±69.15	±68.85			
4	69.88	70.18	67.78	68.03					
5	69.93	70.23			69.35	69.20			
6	69.69	69.99					69.10	68.95	CONTRACTOR TO CONFIRM EX. ABANDONED WATERMAIN LOCATION AND ELEVATION AND REMOVE IF CONFLICTING WITH PROPOSED SERVICE.
7			67.58	67.83			69.15	69.00	CONTRACTOR TO CONFIRM EX. ABANDONED WATERMAIN LOCATION AND ELEVATION AND REMOVE IF CONFLICTING WITH PROPOSED SERVICE.
8					68.95	68.80	69.20	69.05	CONTRACTOR TO CONFIRM EX. ABANDONED WATERMAIN LOCATION AND ELEVATION AND REMOVE IF CONFLICTING WITH PROPOSED SERVICE.

* BRACKETS DENOTE ADJUSTED VALUE WITH CONCRETE PIPE THICKNESS

GENERAL NOTES

- ALL WORK SHALL BE CARRIED OUT IN COMPLIANCE WITH THE ONTARIO OCCUPATIONAL HEALTH AND SAFETY ACT AND REGULATIONS FOR CONSTRUCTION PROJECTS.
- ALL WORK AND MATERIALS TO CONFORM WITH CURRENT MINISTRY OF THE ENVIRONMENT & ENERGY OF ONTARIO, CITY OF OTTAWA AND ONTARIO PROVINCIAL STANDARDS AND SPECIFICATIONS. LOCAL UTILITY STANDARDS AND MINISTRY OF TRANSPORTATION STANDARDS WILL APPLY WHERE REQUIRED.
- THE CONTRACTOR IS ADVISED THAT WORKS BY OTHERS MAY BE ONGOING DURING THE PERIOD OF THIS CONTRACT. THE CONTRACTOR SHALL COORDINATE CONSTRUCTION ACTIVITIES AND COORDINATION WITH ALL OTHER CONTRACTORS AND PREVENT CONSTRUCTION CONFLICTS.
- THE INFORMATION SHOWN FOR EXISTING SERVICES AND UTILITIES WAS PROVIDED BY OTHERS. THE CONTRACTOR IS RESPONSIBLE FOR LOCATING AND PROTECTING ALL SERVICES AND UTILITIES DURING CONSTRUCTION. ALL EXISTING UTILITIES MUST BE LOCATED AND VERIFIED BY EACH UTILITY PRIOR TO COMMENCEMENT OF WORK. ANY VARIANCE IS TO BE IMMEDIATELY REPORTED TO THE ENGINEER. LOST TIME DUE TO FAILURE OF THE CONTRACTOR TO CONFIRM SERVICE AND UTILITY LOCATIONS AND NOTIFY THE ENGINEER OF POSSIBLE CONFLICTS PRIOR TO CONSTRUCTION WILL BE AT THE CONTRACTORS EXPENSE.
- ALL CONSTRUCTION SHALL BE CARRIED OUT IN ACCORDANCE WITH THE RECOMMENDATIONS MADE IN THE GEOTECHNICAL REPORT.
- THE CONTRACTOR IS RESPONSIBLE FOR OBTAINING ALL PERMITS REQUIRED AND TO BEAR THE COST OF SAME INCLUDING WATER PERMIT AND ASSOCIATED COSTS.
- ALL DISTURBED AREAS SHALL BE REINSTATED TO EQUAL OR BETTER CONDITION TO THE SATISFACTION. THE ENGINEER AND THE CITY OF OTTAWA. PAYMENT REINSTATEMENT FOR SERVICE AND UTILITY CUTS SHALL BE IN ACCORDANCE WITH CITY OF OTTAWA STANDARD R10, OPSD 509.010 AND OPSD 310.
- BENCHMARKS: IT IS THE RESPONSIBILITY OF THE CONTRACTOR TO VERIFY THAT THE SITE BENCHMARK(S) HAS NOT BEEN ALTERED OR DISTURBED AND THAT ITS RELATIVE ELEVATION AND DESCRIPTION AGREES WITH THE INFORMATION SHOWN ON DRAWING GP-1.
- THE CONTRACTOR SHALL PROVIDE TO THE ENGINEER 1 [ONE] SET OF AS CONSTRUCTED SITE SERVING, GRADING, AND SITE ELECTRICAL DWGS.
- CONTRACTOR TO LOCATE EXISTING SERVICE LATERALS PRIOR TO CONSTRUCTION. EXISTING STORM AND SANITARY SERVICE LATERALS TO BE ABANDONED PER S11.4. EXISTING WATER SERVICE TO BE BLANKED AT THE MAIN (TYP.)
- TOPOGRAPHIC SURVEY SUPPLIED BY ANNIS, O'SULLIVAN, VOLLEBEK LTD. PROJECT NO. 24453-23. TOPOGRAPHIC PLAN OF SURVEY PART OF LOT 18 REGISTERED PLAN 217 CITY OF OTTAWA DATED NOVEMBER 19, 2024.
- SITE PLAN PREPARED BY RODERICK LAHEY ARCHITECT INC. DATED AUGUST 19, 2025.
- GEOTECHNICAL INVESTIGATION P05770-1 PREPARED BY PATERSON GROUP DATED FEBRUARY 3, 2025. GEOTECHNICAL INFORMATION PRESENTED ON THESE DRAWINGS MAY BE INTERPOLATED FROM THE ORIGINAL REPORT. REFER TO ORIGINAL GEOTECHNICAL REPORT FOR ADDITIONAL DETAILS AND TO VERIFY ASSUMPTIONS MADE HERE.

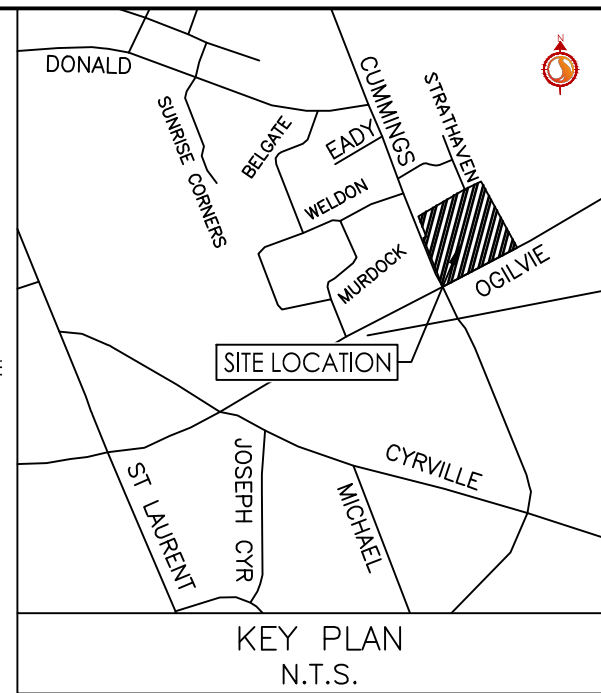

Stantec Consulting Ltd.
400 - 1331 Clyde Avenue
Ottawa ON
Tel. 613.722.4420
www.stantec.com

Copyright Reserved

The Contractor shall verify and be responsible for all dimensions. DO NOT scale the drawing - any errors or omissions shall be reported to Stantec without delay.
The Copyrights to all designs and drawings are the property of Stantec. Reproduction or use for any purpose other than that authorized by Stantec is forbidden.

Legend

- PROPOSED WATERMAIN
- PROPOSED VALVE AND VALVE BOX
- PROPOSED VALVE CHAMBER
- PROPOSED W3 CHAMBER
- PROPOSED REDUCER
- PROPOSED FIRE HYDRANT
- PROPOSED SANITARY SEWER
- PROPOSED STORM SEWER
- PROPOSED CATCHBASIN MANHOLE
- PROPOSED CATCHBASIN
- EXISTING WATERMAIN
- EXISTING VALVE AND VALVE BOX
- EXISTING VALVE CHAMBER
- EXISTING REDUCER
- EXISTING FIRE HYDRANT
- EXISTING COMBINED SEWER
- EXISTING STORM SEWER
- EXISTING CATCHBASIN MANHOLE
- EXISTING CATCHBASIN
- PROPOSED DEPRESSURE CURB LOCATIONS
- PROPOSED BARRIER CURB
- THERMAL INSULATION ON STORM SEWER WHERE COVER IS LESS THAN 2.0m AS PER S35. THERMAL INSULATION ON WATERMAIN WHERE COVER IS LESS THAN 2.4m AS PER W22.
- WATER METER
- REMOTE WATER METER
- APPROX. LOCATION OF CONTROLLED ROOF DRAIN AS PER ARCHITECTURAL PLANS PREPARED BY RLA ARCHITECTURE
- APPROX. LOCATION OF SCUPPERS WITHIN ROOFTOP STORM WATER STORAGE AREAS AS PER ARCHITECTURAL PLANS PREPARED BY RLA ARCHITECTURE

Notes

- ALL AREA AND TRENCH DRAINS TO BE CONNECTED TO INTERNAL PLUMBING AND COLLECTED IN STORM WATER MANAGEMENT CISTERN, DESIGN AND INSTALLATION BY OTHERS.
- FINAL SERVICE LATERAL SIZE, LOCATION AND ELEVATION AND METER AND REMOTE METER LOCATIONS TO BE CONFIRMED BY MECHANICAL CONSULTANT.
- SUMP PUMP REQUIRED TO DISCHARGE INTERNAL STORM AND SANITARY SEWERS. TO BE DESIGNED BY THE MECHANICAL CONSULTANT.
- STORMWATER MANAGEMENT TO BE PROVIDED THROUGH A CISTERN LOCATED IN THE UNDERGROUND PARKING.
- BOOSTER PUMPS TO BE PROVIDED TO MAINTAIN MINIMUM PRESSURES FOR TOWERS 6-STORIES AND HIGHER.
- FLOOR DRAINS LOCATED INSIDE PARKING GARAGE TO BE CONNECTED TO BUILDING INTERNAL SANITARY SEWER.
- USF TO BE CONFIRMED BY THE STRUCTURAL CONSULTANT.

Revision	By	Appd.	YY.MM.DD
3	WAJ	KJK	25.08.29
2	WAJ	KJK	25.08.22
1	WAJ	KJK	25.04.16

File Name:	160402095-DB-1137 Oglvie.dwg	WAJ	KJK	WAJ	25.04.08
		Dwn.	Chkd.	Dsgn.	YY.MM.DD

Permit-Seal

Client/Project

TC UNITED DEVELOPMENT CORPORATION

1137 OGLVIE ROAD

OTTAWA, ON

Title

SITE SERVING PLAN

Project No.	Scale	0	2.5	7.5	12.5m
160402095	1:250				
Drawing No.	Sheet	Revision			

SSP-1

2 of 7

3

PLAN # 19283

D07-12-25-0054