

M:\2018\118224\CAD\Design\Medium\Detail\118224-PR-4D.dwg, PR1, Aug 15, 2025 - 12:31am, bundle

NOTE:  
THE POSITION OF ALL POLE LINES, CONDUITS,  
WATERMAINS, SEWERS AND OTHER  
UNDERGROUND AND OVERGROUND UTILITIES AND  
STRUCTURES IS NOT NECESSARILY SHOWN ON  
THE CONTRACT DRAWINGS, AND WHERE SHOWN,  
THE ACCURACY OF THE POSITION OF SUCH  
UTILITIES AND STRUCTURES IS NOT GUARANTEED.  
BEFORE STARTING WORK, DETERMINE THE EXACT  
LOCATION OF ALL SUCH UTILITIES AND  
STRUCTURES AND ASSUME ALL LIABILITY FOR  
DAMAGE TO THEM.

PROPOSED ELEVATION	90.52	90.93	91.10	90.94	90.93	90.99	90.84	90.85	91.05	91.10	90.86	91.00	90.89	90.86	90.85	90.87	90.75
TOP OF WM	87.84	88.34	88.53	88.70	88.54	88.53	88.59	88.64	88.65	88.70	88.65	88.63	88.60	88.59	88.57	88.49	88.56
STORM SEWER INVERTS		SW=89.13 SE=88.78			41.4m - 300mmØ STM @ 0.34%	SW=89.06 SE=88.52	8.2m - 200mmØ SAN @ 0.50%	SW=88.81 SE=88.31	19.2m - 300mmØ STM @ 0.34%	SW=88.78 SE=88.31	10.0m - 300mmØ STM @ 0.50%	SW=88.55 SE=88.07	39.9m - 300mmØ STM @ 0.34%	SW=88.01 SE=88.09	14.0m - 375mmØ STM @ 0.30%	SW=88.43 SE=88.21	
SANITARY SEWER INVERTS		SW=88.78			39.9m - 200mmØ SAN @ 0.65%	SW=88.52 SE=88.06	8.2m - 200mmØ SAN @ 0.50%	SW=88.81 SE=88.31	17.9m - 200mmØ SAN @ 0.34%	SW=88.36 SE=88.01	8.8m - 200mmØ SAN @ 0.50%	SW=88.29 SE=88.01	37.9m - 200mmØ SAN @ 0.32%	SW=88.14 SE=88.09			
EXISTING ELEVATION	90.42	90.81	90.87	90.54	90.54	90.54	90.54	90.54	90.20	90.54	90.54	90.54	90.54	90.54	90.54	90.54	90.54
CHAINAGE	1+000	1+072.62 TEE	1+020.09 DWA	1+020.09 SANMH 109	1+025	1+050	1+062.12 STMMH 108	1+062.11 HEEND	1+071.47 HEEND	1+075	1+090.55 STMMH 104	1+090.53 HEEND	1+093.75 TEE&HYD	1+097.18 TEE	1+100.57 CAP	1+100.57 STMMH 102	1+150

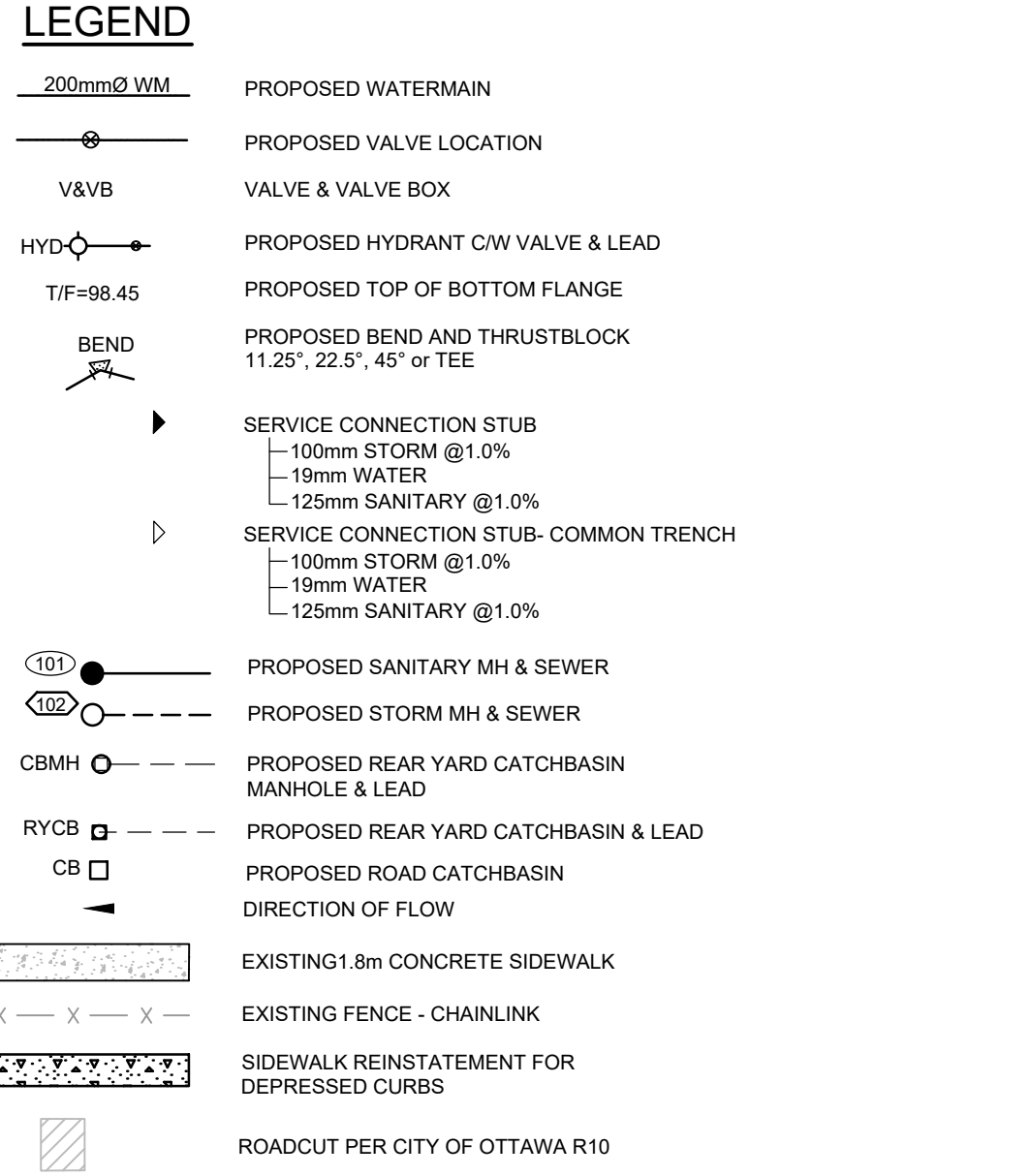
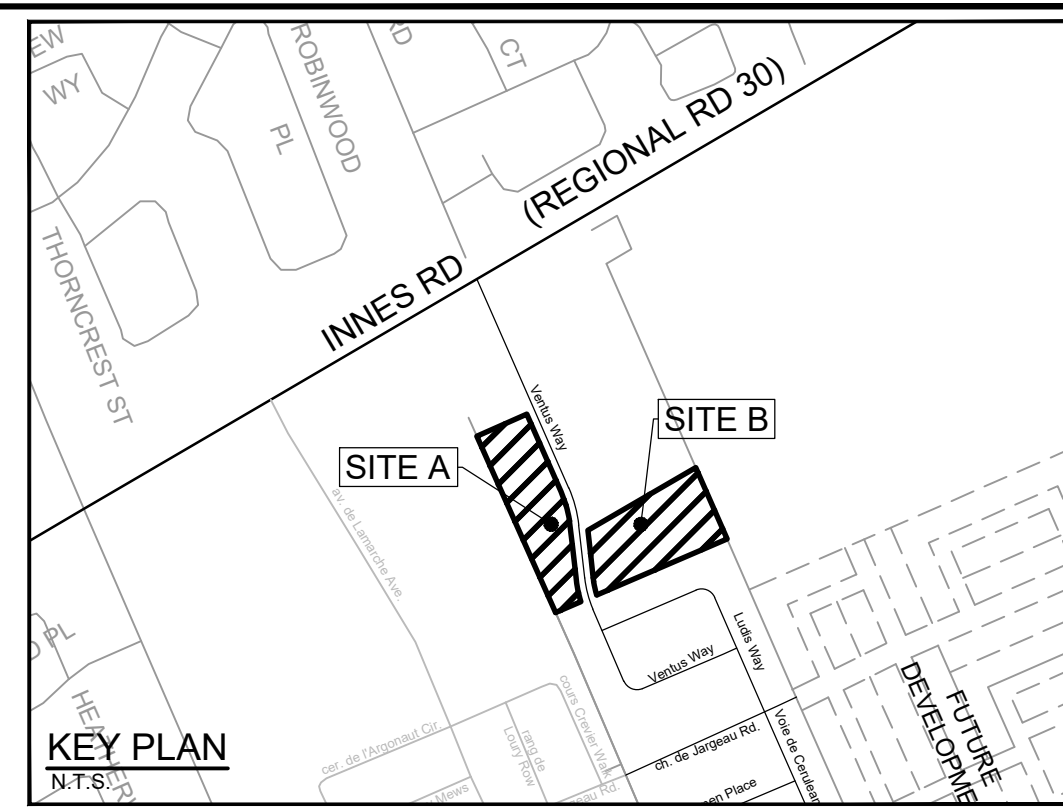
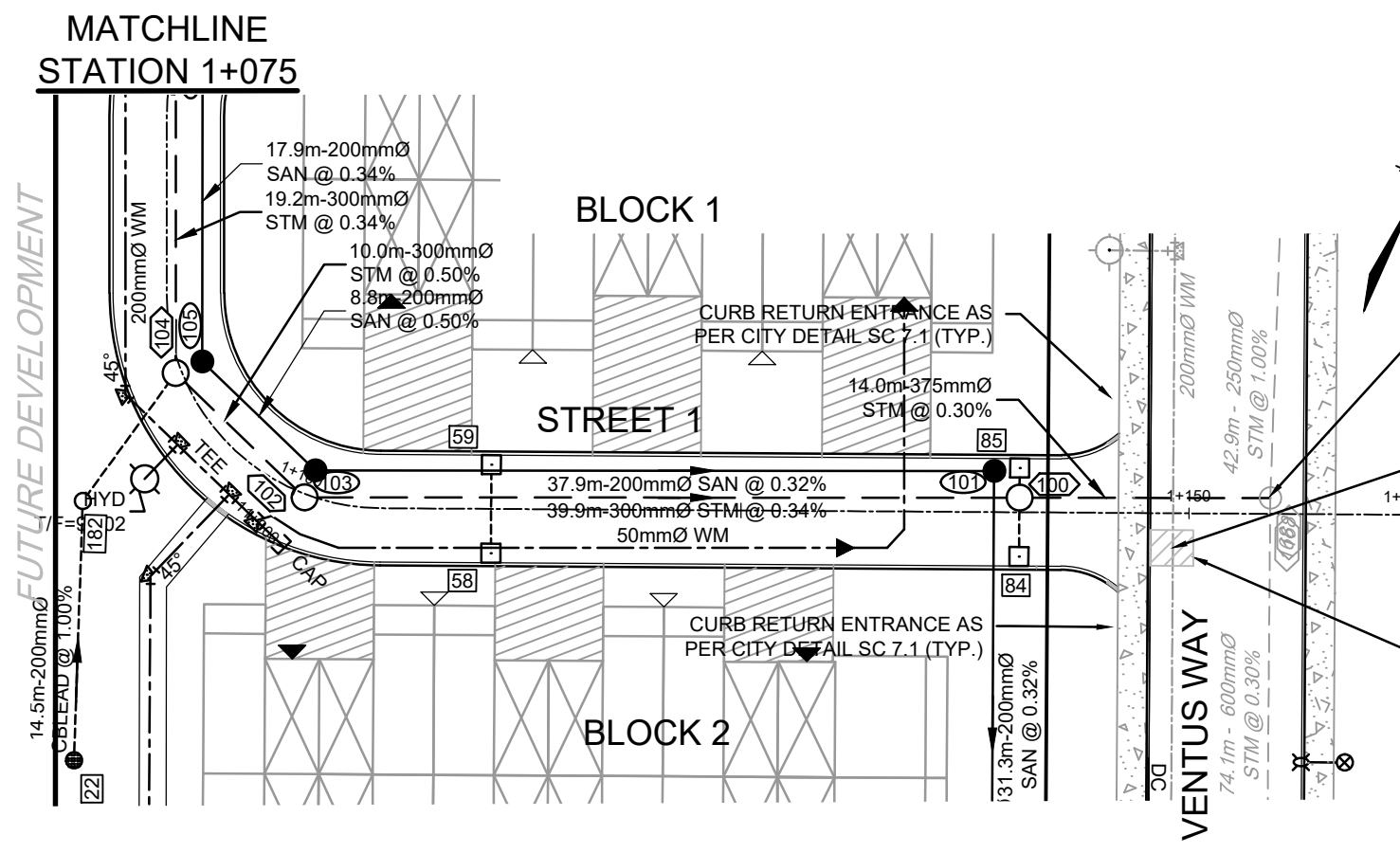
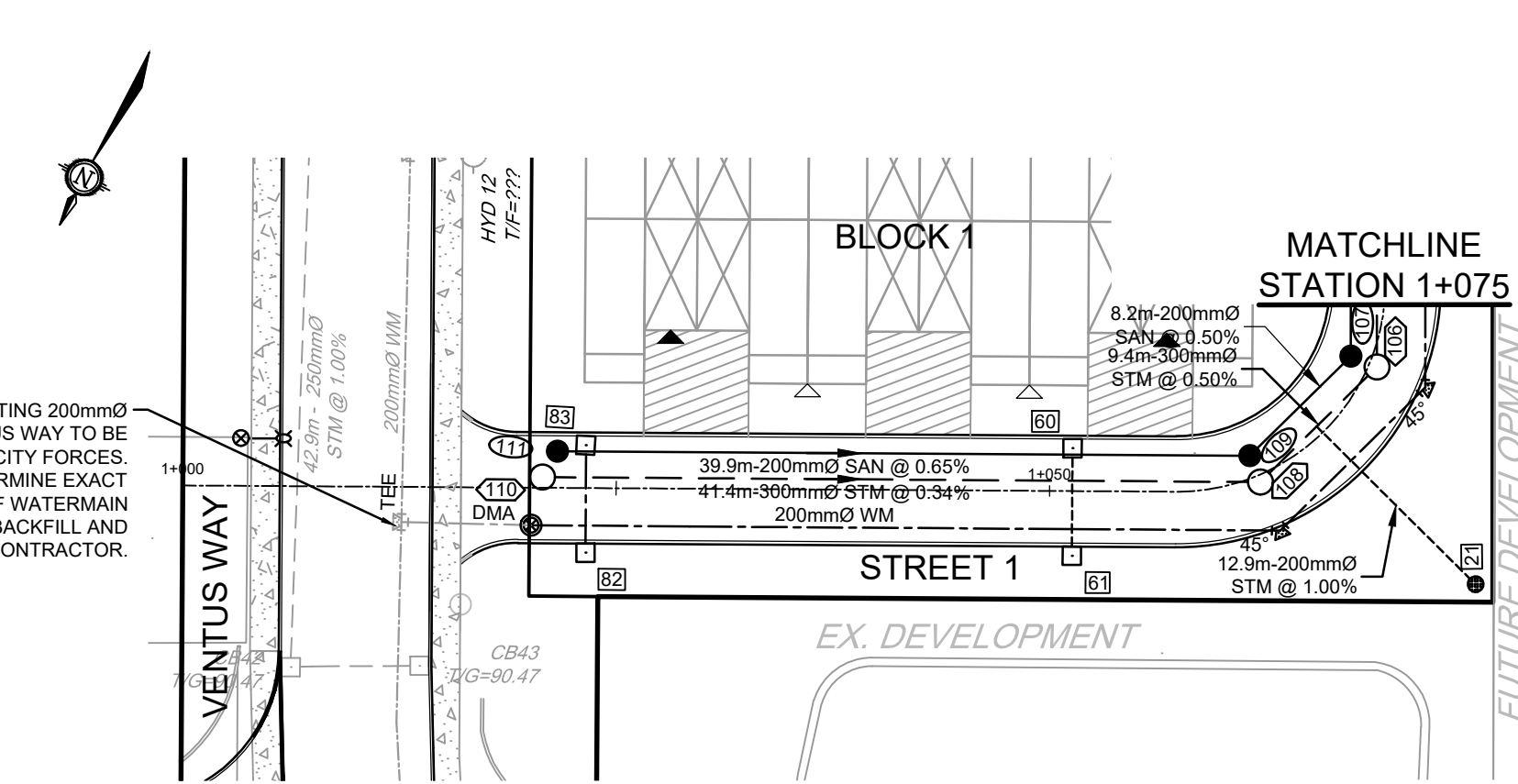
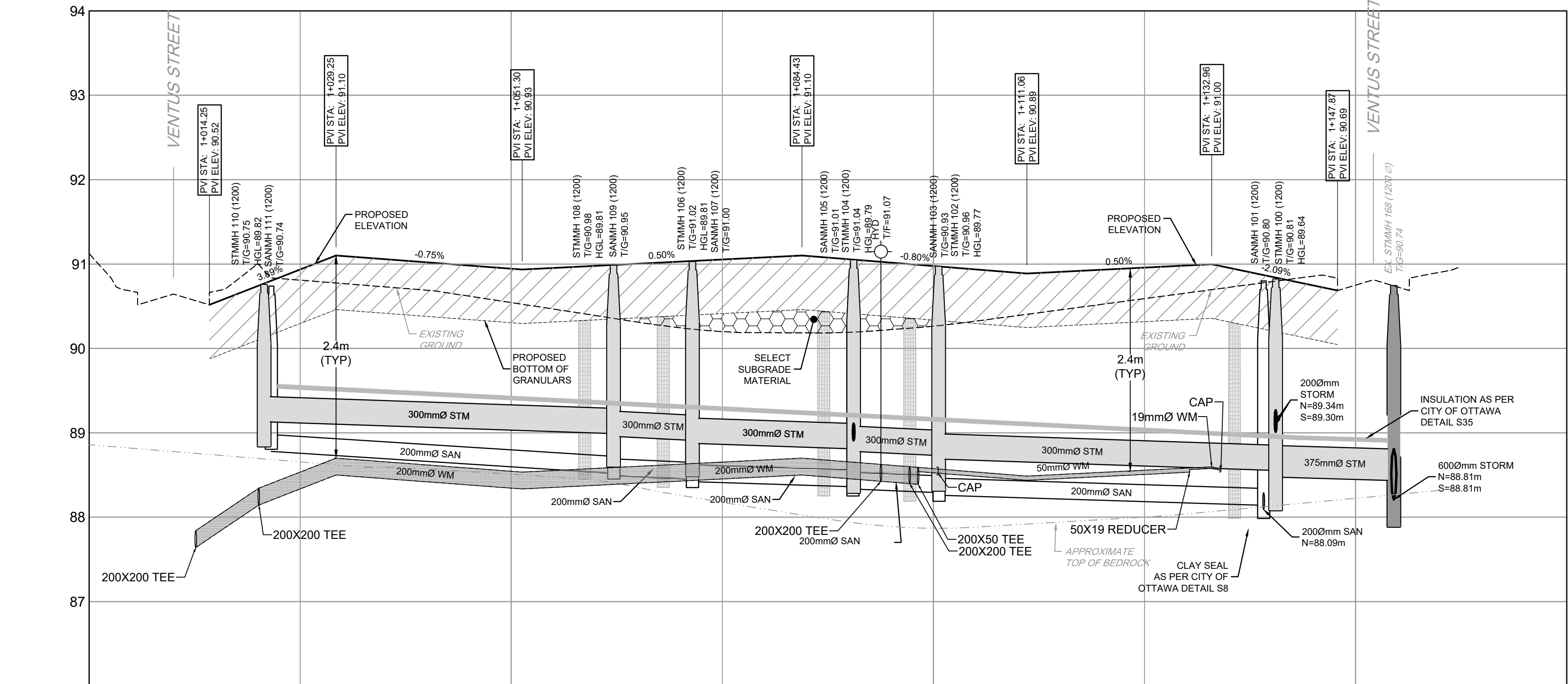

NOTE:  
DURING SERVICING, GRADING, AND REINSTATEMENT WORKS, TIE INTO EXISTING ELEVATIONS AND ELIMINATE ENCROACHMENT INTO ADJACENT PROPERTY LANDS, WHERE POSSIBLE. PERMISSION REQUIRED FOR WORKS ON ADJACENT PROPERTY LANDS. USE PROTECTION FENCING AND BEST EFFORTS TO REDUCE IMPACT TO ADJACENT LANDS' EXISTING FEATURES INCLUDING, BUT NOT LIMITED TO, RETAINING WALLS, FENCES, HARD AND SOFT LANDSCAPE. ANY DISTURBED AREA IS TO BE REINSTATED TO EXISTING CONDITIONS OR BETTER, TO THE SATISFACTION OF PROPERTY OWNER AND CITY.

No.	REVISION	DATE	BY
3.	REVISED PER CITY COMMENTS	AUG 15/25	MS
2.	REVISED PER CITY COMMENTS	MAR 5/25	MS
1.	ISSUED FOR DISCUSSION	NOV 1/24	BHB

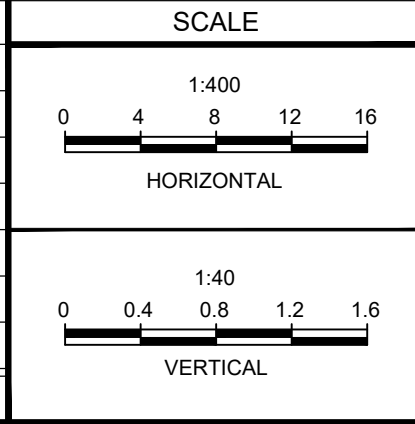

DESIGN	BR
CHECKED	MS
DRAWN	BR
CHECKED	MS
APPROVED	BHB

**FOR REVIEW ONLY**

**PROFESSIONAL ENGINEER**

**B. P. RUNDLE**

**100527529**

**Aug 15, 2025**

**PROVINCE OF ONTARIO**

**NOVATECH**

Engineers, Planners & Landscape Architects

Suite 200, 240 Michael Cowpland Drive  
Ottawa, Ontario, Canada K2M 1P6

Telephone: (613) 254-9643  
Facsimile: (613) 254-5867  
Website: novatech-eng.com

LOCATION CITY OF OTTAWA THE COMMONS - PHASE 4	PROJECT No. 118224-MD
DRAWING NAME PLAN AND PROFILE STREET 1 STATION 1+000 TO 1+175	REV REV # 3
	DRAWING No. 118224-MD-PR1

D07-12-24-0141