

OPTION 1: TEMPORARY VEHICULAR TRAFFIC THROUGH LAMARCHE AVANEUE  
1:1000

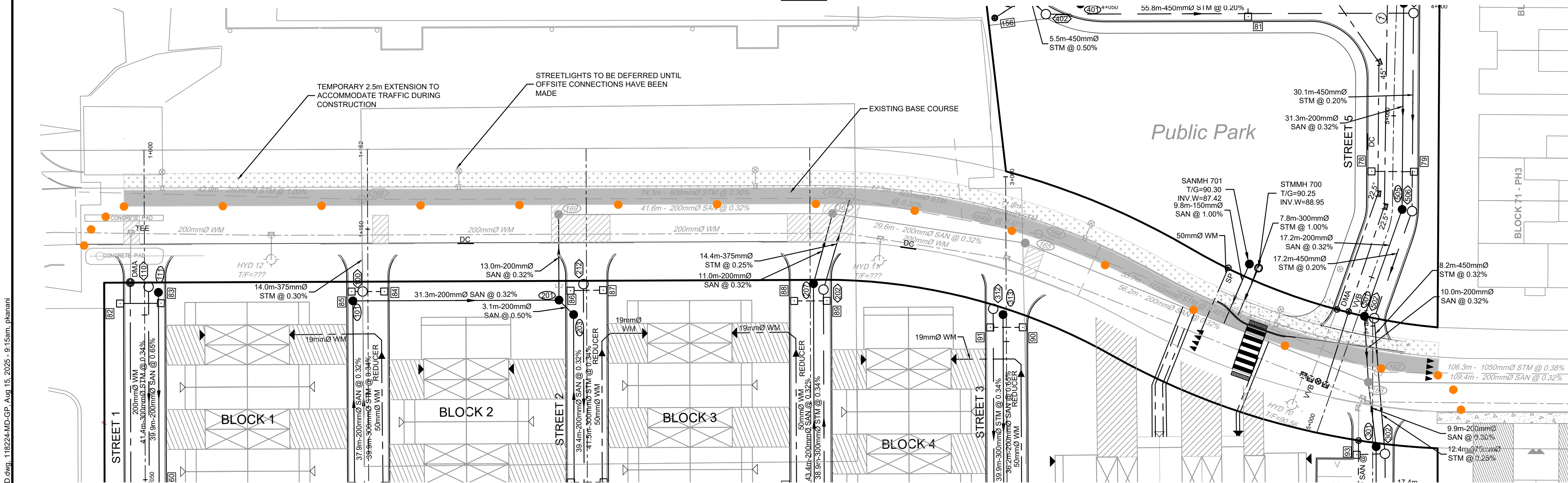

OPTION 2: TEMPORARY TRAFFIC DIVERSION ON VENTUS WAY

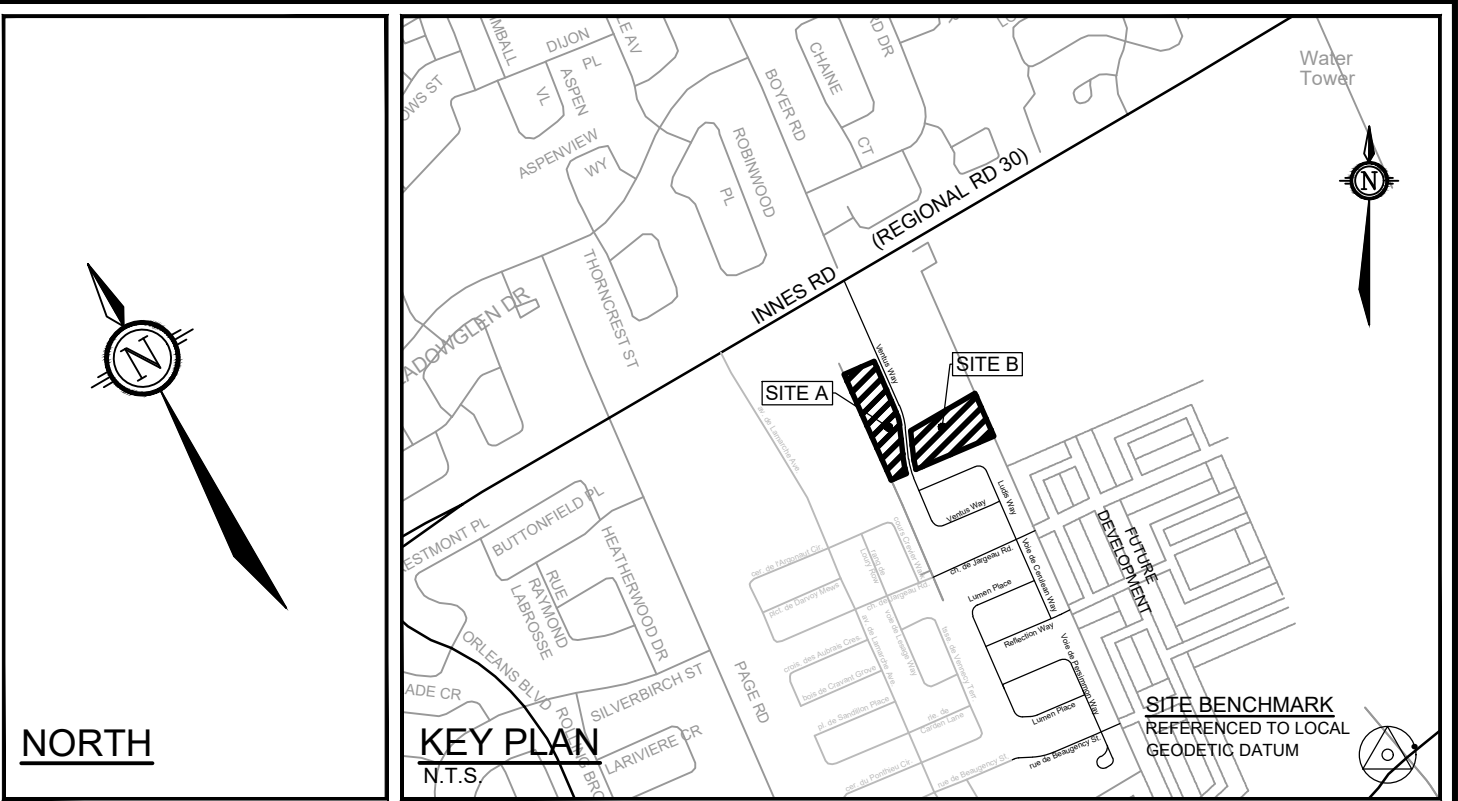

LEGEND

- 200mmØ WM PROPOSED WATERMAIN
- PROPOSED VALVE LOCATION
- V&VB VALVE & VALVE BOX
- V&VC VALVE & VALVE CHAMBER
- HYD T/F=98.45 PROPOSED HYDRANT CW VALVE & LEAD
- T/F=98.45 PROPOSED TOP OF BOTTOM FLANGE
- BEND PROPOSED BEND AND THRUSTBLOCK 11.25°, 22.5°, 45° or TEE (SEE PLAN AND PROFILES)
- PROPOSED SANITARY MH & SEWER
- PROPOSED STORM MH & SEWER
- PROPOSED LANDSCAPE TEE CATCHBASIN & PERFORATED SUBDRAIN
- PROPOSED LANDSCAPE ELBOW CATCHBASIN & PERFORATED SUBDRAIN
- PROPOSED REAR YARD CATCHBASIN MANHOLE & LEAD
- PROPOSED REAR YARD CATCHBASIN & LEAD
- FENCE - PRIVACY
- FENCE - CHAINLINK
- FENCE - POST AND RAIL
- SERVICE CONNECTION STUB
  - 100mm STORM @1.0%
  - 19mm WATER
  - 125mm SANITARY @1.0%
- SERVICE CONNECTION STUB- COMMON TRENCH
  - 100mm STORM @1.0%
  - 19mm WATER
  - 125mm SANITARY @1.0%
- PROPOSED ROAD CATCHBASIN
- DIRECTION OF FLOW
- ROADCUT PER CITY OF OTTAWA R10
- EXISTING BASE COURSE
- TEMPORARY EXTENSION OF BASE COURSE
- TRAFFIC CONES

PRELIMINARY CONSTRUCTION MANAGEMENT CHECKLIST	
WILL CONSTRUCTION REQUIRE THE DETOUR OF A BUS ROUTE?	NO
WILL THIS WORK BLOCK A BIKE LANE?	NO
WILL THIS WORK BLOCK A SIDEWALK?	NO
WILL THIS WORK REQUIRE A TRAFFIC LANE TO BE CLOSED?	YES

CMP NOTES:

- TRAFFIC CONTROL PLAN WILL BE PREPARED FOR THIS SITE PRIOR TO COMMENCEMENT OF CONSTRUCTION AND ALL NECESSARY ENCROACHMENTS WILL BE COORDINATED WITH THE CITY OF OTTAWA.

NOTE:  
THE POSITION OF ALL POLE LINES, CONDUITS, WATERMANS, SEWERS AND OTHER UNDERGROUND AND OVERGROUND UTILITIES AND STRUCTURES IS NOT NECESSARILY SHOWN ON THE CONTRACT DRAWINGS, AND WHERE SHOWN, THE ACCURACY OF THE POSITION OF SUCH UTILITIES AND STRUCTURES IS NOT GUARANTEED. BEFORE STARTING WORK, DETERMINE THE EXACT LOCATION OF ALL SUCH UTILITIES AND STRUCTURES AND ASSUME ALL LIABILITY FOR DAMAGE TO THEM.

PRELIMINARY

No.	REVISION	DATE	BY
2.	REVISED PER CITY COMMENTS	AUG 15/25	BR
1.	ISSUED FOR CITY REVIEW	NOV 1/24	MS

SCALE

1:400

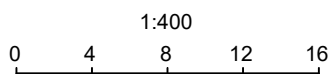

DESIGN

CV/MS

CHECKED

MS

DRAWN

CV

CHECKED

MS

APPROVED

BHB

FOR REVIEW ONLY



NOVATECH

Engineers, Planners & Landscape Architects  
Suite 200, 240 Michael Cowpland Drive  
Ottawa, Ontario, Canada K2M 1P6

Telephone (613) 254-9643  
Facsimile (613) 254-5867  
Website www.novatech-eng.com

LOCATION  
CITY OF OTTAWA  
THE COMMONS - PHASE 4

DRAWING NAME  
CONSTRUCTION MANAGEMENT  
PLAN

PROJECT No.

118224-MD

REV

REV # 2

DRAWING No.

18224-CMP-MD