

CLIENT

Killam
PROPERTIES INC

COPYRIGHT

This drawing has been prepared solely for the intended use, thus any reproduction or distribution for any purpose other than authorized by Arcadis is forbidden. Written dimensions shall have precedence over scaled dimensions. Contractors shall verify and be responsible for all dimensions and conditions on the job, and Arcadis shall be informed of any variations from the dimensions and conditions shown on the drawing. Shop drawings shall be submitted to Arcadis for general conformance before proceeding with fabrication.

Arcadis Professional Services (Canada) Inc.

formerly (B) Group Professional Services (Canada) Inc.

ISSUES		
No.	DESCRIPTION	DATE
1	ISSUED FOR SPRA	2025-08-21

CONSULTANTS

1:250

0 5 10 12.5m

SEAL

T. R. BRULE
2025/08/21
PROVINCE OF ONTARIO

PRIME CONSULTANT

ARCADIS

333 Preston Street - Suite 500
Ottawa ON K1S 5N4 Canada
tel 613 225 1311
www.arcadis.com

PROJECT

KILLAM - CITY PARK PHASE 2
INTERIM PARKING

200 FRONTIER PATH PVT.

PROJECT NO:

38729

DRAWN BY:

D.D. / E.H.

CHECKED BY:

M.P.

PROJECT MGR:

T.R.B.

APPROVED BY:

T.R.B.

SHEET TITLE

GENERAL SERVICING PLAN

SHEET NUMBER

C-103

ISSUE

1

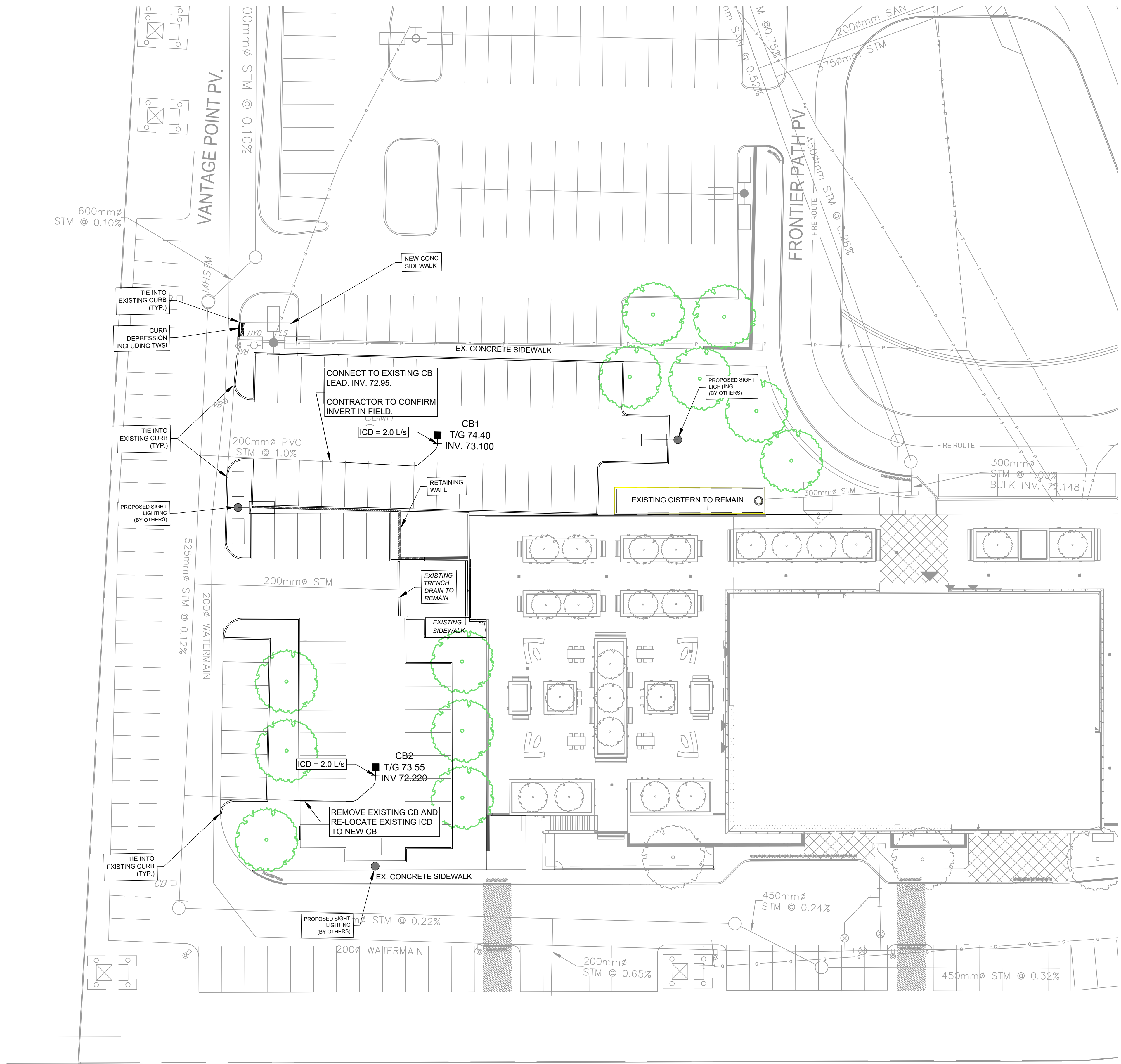

File Location: J:\38729-SilverCity\CA\5.9 Drawings\59\Current\Parking\SheetC-103 SERVICING PLAN.dwg Last Saved: August 15, 2025, by bared5754 Plotted: August 15, 2025 9:40:51 AM by Dore, Denis D07-xx-xx-xxxx