

GRADING NOTES:

- ALL TOPSOIL, ORGANIC OR DELETERIOUS MATERIAL MUST BE ENTIRELY REMOVED FROM BENEATH THE PROPOSED PAVED AREAS AS DIRECTED BY THE SITE ENGINEER OR GEOTECHNICAL ENGINEER.
- EXPOSED SUBGRADES IN PROPOSED PAVED AREAS SHOULD BE PROOF ROLLED WITH A LARGE STEEL DRUM ROLLER AND INSPECTED BY THE GEOTECHNICAL ENGINEER PRIOR TO THE PLACEMENT OF GRANULARS.
- ANY SOFT AREAS EVIDENT FROM THE PROOF ROLLING SHOULD BE SUB-EXCAVATED AND REPLACED WITH SUITABLE MATERIAL THAT IS FROST COMPATIBLE WITH THE EXISTING SOILS AS RECOMMENDED BY THE GEOTECHNICAL ENGINEER.
- THE GRANULAR BASE SHOULD BE COMPACTED TO AT LEAST 100% OF THE STANDARD PROCTOR MAXIMUM DRY DENSITY VALUE. ANY ADDITIONAL GRANULAR FILL USED BELOW THE PROPOSED PAVEMENT SHOULD BE COMPACTED TO AT LEAST 95% OF THE STANDARD PROCTOR MAXIMUM DRY DENSITY VALUE.
- MINIMUM OF 2% GRADE FOR ALL GRASS AREAS UNLESS OTHERWISE NOTED.
- MAXIMUM TERRACING GRADE TO BE 3:1 UNLESS OTHERWISE NOTED.
- ALL GRADES BY CURBS ARE EDGE OF PAVEMENT GRADES UNLESS OTHERWISE INDICATED.
- ALL CURBS SHALL BE BARRIER CURB (150mm) UNLESS OTHERWISE NOTED AND CONSTRUCTED AS PER CITY OF OTTAWA STANDARDS (SC1.1).
- REFER TO LANDSCAPE PLAN FOR PLANTING AND OTHER LANDSCAPE FEATURE DETAILS.
- CONTRACTOR TO PROVIDE THE CONSULTANT WITH A GRADING PLAN INDICATING AS-BUILT ELEVATIONS OF ALL DESIGN GRADES SHOWN ON THIS PLAN.

PAVEMENT STRUCTURE:

- LIGHT DUTY - CAR ONLY PARKING AREAS
50mm HL3
150mm GRAN "A"
300mm GRAN "B" TYPE II
- HEAVY DUTY - DRIVE AISLES
40mm SUPERPAVE 12.5
50mm SUPERPAVE 19.0
150mm GRAN "A"
300mm GRAN "B" TYPE II

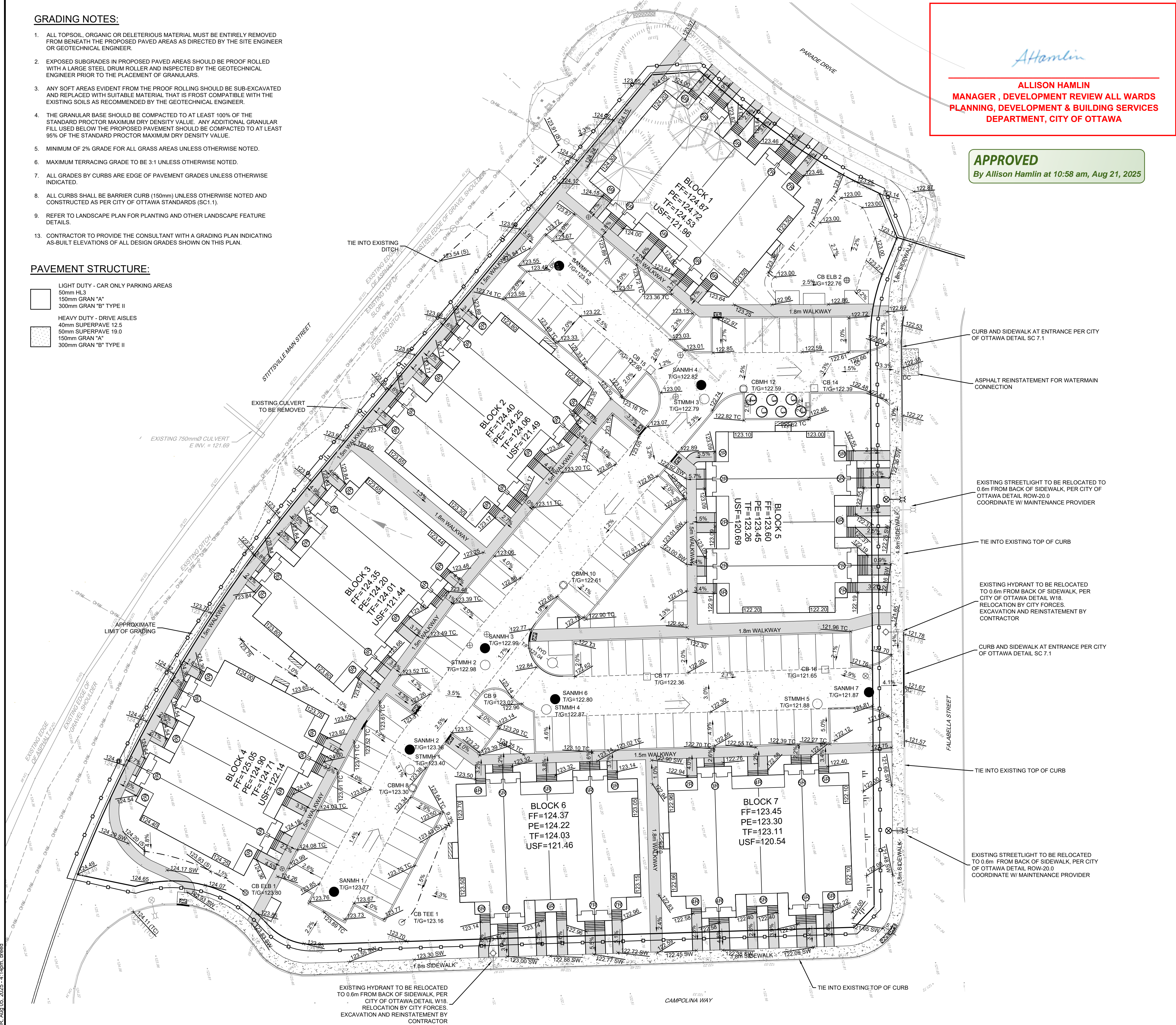

A Hamlin

ALLISON HAMLIN
MANAGER, DEVELOPMENT REVIEW ALL WARDS
PLANNING, DEVELOPMENT & BUILDING SERVICES
DEPARTMENT, CITY OF OTTAWA

APPROVED
By Allison Hamlin at 10:58 am, Aug 21, 2025

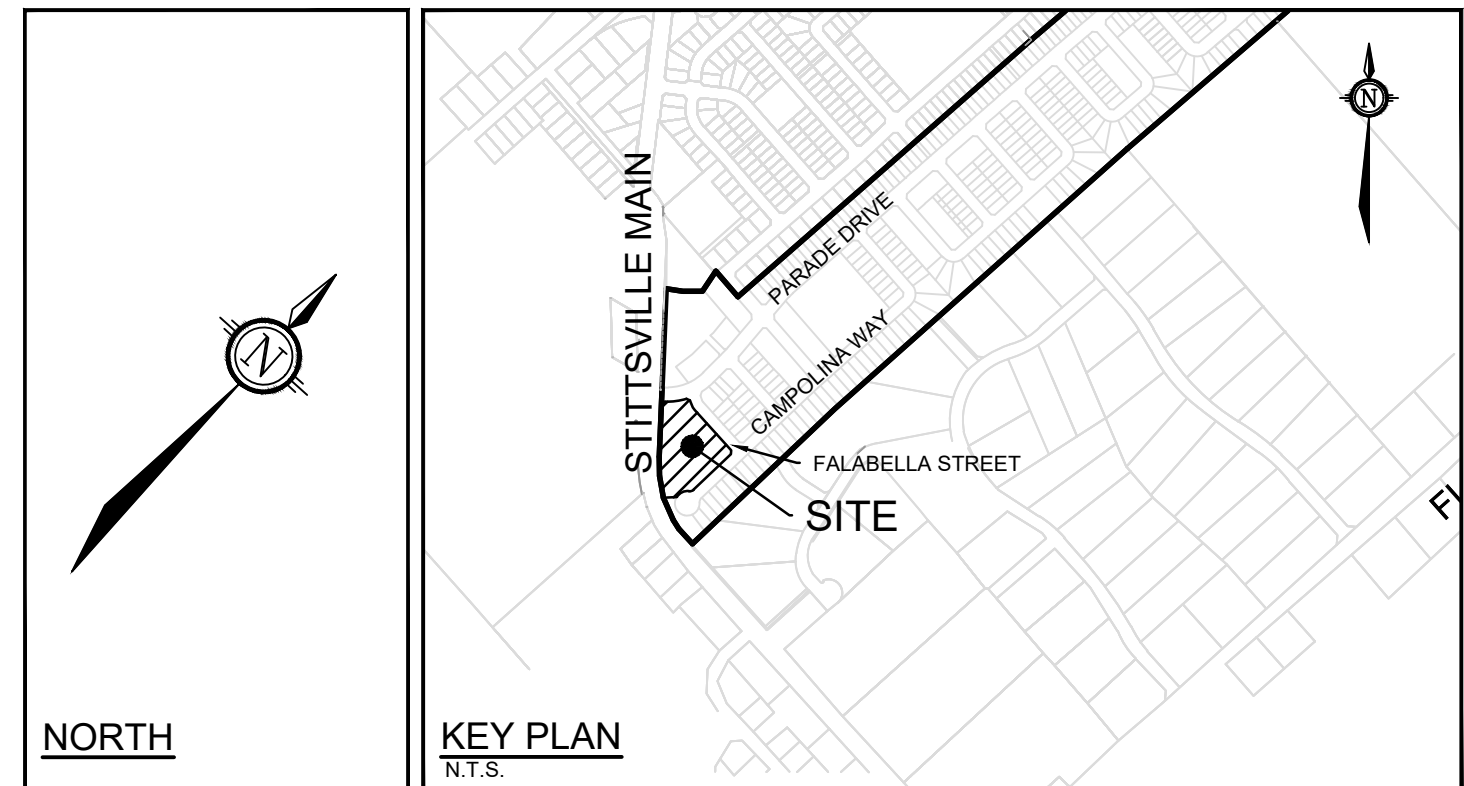

- LEGEND**
- PROPOSED ELEVATION
 - EXISTING ELEVATION
 - PROPOSED SWALE ELEVATION
 - PROPOSED TOP OF GRATE ELEVATION
 - GRADE AND DIRECTION
 - PROPOSED TERRACE ELEVATION
 - NUMBER OF RISERS (RAILINGS AS REQUIRED BY OBC)
 - FF= FINISHED FLOOR ELEVATION
 - PE= PORCH ELEVATION
 - TF= TOP OF FOUNDATION ELEVATION
 - USF= UNDERSIDE OF FOOTING ELEVATION
 - PROPOSED TERRACING
 - PROPOSED SWALE
 - PROPOSED SANITARY MH
 - PROPOSED STORM MH
 - PROPOSED CATCHBASIN MANHOLE
 - PROPOSED ROAD CATCHBASIN
 - PROPOSED LANDSCAPE ELBOW CATCHBASIN
 - PROPOSED LANDSCAPE TEE CATCHBASIN
 - PROPOSED 1.5m CONCRETE WALKWAY
 - PROPOSED 1.8m SIDEWALK
 - EXISTING 1.8m SIDEWALK
 - PROPOSED EROSION CONTROL SILT FENCE
 - MAJOR OVERLAND FLOW ROUTE
 - PROPOSED HYDRO NICHE LOCATION

- EROSION AND SEDIMENT CONTROL NOTES:**
- ALL EROSION AND SEDIMENT CONTROLS ARE TO BE INSTALLED TO THE SATISFACTION OF THE TOWN OF CARLETON PLACE AND MINISTRY OF ENVIRONMENT, CONSERVATION AND PARKS (MOECP), APPROPRIATE TO THE SITE CONDITIONS. PRIOR TO UNDERTAKING ANY SITE ALTERATIONS (FILLING, GRADING, REMOVAL OF VEGETATION, ETC.) AND DURING ALL PHASES OF SITE PREPARATION AND CONSTRUCTION IN ACCORDANCE WITH THE CURRENT BEST MANAGEMENT PRACTICES FOR EROSION AND SEDIMENT CONTROL SUCH AS BUT NOT LIMITED TO INSTALLING SILTSACKS ACROSS MANHOLE/CATCHBASIN LIDS TO PREVENT SEDIMENTS FROM ENTERING STRUCTURES AND INSTALL AND MAINTAIN A LIGHT DUTY SILT FENCE BARRIER AS REQUIRED.
 - TO PREVENT SURFACE EROSION FROM ENTERING THE STORM SYSTEM DURING CONSTRUCTION, SILTSACKS WILL BE PLACED UNDER ALL PROPOSED AND SURROUNDING CATCHBASINS AND MANHOLES. THE SILTSACKS WILL REMAIN IN PLACE UNTIL VEGETATION HAS BEEN ESTABLISHED AND CONSTRUCTION COMPLETE.
 - CONTRACTOR IS TO INSTALL LIGHT DUTY SILT FENCE AS PER OPSD 219.110 NEAR EXISTING CULVERTS AROUND SITE PRIOR TO THE COMMENCEMENT OF CONSTRUCTION AS SHOWN ON DRAWING 119221-ESC. CONTRACTOR SHALL MAINTAIN SILT FENCE FOR THE DURATION OF THE CONTRACT.
 - CONTRACTOR IS TO INSTALL STRAW BALES AS PER OPSD 219.180 AS INDICATED AND DIRECTED BY THE ENGINEER PRIOR TO THE COMMENCEMENT OF CONSTRUCTION.
 - ALL AREAS DISTURBED BY CONSTRUCTION ARE TO BE TREATED WITH IMPORTED TOPSOIL, SEED AND MULCH.
 - THE CONTRACTOR ACKNOWLEDGES THAT FAILURE TO IMPLEMENT EROSION AND SEDIMENT CONTROL MEASURES MAY BE SUBJECT TO PENALTIES IMPOSED BY ANY APPLICABLE REGULATORY AGENCY.
 - ALL STREETS ARE TO BE SWEEP ONCE ROADWAYS ARE PAVED AND TO CONTINUE FOR THE DURATION OF CONSTRUCTION ACTIVITY. STREETS ARE TO SWEEP REGULARLY AS INDICATED BY THE ENGINEER.
 - THE CONTRACTOR SHALL KEEP MATERIAL FOR ADDITIONAL EROSION AND SEDIMENT CONTROLS ONSITE AT ALL TIMES. THESE MATERIALS INCLUDE BUT ARE NOT LIMITED TO: SILT FENCES, STRAW BALES, SEDIMENT BAGS AND CLEAR STONE. A CONTINGENCY PLAN TO INCLUDE THE PROVISION OF ADDITIONAL LABOUR, EQUIPMENT OR MATERIALS TO INSTALL ADDITIONAL CONTROL MEASURES, AS WELL AS PROVIDE AN EMERGENCY RESPONSE PLAN IN CASE OF AN ACCIDENTAL EVENT. AS SUCH, THE CONTRACTORS SHALL HAVE ADDITIONAL CONTROL MEASURES ON SITE ALL TIMES WHICH ARE EASILY ACCESSIBLE AND MAY BE IMPLEMENTED AT A MOMENT'S NOTICE.
 - MUD MATS ARE TO BE INSTALLED AND MAINTAINED AT CONSTRUCTION ACCESS POINTS TO MINIMIZE SEDIMENT TRANSFER TO EXISTING ROADWAYS (SEE MUD MAT DETAIL).
 - COORDINATE ALL WORK WITH THE OWNER AND CONTRACT ADMINISTRATOR

NOTE:
THE POSITION OF ALL POLE LINES, CONDUITS, WATERMANS, SEWERS AND OTHER UNDERGROUND AND OVERGROUND UTILITIES AND STRUCTURES IS NOT NECESSARILY SHOWN ON THE CONTRACT DRAWINGS, AND WHERE SHOWN, THE ACCURACY OF THE POSITION OF SUCH UTILITIES AND STRUCTURES IS NOT GUARANTEED. BEFORE STARTING WORK, DETERMINE THE EXACT LOCATION OF ALL SUCH UTILITIES AND STRUCTURES AND ASSUME ALL LIABILITY FOR DAMAGE TO THEM.

No.	REVISION	DATE	BY
11.	ISSUED FOR TENDER AND RESUBMISSION	AUG 7/25	BHB
10.	REVISED AND RE-ISSUED FOR REVIEW	JUN 24/25	BHB
9.	ISSUED FOR COORDINATION	MAY 28/25	BHB

No.	REVISION	DATE	BY
8.	RE-ISSUED FOR SITE PLAN APPLICATION	APR 11/25	DJC
7.	ISSUED FOR COORDINATION	JAN 23/25	ARM
6.	ISSUED FOR COORDINATION	JAN 7/25	ARM
5.	ISSUED FOR COORDINATION	DEC 3/24	ARM
4.	ISSUED FOR COORDINATION	NOV 21/24	ARM
3.	ISSUED FOR COORDINATION	OCT 22/24	ARM
2.	ISSUED FOR COORDINATION	OCT 9/24	ARM
1.	ISSUED FOR COORDINATION	SEP 11/24	ARM

SCALE
1:300
0 3 6 9 12

DESIGN
MNP
ARM
MNP
ARM
ARM

FOR REVIEW ONLY

LOCATION
CITY OF OTTAWA BLOCK 349
DRAWING NAME
GRADING PLAN AND EROSION AND SEDIMENT CONTROL PLAN
PROJECT No.
124097
REV
REV # 11
DRAWING No.
124097-GR

M:\2024\124097\CAD\Civil\124097-GR.dwg, GR, Aug 05, 2025 - 4:14pm, breed

#19328
D07-12-24-0142