

PLANT LISTS

KEY	QTY	BOTANICAL NAME	COMMON NAME	TREE HT AT MATURITY	SIZE	COND	SPACING	NATIVE/ NON-NATIVE*
ROW - Deciduous Trees								
ARU	4	Acer rubrum 'Autumn Radiance'	Autumn Radiance Red Maple	14m	50mm Cal	WB	As Shown	Native
UPE	4	Ulmus procumbens 'UFS-Bleichen'	Emerald Sunshine Elm	11m	50mm Cal	WB	As Shown	Native
Deciduous Trees (Large)								
CCV	1	Carya cordiformis	Bitternut Hickory	20m	50mm Cal	PT	As Shown	Native
GOI	3	Gymnocladia dioica	Kentucky Coffee Tree	18m	50mm Cal	WB	As Shown	Native
PTO	2	Platanus occidentalis	American Sycamore	30m	50mm Cal	WB	As Shown	Native
QR	3	Quercus rubra	Red Oak	22m	50mm Cal	WB	As Shown	Native
Deciduous Trees (Medium)								
AFJ	2	Acer x freemanii 'Jeffersred'	Autumn Blaze Maple	15m	50mm Cal	WB	As Shown	Native
Deciduous Trees (Small)								
ALS	3	Aamelanchier lancea 'Spring Flurry'	Spring Flurry Senecoberry	8.5m	50mm Cal	WB	As Shown	Native
AXA	6	Aamelanchier x grandiflora 'Autumn Brilliance'	Autumn Brilliance Senecoberry	7.5m	50mm Cal	WB	As Shown	Native
CHD	6	Carolin canadensis 'Heart's Desire'	Heart's Desire™ Redbud	9m	150cm Ht	WB	As Shown	Native
Coniferous Trees								
TO	3	Thuja occidentalis	Eastern White Cedar	12m	200cm Ht	WB	As Shown	Native

Proposed Planting: Ownership	Total
Private	29
City-Owned (ROW)	8

KEY	QTY	BOTANICAL NAME	COMMON NAME	SIZE	COND	SPACING	NATIVE/ NON-NATIVE*
Coniferous Shrubs							
Ton	26	Taxus cuspidata 'Nana'	Dwarf Japanese Yew	50cm Spr	PT	As Shown	Non-Native
Jcs	26	Juniperus chinensis 'Spartan'	Spartan Juniper	3g	PT	As Shown	Non-Native
Jco	65	Juniperus horizontalis 'Plumosa Compacta'	Compact Andorra Juniper	40cm Spr	PT	As Shown	Non-Native
Toe	10	Thuja occidentalis 'Smaragd'	Emerald Cedar	200cmWB	PT	200cm O.C	Native
Tsh	11	Taxus media 'Hicksii'	Hicks Yew	100cmBB	PT	As Shown	Non-Native
Deciduous Shrubs							
Am	2	Aronia melanocarpa	Black Chokeberry	60cm Ht	PT	As Shown	Native
Ton	26	Aronia melanocarpa Ground Hug	Ground Hug Aronia	1g	PT	As Shown	Native
Avl	38	Aronia x Low Scape Mound (UCONN4M165)	Low Scape Mound Chokeberry	40cm Ht	PT	As Shown	Native
Csk	6	Cornus sericea 'Kelsay'	Kelsay Dogwood	40cm Ht	PT	As Shown	Native
Dsf	26	Dierilla splendens 'Firefly Nightglow'	Firefly Nightglow Bush Honeysuckle (El Madrigal)	60cm Ht	PT	As Shown	Native
Hpq	3	Hydrangea paniculata 'Quick Fire'	Quick Fire Hydrangea	60cm Ht	PT	As Shown	Non-Native
Pqj	4	Physocarpus opulifolius 'JEFAM'	Amber Jubilee Ninebark	60cm Ht	PT	As Shown	Native
Ra	1	Rhus aromatica	Fragrant Sumac	60cm Ht	PT	As Shown	Native
Va	2	Viburnum dentatum	Arrowwood Viburnum	60cm Ht	PT	As Shown	Native
Vj	2	Viburnum x juddii	Juddi Viburnum	60cm Ht	PT	As Shown	Non-Native
Perennials							
apd	67	Aster novae-angliae 'Purple Dome'	Purple Dome New England Aster	1g	plug	As Shown	Native
echp	23	Echinacea purpurea 'Powwow Wild Berry'	Wild Berry Coneflower	1g	PT	60cm O.C	Native
gm	251	Geranium maculatum	Spotted Cranesbill	1g	PT	50cm O.C	Native
hna	98	Hosta August Moon	August Moon Hosta	1g	PT	As Shown	Non-Native
ml	18	Mertensia fassena 'Walker's Low'	Walker's Low Catmint	1g	PT	70cm O.C	Non-Native
pbd	141	Panetmon barbatus 'Prairie Dusk'	Prairie Dusk Beard Tongue	1g	PT	60cm O.C	Non-Native
pmb	166	Phlox divaricata 'May Breeze'	Woodland Phlox	1g	PT	50cm O.C	Non-Native
mv	75	Mertensia virginica	Virginia bluebells	1g	PT	60cm O.C	Native
tsc	139	Thymus serpyllum 'Coccineus'	Red Creeping Thyme	1g	PT	60cm O.C	Native
Ornamental Grasses / Ferns							
clf	162	Calamagrostis acutiflora Karl Foerster	Karl Foerster Feather Reed Grass	1g	PT	80cm O.C	Non-Native
cpl	46	Carex plantaginifolia	Plantain-Leaved Sedge	1g	PT	As Shown	Native
cqv	75	Carex pensylvanica	Pennsylvania Sedge	1g	PT	60cm O.C	Native
fms	15	Meteucia struthioptens	Ostrich Fern	1g	PT	100cm O.C	Native
pncs	107	Panicum virgatum 'Cheyenne Sky'	Cheyenne Sky Switch Grass	1g	PT	70cm O.C	Native
pnr	88	Panicum virgatum 'Northwind'	Northwind Switch Grass	1g	PT	70cm O.C	Native
sh	95	Sporobolus heterostachys	Prairie Dropseed	1g	PT	60cm O.C	Native
sso	67	Schizachyrium scoparium 'Standing Ovation'	Standing Ovation Little Blue Stem	1g	PT	50cm O.C	Native

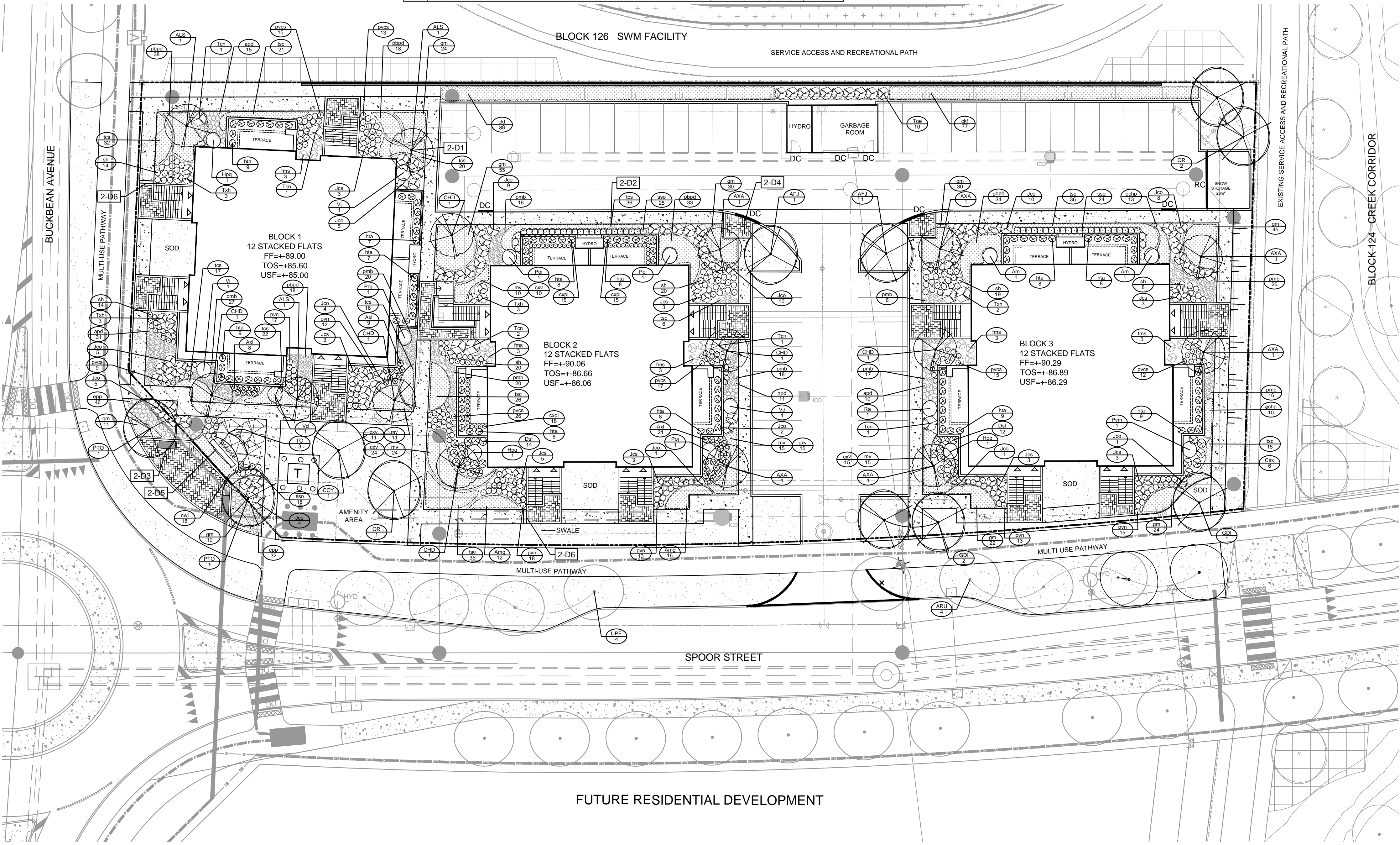

NOTE:
THE POSITION OF ALL POLE LINES, CONDUITS, WATER MAINS, SEWERS AND OTHER UNDERGROUND AND OVERGROUND UTILITIES AND STRUCTURES IS NOT NECESSARILY SHOWN ON THE CONTRACT DRAWINGS, AND WHERE SHOWN, THE ACCURACY OF THE POSITION OF SUCH UTILITIES AND STRUCTURES IS NOT GUARANTEED, BEFORE STARTING WORK, DETERMINE THE EXACT LOCATION OF ALL SUCH UTILITIES AND STRUCTURES AND ASSUME ALL LIABILITY FOR DAMAGE TO THEM.

Owner:
Uniform Developments
117 Concourse Drive, #300
Nepean, ON K2G 5X3
Phone: 613.225.0770

Engineer:
Novatech Engineers, Planners
& Landscape Architects
240 Michael Cowpland Drive,
Ottawa, ON, K2M 1P6
Phone: 613.254.9643

Architect:
Hobin Architecture INC.
63 Pamela Street,
Ottawa, ON K1S 3K7
Phone: 613.236.7200

Surveyor:
Annis, O'Sullivan, Vollebek Ltd.
14 Concourse Gate, Suite 500
Nepean, ON K2E 7S6
Phone: 613.727.0850

DISCLAIMER:
The elements on this plan illustrate the design intent and the general constructability of the proposed landscape which will support the associated development. This is to demonstrate how the canopy cover, urban design, health, and climate change objectives of the Official Plan will be met through tree planting and site design. This drawing is for City review only and is not intended for construction. Final detailed design and construction documentation is to be provided with certified 'Issued for Construction' drawings and specifications prior to construction.

No.	REVISION	DATE	BY
3.	REVISED PER FORMAL REVIEW COMMENTS	AUG 14/25	SC
2.	REVISED PER COMPLETENESS REVIEW COMMENTS	MAY 09/25	SC
1.	ISSUED FOR SITE PLAN APPLICATION	MAR 21/25	SC

SCALE

1:250

0 2 4 6 8 10

DESIGN

SC

CHECKED

SC

DRAWN

TB

CHECKED

SC

APPROVED

SC

FOR REVIEW ONLY

ASSOCIATION OF LANDSCAPE ARCHITECTS
CMA
August 14, 2025
MEMBER

Telephone: (613) 254-9643
Facsimile: (613) 254-5867
Website: www.novatech-eng.com

NOVATECH

Engineers, Planners & Landscape Architects
Suite 200, 240 Michael Cowpland Drive
Ottawa, Ontario, Canada K2M 1P6

Telephone: (613) 254-9643
Facsimile: (613) 254-5867
Website: www.novatech-eng.com

LOCATION
COPPERWOOD FLATS, 1101 SPOOR ST, KANATA
STACKED APARTMENTS - BLOCK 125

DRAWING NAME
LANDSCAPE PLAN

PROJECT NO.
122144

REV
REV # 3

DRAWING NO.
122144-125-L1

C:\Temp\p\p\publish_12506\122144-BLK125-L.dwg, L1, Aug 14, 2025 - 4:51pm, bbankale

D07-12-25-0039

PLANT.DWG 07/25/2025 #0000

PROPOSED AND RETAINED CANOPY COVER ESTIMATE:

PROPOSED CANOPY COVERAGE AT MATURITY				
SIZE OF PROPOSED TREE	AVERAGE MATURE SPREAD	CANOPY COVERAGE PER TREE AT MATURITY (m2)	QUANTITY OF TREES	TOTAL CANOPY COVERAGE (m2)
Deciduous trees- Small	4.5m	16	15	240
Deciduous trees- Medium*	10m	79	10	790
Deciduous trees- Large	15m	177	9	1590
Conifers	5m	20	3	60
TOTAL PROPOSED CANOPY COVERAGE (m2):				2,680
TOTAL SITE AREA (m2):				5,503
EST. PROPOSED CANOPY COVERAGE (%):				49%
1. Area of a circle = (πr^2)				
2. Canopy coverage per tree calculation: (average mature spread/2) x (average mature spread/2) x π				
*3. ROW trees along Spoor Street have also been counted under the medium canopy category.				

SOIL AVAILABILITY CALCULATIONS:

Planting bed no.	Available Soil Area (sq m)	Available Soil Volume* (cu m)	No. of trees proposed				Total No. of trees	Min. required Soil volume total (cu m)
			Small (min. 25m ³ soil for single & 15m ³ for shared)	Medium (min. 30m ³ soil for single & 18m ³ for shared)	Large (min. 35m ³ soil for single & 20m ³ for shared)	Conifers (min. 30m ³ soil for one tree)		
Planting bed 1	87	130					5	130.00
Planting bed 2	172	258			2		2	40.00
Planting bed 3	109	164	1				1	25.00
Planting bed 4	89	134					NA	0.00
Planting bed 5	25	38					NA	0.00
Planting bed 6	23	35			1		1	35.00
Planting bed 7	101	152	1		2		3	55.00
Planting bed 8	63	95					NA	0.00
Planting bed 9	128	192	2				2	30.00
Planting bed 10	18	27		1			1	30.00
Planting bed 11	18	27		1			1	30.00
Planting bed 12	67	101	2				2	30.00
Planting bed 13	67	101	2				2	30.00
Planting bed 14	130	195	2				2	30.00
Planting bed 15	46	69	1				1	25.00
Planting bed 16	251	377			2		2	40.00
Planting bed 17	65	98	1				1	25.00
Planting bed 18	43	64					NA	0.00
Planting bed 19	72	108	2				2	30.00
Planting bed 20	41	62	1				1	25.00
*Note : For all planting beds proposed, the available soil depth is considered to be 1.5m.								

TREE PLANTING IN SENSITIVE CLAY

- The landscape plans have been developed in accordance with the Paterson Group Geotechnical Report PG6613-1 Revision 3, dated May 1, 2025 which includes the Test Hole Locations Plan, dated April, 2023 that confirms the categories and locations of clay soils, and coordinated with the Paterson Group Geotechnical Memo PG6613-MEMO.01 dated May 1, 2025, which provides responses to the Geotechnical related comments from the City.
 - As per the Paterson Group Geotechnical memo PG6613-MEMO.01 - Response to City Comments, dated May 1, 2025, due to the thin nature of the silty clay deposit impacting buildings 1 and 2, this layer will be removed from under the proposed footing and replaced with engineered fill. This will remove the tree setback restrictions for the buildings 1 and 2.
 - Based on the subsurface conditions observed in the test holes around block 3, this block is not expected to be subject to tree planting setback requirements.
 - Therefore, in this case, tree planting will not be restricted by the sensitivity clay soils.
 - The soil volumes provided are sufficient for a reasonable chance of tree survival. Unless otherwise noted, all new trees on City property meet the minimum soil volume requirements of the following, based on a depth of 1.5m below finished grade, and subtracting the volume of utility trenches.
 - Small tree (mature height up to 7.5m) - 25m³/ minimum soil volume provided.
 - Medium tree (mature height 7.5-14m) - 30m³/ minimum soil volume provided.
- Where trees share a continuous greenspace:
- Two (2) small trees - 15m³/ minimum soil volume provided per tree.
 - Two (2) medium trees - 18m³/ minimum soil volume provided per tree.

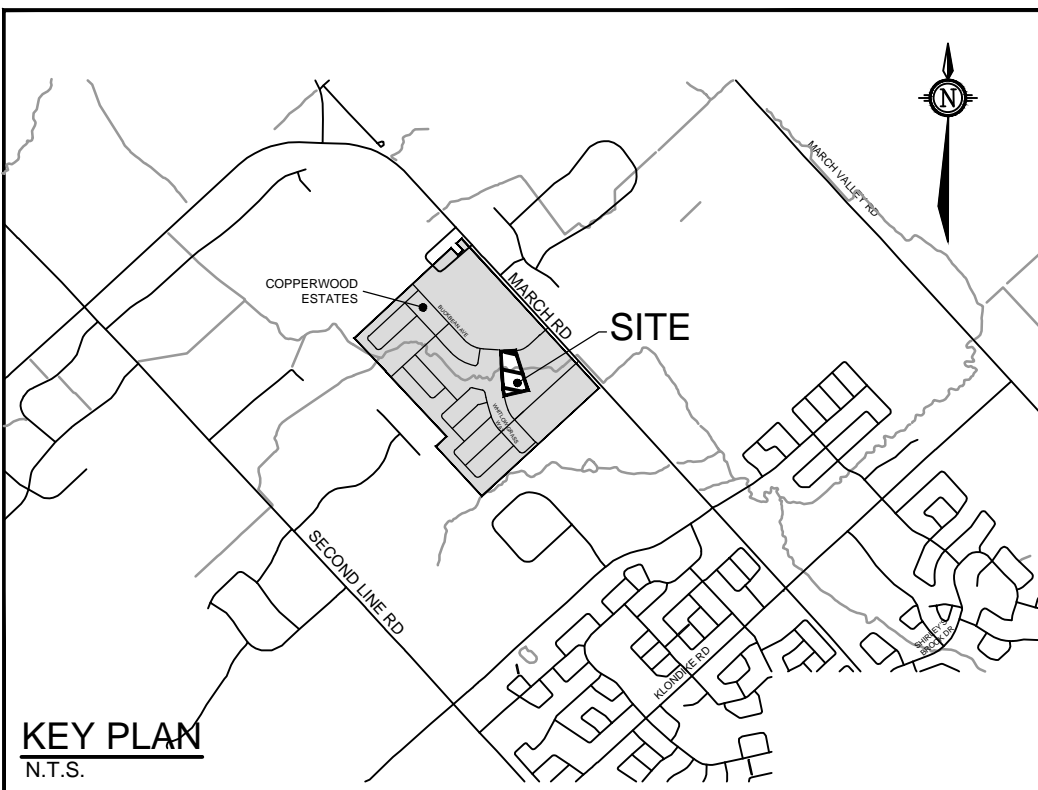
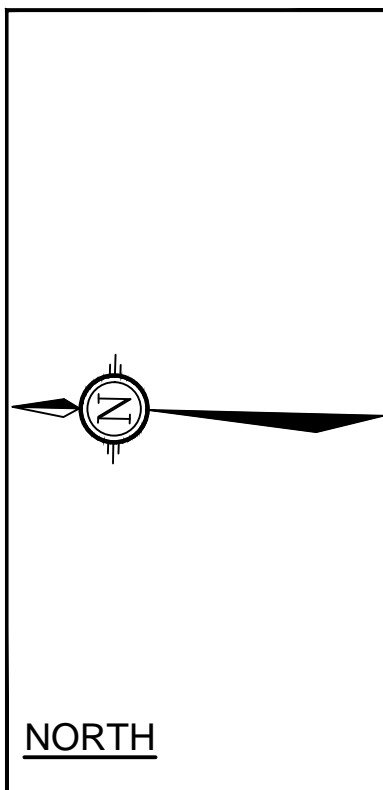

LEGEND

- PROPERTY LIMIT
- PROPOSED CONCRETE
- OFF-SITE CONCRETE
- PROPOSED PAVERS
- PROPOSED DECIDUOUS TREE
- PROPOSED CONIFEROUS TREE
- CANOPY COVER AREA OF PROPOSED TREES AT MATURITY
- PLANTING BED SOIL
- TREES AROUND THE SITE (BY OTHERS)
- RETAINING WALL REFER TO GR
- SPECIES (SEE PLANT LIST)
- QUANTITY

CONSTRUCTION

- All general site information and conditions are compiled from Consultant field notes and plans provided by the Owner and are supplied for information purposes only. It is the responsibility of the Contractor to verify the accuracy of all the information obtained from this plan.
 - Together with all Subcontractors involved, the Contractor is to examine all surfaces or conditions relating to the work, in order to determine the acceptability of such surfaces or conditions for the work to commence. Notify the Contract Administrator in writing of conditions which could be detrimental to installation and do not commence work until instructed by the Contract Administrator. The commencement of work implies Contractor acceptance of the conditions.
 - Contractor to check and report any discrepancies before commencing work. No responsibility is borne by the Consultants for subsurface conditions.
 - Contractor to check and verify all dimensions and quantities on site and report any errors or omissions to the Consultant. Contractor is responsible for all fees arising from the completion of works conveyed by these drawings, details, and specifications. Fees include but are not limited to securities, permit fees, deposits, application fees, letters of credit, or any other related funding requests.
 - Contractor to coordinate all access and protect the public and users of the site with appropriate control fence and supervision throughout the construction period, to the satisfaction of the Consultant.
 - Contract Administrator is to approve access point(s) prior to mobilization.
 - A Contractor flagman is required to direct all deliveries of machinery or materials to the site.
 - Contractor to coordinate and schedule all work with other trades and contractors. Contractor is to notify Contract Administrator of any schedule difficulties.
 - Contractor responsible for the removal and off-site disposal of all materials as required to facilitate new construction. Store all items and materials identified by the Consultant for salvage at a location on site as identified by the Consultant. Excavate and remove from site any contaminated material. Dispose all contaminated material at a licensed landfill facility. Maintain site in a clean and orderly state for the duration of construction; perform all work in accordance with the Occupational Health and Safety Act. Remove all excess materials, packaging, and debris from the site.
 - Contractor is responsible to take all necessary measures to control dust on the project site and to the satisfaction of the Contract Administrator.
 - Contractor is responsible for all layout for construction purposes.
 - Contractor is to protect all iron bars. Replace any disturbed bars by Owner at the Contractor expense.
 - The Contractor is to notify the Contract Administrator upon completion of the required works to schedule an inspection for acceptance.
- Plant Beds - **450mm** continuous depth. Applies to shrubs, perennials, vines, and groundcovers.
 - Sod/ Seed Areas - **100mm** depth.
 - Reforestation - **300mm** depth.
- Plant Beds - (8-32.16), i.e. 8% Nitrogen, 32% Phosphorus, 16% Potash per manufacturer specifications.
 - Sod Areas - (8-32.16), i.e. 8% Nitrogen, 32% Phosphorus, 16% Potash at a rate of 350kg/ha.
- Where applicable, for any plant areas with a mix of species/ cultivars notes, Contractor is to cluster like plants in groups of 3-5 and evenly distribute these in the noted area.

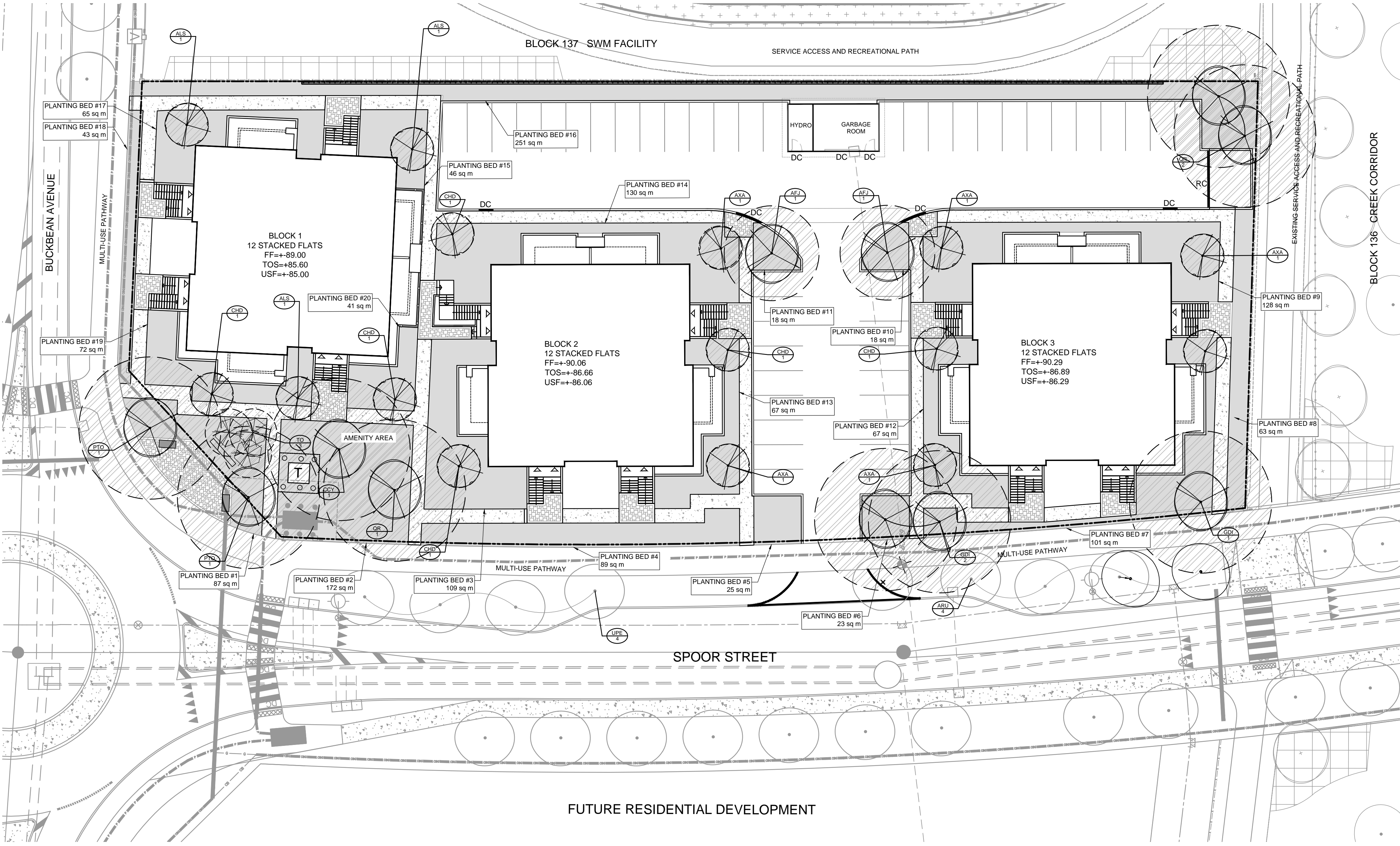

NOTE:
THE POSITION OF ALL POLE LINES, CONDUITS, WATERMAINS, SEWERS AND OTHER UNDERGROUND AND OVERGROUND UTILITIES AND STRUCTURES IS NOT NECESSARILY SHOWN ON THE CONTRACT DRAWINGS, AND WHERE SHOWN, THE ACCURACY OF THE POSITION OF SUCH UTILITIES AND STRUCTURES IS NOT GUARANTEED. BEFORE STARTING WORK, DETERMINE THE EXACT LOCATION OF ALL SUCH UTILITIES AND STRUCTURES AND ASSUME ALL LIABILITY FOR DAMAGE TO THEM.

Owner:
Uniform Developments
117 Centopente Drive, #300
Nepean, ON K2G 5X3
Phone: 613.225.0770

Engineer:
Novatech Engineers, Planners
& Landscape Architects,
240 Michael Cowpland Drive,
Ottawa, ON, K2M 1P6
Phone: 613.254.9643

Architect
Hobin Architecture INC.
63 Pamela Street,
Ottawa, ON K1S 3K7
Phone: 613.236.7200

Surveyor:
Annis, O'Sullivan, Vollebakk Ltd.
14 Concourse Gate, Suite 500
Nepean, ON K2E 7S6
Phone: 613.727.0850

DISCLAIMER:			
The elements on this plan illustrate the design intent and general constructability of the proposed landscape which will support the associated development. This is to demonstrate how the canopy cover, urban design, health, and climate change objectives of the Official Plan will be met through tree planting and site design. This drawing is for City review only and is not intended for construction. Final detailed design and construction documentation is to be provided with certified 'Issued for Construction' drawings and specifications prior to construction.			
3.	REVISED PER FORMAL REVIEW COMMENTS	AUG 14/25	SC
2.	REVISED PER COMPLETENESS REVIEW COMMENTS	MAY 09/25	SC
1.	ISSUED FOR SITE PLAN APPLICATION	MAR 21/25	SC
No.	REVISION	DATE	BY

SCALE

1:250

0 2 4 6 8 10

DESIGN

SC

CHECKED

SC

DRAWN

TB

CHECKED

SC

APPROVED

SC

FOR REVIEW ONLY

ASSOCIATION OF LANDSCAPE ARCHITECTS OF CANADA

August 14, 2025

Engineers, Planners & Landscape Architects
Suite 200, 240 Michael Cowpland Drive
Ottawa, Ontario, Canada K2M 1P6
(613) 254-9643
(613) 254-5867
www.novatech-eng.com

LOCATION
COPPERWOOD FLATS, 1101 SPOOR ST, KANATA
STACKED APARTMENTS - BLOCK 125

DRAWING NAME
CANOPY COVER AND SOIL PLAN

PROJECT No.
122144

REV
REV # 3

DRAWING No.
122144-125-L3

C:\Temp\p\publish_125061122144-BLK125-L.dwg, L3, Aug 14, 2025 - 4:51pm, ibankide

D07-12-25-0039