



1. Refer to the Tree Conservation Report for 2475 Regina Street issued on 2025-05-30 by IFS ASSOCIATES.  
Select pruning / limbing will be required in some areas including along the path of travel for heavy equipment. Prior to commencing construction work, the contractor should walk the site and complete selective pruning / limbing with a certified arborist. All limbing and pruning shall be as per accepted arboricultural practices. Excavation within the critical root zone shall be avoided where possible. Where unavoidable, required excavation shall be by hand or hydro excavation to avoid tearing of roots. Trenching within the critical root zone is not permitted. In instances where root pruning is required, the service of a Certified Arborist or Qualified Tree Worker under the supervision of a Certified Arborist shall be retained. Any root cutting shall be made using a sharp spade or knife at the limit of disturbance prior to any construction activities. Roots to remain that are exposed by construction activities must be immediately reburied with native topsoil or temporarily covered with burlap, filter cloth, or wadchips and kept moist (i.e watering with a soft-spray nozzle at least three times a week). A covering plastic should be used in order to retain moisture during an extended period where watering may not be possible (i.e. over weekends). Where re-grading is required within the Critical Root Zone (CRZ), it should be performed by hand under the supervision of a Certified Arborist. When working near vegetation, the Contractor shall ensure that exhaust fumes from all equipment are NOT directed towards any tree's canopy.
2. Refer to drawings L4-L5 for planting schedule.
3. Refer to drawings L6-L9 for Landscape sections & elevations, general notes & details.
4. The landscape plan has been developed meeting all AODA requirements for accessibility.



\\02050001\Projects\2475 Regina Street\2475-01\2475-01-01.dwg  
2025/08/08 11:09 AM  
Kersten Nitsche  
2025/08/08 11:09 AM  
Kersten Nitsche

ORIGINAL SHEET - ARCH D

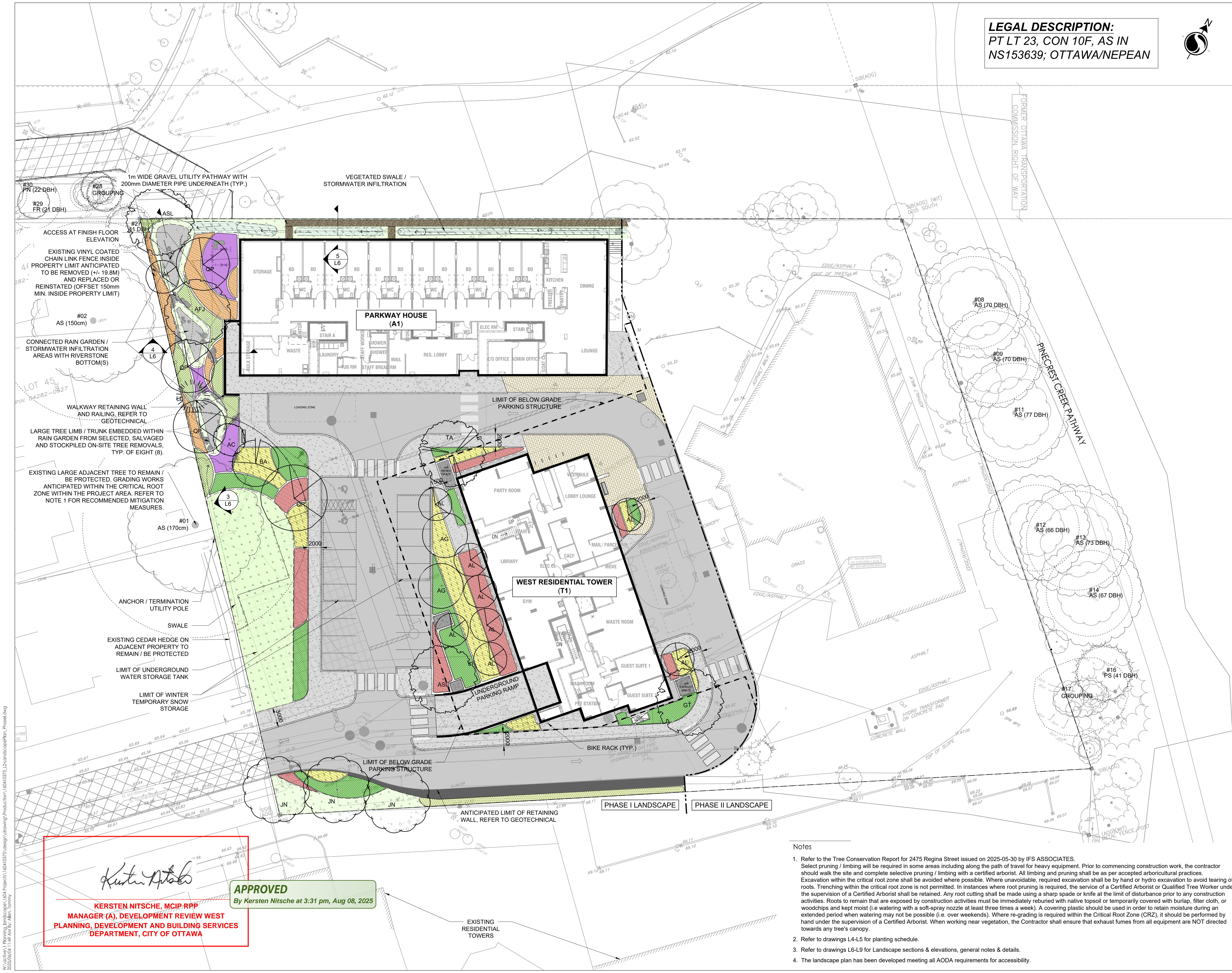

**LEGAL DESCRIPTION:**  
PT LT 23, CON 10F, AS IN  
NS153639; OTTAWA/NEPEAN



Stantec Consulting Ltd.  
400 - 1331 Clyde Avenue  
Ottawa ON  
Tel. 613.722.4420  
www.stantec.com

Copyright Reserved

The Contractor shall verify and be responsible for all dimensions. DO NOT scale the drawing - any errors or omissions shall be reported to Stantec without delay.  
The Copyrights to all designs and drawings are the property of Stantec. Reproduction or use for any purpose other than that authorized by Stantec is forbidden.

Key Plan

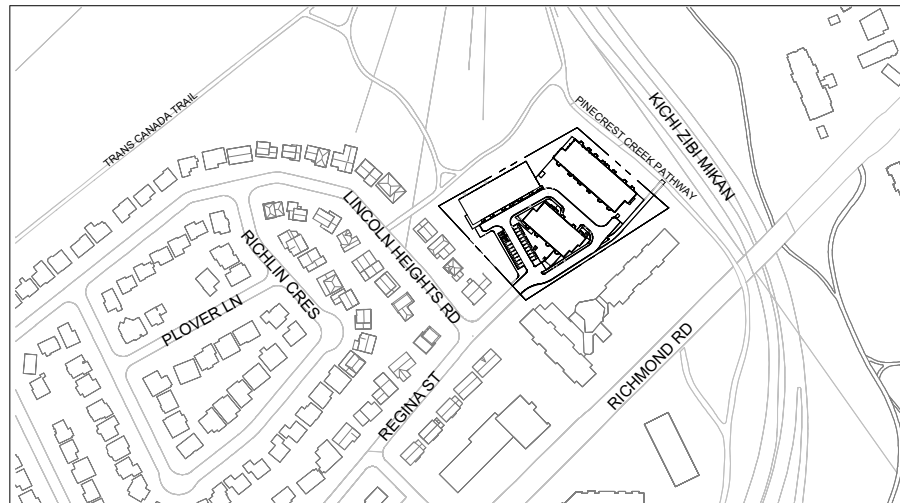

Legend

	CONCRETE PAVING REFER TO DETAILS 5-6 SHEET L8		MIXED SHRUB BED (NATURALIZED AREAS) REFER TO DETAIL 8 SHEET L9
	UNIT PAVING REFER TO DETAIL 8 SHEET L8		PERENNIALS & HERBACEOUS PLANTS (NATURALIZED AREAS) REFER TO DETAIL 7 SHEET L9
	ASPHALT PAVING REFER TO DETAILS 1-2 SHEET L8		ORNAMENTAL GRASS (NATURALIZED AREAS) REFER TO DETAIL 8 SHEET L9
	GRAVEL REFER TO SECTION 5 SHEET L8		MIXED SHRUB BED (URBAN AREAS) REFER TO DETAIL 6 SHEET L9
	SOIL CELL (BELOW) REFER TO SECTION 1 SHEET L8		PERENNIALS & HERBACEOUS PLANTS (URBAN AREAS) REFER TO DETAIL 8 SHEET L9
	NATIVE SEEDMIX RAIN GARDEN / WETLAND MIX		ORNAMENTAL GRASS (URBAN AREAS) REFER TO DETAIL 8 SHEET L9
	NATIVE SEEDMIX DROUGHT TOLERANT POLLINATOR MEADOW MIX		VINES / CLIMBERS REFER TO DETAIL 7 SHEET L9
	SOD INCLUDING 150mm TOPSOIL		
	PLANTER EDGE REFER TO DETAIL 11 SHEET L8		
	CONCRETE PLANTER CURB REFER TO DETAIL 9 SHEET L8		
	SEATWALL REFER TO SECTION 1 SHEET L8		
	ACCESSIBLE BENCH		
	BIKE RACK(S) REFER TO DETAIL 12 SHEET L8		
	LANDSCAPE BOULDER / ARMOUR STONE REFER TO DETAIL 10 SHEET L8		
	TREE PROTECTION FENCE		
	DECIDUOUS TREE PLANTING REFER TO DETAILS 1-2 SHEET L9		
	CONIFEROUS TREE PLANTING REFER TO DETAIL 34 SHEET L9		
	EXISTING TREE ANTICIPATED TO REMAIN (INCLUDING ID#S, SPECIES & DIAMETER AT BREAST HEIGHT). REFER TO NOTE 1.		

2	ISSUED FOR CITY REVIEW	TA	KP	25.06.04
1	60% DETAIL SUBMISSION	TA	KP	25.04.16
0	ISSUED FOR CITY REVIEW	TA	KP	25.02.20
Revision		By	Appd.	YY.MM.DD

File Name:	160410375-200	BL	KP / L	KP / BL	23.11.22
		Dwn.	Chkd.	Dsgn.	YY.MM.DD

Permit-Seal



Client/Project

WINDMILL DEVELOPMENT GROUP LTD.

2475 REGINA STREET

Ottawa, ON

Title

LANDSCAPE PLAN  
PHASE I

Project No.

160410375

Drawing No.

L2

Scale

0 2.5 7.5 12.5m  
1:250

Sheet

2 of 9

Revision

2

PLAN NUMBER: 19267

Notes

- Refer to the Tree Conservation Report for 2475 Regina Street issued on 2025-05-30 by IFS ASSOCIATES.  
Select pruning / limbing will be required in some areas including along the path of travel for heavy equipment. Prior to commencing construction work, the contractor should walk the site and complete selective pruning / limbing with a certified arborist. All limbing and pruning shall be as per accepted arboricultural practices. Excavation within the critical root zone shall be avoided where possible. Where unavoidable, required excavation shall be by hand or hydro excavation to avoid tearing of roots. Trenching within the critical root zone is not permitted. In instances where root pruning is required, the service of a Certified Arborist or Qualified Tree Worker under the supervision of a Certified Arborist shall be retained. Any root cutting shall be made using a sharp spade or knife at the limit of disturbance prior to any construction activities. Roots to remain that are exposed by construction activities must be immediately reburied with native topsoil or temporarily covered with burlap, filter cloth, or woodchips and kept moist (i.e. watering with a soft-spray nozzle at least three times a week). A covering plastic should be used in order to retain moisture during an extended period when watering may not be possible (i.e. over weekends). Where re-grading is required within the Critical Root Zone (CRZ), it should be performed by hand under the supervision of a Certified Arborist. When working near vegetation, the Contractor shall ensure that exhaust fumes from all equipment are NOT directed towards any tree's canopy.
- Refer to drawings L4-L5 for planting schedule.
- Refer to drawings L6-L9 for Landscape sections & elevations, general notes & details.
- The landscape plan has been developed meeting all AODA requirements for accessibility.



LEGAL DESCRIPTION:  
PT LT 23, CON 10F, AS IN  
NS153639; OTTAWA/NEPEAN

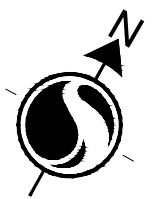

Stantec Consulting Ltd.  
400 - 1331 Clyde Avenue  
Ottawa ON  
Tel. 613.722.4420  
www.stantec.com

Copyright Reserved

The Contractor shall verify and be responsible for all dimensions. DO NOT scale the drawing - any errors or omissions shall be reported to Stantec without delay.  
The Copyrights to all designs and drawings are the property of Stantec. Reproduction or use for any purpose other than that authorized by Stantec is forbidden.

Key Plan



Legend

- TREE CANOPY COVERAGE**  
ANTICIPATED AT 40 YEARS
- SOIL BEDS - ON STRUCTURE**  
REFER TO ANNOTATIONS FOR SOIL VOLUME
- CONCRETE PAVING**  
REFER TO DETAILS 5-6 SHEET L8
- UNIT PAVING**  
REFER TO DETAIL 8 SHEET L8
- ASPHALT PAVING**  
REFER TO DETAILS 1-2 SHEET L8
- GRAVEL**  
REFER TO SECTION 5 SHEET L8
- SOIL CELL (BELOW)**  
REFER TO SECTION 1 SHEET L6
- PLANTER EDGE**  
REFER TO DETAIL 11 SHEET L8
- CONCRETE PLANTER CURB**  
REFER TO DETAIL 9 SHEET L8
- SEATWALL**  
REFER TO SECTION 1 SHEET L6
- ACCESSIBLE BENCH**  
REFER TO DETAIL 12 SHEET L8
- BIKE RACK(S)**  
REFER TO DETAIL 10 SHEET L8
- LANDSCAPE BOULDERS / ARMOUR STONE**  
REFER TO DETAIL 10 SHEET L8
- EXISTING TREE**  
ANTICIPATED TO REMAIN (INCLUDING ID#, SPECIES & DIAMETER AT BREAST HEIGHT). REFER TO NOTE 1.  
XX (DBH)
- ANTICIPATED TREE ROOT GROWTH**  
REFER TO SECTIONS 1 AND 2 SHEET L7

3	ISSUED FOR CITY REVIEW	TA	KP	25.06.04
2	60% DETAIL SUBMISSION	TA	KP	25.04.16
1	ISSUED FOR CITY REVIEW	TA	KP	25.02.20
0	ISSUED FOR CITY REVIEW	TA	KP	24.11.28
Revision		By	Appd.	YY.MM.DD

File Name:	160410375-200	BL	KP / IL	KP / BL	23.11.22
		Dwn.	Chkd.	Dsgn.	YY.MM.DD

Permit-Seal



Client/Project

WINDMILL DEVELOPMENT GROUP LTD.

2475 REGINA STREET

Ottawa, ON

Title

TREE CANOPY AND SOIL VOLUME

Project No.	Scale	0	2.5	7.5	12.5m
160410375	1:250				
Drawing No.	Sheet	Revision			

L3

3 of 9

3

PLAN NUMBER: 19267

ANTICIPATED LIMIT OF TREE  
CANOPY COVER AT 40 YEARS GROWTH:  
TREE CANOPY AREA = 3,625 m<sup>2</sup>  
PROJECT SITE AREA = 10,359 m<sup>2</sup>  
CANOPY COVERAGE = 35.0%



Notes

- Refer to the Tree Conservation Report for 2475 Regina Street issued on 2025-05-30 by IFS ASSOCIATES. Select pruning / limbing will be required in some areas including along the path of travel for heavy equipment. Prior to commencing construction work, the contractor should walk the site and complete selective pruning / limbing with a certified arborist. All limbing and pruning shall be as per accepted arboricultural practices. Excavation within the critical root zone shall be avoided where possible. Where unavoidable, required excavation shall be by hand or hydro excavation to avoid tearing of roots. Trenching within the critical root zone is not permitted. In instances where root pruning is required, the service of a Certified Arborist or Qualified Tree Worker under the supervision of a Certified Arborist shall be retained. Any root cutting shall be made using a sharp spade or knife at the limit of disturbance prior to any construction activities. Roots to remain that are exposed by construction activities must be immediately reburied with native topsoil or temporarily covered with burlap, filter cloth, or woodchips and kept moist (i.e. watering with a soft-spray nozzle at least three times a week). A covering plastic should be used in order to retain moisture during an extended period when watering may not be possible (i.e. over weekends). Where re-grading is required within the Critical Root Zone (CRZ), it should be performed by hand under the supervision of a Certified Arborist. When working near vegetation, the Contractor shall ensure that exhaust fumes from all equipment are NOT directed towards any tree's canopy.
- Refer to drawings L4-L5 for planting schedule.
- Refer to drawings L6-L9 for Landscape sections & elevations, general notes & details.
- The landscape plan has been developed meeting all AODA requirements for accessibility.

*Kersten Nitsche*

KERSTEN NITSCHKE, MCIP RPP  
MANAGER (A), DEVELOPMENT REVIEW WEST  
PLANNING, DEVELOPMENT AND BUILDING SERVICES  
DEPARTMENT, CITY OF OTTAWA

APPROVED

By Kersten Nitsche at 3:31 pm, Aug 08, 2025



PLANTING SCHEDULE (PRIVATE OWNERSHIP)

CONIFEROUS TREES - REFER TO DETAIL 3 SHEET L9										
KEY	PH1 QTY	PH2 QTY	BOTANICAL NAME	COMMON NAME	SPACING (mm O.C.)	CALIPER (mm)	HEIGHT (mm)	ROOT	DESCRIPTION / NOTES	MATURE HEIGHT
AA	0	3	<i>Abies alba</i>	Silver Fir	Refer to Plan	-	2000	W.B.	full sun, partial sun/shade, low maintenance	Medium (10-15m)
LL	1	2	<i>Larix laricina</i>	Eastern larch	Refer to Plan	-	2000	W.B.	native (Ontario), full sun, fall foliage, low maintenance	Large (15m+)
TO	0	2	<i>Thuja occidentalis</i>	Eastern White Cedar	Refer to Plan	-	2000	W.B.	native (Ontario), drought tolerant, low maintenance, full sun	Medium (10-15m)
PS	0	13	<i>Pinus strobus</i>	White Pine	Refer to Plan	-	2000	W.B.	full sun, low maintenance	Small (5-10m)
DECIDUOUS TREES (ON STRUCTURE) - REFER TO DETAIL 2 SHEET L9										
KEY	PH1 QTY	PH2 QTY	BOTANICAL NAME	COMMON NAME	SPACING mm (O.C.)	CALIPER (mm)	HEIGHT (mm)	ROOT	DESCRIPTION / NOTES	MATURE HEIGHT
AAA	0	1	<i>Amelanchier arborea</i>	Downy Serviceberry	Refer to Plan	45	2500	W.B.	native (Ontario), treeform, full shade, partial sun/shade, full shade, colourful flowers, attracts birds	Small (5-10m)
AG	2	0	<i>Aesculus glabra</i>	Ohio buckeye	Refer to Plan	50	-	W.B.	native (Ontario), full sun, partial sun/shade, attracts birds, fall foliage	Medium (10-15m)
AL	8	2	<i>Amelanchier laevis</i>	Allegheny Serviceberry	Refer to Plan	45	2500	W.B.	native (Ontario), treeform, full sun, partial sun/shade, attracts birds, edible fruit, fall foliage, colourful flowers	Small (5-10m)
ASL	1	3	<i>Acer saccharum 'Legacy'</i>	Legacy Sugar Maple	Refer to Plan	50	-	W.B.	native (Ontario), drought tolerant, full sun, fall foliage	Large (15m+)
AX	0	3	<i>Amelanchier x grandiflora 'Autumn Brilliance'</i>	Autumn Brilliance Serviceberry	Refer to Plan	45	2500	W.B.	native (Ontario), treeform, full sun, partial sun/shade, attracts birds, edible fruit, fall foliage, colourful flowers	Small (5-10m)
CC	0	3	<i>Carpinus caroliniana</i>	Musclewood	Refer to Plan	50	-	W.B.	native (Ontario), partial sun/shade, full sun, attracts birds, fall foliage	Medium (10-15m)
GT	0	3	<i>Gleditsia triacanthos</i>	Honey locust	Refer to Plan	50	-	W.B.	native (Ontario), drought tolerant, salt tolerant, heat tolerant, full sun, partial sun/shade	Large (15m+)

DECIDUOUS TREES (ON GRADE) - REFER TO DETAIL 1 SHEET L9										
KEY	PH1 QTY	PH2 QTY	BOTANICAL NAME	COMMON NAME	SPACING mm (O.C.)	CALIPER (mm)	HEIGHT (mm)	ROOT	DESCRIPTION / NOTES	MATURE HEIGHT
AC	1	0	<i>Amelanchier canadensis</i>	Canadian Serviceberry	Refer to Plan	50	2500	B.B.	native (Ontario), treeform, full sun, partial sun/shade, attracts birds, edible fruit, fall foliage, colourful flowers	Small (5-10m)
AL	1	6	<i>Amelanchier laevis</i>	Allegheny Serviceberry	Refer to Plan	45	2500	W.B.	native (Ontario), treeform, full sun, partial sun/shade, attracts birds, edible fruit, fall foliage, colourful flowers	Small (5-10m)
AR	0	1	<i>Acer rubrum</i>	Red Maple	Refer to Plan	50	-	W.B.	native (Ontario), fall foliage, full sun, partial sun/shade	Medium (10-15m)
ASL	1	2	<i>Acer saccharum 'Legacy'</i>	Legacy Sugar Maple	Refer to Plan	50	-	W.B.	native (Ontario), drought tolerant, full sun, fall foliage	Large (15m+)
AFJ	1	0	<i>Acer X freemanii 'Jeffersred'</i>	Autumn Blaze Maple	Refer to Plan	50	-	W.B.	native (Ontario), drought tolerant, full sun, fall foliage	Large (15m+)
AX	0	2	<i>Amelanchier x grandiflora 'Autumn Brilliance'</i>	Autumn Brilliance Serviceberry	Refer to Plan	45	2500	W.B.	native (Ontario), treeform, full sun, partial sun/shade, attracts birds, edible fruit, fall foliage, colourful flowers	Small (5-10m)
BA	1	5	<i>Betula alleghaniensis</i>	Yellow Birch	Refer to Plan	50	-	W.B.	native (Ontario), full sun, partial sun/shade, fall foliage	Medium (10-15m)
BP	0	2	<i>Betula papyrifera</i>	White Birch	Refer to Plan	50	-	W.B.	native (Ontario), salt tolerant, full shade, attracts birds, fall foliage	Medium (10-15m)
GT	1	0	<i>Gleditsia triacanthos</i>	Honey Locust	Refer to Plan	50	-	W.B.	native (Ontario), drought tolerant, salt tolerant, heat tolerant, full sun, partial sun/shade	Large (15m+)
JN	3	1	<i>Juglans nigra</i>	Black Walnut	Refer to Plan	50	-	W.B.	native (Ontario), salt tolerant, drought tolerant, full sun, edible fruit, fall foliage	Large (15m+)
OV	0	3	<i>Ostrya virginiana</i>	Ironwood	Refer to Plan	50	-	W.B.	native (Ontario), drought tolerant, full sun, partial sun/shade, full shade, attracts birds, fall foliage	Medium (10-15m)
QM	0	3	<i>Quercus macrocarpa</i>	Bur Oak	Refer to Plan	50	-	W.B.	native (Ontario), drought tolerant, low maintenance, full sun, fall foliage	Medium (10-15m)
QP	3	0	<i>Quercus palustris</i>	Pin Oak	Refer to Plan	50	-	W.B.	native (Ontario), drought tolerant, full sun, fall foliage	Medium (10-15m)
QR	1	0	<i>Quercus rubra</i>	Red Oak	Refer to Plan	50	-	W.B.	native (Ontario), drought tolerant, full sun, fall foliage	Large (15m+)
TA	1	0	<i>Tilia americana</i>	Basswood	Refer to Plan	50	-	W.B.	native (Ontario), drought tolerant, full sun, partial sun/shade, attracts butterflies, fragrant	Large (15m+)

MIXED SHRUB BED (NATURALIZED AREAS) - REFER TO DETAIL 5 SHEET L9										
KEY	PH1 QTY	PH2 QTY	BOTANICAL NAME	COMMON NAME	SPACING (mm) (O.C.)	SIZE	HEIGHT (mm)	ROOT	DESCRIPTION / NOTES	% BED COVER
Als	3	1	<i>Amelanchier laevis</i>	Downy Serviceberry	3000	3 Gal.	-	Pot	native (Ontario), full sun, partial sun/shade, attracts birds, fall foliage	34%
Cos	2	1	<i>Cephalanthus occidentalis</i>	Buttonbush	1500	2 Gal.	-	Pot	native (Ontario), rain garden, full sun, partial sun/shade, attracts butterflies, fragrant, long bloom, waters edge	6%
Caa	3	1	<i>Cornus alternifolia</i>	Pagoda Dogwood	1200	3 Gal.	-	Pot	native (Ontario), full sun, partial sun/shade, attracts birds, attracts butterflies, fall foliage, fragrant, low maintenance	5%
Cam	2	1	<i>Cornus amomum</i>	Silky Dogwood	2000	2 Gal.	-	Pot	native (Ontario), full sun, partial sun/shade, attracts birds	10%
Csa	2	1	<i>Cornus sericea</i>	Red Osier Dogwood	2000	2 Gal.	-	Pot	native (Ontario), partial sun/shade, full sun, attracts birds, fall foliage, salt tolerant	10%
Csf	2	1	<i>Cornus sericea 'Flaviramea'</i>	Yellowtwig Dogwood	2000	2 Gal.	-	Pot	native (Ontario), partial sun/shade, full sun, attracts birds, fall foliage, salt tolerant	10%
Dia	4	1	<i>Diervilla lonicera</i>	Bush Honeysuckle	750	3 Gal.	-	Pot	native (Ontario), drought tolerant, full sun, full shade, partial sun/shade, attracts butterflies, fall foliage, fragrant, low maintenance	3%
Scs	3	1	<i>Sambucus canadensis</i>	Canada Elderberry	2000	3 Gal.	-	Pot	native (Ontario), full sun, partial sun/shade, attracts birds, attracts butterflies, edible, fragrant	15%
Saa	4	1	<i>Spirea alba</i>	White Meadowsweet	600	3 Gal.	-	Pot	native (Ontario), partial sun/shade, full sun, attracts butterflies, fall foliage, long bloom, salt tolerant, low maintenance, waters edge	2%
Sas	4	1	<i>Symphoricarpos albus</i>	Snowberry	1000	3 Gal.	-	Pot	native (Ontario), drought tolerant, full sun, partial sun/shade, attracts birds, low maintenance	5%

	MIXED SHRUB BED (URBAN AREAS) - REFER TO DETAIL 6 SHEET L9									
KEY	PH1 QTY	PH2 QTY	BOTANICAL NAME	COMMON NAME	SPACING mm (O.C.)	SIZE (Pot)	HEIGHT (mm)	ROOT	DESCRIPTION / NOTES	% BED COVER
Dia	31	27	<i>Diervilla lonicera</i>	Bush Honeysuckle	750	3 Gal.	-	Pot	native (Ontario), drought tolerant, full sun, full shade, partial sun/shade, attracts butterflies, fall foliage, fragrant, low maintenance	8%
Hkm	34	65	<i>Hypericum kalmianum</i>	Pot O'Gold	500	-	400	Pot	native (Ontario), drought tolerant, full sun, partial sun/shade, attracts butterflies, long bloom	4%
Pos	13	25	<i>Physocarpus opulifolius</i>	Common Ninebark	1500	-	400	Pot	native (Ontario), drought tolerant, full sun, partial sun/shade	14%
Pfa	17	32	<i>Potentilla fruticosa</i> 'Abbotswood'	Abbotswood Cinquefoil	500	2 Gal.	-	Pot	native (Ontario), drought tolerant, salt tolerant, attracts butterflies, long bloom, low maintenance, ground cover, rock garden, full sun	2%
Pff	17	32	<i>Potentilla fruticosa</i> 'Farren'	Golddrop Cinquefoil	500	2 Gal.	-	Pot	native (Ontario), drought tolerant, salt tolerant, attracts butterflies, long bloom, low maintenance, ground cover, rock garden, full sun	2%
Rag	22	41	<i>Rhus aromatica</i> 'Grow-Low'	Grow-Low Fragrant Sumac	1500	-	400	Pot	native (Ontario), drought tolerant, low maintenance, erosion / bank control, attracts birds, ground cover, fall foliage, fragrant, full sun, partial sun/shade	23%
Rba	20	37	<i>Rosa blanda</i>	Smooth Rose	1500	3 Gal.	-	Pot	native (Ontario), full sun, partial sun/shade, attracts butterflies, fruit attracts birds, fragrant, colourful flowers	21%
Rva	30	56	<i>Rosa virginiana</i>	Virginia Rose	600	2 Gal.	-	Pot	native (Ontario), drought tolerant, edible fruit, partial sun/shade, full shade, attracts pollinators	5%
Ros	14	26	<i>Rubus odoratus</i>	Flowering Raspberry	1500	3 Gal.	-	Pot	native (Ontario), full sun, attracts birds, fall foliage, fragrant	15%
Tom	19	36	<i>Thuja occidentalis</i> 'Sherwood Moss'	Sherwood Moss Cedar	800	-	400	Pot	native (Ontario), full sun, partial sun/shade, low maintenance	6%

PERENNIALS & HERBACEOUS PLANTS (NATURALIZED AREAS) - REFER TO DETAIL 7 SHEET L9										
KEY	PH1 QTY	PH2 QTY	BOTANICAL NAME	COMMON NAME	SPACING (mm O.C.)	SIZE (Pot)	HEIGHT (mm)	ROOT	DESCRIPTION / NOTES	% BED COVER
Aia	16	2	<i>Asclepias incarnata</i>	Swamp Milkweed	800	1 Gal.	-	Pot	native (Ontario), rain garden, full sun, partial sun/shade, attracts butterflies, attracts pollinators, cutting flower, waters edge	15%
Ata	19	3	<i>Asclepias tuberosa</i>	Butterfly Milkweed	450	1 Gal.	-	Pot	native (Ontario), drought tolerant, full sun, attracts butterflies, attracts pollinators, cutting flower, rock garden	5%
Clf	38	5	<i>Coreopsis lanceolata</i>	Lance-Leaved Tickseed	450	1 Gal.	-	Pot	native (Ontario), drought tolerant, full sun, partial sun/shade, attracts butterflies, attracts pollinators, long bloom, low maintenance	10%
Lsp	38	5	<i>Liatris spicata 'Floristan Purple'</i>	Floristan Purple Blazing Star	450	1 Gal.	-	Pot	native (Ontario), drought tolerant, rain garden, full sun, attracts birds, attracts butterflies, attracts pollinators, cutting flower	10%
Lcs	15	2	<i>Lobelia cardinalis</i>	Cardinal Flower	500	1 Gal.	-	Pot	native (Ontario), drought tolerant, rain garden, full sun, partial sun/shade, attracts butterflies, attracts birds, attracts pollinators, cutting flower	5%
Lsa	19	3	<i>Lobelia siphilitica</i>	Great Blue Lobelia	450	1 Gal.	-	Pot	native (Ontario), drought tolerant, rain garden, full sun, partial sun/shade, attracts butterflies, attracts birds, attracts pollinators, cutting flower	5%
Lps	15	2	<i>Lupinus perennis</i>	Sundial Lupine	1000	1 Gal.	-	Pot	native (Ontario), drought tolerant, full sun, attracts birds, attracts butterflies, attracts pollinators, cutting flower, salt tolerant, rock garden	20%
Mda	11	2	<i>Monarda didyma</i>	Beebalm	800	1 Gal.	-	Pot	native (Ontario), drought tolerant, full sun, ethnobotanical, partial sun/shade, attracts butterflies, attracts birds, attracts pollinators, fragrant	10%
Mfa	19	3	<i>Monarda fistulosa</i>	Wild Bergamot	450	1 Gal.	-	Pot	native (Ontario), drought tolerant, full sun, ethnobotanical, partial sun/shade, attracts butterflies, attracts birds, attracts pollinators, fragrant	5%
Pda	19	3	<i>Phlox divancta</i>	Woodland Phlox	450	1 ltr	-	Pot	native (Ontario), drought tolerant, full sun, attracts butterflies, attracts pollinators, fragrant	5%
Eum	7	1	<i>Eupatorium maculatum</i>	Joe Pye Weed	1000	1 Gal.	-	Pot	native (Ontario), drought tolerant, full sun, partial sun/shade, attracts butterflies, attracts pollinators, attracts birds, cutting flower, colourful flowers	10%

PERENNIALS & HERBACEOUS PLANTS (URBAN AREAS) - REFER TO DETAIL 8 SHEET L9										
KEY	PH1 QTY	PH2 QTY	BOTANICAL NAME	COMMON NAME	SPACING mm (O.C.)	SIZE (Pot)	HEIGHT (mm)	ROOT	DESCRIPTION / NOTES	% BED COVER
Ata	85	95	<i>Asclepias tuberosa</i>	Butterfly Milkweed	450	1 Gal.	-	Pot	native (Ontario), drought tolerant, full sun, attracts butterflies, attracts pollinators, cutting flower, rock garden	10%
Epl	85	95	<i>Echinacea pallida</i>	Pale Purple Coneflower	450	1 Gal.	-	Pot	native (Ontario), drought tolerant, full sun, partial sun/shade, attracts birds, attracts butterflies, attracts pollinators, colourful flowers, colourful flowers	10%
Epp	65	73	<i>Echinacea purpurea 'Prairie Splendor'</i>	Prairie Splendor Coneflower	500	1 Gal.	-	Pot	native (Ontario), drought tolerant, full sun, partial sun/shade, attracts birds, attracts butterflies, attracts pollinators, colourful flowers, cutting flower	10%
Gmm	98	110	<i>Geranium macrorrhizum</i>	Bigroot Geranium	500	1 Gal.	-	Pot	native (Ontario), full sun, partial sun/shade, ground cover	15%
Nfi	91	102	<i>Nepeta faassenii 'Cat's Meow'</i>	Catmint	600	1 Gal.	-	Pot	drought tolerant, full sun, partial sun/shade, attracts butterflies, attracts pollinators, fragrant, long bloom, low maintenance	20%
Rhc	91	101	<i>Rudbeckia hirta 'Autumn Colours'</i>	Autumn Colours Gloriosa Daisy	300	1 Gal.	-	Pot	native (Ontario), drought tolerant, full sun, partial sun/shade, attracts butterflies, attracts pollinators, attracts birds, colourful flowers, cutting flower	5%
Cas	49	55	<i>Ceanothus americanus</i>	New Jersey Tea	1000	1 Gal.	-	Pot	native (Ontario), drought tolerant, full sun, partial sun/shade, attracts birds, attracts butterflies, attracts pollinators, fragrant, cutting flower	30%

ORNAMENTAL GRASS (NATURALIZED AREAS) - REFER TO DETAIL 7 SHEET L9										
KEY	PH1 QTY	PH2 QTY	BOTANICAL NAME	COMMON NAME	SPACING mm (O.C.)	SIZE (Pot)	HEIGHT (mm)	ROOT	DESCRIPTION / NOTES	% BED COVER
Ag1	23	11	<i>Andropogon gerardii</i>	Big Bluestem	900	1 Gal.	-	Pot	native (Ontario), drought tolerant, full sun, cutting flower, heat tolerant, fall foliage, long bloom	20%
Bga	31	15	<i>Bouteloua gracilis</i>	Blue Grama	300	1 Gal.	-	Pot	native (Ontario), drought tolerant, full sun, attracts birds, heat tolerant, low maintenance, long bloom, ground cover	3%
Ccs	19	9	<i>Calamagrostis canadensis</i>	Canada Blue Joint	1000	1 Gal.	-	Pot	native (Ontario), rain garden, full sun, partial sun/shade, drought tolerant, long bloom, low maintenance	20%
Cbi	93	44	<i>Carex bebbii</i>	Bebb's Sedge	100	1 Gal.	-	Pot	native (Ontario), full sun, partial sun/shade, rain garden, waters edge	1%
Cca	12	6	<i>Carex comosa</i>	Bristly Sedge	1000	1 Gal.	-	Pot	native (Ontario), drought tolerant, rain garden, full sun, partial sun/shade, attracts birds, long bloom, salt tolerant, low maintenance	13%
Cgi	21	10	<i>Carex grayi</i>	Morning Star Sedge	600	1 Gal.	-	Pot	native (Ontario), drought tolerant, rain garden, full sun, partial sun/shade, cutting flower, long bloom, waters edge	8%
Cpa	17	8	<i>Carex pensylvanica</i>	Wood Sedge	400	1 Gal.	-	Pot	native (Ontario), drought tolerant, rain garden, full sun, partial sun/shade, full shade, attracts birds, low maintenance, ground cover	3%
Csa	19	9	<i>Carex stricta</i>	Tussock Sege	500	1 Gal.	-	Pot	native (Ontario), drought tolerant, rain garden, full sun, partial sun/shade, attracts birds, long bloom, low maintenance, waters edge	5%
Cva	19	9	<i>Carex vulpinoidea</i>	Fox Sedge	500	1 Gal.	-	Pot	native (Ontario), rain garden, full sun, partial sun/shade, attracts birds, low maintenance, waters edge	5%
Hoa	14	7	<i>Hierochloa odorata</i>	Sweet Grass	1200	1 ltr	-	Pot	native (Ontario), ethnobotanical, full sun, partial sun/shade, attracts birds, salt tolerant, waters edge	22%

ORNAMENTAL GRASS (URBAN AREAS) - REFER TO DETAIL 8 SHEET L9										
KEY	PH1 QTY	PH2 QTY	BOTANICAL NAME	COMMON NAME	SPACING mm (O.C.)	SIZE (Pot)	HEIGHT (mm)	ROOT	DESCRIPTION / NOTES	% BED COVER
Dcb	112	155	<i>Deschampsia cespitosa 'Bronze Vail'</i>	Bronze Tufted Hair Grass	500	1 Gal.	-	Pot	native (Ontario), drought tolerant, full sun, partial sun/shade, fall foliage, long bloom, low maintenance, ground cover, rock garden	15%
Dcn	112	155	<i>Deschampsia cespitosa 'Northern Lights'</i>	Variegated Tufted Hair Grass	500	1 Gal.	-	Pot	native (Ontario), drought tolerant, full sun, partial sun/shade, fall foliage, long bloom, low maintenance, ground cover, rock garden	15%
Pvm	66	90	<i>Panicum virgatum</i>	Switch Grass	1000	1 Gal.	-	Pot	native (Ontario), drought tolerant, full sun, attracts birds, cutting flower, heat tolerant, long bloom, salt tolerant, low maintenance	35%
Ssm	104	143	<i>Schizachyrium scoparium</i>	Little Bluestem	600	1 Gal.	-	Pot	native (Ontario), drought tolerant, full sun, cutting flower, heat tolerant, long bloom	20%
Shs	112	155	<i>Sporobolous heterolepis</i>	Prairie Dropseed	500	1 Gal.	-	Pot	native (Ontario), drought tolerant, full sun, attracts birds, fall foliage, heat tolerant	15%

NATIVE SEED MIX	
PH1: 72m2	PH2: 72m2
RAIN GARDEN / WETLAND SOW AT 500g/180m <sup>2</sup>	
BOTANICAL NAME	COMMON NAME
<i>Asclepias incarnata</i>	Swamp Milkweed
<i>Aster puniceus</i>	Purple Stemmed Aster
<i>Bidens cernua</i>	Nodding Bur Marigold
<i>Carex crinita</i>	Fringed/Nodding Sedge
<i>Carex lurida</i>	Lurid Sedge
<i>Carex scopari</i>	Blunt Broom Sedge
<i>Carex stipata</i>	Awl Sedge
<i>Carex vulpinoidea</i>	Fox Sedge
<i>Elymus virginicus</i>	Virginia Wild Rye
<i>Eupatorium maculatum</i>	Spotted Joe Pye Weed
<i>Eupatorium perfoliatu</i>	Bonese
<i>Juncus effusus</i>	Soft Rush
<i>Mimulus ringens</i>	Square Stemmed Monkey Flower
<i>Scirpus cyperinus</i>	Wool Grass
<i>Sparangium eurycarpum</i>	Giant Bur Reed

NATIVE SEED MIX	
PH1: 488m2	PH2: 713m2
DROUGHT TOLERANT / POLLINATOR MEADOW SOW AT 500g/180m <sup>2</sup>	
BOTANICAL NAME	COMMON NAME
<i>Aster novae-angliae</i>	New England Aster
<i>Desmodium canadense</i>	Showy Tick Trefoil
<i>Elymus canadensis</i>	Canada Wild Rye
<i>Elymus virginicus</i>	Virginia Wild Rye
<i>Eupatorium perfoliatum</i>	Bonaset
<i>Liatris spicata</i>	Dense Blazing Star
<i>Monarda fistulosa</i>	Wild Bergamot
<i>Penstemon digitalis</i>	Foxglove / Beardtongue
<i>Rudbeckia hirta</i>	Black Eyed Susan
<i>Schizachyrium scoparium</i>	Little Bluestem
<i>Sorghastrum nutans</i>	Indiangrass
<i>Verbena hastata</i>	Blue Vervain

\\02050001\Planning\_Basic\pape\1604\0375\design\drawing\Production\1604\0375\_L4-L5\PlantingSchedule.dwg  
2025/08/08 11:17:49 AM K. Nitsche



**APPROVED**  
By Kersten Nitsche at 3:31 pm, Aug 08, 2025

**KERSTEN NITSCHKE, MCIP RPP**  
**MANAGER (A), DEVELOPMENT REVIEW WEST**  
**PLANNING, DEVELOPMENT AND BUILDING SERVICES**  
**DEPARTMENT, CITY OF OTTAWA**



**Stantec**

Stantec Consulting Ltd.  
400 - 1331 Clyde Avenue  
Ottawa ON



\\02050001\Planning\Boracocapsa\1604\Projects\160410375\design\drawing\Production\160410375\_L4-L5-PlantingSchedule.dwg  
2025/08/08 11:59:04 by: Kersten Nitsche

PLANTING SCHEDULE (CITY OWNERSHIP)

CONIFEROUS TREES - REFER TO DETAIL 3 SHEET L9									
KEY	QTY	BOTANICAL NAME	COMMON NAME	SPACING (mm O.C.)	CALIPER (mm)	HEIGHT (mm)	ROOT	DESCRIPTION / NOTES	MATURE HEIGHT
TC	3	<i>Tsuga canadensis</i>	Eastern Hemlock	Refer to Plan	-	2000	W.B.	native (Ontario), drought tolerant, low maintenance, full sun	Small (5-10m)
PS	3	<i>Pinus strobus</i>	White Pine	Refer to Plan	-	2000	W.B.	full sun, low maintenance	Small (5-10m)
DECIDUOUS TREES (ON GRADE) - REFER TO DETAIL 1 SHEET L9									
KEY	QTY	BOTANICAL NAME	COMMON NAME	SPACING mm (O.C.)	CALIPER (mm)	HEIGHT (mm)	ROOT	DESCRIPTION / NOTES	MATURE HEIGHT
AR	3	<i>Acer rubrum</i>	Red Maple	Refer to Plan	50	-	W.B.	native (Ontario), fall foliage, full sun, partial sun/shade	Medium (10-15m)
ASL	3	<i>Acer saccharum</i> 'Legacy'	Legacy Sugar Maple	Refer to Plan	50	-	W.B.	native (Ontario), drought tolerant, full sun, fall foliage	Large (15m+)
BA	2	<i>Betula alleghaniensis</i>	Yellow Birch	Refer to Plan	50	-	W.B.	native (Ontario), full sun, partial sun/shade, fall foliage	Medium (10-15m)
JN	1	<i>Juglans nigra</i>	Black Walnut	Refer to Plan	50	-	W.B.	native (Ontario), salt tolerant, drought tolerant, full sun, edible fruit, fall foliage	Large (15m+)
QM	1	<i>Quercus macrocarpa</i>	Bur Oak	Refer to Plan	50	-	W.B.	native (Ontario), drought tolerant, low maintenance, full sun, fall foliage	Medium (10-15m)
TA	3	<i>Tilia americana</i>	Basswood	Refer to Plan	50	-	W.B.	native (Ontario), drought tolerant, full sun, partial sun/shade, attracts butterflies, fragrant	Large (15m+)

MIXED SHRUB BED (NATURALIZED AREAS) - REFER TO DETAIL 6 SHEET L9									
KEY	QTY	BOTANICAL NAME	COMMON NAME	SPACING mm (O.C.)	SIZE	HEIGHT (mm)	ROOT	DESCRIPTION / NOTES	% BED COVER
Als	4	<i>Amelanchier laevis</i>	Downy Serviceberry	3000	3 Gal.	-	Pot	native (Ontario), full sun, partial sun/shade, attracts birds, fall foliage	34.00%
Cos	2	<i>Cephalanthus occidentalis</i>	Buttonbush	1500	2 Gal.	-	Pot	native (Ontario), rain garden, full sun, partial sun/shade, attracts butterflies, fragrant, long bloom, waters edge	6.00%
Caa	3	<i>Cornus alternifolia</i>	Pagoda Dogwood	1200	3 Gal.	-	Pot	native (Ontario), full sun, partial sun/shade, attracts birds, attracts butterflies, fall foliage, fragrant, low maintenance	5.00%
Cam	3	<i>Cornus amomum</i>	Silky Dogwood	2000	2 Gal.	-	Pot	native (Ontario), full sun, partial sun/shade, attracts birds	15.00%
Csa	6	<i>Cornus alba</i> 'Ivory Halo®' (Bailho)	Ivory Halo® Dogwood	1500	2 Gal.	-	Pot	native (Ontario), partial sun/shade, full sun, attracts birds, fall foliage, salt tolerant	15.00%
Dia	5	<i>Diervilla lonicera</i>	Bush Honeysuckle	750	3 Gal.	-	Pot	native (Ontario), drought tolerant, full sun, full shade, partial sun/shade, attracts butterflies, fall foliage, fragrant, low maintenance	3.00%
Scs	3	<i>Sambucus canadensis</i>	Canada Elderberry	2000	3 Gal.	-	Pot	native (Ontario), full sun, partial sun/shade, attracts birds, attracts butterflies, edible, fragrant	15.00%
Saa	5	<i>Spirea alba</i>	White Meadowsweet	600	3 Gal.	-	Pot	native (Ontario), partial sun/shade, full sun, attracts butterflies, fall foliage, long bloom, salt tolerant, low maintenance, waters edge	2.00%
Sas	4	<i>Symphoricarpos albus</i>	Snowberry	1000	3 Gal.	-	Pot	native (Ontario), drought tolerant, full sun, partial sun/shade, attracts birds, low maintenance	5.00%

PERENNIALS & HERBACEOUS PLANTS (NATURALIZED AREAS) - REFER TO DETAIL 7 SHEET L9									
KEY	QTY	BOTANICAL NAME	COMMON NAME	SPACING mm (O.C.)	SIZE (Pot)	HEIGHT (mm)	ROOT	DESCRIPTION / NOTES	% BED COVER
Aia	11	<i>Asclepias incarnata</i>	Swamp Milkweed	800	1 Gal.	-	Pot	native (Ontario), rain garden, full sun, partial sun/shade, attracts butterflies, attracts pollinators, cutting flower, waters edge	15.00%
Ata	13	<i>Asclepias tuberosa</i>	Butterfly Milkweed	450	1 Gal.	-	Pot	native (Ontario), drought tolerant, full sun, attracts butterflies, attracts pollinators, cutting flower, rock garden	5.00%
Cif	27	<i>Coreopsis lanceolata</i>	Lance-Leaved Tickseed	450	1 Gal.	-	Pot	native (Ontario), drought tolerant, full sun, partial sun/shade, attracts butterflies, attracts pollinators, long bloom, low maintenance	10.00%
Lsp	27	<i>Liatris spicata</i> 'Floristan Purple'	Floristan Purple Blazing Star	450	1 Gal.	-	Pot	native (Ontario), drought tolerant, rain garden, full sun, attracts birds, attracts butterflies, attracts pollinators, cutting flower	10.00%
Lcs	10	<i>Lobelia cardinalis</i>	Cardinal Flower	500	1 Gal.	-	Pot	native (Ontario), drought tolerant, rain garden, full sun, partial sun/shade, attracts butterflies, attracts birds, attracts pollinators, cutting flower	5.00%
Lsa	13	<i>Lobelia siphilitica</i>	Great Blue Lobelia	450	1 Gal.	-	Pot	native (Ontario), drought tolerant, rain garden, full sun, partial sun/shade, attracts butterflies, attracts birds, attracts pollinators, cutting flower	5.00%
Lps	10	<i>Lupinus perennis</i>	Sundial Lupine	1000	1 Gal.	-	Pot	native (Ontario), drought tolerant, full sun, attracts birds, attracts butterflies, attracts pollinators, cutting flower, salt tolerant, rock garden	20.00%
Mda	8	<i>Monarda didyma</i>	Beebalm	800	1 Gal.	-	Pot	native (Ontario), drought tolerant, full sun, ethnobotanical, partial sun/shade, attracts butterflies, attracts birds, attracts pollinators, fragrant	10.00%
Mfa	13	<i>Monarda fistulosa</i>	Wild Bergamot	450	1 Gal.	-	Pot	native (Ontario), drought tolerant, full sun, ethnobotanical, partial sun/shade, attracts butterflies, attracts birds, attracts pollinators, fragrant	5.00%
Pda	13	<i>Phlox divaricta</i>	Woodland Phlox	450	1 ltr	-	Pot	native (Ontario), drought tolerant, full sun, attracts butterflies, attracts pollinators, fragrant	5.00%
Eum	5	<i>Eupatorium maculatum</i>	Joe Pye Weed	1000	1 Gal.	-	Pot	native (Ontario), drought tolerant, full sun, partial sun/shade, attracts butterflies, attracts pollinators, attracts birds, cutting flower, colourful flowers	10.00%

ORNAMENTAL GRASS (NATURALIZED AREAS) - REFER TO DETAIL 7 SHEET L9									
KEY	QTY	BOTANICAL NAME	COMMON NAME	SPACING mm (O.C.)	SIZE (Pot)	HEIGHT (mm)	ROOT	DESCRIPTION / NOTES	% BED COVER
Ag1	16	<i>Andropogon gerardii</i>	Big Bluestem	900	1 Gal.	-	Pot	native (Ontario), drought tolerant, full sun, cutting flower, heat tolerant, fall foliage, long bloom	20.00%
Bga	22	<i>Bouteloua gracilis</i>	Blue Grama	300	1 Gal.	-	Pot	native (Ontario), drought tolerant, full sun, attracts birds, heat tolerant, low maintenance, long bloom, ground cover	3.00%
Ccs	13	<i>Calamagrostis canadensis</i>	Canada Blue Joint	1000	1 Gal.	-	Pot	native (Ontario), rain garden, full sun, partial sun/shade, drought tolerant, long bloom, low maintenance	20.00%
Cbi	67	<i>Carex bebbii</i>	Bebb's Sedge	100	1 Gal.	-	Pot	native (Ontario), full sun, partial sun/shade, rain garden, waters edge	1.00%
Cca	9	<i>Carex comosa</i>	Bristly Sedge	1000	1 Gal.	-	Pot	native (Ontario), drought tolerant, rain garden, full sun, partial sun/shade, attracts birds, long bloom, salt tolerant, low maintenance	13.00%
Cgi	15	<i>Carex grayi</i>	Moming Star Sedge	600	1 Gal.	-	Pot	native (Ontario), drought tolerant, rain garden, full sun, partial sun/shade, cutting flower, long bloom, waters edge	8.00%
Cpa	13	<i>Carex pensylvanica</i>	Wood Sedge	400	1 Gal.	-	Pot	native (Ontario), drought tolerant, rain garden, full sun, partial sun/shade, full shade, attracts birds, low maintenance, ground cover	3.00%
Csa	13	<i>Carex stricta</i>	Tussock Sege	500	1 Gal.	-	Pot	native (Ontario), drought tolerant, rain garden, full sun, partial sun/shade, attracts birds, long bloom, low maintenance, waters edge	5.00%
Cva	13	<i>Carex vulpinoidea</i>	Fox Sedge	500	1 Gal.	-	Pot	native (Ontario), rain garden, full sun, partial sun/shade, attracts birds, low maintenance, waters edge	5.00%
Hoa	10	<i>Hierochloa odorata</i>	Sweet Grass	1200	1 ltr	-	Pot	native (Ontario), ethnobotanical, full sun, partial sun/shade, attracts birds, salt tolerant, waters edge	22.00%

NATIVE SEED MIX (826 4M")	
DROUGHT TOLERNAT POLLINATOR MEADOW	
SOW AT 500g/180M <sup>2</sup>	
BOTANICAL NAME	COMMON NAME
<i>Aster novae-angliae</i>	New England Aster
<i>Desmodium canadense</i>	Showy Tick Trefoil
<i>Elymus canadensis</i>	Canada Wild Rye
<i>Elymus virginicus</i>	Virginia Wild Rye
<i>Eupatorium perfoliatum</i>	Boneset
<i>Liatris spicata</i>	Dense Blazing Star
<i>Monarda fistulosa</i>	Wild Bergamot
<i>Penstemon digitalis</i>	Foxglove / Beardtongue
<i>Rudbeckia hirta</i>	Black Eyed Susan
<i>Schizachyrium scorparium</i>	Little Bluestem
<i>Sorghastrum nutans</i>	Indiangrass
<i>Verbena hastata</i>	Blue Vervain

APPROVED  
By Kersten Nitsche at 3:31 pm, Aug 08, 2025

KERSTEN NITSCHKE, MCIP RPP  
MANAGER (A), DEVELOPMENT REVIEW WEST  
PLANNING, DEVELOPMENT AND BUILDING SERVICES  
DEPARTMENT, CITY OF OTTAWA



Stantec Consulting Ltd.  
400 - 1331 Clyde Avenue  
Ottawa ON  
Tel. 613.722.4420  
www.stantec.com

Copyright Reserved

The Contractor shall verify and be responsible for all dimensions. DO NOT scale the drawing - any errors or omissions shall be reported to Stantec without delay.  
The Copyrights to all designs and drawings are the property of Stantec. Reproduction or use for any purpose other than that authorized by Stantec is forbidden.

Legend

Notes

2	ISSUED FOR CITY REVIEW	TA	KP 25.06.04
1	60% DETAIL SUBMISSION	TA	KP 25.04.16
0	ISSUED FOR CITY REVIEW	TA	KP 25.02.20
Revision		By	Appd. YY.MM.DD

File Name:	160410375-L200	BL	KP / IL	KP / BL	23.11.22
		Dwn.	Chkd.	Dsgn.	YY.MM.DD

Permit-Seal



Client/Project

WINDMILL DEVELOPMENT GROUP LTD.

2475 REGINA STREET

Ottawa, ON

Title

PLANTING SCHEDULE  
CITY OWNERSHIP

Project No.	Scale	
160410375		
Drawing No.	Sheet	Revision

L5

5 of 9

2

PLAN NUMBER: 19267

D07-12-24-01 61



5	60% DETAIL SUBMISSION	TA	KP	25.04.16
4	ISSUED FOR CITY REVIEW	TA	KP	25.02.20
3	ISSUED FOR CITY REVIEW	TA	KP	24.11.28
2	ISSUED FOR COORDINATION	TA	KP	24.11.15
6	ISSUED FOR CITY REVIEW	TA	KP	25.06.04

Revision	By	Appd.	YY.MM.DD
----------	----	-------	----------

File Name:	160410375-L200	BL	KP / IL	KP / BL	23.11.22
		Dwn.	Chkd.	Dsgn.	YY.MM.DD

Permit-Seal



Client/Project  
WINDMILL DEVELOPMENT GROUP LTD.

2475 REGINA STREET

Ottawa, ON

Title  
LANDSCAPE SECTIONS /  
ELEVATIONS - I

Project No.	Scale	Revision
160410375	AS NOTED	
Drawing No.	Sheet	

L6

6 of 9

6

PLAN NUMBER: 19267

APPROVED

By Kersten Nitsche at 3:31 pm, Aug 08, 2025

*Kersten Nitsche*

KERSTEN NITSCHKE, MCIP RPP  
MANAGER (A), DEVELOPMENT REVIEW WEST  
PLANNING, DEVELOPMENT AND BUILDING SERVICES  
DEPARTMENT, CITY OF OTTAWA

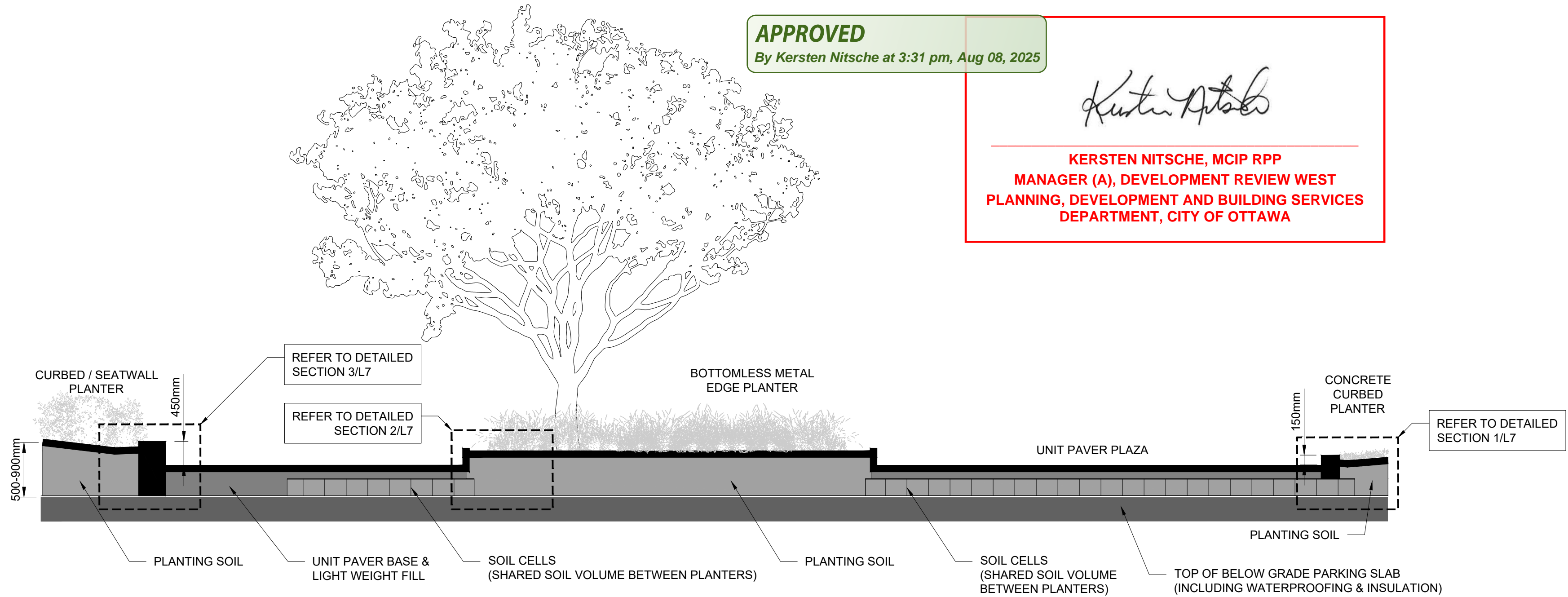

1 SECTION / ELEVATION: COMMON PLAZA  
L6 SCALE 1:50

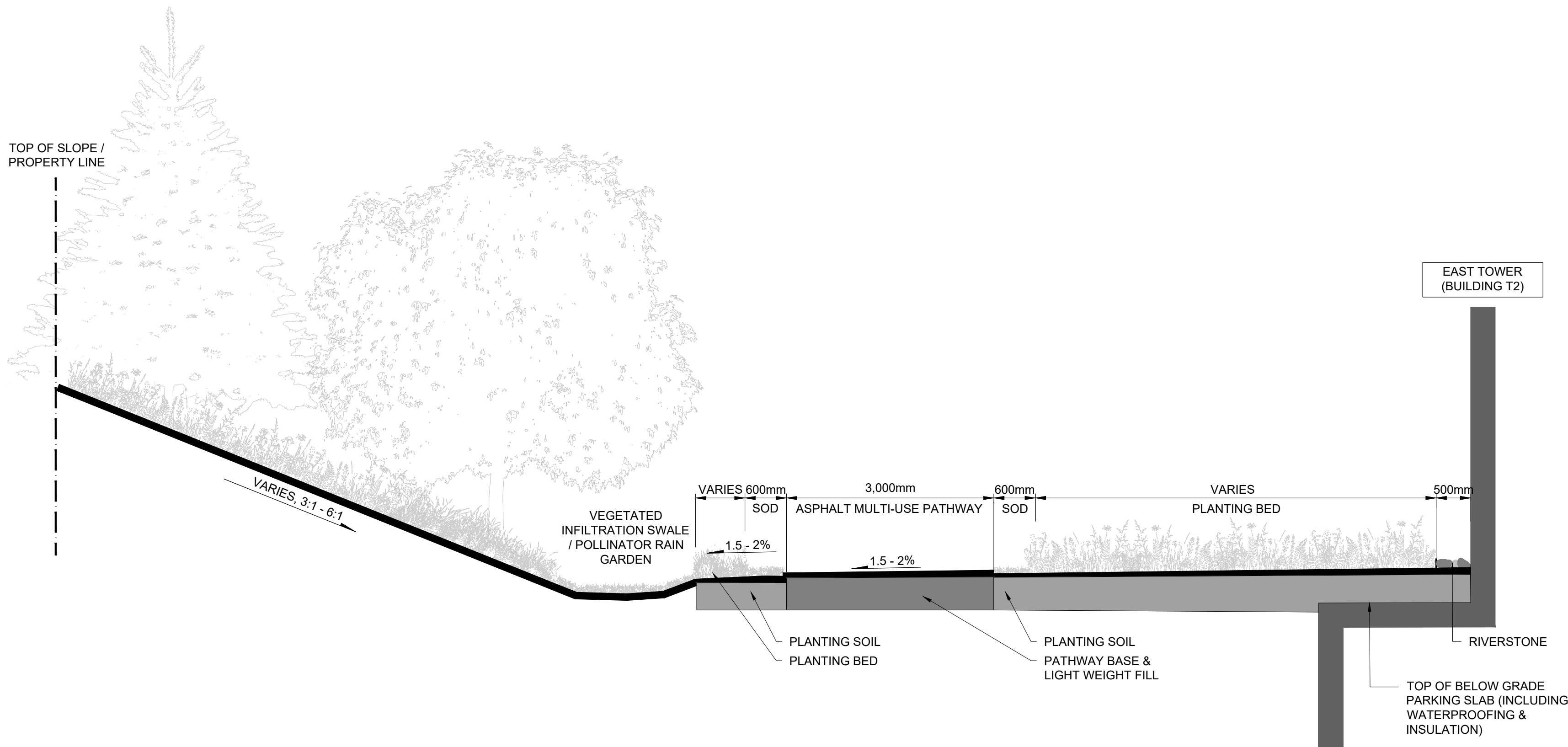

2 SECTION / ELEVATION: EAST TOWER SOUTH EMBANKMENT  
L6 SCALE 1:50

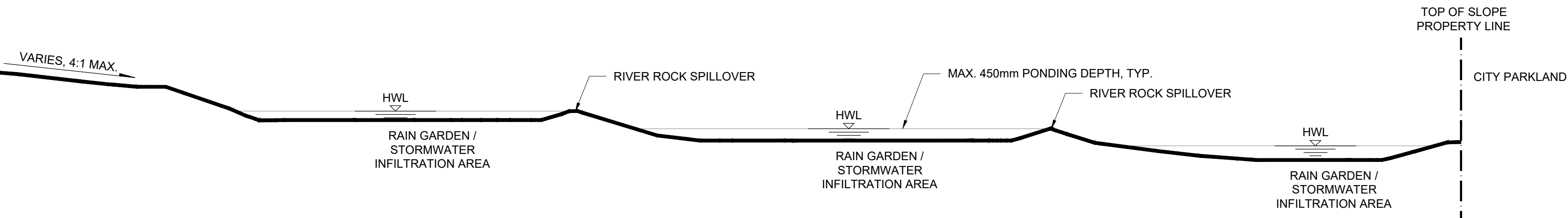

3 SECTION: PARKWAY HOUSE POLLINATOR RAIN GARDEN (N-S LONGITUDINAL VIEW)  
L6 SCALE 1:100

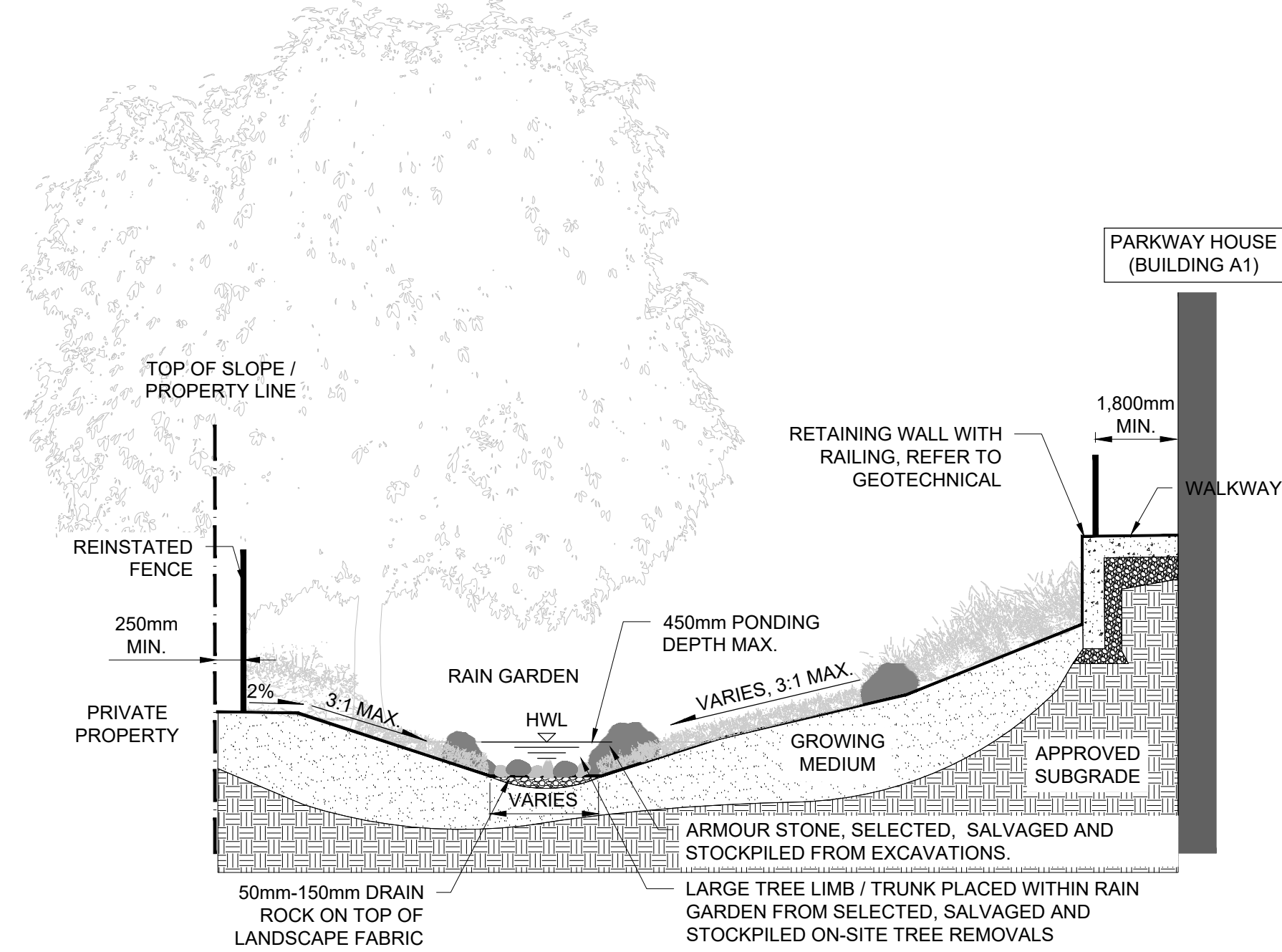

4 SECTION / ELEVATION: PARKWAY HOUSE POLLINATOR RAIN GARDEN  
L6 SCALE 1:50

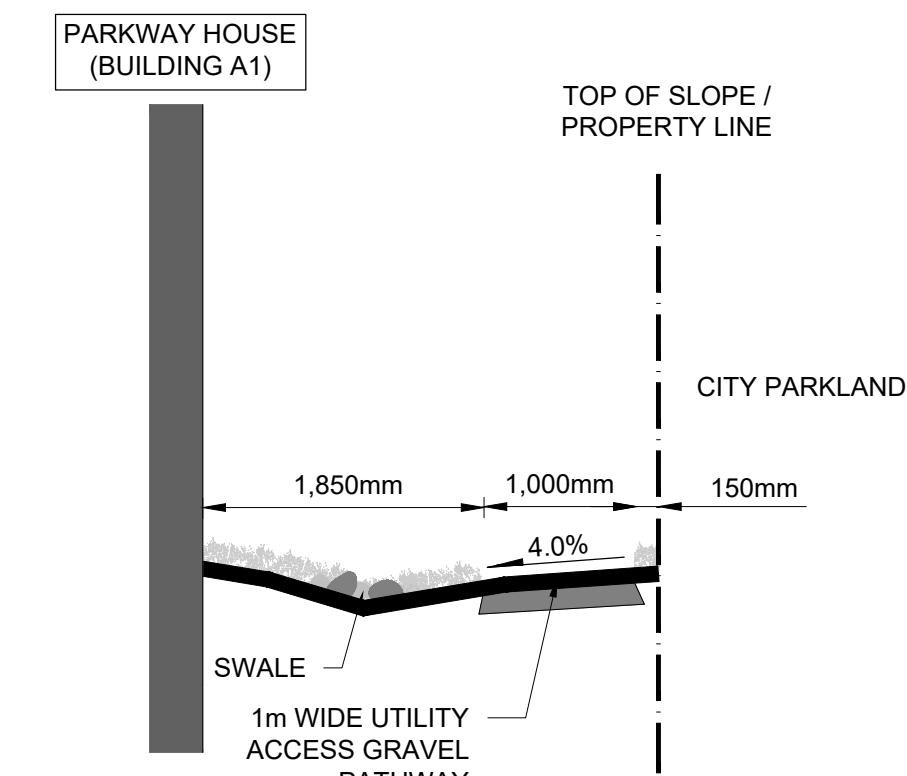

5 SECTION / ELEVATION: A1 REAR UTILITY PATHWAY AND SWALE  
L6 SCALE 1:50

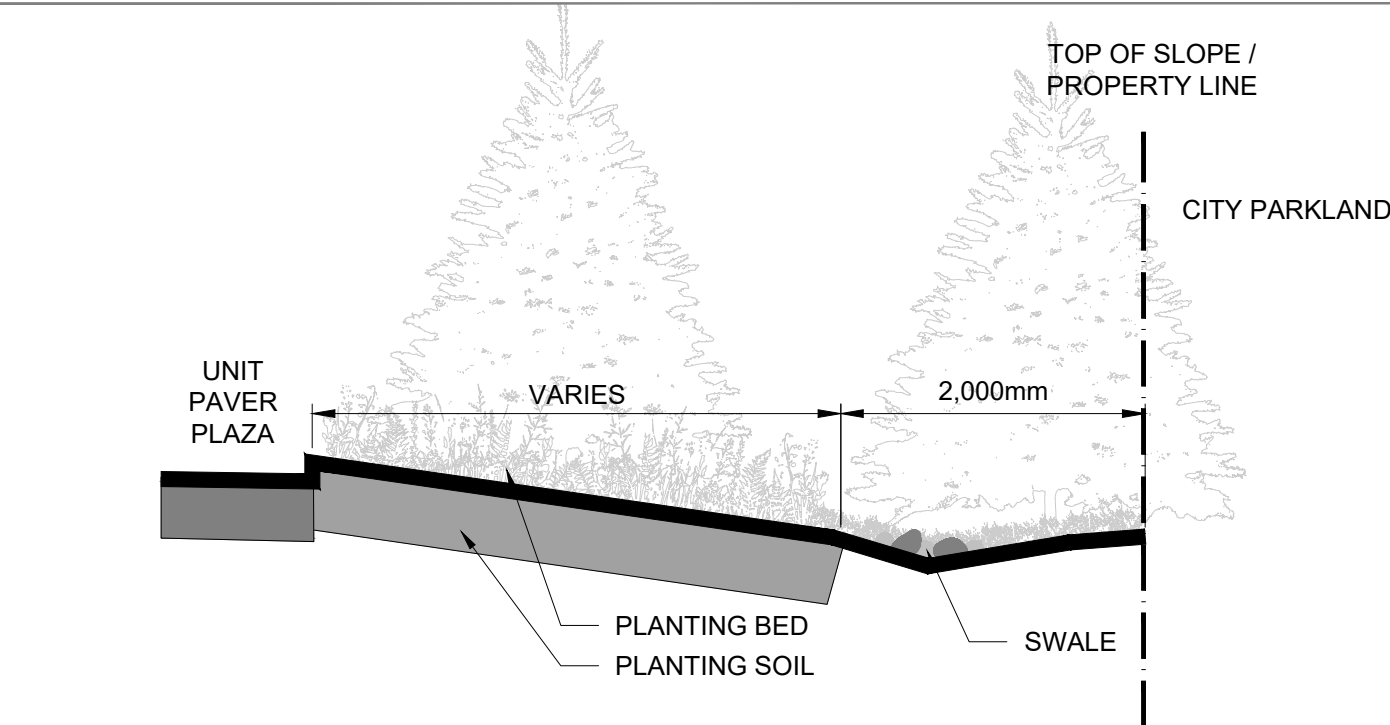

6 SECTION / ELEVATION: NORTH SWALE AND PLANTING BED  
L6 SCALE 1:50

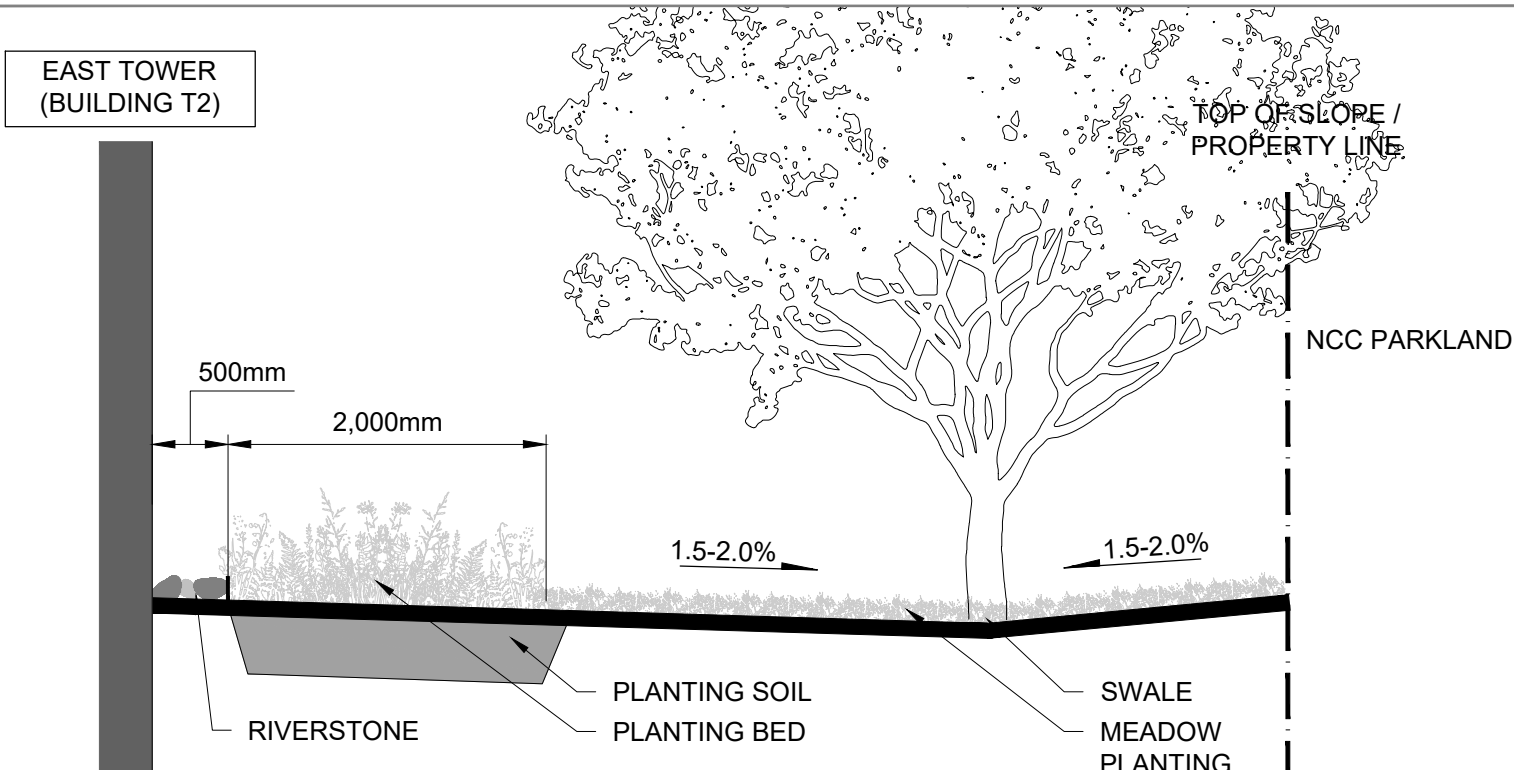

7 SECTION / ELEVATION: EAST TOWER EASTERN EDGE WITH SWALE  
L6 SCALE 1:50





The Contractor shall verify and be responsible for all dimensions, DO NOT scale the drawing - any errors or omissions shall be reported to Stantec without delay.

The Copyrights to all designs and drawings are the property of Stantec. Reproduction or use for any purpose other than that authorized by Stantec is forbidden.

## Notes

2	ISSUED FOR CITY REVIEW	TA	KP	25.06.04
1	60% DETAIL SUBMISSION	TA	KP	25.04.16
0	ISSUED FOR CITY REVIEW	TA	KP	25.02.20
Revision		By	Appd.	YY.MM.DD

File Name: 160410375-L200	BL	KP / IL	KP / BL	23.11.22
	Dwn.	Chkd.	Dsgn.	YY.MM.DD

Permit-Seal



Client/Project

WINDMILL DEVELOPMENT GROUP LTD.

2475 REGINA STREET

Ottawa, ON

Title

LANDSCAPE SECTIONS /  
ELEVATIONS - II

Project No.

160410375

Scale

AS NOTED

Sheet

Revision

L7

7 of 9

2

PLAN NUMBER: 19267

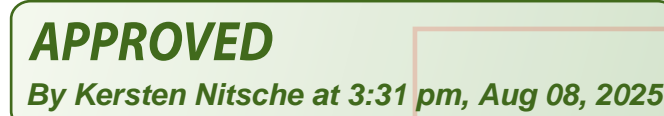

Kurtin Pitsch

**KERSTEN NITSCHKE, MCIP RPP**  
**MANAGER (A), DEVELOPMENT REVIEW WEST**  
**PLANNING, DEVELOPMENT AND BUILDING SERVICES**  
**DEPARTMENT, CITY OF OTTAWA**

L7 SCALE 1:20

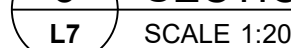
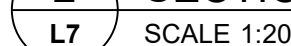



**APPROVED**

By Kersten Nitsche at 3:31 pm, Aug 08, 2025

**KERSTEN NITSCHKE, MCIP RPP**

**MANAGER (A), DEVELOPMENT REVIEW WEST  
PLANNING, DEVELOPMENT AND BUILDING SERVICES  
DEPARTMENT, CITY OF OTTAWA**

5	60% DETAIL SUBMISSION	TA	KP	25.04.16
4	ISSUED FOR CITY REVIEW	TA	KP	25.02.20
3	ISSUED FOR CITY REVIEW	TA	KP	24.11.28
2	ISSUED FOR COORDINATION	TA	KP	24.11.15
6	ISSUED FOR CITY REVIEW	TA	KP	25.06.04

Revision By Appd. YY.MM.DD

File Name: 160410375-L200 CA KP / IL KP / BL 23.11.22  
Dwn. Chkd. Dsgn. YY.MM.DD

Permit-Seal



Client/Project  
WINDMILL DEVELOPMENT GROUP LTD.

2475 REGINA STREET

Ottawa, ON

Title  
LANDSCAPE DETAILS &  
GENERAL NOTES - I

Project No.  
160410375

Scale  
AS NOTED

Drawing No. Sheet Revision

L8

8 of 9

6

PLAN NUMBER: 19267

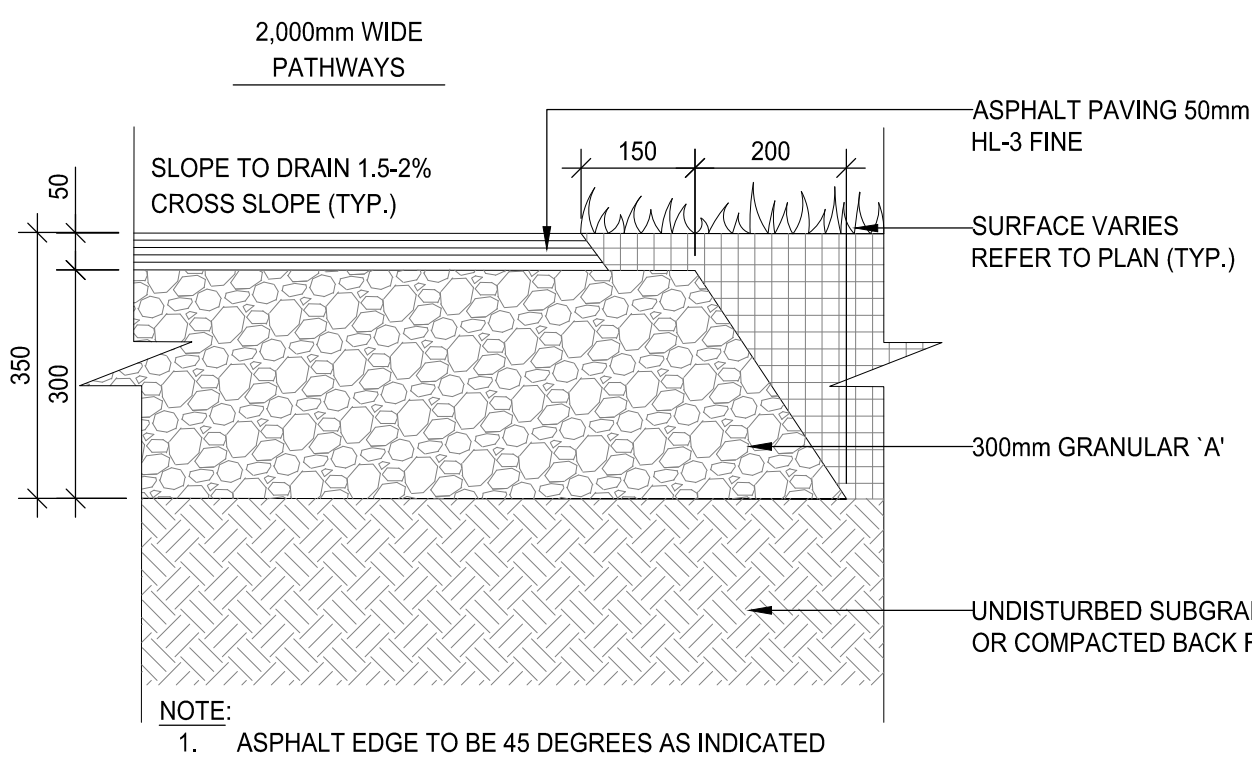

**1 ASPHALT PAVING FOR PATHWAYS ON GRADE**  
SCALE 1:10

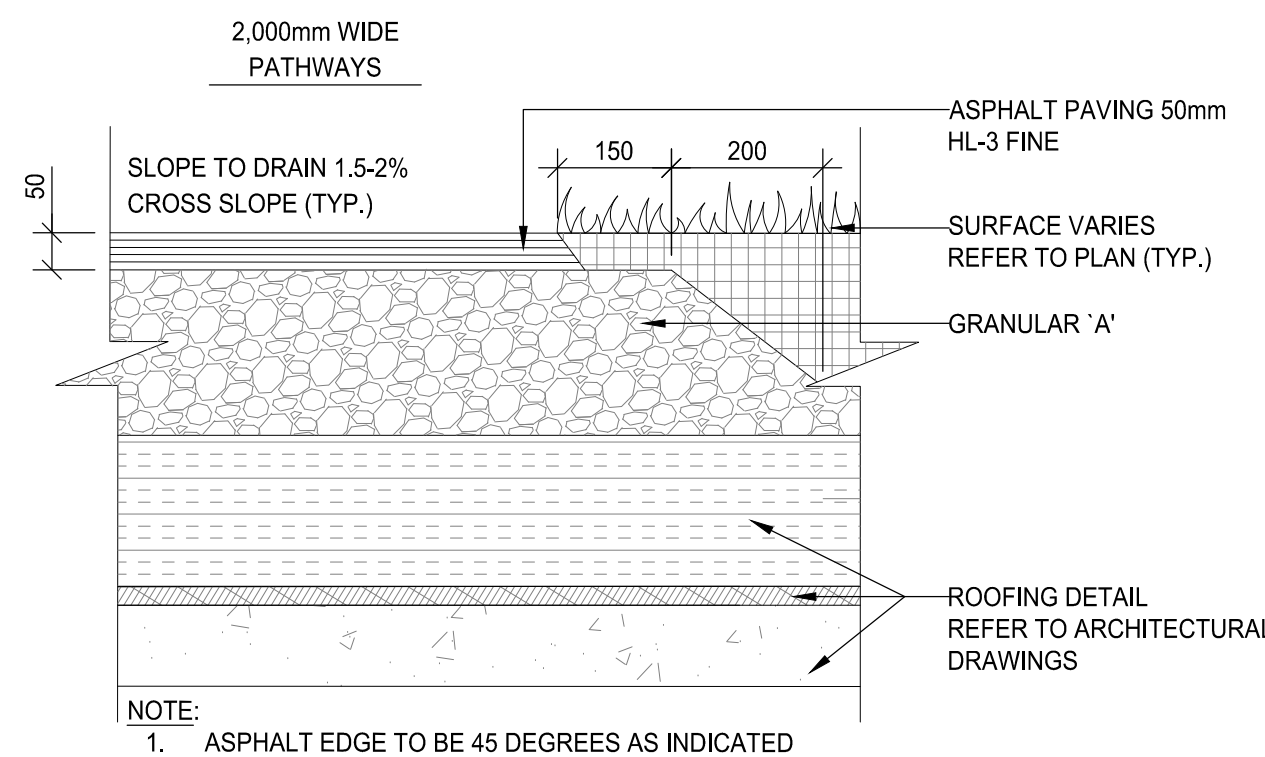

**2 ASPHALT PAVING FOR PATHWAYS ON SLAB**  
SCALE 1:10

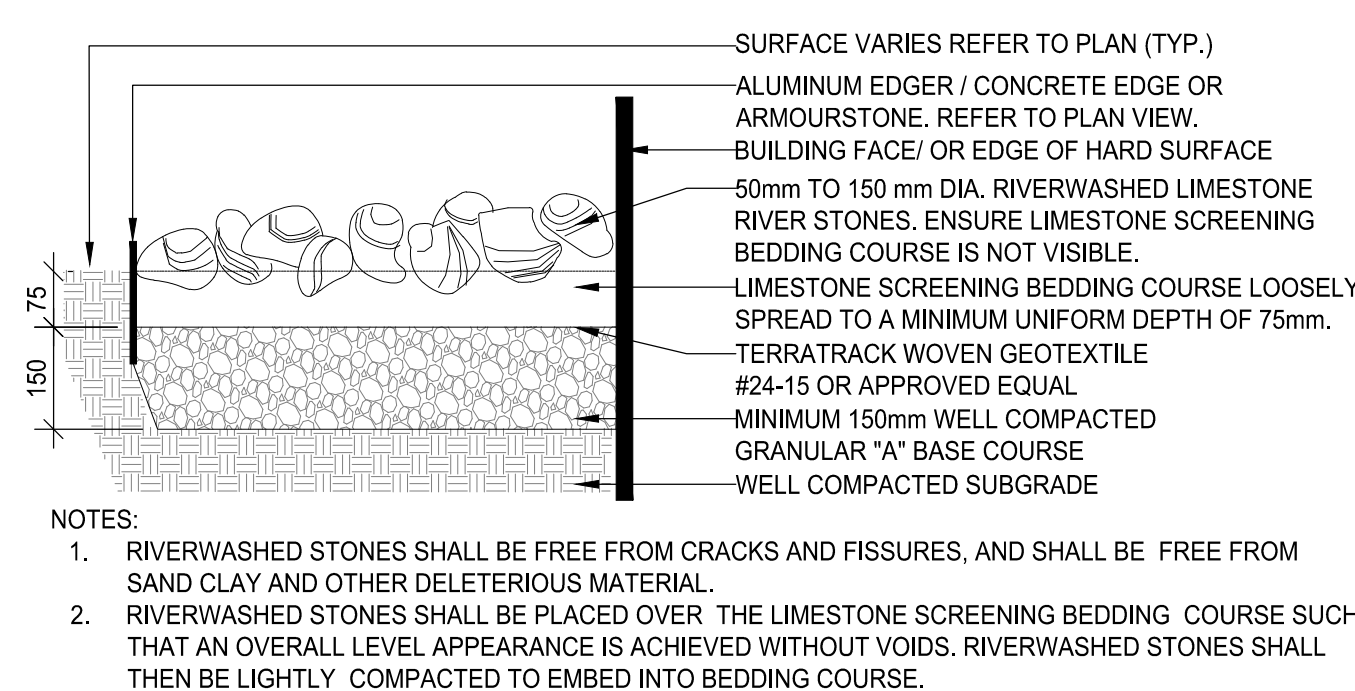

**3 RIVERWASHED STONES ON GRADE**  
SCALE 1:10

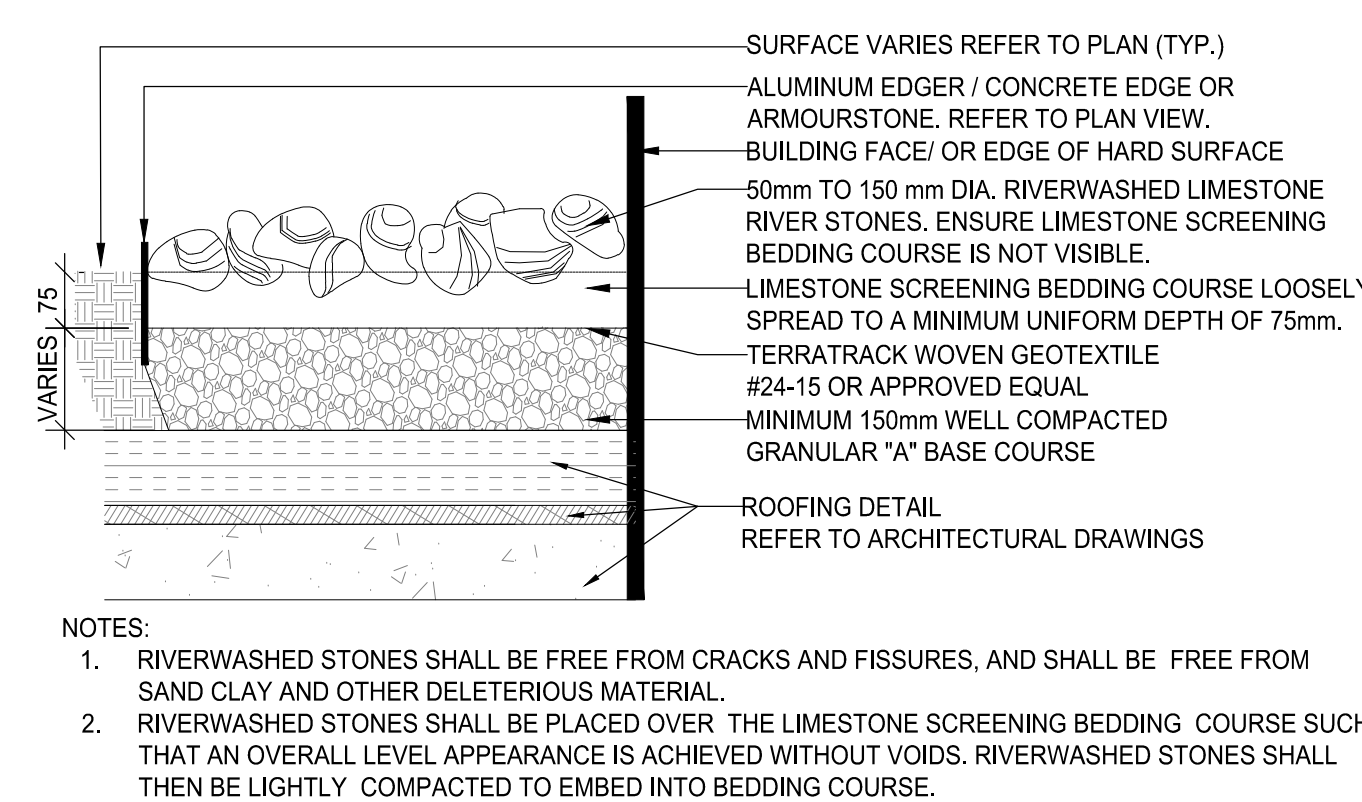

**4 RIVERWASHED STONES ON SLAB**  
SCALE 1:10

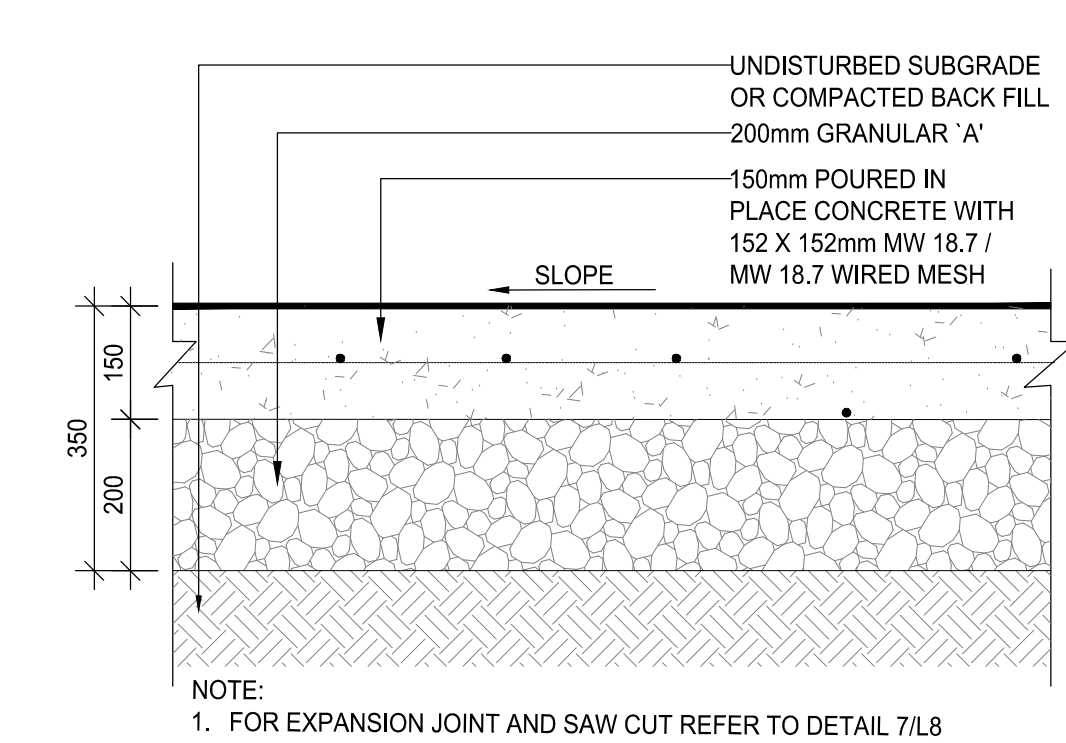

**5 CONCRETE PAVEMENT DETAIL ON GRADE**  
SCALE 1:10

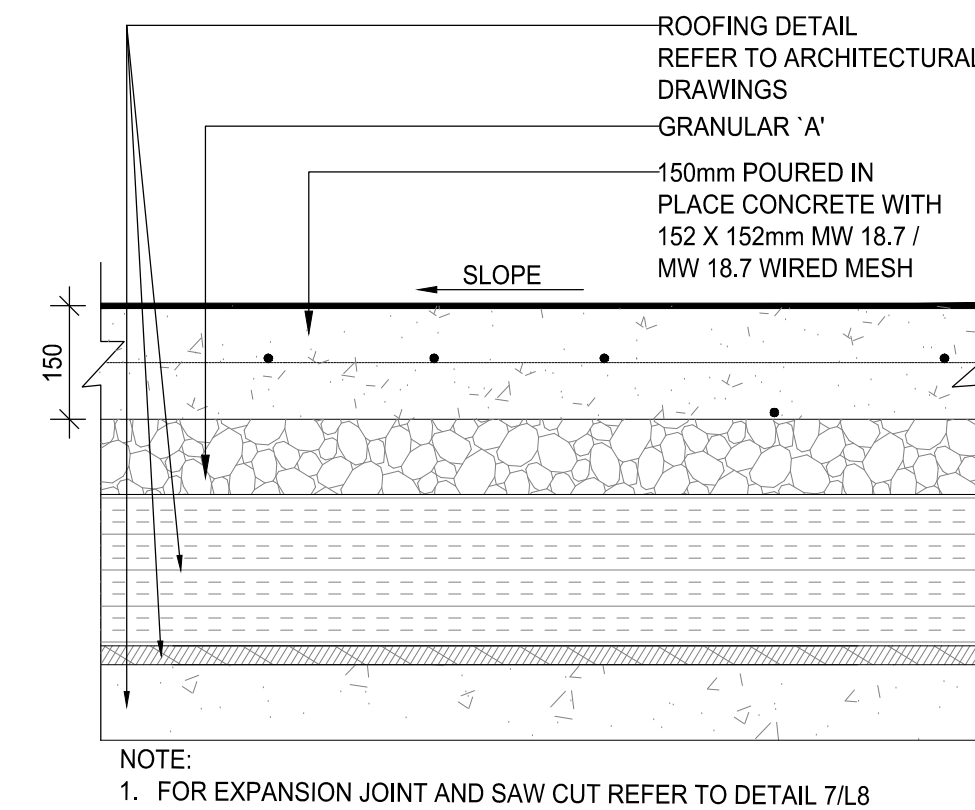

**6 CONCRETE PAVEMENT DETAIL ON SLAB**  
SCALE 1:10

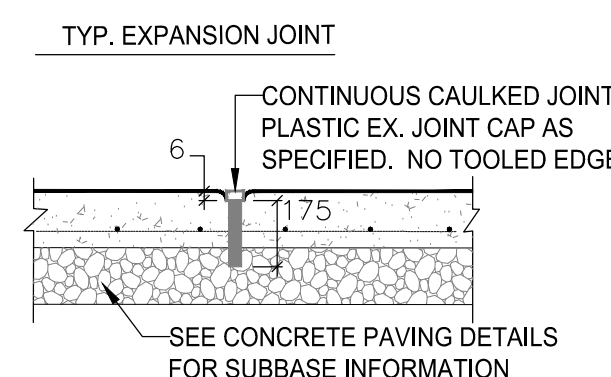

- NOTES:
1. TOP OF JOINT CAP TO BE FLUSH WITH TOP OF PAVEMENT. REMOVE TOP OF CAP BEFORE CAULKING.
  2. FINISH ALL EXPOSED EXPANSION JOINTS WITH CONTINUOUS CAULK ON TOP.
  3. REFER TO SPECIFICATIONS FOR JOINT TYPE.
  4. BITUMEN FIBRE EXPANSION JOINT TO BE MAX. 10mm WIDTH.
  5. STEEL DOWELS 10m X 600mm.
  6. GREASE AND SLEEVE ON END.

**7 CONCRETE JOINTS DETAIL**  
SCALE 1:20

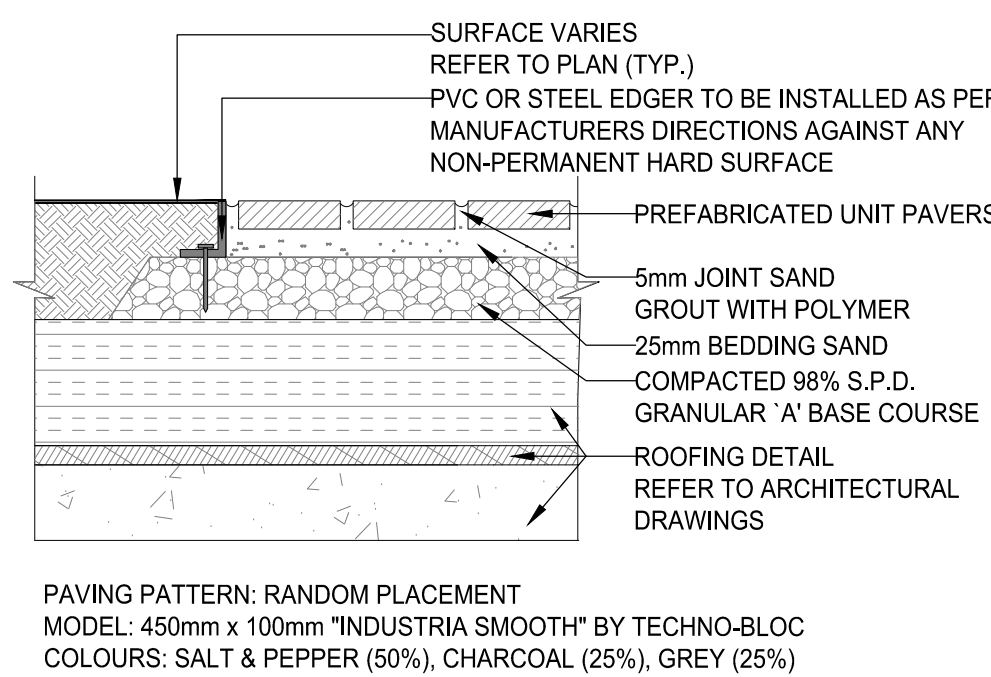
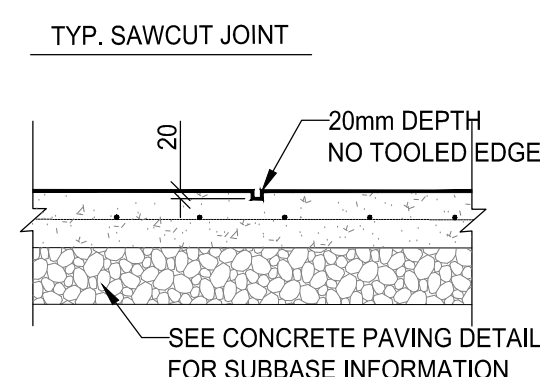

**8 UNIT PAVING DETAIL ON SLAB**  
SCALE 1:10

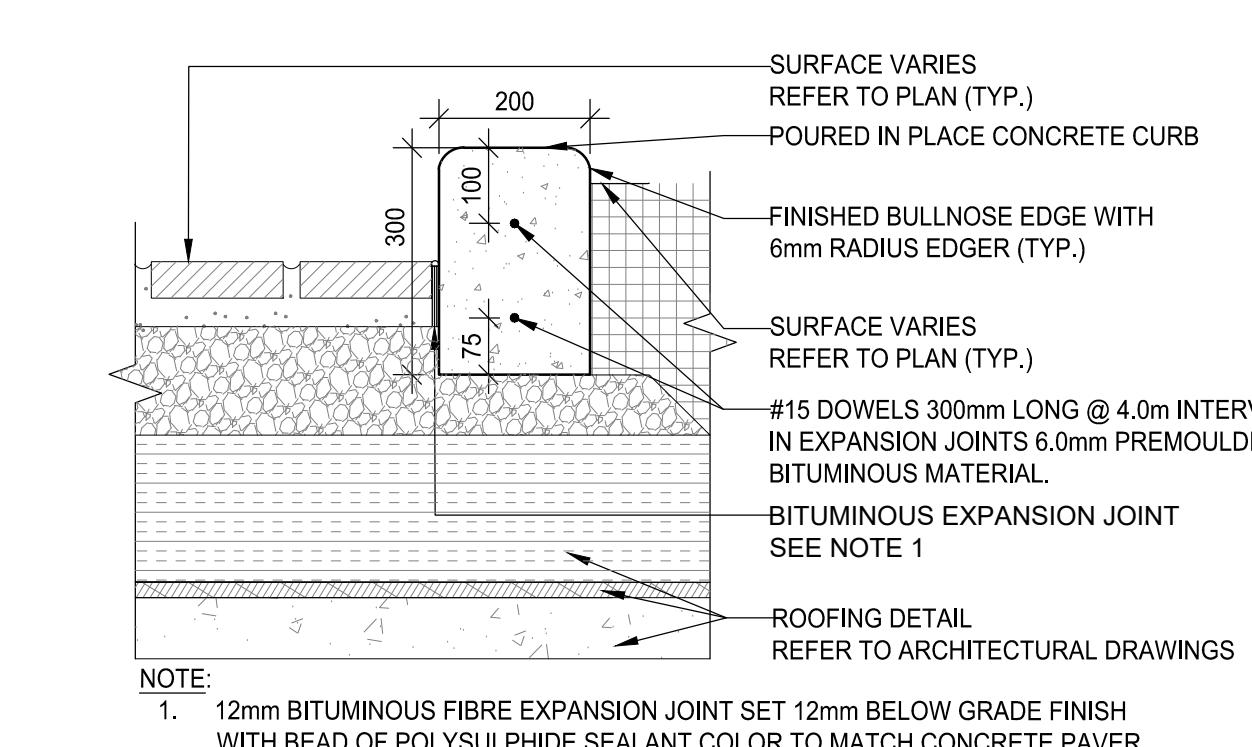

**9 CONCRETE PLANTING BED CURB ON SLAB**  
SCALE 1:10

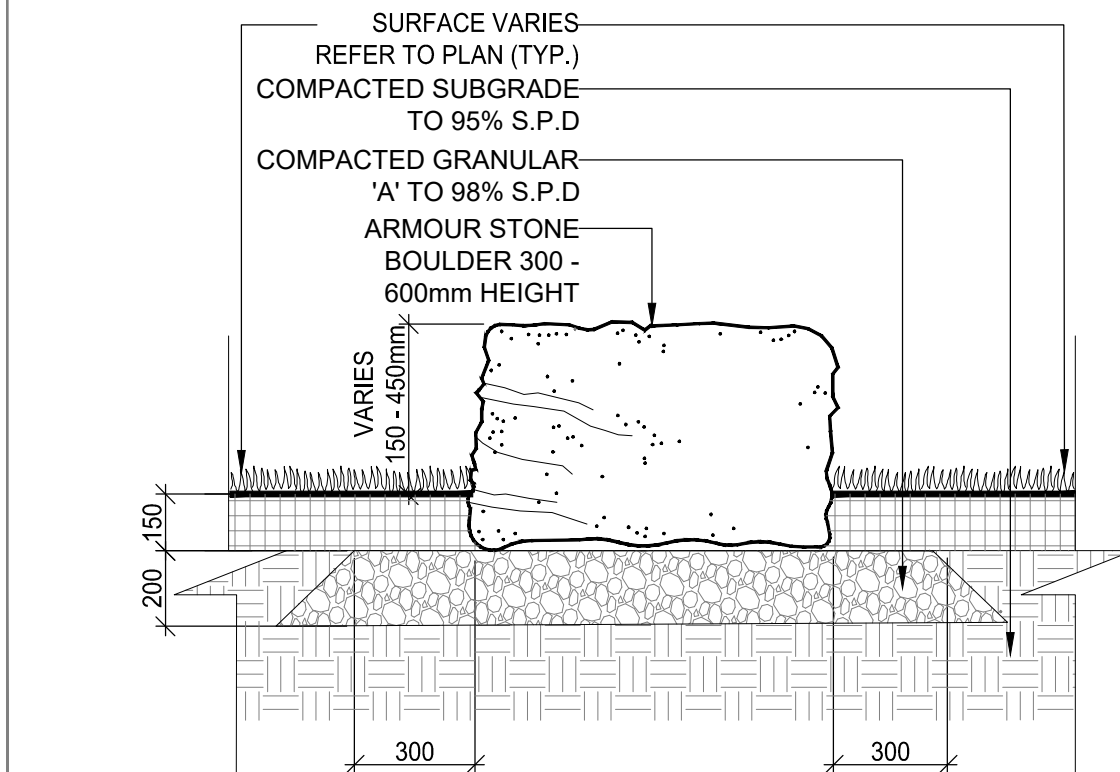

**10 ARMOURSTONE BOULDER**  
SCALE 1:20

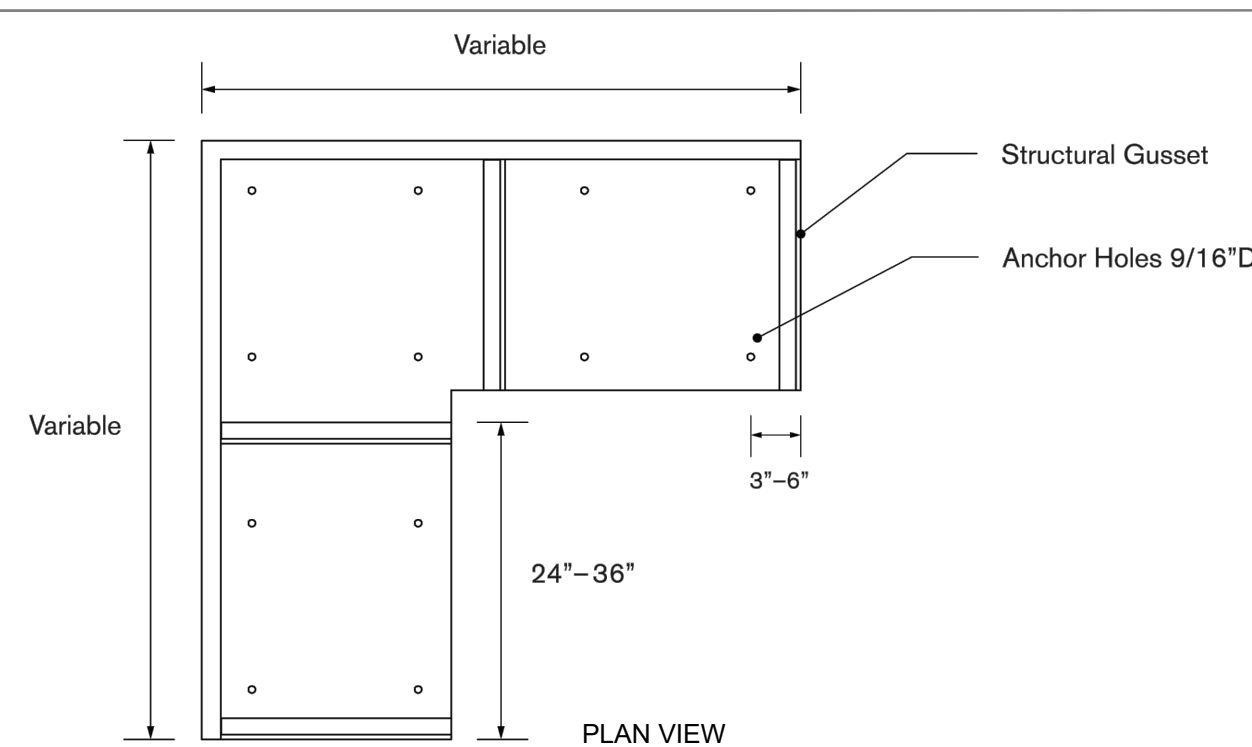

- NOTES:
1. PLANTERS TO BE 'JOIN EDGING' BY GREEN THEORY OR APPROVED EQUIVALENT.
  2. GREEN THEORY CONTACT: TEL: 519-544-2345 EMAIL: info@greentheory.com
  3. LAYOUT AS INDICATED ON LANDSCAPE PLAN.
  4. HEIGHT: 600mm (24")
  5. COLOR: MATTIE BLACK
  6. SHOP DRAWINGS OF PLANTERS TO BE PROVIDED FOR APPROVAL BY LANDSCAPE ARCHITECT PRIOR TO PLACE ORDER.

**11 HEAVY DUTY ALUMINUM PLANTER**  
SCALE N.T.S.

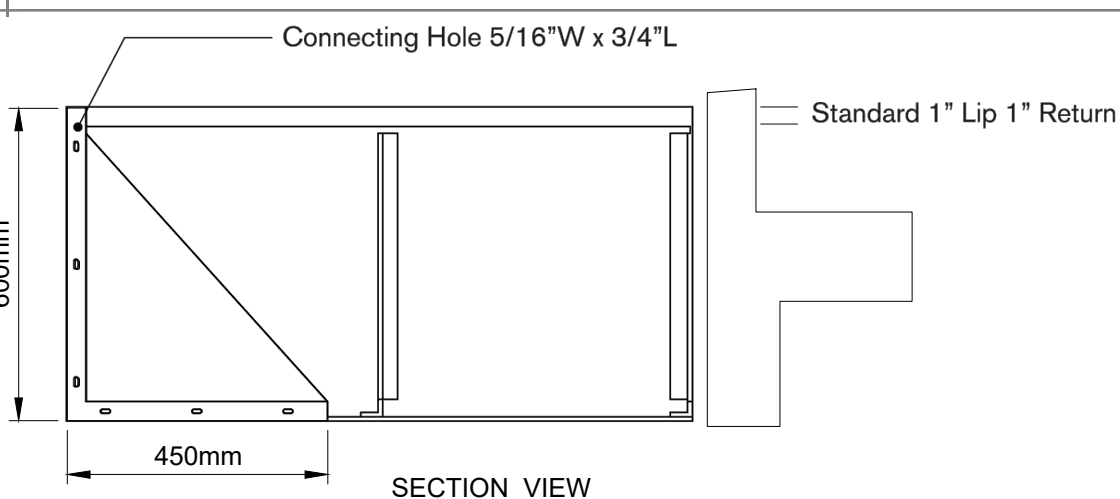

- NOTES:
1. PLEASE CONTACT MANUFACTURER FOR FINISH AND COVERING OPTIONS.
  2. INSTALLATION TO BE COMPLETED IN ACCORDANCE WITH MANUFACTURER'S SPECIFICATIONS.
  3. THIS DRAWING IS INTENDED FOR USE BY ARCHITECTS, ENGINEERS, CONTRACTORS, CONSULTANTS AND DESIGN PROFESSIONALS FOR PLANNING PURPOSES ONLY. THIS DRAWING MAY NOT BE USED FOR CONSTRUCTION.
  4. ALL INFORMATION CONTAINED HEREIN WAS CURRENT AT THE TIME OF DEVELOPMENT BUT MUST BE REVIEWED AND APPROVED BY THE PRODUCT MANUFACTURER TO BE CONSIDERED ACCURATE.

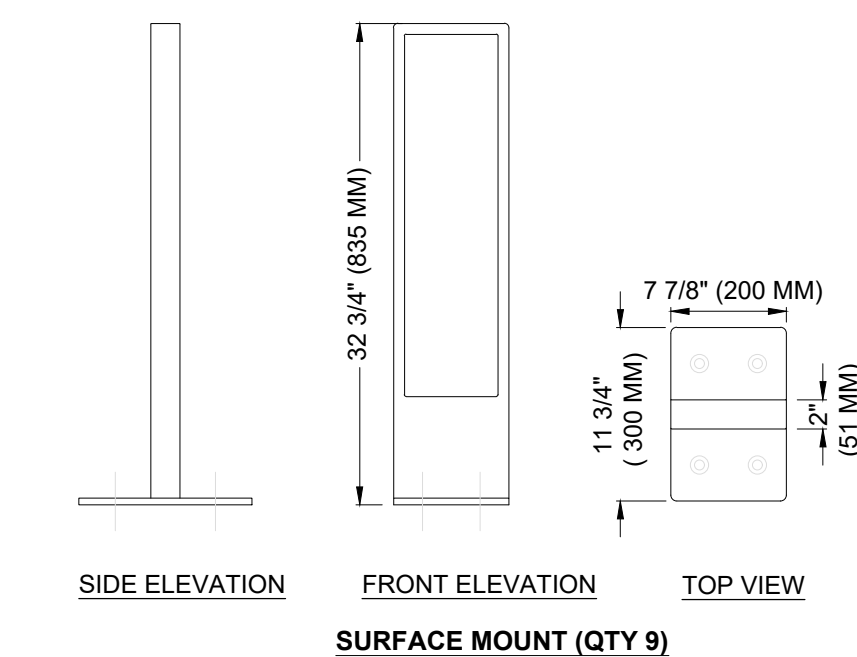
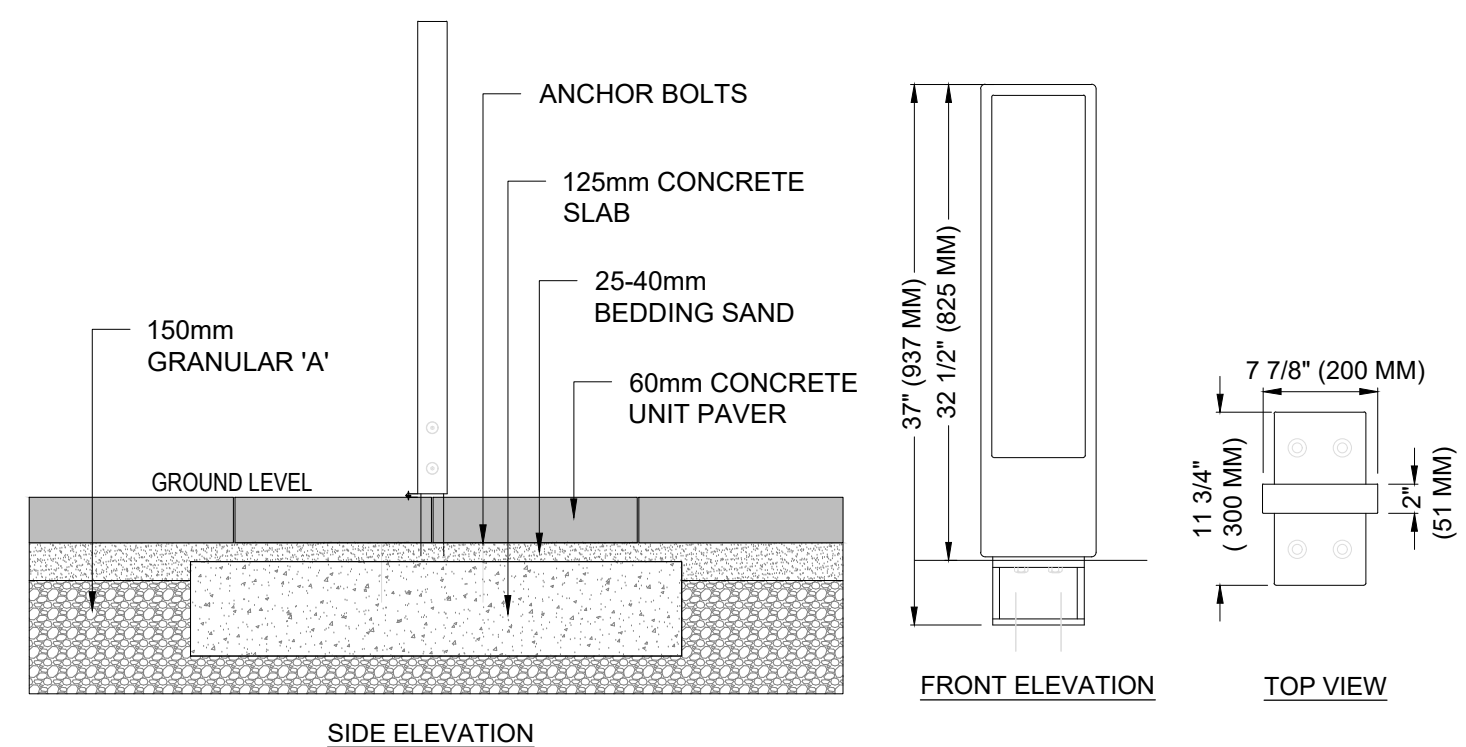

**12 BIKE RACKS**  
SCALE N.T.S.

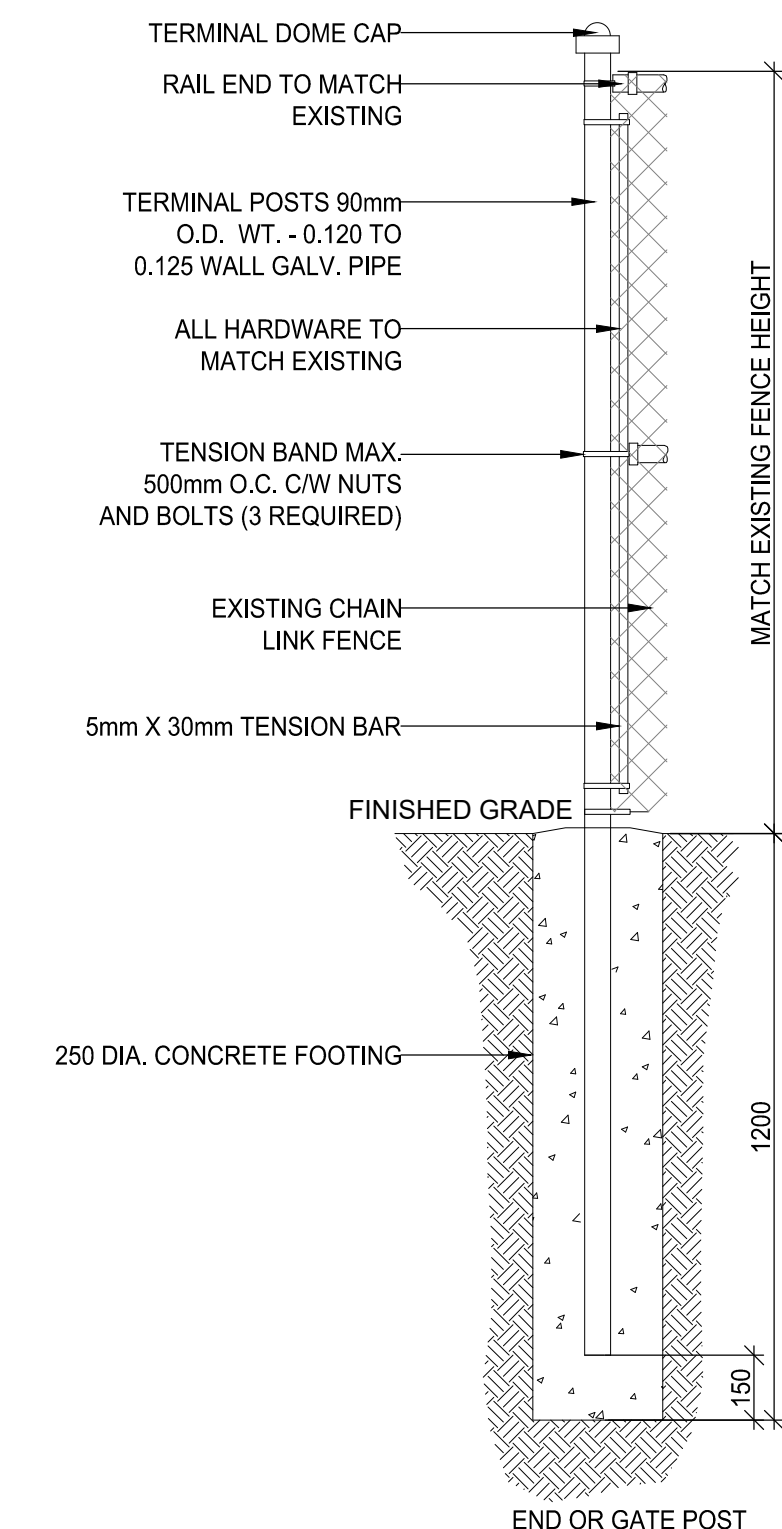

- NOTE:
1. REFER TO FENCING LAYOUT PLAN FOR ALIGNMENT AND GRADES.
  2. FENCE TO BE INSTALLED 150MM INSIDE PROPERTY LINES.

**13 CHAIN LINK FENCE END POST**  
SCALE N.T.S.



X:\2025\01\16\Working\Bridgescape\_1604\Projects\1604\0375\Design\Working\Production\1604\0375\_L6-9-LandscapeDetail.dwg  
2025/01/16 1:20:10 PM J. N. Smith, J. N. Smith

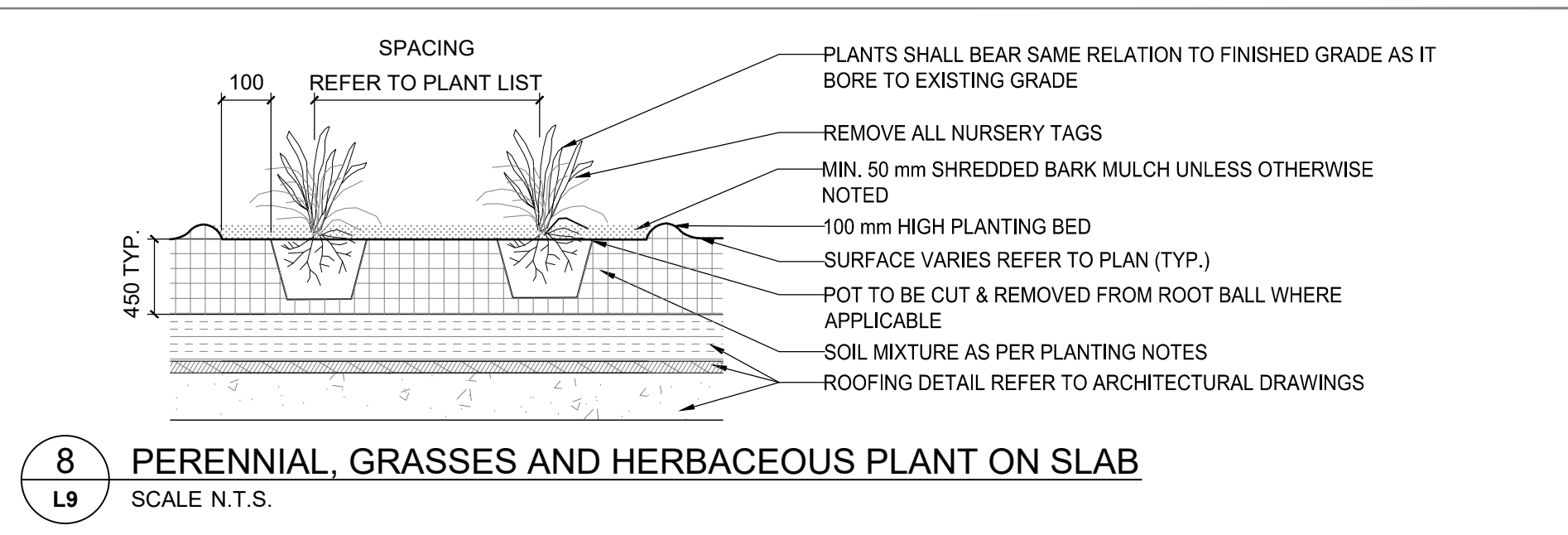
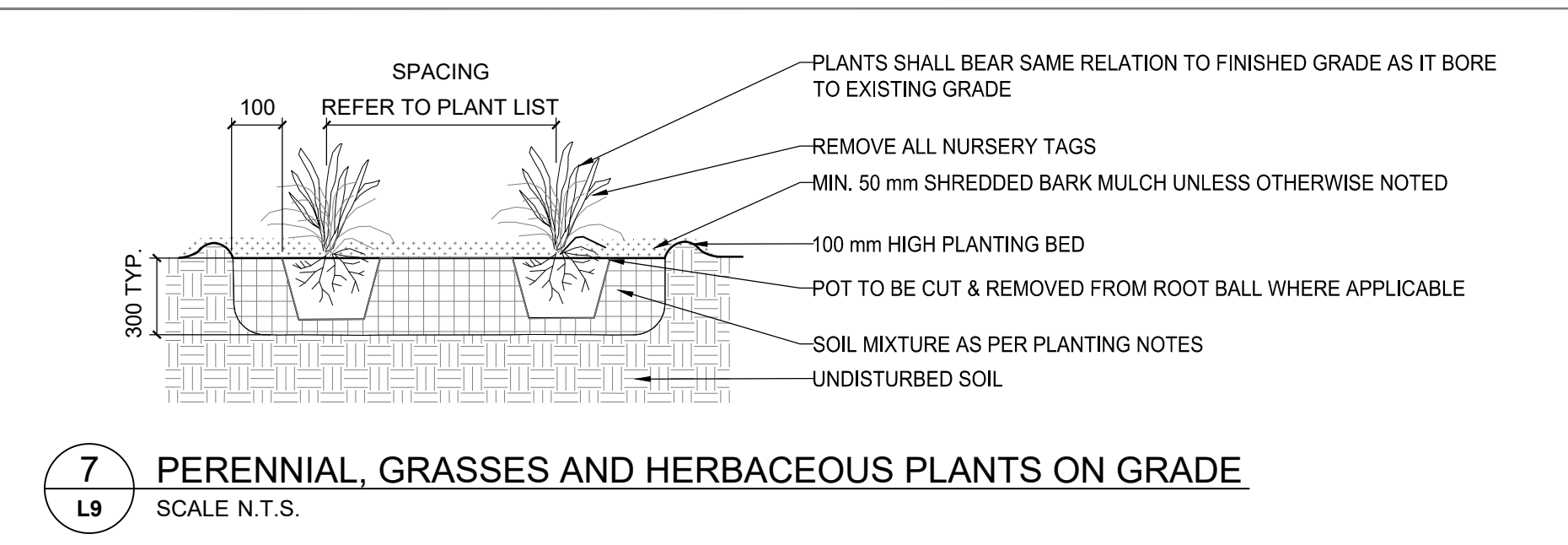
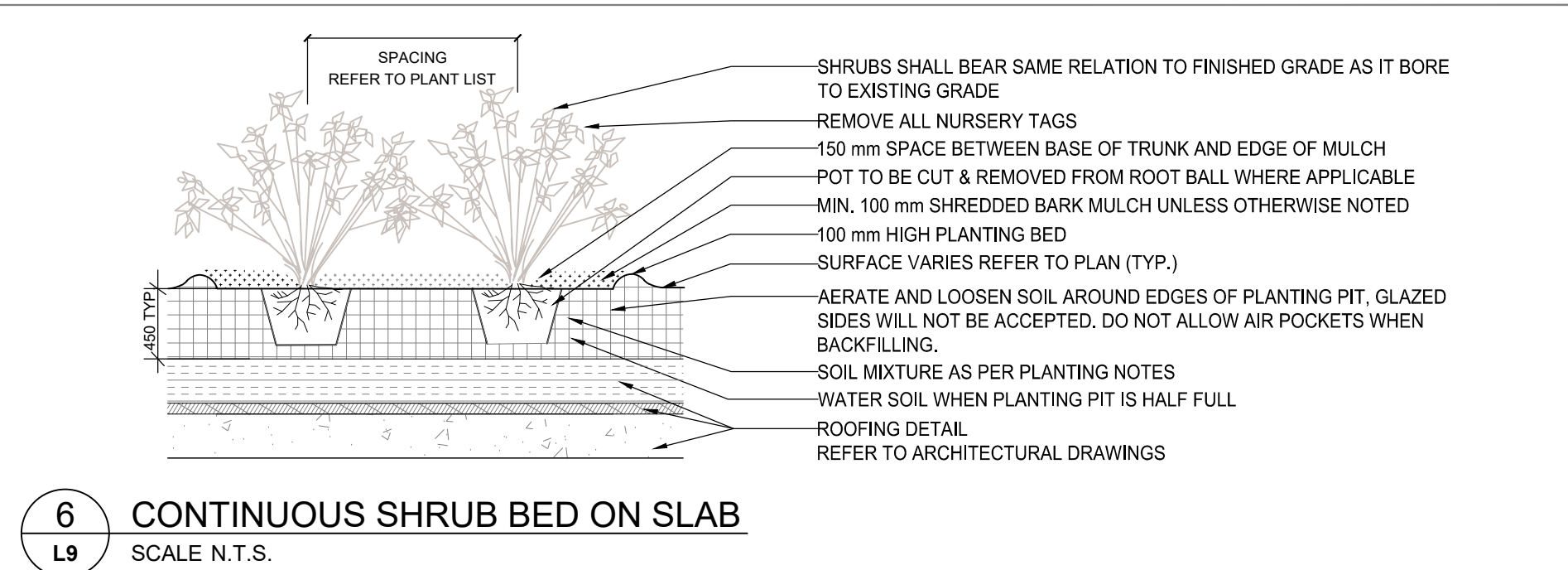
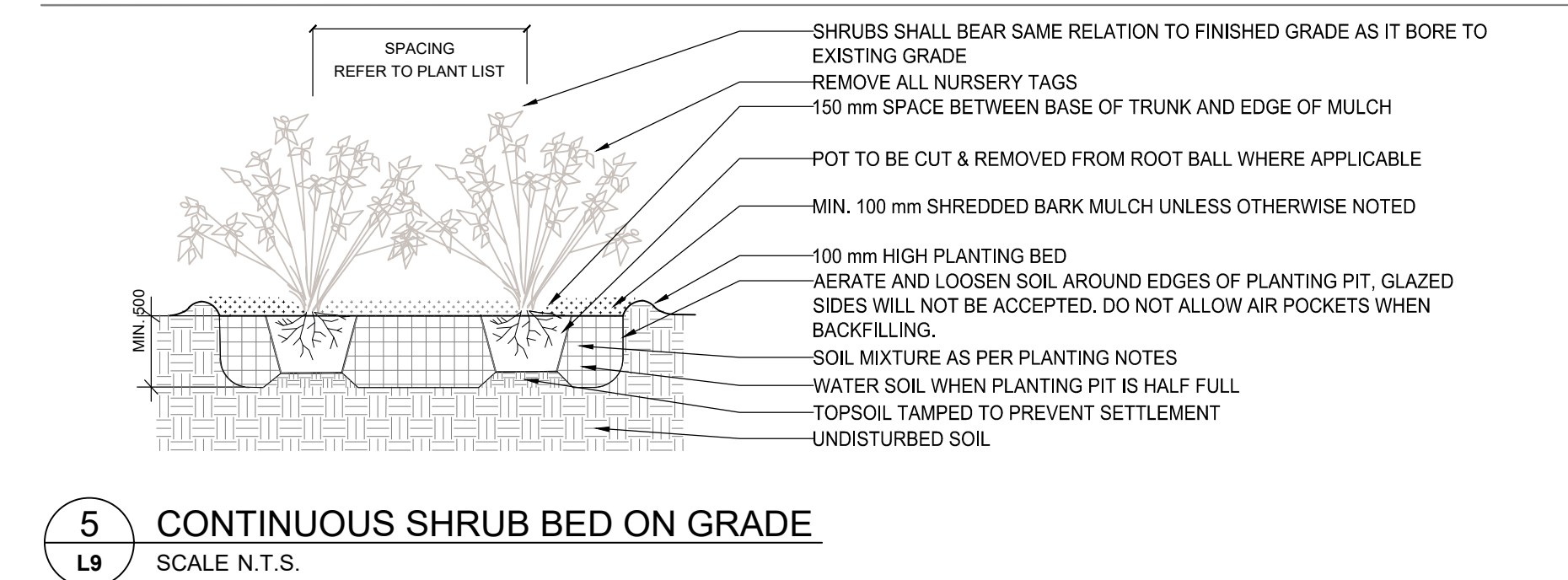
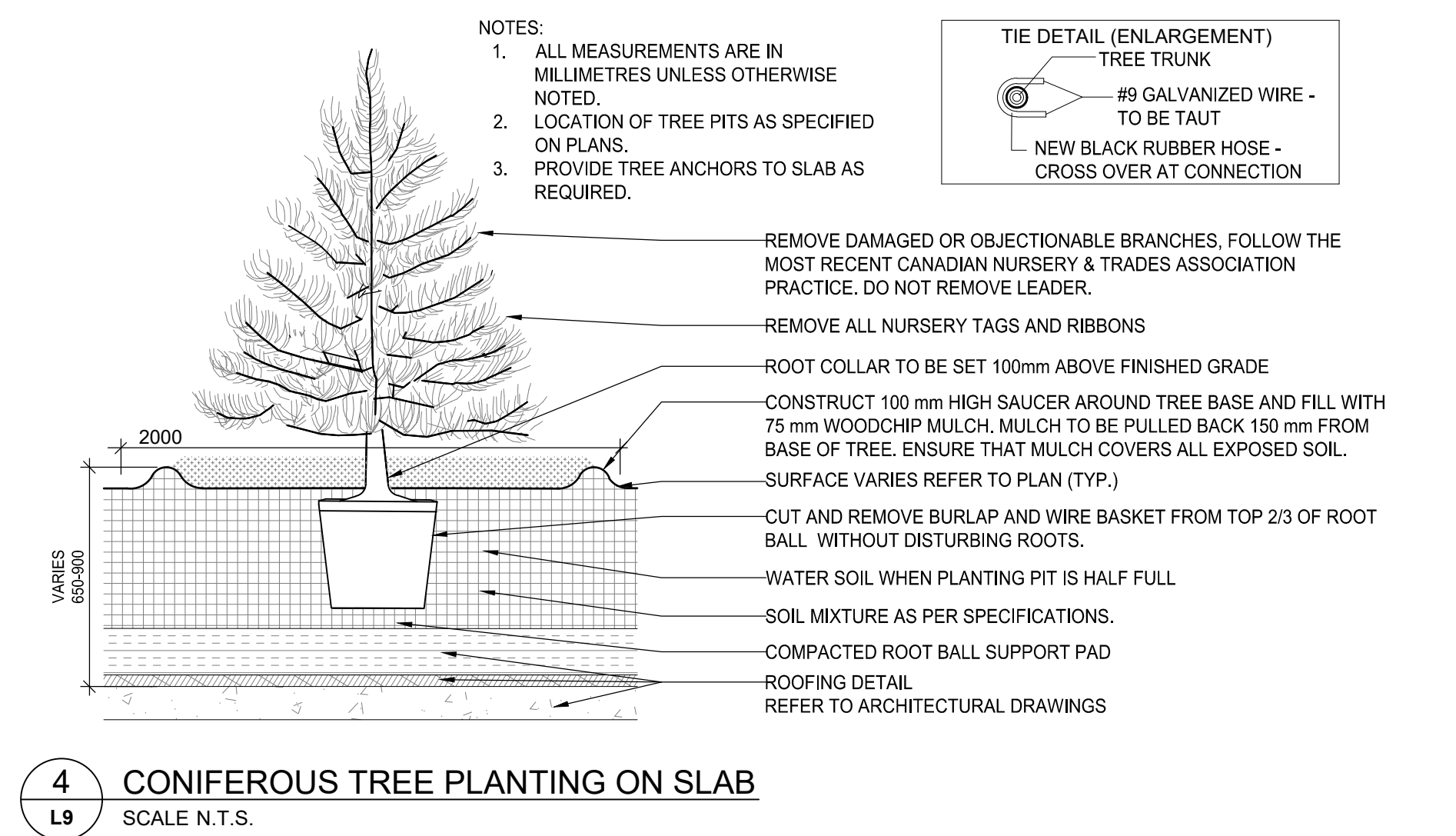
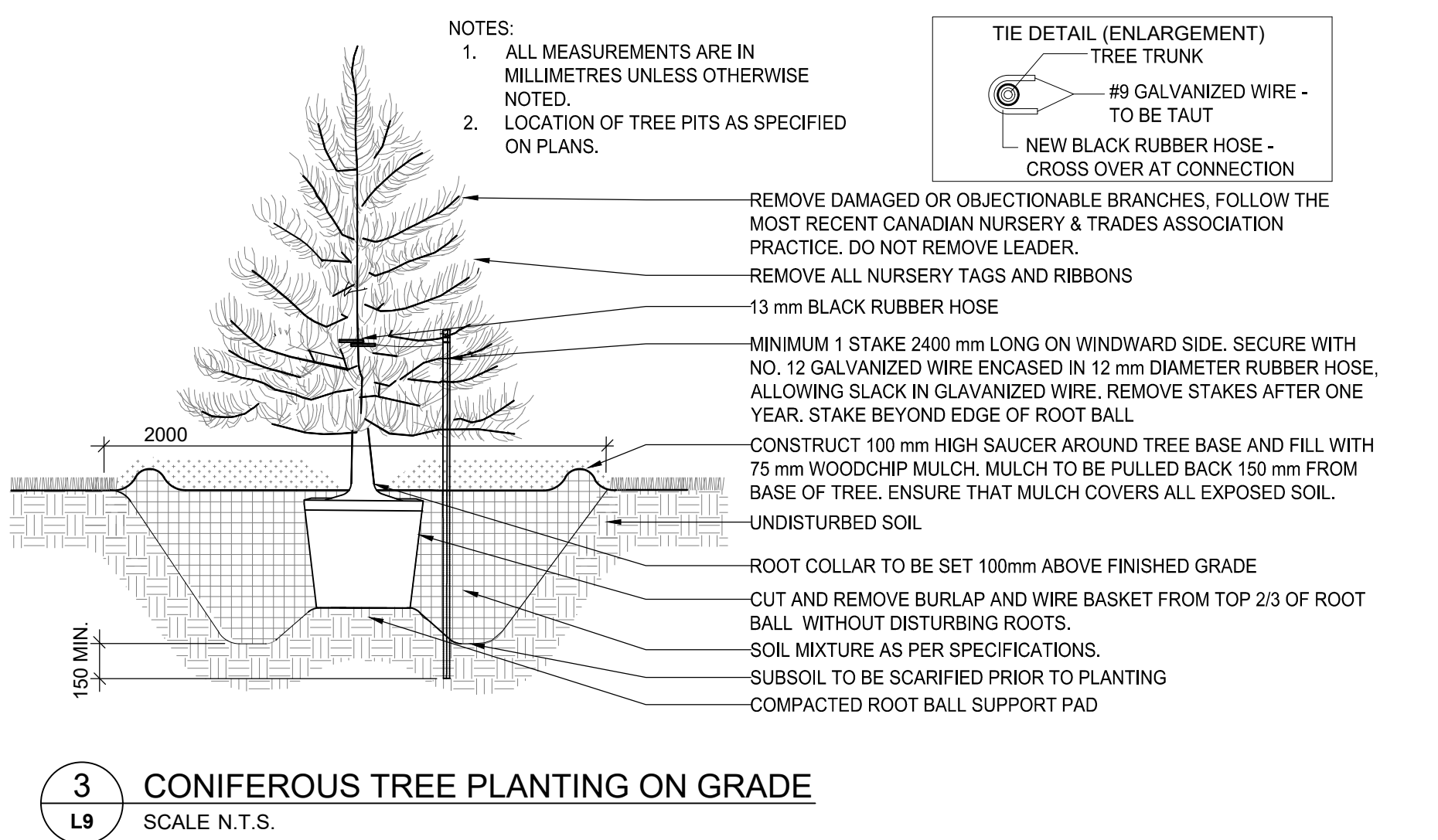
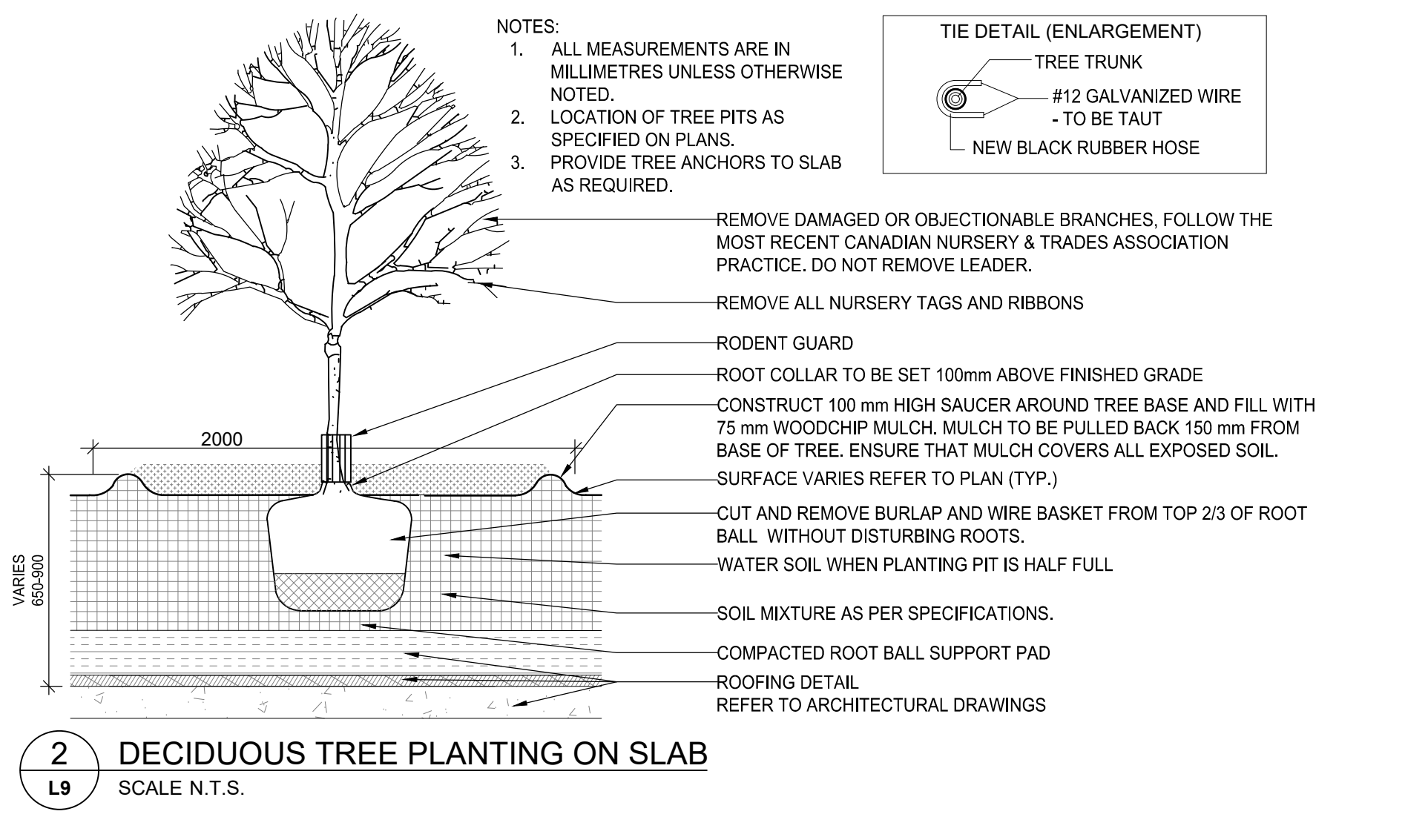
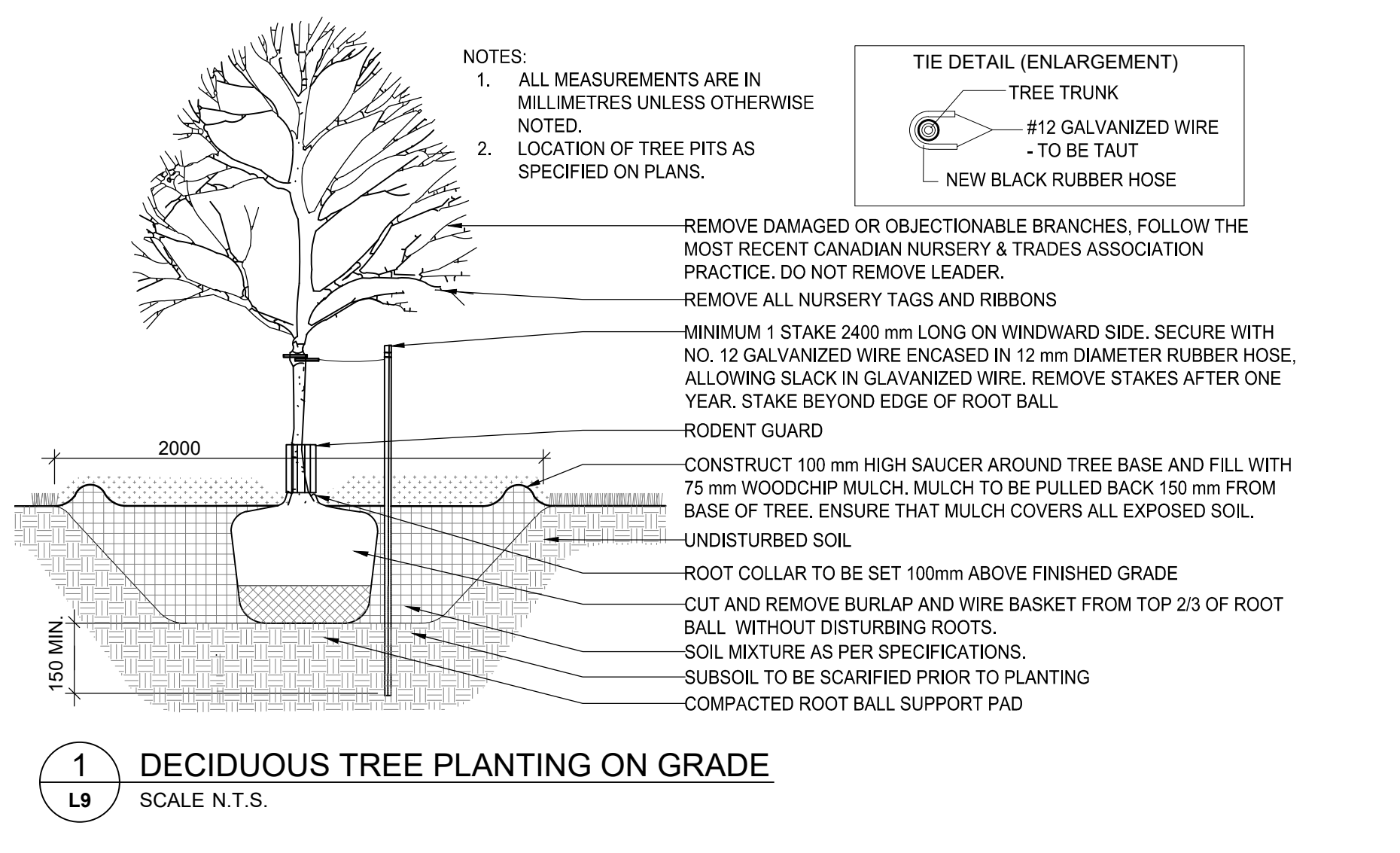

#### PLANTING NOTES

1. THE DETAILS ON THIS SHEET DO NOT REPRESENT ANY PARTICULAR SPECIES.
2. TREES AND SHRUBS AS INDICATED IN THE DETAILS REPRESENT BOTH CONIFEROUS AND DECIDUOUS SPECIES.
3. MATERIAL PLANTED IN GROUP SHALL BE SET IN CONTINUOUS PLANTING BEDS.
4. CENTRE LINE OF SHRUBS SHALL NOT BE CLOSER THAN 2.4m FROM BUILDING FACE TO PROTECT BUILDING FOOTINGS AND INSULATION.
5. PRUNING - TO SUIT SPECIES - PRUNE BRANCHES BY 1/3 TO REMOVE DAMAGED OR OBJECTIONABLE BRANCHES FOLLOWING PROPER HORTICULTURAL PRACTICE. DO NOT PRUNE LEADERS.
6. FIRMLY COMPACT BACKFILLED PLANTING MIXTURE TO ELIMINATE AIR POCKETS OR PREVENT SETTLEMENT.
7. PLANTING MATERIAL QUALITY STANDARDS:
  - ALL PLANT MATERIALS TO CONFORM TO THE CANADIAN NURSERY LANDSCAPE ASSOCIATION FOR VARIETY, SIZE AND CONDITION.
  - PLANT MATERIAL COLLECTED FROM WILD SOURCES WILL NOT BE ACCEPTED.
  - THE LANDSCAPE ARCHITECT RESERVES THE RIGHT TO REFUSE ACCEPTANCE OF ANY PLANT DISPLAYING POOR GROWTH HABITS APPROPRIATE TO SPECIES, DISEASE OR DAMAGE FROM POOR HANDLING DURING TRANSPORT, ON SITE STORAGE, INSTALLATION OR MAINTENANCE.
  - ANY PLANTS THAT DO NOT CONFORM TO THE ABOVE STANDARDS WILL BE PROMPTLY REMOVED FROM THE SITE BY THE CONTRACTOR AND REPLACED WITH MATERIAL OF ACCEPTABLE QUALITY AT NO ADDITIONAL COST TO THE PROJECT.

8. TOPSOIL / SOIL MIXTURE:
  - SOIL TEXTURE BASED ON THE CANADIAN SYSTEM OF SOIL CLASSIFICATION TO CONSIST OF:
    - CLAY: 14-20%
    - SILT: 0-35%
    - SAND: 45-70%
    - ORGANIC MATERIAL: 4-10%
    - pH: 6-8
  - SPREAD TOPSOIL TO FOLLOWING MINIMUM DEPTHS AFTER SETTLEMENTS UNLESS OTHERWISE NOTED ON DETAILS:
    - 300mm FOR PERENNIALS
    - 500mm FOR SHRUB BEDS
    - 1000mm FOR TREE PLANTING
9. MULCH SHALL BE SHREDDED WOOD VARYING IN SIZE FROM 25-125mm IN LENGTH FROM CONIFEROUS TREES.
10. TREE GUARDS TO PROTECT DECIDUOUS TREES 2.5m HEIGHT AND GREATER FROM RODENT DAMAGE. THEY SHALL BE ONE OF THE FOLLOWING:
  - 13mm WIRE MESH (HARDWARE CLOTH) GUARD OF 0.5mm GALVANIZED STEEL SUPPLIED IN 600mm WIDE ROLLS.
  - AN EXPANDED DIAMOND MESH OF 0.4mm GALVANIZED STEEL SUPPLIED IN 600mm WIDTH.
  - 150mm PLASTIC DRAINAGE PIPE, ULTRA-VIOLET PROTECTED SUPPLIED IN MINIMUM 600mm LENGTHS.

#### NOTES:

##### TREE PROTECTION REQUIREMENTS:

1. PRIOR TO ANY WORK ACTIVITY WITHIN THE CRITICAL ROOT ZONE (CRZ = 10X DIAMETER) OF A TREE, TREE PROTECTION FENCING MUST BE INSTALLED SURROUNDING THE CRITICAL ROOT ZONE, AND REMAIN IN PLACE UNTIL THE WORK IS COMPLETE.
2. UNLESS PLANS ARE APPROVED BY CITY FORESTRY STAFF, FOR WORK WITHIN THE CRZ:
  - DO NOT PLACE ANY MATERIAL OR EQUIPMENT - INCLUDING OUTHOUSES;
  - DO NOT ATTACH ANY SIGNS, NOTICES OR POSTERS TO ANY TREE;
  - DO NOT RAISE OR LOWER THE EXISTING GRADE;
  - TUNNEL OR BORE WHEN DIGGING;
  - DO NOT DAMAGE THE ROOT SYSTEM, TRUNK, OR BRANCHES OF ANY TREE;
  - ENSURE THAT EXHAUST FUMES FROM ALL EQUIPMENT ARE NOT DIRECTED TOWARD ANY TREE CANOPY.
  - DO NOT EXTEND HARD SURFACE OR SIGNIFICANTLY CHANGE LANDSCAPING.
3. TREE PROTECTION FENCING MUST BE AT LEAST 1.2M IN HEIGHT, AND CONSTRUCTED OF RIGID OR FRAMED MATERIALS (E.G. MODULOC - STEEL, PLYWOOD HOARDING, OR SNOW FENCE ON A 2"x4" WOOD FRAME) WITH POSTS 2.4M APART, SUCH THAT THE FENCE LOCATION CANNOT BE ALTERED. ALL SUPPORTS AND BRACING MUST BE PLACED OUTSIDE OF THE CRZ, AND INSTALLATION MUST MINIMISE DAMAGE TO EXISTING ROOTS. (SEE DETAIL)
4. THE LOCATION OF THE TREE PROTECTION FENCING MUST BE AS INDICATED ON THE TREE PRESERVATION PLAN WITHIN THIS SET OF DRAWINGS. THE PLAN AND CONSTRUCTED FENCING MUST BE APPROVED BY CITY FORESTRY STAFF PRIOR TO COMMENCEMENT OF WORK.
5. IF THE FENCED TREE PROTECTION AREA MUST BE REDUCED TO FACILITATE CONSTRUCTION, MITIGATION MEASURES MUST BE PRESCRIBED BY AN ARBORIST AND APPROVED BY CITY FORESTRY STAFF. THESE MAY INCLUDE THE PLACEMENT OF PLYWOOD, WOOD CHIPS, OR STEEL PLATING OVER THE ROOTS FOR PROTECTION OR THE PROPER PRUNING AND CARE OF ROOTS WHERE ENCOUNTERED.

THE CITY'S TREE PROTECTION BY-LAW, 2020-340 PROTECTS BOTH CITY-OWNED TREES, CITY-WIDE, AND PRIVATELY-OWNED TREES WITHIN THE URBAN AREA. PLEASE REFER TO WWW.OTTAWA.CA/TREEBYLAW FOR MORE INFORMATION ON HOW THE TREE BY-LAW APPLIES.

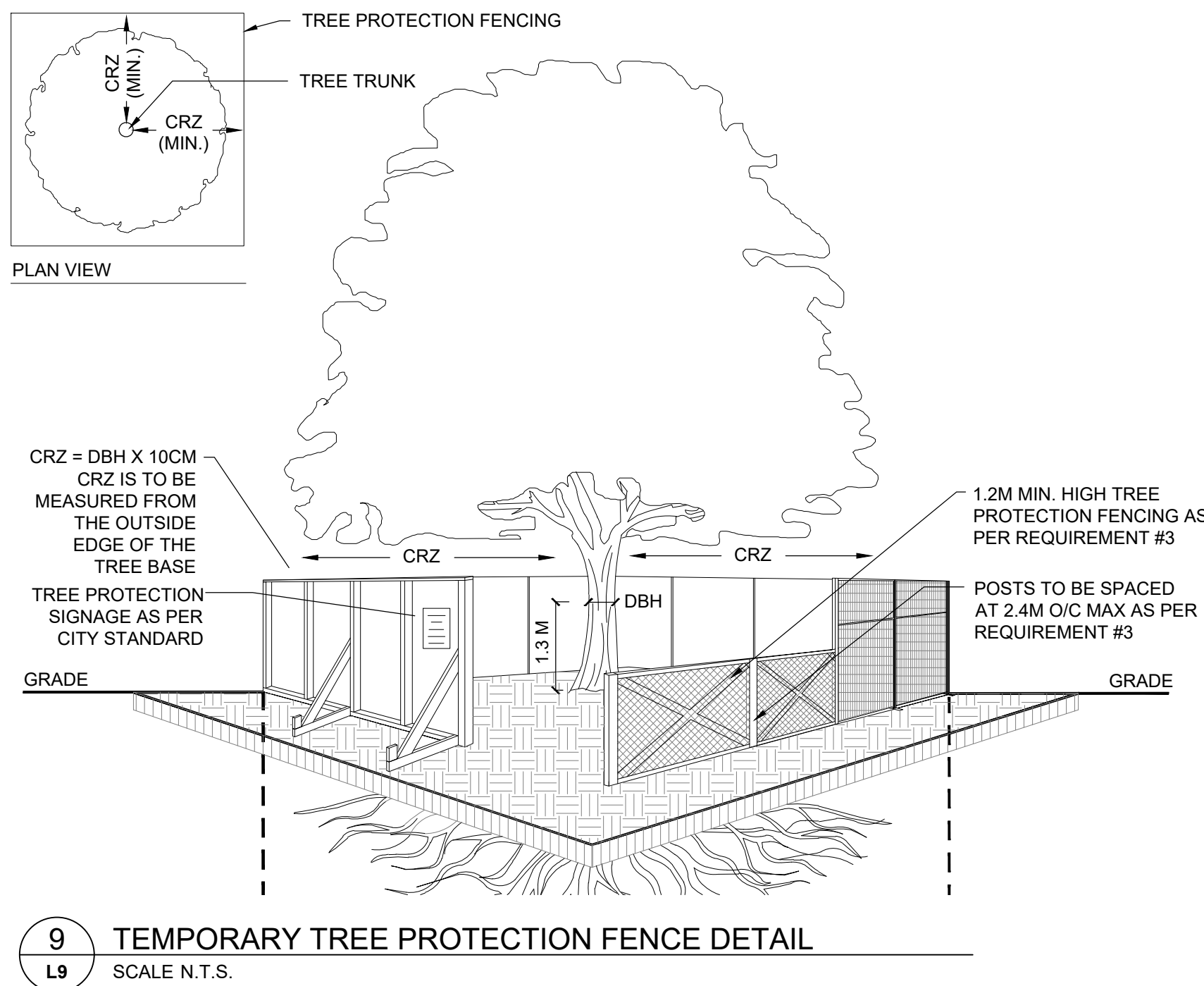

#### GENERAL LANDSCAPE NOTES

1. REFER TO ENGINEERING DRAWINGS FOR PROPOSED GRADING, SITE SERVICING, AND FENCING LOCATION.
2. EXISTING VEGETATED AREAS ON ADJACENT PROPERTIES SHALL REMAIN AND BE PROTECTED BEFORE, DURING, AND AFTER CONSTRUCTION.
3. SOD SHALL BE INSTALLED THROUGHOUT WITHIN LIMIT OF WORK AND IN ALL DISTURBED AREAS OUTSIDE THE LIMIT OF WORK EXCEPT WHERE INDICATED. SOD SHALL BE INSTALLED AS PER OPSS 803. SOD SHALL BE KENTUCKY BLUEGRASS SOD INSTALLED OVER 135mm OF TOPSOIL.
4. CONTRACTOR TO LOCATE AND STAKE ALL UTILITIES PRIOR TO ANY WORK ON THE SITE AND TO OBTAIN CLEARANCE FROM ALL APPLICABLE UTILITIES. DO NOT PLANT DIRECTLY ABOVE UNDERGROUND UTILITIES. REPORT CONFLICTS AND ANY DISCREPANCIES TO THE LANDSCAPE ARCHITECT FOR DIRECTION.
5. NO TREES SHALL BE PLANTED ON PROPERTY LOT LINES OR WITHIN DRAINAGE EASEMENTS.
6. NO TREES SHALL BE PLANTED UNDER OVERHEAD WIRES.
7. MAINTAIN A MINIMUM DISTANCE OF 1500mm BETWEEN TREE AND ALL UNDERGROUND UTILITIES OR USE ROOT BARRIERS WHERE ROOT BALL OF TREE IS WITHIN 1000mm OF UNDERGROUND UTILITIES.
8. MAINTAIN A MINIMUM DISTANCE OF 4500mm BETWEEN TREE AND ALL BUILDINGS.
9. MAINTAIN A MINIMUM DISTANCE OF 4000mm BETWEEN TREE AND ALL HYDRO TRANSFORMERS.
10. MAINTAIN A MINIMUM OF 2000mm FROM THE ROAD CURB FOR DECIDUOUS TREES AND 5000mm FOR CONIFEROUS TREES.
11. MAINTAIN A MINIMUM OF 2000mm BETWEEN TREE AND FIRE HYDRANTS.
12. MAINTAIN A MINIMUM OF 1000mm BETWEEN TREE AND SIDEWALKS, PATHWAYS, AND DRIVEWAYS.
13. THE LANDSCAPE ARCHITECT MAY ADJUST THE LOCATION OF PLANTING PRIOR TO PLANTING TO MINIMIZE CONFLICTS WITH UTILITIES, DRIVEWAYS AND INTERSECTION VISIBILITY.
14. CONTRACTOR SHALL SUPPLY ALL MATERIALS IN QUANTITIES SUFFICIENT TO COMPLETE WORK SHOWN ON THESE DRAWINGS. ANY DISCREPANCIES SHALL BE REPORTED TO THE LANDSCAPE ARCHITECT FOR DIRECTION.
15. DO NOT MAKE SUBSTITUTIONS OF MATERIALS, PRODUCTS OR QUANTITIES WITHOUT PRIOR WRITTEN PERMISSION OF THE LANDSCAPE ARCHITECT.
16. THE CONTRACTOR TO MAKE GOOD TO THE SATISFACTION OF THE LANDSCAPE ARCHITECT ANY AREAS DAMAGED BY THE WORK.
17. UPON THE COMPLETION OF WORK EACH DAY, REMOVE ALL DEBRIS, GARBAGE AND SURPLUS MATERIALS FROM THE SITE. KEEP THE SITE CLEAN AND USEABLE AT ALL TIMES.
18. ALL WORKMANSHIP AND MATERIALS (INCLUDING PLANTS) TO BE GUARANTEED FOR ONE FULL YEAR FOLLOWING FINAL ACCEPTANCE OF THE PROJECT BY THE LANDSCAPE ARCHITECT.
19. THE CONTRACTOR SHALL REMOVE ALL TREE STAKES AND TREE SUPPORTS PRIOR TO ASSUMPTION BY THE OWNER.
20. AT THE TIME OF INSPECTION FOR ACCEPTANCE ALL TREE PITS SHALL BE CULTIVATED, FREE OR WEEDS, LEAVES, BROKEN BRANCHES AND DEBRIS.
21. AT THE TIME OF INSPECTION FOR ACCEPTANCE ALL TREE PITS SHALL BE CULTIVATED, FREE OR WEEDS, LEAVES, BROKEN BRANCHES AND DEBRIS.

#### WORK WITHIN PROTECTED AREAS

1. EXCAVATION WORK:
  - TO ENSURE THE ROOTS ARE NOT DISTURBED MORE THAN NECESSARY AND WHERE EXCAVATION WORKS ARE UNAVOIDABLE WITHIN THE CRZ OF TREES, THE FOLLOWING MITIGATION MEASURES SHALL BE USED:
    - a. ALL EXCAVATION WITHIN THE CRZ OF TREES SHALL BE BY HAND OR HYDRO EXCAVATION USING THE SMALLEST TOOLS. ROOT CUTTING SHALL BE MADE USING A SHARP SPADE OR KNIFE AT THE LIMIT OF DISTURBANCE PRIOR TO ANY CONSTRUCTION ACTIVITIES.
    - b. THE CONTRACTOR SHALL ONLY TUNNEL OR BORE WITHIN THE CRZ, INSTEAD OF CREATING A TRENCH.
    - c. ANY ROOTS THAT ARE EXPOSED BY CONSTRUCTION ACTIVITIES MUST BE COVERED WITH NATIVE TOPSOIL IMMEDIATELY, TO ENSURE THAT THE ROOTS DO NOT DRY OUT OR HAVE ANY FURTHER DAMAGE OCCUR TO THEM.
    - d. IN ALL THOSE INSTANCES WHERE ROOT PRUNING IS REQUIRED, THE SERVICE OF A CERTIFIED ARBORIST OR QUALIFIED TREE WORKER UNDER THE SUPERVISION OF A CERTIFIED ARBORIST SHALL BE RETAINED. IN ADDITION, ALL REMEDIAL WORKS MUST BE CONDUCTED BY A CERTIFIED CARE PROFESSIONAL TO ENSURE PROPER CARE IS ADMINISTERED IN ORDER TO ENABLE THE CONTINUED HEALTH OF THE TREES.
2. GRADING WORK:
  - WHERE RE-GRADING IS REQUIRED WITHIN THE CRZ, IT SHOULD BE PERFORMED BY HAND UNDER THE SUPERVISION OF A CERTIFIED ARBORIST.



Stantec Consulting Ltd.  
400 - 1331 Clyde Avenue  
Ottawa ON  
Tel. 613.722.4420  
www.stantec.com

Copyright Reserved

The Contractor shall verify and be responsible for all dimensions. DO NOT scale the drawing - any errors or omissions shall be reported to Stantec without delay. The Copyrights to all designs and drawings are the property of Stantec. Reproduction or use for any purpose other than that authorized by Stantec is forbidden.

Legend

APPROVED

By Kersten Nitsche at 3:31 pm, Aug 08, 2025

Kersten Nitsche

KERSTEN NITSCHKE, MCIP RPP  
MANAGER (A), DEVELOPMENT REVIEW WEST  
PLANNING, DEVELOPMENT AND BUILDING SERVICES  
DEPARTMENT, CITY OF OTTAWA

5	60% DETAIL SUBMISSION	TA	KP	25.04.16
4	ISSUED FOR CITY REVIEW	TA	KP	25.02.20
3	ISSUED FOR CITY REVIEW	TA	KP	24.11.28
2	ISSUED FOR COORDINATION	TA	KP	24.11.15
6	ISSUED FOR CITY REVIEW	TA	KP	25.06.04
Revision		By	Appd.	YY.MM.DD

File Name:	160410375-L200	CA	KP / LP	KP / BL	23.11.22
		Dwn.	Chkd.	Dsgn.	YY.MM.DD

Permit-Seal



Client/Project

WINDMILL DEVELOPMENT GROUP LTD.

2475 REGINA STREET

Ottawa, ON

Title

LANDSCAPE DETAILS - II  
& GENERAL NOTES

Project No.	Scale	
160410375	AS NOTED	
Drawing No.	Sheet	Revision

L9

9 of 9

6

PLAN NUMBER: 19267