

SOIL AVAILABILITY CALCULATION

Planting bed no.	Available Soil Area (sq m)	Available Soil Volume* (cu m)	No. of trees proposed			Total No. of trees	Min. required Soil volume total (cu m)
			Small (min. 25m³ soil for single & 15m³ for shared)	Medium (min. 30m³ soil for single & 18m³ for shared)	Large (min. 35m³ soil for single & 20m³ for shared)		
Planting bed 1	108	162	2			4	66.00
Planting bed 2	52	79		1		1	30.00
Planting bed 3	52	78		1		1	30.00
Planting bed 4	164	246		5		5	90.00
Planting bed 5	51	76		1		1	30.00
Planting bed 6	49	73		1		1	30.00
Planting bed 7	29	43				NA	0.00
Planting bed 8	38	56	1			1	25.00
Planting bed 9	18	28	1			1	25.00
Planting bed 10	17	26	1			1	25.00
Planting bed 11	17	26	1			1	25.00
Planting bed 12	441	661	2	4	1	6	122.00
Planting bed 13	134	200		6		6	108.00
Planting bed 14	351	527	5			10	165.00
Planting bed 15	143	214		3		3	54.00

*Note 1: For all planting beds proposed, the available soil depth is considered to be 1.5m due to clay soil conditions.

CANOPY COVERAGE CALCULATION

PROPOSED CANOPY COVERAGE AT MATURITY				
SIZE OF PROPOSED TREE	AVERAGE MATURE SPREAD	CANOPY COVERAGE PER TREE AT MATURITY (m2)	QUANTITY OF TREES	TOTAL CANOPY COVERAGE (m2)
Deciduous trees- Small	4.5m	16	13	208
Deciduous trees- Medium	12m	79	29	2291
Deciduous trees- Large	15m	177	1	177
TOTAL PROPOSED CANOPY COVERAGE (m2):				2,499
TOTAL SITE AREA (m2):				8,155
EST. PROPOSED CANOPY COVERAGE (%):				31%

1. Area of a circle = $(\pi \times r^2) \times \pi$
2. Canopy coverage per tree calculation: (average mature spread/2) x (average mature spread/2) x π
3. ROW trees along Abbott Street have not been counted under the retained canopy coverage category.

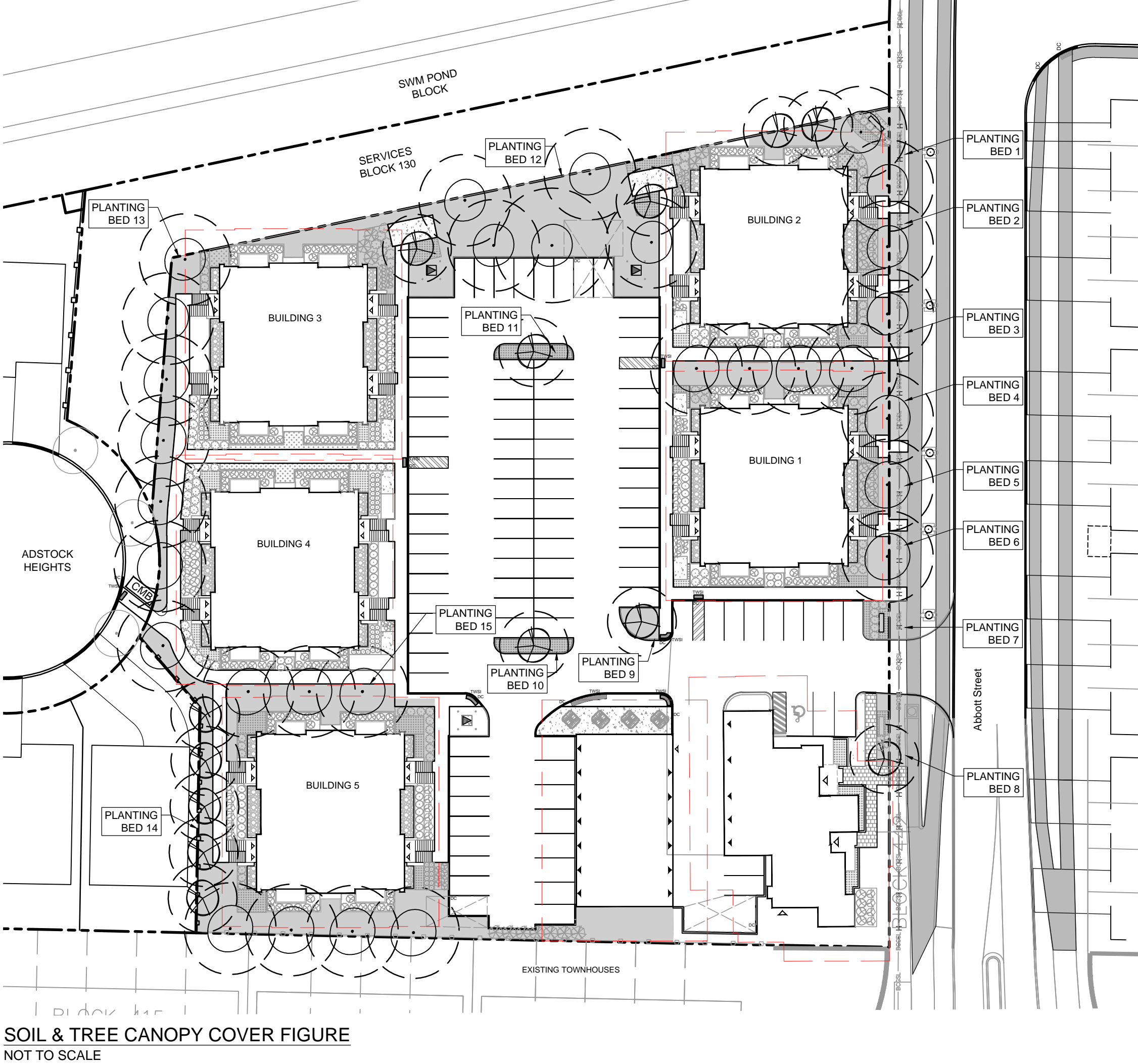

LEGAL DESCRIPTION:
Block 123, Plan 4M-1616, Ottawa

NOTE:
THE POSITION OF ALL POLE LINES, CONDUITS, WATERMANS, SEWERS AND OTHER UNDERGROUND AND OVERGROUND UTILITIES AND STRUCTURES IS NOT NECESSARILY SHOWN ON THE CONTRACT DRAWINGS, AND WHERE SHOWN, THE ACCURACY OF THE POSITION OF SUCH UTILITIES AND STRUCTURES IS NOT GUARANTEED. BEFORE STARTING WORK, DETERMINE THE EXACT LOCATION OF ALL SUCH UTILITIES AND STRUCTURES AND ASSUME ALL LIABILITY FOR DAMAGE TO THEM.

Owner:
SPB Developments Inc.
c/o Todd Duckworth
4829 Abbott Street East
Kanata, ON K2V 0L4
Phone: (613) 301-7792

Architect
Hobin Architecture Inc.
c/o Todd Duckworth
63 Pamela Street
Ottawa, ON K1S 3K7
Phone: (613) 551-3954

Planning
Novatech Engineers, Planners
& Landscape Architects
c/o Alex McAuley
240 Michael Cowpland Drive,
Ottawa, ON, K2M 1P6
Phone: 613.254.9643

DISCLAIMER:

The elements on this plan illustrate the design intent and general constructability of the proposed landscape which will support the associated development. This is to demonstrate how the canopy cover, urban design, health, and climate change objectives of the Official Plan will be met through tree planting and site design. This drawing is for City review only and is not intended for construction. Final detailed design and construction documentation is to be provided with certified 'Issued for Construction' drawings and specifications prior to construction.

No.	REVISION	DATE	BY
3.	RE-ISSUED FOR SITE PLAN APPLICATION	AUG 07/25	RGJ
2.	ISSUED FOR SITE PLAN APPLICATION	JUN X/25	RGJ
1.	ISSUED FOR COORDINATION	JUN 5/25	RGJ

SCALE

1:200

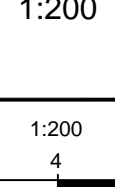

DESIGN

CHECKED	TCB
DRAWN	RGJ
CHECKED	TCB
APPROVED	RGJ

FOR REVIEW ONLY



NOVATECH
Engineers, Planners & Landscape Architects
Suite 200, 240 Michael Cowpland Drive
Ottawa, Ontario, Canada K2M 1P6
Telephone (613) 254-9643
Facsimile (613) 254-5867
Website www.novatech-ceng.com

SPB DEVELOPMENTS INC.
METRIC HOMES SUBDIVISION - BLOCK 123
4829 ABBOTT STREET EAST, KANATA

DRAWING NAME
**LANDSCAPE DETAILS,
CANOPY COVERAGE AND SOIL
AVAILABILITY CALCULATIONS**

PROJECT No.	110037
REV	REV # 3
DRAWING No.	110037-B123-L2