

PROPOSED PLANT LIST XX

KEY	QTY	BOTANICAL NAME	COMMON NAME	SIZE	CONDITION	REMARKS
TREES						
* FM	1	Acer x freemanii	Freeman's Maple	50mm cal.	B&B	On private property
* HL	3	Gleditsia triacanthos	Honey Locust	50mm cal.	B&B	On private property
* PC	15	Prunus pensylvanica	Pin Cherry	50mm cal.	B&B	On city property
* SB	14	Amelanchier canadensis	Serviceberry	50mm cal.	B&B	On city property
* SF	14	Amelanchier laevis	Allegheny Serviceberry	50mm cal.	B&B	On city property
* SM	2	Acer saccharum	Sugar Maple	50mm cal.	B&B	On private property
* WS	1	Picea glauca	White Spruce	50mm cal.	B&B	On private property

*NATIVE TO ONTARIO

NOTE:

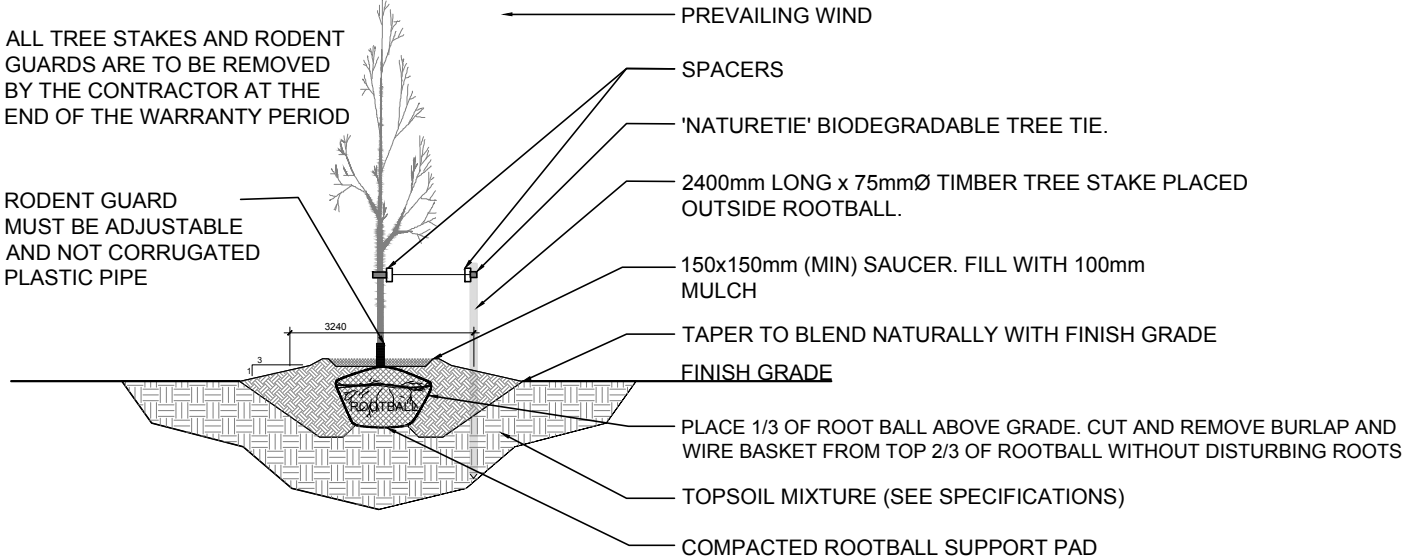

2 DECIDUOUS TREE PLANTING

L.1 SCALE: NTS

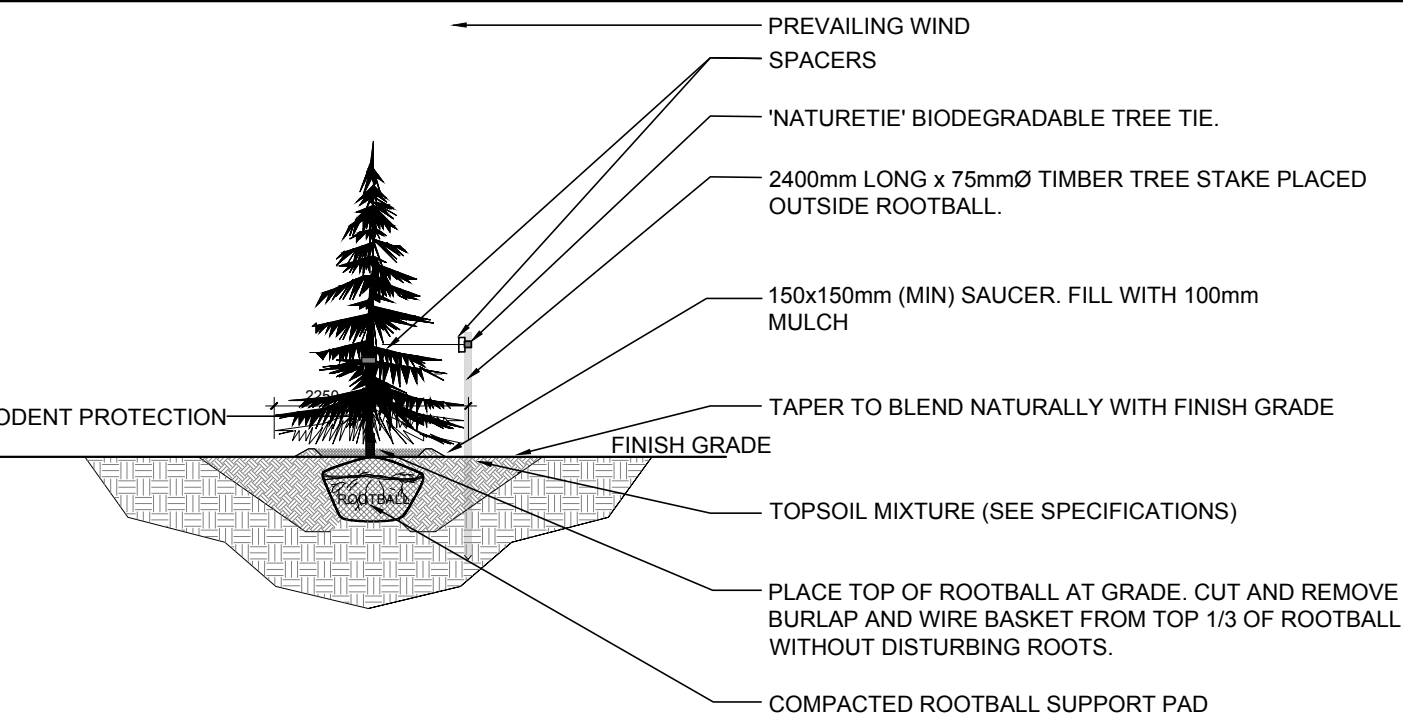

3 CONIFEROUS TREE PLANTING

L.1 SCALE: NTS

40 YEAR CANOPY CALCULATION:

-5,543m2 site area

-3 large trees proposed (154m2 ea.), 3 medium trees proposed (79m2 ea.), 1 large coniferous tree proposed (79m2 ea.) and 43 small trees proposed (7m2 ea)

=1079m2 canopy cover =19.5% canopy cover

Large trees calculated at 14m spread, Medium at trees at 10m spread, large coniferous at 10m spread and small at 3m spread. Methodology for canopy calculation based on town of Oakville canopy calculation formula. We are limited to small street tree planting due to overhead wires.

KEY PLAN

N.T.S



KEY PLAN N.T.S.

GENERAL NOTES:

- It is the responsibility of the appropriate contractor or official to report any errors, omissions or discrepancies on this plan with actual site conditions to the Landscape Architect before proceeding with construction.
- The contractor is to notify all utility companies and authorities prior to any excavation and ascertain locations of underground services.
- The contractor is to reinstate all areas and items damaged as a result of construction activity.
- The contractor is to comply with all pertinent codes and by-laws.
- The contractor is to maintain a positive surface run-off throughout the entire construction period.
- The Landscape Architect is not responsible for subsurface conditions.
- The contractor is to identify all existing trees to remain on site with the Landscape Architect prior to construction.
- The contractor is to stake the proposed location of all plant material in conjunction with the Landscape Architect prior to excavation.
- Minimum distances for selected deciduous trees are as follows:
 - Sidewalks 1.5m
 - Public Streets 2.5m
 - Underground Infrastructure 1.5m
- All trees within 1m of underground utility trenches are to be excavated by hand.
- Remove all protective wrapping from tree trunks after installation.
- Staking of trees shall only be performed if necessary.
- Ensure that mulch is pulled back a min. distance of 75mm from base of tree trunk.
- The L.1 drawing has been prepared in conjunction with the "Geotechnical Investigation" addendum prepared by EXP Services Inc. June 27th, 2025

LEGEND

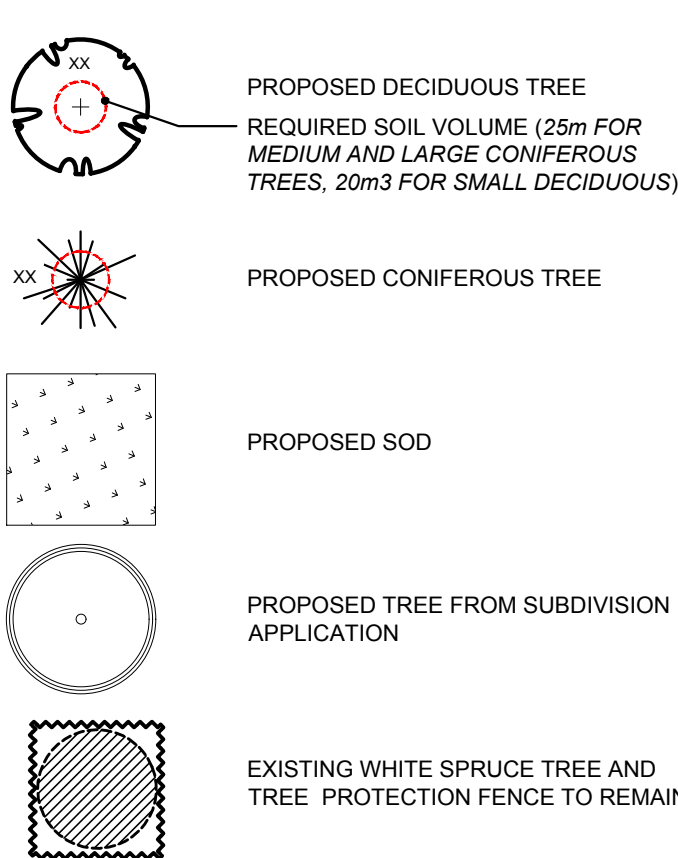

3	REVISED PER CITY COMMENTS	07/18/2025	ML	JL
2	REVISED PER CITY COMMENTS	03/19/2025	ML	JL
1	ISSUED FOR SITE PLAN CONTROL	10/04/2024	ML	JL
No.	Issue	Date	MM/DD/YY	DR CK

JAMES B. LENNOX & ASSOCIATES INC.
LANDSCAPE ARCHITECTS
3332 CARLING AVE. OTTAWA, ONTARIO K2H 5A8
Tel. (613) 722-5168 Fax. (1(866) 343-3942

PROJECT
NAVAN BUILDINGS "E" AND "F"
BLOCK 17 NAVAN ROAD, OTTAWA ON

DRAWING
LANDSCAPE PLAN

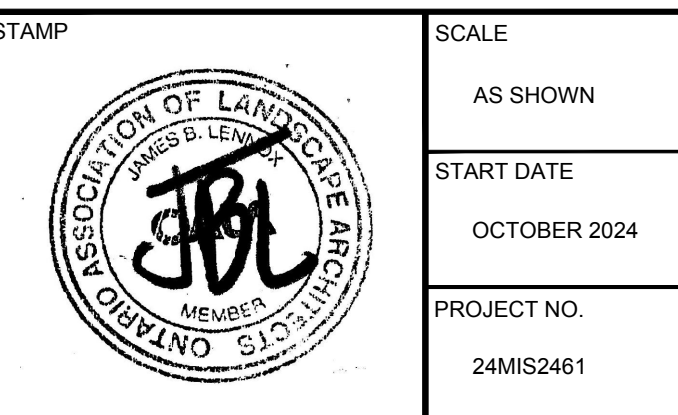

PROJECT NORTH	DRAWING NO.
	L.1
	PLOT SIZE ARCH-D