

1 ENLARGEMENT - WEST PATIO  
Scale: 1:100

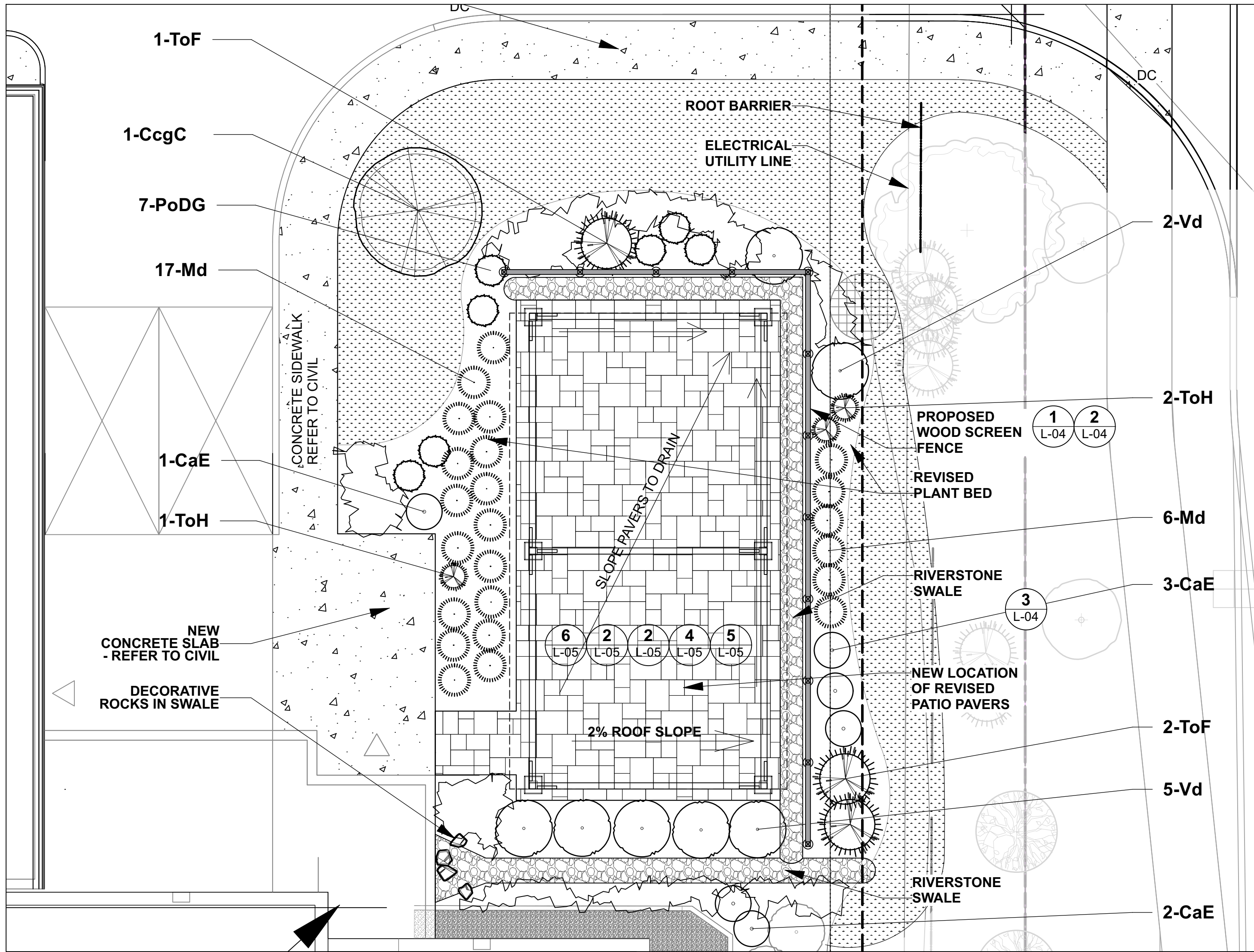

2 ENLARGEMENT EAST PATIO  
Scale: 1:100

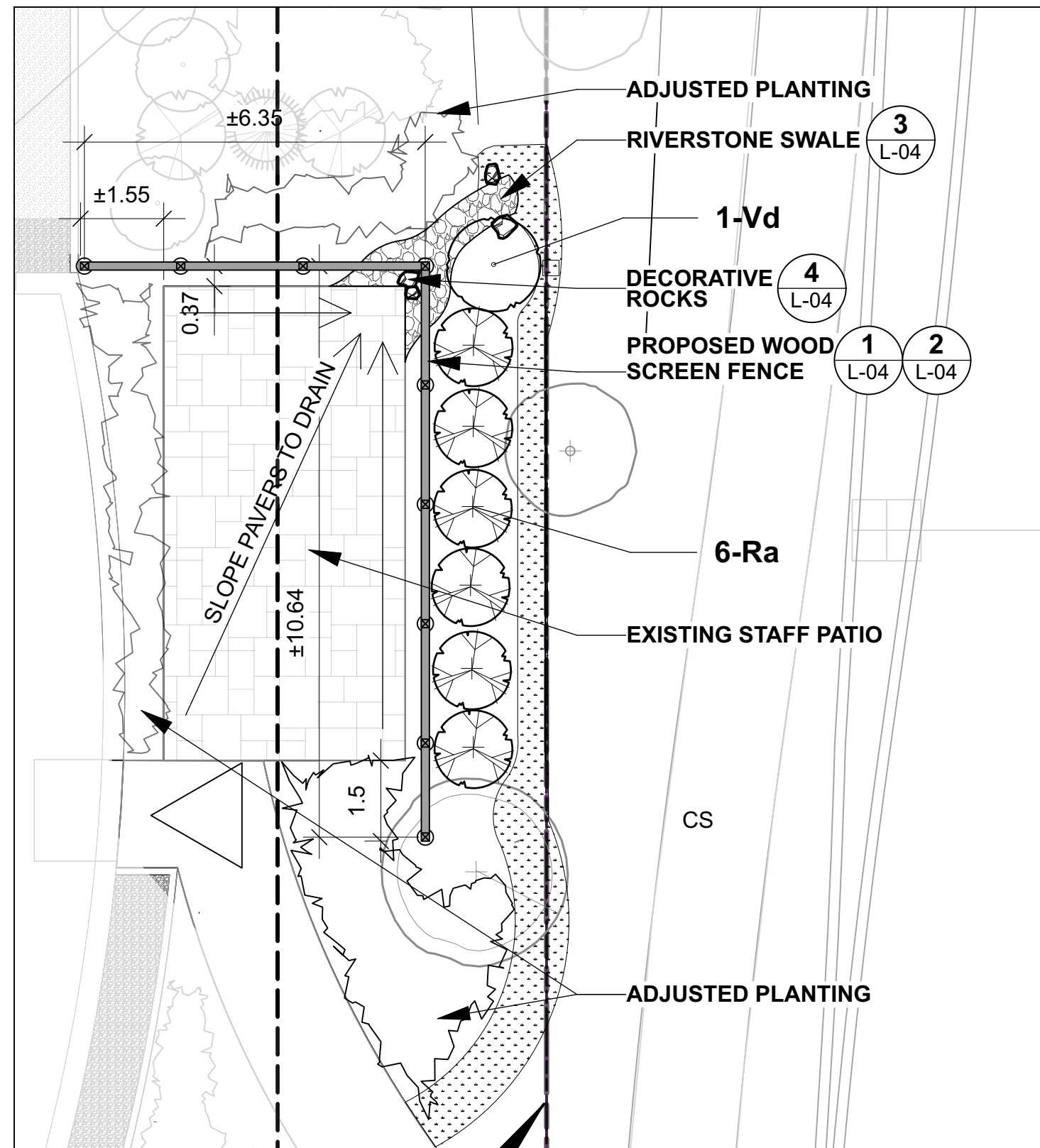

3 ENLARGEMENT SOUTH PATIO  
Scale: 1:100

REFER TO CIVIL FOR DRAINAGE AND SWALE CONNECTIONS



- GENERAL NOTES**
- All general site information and conditions compiled from existing plans, surveys and consultant's field notes. Report all discrepancies prior to any work. No responsibility is born by the Consultant for unknown subsurface conditions.
  - The location of the utilities is approximate only, and the exact location should be determined by consulting the municipal authorities and utility companies concerned. The Contractor shall prove the location of utilities and shall be responsible for adequate protection from damage.
  - All dimensions shown are to be verified on site prior to any construction. No deviations are to be made from the layouts as shown on this plan without prior consultation with the Landscape Architect and Owner.
  - Obtain approval of Landscape Architect for granular base and layout of all pavement areas prior to construction.
  - Stake planting locations and receive approval of Landscape Architect, prior to excavation of any planting pits. No substitutions of plant material shall be made without prior approval of the Landscape Architect.
  - Where clay is encountered proper drainage must be ensured in tree/shrub pits, prior to planting. Have method approved by Landscape Architect.
  - All sodded areas to receive a minimum of 150mm of topsoil over graded sub-base. If sod with mesh is used, mesh to be removed completely during sodding operations. Sod shall come from an approved source and shall be laid within 24 hours of being cut in the nursery. Only nursery sod shall be used.
  - Final subgrade is to approved by the Landscape Architect prior to sod being laid.
  - Maintain positive surface runoff through the entire construction period.
  - Reinstate all areas and items damaged as a result of construction activities.

3	Re-issued for Site Plan Control	2025-07-17
2	Re-issued for Site Plan Control	2025-04-15
1	Issued for Site Plan Control	2025-03-11
no.	revision	date

**Ruhland & Associates Ltd**  
204-1750 Courtwood Crescent, Ottawa, Ontario K2C 3B5  
P (613) 224-4744 x 222 F (613) 224-1151 info@ralc.ca www.ralc.ca

architect  
**N45 ARCHITECTURE INC.**  
71 Bank Street, 7th Floor - Ottawa, Ontario, K1P 5K2  
tel: 613.224.0955 fax: 613.224.8811

surveyor  
**Monument-Urso Surveying Ltd.**  
Ontario Land Surveyors Canada Land Surveyors  
1755 WOODWARD DRIVE, OTTAWA ON, K2C 0P9  
TEL: (613) 805-1553  
3387 FOURTH LINE EAST, SAULT STE. MARIE ON, P6A 6J8  
TEL: (705) 254-7651 FAX: (705) 254-5571

civil engineer  
**NOVATECH** NOVATECH  
Engineers, Planners & Landscape Architects  
structural and geotechnical engineer  
240 MICHAEL COMPLAND DRIVE,  
SUITE 200 OTTAWA, ON, K2M 1P6  
T: 613.254.9643

**Stantec** STANTEC  
400-131 CLYDE AVENUE  
OTTAWA ON K2C 3S4  
T: 613.738.9070

**CARPENTERS DISTRICT COUNCIL OF ONTARIO LOCAL 93. - ADDITION**  
CAMPEAU DRIVE  
OTTAWA, ON

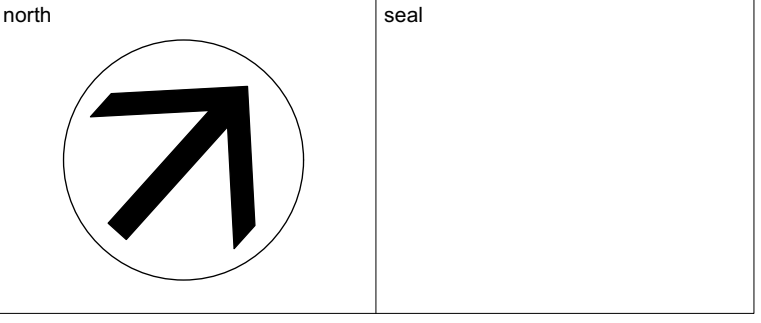

drawing title <b>PLAN ENLARGEMENTS</b>	
scale	drawn by T. Frost / V. Odusanya
date 2023 06 09	checked by M. Ruhland
project number N45 23-790	drawing number <b>L- 03</b>
RA 23-1724	revision
CONTRACTOR TO VERIFY ALL DIMENSIONS AND NOTIFY THE ARCHITECT OF ANY DISCREPANCIES BEFORE WORK COMMENCES.	
DO NOT SCALE DRAWINGS	



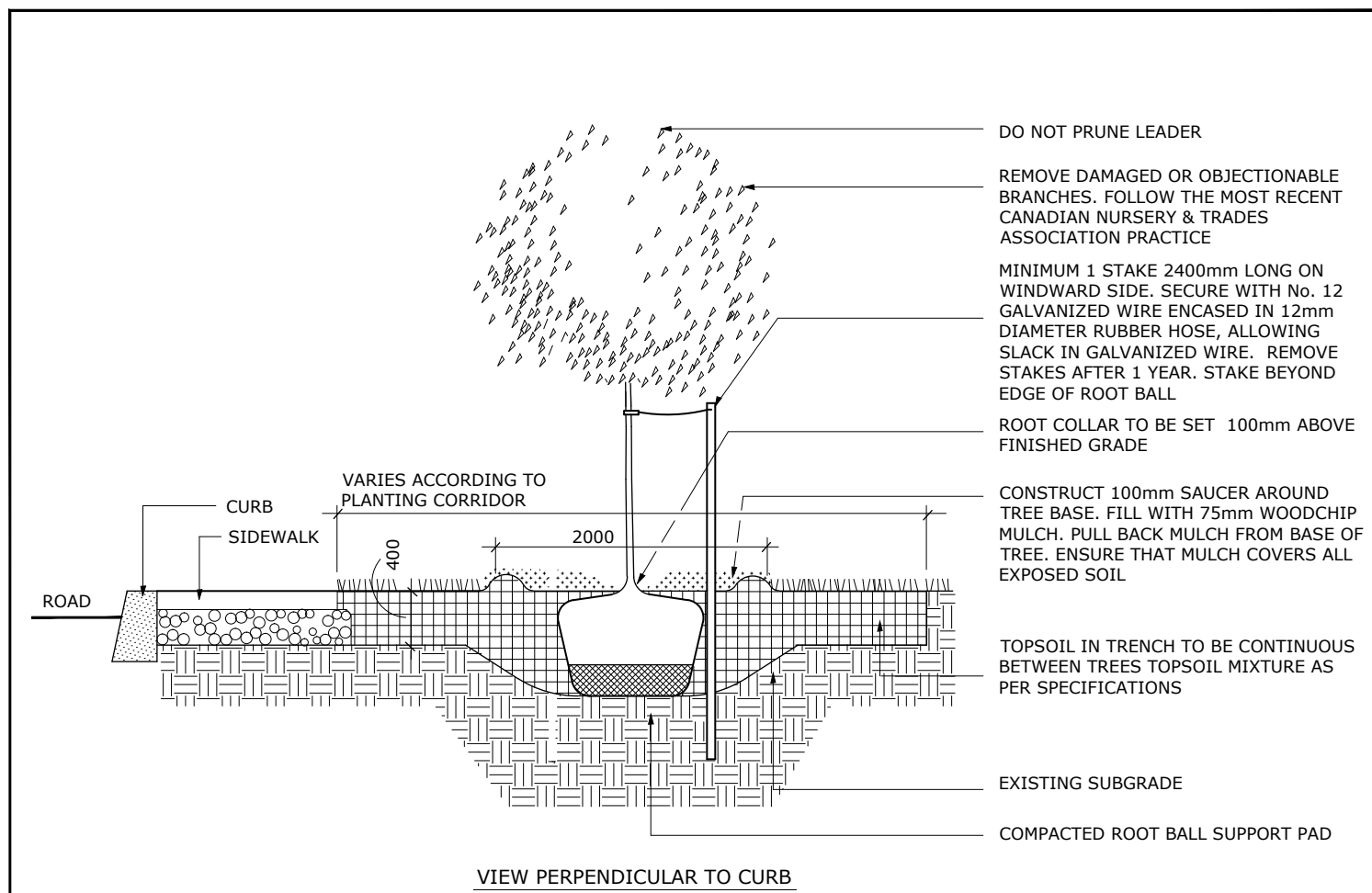

- NOTES:
1. ALL MEASUREMENTS ARE IN MILLIMETRES UNLESS OTHERWISE NOTED
  2. CUT AND REMOVE BURLAP AND WIRE BASKET FROM TOP 2/3 OF ROOT BALL WITHOUT DISTURBING ROOTS
  3. LOCATION AS SPECIFIED ON THE CONTRACT DRAWINGS



TITLE: PLANTING TRENCH WELL DRAINED SOILS

DATE: MAY 2001  
REV: JAN 2017  
DWG No: L1

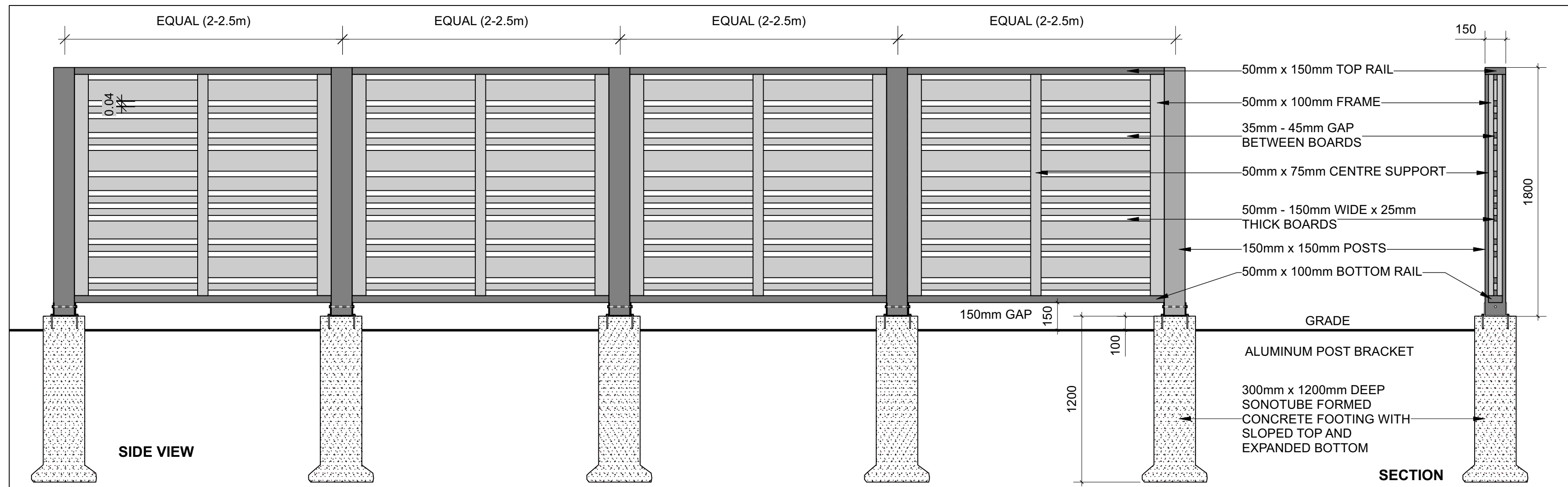

## 1 CEDAR SCREEN FENCE WITH CONCRETE FOOTINGS

Scale: NTS

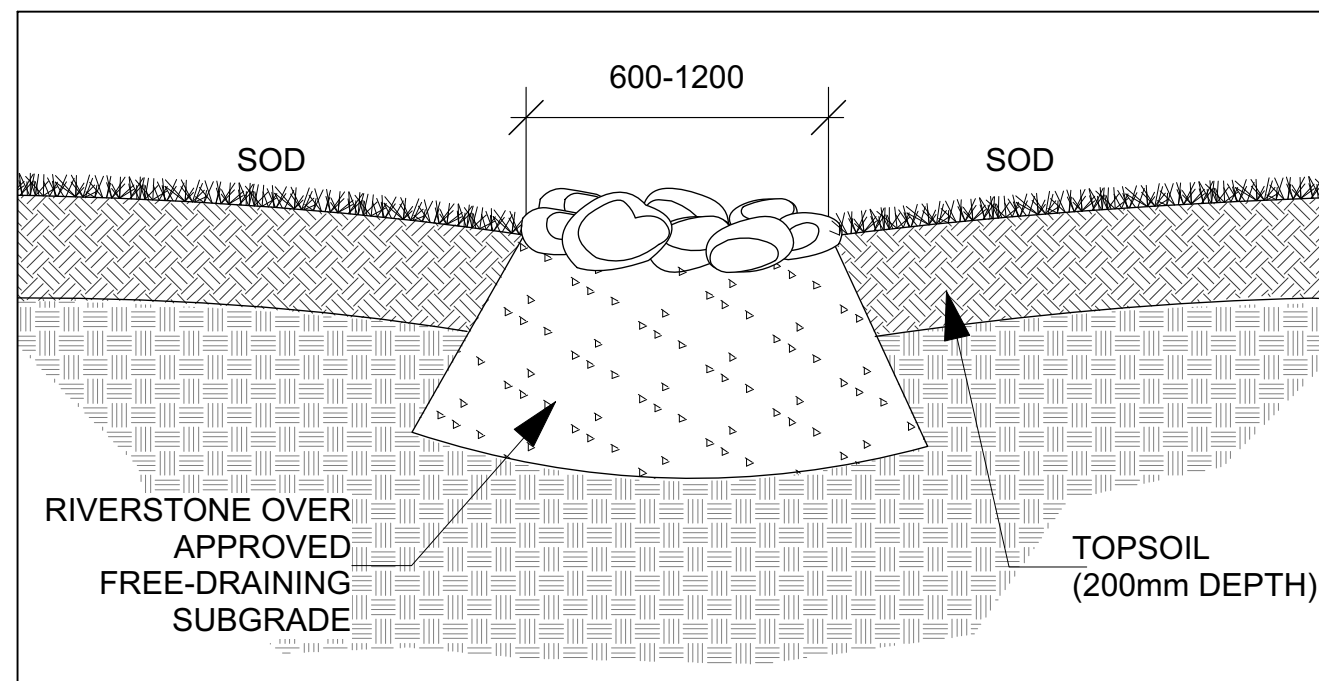

## 2 SWALE SECTION

Scale: NTS

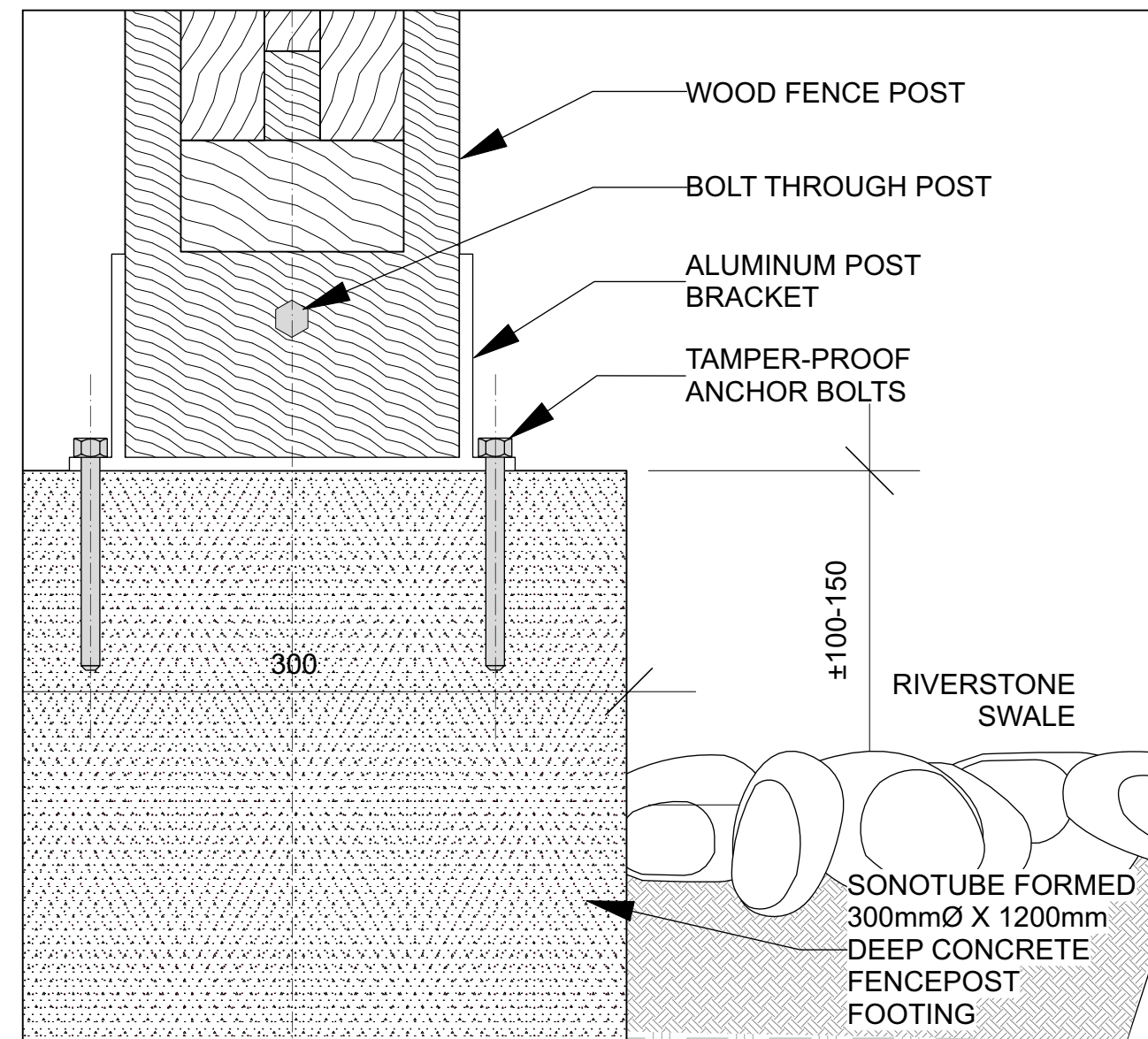

## 3 FENCE POST BASE

Scale: NTS

SHOWN FOR DESIGN PURPOSES ONLY. PROVIDE STAMPED ENGINEERED SHOP DRAWINGS INCLUDING FOOTINGS AND ANCHORAGE SYSTEM.

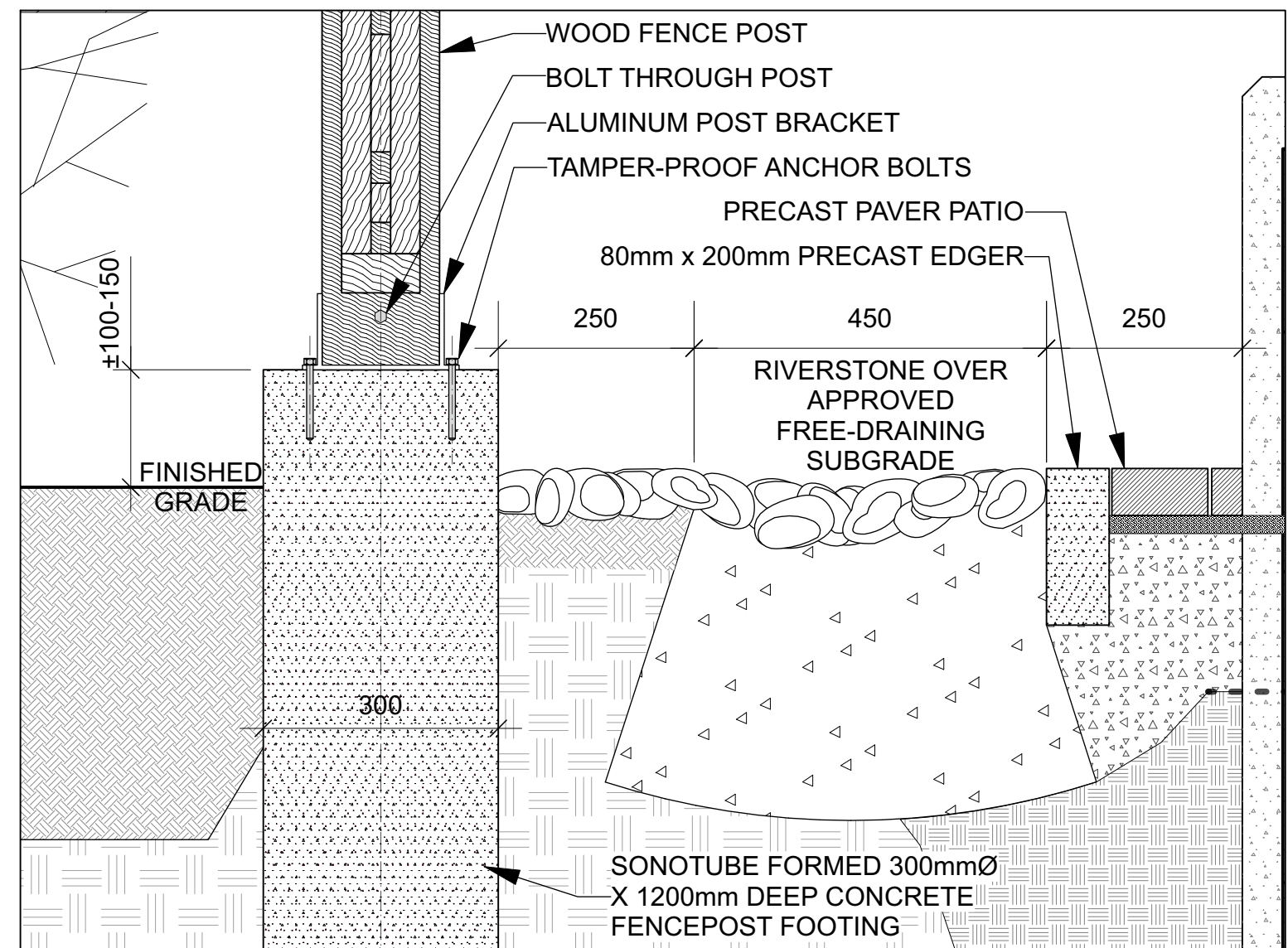

## 5 SWALE SECTION AT PERGOLA

Scale: NTS

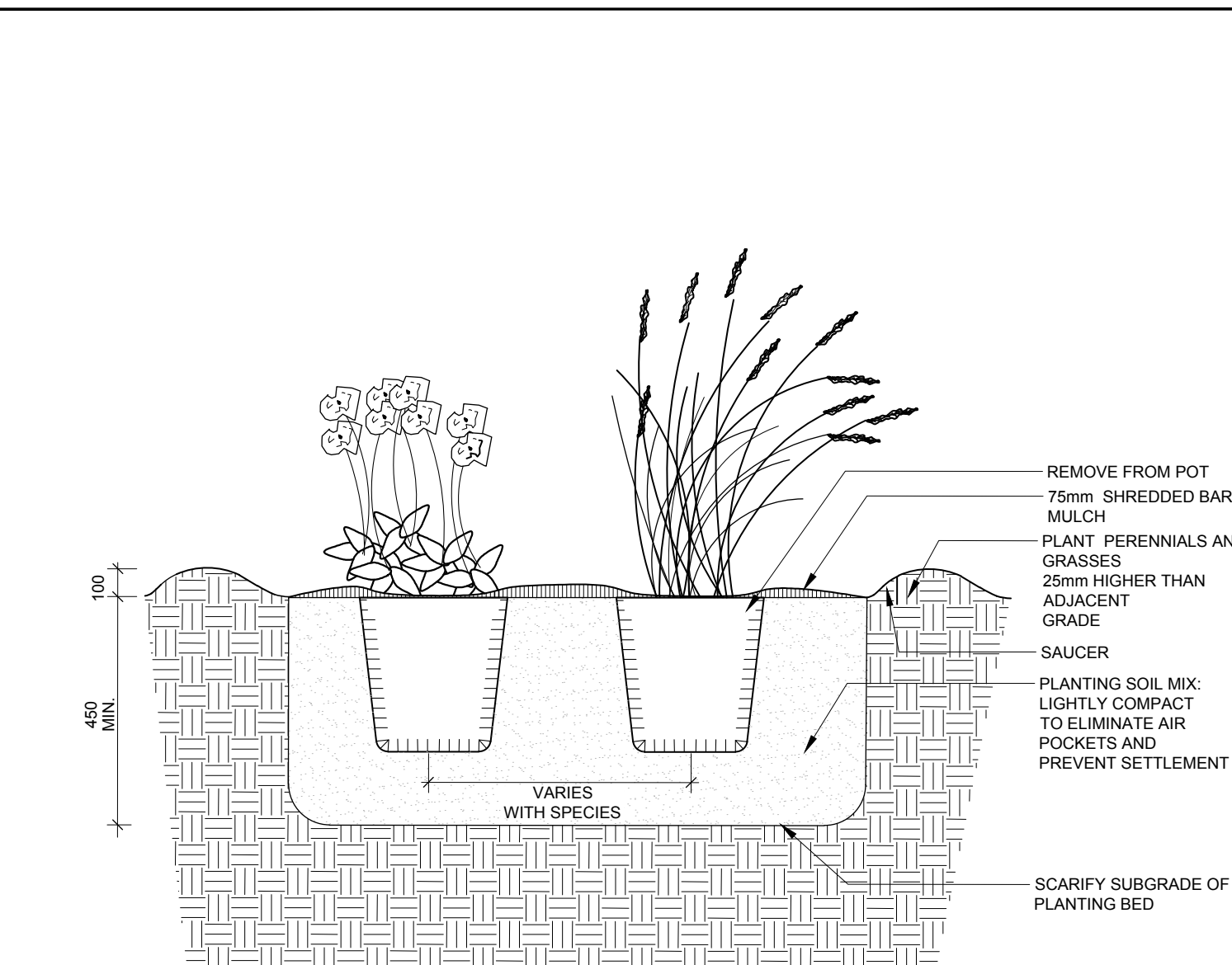

- NOTES:
1. ALL DIMENSIONS ARE IN MILLIMETRES UNLESS OTHERWISE NOTED.
  2. PLANTING SOIL MIXTURE AS PER SPECIFICATION.
  3. PROVIDE 100mm HIGH EARTH SAUCER AROUND PERENNIAL/GRASS BED.



TITLE: PERENNIAL AND ORNAMENTAL GRASS PLANTING

DATE: JAN 2015  
REV:  
DWG No: L21

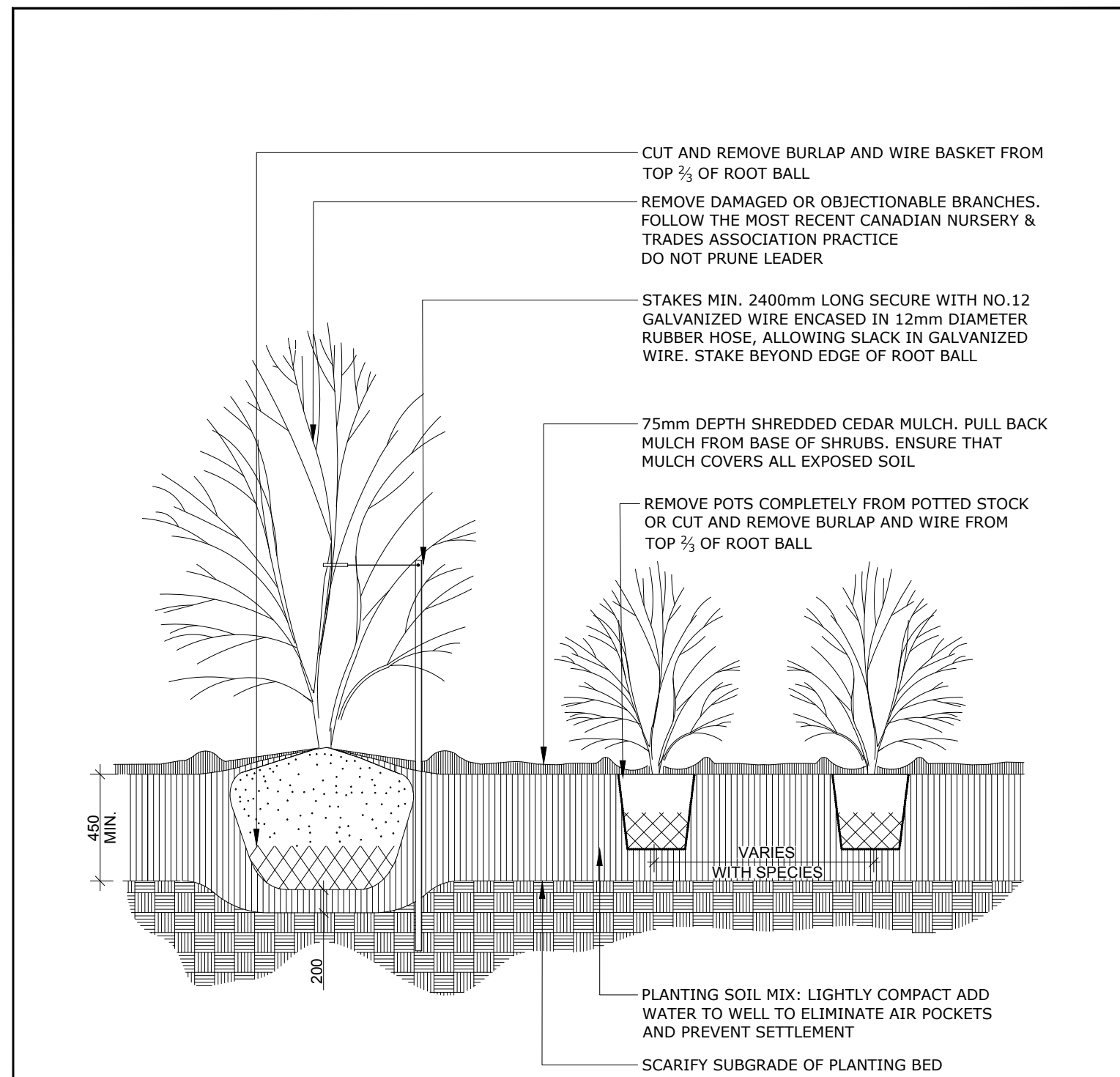

## NOTES:

1. PLANTING SOIL MIXTURE AS PER SPECIFICATION.
2. SHRUBS SPECIFIED BARE ROOTS (B.R.) TO BE PLANTED SO THAT ROOTS ARE FULLY EXTENDED IN PLANTING HOLE WITH SOIL MIX BACKFILLED CAREFULLY TO PREVENT ROOT DAMAGE
3. PROVIDE 100 HIGH EARTH SAUCER AROUND SHRUB BED
4. STAKES TO BE REMOVED AT COMPLETION OF TWO YEAR WARRANTY PERIOD



TITLE: CONTINUOUS SHRUB BED PLANTING

DATE: FEB 2013  
REV: FEB 2014  
DWG No: L17



## GENERAL NOTES

1. All general site information and conditions compiled from existing plans, surveys and consultant's field notes. Report all discrepancies prior to any work. No responsibility is born by the Consultant for unknown subsurface conditions.
2. The location of the utilities is approximate only, and the exact location should be determined by consulting the municipal authorities and utility companies concerned. The Contractor shall prove the location of utilities and shall be responsible for adequate protection from damage.
3. All dimensions shown are to be verified on site prior to any construction. No deviations are to be made from the layouts as shown on this plan without prior consultation with the Landscape Architect and Owner.
4. Obtain approval of Landscape Architect for granular base and layout of all pavement areas prior to construction.
5. Stake planting locations and receive approval of Landscape Architect, prior to excavation of any planting pits. No substitutions of plant material shall be made without prior approval of the Landscape Architect.
6. Where clay is encountered proper drainage must be ensured in tree/shrub pits, prior to planting. Have method approved by Landscape Architect.
7. All sodded areas to receive a minimum of 150mm of topsoil over graded sub-base. If sod with mesh is used, mesh to be removed completely during sodding operations. Sod shall come from an approved source and shall be laid within 24 hours of being cut in the nursery. Only nursery sod shall be used.
8. Final subgrade is to be approved by the Landscape Architect prior to sod being laid.
9. Maintain positive surface runoff through the entire construction period.
10. Reinststate all areas and items damaged as a result of construction activities.

3	Re-issued for Site Plan Control	2025-07-17
2	Re-issued for Site Plan Control	2025-04-15
1	Issued for Site Plan Control	2025-03-11
no.	revision	date

## Ruhland & Associates Ltd

204-1750 Courtwood Crescent, Ottawa, Ontario K3C 3B5  
P (613) 224-4744 x 822 F (613) 224-4151 info@rah.ca www.rah.ca

architect



N45 ARCHITECTURE INC.

71 Bank Street, 7th Floor - Ottawa, Ontario, K1P 9A2  
Tel: 613.224.0965 Fax: 613.224.8811

surveyor



Monument-Urso Surveying Ltd.  
Ontario Land Surveyors Canada Land Surveyors  
175 WOODWARD DRIVE, OTTAWA ON, K2C 0P9  
TEL: (613) 805-1583  
3307 FOURTH LINE EAST, SAULT STE. MARIE ON, P6A 6J8  
TEL: (705) 254-7651 FAX: (705) 254-5571

civil engineer



Engineers, Planners & Landscape Architects

structural and geotechnical engineer



STANTEC  
400-131 CLYDE AVENUE  
OTTAWA ON K2C 3G4  
T: 613.738.8070

## CARPENTERS DISTRICT COUNCIL OF ONTARIO LOCAL 93. - ADDITION

CAMPEAU DRIVE  
OTTAWA, ON

north	seal
-------	------

drawing title

## DETAILS

scale	drawn by
date	checked by
2023 06 09	M. Ruhland
project number	drawing number
N45 23-790	L- 04
RA 23-1724	revision

CONTRACTOR TO VERIFY ALL DIMENSIONS AND NOTIFY THE ARCHITECT OF ANY DISCREPANCIES BEFORE WORK COMMENCES.

DO NOT SCALE DRAWINGS



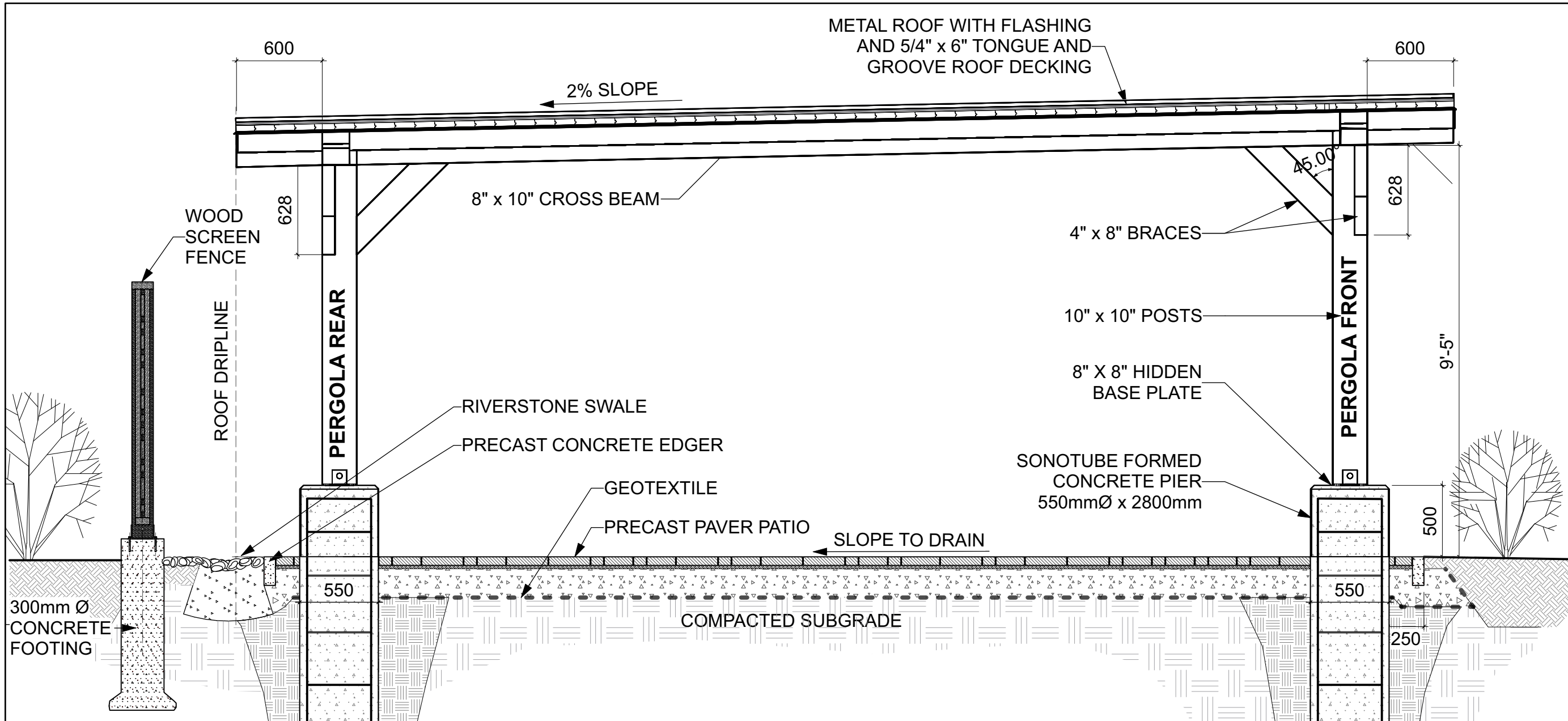

1 PERGOLA - SIDE ELEVATION  
Scale: NTS

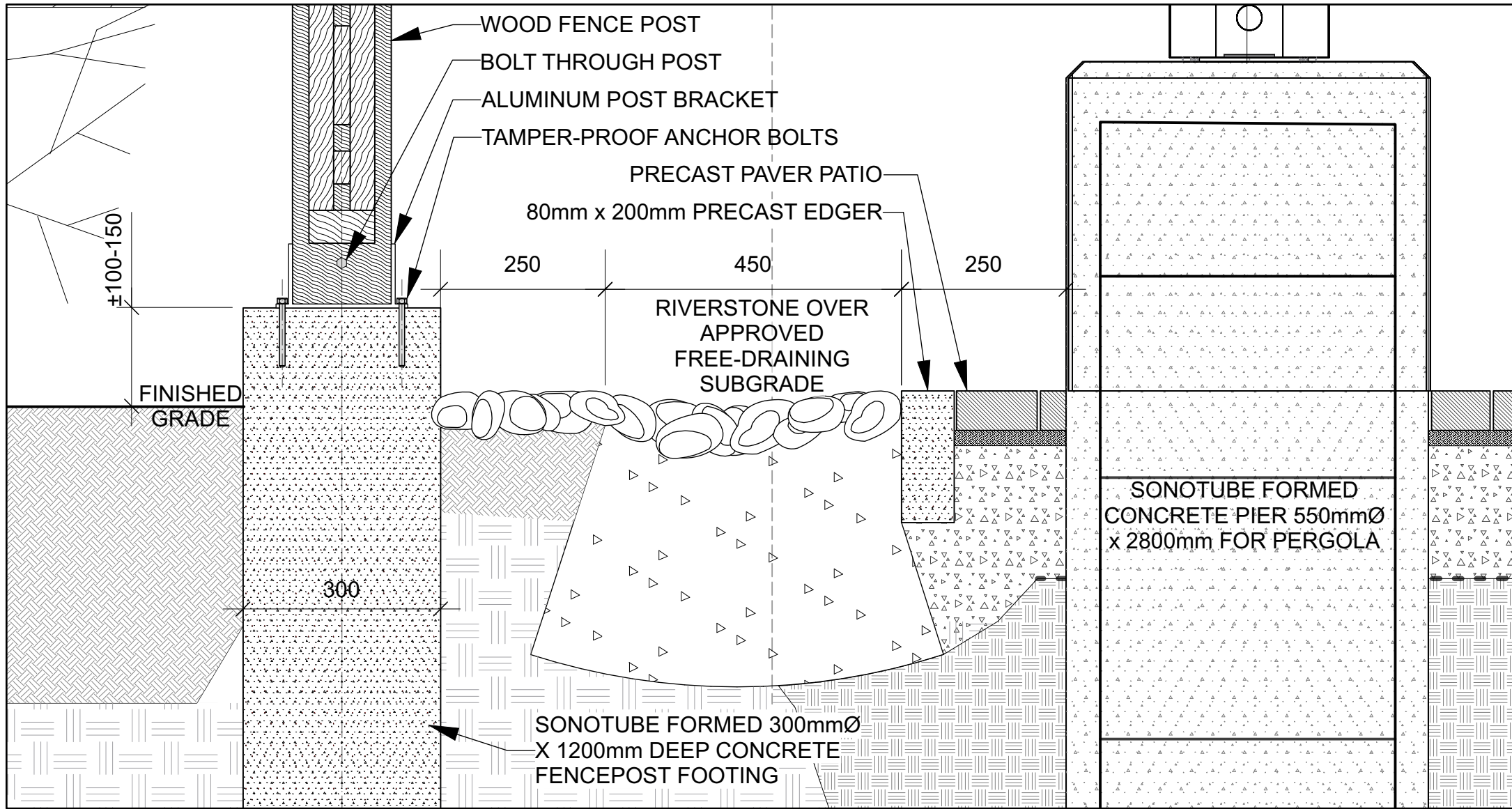

3 PERGOLA - FENCE FOOTING, SWALE, AND PERGOLA FOOTING SECTION  
Scale: NTS

## ROOFING AT REAR (LOWER) CORNER

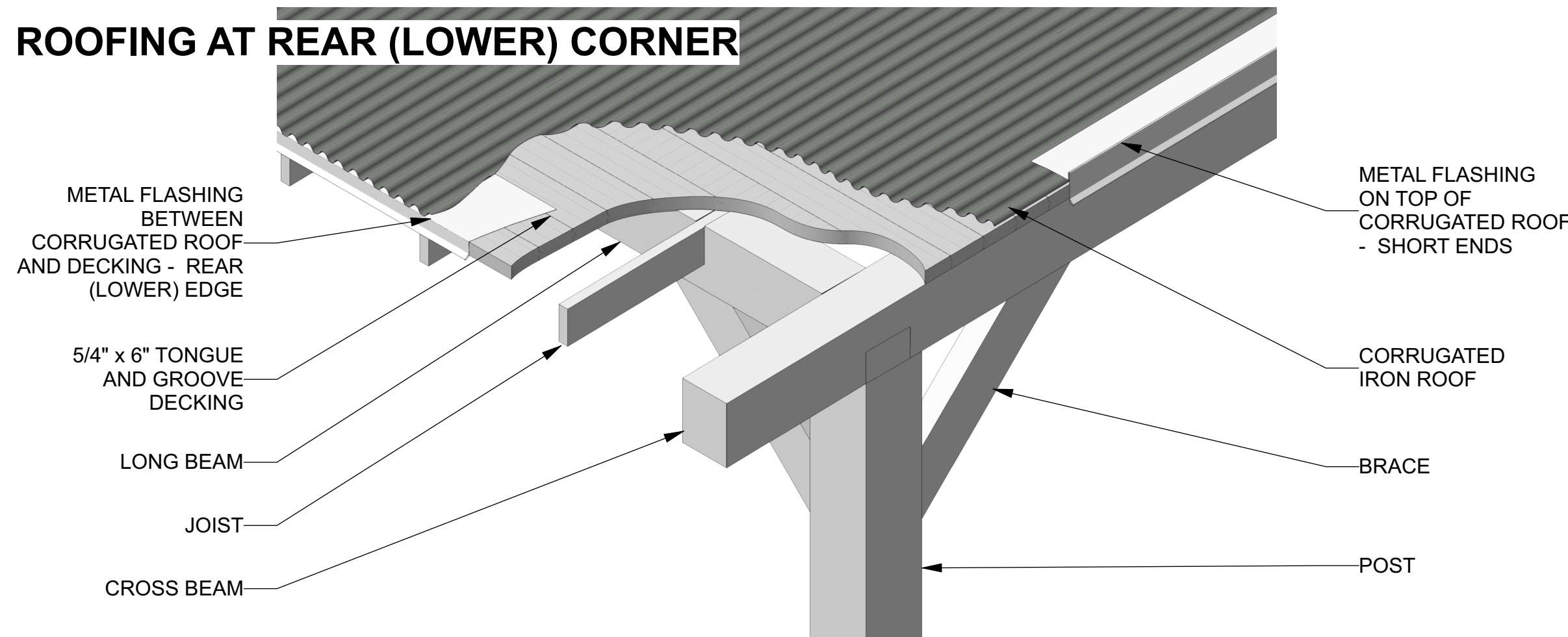

5 PERGOLA - ROOF CONSTRUCTION  
Scale: NTS



2 PERGOLA APPEARANCE  
Scale: NTS

NOTE: PERGOLA CONFIGURATION TO BE ADJUSTED ACCORDING TO SITE.

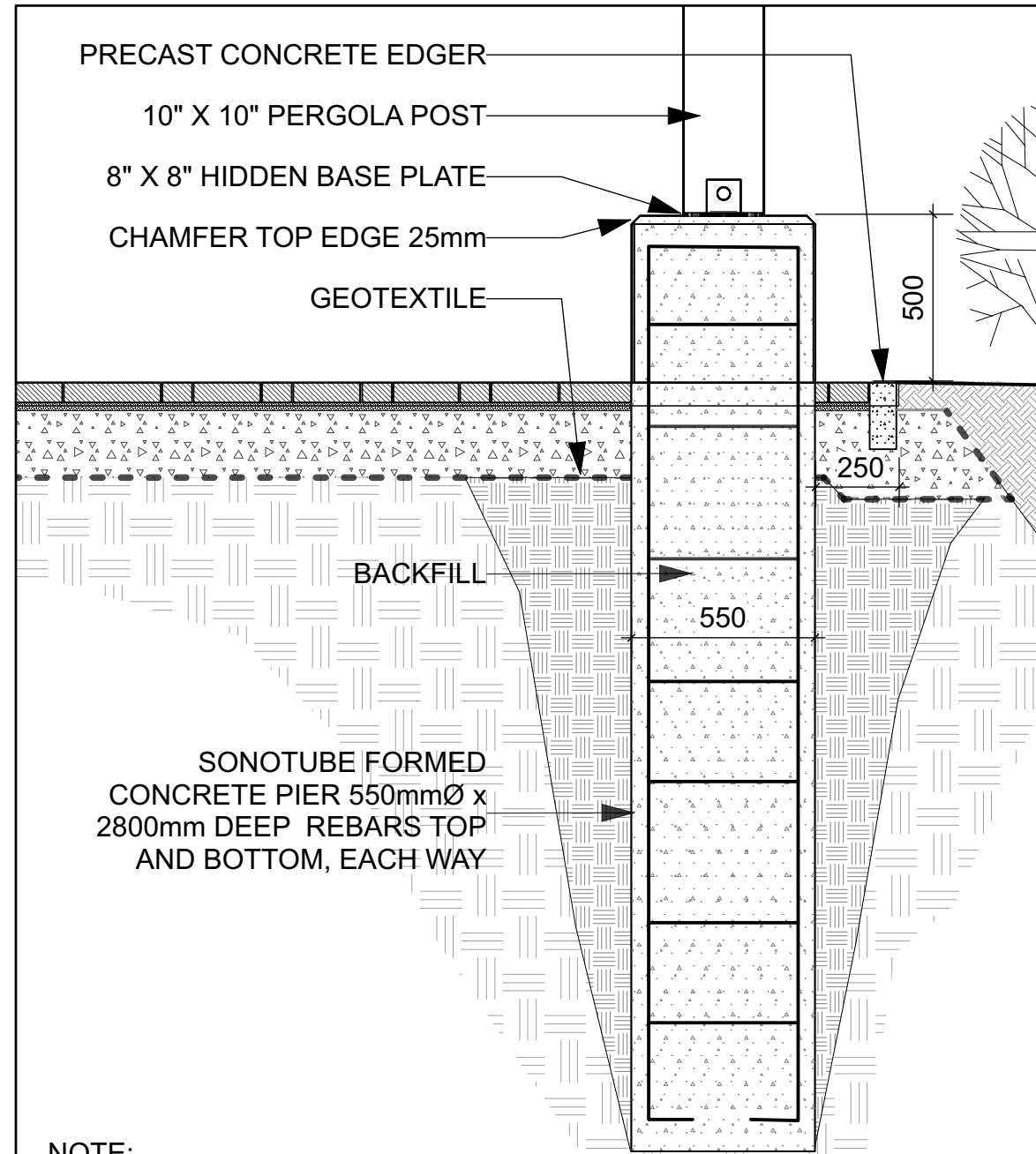

NOTE:  
• CONCRETE IN PIER TO BE CLASS C-2 (32MPa, AIR 5-8%).  
• CONCRETE IN FOOTING TO BE 25MPa.  
• ALL EXPOSED SURFACES TO BE LIGHTLY SANDBLASTED.  
• ALL REBARS TO BE EPOXY COATED.  
• INSTALL PERGOLA AS PER MANUFACTURER'S SPECIFICATIONS

4 PERGOLA FOOTING  
Scale: NTS

NOTE: DETAILS ARE SHOWN FOR DESIGN INTENT ONLY. PROVIDE FULL SHOP DRAWINGS, STAMPED BY A PROFESSIONAL ENGINEER LICENSED IN THE PROVINCE OF ONTARIO, FOR PERGOLA , FOOTINGS, REBAR DIMENSIONS, ANCHORAGE SYSTEM, AND STRUCTURAL COMPONENTS.



### GENERAL NOTES

- 1 All general site information and conditions compiled from existing plans, surveys and consultant's field notes. Report all discrepancies prior to any work. No responsibility is born by the Consultant for unknown subsurface conditions.
- 2 The location of the utilities is approximate only, and the exact location should be determined by consulting the municipal authorities and utility companies concerned. The Contractor shall prove the location of utilities and shall be responsible for adequate protection from damage.
- 3 All dimensions shown are to be verified on site prior to any construction. No deviations are to be made from the layouts as shown on this plan without prior consultation with the Landscape Architect and Owner.
- 4 Obtain approval of Landscape Architect for granular base and layout of all pavement areas prior to construction.
- 5 Stake planting locations and receive approval of Landscape Architect, prior to excavation of any planting pits. No substitutions of plant material shall be made without prior approval of the Landscape Architect.
- 6 Where clay is encountered proper drainage must be ensured in tree/shrub pits, prior to planting. Have method approved by Landscape Architect.
- 7 All sodded areas to receive a minimum of 150mm of topsoil over graded sub-base. If sod with mesh is used, mesh to be removed completely during sodding operations. Sod shall come from an approved source and shall be laid within 24 hours of being cut in the nursery. Only nursery sod shall be used.
- 8 Final subgrade is to approved by the Landscape Architect prior to sod being laid.
- 9 Maintain positive surface runoff through the entire construction period.
- 10 Reinststate all areas and items damaged as a result of construction activities.

no.	revision	date
3	Re-issued for Site Plan Control	2025-07-17
2	Re-issued for Site Plan Control	2025-04-15
1	Issued for Site Plan Control	2025-03-11

### Ruhland & Associates Ltd

204-1750 Courtwood Crescent, Ottawa, Ontario K2C 3B5  
P (613) 224-4744 x 822 F (613) 224-4151 info@rald.ca www.rald.ca

architect



### N45 ARCHITECTURE INC.

71 Bank Street, 7th Floor - Ottawa, Ontario, K1P 5K2  
Tel: 613.224.0955 Fax: 613.224.8811

surveyor

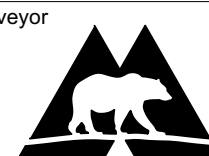

Monument-Urso Surveying Ltd.  
Ontario Land Surveyors Canada Land Surveyors  
1755 WOODWARD DRIVE, OTTAWA ON, K2C 0P9  
TEL: (613) 805-1550  
3387 FOURTH LINE EAST, SAULT STE. MARIE ON, P6A 6J8  
TEL: (705) 254-7651 FAX: (705) 254-5571

civil engineer

### NOVATECH

Engineers, Planners & Landscape Architects

structural and geotechnical engineer

### Stantec

240 MICHAEL COWPLAND DRIVE, SUITE 200 OTTAWA, ON, K2M 1P6  
T: 613.254.9643

## CARPENTERS DISTRICT COUNCIL OF ONTARIO LOCAL 93. - ADDITION

CAMPEAU DRIVE  
OTTAWA, ON

north	seal
-------	------

drawing title	
PERGOLA DETAILS	
scale	drawn by T. Frost / V. Odusanya
date	checked by 2023 06 09 M. Ruhland
project number	drawing number N45 23-790
RA 23-1724	L- 05
CONTRACTOR TO VERIFY ALL DIMENSIONS AND NOTIFY THE ARCHITECT OF ANY DISCREPANCIES BEFORE WORK COMMENCES.	
DO NOT SCALE DRAWINGS	
revision	