

MINTO  
**ABBOTT'S RUN PH2 - BLK 13**

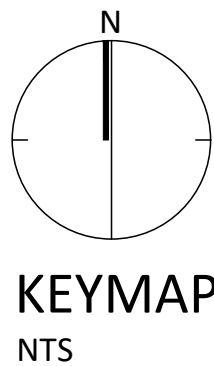

**LIST OF DRAWINGS:**

- L1.0 - LANDSCAPE PLAN
- L1.1 - TREE CANOPY CALCULATIONS AND SOIL VOLUMES
- L1.2 - LANDSCAPE ENLARGEMENTS
- L2.0 - DETAILS
- L2.1 - DETAILS





NOTES:  
THE LANDSCAPE PLAN WAS PREPARED IN CONJUNCTION WITH THE  
GEOTECHNICAL REPORT PREPARED BY PATERSON GROUP;  
• PG7460-1 DATED MAY 28, 2025

ALL EXISTING SITE INFORMATION AS PER SITE SURVEY 4M PLAN DATED MAY  
23, 2025 AND PREPARED BY ANNIS O'SULLIVAN, VOLLEBEKK LTD.

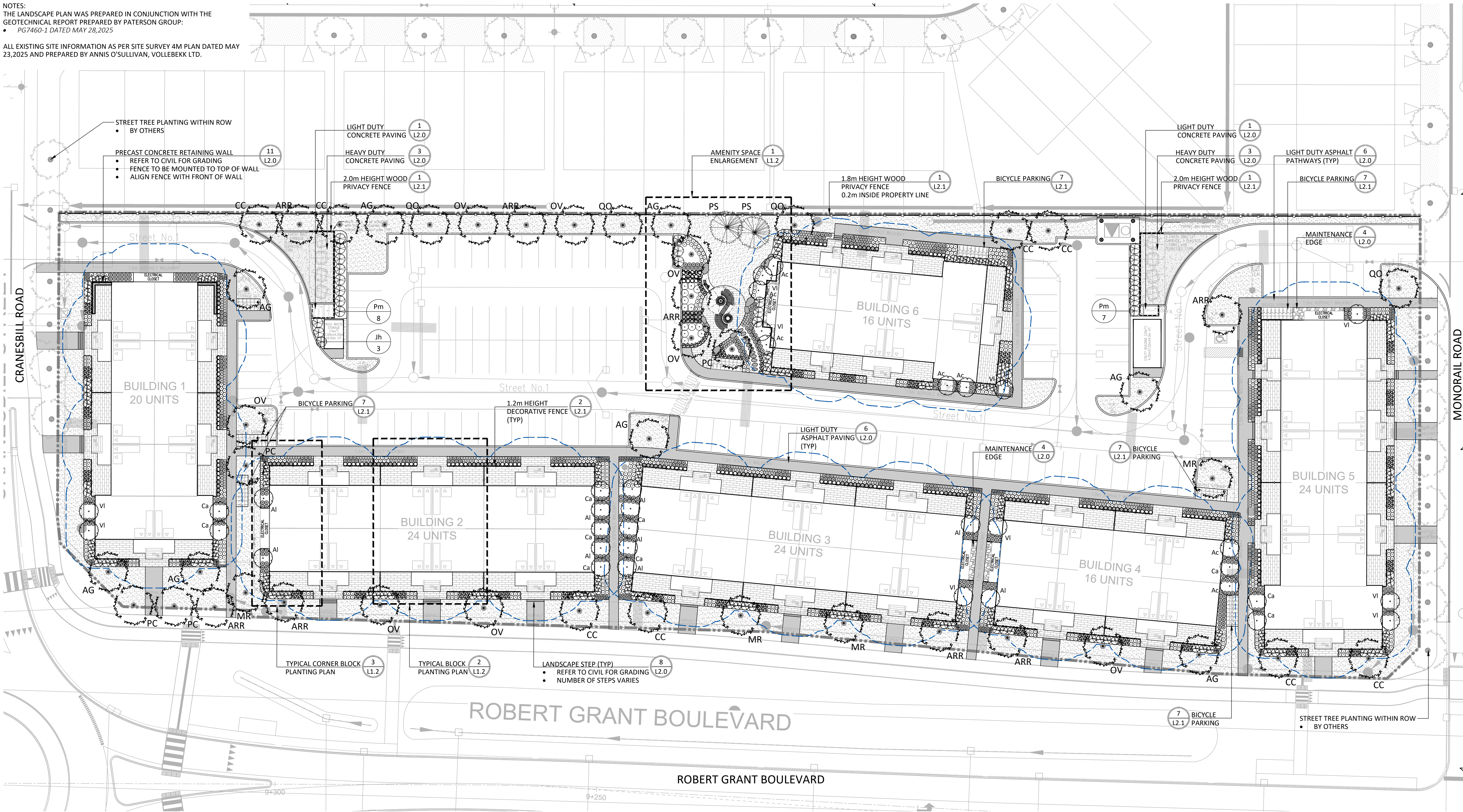

GENERAL NOTES:

- ALL PLANT MATERIAL SHALL BE NURSERY GROWN STOCK UNLESS OTHERWISE NOTED.
- TREES TO HAVE A MINIMUM 1800 CLEAR STEM ABOVE GRADE.
- CONTRACTOR TO MAKE GOOD ALL EXISTING AREAS DAMAGED BY HIS WORK TO THE SATISFACTION OF THE CONTRACTOR.
- ALL PLANT MATERIAL SHALL BE WARRANTED FOR TWO YEARS FROM THE DATE OF SUBSTANTIAL COMPLETION.
- CONTRACTOR TO VERIFY LOCATION OF ALL SERVICES PRIOR TO ANY EXCAVATION.
- ANY PROPOSED SUBSTITUTIONS OF PLANT SPECIES SHALL BE MADE WITH PLANTS OF EQUIVALENT OVERALL FORM, HEIGHT, BRANCHING HABIT, FLOWER, LEAF, COLOR, FRUIT AND CULTURE AND ONLY AFTER APPROVAL OF THE LANDSCAPE ARCHITECT.

TREE PLANTING IN MARINE CLAY SOILS

THE LANDSCAPE CONSIDERATIONS CONTAINED WITHIN SEC. 6.8 OF PATERSON GROUP'S GEOTECHNICAL INVESTIGATION, DATED MAY 28, 2025.

- THIS LANDSCAPE PLAN CONFORMS WITH THE TREE-TO-FOUNDATION SETBACK, SOIL VOLUME, AND SURFACE-GRADING REQUIREMENTS OUTLINED IN THE CITY OF OTTAWA'S GUIDELINES FOR TREE PLANTING IN SENSITIVE MARINE CLAY SOILS (2017), BASED ON THE FINDINGS OUTLINED IN THE PROJECT GEOTECHNICAL REPORT BY PATERSON GROUP (REPORT PG7460-1 DATED MAY 28, 2025).
- ADDITIONAL REQUIREMENTS OUTLINED IN THE CITY OF OTTAWA'S GUIDELINES FOR TREE PLANTING IN SENSITIVE MARINE CLAY SOILS (2017), INCLUDING USF DEPTH, FOUNDATION WALL REINFORCEMENT, AND SUBDIVISION GRADING, SHOULD BE CONFIRMED BY THE PROJECT ENGINEER(S).

PLANT LIST						
KEY	BOTANICAL NAME	COMMON NAME	QTY	SIZE	REMARKS	NATIVE
DECIDUOUS TREES - MEDIUM (8-14M HEIGHT) - TOTAL: 44 (PRIVATELY OWNED)						
AG	AESCULUS GLABRA	OHIO BUCKEYE	8	50mm	B&B	Y
ARR	ACER RUBRUM 'REDPOINTE'	REDPOINTE RED MAPLE	8	50mm	B&B	N
CC	CARPINUS CAROLINIANA	BLUE BEECH	8	50mm	B&B	Y
MR	MORUS RUBRA	RED MULBERRY	4	50mm	B&B	Y
OV	Ostrya virginiana	IRONWOOD	8	50mm	B&B	Y
PC	PRUNUS PENSYLVANICA	PIN CHERRY	4	50mm	B&B	Y
QO	QUERCUS PRINUS	CHESNUT OAK	4	50mm	B&B	Y
CONIFEROUS TREES - TOTAL: 2 (PRIVATELY OWNED)						
PS	PINUS STROBUS	WHITE PINE	2	200cm	B&B	Y
MULTISTEM SHRUBS - TOTAL: 36 (PRIVATELY OWNED)						
Ac	AMELANCHIER CANADENSIS	SERVICEBERRY	7	125cm HT	PT, CLUMP	Y
AI	AMELANCHIER LAEVIS	ALLEGHENY SERVICEBERRY	9	125cm HT	PT, CLUMP	Y
Ca	CORNUS ALTERNIFOLIA	PAGODA DOGWOOD	10	125cm HT	PT, CLUMP	Y
VI	VIBURNUM LENTAGO	NANNYBERRY	10	125cm HT	PT, CLUMP	Y
CONIFEROUS SHRUBS						
Jh	JUNIPERUS HORIZONTALIS	CREeping JUNIPER	9	3 GAL	POTTED	
Pm	PINUS MUGO VAR. PUMILIO	DWARF MUGO VAR. PUMILIO	15	3 GAL	POTTED	

DECIDUOUS SHRUBS						
Au	ARONIA 'LOW SCAPE MOUND'	LOW SCAPE MOUND CHokeberry	241	2 GAL	POTTED	
Cs	CORNUS SERICEA 'ARCTIC FIRE'	ARCTIC FIRE DOGWOOD	82	3 GAL	POTTED	
Po	PHYSOCARPUS OPULIFOLIUS 'LITTLE DEVIL'	LITTLE DEVIL NINEBARK	43	3 GAL	POTTED	
Ra	RHUS AROMATICA 'GRO-LOW'	GRO-LOW FRAGRANT SUMAC	13	3 GAL	POTTED	
So	SYMPHORICARPUS ORBICULATUS	CORALBERRY	39	2 GAL	POTTED	
GRASSES/PERENNIALS						
aa	ASTILBE ARDENSII 'BRIDAL VEIL'	BRIDAL VEIL FALSE SPIREA	234	1 GAL	POTTED	
bg	BOUTELOUA GRACILIS	SIDE OATS GRAMA	82	1 GAL	POTTED	
dc	DESCHAMPSIA CESPITOSA	TUFTED HAIR GRASS	81	1 GAL	POTTED	
ep	ECHINACEA PARADOXA	YELLOW CONEFLOWER	382	1 GAL	POTTED	
es	ECHINACEA SOMBRERO HOT CORAL	HOT CORAL CONEFLOWER	230	1 GAL	POTTED	
hb	HOSTA 'BLUE MOUSE EARS'	BLUE MOUSE EARS HOSTA	102	1 GAL	POTTED	
hf	HOSTA 'FRANCEE'	FRANCEE HOSTA	84	1 GAL	POTTED	
hg	HOSTA 'AUGUST MOON'	AUGUST MOON HOSTA	121	1 GAL	POTTED	
hr	HEMEROCALLIS 'RED MAGIC'	RED MAGIC DAYLILY	85	1 GAL	POTTED	
hv	HEMEROCALLIS 'VANILLA FLUFF'	VANILLA FLUFF DAYLILY	97	1 GAL	POTTED	
se	SEDUM 'HERBSTFREUDE'	AUTUMN JOY STONECROP	467	1 GAL	POTTED	
sh	SPOROBOLUS HETEROLEPSIS	PRairie DROPSEED	138	1 GAL	POTTED	

Contractor shall check all dimensions on the work and report any discrepancy to the Landscape Architect before proceeding. All drawings and specifications are the property of the Landscape Architect and must be returned at the completion of the work. This drawing is not to be used for construction until signed by the Landscape Architect.

LEGEND

- PROPERTY LINE  
--- GEOTECHNICAL FOUNDATION SETBACK (4.5m)
- FENCING
- 2.0m HT. WOOD PRIVACY FENCE  
--- 1.8m HT. WOOD PRIVACY FENCE  
--- 1.2m HT. DECORATIVE FENCE
- PLANTING
- MEDIUM DECIDUOUS TREE  
○ CONIFEROUS TREE  
○ TREE CANOPY PROJECTION AT MATURITY  
○ TREE FORM SHRUB  
○ DECIDUOUS/CONIFEROUS SHRUB  
○ GRASSES/PERENNIALS  
○ SODDING

PAVING

- LIGHT DUTY ASPHALT WALKWAYS  
--- LIGHT DUTY CONCRETE PAVING  
--- HEAVY DUTY CONCRETE PAVING  
--- PRECAST UNIT PAVERS  
--- RIVERSTONE PAVING  
--- PRECAST EDGER

SITE FURNISHINGS

- BENCH  
--- BIKE RACK  
--- LANDSCAPE BOULDERS  
--- FLAGSTONE STEPPING STONES

PLANTING KEY

- XX QUANTITY  
00 QUANTITY

DETAIL KEY

- 1 DETAIL NO.  
L1 SHEET NO.

3	Issued for First Submission	Jun.25/25
2	Issued for Client Review	Jun.02/25
1	Issued for Client Review	Apr.21/25
No.	Description	Date

Revision	City Approval Stamp	OWNERSHIP MINTO COMMUNITIES INC. 200-180 Kent St., Ottawa, ON
		ARCHITECT SHR ARCHITECTS 8395 June St., Vaughan, ON
		PLANNING ALCADIS 333 Preston St. Suite 500, Ottawa, ON
		CIVIL/SERVICING DEL 120 Iber Rd. Suite 103, Ottawa, ON
		TRAFFIC/NOISE NOVATICH 240 Michael Cowpland Dr. Suite 101, Ottawa, ON
		LANDSCAPE ARCHITECT NAK DESIGN STRATEGIES 1285 Wellington St., Ottawa, ON

PROPERTY INFORMATION  
Part of Lot 28, Concession 11, Geographic Township of Goulbourn, City of Ottawa, Part of PIN 04560-7879

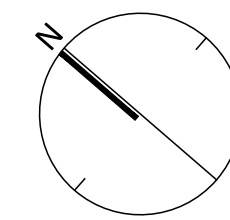

**NAK**  
design strategies

1285 WELLINGTON STREET, OTTAWA, ON K1Y 3A8 CANADA  
613.237.2345  
Project

PHASE 2  
ABBOTT'S RUN BLOCK 13  
5618 HAZELDEAN RD, OTTAWA, ON

Title	LANDSCAPE PLAN
Date	2025-04-21
Scale	1:300
Drawn	SW
Checked	PG
Job No.	25-083
Sheet	L1.0

PLAN N° XXXXX

CITY FILE N° XXX-XX-XXXX



NOTES:  
THE LANDSCAPE PLAN WAS PREPARED IN CONJUNCTION WITH THE  
GEOTECHNICAL REPORT PREPARED BY PATERSON GROUP;  
• PG7460-1 DATED MAY 28, 2025

ALL EXISTING SITE INFORMATION AS PER SITE SURVEY 4M PLAN DATED MAY  
23, 2025 AND PREPARED BY ANNIS O'SULLIVAN, VOLLEBEKK LTD.

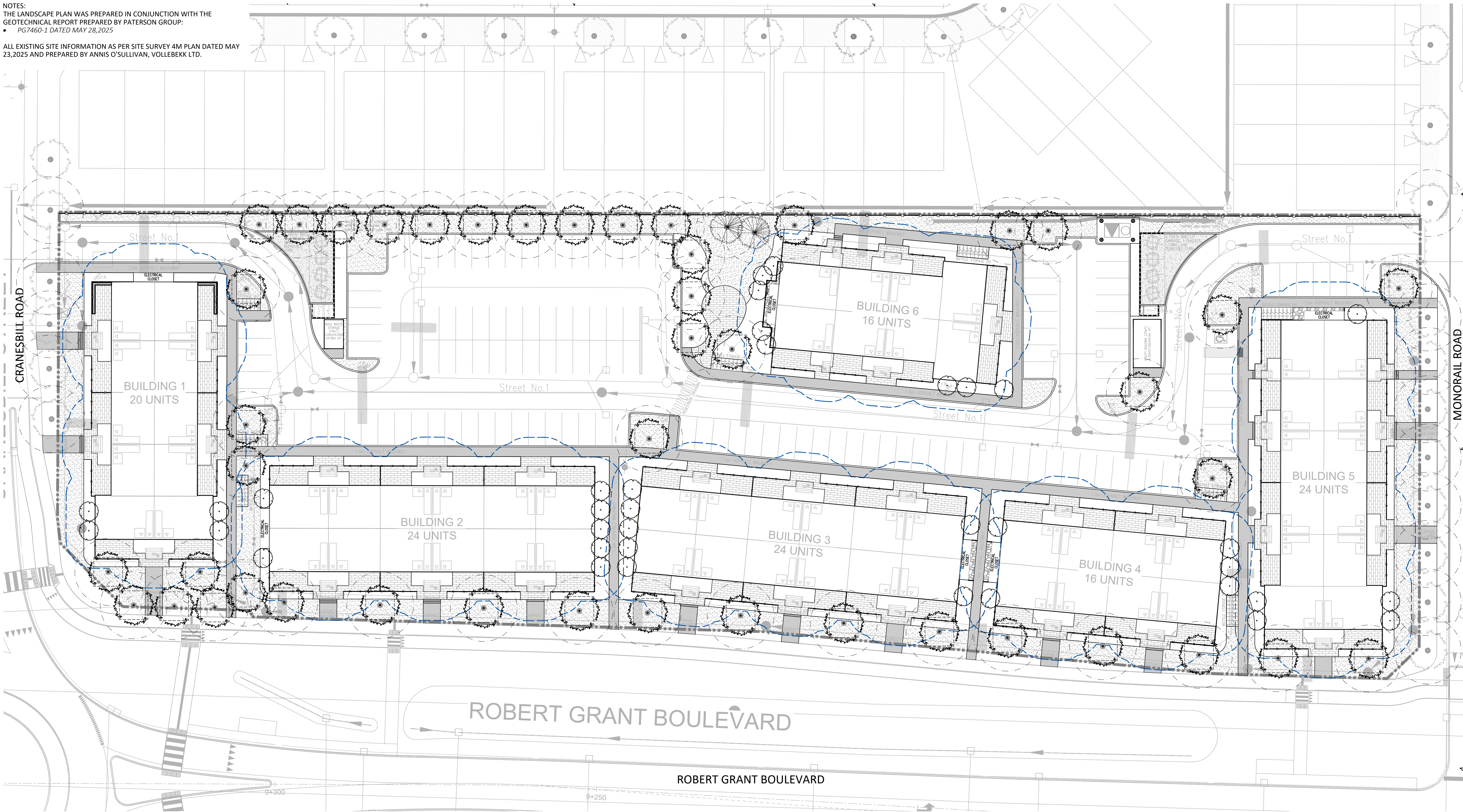

GENERAL NOTES:

- ALL PLANT MATERIAL SHALL BE NURSERY GROWN STOCK UNLESS OTHERWISE NOTED.
- TREES TO HAVE A MINIMUM 1800 CLEAR STEM ABOVE GRADE.
- CONTRACTOR TO MAKE GOOD ALL EXISTING AREAS DAMAGED BY HIS WORK TO THE SATISFACTION OF THE CONTRACTOR.
- ALL PLANT MATERIAL SHALL BE WARRANTED FOR TWO YEARS FROM THE DATE OF SUBSTANTIAL COMPLETION.
- CONTRACTOR TO VERIFY LOCATION OF ALL SERVICES PRIOR TO ANY EXCAVATION.
- ANY PROPOSED SUBSTITUTIONS OF PLANT SPECIES SHALL BE MADE WITH PLANTS OF EQUIVALENT OVERALL FORM, HEIGHT, BRANCHING HABIT, FLOWER, LEAF, COLOR, FRUIT AND CULTURE AND ONLY AFTER APPROVAL OF THE LANDSCAPE ARCHITECT.

TREE PLANTING IN MARINE CLAY SOILS

- THE LANDSCAPE CONSIDERATIONS CONTAINED WITHIN SEC. 6.8 OF PATERSON GROUP'S GEOTECHNICAL INVESTIGATION, DATED MAY 28, 2025.
- THIS LANDSCAPE PLAN CONFORMS WITH THE TREE-TO-FOUNDATION SETBACK, SOIL VOLUME, AND SURFACE-GRADING REQUIREMENTS OUTLINED IN THE CITY OF OTTAWA'S GUIDELINES FOR TREE PLANTING IN SENSITIVE MARINE CLAY SOILS (2017), BASED ON THE FINDINGS OUTLINED IN THE PROJECT GEOTECHNICAL REPORT BY PATERSON GROUP (REPORT PG7460-1 DATED MAY 28, 2025).
  - ADDITIONAL REQUIREMENTS OUTLINED IN THE CITY OF OTTAWA'S GUIDELINES FOR TREE PLANTING IN SENSITIVE MARINE CLAY SOILS (2017), INCLUDING USF DEPTH, FOUNDATION WALL REINFORCEMENT, AND SUBDIVISION GRADING, SHOULD BE CONFIRMED BY THE PROJECT ENGINEER(S).

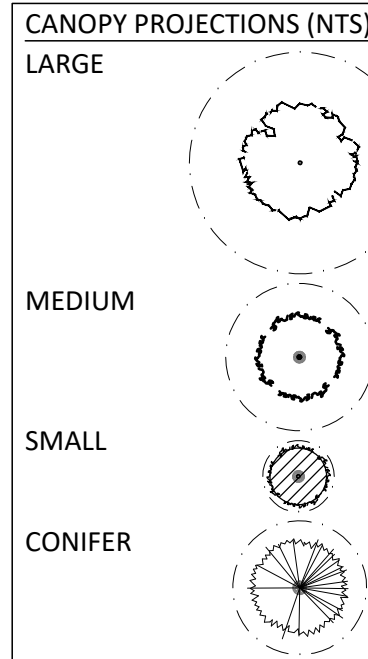

PROPOSED TREE CANOPY PROJECTIONS			
TREE TYPE/SIZE	CROWN AREA PER TREE STANDARD RANGE (m <sup>2</sup> )	CROWN AREA PER TREE USED FOR CALC. (m <sup>2</sup> )	SITE CANOPY COVER
LARGE (0)	135-250*	192	CANOPY (W OVERLAP): 1,780m <sup>2</sup>
MEDIUM (44)	35-135*	85	
SMALL (0)	5-35*	20	
CONIFER (2)	45-96*	70	
PROPOSED STREET TREE CANOPY OVERLAPPING SITE			
PROPOSED STREET TREE CANOPY, m <sup>2</sup> CALCULATION BASED ON PROPOSED SPECIES AVERAGE MATURE CANOPY SIZE.			CANOPY (W. OVERLAP): 300m <sup>2</sup>
*RANGE OF CROWN AREAS IS IN ACCORDANCE WITH PROPOSED TREES SPECIES			SITE: 13,930m <sup>2</sup>
**CROWN AREAS ARE ACCORDING TO THE AVERAGE MATURE CANOPY SIZE OF THE RESPECTIVE SPECIES. CANOPY SIZING HAS BEEN DETERMINED IN REFERENCE TO VARIOUS ARBORICULTURAL AND BOTANICAL SOURCES, SUCH AS: ONTARIO MINISTRY OF NATURAL RESOURCES & FORESTRY (OMNRF); US FOREST SERVICE; FARRAR, J.L. TREES IN CANADA, UNIVERSITY OF GUELPH ARBORETUM, VARIOUS PUBLICATIONS			TOTAL PERCENT COVER: 14.93%

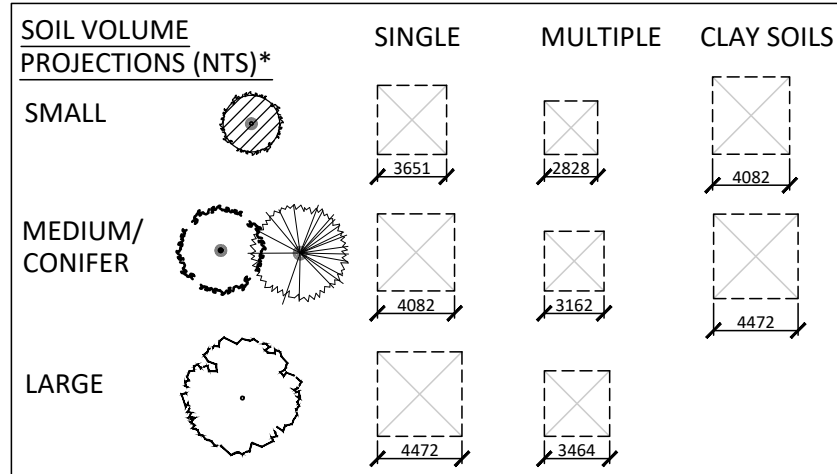

TREE SOIL VOLUMES			
TREE TYPE/SIZE	SINGLE TREE SOIL VOLUME	MULTIPLE TREE SOIL VOLUME (m <sup>3</sup> /TREE)	SOIL VOLUME FOR MARINE CLAY AREAS (SINGLE TREE)
ORNAMENTAL	15	9	
COLUMNAR	15	9	
SMALL	20	12	25
MEDIUM	25	15	30
LARGE	30	18	
CONIFER	25	15	
*SOIL VOLUME CALCULATION BASED ON 1.5m DEPTH			

Contractor shall check all dimensions on the work and report any discrepancy to the Landscape Architect before proceeding. All drawings and specifications are the property of the Landscape Architect and must be returned at the completion of the work. This drawing is not to be used for construction until signed by the Landscape Architect.

LEGEND

PROPERTY LINE

GEOTECHNICAL FOUNDATION SETBACK (4.5m)

FENCING

2.0m HT. WOOD PRIVACY FENCE

1.8m HT. WOOD PRIVACY FENCE

1.2m HT. DECORATIVE FENCE

PLANTING

MEDIUM DECIDUOUS TREE

CONIFEROUS TREE

TREE CANOPY PROJECTION AT MATURITY

TREE FORM SHRUB

DECIDUOUS/CONIFEROUS SHRUB

GRASSES/PERENNIALS

SODDING

PAVING

LIGHT DUTY ASPHALT WALKWAYS

LIGHT DUTY CONCRETE PAVING

HEAVY DUTY CONCRETE PAVING

PRECAST UNIT PAVERS

RIVERSTONE PAVING

PRECAST EDGER

SITE FURNISHINGS

BENCH

BIKE RACK

LANDSCAPE BOULDERS

FLAGSTONE STEPPING STONES

PLANTING KEY

SHRUB/PERENNIAL SPECIES

QUANTITY

DETAIL KEY

DETAIL NO.

SHEET NO.

3	Issued for First Submission	Jun.25/25
2	Issued for Client Review	Jun.02/25
1	Issued for Client Review	Apr.21/25
No.	Description	Date
Revision		
City Approval Stamp		
OWNERSHIP MINTO COMMUNITIES INC. 200-180 Kent St., Ottawa, ON		
ARCHITECT SRN ARCHITECTS 8359 June St., Vaughan, ON		
PLANNING ARCADIS 833 Preston St. Suite 500, Ottawa, ON		
CIVIL/SERVICING D&L 120 Iber Rd. Suite 103, Ottawa, ON		
TRAFFIC/NOISE NOVATICH 240 Michael Cowpland Dr. Suite 101, Ottawa, ON		
LANDSCAPE ARCHITECT NAK DESIGN STRATEGIES 1285 Wellington St., Ottawa, ON		

PROPERTY INFORMATION  
Part of Lot 28, Concession 11, Geographic Township of Goulbourn, City of Ottawa, Part of PN 04560-7879

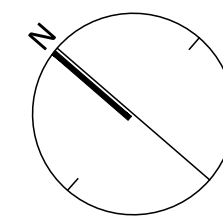

NAK  
design strategies

1285 WELLINGTON STREET, OTTAWA, ON K1Y 3A8 CANADA  
T 613.237.2345  
Project

PHASE 2  
ABBOTT'S RUN BLOCK 13  
5618 HAZELDEAN RD, OTTAWA, ON

Title		
TREE CANOPY CALCULATIONS AND SOIL VOLUMES		
Date	2025-04-21	Sheet
Scale	1:300	L1.1
Drawn	SW	
Checked	PG	
Job No.	25-083	

PLAN N° XXXXX

CITY FILE N° XXX-XX-XX-XXXX



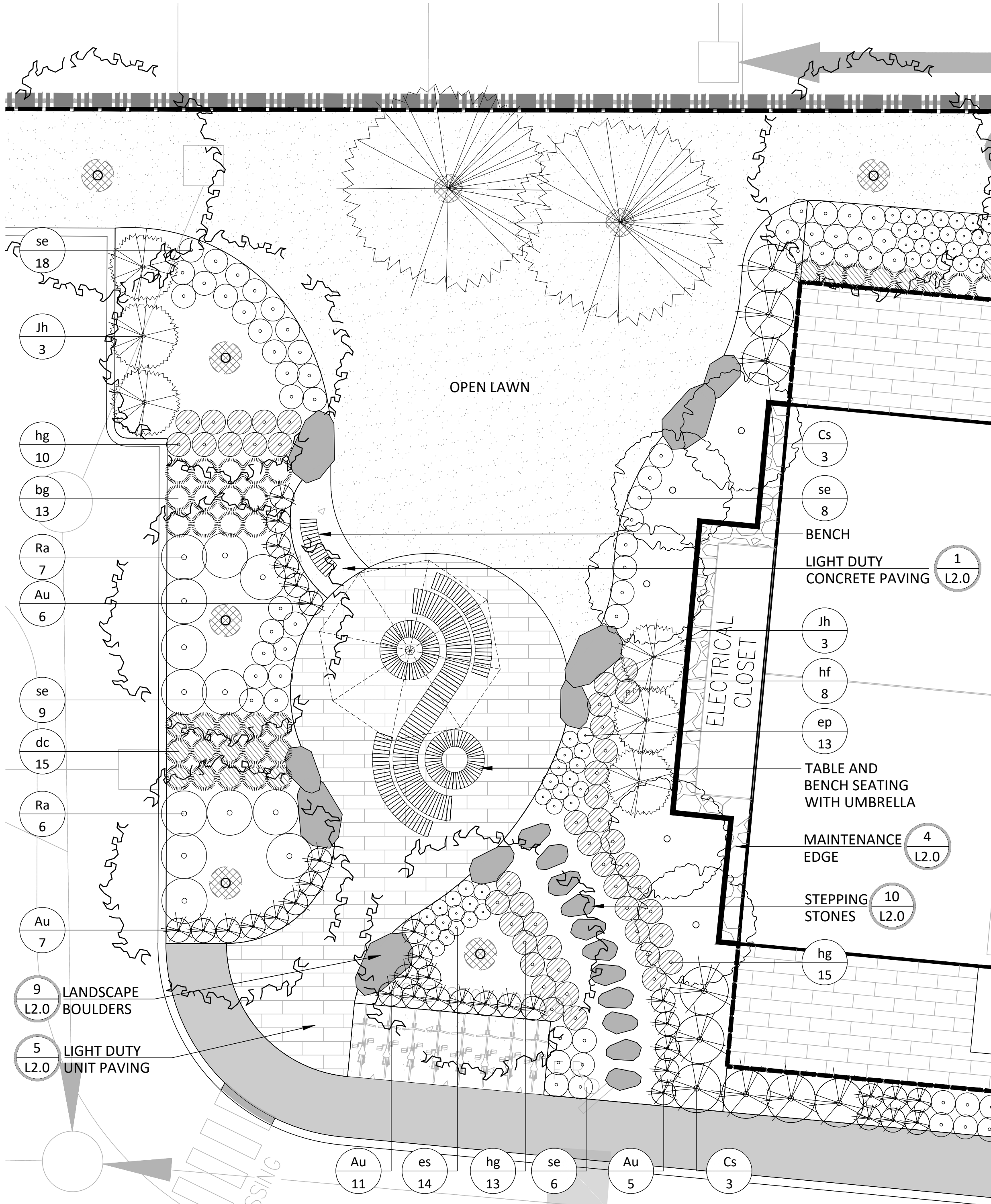

1 AMENITY SPACE OPTION A  
1:75

PLANT LIST						
KEY	BOTANICAL NAME	COMMON NAME	QTY	SIZE	REMARKS	NATIVE
DECIDUOUS TREES - MEDIUM (8-14M HEIGHT) - TOTAL: 44 (PRIVATELY OWNED)						
AG	AESCULUS GLABRA	OHIO BUCKEYE	8	50mm	B&B	Y
ARR	ACER RUBRUM 'REDPOINTE'	REDPOINTE RED MAPLE	8	50mm	B&B	N
CC	CARPINUS CAROLINIANA	BLUE BEECH	8	50mm	B&B	Y
MR	MORUS RUBRA	RED MULBERRY	4	50mm	B&B	Y
OV	OSTRYA VIRGINIANA	IRONWOOD	8	50mm	B&B	Y
PC	PRUNUS PENSYLVANICA	PIN CHERRY	4	50mm	B&B	Y
QO	QUERCUS PRINUS	CHESNUT OAK	4	50mm	B&B	Y
CONIFEROUS TREES - TOTAL: 2 (PRIVATELY OWNED)						
PS	PINUS STROBUS	WHITE PINE	2	200cm	B&B	Y
MULTISTEM SHRUBS - TOTAL: 36 (PRIVATELY OWNED)						
Ac	AMELANCHIER CANADENSIS	SERVICEBERRY	7	125cm HT	PT, CLUMP	Y
Al	AMELANCHIER LAEVIS	ALLEGHENY SERVICEBERRY	9	125cm HT	PT, CLUMP	Y
Ca	CORNUS ALTERNIFOLIA	PAGODA DOGWOOD	10	125cm HT	PT, CLUMP	Y
VI	VIBURNUM LENTAGO	NANNYBERRY	10	125cm HT	PT, CLUMP	Y
CONIFEROUS SHRUBS						
Jh	JUNIPERUS HORIZONTALIS	CREeping JUNIPER	9	3 GAL	POTTED	
Pm	PINUS MUGO VAR. PUMILIO	DWARF MUGO VAR. PUMILIO	15	3 GAL	POTTED	

DECIDUOUS SHRUBS						
Au	ARONIA 'LOW SCAPE MOUND'	LOW SCAPE MOUND CHOKEBERRY	241	2 GAL	POTTED	
Cs	CORNUS SERICEA 'ARCTIC FIRE'	ARCTIC FIRE DOGWOOD	82	3 GAL	POTTED	
Po	PHYSOCARPUS OPULIFOLIUS 'LITTLE DEVIL'	LITTLE DEVIL NINEBARK	43	3 GAL	POTTED	
Ra	RHUS AROMATICA 'GRO-LOW'	GRO-LOW FRAGRANT SUMAC	13	3 GAL	POTTED	
So	SYMPHORICARPOS ORBICULATUS	CORALBERRY	39	2 GAL	POTTED	
GRASSES/PERENNIALS						
aa	ASTILBE ARDENSII 'BRIDAL VEIL'	BRIDAL VEIL FALSE SPIREA	234	1 GAL	POTTED	
bg	BOUTELOUA GRACILIS	SIDE OATS GRAMA	82	1 GAL	POTTED	
dc	DESCHAMPسيا CESPITOSA	TUFTED HAIR GRASS	81	1 GAL	POTTED	
ep	ECHINACEA PARADOXA	YELLOW CONEFLOWER	382	1 GAL	POTTED	
es	ECHINACEA SOMBRERO HOT CORAL	HOT CORAL CONEFLOWER	230	1 GAL	POTTED	
hb	HOSTA 'BLUE MOUSE EARS'	BLUE MOUSE EARS HOSTA	102	1 GAL	POTTED	
hf	HOSTA 'FRANCEE'	FRANCEE HOSTA	84	1 GAL	POTTED	
hg	HOSTA 'AUGUST MOON'	AUGUST MOON HOSTA	121	1 GAL	POTTED	
hr	HEMEROCALLIS 'RED MAGIC'	RED MAGIC DAYLILY	85	1 GAL	POTTED	
hv	HEMEROCALLIS 'VANILLA FLUFF'	VANILLA FLUFF DAYLILY	97	1 GAL	POTTED	
se	SEDUM 'HERBSTFREUDE'	AUTUMN JOY STONECROP	467	1 GAL	POTTED	
sh	SPOROBOLUS HETEROLEPSIS	PRAIRIE DROPSEED	138	1 GAL	POTTED	

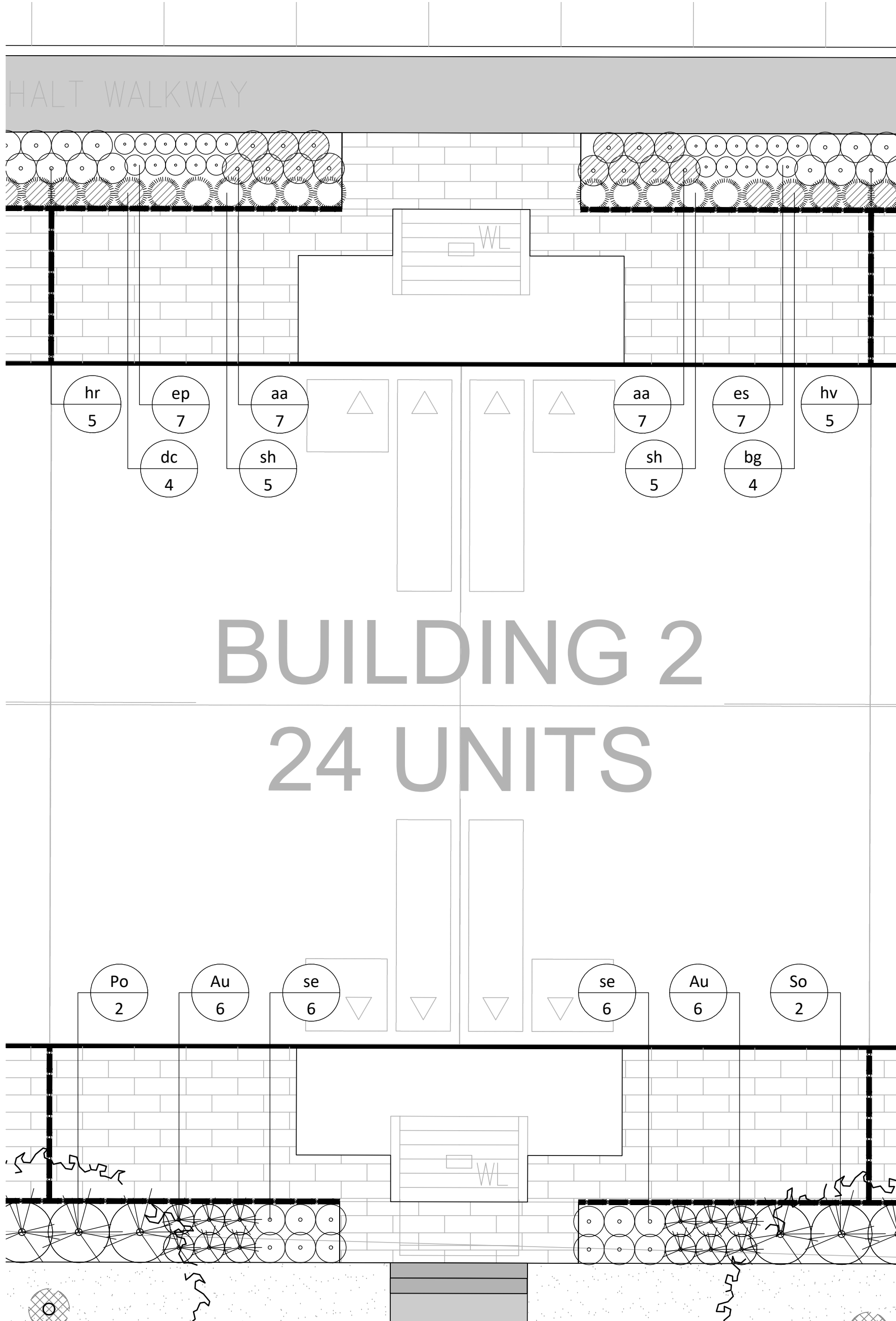

2 TYPICAL BLOCK PLANTING PLAN  
1:75

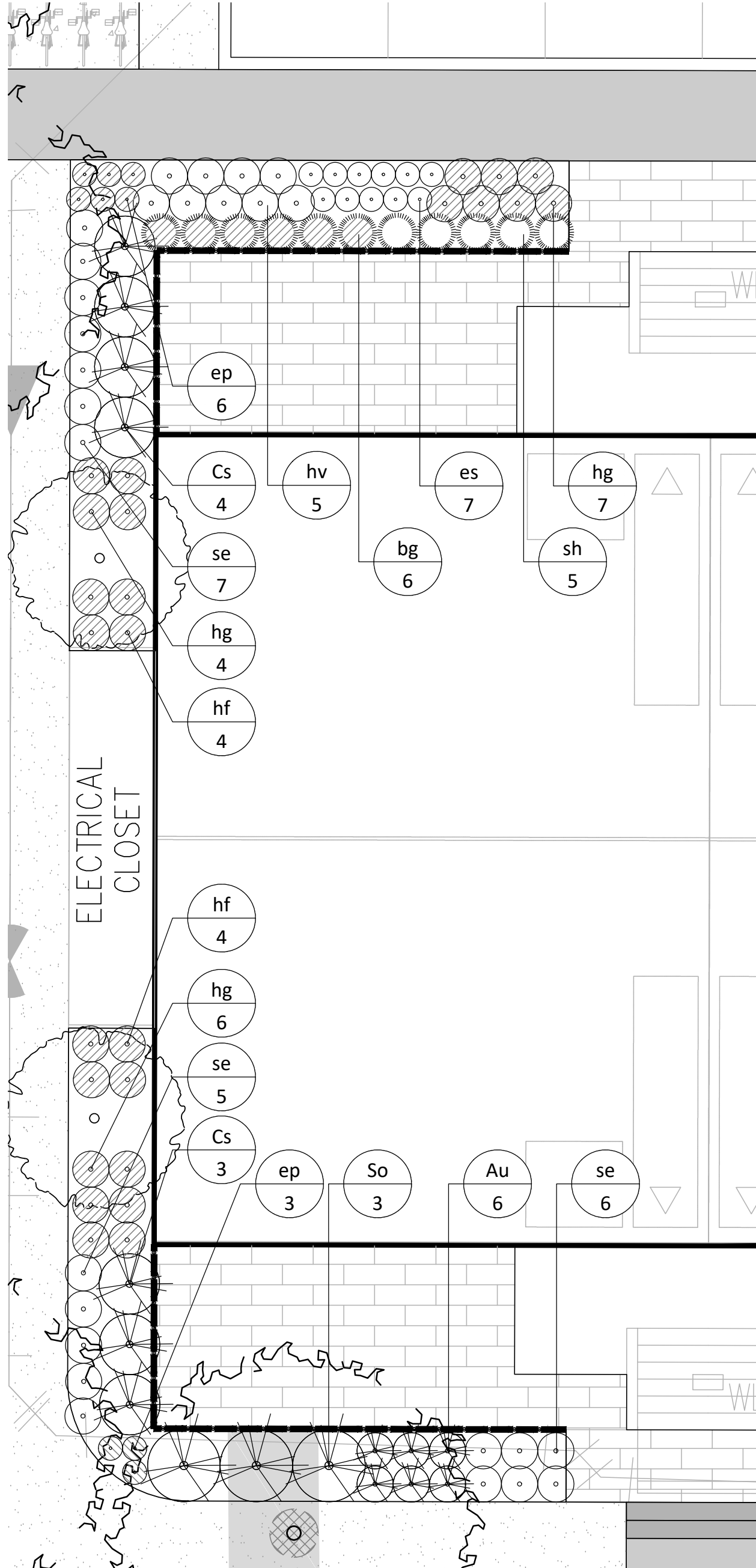

3 TYPICAL CORNER BLOCK PLANTING PLAN  
1:75

Contractor shall check all dimensions on the work and report any discrepancy to the Landscape Architect before proceeding. All drawings and specifications are the property of the Landscape Architect and must be returned at the completion of the work. This drawing is not to be used for construction until signed by the Landscape Architect.

- LEGEND**
- PROPERTY LINE
  - GEOTECHNICAL FOUNDATION SETBACK (4.5m)
  - 2.0m HT. WOOD PRIVACY FENCE
  - 1.8m HT. WOOD PRIVACY FENCE
  - 1.2m HT. DECORATIVE FENCE
- FENCING**

- PLANTING**
- MEDIUM DECIDUOUS TREE
  - CONIFEROUS TREE
  - TREE CANOPY PROJECTION AT MATURITY
  - TREE FORM SHRUB
  - DECIDUOUS/CONIFEROUS SHRUB
  - GRASSES/PERENNIALS
  - SODDING
- PAVING**
- LIGHT DUTY ASPHALT WALKWAYS
  - LIGHT DUTY CONCRETE PAVING
  - HEAVY DUTY CONCRETE PAVING
  - PRECAST UNIT PAVERS
  - RIVERSTONE PAVING
  - PRECAST EDGER
- SITE FURNISHINGS**
- BENCH
  - BIKE RACK
  - LANDSCAPE BOULDERS
  - FLAGSTONE STEPPING STONES

- PLANTING KEY**
- xx -- SHRUB/PERENNIAL SPECIES
  - oo -- QUANTITY
- DETAIL KEY**
- 1 -- DETAIL NO.
  - 11 -- SHEET NO.

-		
-		
-		
-		
-		
1	Issued for Client Review	Jun.09/25
No.	Description	Date

Revision	
City Approval Stamp	
OWNERSHIP	MINUTO COMMUNITIES INC. 200-180 Kent St., Ottawa, ON
ARCHITECT	SHR ARCHITECTS 8395 Jane St., Vaughan, ON
PLANNING	ARCADIS 333 Preston St. Suite 500, Ottawa, ON
CIVIL/SERVICING	OSL 120 Iber Rd. Suite 103, Ottawa, ON
TRAFFIC/NOISE	NOVATICH 240 Michael Cowpland Dr. Suite 101, Ottawa, ON
LANDSCAPE ARCHITECT	NAK DESIGN STRATEGIES 1285 Wellington St., Ottawa, ON

**PROPERTY INFORMATION**  
Part of Lot 28, Concession 11, Geographic Township of Goulbourn, City of Ottawa, Part of PIN 04560-7879

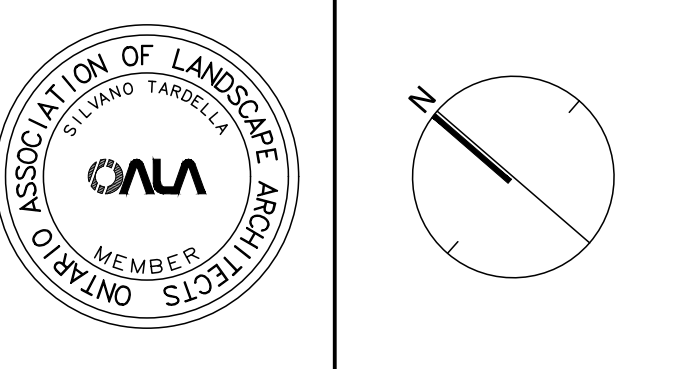

**NAK**  
design strategies  
1285 WELLINGTON STREET, OTTAWA, ON K1Y 3A8 CANADA  
T 613.237.2345  
Project

**PHASE 2**  
**ABBOTT'S RUN BLOCK 13**  
5618 HAZELDEAN RD, OTTAWA, ON

Title  
LANDSCAPE ENLARGEMENTS

Date	2025-04-21	Sheet
Scale	1:75	
Drawn	SW	
Checked	PG	
Job No.	25-083	

L1.2



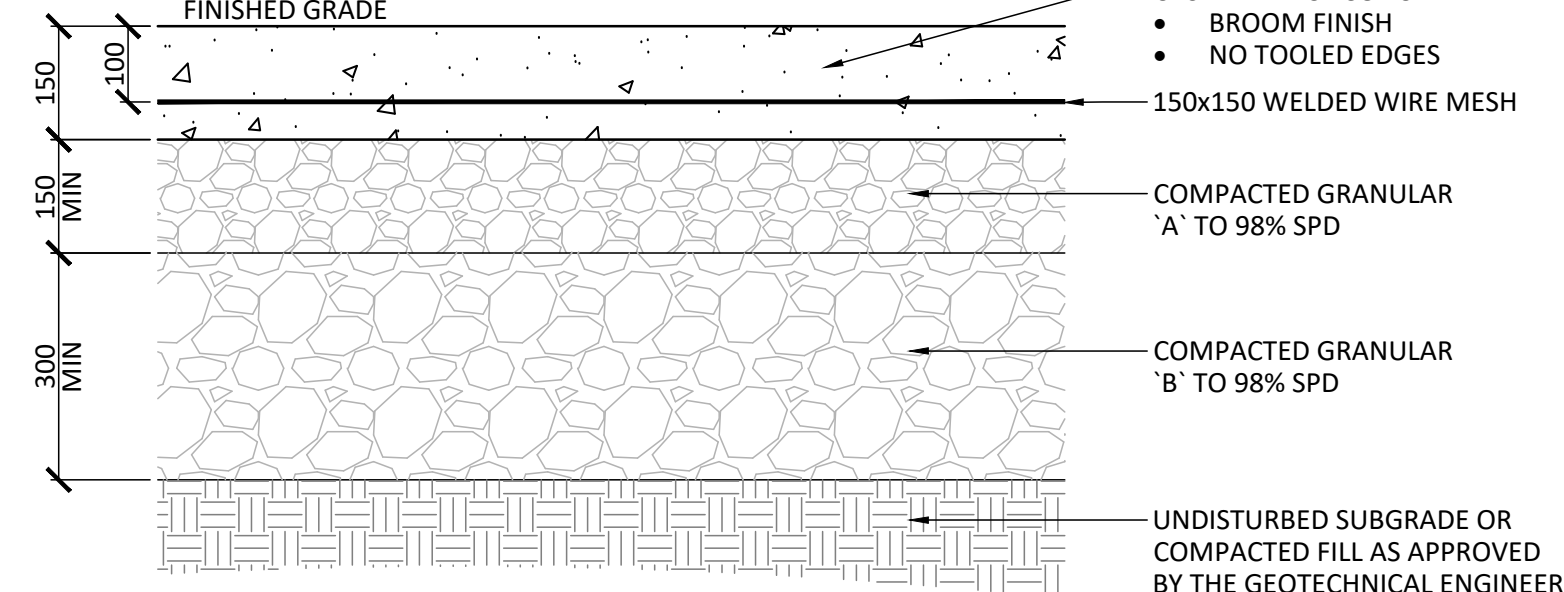
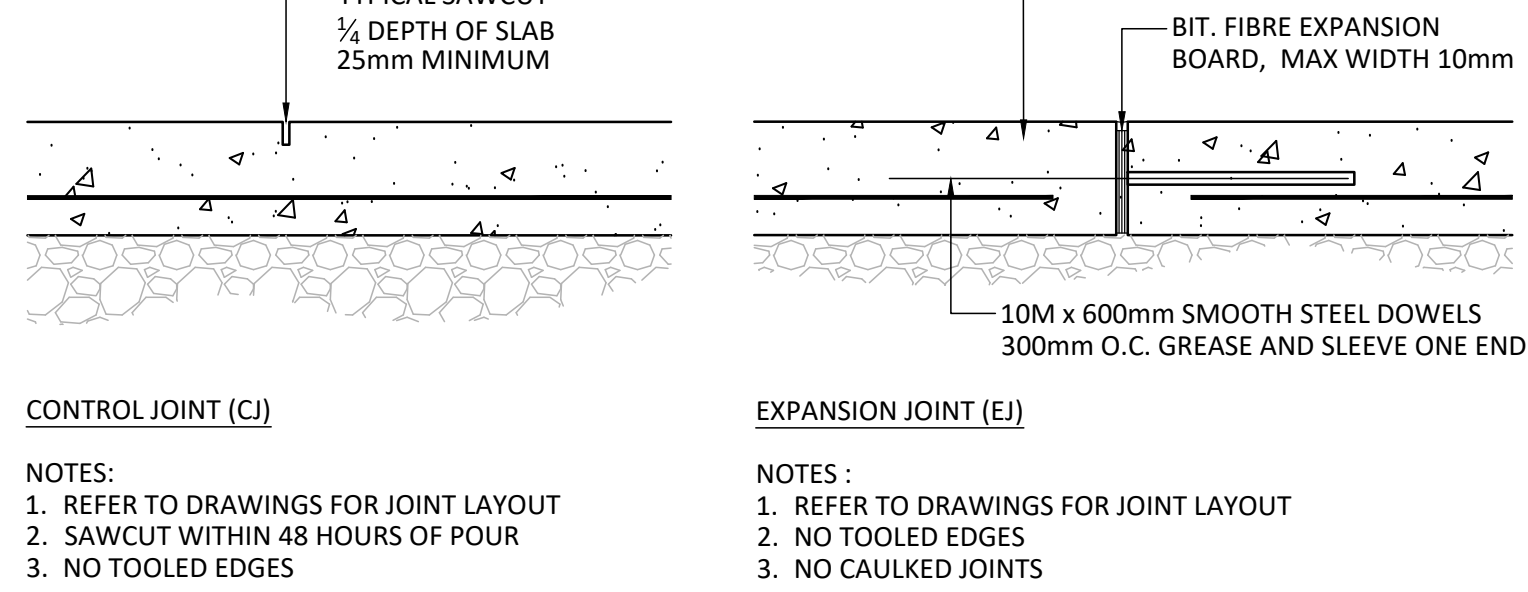
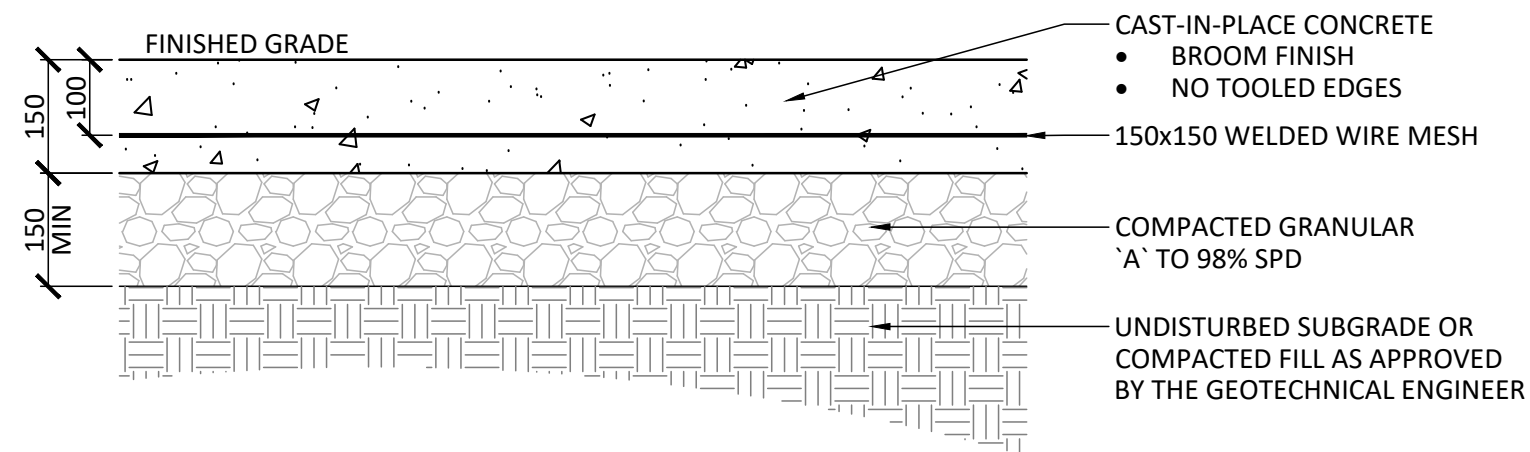

1 LIGHT DUTY CONCRETE PAVING  
1:10

2 CONCRETE JOINTING  
1:10

3 HEAVY DUTY CONCRETE PAVING  
1:10

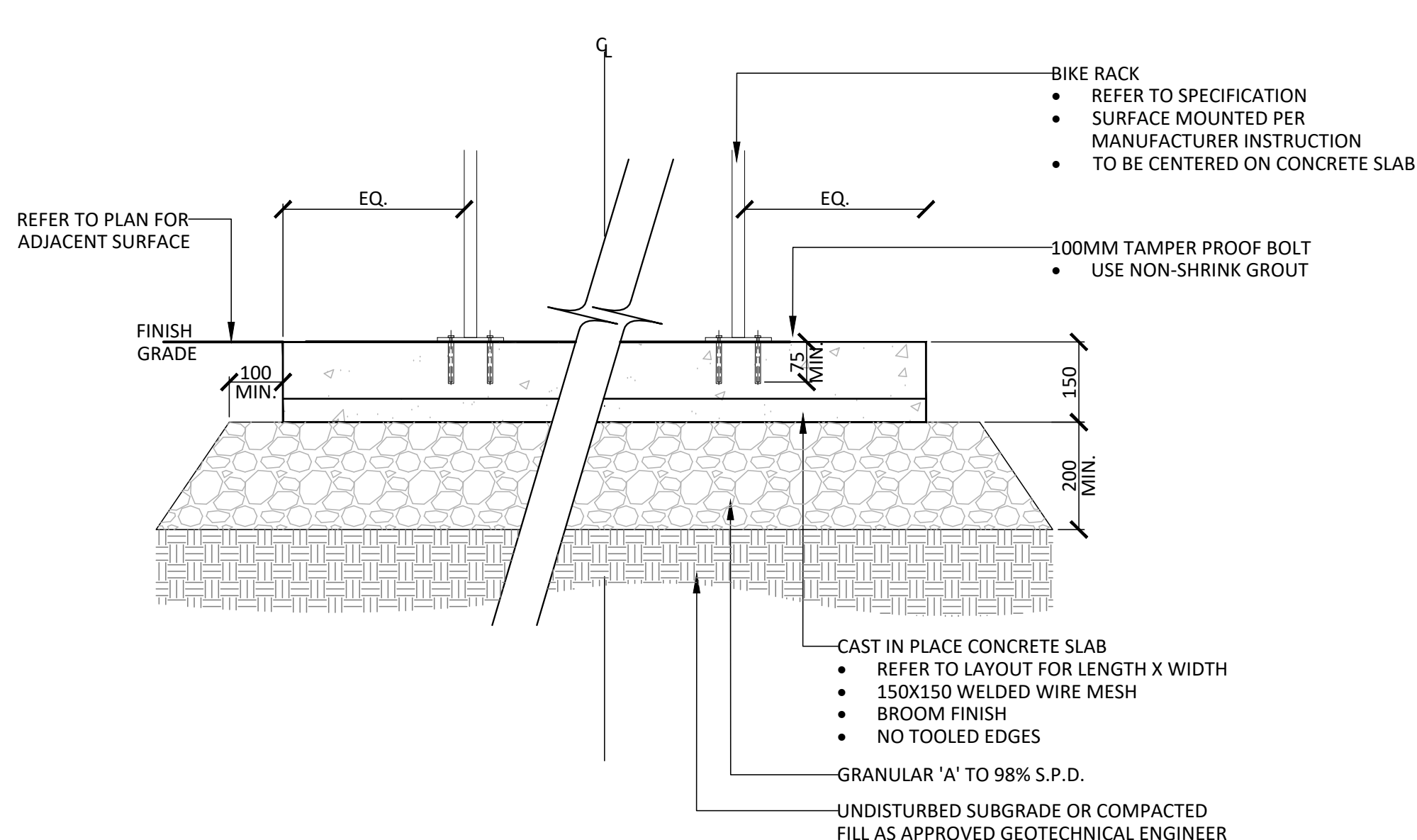
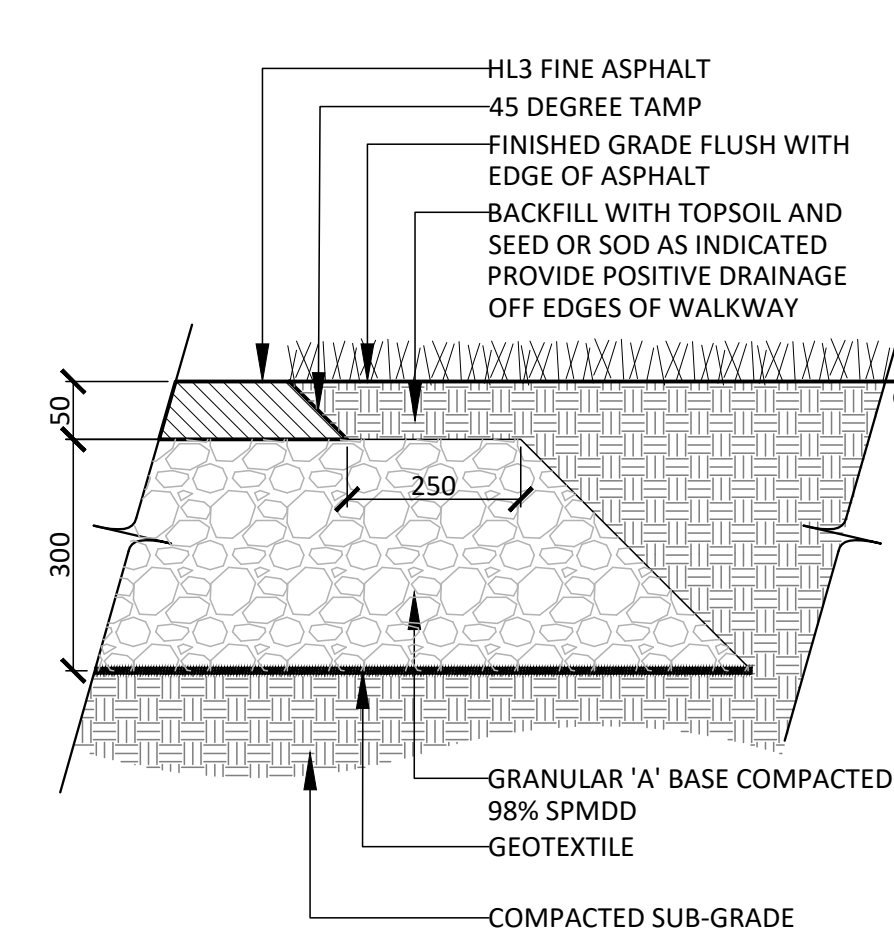
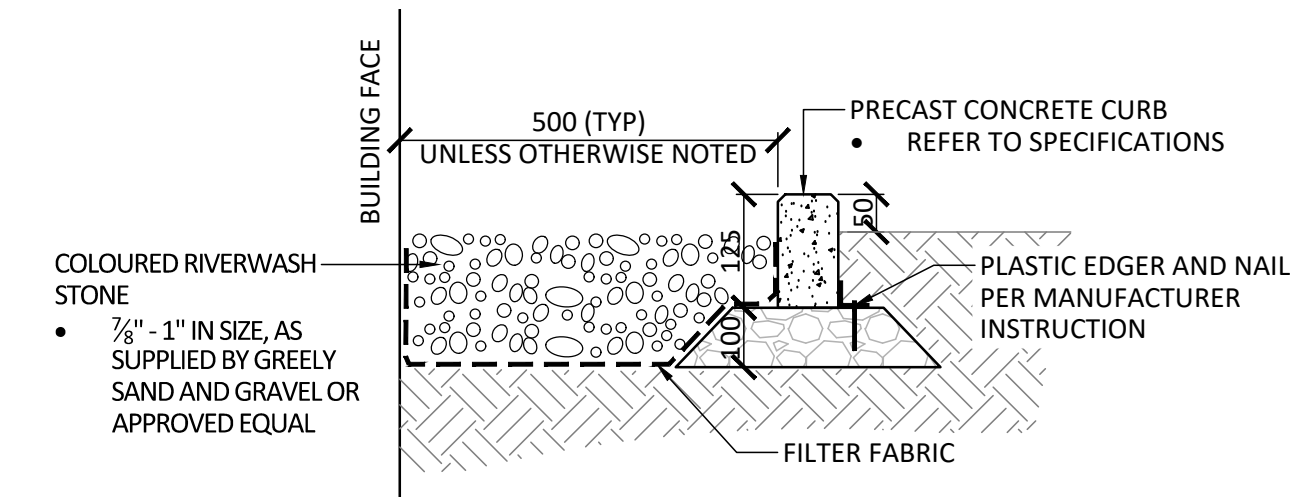

4 MAINTENANCE EDGE  
1:10

5 LIGHT DUTY UNIT PAVING  
1:10

6 LIGHT DUTY ASPHALT PAVING  
1:10

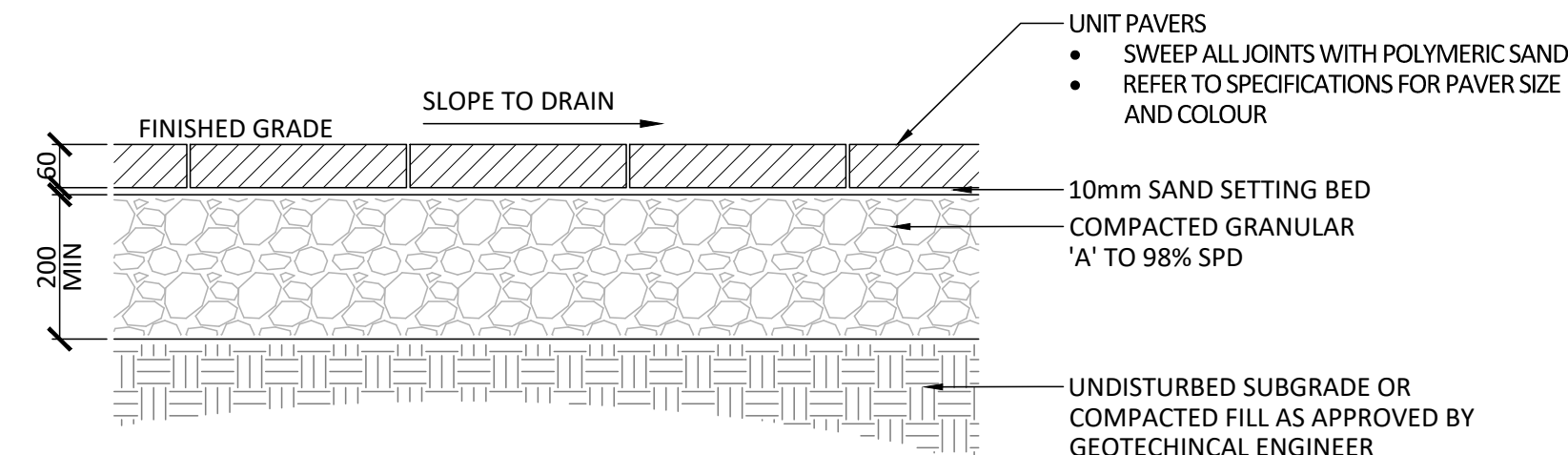

- NOTES:
- CROSS SLOPE PATH 1-2% IN DIRECTION OF NATURAL DRAINAGE TO PROVIDE POSITIVE DRAINAGE OF ALL WALKS.
  - FILTER FABRIC SHALL BE APPROVED. NON-WOVEN CLASS 1 GEOTEXTILE AS PER MS-22.15 WHEN WARRANTED BY SOIL CONDITION, SUBJECT TO APPROVAL BY THE LANDSCAPE ARCHITECT.
  - ALL DISTURBED AREAS ALONG ASPHALT WALKWAYS SHALL BE SODDED OVER 150mm TOPSOIL FOR A MINIMUM DISTANCE OF 900mm.
  - GRANULAR 'A' SHALL MEET THE REQUIREMENTS OF OPSS 1010.

5 LIGHT DUTY UNIT PAVING  
1:10

6 LIGHT DUTY ASPHALT PAVING  
1:10

7 BICYCLE PARKING  
1:10

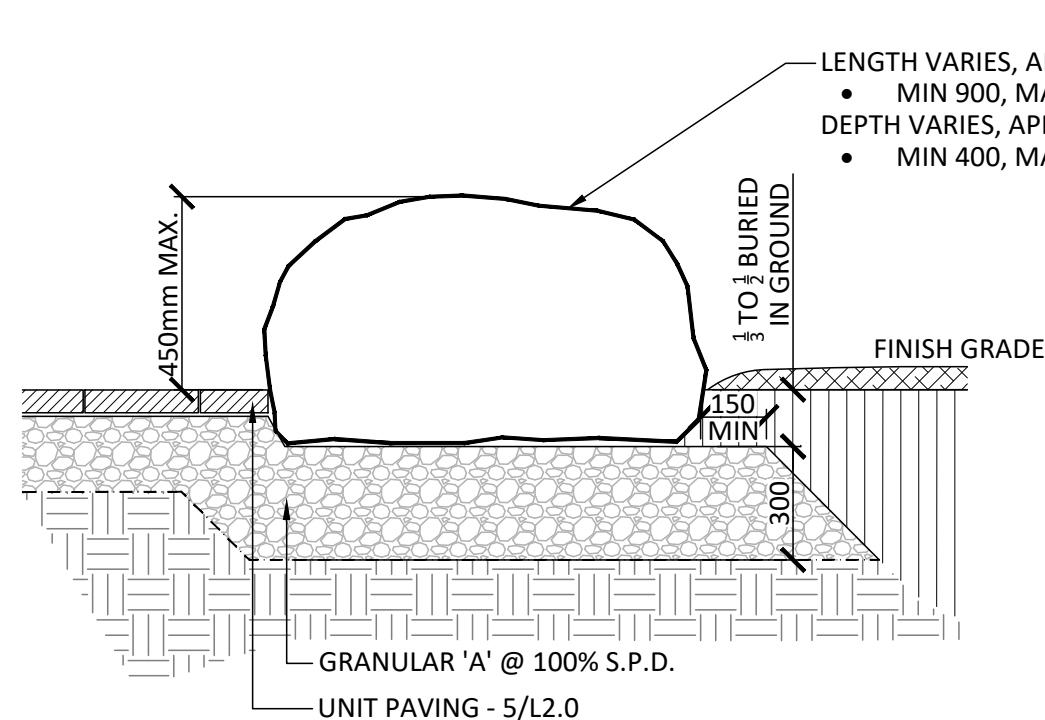
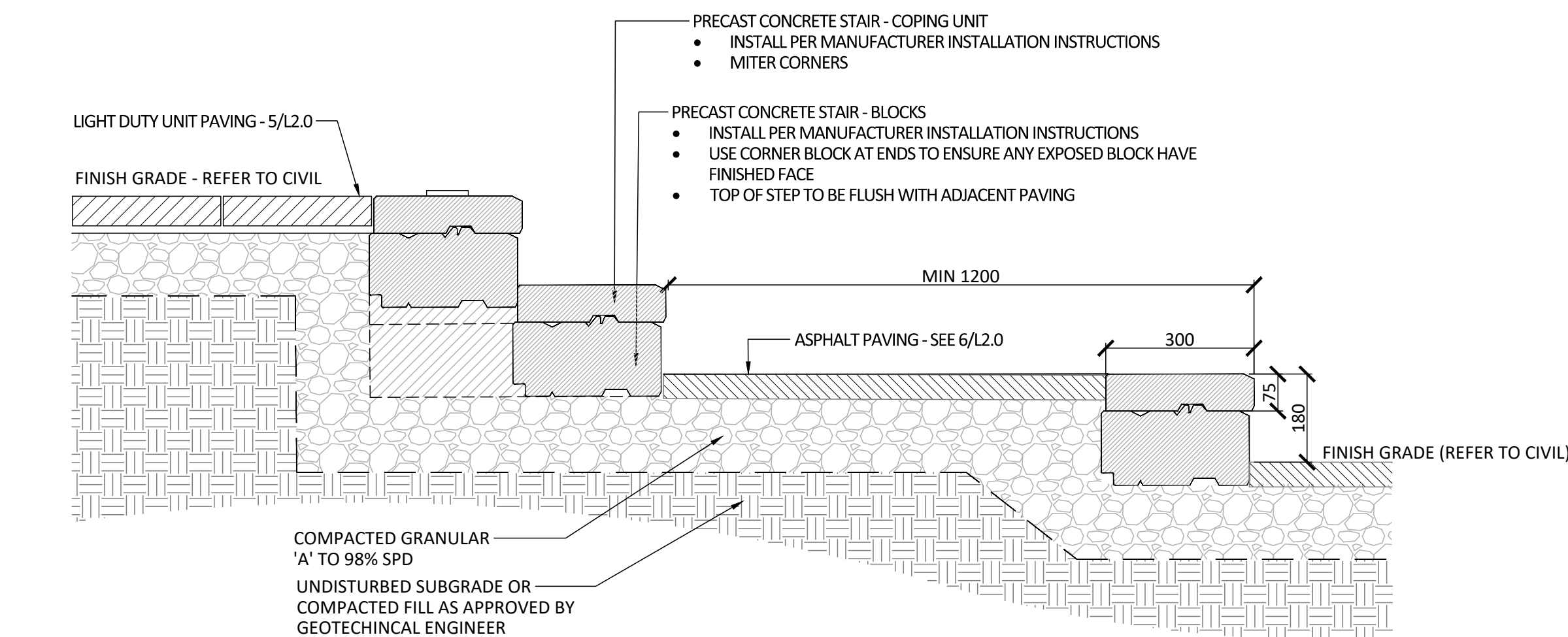

- NOTES:
- NO SHARP EDGES, CRACKS OR SPALLING.
  - NO FROST SUSCEPTIBLE BOULDER.
  - CONTRACTOR TO CONFIRM SOURCE/ QUARRY WITH LANDSCAPE ARCHITECT. GRANITE BOULDER FROM LOCAL SOURCE IS PREFERRED.
  - PLACEMENT AND SIZING OF BOULDER TO BE DETERMINED ON SITE AND APPROVED BY LANDSCAPE ARCHITECT.

8 LANDSCAPE STEP(S)  
1:10

9 LANDSCAPE BOULDER  
1:20

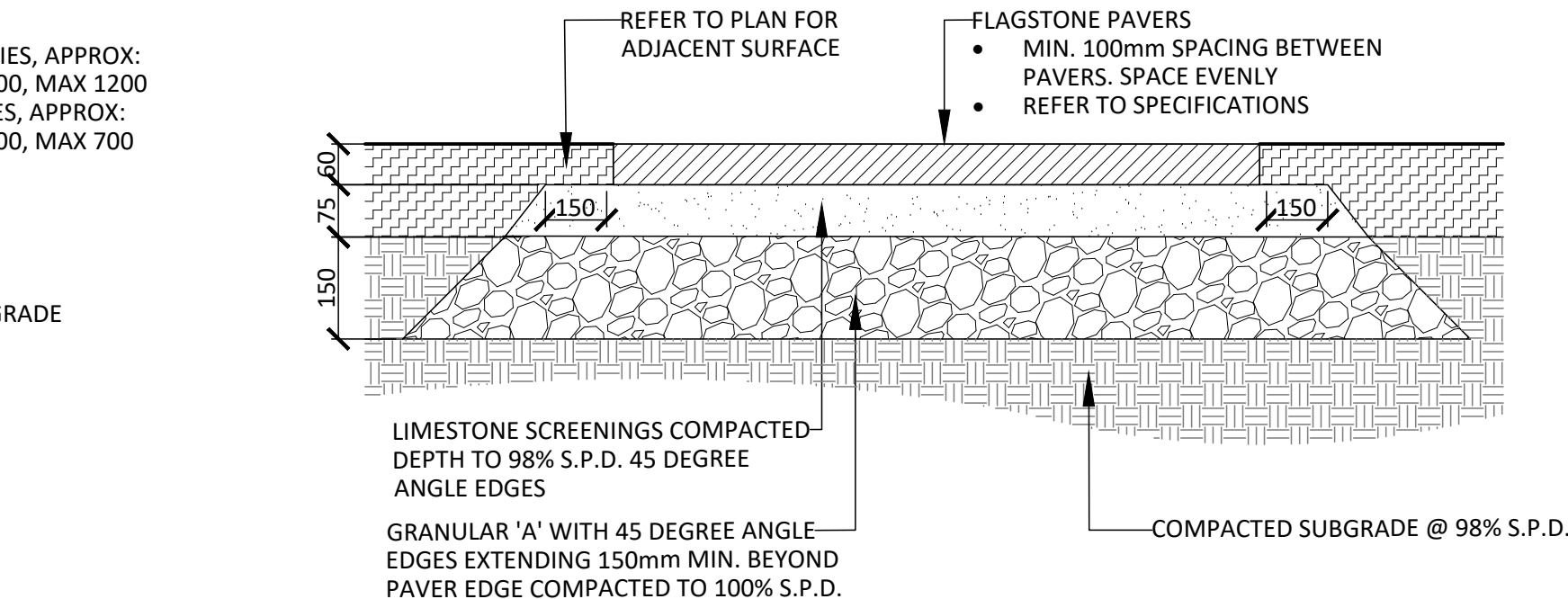

10 STEPPING STONES  
1:20

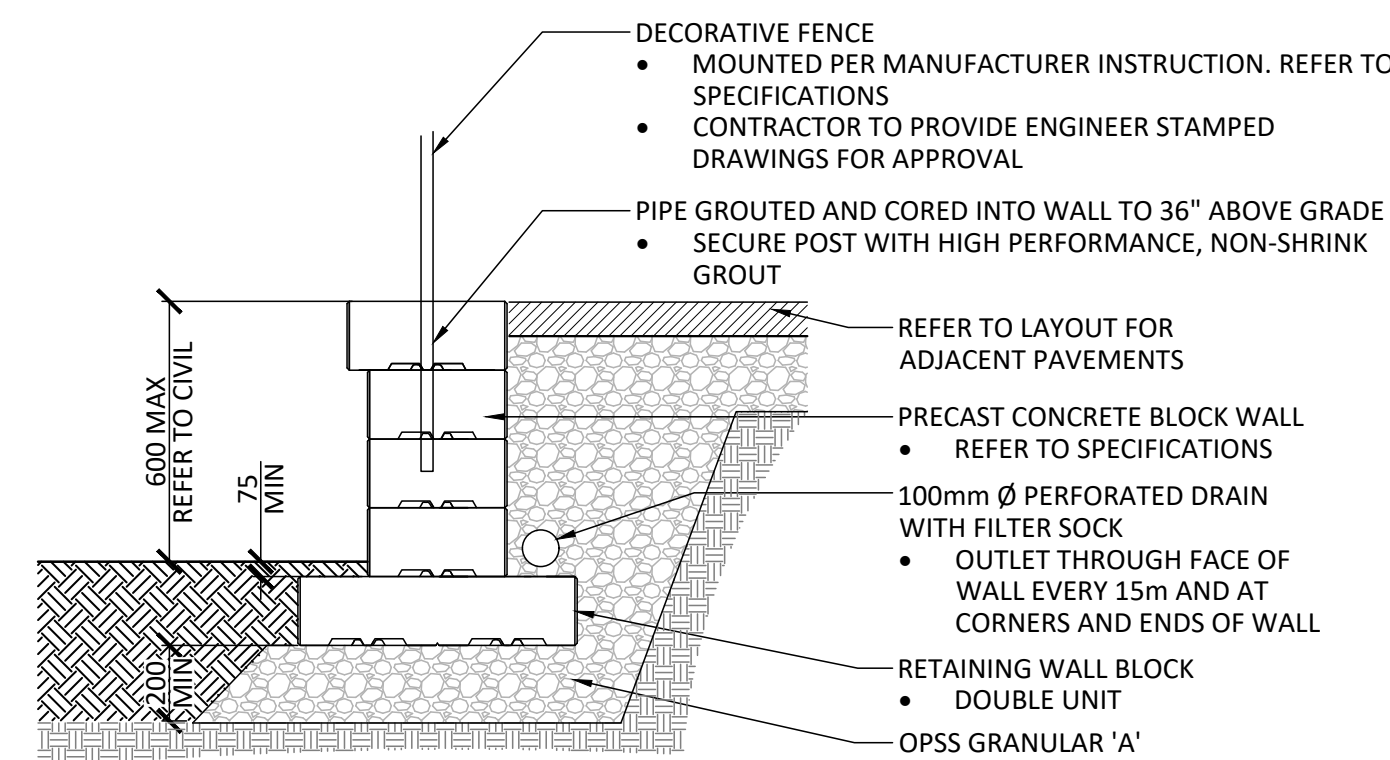

- NOTES:
- CONTRACTOR TO PROVIDE ENGINEER STAMPED SHOP DRAWINGS FOR APPROVAL PRIOR TO INSTALLATION

11 PRECAST RETAINING WALL  
1:20

Contractor shall check all dimensions on the work and report any discrepancy to the Landscape Architect before proceeding. All drawings and specifications are the property of the Landscape Architect and must be returned at the completion of the work. This drawing is not to be used for construction until signed by the Landscape Architect.

-		
-		
-		
-		
3	Issued for First Submission	Jun.25/25
2	Issued for Client Review	Jun.02/25
1	Issued for Client Review	Apr.21/25
No.	Description	Date

City Approval Stamp	OWNERSHIP MINTO COMMUNITIES INC. 200-180 Kent St., Ottawa, ON
	ARCHITECT SRN ARCHITECTS 8395 Jane St., Vaughan, ON
	PLANNING ARCADIS 333 Preston St. Suite 500, Ottawa, ON
	CIVIL/SERVICING ISEL 120 Iber Rd. Suite 103, Ottawa, ON
	TRAFFIC/NOISE NOVATICH 240 Michael Cowpland Dr. Suite 101, Ottawa, ON
	LANDSCAPE ARCHITECT NAK DESIGN STRATEGIES 1285 Wellington St., Ottawa, ON

PROPERTY INFORMATION  
Part of Lot 28, Concession 11, Geographic Township of Goulbourn, City of Ottawa, Part of PIN 04560-7879



**NAK**  
design strategies

1285 WELLINGTON STREET, OTTAWA, ON K1Y 3A8 CANADA  
T 613.237.2345  
Project

PHASE 2  
ABBOTT'S RUN BLOCK 13  
5618 HAZELDEAN RD, OTTAWA, ON

Title  
LANDSCAPE DETAILS

Date	2025-04-21	Sheet
Scale	1:300	
Drawn	SW	
Checked	PG	
Job No.	25-083	

L2.0



