



URBAN FORESTRY & FOREST MANAGEMENT CONSULTING

P.O. Box 13593, Ottawa, ON K2K 1X6
Telephone: (613) 850-2475
Website: www.ifsassociates.ca

December 9, 2024

Mr. Dani Farah, M.Eng.
Transformation Manager/Project Manager
Richcraft
2280 St. Laurent Blvd., Suite 201
Ottawa, ON
K1G 4K1

RE: TREE INFORMATION REPORT (SHORT) FOR 2760 SHEFFIELD ROAD, OTTAWA

This brief report details the assessment of a single distinctive tree located on City of Ottawa land in front of the above noted property in Ottawa. The need for this report is related to trees protected under the City of Ottawa's Tree Protection By-law (By-law No. 2020-340).

The attributes of the tree are noted in Table 1 on page 2 of this report. Picture 1 on page 5 shows the tree's current location and condition. Field work for this report was completed in December 2024.

The rationale for removal was provided by Mr. Arthur Gordon at Castleglenn Consultants Inc.: *"We can confidently state that the removal of the tree ... is indeed necessary and the roadway design has been minimized in terms of space requirements and impacts."* See proposed private access concept plan on page 3 of this report.

Nearby trees on city property will be suitably protected during construction (see City of Ottawa Tree Protection Barrier specification on page 4) and a replacement tree will be planted in the city's right of way.

I trust this report satisfies your requirements. Please do not hesitate to contact me with any questions or comments you may have.

This report is subject to the attached Limitations of Tree Assessments and Liability to which the reader's attention is directed.

Yours,



Andrew K. Boyd, B.Sc.F, R.P.F. (#1828)
Certified Arborist #ON-0496A
Consulting Urban Forester

TREE SPECIES, OWNERSHIP/LOCATION, SIZE, CONDITION AND RATIONALE FOR REMOVAL

Table 1 below details the species, ownership, size (diameter) and condition of the tree recommended for removal.

Table 1. Tree information for 2760 Sheffield Road

Tree No.	Tree species	Ownership & Location	DBH ¹ (cm)	Tree condition, age class, condition notes & species origin	Reason for removal	Forester's opinion re. removal
1	Norway maple (<i>Acer platanoides</i>)	City	32.2	Fair; maturing; central stem with competing lateral at 2m on south and suppressed lateral at 2m on east; introduced invasive species	Conflicts with proposed expanded entranceway and new stormwater lateral into subject property	Tree and stump be removed

¹ diameter at breast height, or 1.4m from grade (unless otherwise indicated)

SELF-DECLARATION STATEMENT (TO BE SIGNED BY PROPERTY OWNER OR THEIR REPRESENTATIVE):

Mr. Dani Farah: (613) 739-7111 ext. 174; dfarah@richcraft.com

By signing the application, you are acknowledging and understanding that a city forestry inspector or municipal law enforcement officer may enter the property at a reasonable time for the purpose of carrying out an inspection. You also acknowledge and understand that through failure to abide by the recommendations of the approved Tree Information Report, damaging or destructing trees identified for protection, you alone will be responsible to bear fully the cost of compensation, removal, and replacement.

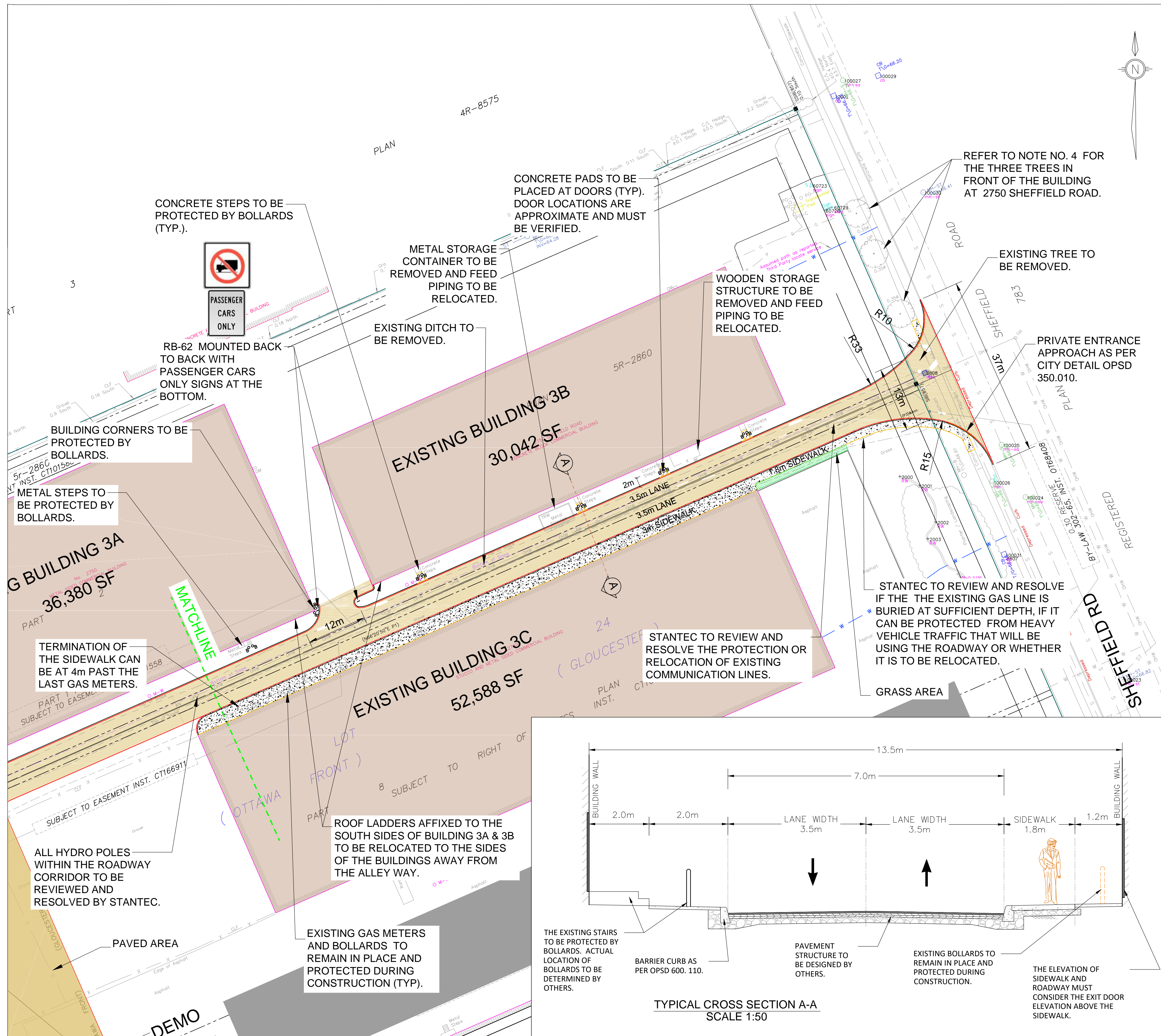

CITY OF OTTAWA
2760 SHEFFILED ROAD

PROPOSED PRIVATE ACCESS
CONCEPT PLAN

Contract No.
7337

Dwg. No.
01

Sheet 1 of 4

Asset Group
ISD

Des.
RM

Chk'd.
AEG

Dwn.
RM

Chk'd.
AEG

Utility Circ. No.
Index No.

Cost. Inspector

Scale:
8m 0 8m
HORIZ 1:400

PROJECT REF. NUMBER: 7344

NOTE: The location of utilities is approximate only, the exact location should be determined by consulting the municipal authorities and utility companies concerned. The contractor shall prove the location of utilities and shall be responsible for adequate protection from damage.

No.	Description	By	Date (dd/mm/yy)
1	AS PER CITY COMMENTS	xx	XX/XX/XX

- NOTES
- OBSTACLES SUCH AS TREES, HYDRO POLES, AND THE IMPACTS/PROVISIONS TO POTENTIAL GAS SERVICES AND OTHER EXISTING UTILITIES ARE TO BE CIRCULATED TO STANTEC FOR REVIEW AND RESOLUTION.
 - 8NO. ROOF DRAINAGE PIPES PROTRUDING FROM BUILDING 3C ON SOUTH SIDE OF ALLEY TO BE RE-ROUTED AWAY FROM ALLEY AND SIDEWALK.
 - THE SURFACE BETWEEN BUILDINGS NO. 3A AND 3B AND THE ROADWAY IN THE NORTH AND SURFACE BETWEEN BUILDING NO. 3C AND SIDEWALK IN THE SOUTH TO BE DETERMINED BY THE LANDSCAPING PLANNER.
 - THERE ARE THREE (3) TREES IN FRONT OF 2750 SHEFFIELD ROAD THAT WOULD REMAIN, HOWEVER, DURING THE SUMMER MONTHS, THE FOLIAGE ON THESE TREES COULD OBSCURE THE 150M LONG SIGHT LINE OF A HEAVY VEHICLE LEAVING THE ALLEY ACCESS LOOKING TO THE NORTH AND ATTEMPTING TO TURN ONTO SHEFFIELD ROAD. IF THIS IS THE CASE, THE REMAINING TREES SHOULD BE TRIMMED TO ASSURE NO OBSTRUCTION OF THE SIGHT LINE.

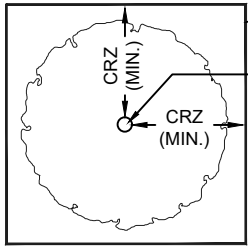

PLAN VIEW

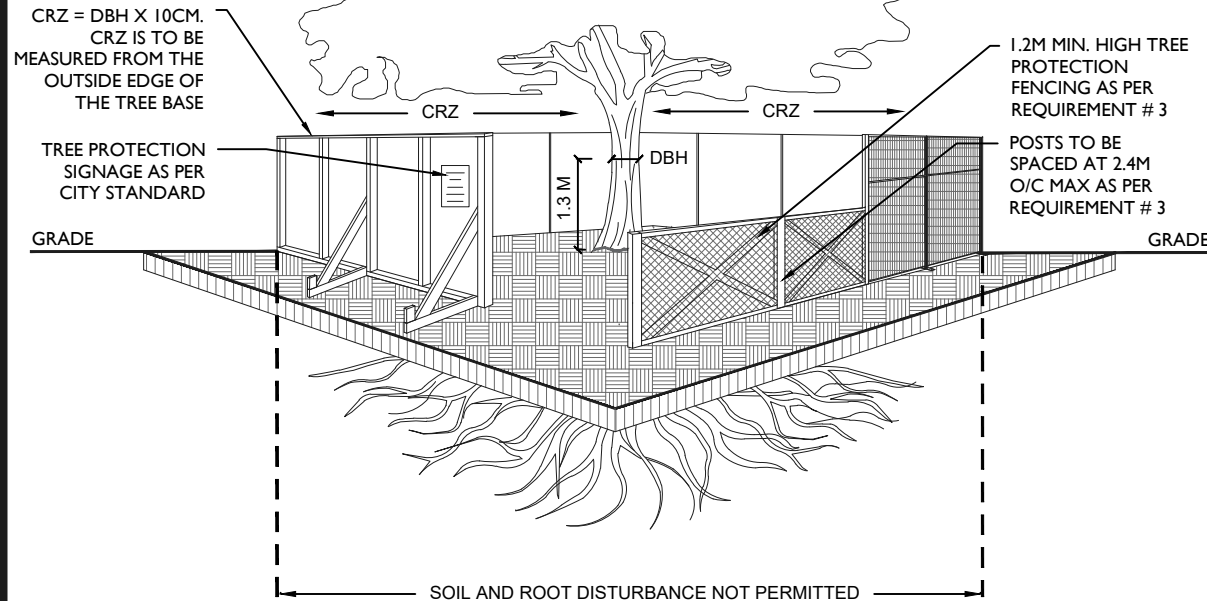

ACCESSIBLE FORMATS AND COMMUNICATION
SUPPORTS ARE AVAILABLE, UPON REQUEST

TREE PROTECTION REQUIREMENTS:

1. PRIOR TO ANY WORK ACTIVITY WITHIN THE CRITICAL ROOT ZONE (CRZ = 10 X DIAMETER) OF A TREE, TREE PROTECTION FENCING MUST BE INSTALLED SURROUNDING THE CRITICAL ROOT ZONE, AND REMAIN IN PLACE UNTIL THE WORK IS COMPLETE.
2. UNLESS PLANS ARE APPROVED BY CITY FORESTRY STAFF, FOR WORK WITHIN THE CRZ:
 - DO NOT PLACE ANY MATERIAL OR EQUIPMENT - INCLUDING OUTHOUSES;
 - DO NOT ATTACH ANY SIGNS, NOTICES OR POSTERS TO ANY TREE;
 - DO NOT RAISE OR LOWER THE EXISTING GRADE;
 - TUNNEL OR BORE WHEN DIGGING;
 - DO NOT DAMAGE THE ROOT SYSTEM, TRUNK, OR BRANCHES OR ANY TREE;
 - ENSURE THAT EXHAUST FUMES FROM ALL EQUIPMENT ARE NOT DIRECTED TOWARD ANY TREE CANOPY.
 - DO NOT EXTEND HARD SURFACE OR SIGNIFICANTLY CHANGE LANDSCAPING
3. TREE PROTECTION FENCING MUST BE AT LEAST 1.2M IN HEIGHT, AND CONSTRUCTED OF RIGID OR FRAMED MATERIALS (E.G. MODULOC - STEEL, PLYWOOD HOARDING, OR SNOW FENCE ON A 2"X4" WOOD FRAME) WITH POSTS 2.4M APART, SUCH THAT THE FENCE LOCATION CANNOT BE ALTERED. ALL SUPPORTS AND BRACING MUST BE PLACED OUTSIDE OF THE CRZ, AND INSTALLATION MUST MINIMISE DAMAGE TO EXISTING ROOTS. (SEE DETAIL)
4. THE LOCATION OF THE TREE PROTECTION FENCING MUST BE DETERMINED BY AN ARBORIST AND DETAILED ON ANY ASSOCIATED PLANS FOR THE SITE (E.G. TREE CONSERVATION REPORT, TREE INFORMATION REPORT, ETC). THE PLAN AND CONSTRUCTED FENCING MUST BE APPROVED BY CITY FORESTRY STAFF PRIOR TO THE COMMENCEMENT OF WORK.
5. IF THE FENCED TREE PROTECTION AREA MUST BE REDUCED TO FACILITATE CONSTRUCTION, MITIGATION MEASURES MUST BE PRESCRIBED BY AN ARBORIST AND APPROVED BY CITY FORESTRY STAFF. THESE MAY INCLUDE THE PLACEMENT OF PLYWOOD, WOOD CHIPS, OR STEEL PLATING OVER THE ROOTS FOR PROTECTION OR THE PROPER PRUNING AND CARE OF ROOTS WHERE ENCOUNTERED.

THE CITY'S TREE PROTECTION BY-LAW, 2020-340 PROTECTS BOTH CITY-OWNED TREES, CITY-WIDE, AND PRIVATELY-OWNED TREES WITHIN THE URBAN AREA. PLEASE REFER TO WWW.OTTAWA.CA/TREEBYLAW FOR MORE INFORMATION ON HOW THE TREE BY-LAW APPLIES.



TREE PROTECTION SPECIFICATION

TO BE IMPLEMENTED FOR RETAINED TREES, BOTH ON SITE AND ON ADJACENT SITES, PRIOR TO ANY TREE REMOVAL OR SITE WORKS AND MAINTAINED FOR THE DURATION OF WORK ACTIVITIES ON SITE.

SCALE: NTS

DATE: MARCH 2021

DRAWING NO.: 1 of 1



Picture 1. Norway maple on City of Ottawa land in front of 2760 Sheffield Road

LIMITATIONS OF TREE ASSESSMENTS & LIABILITY

GENERAL

It is the policy of Integrated Forestry Services Inc. (IFS Inc.) to attach the following clause regarding limitations. We do this to ensure that our clients are clearly aware of what is technically and professionally realistic in assessing trees.

This report was prepared by IFS Inc. at the request of the client. The information, interpretation and analysis expressed in this report are for the sole benefit and exclusive use of the client. Possession of this report or a copy thereof does not imply right of publication or use for any purpose by any other than the client to whom it is addressed. Unless otherwise required by law, neither all or any part of the contents of this report, nor copy thereof, shall be conveyed by anyone, including the client, to the public through public relations, news or other media, without the prior expressly written consent of the author, and especially as to value conclusions, identity of the author, or any reference to any professional society or institute or to any initialed designation conferred upon the author as stated in his qualifications.

This report and any values expressed herein represent the opinion of the author; his fee is in no way contingent upon the reporting of a specified value, a stipulated result, nor upon any finding to be reported.

The assessment presented in this report is valid at the time of the inspection only. The loss or alteration of any part of this report invalidates the entire report.

LIMITATIONS

The information contained in this report covers only the tree(s) in question and no others. It reflects the condition of the assessed tree(s) at the time of inspection and was limited to a visual examination of the accessible portions only. Integrated Forestry Services Inc. has prepared this report in a manner consistent with that level of care and skill ordinarily exercised by members of the forestry and arboricultural professions, subject to the time limits and physical constraints applicable to this report. The assessment of the tree(s) presented in this report has been made using accepted arboricultural techniques. These include a visual examination of the above-ground portions of each tree for structural defects, scars, cracks, cavities, external indications of decay such as fungal fruiting bodies, evidence of insect infestations, discoloured foliage, the condition of any visible root structures, the degree and direction of lean (if any), the general condition of the tree(s) and the surrounding site, and the proximity of people and property. Except where specifically noted in the report, the tree(s) examined were not dissected, cored, probed or climbed to gain further evidence of their structural condition. Also, unless otherwise noted, no detailed root collar examinations involving excavation were undertaken.

ASSUMPTIONS

Statements made to IFS Inc. regarding the condition, history and location of the tree(s) are assumed to be correct and true. Unless indicated otherwise, all trees under investigation in this report are assumed to be fully on the client's property.

LIABILITY

Without limiting the foregoing, no liability is assumed by IFS Inc. for:

- 1) any legal description provided with respect to the property.
- 2) issues of title and/or ownership with respect to the property.
- 3) the accuracy of the property line locations or boundaries with respect to the property.
- 4) the accuracy of any other information provided by the client or third parties.
- 5) any consequential loss, injury or damages suffered by the client or any third parties, including but not limited to replacement costs, loss of use, earnings and business interruption; and,
- 6) the unauthorized distribution of the report.

Further, under no circumstances may any claims be initiated or commenced by the client against *IFS Associates Inc.* or any of its directors, officers, employees, contractors, agents or assessors, in contract or in tort, more than 12 months after the date of this report.

ONGOING SERVICES

Integrated Forestry Services Inc. accepts no responsibility for the implementation of any or all parts of the report, unless specifically requested to supervise the implementation or examine the results of activities recommended herein. If further examination or supervision is requested, that request shall be made in writing and the details, including fees, agreed to in advance.