

LEGAL DESCRIPTION:  
**BLOCK 220**  
**REGISTERED PLAN 4M-1641**  
CITY OF OTTAWA

ALL LEGAL SURVEY INFORMATION  
OBTAINED FROM SURVEY PLANS  
PREPARED BY : STANTEC  
GEOMATICS LTD., DATED , 8th OF  
MARCH 2025

PROPOSED PLANT LIST						QTY SF
KEY	QTY	BOTANICAL NAME	COMMON NAME	SIZE	CONDITION	COMMENTS
TREES						
• FM	13	Acer x freemanii 'Jeffersred'	Autumn Blaze Maple	50mm cal.	B&B	Large tree-native
• GB	11	Ginkgo biloba	Ginkgo	50mm cal.	B&B	Large tree-not native
• HB	11	Celtis occidentalis	Hackberry	50mm cal.	B&B	Large tree-native
• HL	15	Gleditsia triacanthos var. inermis 'Shademaster'	Shademaster Honeylocust	50mm cal.	B&B	Med tree-native to S. Ont
• JTL	6	Syringa reticulata 'Ivory Silk'	Ivory Silk Tree Lilac	50mm cal.	B&B	Small tree-not native
• RM	4	Acer rubrum	Red Maple	50mm cal.	B&B	Large tree-native
• RO	18	Quercus rubra	Red Oak	50mm cal.	B&B	Large tree-native
• SM	15	Acer saccharum	Sugar Maple	50mm cal.	B&B	Large tree-native
• WP	5	Pinus strobus	White Pine	1800 mm ht.	B&B	Large coniferous-native
• WS	10	Picea glauca	White Spruce	1800 mm ht.	B&B	Large coniferous-native
• WB	9	Abies balsamea	Balsam Fir	1800 mm ht.	B&B	Large coniferous-native
• WC	5	Tsuga canadensis	Canadian Hemlock	1800 mm ht.	B&B	Large coniferous-native
SHRUBS						
• BH	36	Juniperus chinensis 'Hetz Blue'	Hetz Blue Juniper	800mm spr.	Potted	1500mm o.c.
• BD	38	Juniperus sabina 'Blue Danube'	Blue Danube Juniper	800mm spr.	Potted	1000mm o.c.
• CU	31	Rhus typhina 'Laciniata'	Cutleaf Staghorn Sumac	800mm ht.	Potted	1200mm o.c.
• FS	67	Sorbaria sorbifolia	Ural False Spirea	800mm ht.	Potted	1500mm o.c.
• FR	45	Rhus aromatica	Fragrant Sumac	800mm ht.	Potted	800mm o.c.
• GS	87	Spiraea x arguta	Garland Spirea	800mm ht.	Potted	1000mm o.c.
• SE	98	Sorbaria sorbifolia 'Sem'	Sem False Spirea	800mm ht.	Potted	800mm o.c.
• ST	82	Rhus typhina	Staghorn Sumac	800mm ht.	Potted	1200mm o.c.
PERENNIALS/ GRASSES						
• BL	66	Leymus arenarius	Blue Lyme Grass	250mm pot	Potted	1000mm o.c.
• KF	245	Calamagrostis 'Karl Foerster'	Karl Foerster Grass	250mm pot	Potted	800mm o.c.
* INDICATES PRIVATELY OWNED VEGETATION						

LEGEND

- 40 YEAR CANOPY PROJECTION  
PROPOSED DECIDUOUS TREE  
REQUIRED SOIL VOLUME AT A 1.5m DEPTH
  - 40 YEAR CANOPY PROJECTION  
PROPOSED CONIFEROUS TREE  
REQUIRED SOIL VOLUME AT A 1.5m DEPTH
  - PROPOSED SHRUBS AND PERENNIALS
  - PROPOSED GRASS
  - COMPACTED STONE DUST FOR RUNNING TRACK
  - ELECTRIC CHARGING PARKING STALL
  - BARRIER FREE PARKING
  - PROPOSED GARDEN BED
  - PROPOSED PRECAST CONCRETE PAVERS
  - PROPOSED ARTIFICIAL GRASS AT DAYCARE YARDS
  - PROPOSED BENCH
- GENERAL NOTES
- IT IS THE RESPONSIBILITY OF THE APPROPRIATE CONTRACTOR OR OFFICIAL TO REPORT ANY ERRORS, OMISSIONS OR DISCREPANCIES ON THIS PLAN WITH ACTUAL SITE CONDITIONS TO THE LANDSCAPE ARCHITECT BEFORE PROCEEDING WITH CONSTRUCTION.
  - THE CONTRACTOR IS TO NOTIFY ALL UTILITY COMPANIES AND AUTHORITIES PRIOR TO ANY EXCAVATION AND ASCERTAIN LOCATIONS OF UNDERGROUND SERVICES.
  - THE CONTRACTOR IS TO REINSTATE ALL AREAS AND ITEMS DAMAGED AS A RESULT OF CONSTRUCTION ACTIVITY.
  - THE CONTRACTOR IS TO COMPLY WITH ALL PERTINENT CODES AND BY-LAWS.
  - THE CONTRACTOR IS TO MAINTAIN A POSITIVE SURFACE RUN-OFF THROUGHOUT THE ENTIRE CONSTRUCTION PERIOD.
  - THE LANDSCAPE ARCHITECT IS NOT RESPONSIBLE FOR SURFACE CONDITIONS.
  - THE CONTRACTOR IS TO IDENTIFY ALL EXISTING TREES TO REMAIN ON SITE WITH THE LANDSCAPE ARCHITECT PRIOR TO CONSTRUCTION.
  - THE CONTRACTOR IS TO STAKE THE PROPOSED LOCATION OF ALL PLANT MATERIAL IN CONJUNCTION WITH THE LANDSCAPE ARCHITECT PRIOR TO EXCAVATION.
  - MINIMUM DISTANCES FOR SELECTED DECIDUOUS TREES ARE AS FOLLOWS:
    - 9.1. BUILDING FOUNDATIONS - 7.5M
    - 9.2. SIDEWALKS - 1.5M
    - 9.3. PUBLIC STREETS - 2.5M
    - 9.4. UNDERGROUND INFRASTRUCTURE - 2.0M
  - ALL TREES WITHIN 1M OF UNDERGROUND UTILITY TRENCHES ARE TO BE EXCAVATED BY HAND.
  - REMOVING ALL PROTECTIVE WRAPPING FROM TREE TRUNKS AFTER INSTALLATION.
  - STAKING OF TREES SHALL ONLY BE PERFORMED IF NECESSARY.
  - ENSURE THAT MULCH IS PULLED BACK A MINIMUM DISTANCE OF 750MM FROM BASE OF TREE TRUNK.

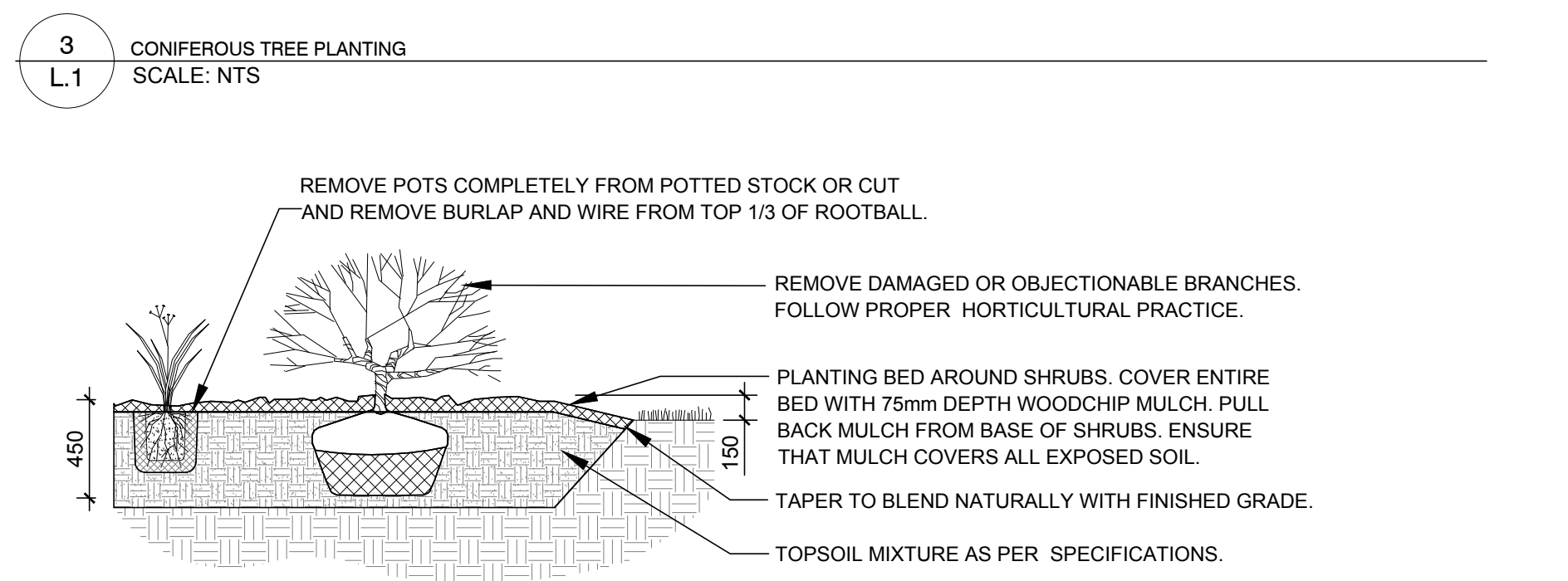
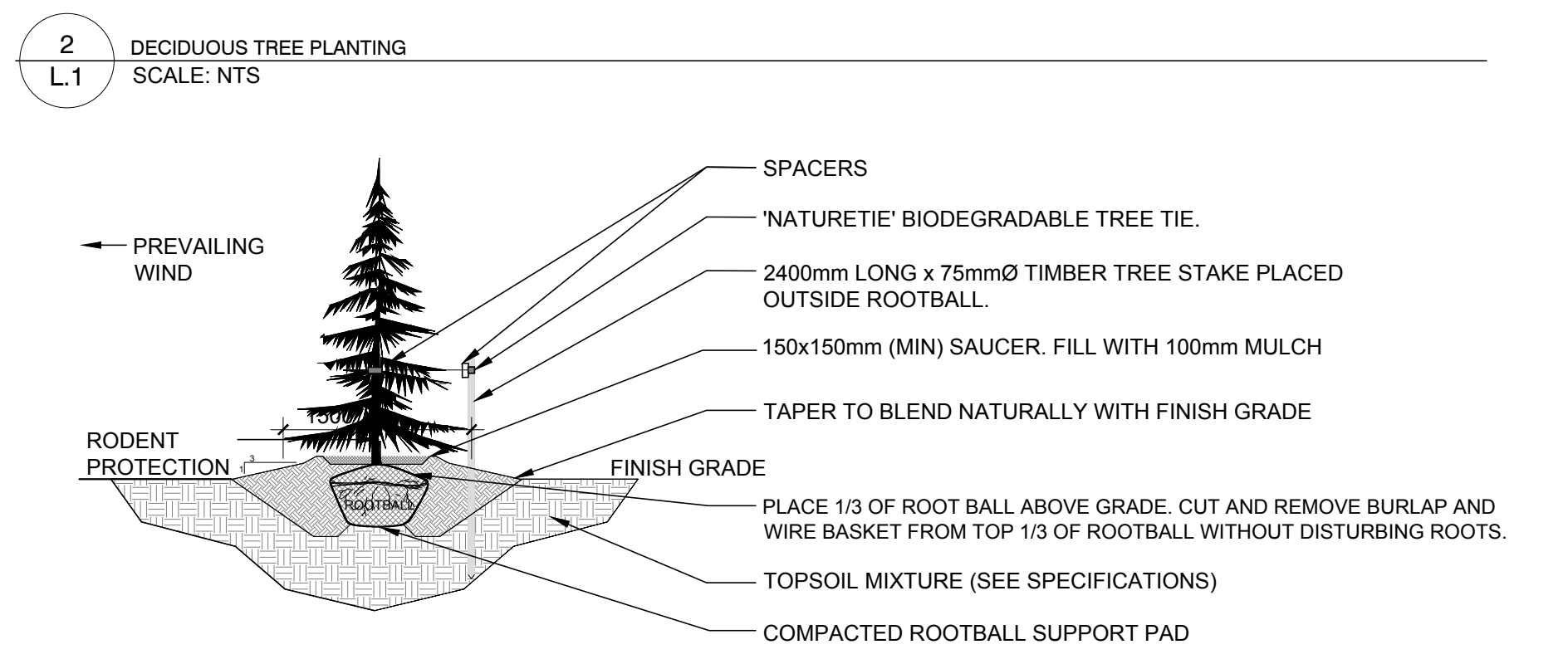
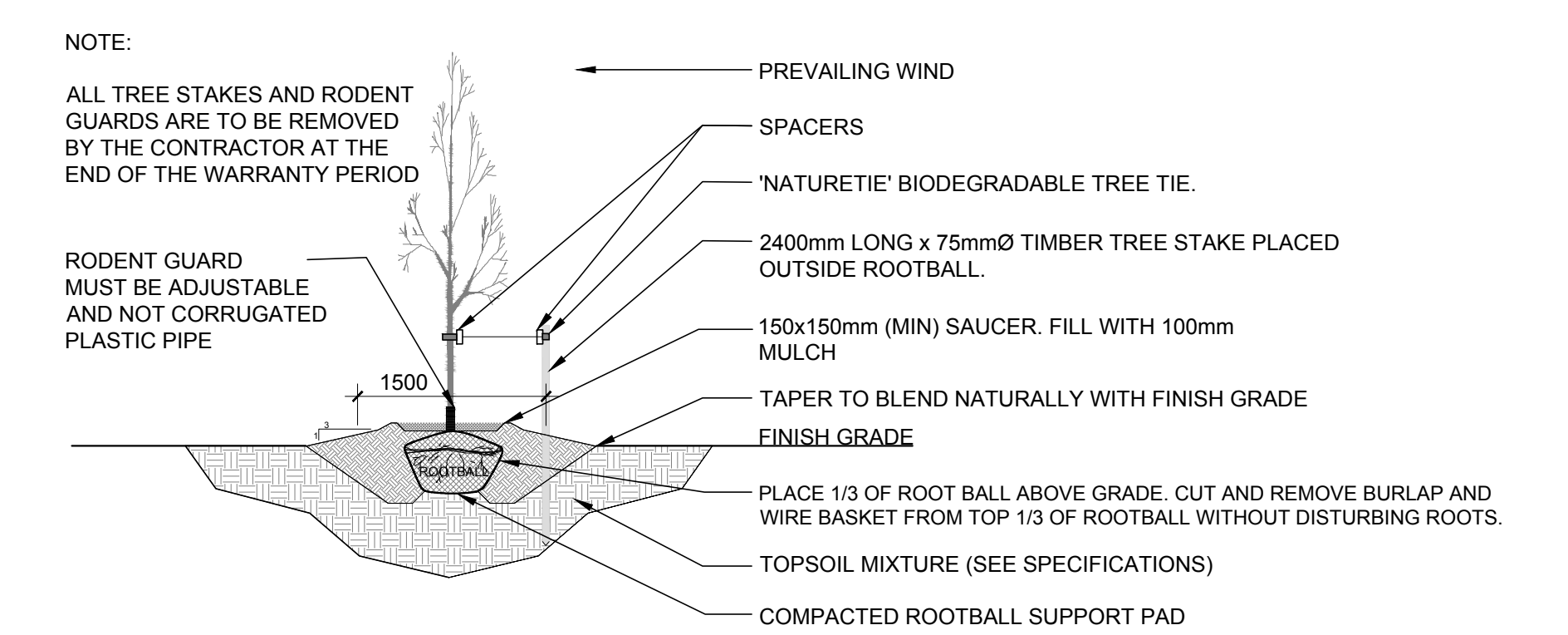

1 LANDSCAPE PLAN  
L.1 SCALE 1:500



**40 YEAR CANOPY CALCULATION:**

-60,072m2 site area

-81 Large deciduous trees proposed (154m2 ea.),  
18 medium deciduous trees proposed (79m2 ea.),  
34 large coniferous trees (79m2 ea.)  
proposed and 7 small deciduous trees proposed (7m2 ea.)

=16,627m2 canopy cover =27.7% canopy cover

\*Large deciduous tree calculated at 14m spread,  
medium deciduous at 10m spread, large  
coniferous at 10m spread and small deciduous  
at 3m spread.

no.	date	revision / issue	by
5	13/06/2025	ISSUED FOR SITE PLAN CONTROL	LC
4	02/06/2025	REVISED AS PER COMMENTS	CAT
3	09/05/2025	ISSUED FOR 66% CLIENT REVIEW	LC
2	04/04/2025	ISSUED FOR SITE PLAN CONTROL	LC
1	14/03/2025	ISSUED FOR 33% CLIENT REVIEW	LC

**grc architects**  
A PROVENCHER\_ROY COMPANY  
47 Clarence Street, Suite 401  
Ottawa, Ontario K1N 9K1  
1-877-341-4203 / 613-242-4180  
info@grcarchitects.com www.grcarchitects.com

consultant  
**JAMES B. LENNOX & ASSOCIATES INC.**  
**LANDSCAPE ARCHITECTS**  
332 CARLING AVE. OTTAWA, ONTARIO K2H 8A8  
Tel: (613) 722-5168 Fax: (613) 722-5168

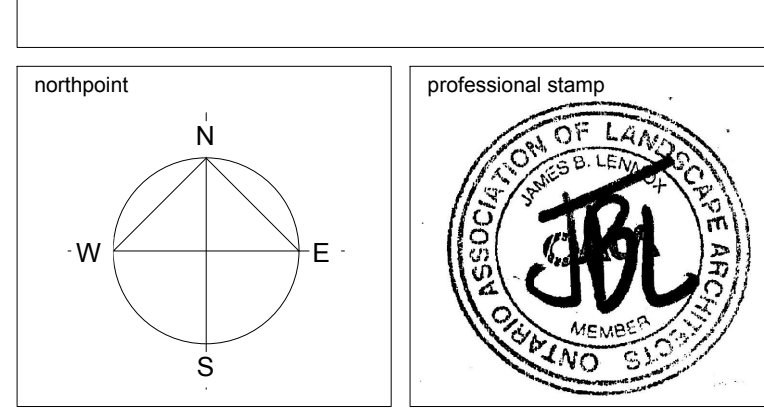

project title  
**NEW CATHOLIC HIGH SCHOOL RIVERSIDE SOUTH**  
675 Borbridge Ave. Ontario

drawing title  
**LANDSCAPE PLAN**

date	SEPTEMBER, 2024	job no.	24GR2437
scale	1 : 500		
drawn	LC	drawing no.	L.1
approved	JL		
plot date	JUNE 6th, 2025		

1. DO NOT SCALE FROM THIS DRAWING.  
2. CONTRACTOR TO VERIFY ALL DIMENSIONS AND NOTIFY THE ARCHITECT OF ANY DISCREPANCIES BEFORE WORK COMMENCES.  
3. THIS DRAWING TO BE READ IN CONJUNCTION WITH THE FOLLOWING DRAWINGS: STRUCTURAL, MECHANICAL, ELECTRICAL.