

# Stantec

LEGAL DESCRIPTION: PT LT 23, CON 10F, AS IN NS153639; OTTAWA/NEPEAN



## LOCATION PLAN

## LIST OF DRAWINGS

### LANDSCAPE DRAWINGS:

- |           |  |
|-----------|--|
| <b>L1</b> | LANDSCAPE PLAN                         |
| <b>L2</b> | LANDSCAPE PLAN - PHASE I               |
| <b>L3</b> | TREE CANOPY AND SOIL VOLUME            |
| <b>L4</b> | PLANTING SCHEDULE (PRIVATE OWNERSHIP)  |
| <b>L5</b> | PLANTING SCHEDULE (CITY OWNERSHIP)     |
| <b>L6</b> | LANDSCAPE SECTIONS / ELEVATIONS - I    |
| <b>L7</b> | LANDSCAPE SECTIONS / ELEVATIONS - II   |
| <b>L8</b> | LANDSCAPE DETAILS - I                  |
| <b>L9</b> | LANDSCAPE DETAILS - II & GENERAL NOTES |

# PARKWAY HOUSE

# 2475 REGINA STREET

CLIENT: WINDMILL DEVELOPMENT GROUP LTD.

2025/06/04

Project Number: 160410375





1. Refer to the Tree Conservation Report for 2475 Regina Street issued on 2025-05-30 by IFS ASSOCIATES.  
Select pruning / limbing will be required in some areas including along the path of travel for heavy equipment. Prior to commencing construction work, the contractor should walk the site and complete selective pruning / limbing with a certified arborist. All limbing and pruning shall be as per accepted arboricultural practices. Excavation within the critical root zone shall be avoided wherever possible. Where unavoidable, required excavation shall be by hand or hydro excavation to avoid tearing of roots. Trenching within the critical root zone is not permitted. In instances where root pruning is required, the service of a Certified Arborist or Qualified Tree Worker under the supervision of a Certified Arborist shall be retained. Any root cutting shall be made using a sharp spade or knife at the limit of disturbance prior to any construction activities. Roots to remain that are exposed by construction activities must be immediately covered by native topsoil or temporarily covered with burlap, filter cloth, or woodchips and kept moist (i.e. watering with a soft-spray nozzle at least three times a week). A covering plastic should be used in order to retain moisture during an extended period where watering may not be possible (i.e. over weekends). Where re-grading is required within the Critical Root Zone (CRZ), it should be performed by hand under the supervision of a Certified Arborist. When working near vegetation, the Contractor shall ensure that exhaust fumes from all equipment are NOT directed towards any tree's canopy.
2. Refer to drawings L4-L5 for planting schedule.
3. Refer to drawings L6-L9 for Landscape sections & elevations, general notes & details.
4. The landscape plan has been developed meeting all AODA requirements for accessibility.





**LEGAL DESCRIPTION:**  
PT LT 23, CON 10F, AS IN  
NS153639; OTTAWA/NEPEAN



Stantec Consulting Ltd.  
400 - 1331 Clyde Avenue  
Ottawa ON  
Tel. 613.722.4420  
www.stantec.com

Copyright Reserved  
The Contractor shall verify and be responsible for all dimensions. DO NOT scale the drawing - any errors or omissions shall be reported to Stantec without delay.  
The Copyrights to all designs and drawings are the property of Stantec. Reproduction or use for any purpose other than that authorized by Stantec is forbidden.

Key Plan

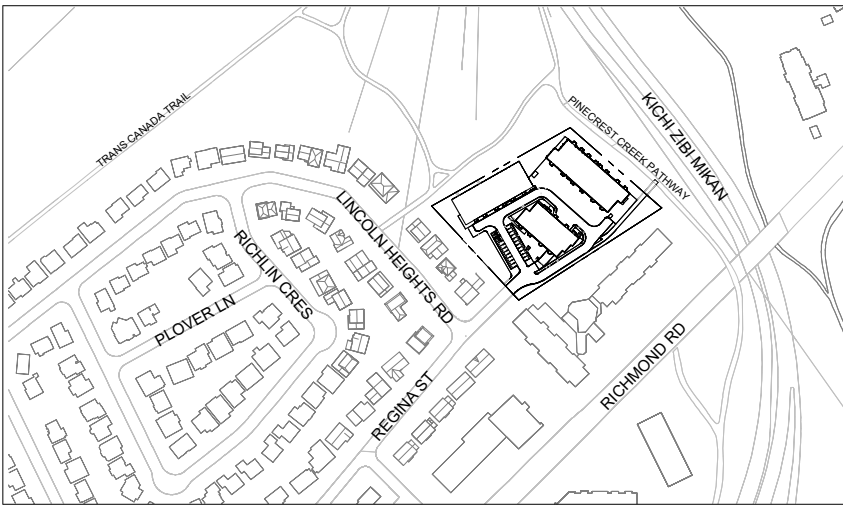

- Legend**
- CONCRETE PAVING  
REFER TO DETAILS 5-6 SHEET L8
  - UNIT PAVING  
REFER TO DETAIL 8 SHEET L8
  - ASPHALT PAVING  
REFER TO DETAILS 1-2 SHEET L8
  - GRAVEL  
REFER TO SECTION 5 SHEET L8
  - SOIL CELL (BELOW)  
REFER TO DETAIL 1 SHEET L8
  - NATIVE SEEDMIX  
RAIN GARDEN / WETLAND MIX
  - NATIVE SEEDMIX  
DROUGHT TOLERANT  
POLLINATOR MEADOW MIX
  - SOD  
INCLUDING 150mm TOPSOIL
  - MIXED SHRUB BED  
(NATURALIZED AREAS)  
REFER TO DETAIL 5 SHEET L9
  - PERENNIALS & HERBACEOUS PLANTS  
(NATURALIZED AREAS)  
REFER TO DETAIL 7 SHEET L9
  - ORNAMENTAL GRASS  
(NATURALIZED AREAS)  
REFER TO DETAIL 7 SHEET L9
  - MIXED SHRUB BED  
(URBAN AREAS)  
REFER TO DETAIL 6 SHEET L9
  - PERENNIALS & HERBACEOUS PLANTS  
(URBAN AREAS)  
REFER TO DETAIL 8 SHEET L9
  - ORNAMENTAL GRASS  
(URBAN AREAS)  
REFER TO DETAIL 8 SHEET L9
  - VINES / CLIMBERS  
REFER TO DETAIL 7 SHEET L9
  - PLANTER EDGE  
REFER TO DETAIL 11 SHEET L8
  - CONCRETE PLANTER CURB  
REFER TO DETAIL 9 SHEET L8
  - SEATWALL  
REFER TO SECTION 1 SHEET L8
  - ACCESSIBLE BENCH
  - BIKE RACK(S)  
REFER TO DETAIL 12 SHEET L8
  - LANDSCAPE BOULDER / ARMOUR STONE  
REFER TO DETAIL 10 SHEET L8
  - TREE PROTECTION FENCE  
REFER TO DETAILS 1-2 SHEET L9
  - CONIFEROUS TREE PLANTING  
REFER TO DETAIL 34 SHEET L9
  - EXISTING TREE  
ANTICIPATED TO REMAIN (INCLUDING ID#, SPECIES & DIAMETER AT BREAST HEIGHT), REFER TO NOTE 1.

2	ISSUED FOR CITY REVIEW	TA	KP	25.06.04
1	60% DETAIL SUBMISSION	TA	KP	25.04.16
0	ISSUED FOR CITY REVIEW	TA	KP	25.02.20
Revision		By	Appd.	YY.MM.DD

File Name:	160410375-200	BL	KP / L	KP / BL	23.11.22
		Dwn.	Chkd.	Dsgn.	YY.MM.DD

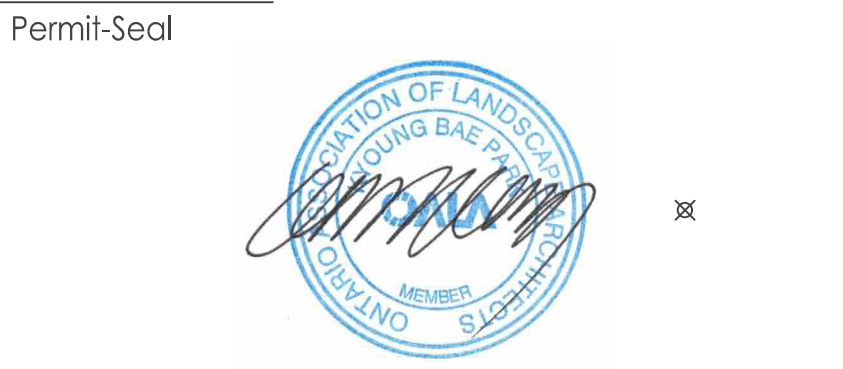

Client/Project  
WINDMILL DEVELOPMENT GROUP LTD.

2475 REGINA STREET

Ottawa, ON

Title  
LANDSCAPE PLAN  
PHASE I

Project No.	Scale	0	2.5	7.5	12.5m
160410375	1:250				
Drawing No.	Sheet	Revision			

L2 2 of 9 2  
D07-12-24 01 01  
PLAN NUMBER: 19267

- Notes**
- Refer to the Tree Conservation Report for 2475 Regina Street issued on 2025-05-30 by IFS ASSOCIATES.  
Select pruning / limbing will be required in some areas including along the path of travel for heavy equipment. Prior to commencing construction work, the contractor should walk the site and complete selective pruning / limbing by a certified arborist. All limbing and pruning shall be as per accepted arboricultural practices. Excavation within the critical root zone shall be avoided where possible. Where unavoidable, required excavation shall be by hand or hydro excavation to avoid tearing of roots. Trenching within the critical root zone is not permitted. In instances where root pruning is required, the service of a Certified Arborist or Qualified Tree Worker under the supervision of a Certified Arborist shall be retained. Any root cutting shall be made using a sharp spade or knife at the limit of disturbance prior to any construction activities. Roots to remain that are exposed by construction activities must be immediately reburied with native topsoil or temporarily covered with burlap, filter cloth, or woodchips and kept moist (i.e. watering with a soft-spray nozzle at least three times a week). A covering plastic should be used in order to retain moisture during an extended period when watering may not be possible (i.e. over weekends). Where re-grading is required within the Critical Root Zone (CRZ), it should be performed by hand under the supervision of a Certified Arborist. When working near vegetation, the Contractor shall ensure that exhaust fumes from all equipment are NOT directed towards any tree's canopy.
  - Refer to drawings L4-L5 for planting schedule.
  - Refer to drawings L6-L9 for Landscape sections & elevations, general notes & details.
  - The landscape plan has been developed meeting all AODA requirements for accessibility.



\\s01\sa\1\Working\Drawings\1604\Projects\1604\10375\design\drawing\Production\160410375\_L3-SoilCanopy.dwg  
2025/05/01 11:50 AM by: JMM/DD

ORIGINAL SHEET - ARCH D



ANTICIPATED LIMIT OF TREE  
CANOPY COVER AT 40 YEARS GROWTH:  
TREE CANOPY AREA = 3,625 m<sup>2</sup>  
PROJECT SITE AREA = 10,359 m<sup>2</sup>  
CANOPY COVERAGE = 35.0%

LEGAL DESCRIPTION:  
PT LT 23, CON 10F, AS IN  
NS153639; OTTAWA/NEPEAN



Stantec Consulting Ltd.  
400 - 1331 Clyde Avenue  
Ottawa ON  
Tel. 613.722.4420  
www.stantec.com

Copyright Reserved

The Contractor shall verify and be responsible for all dimensions. DO NOT scale the drawing - any errors or omissions shall be reported to Stantec without delay.  
The Copyrights to all designs and drawings are the property of Stantec. Reproduction or use for any purpose other than that authorized by Stantec is forbidden.

Key Plan



Legend

- TREE CANOPY COVERAGE**  
ANTICIPATED AT 40 YEARS
- SOIL BEDS - ON STRUCTURE**  
REFER TO ANNOTATIONS FOR SOIL VOLUME
- CONCRETE PAVING**  
REFER TO DETAILS 5-6 SHEET L8
- UNIT PAVING**  
REFER TO DETAIL 8 SHEET L8
- ASPHALT PAVING**  
REFER TO DETAILS 1-2 SHEET L8
- GRAVEL**  
REFER TO SECTION 5 SHEET L8
- SOIL CELL (BELOW)**  
REFER TO SECTION 1 SHEET L6
- PLANTER EDGE**  
REFER TO DETAIL 11 SHEET L8
- CONCRETE PLANTER CURB**  
REFER TO DETAIL 9 SHEET L8
- SEATWALL**  
REFER TO SECTION 1 SHEET L6
- ACCESSIBLE BENCH**  
REFER TO DETAIL 12 SHEET L8
- BIKE RACK(S)**  
REFER TO DETAIL 10 SHEET L8
- LANDSCAPE BOULDERS / ARMOUR STONE**  
REFER TO DETAIL 10 SHEET L8
- EXISTING TREE**  
ANTICIPATED TO REMAIN (INCLUDING ID#, SPECIES & DIAMETER AT BREAST HEIGHT). REFER TO NOTE 1.
- XX (DBH)**  
ANTICIPATED TREE ROOT GROWTH  
REFER TO SECTIONS 1 AND 2 SHEET L7

3	ISSUED FOR CITY REVIEW	TA	KP	25.06.04
2	60% DETAIL SUBMISSION	TA	KP	25.04.16
1	ISSUED FOR CITY REVIEW	TA	KP	25.02.20
0	ISSUED FOR CITY REVIEW	TA	KP	24.11.28
Revision		By	Appd.	YY.MM.DD

File Name:	160410375-L200	BL	KP / IL	KP / BL	23.11.22
		Dwn.	Chkd.	Dsgn.	YY.MM.DD

Permit-Seal



Client/Project  
WINDMILL DEVELOPMENT GROUP LTD.  
2475 REGINA STREET  
Ottawa, ON

Title  
TREE CANOPY AND SOIL VOLUME

Project No.	Scale	0	2.5	7.5	12.5m
160410375	1:250				
Drawing No.	Sheet	Revision			

L3 3 of 9

3  
PLAN NUMBER: 19267

Notes

- Refer to the Tree Conservation Report for 2475 Regina Street issued on 2025-05-30 by IFS ASSOCIATES.  
Select pruning / limbing will be required in some areas including along the path of travel for heavy equipment. Prior to commencing construction work, the contractor should walk the site and complete selective pruning / limbing with a certified arborist. All limbing and pruning shall be as per accepted arboricultural practices. Excavation within the critical root zone shall be avoided where possible. Where unavoidable, required excavation shall be by hand or hydro excavation to avoid tearing of roots. Trenching within the critical root zone is not permitted. In instances where root pruning is required, the service of a Certified Arborist or Qualified Tree Worker under the supervision of a Certified Arborist shall be retained. Any root cutting shall be made using a sharp spade or knife at the limit of disturbance prior to any construction activities. Roots to remain that are exposed by construction activities must be immediately reburied with native topsoil or temporarily covered with burlap, filter cloth, or woodchips and kept moist (i.e. watering with a soft-spray nozzle at least three times a week). A covering plastic should be used in order to retain moisture during an extended period when watering may not be possible (i.e. over weekends). Where re-grading is required within the Critical Root Zone (CRZ), it should be performed by hand under the supervision of a Certified Arborist. When working near vegetation, the Contractor shall ensure that exhaust fumes from all equipment are NOT directed towards any tree's canopy.
- Refer to drawings L4-L5 for planting schedule.
- Refer to drawings L6-L9 for Landscape sections & elevations, general notes & details.
- The landscape plan has been developed meeting all AODA requirements for accessibility.



CONIFEROUS TREES - REFER TO DETAIL 3 SHEET L9										
KEY	PH1 QTY	PH2 QTY	BOTANICAL NAME	COMMON NAME	SPACING (mm O.C.)	CALIPER (mm)	HEIGHT (mm)	ROOT	DESCRIPTION / NOTES	MATURE HEIGHT
AA	0	3	<i>Abies alba</i>	Silver Fir	Refer to Plan	-	2000	W.B.	full sun, partial sun/shade, low maintenance	Medium (10-15m)
LL	1	2	<i>Larix laricina</i>	Eastern larch	Refer to Plan	-	2000	W.B.	native (Ontario), full sun, fall foliage, low maintenance	Large (15m+)
TO	0	2	<i>Thuja occidentalis</i>	Eastern White Cedar	Refer to Plan	-	2000	W.B.	native (Ontario), drought tolerant, low maintenance, full sun	Medium (10-15m)
PS	0	13	<i>Pinus strobus</i>	White Pine	Refer to Plan	-	2000	W.B.	full sun, low maintenance	Small (5-10m)
DECIDUOUS TREES (ON STRUCTURE) - REFER TO DETAIL 2 SHEET L9										
KEY	PH1 QTY	PH2 QTY	BOTANICAL NAME	COMMON NAME	SPACING mm (O.C.)	CALIPER (mm)	HEIGHT (mm)	ROOT	DESCRIPTION / NOTES	MATURE HEIGHT
AAA	0	1	<i>Amelanchier arborea</i>	Downy Serviceberry	Refer to Plan	45	2500	W.B.	native (Ontario), treeform, full shade, partial sun/shade, full shade, colourful flowers, attracts birds	Small (5-10m)
AG	2	0	<i>Aesculus glabra</i>	Ohio buckeye	Refer to Plan	50	-	W.B.	native (Ontario), full sun, partial sun/shade, attracts birds, fall foliage	Medium (10-15m)
AL	8	2	<i>Amelanchier laevis</i>	Allegheny Serviceberry	Refer to Plan	45	2500	W.B.	native (Ontario), treeform, full sun, partial sun/shade, attracts birds, edible fruit, fall foliage, colourful flowers	Small (5-10m)
ASL	1	3	<i>Acer saccharum 'Legacy'</i>	Legacy Sugar Maple	Refer to Plan	50	-	W.B.	native (Ontario), drought tolerant, full sun, fall foliage	Large (15m+)
AX	0	3	<i>Amelanchier x grandiflora 'Autumn Brilliance'</i>	Autumn Brilliance Serviceberry	Refer to Plan	45	2500	W.B.	native (Ontario), treeform, full sun, partial sun/shade, attracts birds, edible fruit, fall foliage, colourful flowers	Small (5-10m)
CC	0	3	<i>Carpinus caroliniana</i>	Muscledow	Refer to Plan	50	-	W.B.	native (Ontario), partial sun/shade, full sun, attracts birds, fall foliage	Medium (10-15m)
GT	0	3	<i>Gleditsia triacanthos</i>	Honey locust	Refer to Plan	50	-	W.B.	native (Ontario), drought tolerant, salt tolerant, heat tolerant, full sun, partial sun/shade	Large (15m+)

DECIDUOUS TREES (ON GRADE) - REFER TO DETAIL 1 SHEET L9										
	PH1 QTY	PH2 QTY2	BOTANICAL NAME	COMMON NAME	SPACING mm (O.C.)	CALIPER (mm)	HEIGHT (mm)	ROOT	DESCRIPTION / NOTES	MATURE HEIGHT
AC	1	0	<i>Amelanchier canadensis</i>	Canadian Serviceberry	Refer to Plan	50	2200	B.B.	native (Ontario), treeform, full sun, partial sun/shade, attracts birds, edible fruit, fall foliage, colourful flowers	Small (5-10m)
AL	1	6	<i>Amelanchier laevis</i>	Allegheny Serviceberry	Refer to Plan	45	2500	W.B.	native (Ontario), treeform, full sun, partial sun/shade, attracts birds, edible fruit, fall foliage, colourful flowers	Small (5-10m)
AR	0	1	<i>Acer rubrum</i>	Red Maple	Refer to Plan	50	-	W.B.	native (Ontario), fall foliage, full sun, partial sun/shade	Medium (10-15m)
ASL	1	2	<i>Acer saccharum 'Legacy'</i>	Legacy Sugar Maple	Refer to Plan	50	-	W.B.	native (Ontario), drought tolerant, full sun, fall foliage	Large (15m+)
AFJ	1	0	<i>Acer X freemanii 'Jeffersred'</i>	Autumn Blaze Maple	Refer to Plan	50	-	W.B.	native (Ontario), drought tolerant, full sun, fall foliage	Large (15m+)
AX	0	2	<i>Amelanchier x grandiflora 'Autumn Brilliance'</i>	Autumn Brilliance Serviceberry	Refer to Plan	45	2500	W.B.	native (Ontario), treeform, full sun, partial sun/shade, attracts birds, edible fruit, fall foliage, colourful flowers	Small (5-10m)
BA	1	5	<i>Betula alleghaniensis</i>	Yellow Birch	Refer to Plan	50	-	W.B.	native (Ontario), full sun, partial sun/shade, fall foliage	Medium (10-15m)
BP	0	2	<i>Betula papyrifera</i>	White Birch	Refer to Plan	50	-	W.B.	native (Ontario), salt tolerant, full shade, attracts birds, fall foliage	Medium (10-15m)
GT	1	0	<i>Gleditsia triacanthos</i>	Honey Locust	Refer to Plan	50	-	W.B.	native (Ontario), drought tolerant, salt tolerant, heat tolerant, full sun, partial sun/shade	Large (15m+)
JN	3	1	<i>Juglans nigra</i>	Black Walnut	Refer to Plan	50	-	W.B.	native (Ontario), salt tolerant, drought tolerant, full sun, edible fruit, fall foliage	Large (15m+)
OV	0	3	<i>Ostrya virginiana</i>	Ironwood	Refer to Plan	50	-	W.B.	native (Ontario), drought tolerant, full sun, partial sun/shade, full shade, attracts birds, fall foliage	Medium (10-15m)
QM	0	3	<i>Quercus macrocarpa</i>	Bur Oak	Refer to Plan	50	-	W.B.	native (Ontario), drought tolerant, low maintenance, full sun, fall foliage	Medium (10-15m)
QR	3	0	<i>Quercus palustris</i>	Pin Oak	Refer to Plan	50	-	W.B.	native (Ontario), drought tolerant, full sun, fall foliage	Medium (10-15m)
QR	1	0	<i>Quercus rubra</i>	Red Oak	Refer to Plan	50	-	W.B.	native (Ontario), drought tolerant, full sun, fall foliage	Large (15m+)
TA	1	0	<i>Tilia americana</i>	Basswood	Refer to Plan	50	-	W.B.	native (Ontario), drought tolerant, full sun, partial sun/shade, attracts butterflies, fragrant	Large (15m+)

MIXED SHRUB BED (NATURALIZED AREAS) - REFER TO DETAIL 5 SHEET L9										
KEY	PH1 QTY	PH2 QTY	BOTANICAL NAME	COMMON NAME	SPACING mm (O.C.)	SIZE	HEIGHT (mm)	ROOT	DESCRIPTION / NOTES	% BED COVER
Als	3	1	<i>Amelanchier laevis</i>	Downy Serviceberry	3000	3 Gal.	-	Pot	native (Ontario), full sun, partial sun/shade, attracts birds, fall foliage	34%
Cos	2	1	<i>Cephalanthus occidentalis</i>	Buttonbush	1500	2 Gal.	-	Pot	native (Ontario), rain garden, full sun, partial sun/shade, attracts butterflies, fragrant, long bloom, waters edge	6%
Caa	3	1	<i>Cornus alternifolia</i>	Pagoda Dogwood	1200	3 Gal.	-	Pot	native (Ontario), full sun, partial sun/shade, attracts birds, attracts butterflies, fall foliage, fragrant, low maintenance	5%
Cam	2	1	<i>Cornus amomum</i>	Silky Dogwood	2000	2 Gal.	-	Pot	native (Ontario), full sun, partial sun/shade, attracts birds	10%
Csa	2	1	<i>Cornus sericea</i>	Red Osier Dogwood	2000	2 Gal.	-	Pot	native (Ontario), partial sun/shade, full sun, attracts birds, fall foliage, salt tolerant	10%
Csf	2	1	<i>Cornus sericea 'Flaviramea'</i>	Yellowtwig Dogwood	2000	2 Gal.	-	Pot	native (Ontario), partial sun/shade, full sun, attracts birds, fall foliage, salt tolerant	10%
Dia	4	1	<i>Diervilla lonicera</i>	Bush Honeysuckle	750	3 Gal.	-	Pot	native (Ontario), drought tolerant, full sun, full shade, partial sun/shade, attracts butterflies, fall foliage, fragrant, low maintenance	3%
Scs	3	1	<i>Sambucus canadensis</i>	Canada Elderberry	2000	3 Gal.	-	Pot	native (Ontario), full sun, partial sun/shade, attracts birds, attracts butterflies, edible, fragrant	15%
Saa	4	1	<i>Spiraea alba</i>	White Meadowsweet	600	3 Gal.	-	Pot	native (Ontario), partial sun/shade, full sun, attracts butterflies, fall foliage, long bloom, salt tolerant, low maintenance, waters edge	2%
Sas	4	1	<i>Symphoricarpos albus</i>	Snowberry	1000	3 Gal.	-	Pot	native (Ontario), drought tolerant, full sun, partial sun/shade, attracts birds, low maintenance	5%

	MIXED SHRUB BED (URBAN AREAS) - REFER TO DETAIL 6 SHEET L9									
KEY	PH1 QTY	PH2 QTY	BOTANICAL NAME	COMMON NAME	SPACING mm (O.C.)	SIZE (Pot)	HEIGHT (mm)	ROOT	DESCRIPTION / NOTES	% BED COVER
Hkn	31	27	<i>Diervilla lonicera</i>	Bush Honeysuckle	750	3 Gal.	-	Pot	native (Ontario), drought tolerant, full sun, full shade, partial sun/shade, attracts butterflies, fall foliage, fragrant, low maintenance	8%
Dia	34	65	<i>Hypericum kalmianum</i>	Pot O'Gold	500	-	400	Pot	native (Ontario), drought tolerant, full sun, partial sun/shade, attracts butterflies, long bloom	4%
Pos	13	25	<i>Physocarpus opulifolius</i>	Common Ninebark	1500	-	400	Pot	native (Ontario), drought tolerant, full sun, partial sun/shade	14%
Pfa	17	32	<i>Potentilla fruticosa</i> 'Abbotswood'	Abbotswood Cinquefoil	500	2 Gal.	-	Pot	native (Ontario), drought tolerant, salt tolerant, attracts butterflies, long bloom, low maintenance, ground cover, rock garden, full sun	2%
Pff	17	32	<i>Potentilla fruticosa</i> 'Farreri'	Golddrop Cinquefoil	500	2 Gal.	-	Pot	native (Ontario), drought tolerant, salt tolerant, attracts butterflies, long bloom, low maintenance, ground cover, rock garden, full sun	2%
Rag	22	41	<i>Rhus aromatica</i> 'Grow-Low'	Grow-Low Fragrant Sumac	1500	-	400	Pot	native (Ontario), drought tolerant, low maintenance, erosion / bank control, attracts birds, ground cover, fall foliage, fragrant, full sun, partial sun/shade	23%
Rba	20	37	<i>Rosa blanda</i>	Smooth Rose	1500	3 Gal.	-	Pot	native (Ontario), full sun, partial sun/shade, attracts butterflies, fruit attracts birds, fragrant, colourful flowers	21%
Rva	30	56	<i>Rosa virginiana</i>	Virginia Rose	600	2 Gal.	-	Pot	native (Ontario), drought tolerant, edible fruit, partial sun/shade, full shade, attracts pollinators	5%
Ros	14	26	<i>Rubus odoratus</i>	Flowering Raspberry	1500	3 Gal.	-	Pot	native (Ontario), full sun, attracts birds, fall foliage, fragrant	15%
Tom	19	36	<i>Thuja occidentalis</i> 'Sherwood Moss'	Sherwood Moss Cedar	800	-	400	Pot	native (Ontario), full sun, partial sun/shade, low maintenance	6%

PERENNIALS & HERBACEOUS PLANTS (NATURALIZED AREAS) - REFER TO DETAIL 7 SHEET L9										
KEY	PH1 QTY	PH2 QTY	BOTANICAL NAME	COMMON NAME	SPACING (O.C.)	SIZE (Pot)	HEIGHT (mm)	ROOT	DESCRIPTION / NOTES	% BED COVER
A1a	16	2	<i>Asclepias incarnata</i>	Swamp Milkweed	800	1 Gal.	-	Pot	native (Ontario), rain garden, full sun, partial sun/shade, attracts butterflies, attracts pollinators, cutting flower, waters edge	15%
A1a	19	3	<i>Asclepias tuberosa</i>	Butterfly Milkweed	450	1 Gal.	-	Pot	native (Ontario), drought tolerant, full sun, attracts butterflies, attracts pollinators, cutting flower, rock garden	5%
C1f	38	5	<i>Coreopsis lanceolata</i>	Lance-Leaved Tickseed	450	1 Gal.	-	Pot	native (Ontario), drought tolerant, full sun, partial sun/shade, attracts butterflies, attracts pollinators, long bloom, low maintenance	10%
Lsp	38	5	<i>Liatris spicata</i> "Floristan Purple Star"	Floristan Purple Blazing Star	450	1 Gal.	-	Pot	native (Ontario), drought tolerant, rain garden, full sun, attracts birds, attracts butterflies, attracts pollinators, cutting flower	10%
Lcs	15	2	<i>Lobelia cardinalis</i>	Cardinal Flower	500	1 Gal.	-	Pot	native (Ontario), drought tolerant, rain garden, full sun, partial sun/shade, attracts butterflies, attracts birds, attracts pollinators, cutting flower	5%
Lsa	19	3	<i>Lobelia siphilitica</i>	Great Blue Lobelia	450	1 Gal.	-	Pot	native (Ontario), drought tolerant, rain garden, full sun, partial sun/shade, attracts butterflies, attracts birds, attracts pollinators, cutting flower	5%
Lps	15	2	<i>Lupinus perennis</i>	Sundial Lupine	1000	1 Gal.	-	Pot	native (Ontario), drought tolerant, full sun, attracts birds, attracts butterflies, attracts pollinators, cutting flower, salt tolerant, rock garden	20%
Mda	11	2	<i>Monarda didyma</i>	Beebalm	800	1 Gal.	-	Pot	native (Ontario), drought tolerant, full sun, ethnobotanical, partial sun/shade, attracts butterflies, attracts birds, attracts pollinators, fragrant	10%
Mda	19	3	<i>Monarda fistulosa</i>	Wild Bergamot	450	1 Gal.	-	Pot	native (Ontario), drought tolerant, full sun, ethnobotanical, partial sun/shade, attracts butterflies, attracts birds, attracts pollinators, fragrant	5%
Pfa	19	3	<i>Phlox divaricata</i>	Woodland Phlox	450	1 ltr	-	Pot	native (Ontario), drought tolerant, full sun, attracts butterflies, attracts pollinators, fragrant	5%
Eum	7	1	<i>Eupatorium maculatum</i>	Joe Pye Weed	1000	1 Gal.	-	Pot	native (Ontario), drought tolerant, full sun, partial sun/shade, attracts butterflies, attracts pollinators, attracts birds, cutting flower, colourful flowers	10%

PERENNIALS & HERBACEOUS PLANTS (URBAN AREAS) - REFER TO DETAIL 8 SHEET L9										
KEY	PH1 QTY	PH2 QTY	BOTANICAL NAME	COMMON NAME	SPACING mm(O.C.)	SIZE (Pot)	HEIGHT (mm)	ROOT	DESCRIPTION / NOTES	% BED COVER
Apl	85	95	<i>Asclepias tuberosa</i>	Butterfly Milkweed	450	1 Gal.	-	Pot	native (Ontario), drought tolerant, full sun, attracts butterflies, attracts pollinators, cutting flower, rock garden	10%
Eti	85	95	<i>Echinacea pallida</i>	Pale Purple Coneflower	450	1 Gal.	-	Pot	native (Ontario), drought tolerant, full sun, partial sun/shade, attracts birds, attracts butterflies, attracts pollinators, colourful flowers, colourful flowers	10%
Epp	65	73	<i>Echinacea purpurea</i> 'Prairie Splendor'	Prairie Splendor Coneflower	450	1 Gal.	-	Pot	native (Ontario), drought tolerant, full sun, partial sun/shade, attracts birds, attracts butterflies, attracts pollinators, colourful flowers, cutting flower	10%
Gmm	98	110	<i>Geranium macrorrhizum</i>	Bigroot Geranium	500	1 Gal.	-	Pot	native (Ontario), full sun, partial sun/shade, ground cover	15%
Nfi	91	102	<i>Nepeta faassenii</i> 'Cat's Meow'	Catmint	600	1 Gal.	-	Pot	drought tolerant, full sun, partial sun/shade, attracts butterflies, attracts pollinators, fragrant, long bloom, low maintenance	20%
Rhc	91	101	<i>Rudbeckia hirta</i> 'Autumn Colours'	Autumn Colours Gloriosa Daisy	300	1 Gal.	-	Pot	native (Ontario), drought tolerant, full sun, partial sun/shade, attracts butterflies, attracts pollinators, attracts birds, colourful flowers, cutting flower	5%
Cas	49	55	<i>Ceanothus americanus</i>	New Jersey Tea	1000	1 Gal.	-	Pot	native (Ontario), drought tolerant, full sun, partial sun/shade, attracts birds, attracts butterflies, attracts pollinators, fragrant, cutting flower	30%

		ORNAMENTAL GRASS (NATURALIZED AREAS) - REFER TO DETAIL 7 SHEET L9									
KEY	PH1 QTY	PH2 QTY	BOTANICAL NAME	COMMON NAME	SPACING mm (O.C.)	SIZE (Pot)	HEIGHT (mm)	ROOT	DESCRIPTION / NOTES		% BED COVER
<b>Ag1</b>	23	11	<i>Andropogon gerardi</i>	Big Bluestem	900	1 Gal.	-	Pot	native (Ontario), drought tolerant, full sun, cutting flower, heat tolerant, fall foliage, long bloom		20%
<b>Bga</b>	31	15	<i>Bouteloua gracilis</i>	Blue Grama	300	1 Gal.	-	Pot	native (Ontario), drought tolerant, full sun, attracts birds, heat tolerant, low maintenance, long bloom, ground cover		3%
<b>Ccs</b>	19	9	<i>Calamagrostis canadensis</i>	Canada Blue Joint	1000	1 Gal.	-	Pot	native (Ontario), rain garden, full sun, partial sun/shade, drought tolerant, long bloom, low maintenance		20%
<b>Cbi</b>	93	44	<i>Carex bebbii</i>	Bebb's Sedge	100	1 Gal.	-	Pot	native (Ontario), full sun, partial sun/shade, rain garden, waters edge		1%
<b>Cga</b>	12	6	<i>Carex comosa</i>	Bristly Sedge	1000	1 Gal.	-	Pot	native (Ontario), drought tolerant, rain garden, full sun, partial sun/shade, attracts birds, long bloom, salt tolerant, low maintenance		13%
<b>Cgi</b>	21	10	<i>Carex grayi</i>	Morning Star Sedge	600	1 Gal.	-	Pot	native (Ontario), drought tolerant, rain garden, full sun, partial sun/shade, cutting flower, long bloom, waters edge		8%
<b>Cpa</b>	17	8	<i>Carex pensylvanica</i>	Wood Sedge	400	1 Gal.	-	Pot	native (Ontario), drought tolerant, rain garden, full sun, partial sun/shade, full shade, attracts birds, low maintenance, ground cover		3%
<b>Csa</b>	19	9	<i>Carex stricta</i>	Tussock Sege	500	1 Gal.	-	Pot	native (Ontario), drought tolerant, rain garden, full sun, partial sun/shade, attracts birds, long bloom, low maintenance, waters edge		5%
<b>Cva</b>	19	9	<i>Carex vulpinoidea</i>	Fox Sedge	500	1 Gal.	-	Pot	native (Ontario), rain garden, full sun, partial sun/shade, attracts birds, low maintenance, waters edge		5%
<b>Hoa</b>	14	7	<i>Hierochloa odorata</i>	Sweet Grass	1200	1 ltr	-	Pot	native (Ontario), ethnobotanical, full sun, partial sun/shade, attracts birds, salt tolerant, waters edge		22%

		ORNAMENTAL GRASS (URBAN AREAS) - REFER TO DETAIL 8 SHEET L9									
	PH1 QTY	PH2 QTY	BOTANICAL NAME	COMMON NAME	SPACING (M.O.C.)	SIZE (Pot)	HEIGHT (mm)	ROOT	DESCRIPTION / NOTES		% BED COVER
<b>Kcb</b>	112	155	<i>Deschampsia cespitosa</i> 'Bronze Veil'	Bronze Tufted Hair Grass	500	1 Gal.	-	Pot	native (Ontario), drought tolerant, full sun, partial sun/shade, fall foliage, ground bloom, low maintenance, ground cover, rock garden		15%
<b>Dcn</b>	112	155	<i>Deschampsia cespitosa</i> 'Northern Lights'	Variegated Tufted Hair Grass	500	1 Gal.	-	Pot	native (Ontario), drought tolerant, full sun, partial sun/shade, fall foliage, ground bloom, low maintenance, ground cover, rock garden		15%
<b>Pvm</b>	66	90	<i>Panicum virgatum</i>	Switch Grass	1000	1 Gal.	-	Pot	native (Ontario), drought tolerant, full sun, attracts birds, cutting flower, heat tolerant, long bloom, salt tolerant, low maintenance		35%
<b>Sms</b>	104	143	<i>Schizachyrium scoparium</i>	Little Bluestem	600	1 Gal.	-	Pot	native (Ontario), drought tolerant, full sun, cutting flower, heat tolerant, long bloom		20%
<b>Shs</b>	112	155	<i>Sporobolus heterolepis</i>	Prairie Dropseed	500	1 Gal.	-	Pot	native (Ontario), drought tolerant, full sun, attracts birds, fall foliage, heat tolerant		15%

VINES / CLIMBERS - REFER TO DETAIL 7 SHEET L9										
KEY	PH1 QTY	PH2 QTY	BOTANICAL NAME	COMMON NAME	SPACING (M.C.)	SIZE (Pot)	HEIGHT (mm)	ROOT	DESCRIPTION / NOTES	% BED COVER
Pqa	13	0	Parthenocissus quinquefolia	Virginia Creeper	1800	1 Gal.	-	Pot	native (Ontario), drought tolerant, full sun, partial sun/shade, full shade, attracts birds, fall foliage, ground cover	100%

NATIVE SEED MIX		
PH1: 72m2	PH2: 72m2	
RAIN GARDEN / WETLAND SOW AT 50g/m <sup>2</sup> /180m		
BOTANICAL NAME	COMMON NAME	
<i>Asclepias incarnata</i>	Swamp Milkweed	
<i>Aster purpureus</i>	Purple Stemmed Aster	
<i>Bidens cernua</i>	Nodding Bur Marigold	
<i>Carex crinita</i>	Fringed/Nodding Sedge	
<i>Carex lurida</i>	Lurid Sedge	
<i>Carex scopari</i>	Blunt Broom Sedge	
<i>Carex stipata</i>	Awl Sedge	
<i>Carex vulpinoidea</i>	Fox Sedge	
<i>Elymus virginicus</i>	Virginia Wild Rye	
<i>Eupatorium maculatum</i>	Spotted Joe Pye Weed	
<i>Eupatorium perfoliatum</i>	Bonese	
<i>Juncus effusus</i>	Soft Rush	
<i>Mimulus ringens</i>	Square Stemmed Monkey Flower	
<i>Scirpus cyperinus</i>	Wool Grass	
<i>Sparangium eurycarpum</i>	Giant Bur Reed	

NATIVE SEED MIX		
PH1: 488m2	PH2: 713m2	
DROUGHT TOLERANT / POLLINATOR MEADOW		
SOW AT 500g/180m;		
BOTANICAL NAME	COMMON NAME	
<i>Aster novae-angliae</i>	New England Aster	
<i>Desmodium canadense</i>	Showy Tick Trefoil	
<i>Elymus canadensis</i>	Canada Wild Rye	
<i>Elymus virginicus</i>	Virginia Wild Rye	
<i>Eupatorium perfoliatum</i>	Boneset	
<i>Liatris spicata</i>	Dense Blazing Star	
<i>Monarda fistulosa</i>	Wild Bergamot	
<i>Penstemon digitalis</i>	Foxglove / Beardtongue	
<i>Rudbeckia hirta</i>	Black Eyed Susan	
<i>Schizachyrium scorparium</i>	Little Bluestem	
<i>Sorghastrum nutans</i>	Indiangrass	
<i>Verbena hastata</i>	Blue Vervain	



Stantec Consulting Ltd.  
400 - 1331 Clyde Avenue  
Ottawa ON  
Tel. 613.722.4420  
[www.stantec.com](http://www.stantec.com)

Copyright Reserved

The Contractor shall verify and be responsible for all dimensions. DO NOT scale the drawing - any errors or omissions shall be reported to Stantec without delay.  
The Copyrights to all designs and drawings are the property of Stantec. Reproduction or use for any purpose other than that authorized by Stantec is forbidden.

Legend

## Notes

5	60% DETAIL SUBMISSION	TA	KP	25.04.16
4	ISSUED FOR CITY REVIEW	TA	KP	25.02.20
3	ISSUED FOR CITY REVIEW	TA	KP	24.11.28
2	ISSUED FOR COORDINATION	TA	KP	24.11.15
6	ISSUED FOR CITY REVIEW	TA	KP	25.06.04
Revision		By	Appd.	YY.MM.DD

File Name: 160410375-L200	BL	KP / IL	KP / BL	23.11.22
	Dwn.	Chkd.	Dsgn.	YY.MM.DD

Permit-Seal



Client/Project

WINDMILL DEVELOPMENT GROUP LTD.

2475 REGINA STREET

Ottawa, ON

Title  
PLANTING SCHEDULE  
PRIVATE OWNERSHIP

Project No.

Scale

Drawing No.

Sheet

Revision

L4

4 of 9

6

PLAN NUMBER: 19267



X:\0205\01\1604\10375\Planting\_Schedule.dwg, 1604 Projects\160410375\design\drawing\Production\160410375\_L4-L5-PlantingSchedule.dwg  
2025/05/01 11:59:45 PM  
2025/05/01 11:59:45 PM

PLANTING SCHEDULE (CITY OWNERSHIP)

CONIFEROUS TREES - REFER TO DETAIL 3 SHEET L9									
KEY	QTY	BOTANICAL NAME	COMMON NAME	SPACING (mm O.C.)	CALIPER (mm)	HEIGHT (mm)	ROOT	DESCRIPTION / NOTES	MATURE HEIGHT
TC	3	<i>Tsuga canadensis</i>	Eastern Hemlock	Refer to Plan	-	2000	W.B.	native (Ontario), drought tolerant, low maintenance, full sun	Small (5-10m)
PS	3	<i>Pinus strobus</i>	White Pine	Refer to Plan	-	2000	W.B.	full sun, low maintenance	Small (5-10m)
DECIDUOUS TREES (ON GRADE) - REFER TO DETAIL 1 SHEET L9									
KEY	QTY	BOTANICAL NAME	COMMON NAME	SPACING mm (O.C.)	CALIPER (mm)	HEIGHT (mm)	ROOT	DESCRIPTION / NOTES	MATURE HEIGHT
AR	3	<i>Acer rubrum</i>	Red Maple	Refer to Plan	50	-	W.B.	native (Ontario), fall foliage, full sun, partial sun/shade	Medium (10-15m)
ASL	3	<i>Acer saccharum</i> 'Legacy'	Legacy Sugar Maple	Refer to Plan	50	-	W.B.	native (Ontario), drought tolerant, full sun, fall foliage	Large (15m+)
BA	2	<i>Betula alleghaniensis</i>	Yellow Birch	Refer to Plan	50	-	W.B.	native (Ontario), full sun, partial sun/shade, fall foliage	Medium (10-15m)
JN	1	<i>Juglans nigra</i>	Black Walnut	Refer to Plan	50	-	W.B.	native (Ontario), salt tolerant, drought tolerant, full sun, edible fruit, fall foliage	Large (15m+)
QM	1	<i>Quercus macrocarpa</i>	Bur Oak	Refer to Plan	50	-	W.B.	native (Ontario), drought tolerant, low maintenance, full sun, fall foliage	Medium (10-15m)
TA	3	<i>Tilia americana</i>	Basswood	Refer to Plan	50	-	W.B.	native (Ontario), drought tolerant, full sun, partial sun/shade, attracts butterflies, fragrant	Large (15m+)

MIXED SHRUB BED (NATURALIZED AREAS) - REFER TO DETAIL 6 SHEET L9									
KEY	QTY	BOTANICAL NAME	COMMON NAME	SPACING mm (O.C.)	SIZE	HEIGHT (mm)	ROOT	DESCRIPTION / NOTES	% BED COVER
Als	4	<i>Amelanchier laevis</i>	Downy Serviceberry	3000	3 Gal.	-	Pot	native (Ontario), full sun, partial sun/shade, attracts birds, fall foliage	34.00%
Cos	2	<i>Cephalanthus occidentalis</i>	Buttonbush	1500	2 Gal.	-	Pot	native (Ontario), rain garden, full sun, partial sun/shade, attracts butterflies, fragrant, long bloom, waters edge	6.00%
Caa	3	<i>Cornus alternifolia</i>	Pagoda Dogwood	1200	3 Gal.	-	Pot	native (Ontario), full sun, partial sun/shade, attracts birds, attracts butterflies, fall foliage, fragrant, low maintenance	5.00%
Cam	3	<i>Cornus amomum</i>	Silky Dogwood	2000	2 Gal.	-	Pot	native (Ontario), full sun, partial sun/shade, attracts birds	15.00%
Csa	6	<i>Cornus alba</i> 'Ivory Halo®' (Bailho)	Ivory Halo® Dogwood	1500	2 Gal.	-	Pot	native (Ontario), partial sun/shade, full sun, attracts birds, fall foliage, salt tolerant	15.00%
Dia	5	<i>Diervilla lonicera</i>	Bush Honeysuckle	750	3 Gal.	-	Pot	native (Ontario), drought tolerant, full sun, full shade, partial sun/shade, attracts butterflies, fall foliage, fragrant, low maintenance	3.00%
Scs	3	<i>Sambucus canadensis</i>	Canada Elderberry	2000	3 Gal.	-	Pot	native (Ontario), full sun, partial sun/shade, attracts birds, attracts butterflies, edible, fragrant	15.00%
Saa	5	<i>Spirea alba</i>	White Meadowsweet	600	3 Gal.	-	Pot	native (Ontario), partial sun/shade, full sun, attracts butterflies, fall foliage, long bloom, salt tolerant, low maintenance, waters edge	2.00%
Sas	4	<i>Symphoricarpos albus</i>	Snowberry	1000	3 Gal.	-	Pot	native (Ontario), drought tolerant, full sun, partial sun/shade, attracts birds, low maintenance	5.00%

PERENNIALS & HERBACEOUS PLANTS (NATURALIZED AREAS) - REFER TO DETAIL 7 SHEET L9									
KEY	QTY	BOTANICAL NAME	COMMON NAME	SPACING mm (O.C.)	SIZE (Pot)	HEIGHT (mm)	ROOT	DESCRIPTION / NOTES	% BED COVER
Aia	11	<i>Asclepias incarnata</i>	Swamp Milkweed	800	1 Gal.	-	Pot	native (Ontario), rain garden, full sun, partial sun/shade, attracts butterflies, attracts pollinators, cutting flower, waters edge	15.00%
Ata	13	<i>Asclepias tuberosa</i>	Butterfly Milkweed	450	1 Gal.	-	Pot	native (Ontario), drought tolerant, full sun, attracts butterflies, attracts pollinators, cutting flower, rock garden	5.00%
Cif	27	<i>Coreopsis lanceolata</i>	Lance-Leaved Tickseed	450	1 Gal.	-	Pot	native (Ontario), drought tolerant, full sun, partial sun/shade, attracts butterflies, attracts pollinators, long bloom, low maintenance	10.00%
Lsp	27	<i>Liatris spicata</i> 'Floristan Purple'	Floristan Purple Blazing Star	450	1 Gal.	-	Pot	native (Ontario), drought tolerant, rain garden, full sun, attracts birds, attracts butterflies, attracts pollinators, cutting flower	10.00%
Lcs	10	<i>Lobelia cardinalis</i>	Cardinal Flower	500	1 Gal.	-	Pot	native (Ontario), drought tolerant, rain garden, full sun, partial sun/shade, attracts butterflies, attracts birds, attracts pollinators, cutting flower	5.00%
Lsa	13	<i>Lobelia siphilitica</i>	Great Blue Lobelia	450	1 Gal.	-	Pot	native (Ontario), drought tolerant, rain garden, full sun, partial sun/shade, attracts butterflies, attracts birds, attracts pollinators, cutting flower	5.00%
Lps	10	<i>Lupinus perennis</i>	Sundial Lupine	1000	1 Gal.	-	Pot	native (Ontario), drought tolerant, full sun, attracts birds, attracts butterflies, attracts pollinators, cutting flower, salt tolerant, rock garden	20.00%
Mda	8	<i>Monarda didyma</i>	Beebalm	800	1 Gal.	-	Pot	native (Ontario), drought tolerant, full sun, ethnobotanical, partial sun/shade, attracts butterflies, attracts birds, attracts pollinators, fragrant	10.00%
Mfa	13	<i>Monarda fistulosa</i>	Wild Bergamot	450	1 Gal.	-	Pot	native (Ontario), drought tolerant, full sun, ethnobotanical, partial sun/shade, attracts butterflies, attracts birds, attracts pollinators, fragrant	5.00%
Pda	13	<i>Phlox divaricta</i>	Woodland Phlox	450	1 ltr	-	Pot	native (Ontario), drought tolerant, full sun, attracts butterflies, attracts pollinators, fragrant	5.00%
Eum	5	<i>Eupatorium maculatum</i>	Joe Pye Weed	1000	1 Gal.	-	Pot	native (Ontario), drought tolerant, full sun, partial sun/shade, attracts butterflies, attracts pollinators, attracts birds, cutting flower, colourful flowers	10.00%

ORNAMENTAL GRASS (NATURALIZED AREAS) - REFER TO DETAIL 7 SHEET L9									
KEY	QTY	BOTANICAL NAME	COMMON NAME	SPACING mm (O.C.)	SIZE (Pot)	HEIGHT (mm)	ROOT	DESCRIPTION / NOTES	% BED COVER
Ag1	16	<i>Andropogon gerardii</i>	Big Bluestem	900	1 Gal.	-	Pot	native (Ontario), drought tolerant, full sun, cutting flower, heat tolerant, fall foliage, long bloom	20.00%
Bga	22	<i>Bouteloua gracilis</i>	Blue Grama	300	1 Gal.	-	Pot	native (Ontario), drought tolerant, full sun, attracts birds, heat tolerant, low maintenance, long bloom, ground cover	3.00%
Ccs	13	<i>Calamagrostis canadensis</i>	Canada Blue Joint	1000	1 Gal.	-	Pot	native (Ontario), rain garden, full sun, partial sun/shade, drought tolerant, long bloom, low maintenance	20.00%
Cbi	67	<i>Carex bebbii</i>	Bebb's Sedge	100	1 Gal.	-	Pot	native (Ontario), full sun, partial sun/shade, rain garden, waters edge	1.00%
Cca	9	<i>Carex comosa</i>	Bristly Sedge	1000	1 Gal.	-	Pot	native (Ontario), drought tolerant, rain garden, full sun, partial sun/shade, attracts birds, long bloom, salt tolerant, low maintenance	13.00%
Cgi	15	<i>Carex grayi</i>	Moming Star Sedge	600	1 Gal.	-	Pot	native (Ontario), drought tolerant, rain garden, full sun, partial sun/shade, cutting flower, long bloom, waters edge	8.00%
Cpa	13	<i>Carex pensylvanica</i>	Wood Sedge	400	1 Gal.	-	Pot	native (Ontario), drought tolerant, rain garden, full sun, partial sun/shade, full shade, attracts birds, low maintenance, ground cover	3.00%
Csa	13	<i>Carex stricta</i>	Tussock Sege	500	1 Gal.	-	Pot	native (Ontario), drought tolerant, rain garden, full sun, partial sun/shade, attracts birds, long bloom, low maintenance, waters edge	5.00%
Cva	13	<i>Carex vulpinoidea</i>	Fox Sedge	500	1 Gal.	-	Pot	native (Ontario), rain garden, full sun, partial sun/shade, attracts birds, low maintenance, waters edge	5.00%
Hoa	10	<i>Hierochloa odorata</i>	Sweet Grass	1200	1 ltr	-	Pot	native (Ontario), ethnobotanical, full sun, partial sun/shade, attracts birds, salt tolerant, waters edge	22.00%

NATIVE SEED MIX (826 4M")	
DROUGHT TOLERNAT POLLINATOR MEADOW	
SOW AT 500g/180M <sup>2</sup>	
BOTANICAL NAME	COMMON NAME
<i>Aster novae-angliae</i>	New England Aster
<i>Desmodium canadense</i>	Showy Tick Trefoil
<i>Elymus canadensis</i>	Canada Wild Rye
<i>Elymus virginicus</i>	Virginia Wild Rye
<i>Eupatorium perfoliatum</i>	Boneset
<i>Liatris spicata</i>	Dense Blazing Star
<i>Monarda fistulosa</i>	Wild Bergamot
<i>Penstemon digitalis</i>	Foxglove / Beardtongue
<i>Rudbeckia hirta</i>	Black Eyed Susan
<i>Schizachyrium scorparium</i>	Little Bluestem
<i>Sorghastrum nutans</i>	Indiangrass
<i>Verbena hastata</i>	Blue Vervain



Stantec Consulting Ltd.  
400 - 1331 Clyde Avenue  
Ottawa ON  
Tel. 613.722.4420  
www.stantec.com

Copyright Reserved

The Contractor shall verify and be responsible for all dimensions. DO NOT scale the drawing - any errors or omissions shall be reported to Stantec without delay.  
The Copyrights to all designs and drawings are the property of Stantec. Reproduction or use for any purpose other than that authorized by Stantec is forbidden.

Legend

Notes

2	ISSUED FOR CITY REVIEW	TA	KP 25.06.04
1	60% DETAIL SUBMISSION	TA	KP 25.04.16
0	ISSUED FOR CITY REVIEW	TA	KP 25.02.20
Revision		By	Appd. YY.MM.DD

File Name:	160410375-L200	BL	KP / IL	KP / BL	23.11.22
		Dwn.	Chkd.	Dsgn.	YY.MM.DD

Permit-Seal



Client/Project

WINDMILL DEVELOPMENT GROUP LTD.

2475 REGINA STREET

Ottawa, ON

Title

PLANTING SCHEDULE  
CITY OWNERSHIP

Project No.	Scale		
160410375			
Drawing No.	Sheet	Revision	

L5

5 of 9

2

PLAN NUMBER: 19267





Copyright Reserved

The Contractor shall verify and be responsible for all dimensions. DO NOT scale the drawing - any errors or omissions shall be reported to Stanlec without delay.

The Copyrights to all designs and drawings are the property of Stanlec. Reproduction or use for any purpose other than that authorized by Stanlec is forbidden.

Legend

---

## Notes

5	60% DETAIL SUBMISSION	TA	KP	25.04.16
4	ISSUED FOR CITY REVIEW	TA	KP	25.02.20
3	ISSUED FOR CITY REVIEW	TA	KP	24.11.28
2	ISSUED FOR COORDINATION	TA	KP	24.11.15
6	ISSUED FOR CITY REVIEW	TA	KP	25.06.04

Revision

File Name: 160410375-L200	BL	KP / IL	KP / BL	23.11.22
	Dwn.	Chkd.	Dsgn.	YY.MM.DD

Permit-Seal



Client/Project  
WINDMILL DEVELOPMENT GROUP LTD.

2475 REGINA STREET

Ottawa, ON

Title  
LANDSCAPE SECTIONS /  
ELEVATIONS - I

Project No.	Scale
160410375	AS NOTED

Drawing No.	Sheet	Revision
-------------	-------	----------

L6 6 of 9

6  
PLAN NUMBER: 19267

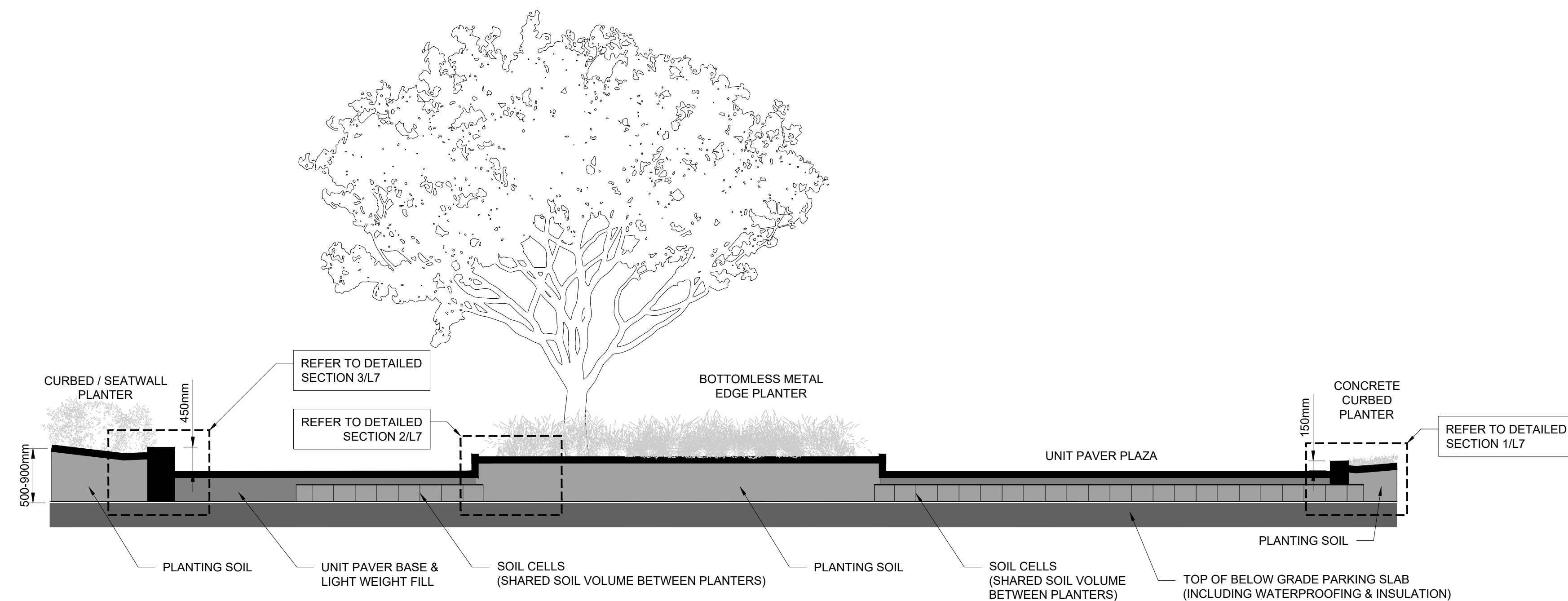

1 SECTION / ELEVATION: COMMON PLAZA  
L6 SCALE 1:50

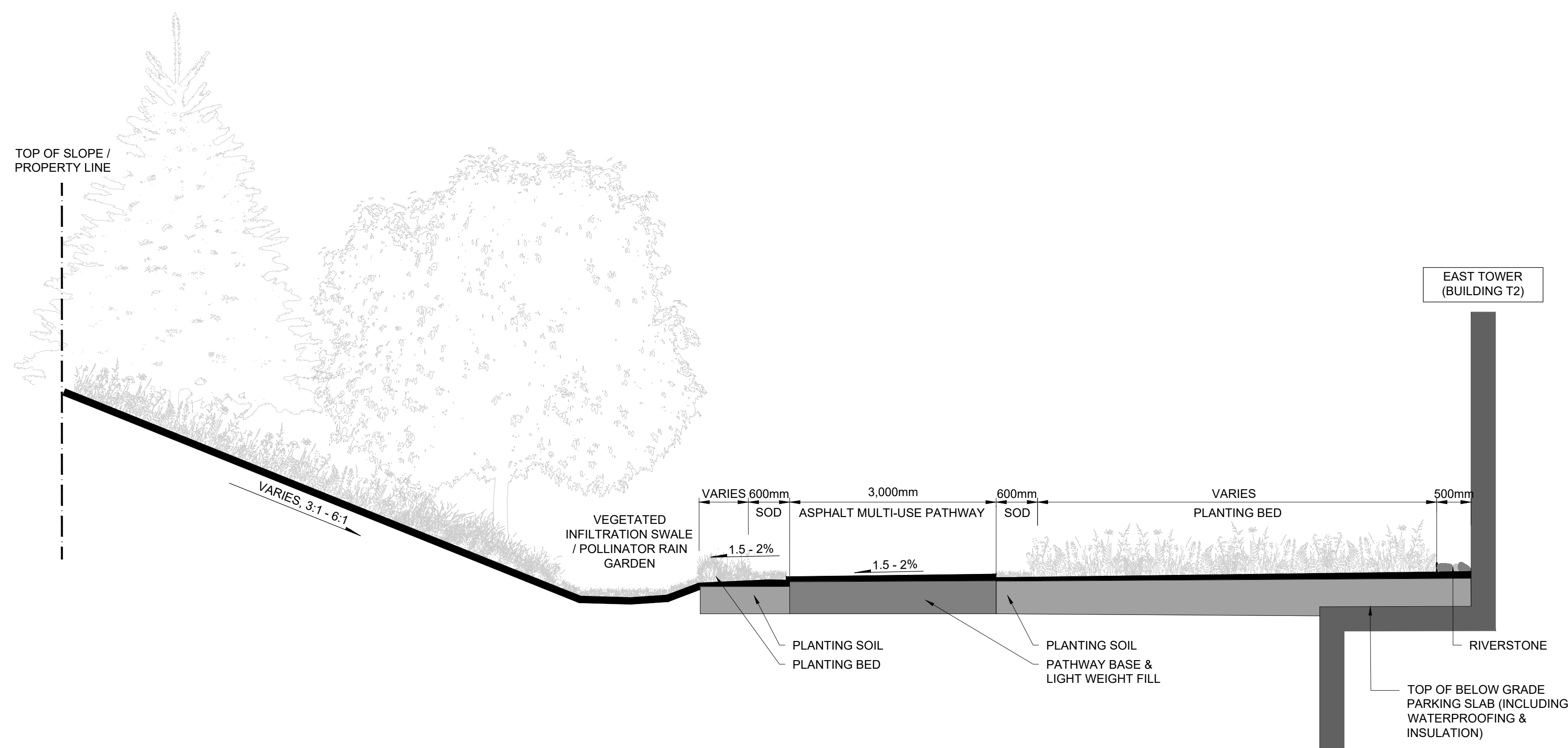

2 SECTION / ELEVATION: EAST TOWER SOUTH EMBANKMENT  
L6 SCALE 1:50

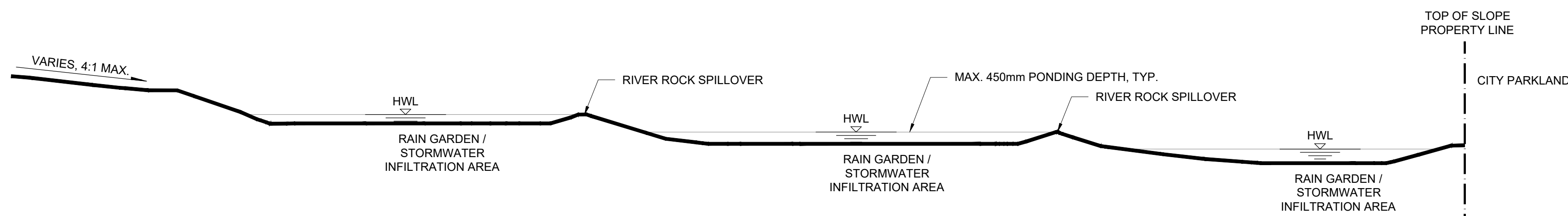

**3 SECTION: PARKWAY HOUSE POLLINATOR RAIN GARDEN (N-S LONGITUDINAL VIEW)**  
**L6 SCALE 1:100**

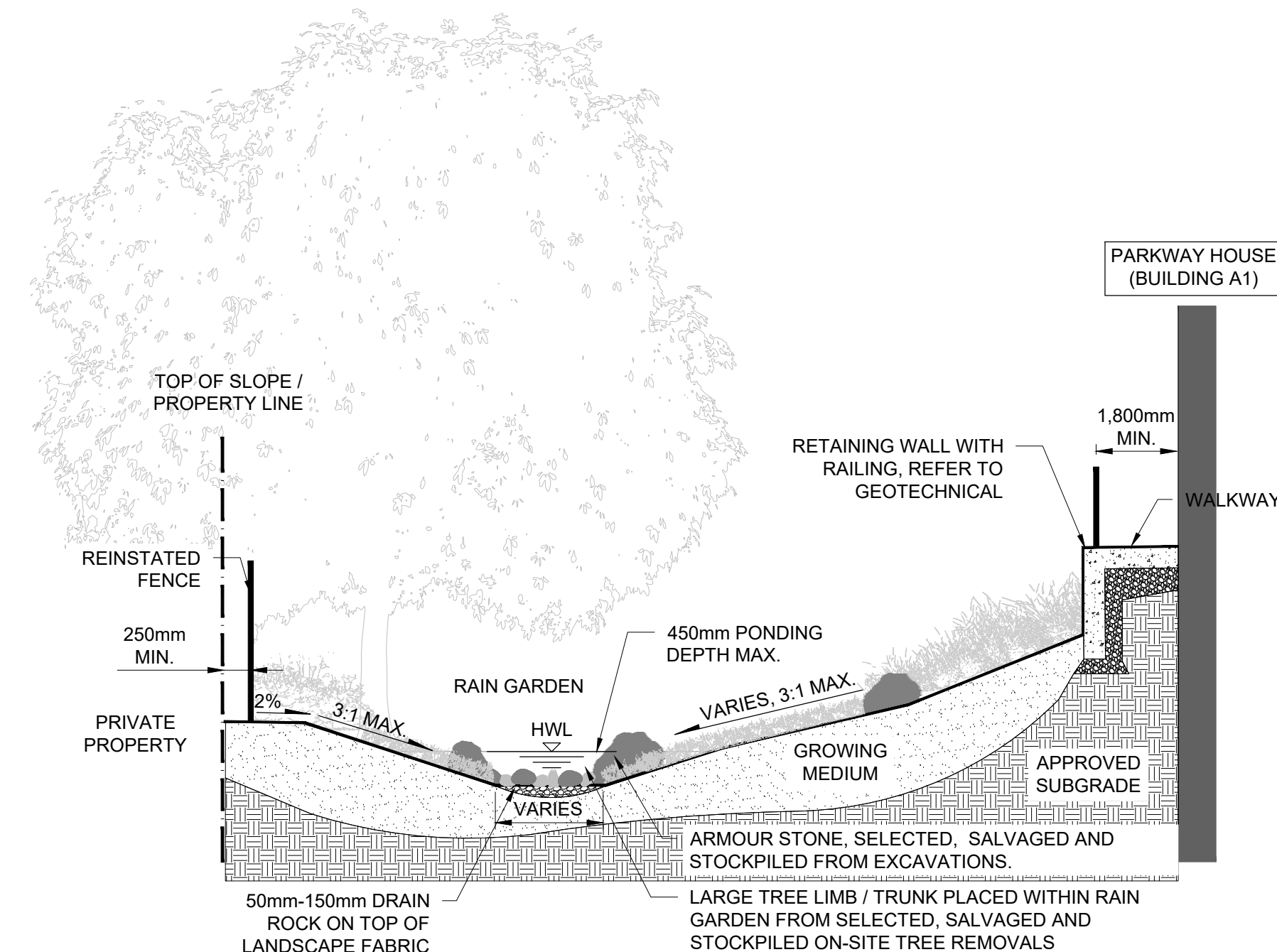

4 SECTION / ELEVATION: PARKWAY HOUSE POLLINATOR RAIN GARDEN  
L6 SCALE 1:50

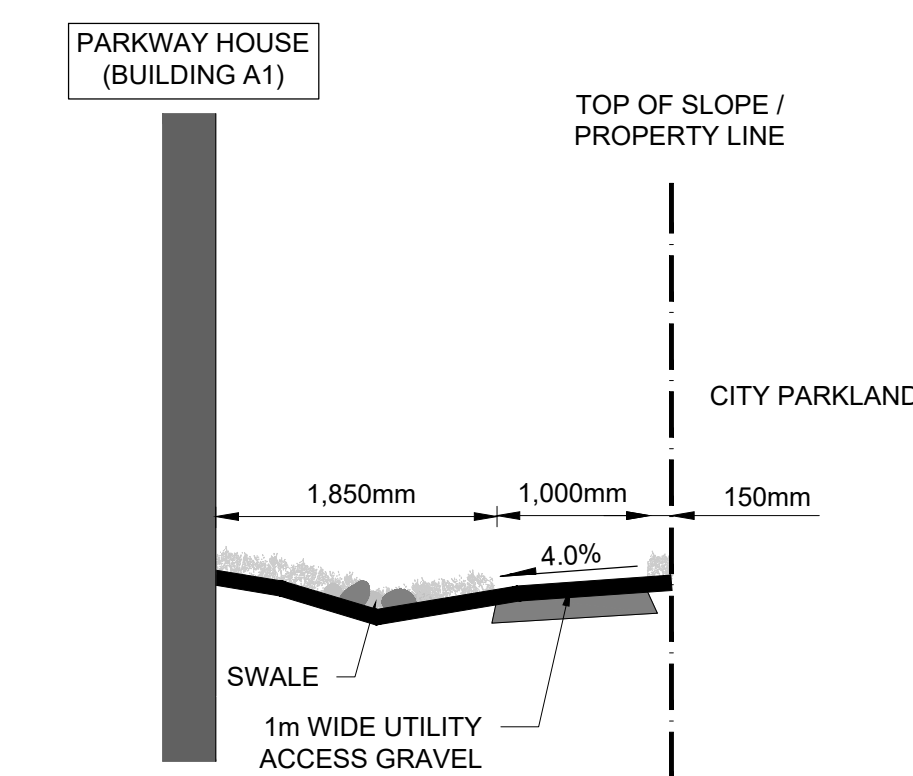

5 SECTION / ELEVATION: A1 REAR UTILITY PATHWAY AND SWALE  
16 SCALE 1:50

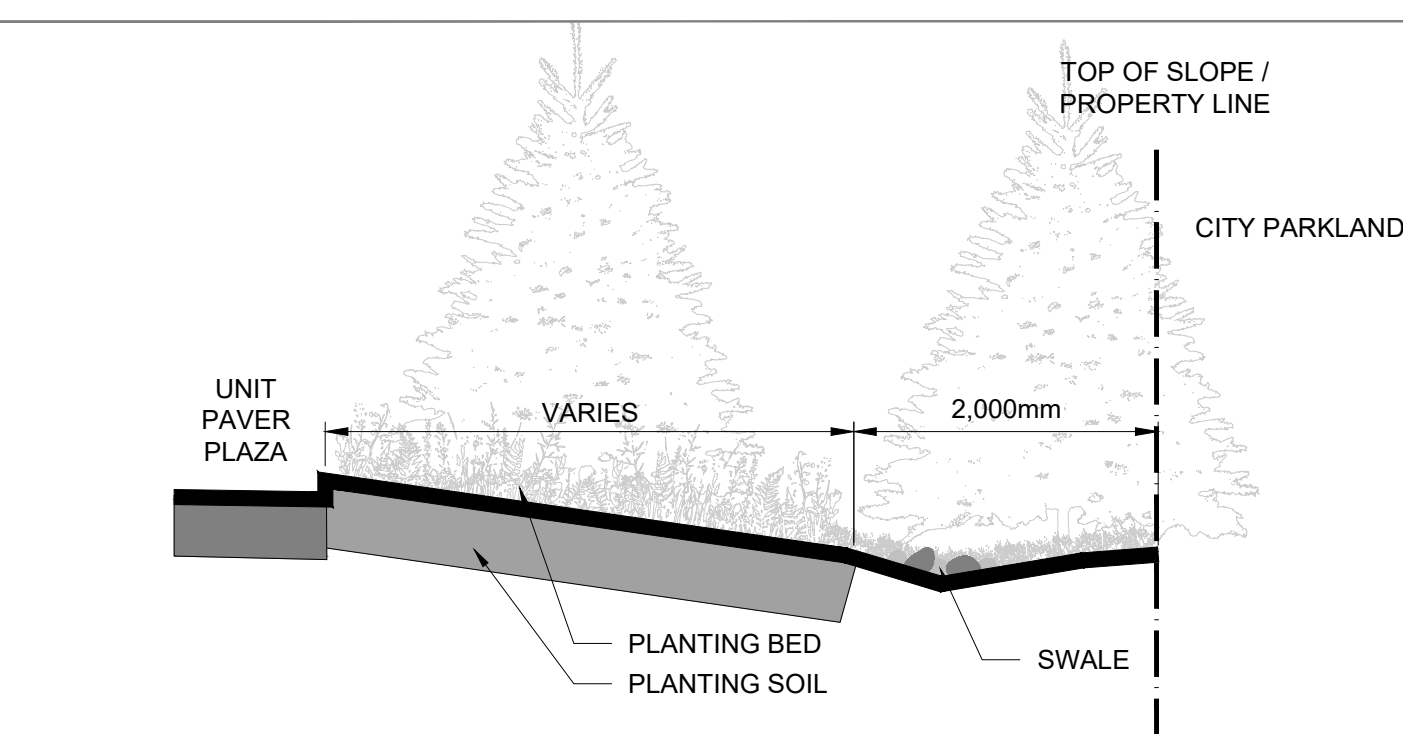

6 SECTION / ELEVATION: NORTH SWALE AND PLANTING BED  
L6 SCALE 1:50

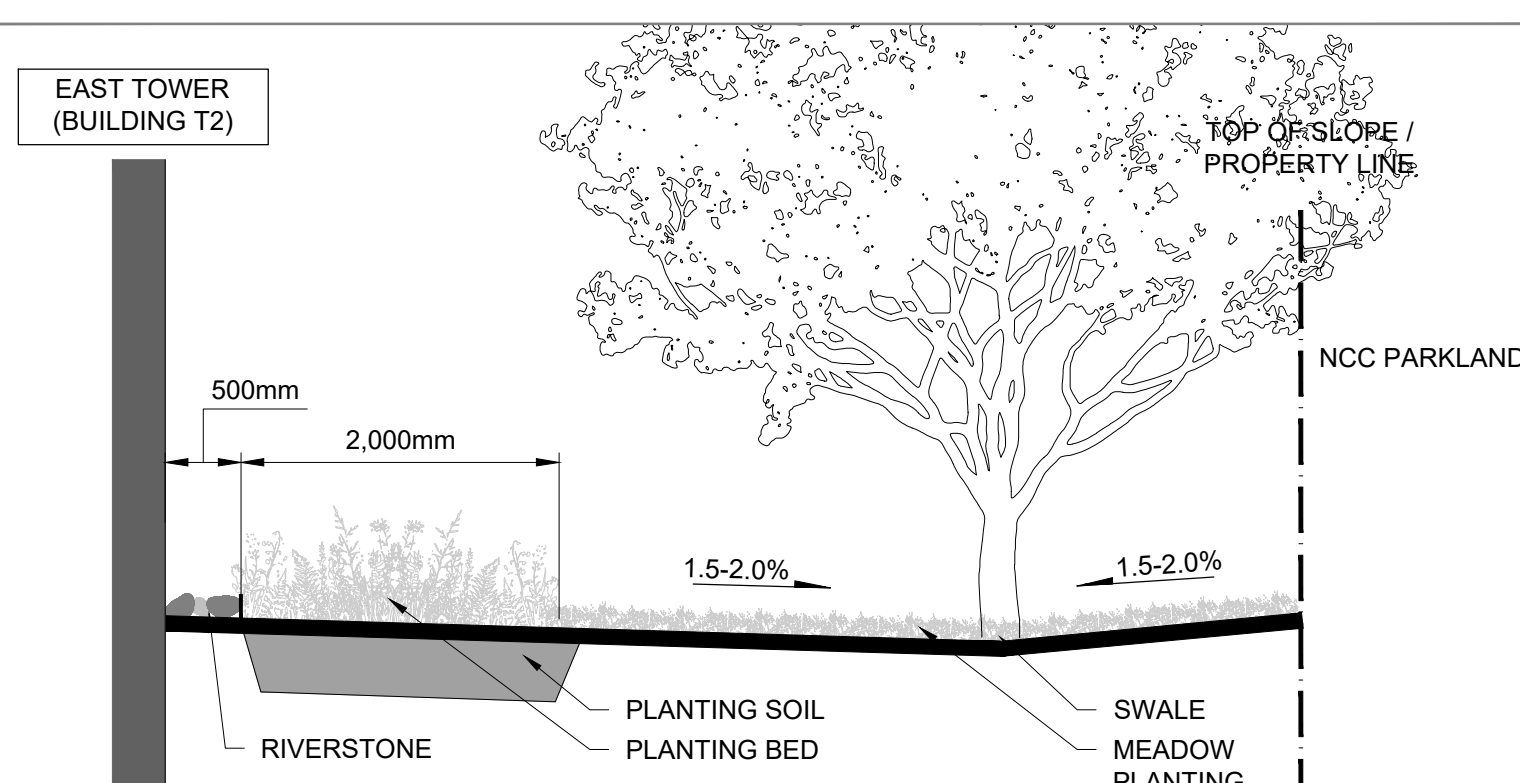

7 SECTION / ELEVATION: EAST TOWER EASTERN EDGE WITH SWALE  
L6 SCALE 1:50





The Contractor shall verify and be responsible for all dimensions. DO NOT scale the drawing - any errors or omissions shall be reported to Stantec without delay.

The Copyrights to all designs and drawings are the property of Stantec. Reproduction or use for any purpose other than that authorized by Stantec is forbidden.

### Legend

## Notes

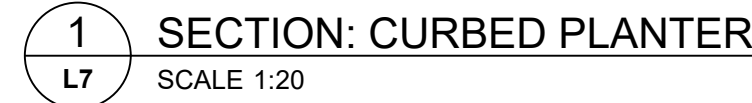

File Name: 160410375-L200	BL	KP / IL	KP / BL	23.11.22
	Dwn.	Chkd.	Dsgn.	YY.MM.DD

WINDMILL DEVELOPMENT GROUP LTD.

Ottawa, ON

Title

LANDSCAPE SECTIONS /  
ELEVATIONS - II

L7 7 of 9

2  
NUMBER: 19267







