

FILENAME: I:\0400\01 Project - Proposed\2023\06\CCO\CCO-23-1408 CSV_C04 Sheetwater_3405 Updated_DWG\12 - Drawing\CCO-23-1408_Presentation.dwg
LAST SAVED: Thursday, February 20, 2025 LAST SAVED BY: m.naper
LAST PLOTTED: Thursday, February 20, 2025 CTR FILE USED: —

WATERMAIN NOTES

- CONSTRUCT ALL WATERMAINS AND APPURTENANCES IN ACCORDANCE WITH OPSD STANDARDS AND SPECIFICATIONS, AS WELL AS CITY STANDARDS.
- WATERMAINS AND/OR WATER SERVICES ARE TO HAVE A MINIMUM COVER OF 2.4m. OTHERWISE THERMAL INSULATION IS REQUIRED AS PER CITY STANDARDS (IF AVAILABLE) OR OPSD 1109.030.
- IF THE WATERMAIN MUST BE DEFLECTED TO MEET ALIGNMENT, ENSURE THAT THE AMOUNT OF DEFLECTION USED IS EQUAL TO OR LESS THAN THAT WHICH IS RECOMMENDED BY THE MANUFACTURER.
- THERMAL INSULATION OF WATERMAINS AT OPEN STRUCTURES AS PER CITY STANDARD W23.
- VALVES TO BE OPERATED BY CITY STAFF ONLY.
- NO CONNECTION TO EXISTING WATER NETWORK SHALL BE COMPLETED UNTIL A WATER PERMIT IS OBTAINED FROM THE CITY. CITY STAFF TO COMPLETE WATERMAIN CONNECTION. CONTRACTOR RESPONSIBLE FOR COORDINATING WATERMAIN CONNECTIONS WITH CITY STAFF. EXCAVATION, BACKFILLING AND REINSTATEMENT TO BE COMPLETED BY CONTRACTOR.
- CONCRETE THRUST BLOCKS TO CONFORM TO OPSD 1109.010 AND OPSD 1103.020.
- ALL WATERMAIN TO BE CLASS 150 DR-18 OR APPROVED EQUIVALENT.
- ALL WATERMAIN TO BE EQUIPPED WITH TRACER WIRE.

NEW 200mmØ VALVE AND BOX CHAMBER PER CITY W3 TO BE INSTALLED WITHIN PROPERTY LINE & DMA CHAMBER PER WDG 4.4.7.2 MINIMUM OF 2.4m SEPARATION BETWEEN EX. CS AND WTM. INSULATE PER CITY STD W23 BETWEEN 0.9-2.4m SEPARATION

OUTLINE OF ROAD CUT AND ASPHALT REINSTATEMENT PER CITY R10 REINSTATEMENT TO EXTEND TO NEAREST LANE LINE.

CONNECT TO EXISTING 305mmØ DI WATERMAIN WITH 300X300X200mm DI TEE.

NEW 305mmØ ISOLATION VALVE VALVE BOX TO BE INSTALLED ALONG MUNICIPAL WATERMAIN C/W CIRCULAR CHAMBER GATE VALVE PER W24

WATERMAIN COVER TABLE

LOCATION	STATION	FINISHED GRADE	TOP OF PIPE	COVER
A - 300 X 200 DI TEE	0+000.00	98.62	96.22	2.40
VALVE	0+007.62	98.76	96.36	2.40
11.25° BEND	0+009.47	98.83	96.43	2.40
CROSSING 6	0+010.52	98.85	96.45	2.40
11.25° BEND	0+021.82	99.18	96.78	2.40
CROSSING 7	0+023.10	99.25	96.85	2.40
CROSSING 8	0+033.05	99.15	96.75	2.40
CROSSING 9	0+035.82	99.03	96.63	2.40
CROSSING 10	0+037.92	99.23	96.83	2.40
VALVE	0+045.75	99.55	97.15	2.40
22.5° BEND	0+122.83	100.20	97.80	2.40
CROSSING 5	0+123.93	100.05	97.15	2.90
CROSSING 4	0+125.37	100.03	96.93	3.10
45° BEND	0+126.82	99.88	97.48	2.40
45° BEND	0+128.90	99.95	97.55	2.40
VALVE	0+130.51	99.84	97.44	2.40
200 X 150 TEE	0+131.18	99.87	97.47	2.40
VALVE	0+131.97	99.85	97.45	2.40
CROSSING 1	0+148.86	99.76	97.36	2.40
CROSSING 3	0+151.13	99.74	97.34	2.40
200 X 150 REDUCER	0+151.86	99.77	97.37	2.40
B - 200 X 150 TEE	1+000.00	99.87	97.47	2.40
VALVE	1+001.66	99.87	97.47	2.40
HYDRANT	1+002.70	99.88	97.48	2.40
C - 200 X 150 TEE	2+000.00	99.69	97.29	2.40
VALVE	2+006.20	99.76	97.36	2.40
BUILDING CONNECTION	2+014.96	99.96	97.56	2.40

CROSSING CONFLICT TABLE

LOCATION	DESCRIPTION	SEPARATION
1	150mmØ SAN SERVICE INV 97.86	0.50
2	200mmØ WTR MAIN TOP 97.86	0.39
3	200mmØ SAN MAIN TOP 97.79	0.50
4	200mmØ STW SERVICE INV 97.84	0.50
5	200mmØ WTR MAIN TOP 97.43	0.50
6	EX 200mmØ SAN SERVICE INV 97.83	0.50
7	EX STORM SERVICE INV 97.65	0.78
8	200mmØ WTR MAIN TOP 97.15	0.90
9	EX STORM SERVICE INV 97.75	0.90
10	200mmØ WTR MAIN TOP 96.65	0.50
11	EX WTR MAIN INV 97.05	0.50
12	EX SAN SERVICE INV 97.13	0.50
13	200mmØ WTR MAIN TOP 96.63	0.50
14	EX STORM SERVICE INV 97.33	0.50
15	200mmØ WTR MAIN TOP 96.83	0.50

GENERAL NOTES

- THE ORIGINAL TOPOGRAPHY, GROUND ELEVATION AND SURVEY DATA SHOWN ARE SUPPLIED FOR INFORMATION PURPOSES ONLY AND IMPLY NO GUARANTEE OF ACCURACY. IT SHALL BE THE RESPONSIBILITY OF THE CONTRACTOR TO VERIFY ALL INFORMATION SHOWN.
- THIS PLAN IS NOT A CADASTRAL SURVEY SHOWING LEGAL PROPERTY BOUNDARIES AND EASEMENTS. THE PROPERTY BOUNDARIES SHOWN HEREON HAVE BEEN DERIVED FROM INFORMATION SUPPLIED BY (OR SHOWN ON) FARLEY, SMITH & DENIS SURVEYING LTD DRAWING #K20-20 AND CANNOT BE RELIED UPON TO BE ACCURATE OR COMPLETE. THE PRECISE LOCATION OF THE CURRENT PROPERTY BOUNDARIES AND EASEMENTS CAN ONLY BE DETERMINED BY AN UP-TO-DATE LAND TITLES SEARCH AND A SUBSEQUENT CADASTRAL SURVEY PERFORMED AND CERTIFIED BY AN ONTARIO LAND SURVEYOR.
- THE CONTRACTOR IS TO OBTAIN AND PAY FOR ALL NECESSARY PERMITS AND APPROVALS FROM THE CITY BEFORE COMMENCING CONSTRUCTION.
- THE CONTRACTOR IS RESPONSIBLE FOR ALL LAI.
- THE CONTRACTOR IS TO DETERMINE THE EXACT LOCATION, SIZE, MATERIAL AND ELEVATION OF ALL EXISTING UTILITIES PRIOR TO COMMENCING CONSTRUCTION. PROTECT AND ASSUME ALL RESPONSIBILITY FOR EXISTING UTILITIES WHETHER OR NOT SHOWN ON THESE DRAWINGS. IF THERE IS ANY DISCREPANCY THE CONTRACTOR IS TO NOTIFY THE ENGINEER PROMPTLY.
- RESTORE ALL TRENCHES AND SURFACES OF PUBLIC ROAD ALLOWANCES TO CONDITION EQUAL OR BETTER THAN ORIGINAL CONDITION AND TO THE SATISFACTION OF THE CITY AUTHORITIES.
- EXCAVATE AND DISPOSE OF ALL EXCESS EXCAVATED MATERIAL, SUCH AS ASPHALT, CURBING AND DEBRIS, OFF SITE AS DIRECTED BY THE ENGINEER AND THE CITY.
- TOPSOIL TO BE STRIPPED AND STOCKPILED FOR REHABILITATION. CLEAN FILL TO BE PLACED IN FILL AREAS AND COMPACTED TO 95% STANDARD PROCTOR DENSITY.
- ALL DISTURBED AREAS TO BE RESTORED TO ORIGINAL CONDITION OR BETTER UNLESS OTHERWISE SPECIFIED.
- THE CONTRACTOR SHALL BE RESPONSIBLE FOR ALL TRAFFIC CONTROL AND SAFETY MEASURES DURING THE CONSTRUCTION PERIOD, INCLUDING THE SUPPLY, INSTALLATION, AND REMOVAL OF ALL NECESSARY SIGNAGE, DELINEATORS, MARKERS AND BARRIERS.
- DO NOT ALTER GRADING OF THE SITE WITHOUT PRIOR APPROVAL OF THE ENGINEER/CITY.
- ALL ROADWAY, PARKING LOT, AND GRADING WORKS TO BE UNDERTAKEN IN ACCORDANCE WITH CITY STANDARDS AND SPECIFICATIONS. THE CONTRACTOR IS TO PROVIDE POSITIVE DRAINAGE AWAY FROM THE BUILDING.
- CONTACT THE CITY FOR INSPECTION OF ROUGH GRADING OF PARKING LOTS, ROADWAYS AND UNDEVELOPED AREAS PRIOR TO PLACEMENT OF ASPHALT AND TOPSOIL. ALL DEFICIENCIES NOTED SHALL BE RECTIFIED TO THE CITY'S SATISFACTION PRIOR TO PLACEMENT OF ANY ASPHALT, TOPSOIL, SEED & MULCH AND/OR SOD.
- ALL DIMENSIONS AND INVERTS MUST BE VERIFIED PRIOR TO CONSTRUCTION. IF THERE IS ANY DISCREPANCY THE CONTRACTOR IS TO NOTIFY THE ENGINEER PROMPTLY.
- ELECTRICAL, GAS, TELEPHONE AND TELEVISION SERVICE LOCATIONS ARE SUBJECT TO THE INDIVIDUAL AGENCY:
 - ELECTRICAL SERVICE - HYDRO ONE.
 - GAS SERVICE - ENBRIDGE.
 - TELEPHONE SERVICE - BELL CANADA.
 - TELEVISION SERVICE - ROGERS.
- INSTALLATION TO BE IN ACCORDANCE WITH CURRENT CODES AND STANDARDS OF APPROVAL AGENCIES HYDRO ONE, BELL AND THE CITY.
- CONTRACTOR TO ENSURE ALL APPLICABLE OPS SPECIFICATIONS ARE FOLLOWED DURING CONSTRUCTION.
- ALL PROPOSED CURB TO BE CONCRETE CURB BARRIER CURB UNLESS OTHERWISE SPECIFIED.
- THIS PLAN MUST BE READ IN CONJUNCTION WITH THE GEOTECHNICAL INVESTIGATION COMPLETED BY PATERSON GROUP, DATED OCTOBER 19, 2020.

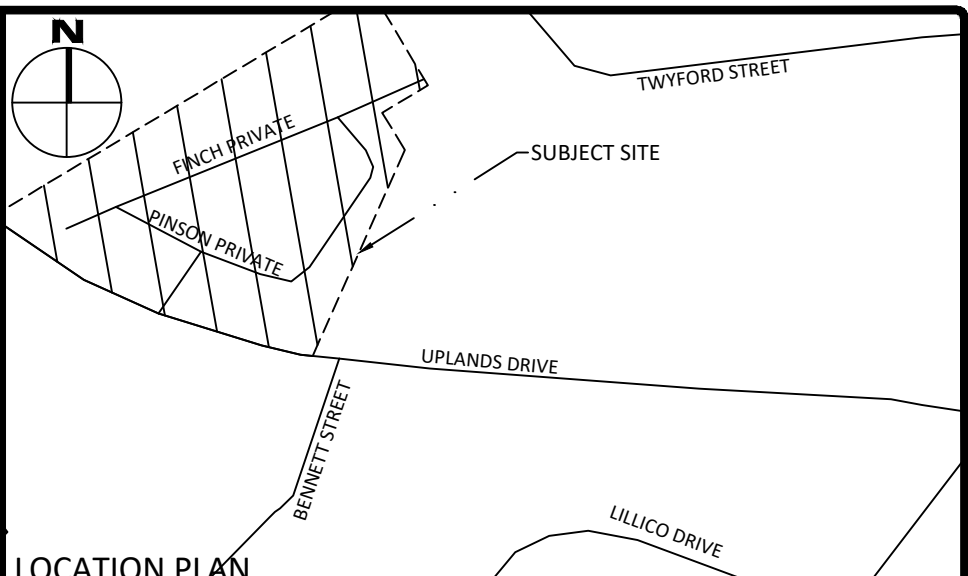
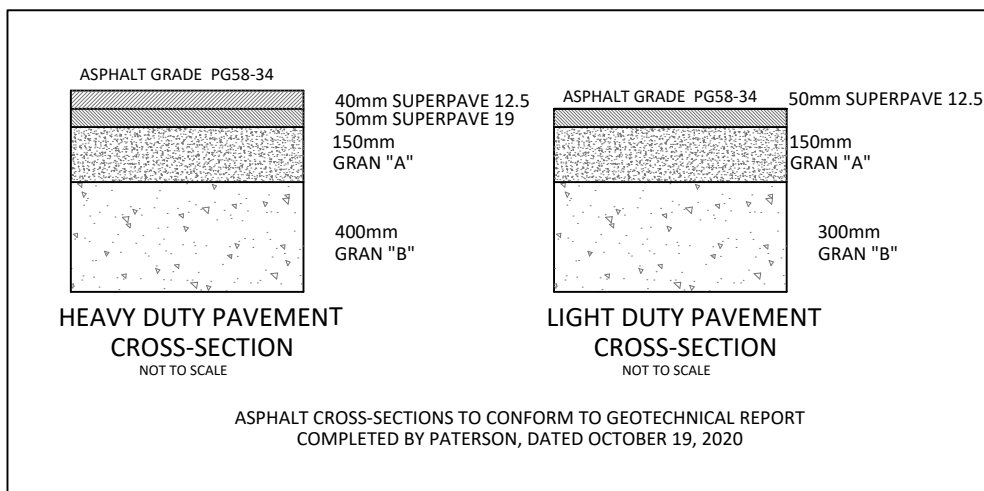

LEGEND	
CONCRETE BARRIER CURB	LIMIT OF CONSTRUCTION
CONCRETE WALKWAY	DRAINAGE SWALE
PROPOSED ASPHALT	DRAINAGE DITCH
LANDSCAPING CATCHBASIN	SLOPING AT 3:1 UNLESS SPECIFIED
CATCHBASIN MANHOLE	95.50 SURFACE ELEVATION
CATCHBASIN	95.50 SWALE ELEVATION
MH/A T/G	95.50 TOP OF WALL ELEVATION
SANITARY SEWER MANHOLE	94.25 BOTTOM OF WALL ELEVATION
FIRE HYDRANT	OVERLAND FLOW ROUTE
WATER VALVE	SILT FENCE BARRIER
WATER METER	PROTECT CB PER DETAIL
REMOTE WATER METER	MUD MAT
LIGHT DUTY PAVEMENT	PROPOSED WATERMAIN
HEAVY DUTY PAVEMENT	PAVERS
EXISTING HYDRO (APPROXIMATE)	EXISTING BELL LINE (APPROXIMATE)
PROPOSED SERVICES	

No.	Revisions	Date
6	REVISED PER CITY COMMENTS	FEB. 21, 2025
5	ISSUED FOR TENDER	DEC. 10, 2024
4	UPDATED PER CITY COMMENTS	MAR. 25, 2024
3	ISSUED FOR PERMIT	FEB. 15, 2024
2	ISSUED FOR SITE PLAN CONTROL RESUBMISSION	OCT. 05, 2023
1	ISSUED FOR REVIEW	MAY 12, 2023

Check and verify all dimensions before proceeding with the work Do not scale drawings

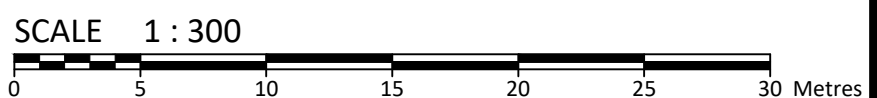

McINTOSH PERRY

115 Walgreen Road, RR3, Carp, ON K0A 1L0
Tel: 613-836-2184 Fax: 613-836-3742
www.mcintoshperry.com

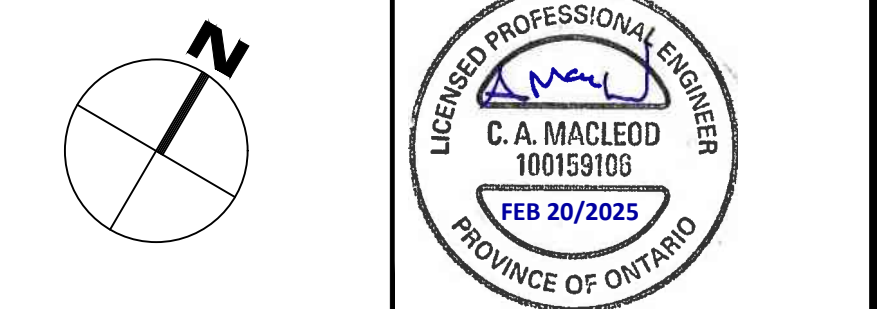

Client: CSV ARCHITECTS
190 O'CONNOR STREET, SUITE 100
OTTAWA, ON K2P 2R3

Project: RESIDENTIAL DEVELOPMENT
1 FINCH PRIVATE

Drawing Title: WATERMAIN EXTENSION PLAN

Scale: 1:300	Project Number: CCO-23-1408
Drawn By: RP	
Checked By: AM	Drawing Number: C102
Designed By: NV	