

PLANT LISTS

KEY	QTY	BOTANICAL NAME	COMMON NAME	TREE HT AT MATURITY	SIZE	COND	SPACING	NATIVE/ NON-NATIVE*
ROW - Deciduous Trees								
ARJ	4	Acer rubrum 'Autumn Radiance'	Autumn Radiance Red Maple	14m	50mm Cal	WB	As Shown	Native
UPE	4	Ulmus propinqua 'JFS-Bieberich'	Emerald Sunshine Elm	11m	50mm Cal	WB	As Shown	Native
Deciduous Trees (Medium)								
AFJ	2	Acer x freemanii 'Jeffersred'	Autumn Blaze Maple	15m	50mm Cal	WB	As Shown	Native
ARJ	2	Acer rubrum 'Autumn Radiance'	Autumn Radiance Red Maple	14m	50mm Cal	WB	As Shown	Native
GTI	2	Gleditsia triacanthos var. 'Inermis 'Impolce'	Imperial Honeylocust	12m	50mm Cal	WB	As Shown	Native
UNH	4	Ulmus japonica x pumila 'New Horizon'	New Horizon Elm	13m	50mm Cal	WB	As Shown	Native
Deciduous Trees (Small)								
ALS	3	Amelanchier laevis 'Spring Flurry'	Spring Flurry Serviceberry	8.5m	50mm Cal	WB	As Shown	Native
AXA	6	Amelanchier x grandiflora 'Autumn Brilliance'	Autumn Brilliance Serviceberry	7.5m	50mm Cal	WB	As Shown	Native
CHD	6	Cercis canadensis 'Heart's Desire™'	Heart's Desire™ Redbud	9m	150cm HT	WB	As Shown	Native
Coniferous Trees								
TO	3	Thuja occidentalis	Eastern White Cedar	12m	200cm HT	WB	As Shown	Native

Proposed Planting: Ownership	Total
Private	29
City-Owned (ROW)	8

KEY	QTY	BOTANICAL NAME	COMMON NAME	SIZE	COND	SPACING	NATIVE/ NON-NATIVE*
Coniferous Shrubs							
Ton	5	Taxus cuspidata 'Nana'	Dwarf Japanese Yew	50cm Spr	PT	As Shown	Non-Native
Jcs	25	Juniperus chinensis 'Spartan'	Spartan Juniper	7g	PT	As Shown	Non-Native
Jcs	65	Juniperus horizontalis 'Plumosa Compacta'	Compact Andorra Juniper	40cm Spr	PT	As Shown	Non-Native
Txb	11	Taxus media 'Hicksii'	Hicks Yew	100cm BB	PT	As Shown	Non-Native
Deciduous Shrubs							
Am	2	Aronia melanocarpa	Black Chokeberry	60cm Ht	PT	As Shown	Native
Ang	28	Aronia melanocarpa Ground Hug	Ground Hug Aronia	1g	PT	As Shown	Native
Axl	38	Aronia x Low Scape Mound (LUCONNAM165)	Low Scape Mound Chokeberry	40cm Ht	PT	As Shown	Native
Csk	6	Cornus sericea 'Kelsays'	Kelsay Dogwood	40cm Ht	PT	As Shown	Native
Def	26	Diervilla splendens 'Firefly Nightglow'	Firefly Nightglow Bush Honeysuckle (B Madrigal)	60cm Ht	PT	As Shown	Native
Hbq	3	Hydrangea paniculata 'Quick Fire'	Quick Fire Hydrangea	60cm Ht	PT	As Shown	Non-Native
Pa	4	Physocarpus opulifolius 'JEFAM'	Amur Jubilee Ninebark	60cm Ht	PT	As Shown	Native
Ra	1	Rhus aromatica	Fragrant Sumac	60cm Ht	PT	As Shown	Native
Vd	2	Viburnum dentatum	Arrowwood Viburnum	60cm Ht	PT	As Shown	Native
Vj	2	Viburnum x juddii	Juddi Viburnum	60cm Ht	PT	As Shown	Non-Native
Perennials							
apd	67	Aster novae-angliae 'Purple Dome'	Purple Dome New England Aster	1g	plug	As Shown	Native
echp	23	Echinacea purpurea 'Powwow Wild Berry'	Wild Berry Coneflower	1g	PT	60cm O.C	Native
gm	251	Geranium maculatum	Spotted Cranebill	1g	PT	60cm O.C	Native
hta	98	Hosia 'August Moon'	August Moon Hosta	1g	PT	As Shown	Non-Native
nwl	18	Nepeta faassensis 'Walker's Low'	Walker's Low Catmint	1g	PT	70cm O.C	Non-Native
pbd	147	Perovskia barbatula 'Prairie Dusk'	Prairie Dusk Beard Tongue	1g	PT	60cm O.C	Non-Native
prb	169	Physocarpus opulifolius 'May Breeze'	Woodland Physocarpus	1g	PT	60cm O.C	Non-Native
rv	75	Monarda virginica	Virginia bluebells	1g	PT	60cm O.C	Native
tsr	139	Thymus serpyllum 'Coccineus'	Red Creeping Thyme	1g	PT	60cm O.C	Non-Native
Ornamental Grasses / Ferns							
cxpl	45	Carex plantaginacea	Plantain-Leaved Sedge	1g	PT	As Shown	Native
cxv	75	Carex pensylvanica	Pennsylvania Sedge	1g	PT	60cm O.C	Native
fms	15	Mattucia struthiopteris	Ostrich Fern	1g	PT	100cm O.C	Native
proa	107	Panicum virgatum 'Chayenne Sky'	Chayenne Sky Sw itch Grass	1g	PT	70cm O.C	Native
pvn	88	Panicum virgatum 'Northwind'	Northwind Sw itch Grass	1g	PT	70cm O.C	Native
sh	95	Sporobolus heterolepis	Prairie Dropseed	1g	PT	60cm O.C	Native
sso	67	Schizachyrium scoparium 'Standing Ovation'	Standing Ovation Little Blue Stem	1g	PT	50cm O.C	Native

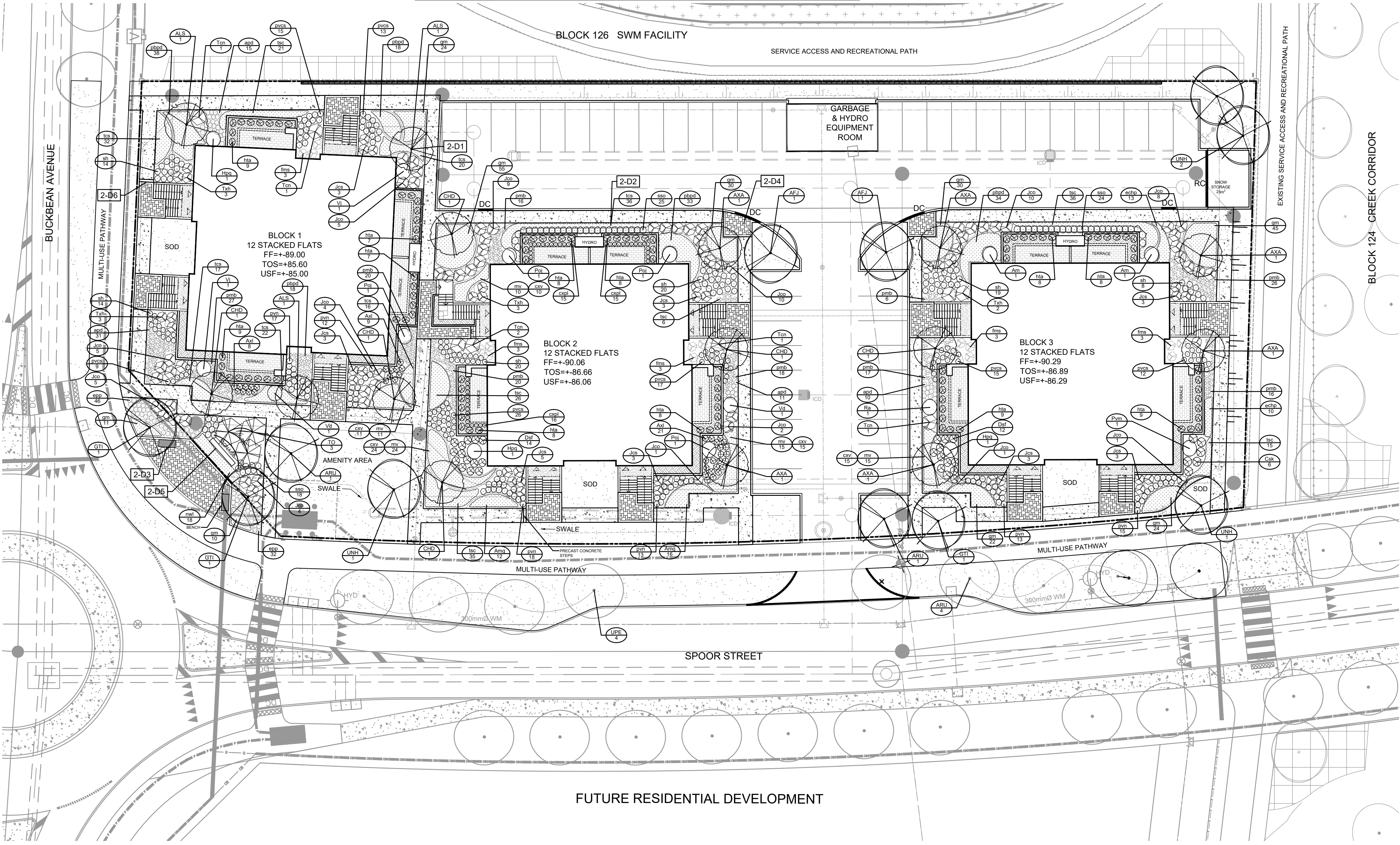

NOTE: THE POSITION OF ALL POLE LINES, CONDUITS, WATERMAINS, SEWERS AND OTHER UNDERGROUND AND OVERGROUND UTILITIES AND STRUCTURES IS NOT NECESSARILY SHOWN ON THE CONTRACT DRAWINGS, AND WHERE SHOWN, THE ACCURACY OF THE POSITION OF SUCH UTILITIES AND STRUCTURES IS NOT GUARANTEED. BEFORE STARTING WORK, DETERMINE THE EXACT LOCATION OF ALL SUCH UTILITIES AND STRUCTURES AND ASSUME ALL LIABILITY FOR DAMAGE TO THEM.

Owner:
Uniform Developments
117 Canterbury Drive, #300
Nepean, ON K2G 5X3
Phone: 613.225.0770

Engineer:
Novatech Engineers, Planners
& Landscape Architects
240 Michael Cowpland Drive,
Ottawa, ON, K2M 1P6
Phone: 613.254.9643

Architect:
Hobin Architecture INC.
63 Pamela Street,
Ottawa, ON K1S 3K7
Phone: 613.236.7200

Surveyor:
Annis, O'Sullivan, Vollebek Ltd.
14 Concourse Gate, Suite 500
Nepean, ON K2E 7S6
Phone: 613.727.0850

DISCLAIMER:
The elements on this plan illustrate the design intent and general constructability of the proposed landscape which will support the associated development. This is to demonstrate how the canopy cover, urban design, health, and climate change objectives of the Official Plan will be met through tree planting and site design. This drawing is for City review only and is not intended for construction. Final detailed design and construction documentation is to be provided with certified 'Issued for Construction' drawings and specifications prior to construction.

No.	REVISION	DATE	BY
2.	REVISED PER COMPLETENESS REVIEW COMMENTS	MAY 09/25	SC
1.	ISSUED FOR SITE PLAN APPLICATION	MAR 21/25	SC

SCALE	DESIGN
1:250	SC
1:250	SC
1:250	TB
1:250	SC
1:250	SC

FOR REVIEW ONLY
SC
SC
TB
SC
SC

NOVATECH
Engineers, Planners & Landscape Architects
Suite 200, 240 Michael Cowpland Drive
Ottawa, Ontario, Canada K2M 1P6
Telephone (613) 254-9643
Facsimile (613) 254-5867
Website www.novatech-eng.com

LOCATION COPPERWOOD FLATS, 1101 SPOOR ST, KANATA STACKED APARTMENTS - BLOCK 125	PROJECT No. 122144
DRAWING NAME LANDSCAPE PLAN	REV REV # 2
DRAWING No. 122144-125-L1	

CITY DETAILS

Related details from City of Ottawa Standard Tender Documents
Volume No. 2 Standard Detail Drawings.

- SC4. Typical Concrete Sidewalk in Boulevard
- SC5. Sidewalk Construction Joints
- SC7.1 Curb Return Entrances - With Boulevard

NOVATECH DETAILS

Found on Sheet L2.

- D1. Standard Deciduous Tree Planting
- D2. Shrub and Perennial Planting
- D3. Bench on Concrete Pavers
- D4. Pavers On Granular Base
- D5. Signage Detail
- D6. Precast Concrete Steps

TREE PLANTING IN SENSITIVE CLAY

- The landscape plans have been developed in accordance with the Geotechnical Report PG6613-1 Rev 2, dated February 7, 2025, which includes the Test Hole Locations Plan, dated April, 2023 that confirms the categories and locations of clay soils.
- In this case tree planting is restricted by low/medium sensitivity clay soils.
- The following City of Ottawa clay soils guideline applies: Guidelines for Tree Planting in Sensitive Marine Clay Soils (2017).
- The soil volumes provided are sufficient for a reasonable chance of tree survival. Unless otherwise noted, all new trees on City property meet the minimum soil volume requirements of the following, based on a depth of 1.5m below finished grade, and subtracting the volume of utility trenches.
 - a. Small tree (mature height up to 7.5m) - 25m³/ minimum soil volume provided.
 - b. Medium tree (mature height 7.5-14m) - 30m³/ minimum soil volume provided.

Where trees share a continuous greenspace:

- c. Two (2) small trees - 15m³/ minimum soil volume provided per tree.
- d. Two (2) medium trees - 18m³/ minimum soil volume provided per tree.

LEGEND

3-D1	DETAIL SHEET # EG. L1, L2, ETC.	NOVATECH OR CITY FOR CODE
---	PROPERTY LIMIT	
[Pattern]	PROPOSED CONCRETE	
[Pattern]	OFF-SITE CONCRETE	
[Pattern]	PROPOSED PAVERS	
[Pattern]	RIVER STONE	
[Pattern]	SOD	
[Symbol]	PROPOSED DECIDUOUS TREE	
[Symbol]	PROPOSED CONIFEROUS TREE	
[Symbol]	PROPOSED PERENNIALS / ORNAMENTAL GRASSES / FERNS	
[Symbol]	PROPOSED SHRUBS	
[Symbol]	TREES AROUND THE SITE (BY OTHERS)	
[Pattern]	BARK CHIPS (SEE SITE PLAN)	
[Symbol]	1.07M TRANSLUCENT GUARD (SEE SITE PLAN)	
[Symbol]	CHAINLINK FENCE 1.5m HT (BY OTHERS)	
[Symbol]	RAILING ON THE RETAINING WALL, REFER TO CIVIL	
[Symbol]	RETAINING WALL REFER TO CIVIL	
[Symbol]	SPECIES (SEE PLANT LIST)	
[Symbol]	QUANTITY	
[Symbol]	PROPOSED BENCHES	

GENERAL

- Read and interpret this drawing/ drawing set in conjunction with all the contract details and specifications, including related civil, utility, structural, architectural, mechanical, electrical, environmental, geotechnical, and survey information.
- The Contractor is to determine the exact location, size, material, and elevation of all existing utilities prior to commencing construction. Protect and assume responsibility for all existing utilities regardless of being shown on the drawings.
- It is essential to use the plans and details in conjunction with the specifications and notes.
- Do not scale drawings. Work to dimensions only.
- Protect all existing and retained vegetation for the duration of construction according to the contract details and specifications.
- Reinstate all areas and items damaged or disturbed, beyond the Limit of Work, because of construction activities, including but not limited to construction staging areas, haul roads, stockpile areas, etc. to the satisfaction of the Consultant. Unless otherwise noted, Contractor is to reinstate all areas to pre-construction condition or better to the satisfaction of the Contract Administrator.

PLANTING

- Plant material to be No. 1 Grade and is to comply with Canadian Standards for Nursery Stock (latest edition) published by the Canadian Nursery Landscape Association.
- Use structurally sound plant material with strong fibrous root system free of disease, defects, and injuries. Use trees with straight trunks, well and characteristically branched for species. Obtain approval from consultant of plant material at source prior to digging. All trees and shrubs to be container grown, potted, WB or B/B, as indicated on Plant List. Bare root plants are only acceptable for certain species and as approved by the Landscape Architect.
- Plant material substitutions are not to be permitted without the written approval from the Consultant, with 48 hours notice, prior to shipping plant material.
- Plant locations are schematic / approximate only. Contractor is to stake out locations on site for approval by the Landscape Architect prior to installation.
- The illustrated number of plants shown in the Planting Plan supersedes the estimated number in the Plant List. Contractor to report any discrepancies to the Landscape Architect prior to installation. Contractor will assume full responsibility if the Landscape Architect is not notified.
- Ensure trees are thoroughly watered following planting. Monitor material and ensure adequate moisture until acceptance.
- In heavy clay or poorly drained soils, set root ball with root collar 75-100mm higher than finished grade.
- Approved topsoil depths are as follows:
 - a. Plant Beds - 450mm continuous depth. Applies to shrubs, perennials, vines, and groundcovers.
 - b. Sod/ Seed Areas - 100mm depth.
 - c. Reforestation - 300mm depth.
- Sod to be No. 1 Kentucky Bluegrass Sod grown from minimum mixture of 3 Kentucky Bluegrass cultivars. Quality and source are to comply with Canadian Standards for Nursery Stock, Section 17, (latest edition) published by the Canadian Nursery Landscape Nursery Landscape Association.
- Install a 1.2m sod strip adjacent to all hard surfaces. Note, sod is not typically graphically shown on plans.
- Apply the following mineral fertilizer unless soil tests show other requirements:
 - a. Plant Beds - (8-32-16), i.e. 8% Nitrogen, 32% Phosphorus, 16% Potash per manufacturer specifications.
 - b. Sod Areas - (8-32-16), i.e. 8% Nitrogen, 32% Phosphorus, 16% Potash at a rate of 350kg/ha.
- Where applicable, for any plant areas with a mix of species/ cultivars notes, Contractor is to cluster like plants in groups of 3-5 and evenly distribute these in the noted area.

SOURCE REFERENCE:

PLAN OF SUBDIVISION OF PART OF LOTS 13 AND 14 CONCESSION 3 GEOGRAPHIC TOWNSHIP OF MARCH, CITY OF OTTAWA, PREPARED BY ANNIS, O-SULLIVAN, VOLLEBEK LTD. ON FEBRUARY 12, 2025, (PRELIMINARY 4M PLAN)

M:\2025\122144\BLDCK\307\CADD\Landscapes\122144-BLK125-L.dwg, L1, May 15, 2025 - 9:22am, barbale

D07-12-25-0039

PLANT.DWG - 07/05/2025

#0000

PROPOSED AND RETAINED CANOPY COVER ESTIMATE:

PROPOSED CANOPY COVERAGE AT MATURITY				
SIZE OF PROPOSED TREE	AVERAGE MATURE SPREAD	CANOPY COVERAGE PER TREE AT MATURITY (m2)	QUANTITY OF TREES	TOTAL CANOPY COVERAGE
Deciduous trees- Small	4.5m	16	15	240
Deciduous trees- Medium*	10m	79	19	1501
Conifers	5m	20	3	60
TOTAL PROPOSED CANOPY COVERAGE (m2):				1,801
TOTAL SITE AREA (m2):				5,503
EST. PROPOSED CANOPY COVERAGE (%):				33%
1. Area of a circle = (πr^2)				
2. Canopy coverage per tree calculation: (average mature spread/2) x (average mature spread/2) x π				
*3. ROW trees along Spoor Street have also been counted under the medium canopy category.				

SOIL AVAILABILITY CALCULATIONS:

Planting bed no.	Available Soil Area (sq m)	Available Soil Volume* (cu m)	No. of trees proposed			Total No. of trees	Min. required Soil volume total (cu m)
			Small (min. 25m ³ soil for single & 15m ³ for shared)	Medium (min. 30m ³ soil for single & 18m ³ for shared)	Conifers (min. 30m ³ soil for one tree)		
Planting bed 1	87	130		2	3	5	126.00
Planting bed 2	176	265		2		2	36.00
Planting bed 3	109	164	1			1	25.00
Planting bed 4	89	134				NA	0.00
Planting bed 5	25	38				NA	0.00
Planting bed 6	23	35		1		1	30.00
Planting bed 7	101	152	1	2		3	51.00
Planting bed 8	63	95				NA	0.00
Planting bed 9	128	192	2			2	30.00
Planting bed 10	18	27		1		1	30.00
Planting bed 11	18	27		1		1	30.00
Planting bed 12	67	101	2			2	30.00
Planting bed 13	67	101	2			2	30.00
Planting bed 14	130	195	2			2	30.00
Planting bed 15	46	69	1			1	25.00
Planting bed 16	251	377		2		2	36.00
Planting bed 17	65	98	1			1	25.00
Planting bed 18	43	64				NA	0.00
Planting bed 19	72	108	2			2	30.00
Planting bed 20	41	62	1			1	25.00

*Note : For all planting beds proposed, the available soil depth is considered to be 1.5m.

TREE PLANTING IN SENSITIVE CLAY

- The landscape plans have been developed in accordance with the Geotechnical Report PG6613-1 Rev 2, dated February 7, 2025, which includes the Test Hole Locations Plan, dated April, 2023 that confirms the categories and locations of clay soils.
 - In this case tree planting is restricted by low/medium sensitivity clay soils.
 - The following City of Ottawa clay soils guideline applies: Guidelines for Tree Planting in Sensitive Marine Clay Soils (2017).
 - The soil volumes provided are sufficient for a reasonable chance of tree survival. Unless otherwise noted, all new trees on City property meet the minimum soil volume requirements of the following, based on a depth of 1.5m below finished grade, and subtracting the volume of utility trenches.
 - Small tree (mature height up to 7.5m) - 25m³/ minimum soil volume provided.
 - Medium tree (mature height 7.5-14m) - 30m³/ minimum soil volume provided.
- Where trees share a continuous greenspace:
- Two (2) small trees - 15m³/ minimum soil volume provided per tree.
 - Two (2) medium trees - 18m³/ minimum soil volume provided per tree.

LEGEND

- PROPERTY LIMIT
- PROPOSED CONCRETE
- OFF-SITE CONCRETE
- PROPOSED PAVERS
- PROPOSED DECIDUOUS TREE
- PROPOSED CONIFEROUS TREE
- CANOPY COVER AREA OF PROPOSED TREES AT MATURITY
- PLANTING BED SOIL
- TREES AROUND THE SITE (BY OTHERS)
- RETAINING WALL REFER TO GR
- SPECIES (SEE PLANT LIST)
- QUANTITY

GENERAL

- Read and interpret this drawing/ drawing set in conjunction with all the contract details and specifications, including related civil, utility, structural, architectural, mechanical, electrical, environmental, geotechnical, and survey information.
- The Contractor is to determine the exact location, size, material, and elevation of all existing utilities prior to commencing construction. Protect and assume responsibility for all existing utilities regardless of being shown on the drawings.
- It is essential to use the plans and details in conjunction with the specifications and notes.
- Do not scale drawings. Work to dimensions only.
- Protect all existing and retained vegetation for the duration of construction according to the contract details and specifications.
- Reinstate all areas and items damaged or disturbed, beyond the Limit of Work, because of construction activities, including but not limited to construction staging areas, haul roads, stockpile areas, etc. to the satisfaction of the Consultant. Unless otherwise noted, Contractor is to reinstate all areas to pre-construction condition or better to the satisfaction of the Contract Administrator.

PLANTING

- Plant material to be No. 1 Grade and is to comply with Canadian Standards for Nursery Stock (latest edition) published by the Canadian Nursery Landscape Association.
- Use structurally sound plant material with strong fibrous root system free of disease, defects, and injuries. Use trees with straight trunks, well and characteristically branched for species. Obtain approval from consultant of plant material at source prior to digging. All trees and shrubs to be container grown, potted, W/B or B/B, as indicated on Plant List. Bare root plants are only acceptable for certain species and as approved by the Landscape Architect.
- Plant material substitutions are not permitted without the written approval from the Consultant, with 48 hours notice, prior to shipping plant material.
- Plant locations are schematic / approximate only. Contractor is to stake out locations on site for approval by the Landscape Architect prior to installation.
- The illustrated number of plants shown in the Planting Plan supersedes the estimated number in the Plant List. Contractor to report any discrepancies to the Landscape Architect prior to installation. Contractor will assume full responsibility if the Landscape Architect is not notified.
- Ensure trees are thoroughly watered following planting. Monitor material and ensure adequate moisture until acceptance.
- In heavy clay or poorly drained soils, set root ball with root collar 75-100mm higher than finished grade.
- Approved topsoil depths are as follows:
 - Plant Beds - 450mm continuous depth. Applies to shrubs, perennials, vines, and groundcovers.
 - Sod/ Seed Areas - 100mm depth.
 - Reforestation - 300mm depth.
- Sod to be No. 1 Kentucky Bluegrass Sod grown from minimum mixture of 3 Kentucky Bluegrass cultivars. Quality and source are to comply with Canadian Standards for Nursery Stock, Section 17, (latest edition) published by the Canadian Nursery Landscape Nursery Landscape Association.
- Install a 1.2m sod strip adjacent to all hard surfaces. Note, sod is not typically graphically shown on plans.
- Apply the following mineral fertilizer unless soil tests show other requirements:
 - Plant Beds - (8-32-16), i.e. 8% Nitrogen, 32% Phosphorus, 16% Potash per manufacturer specifications.
 - Sod Areas - (8-32-16), i.e. 8% Nitrogen, 32% Phosphorus, 16% Potash at a rate of 350kg/ha.
- Where applicable, for any plant areas with a mix of species/ cultivars notes, Contractor is to cluster like plants in groups of 3-5 and evenly distribute these in the noted area.

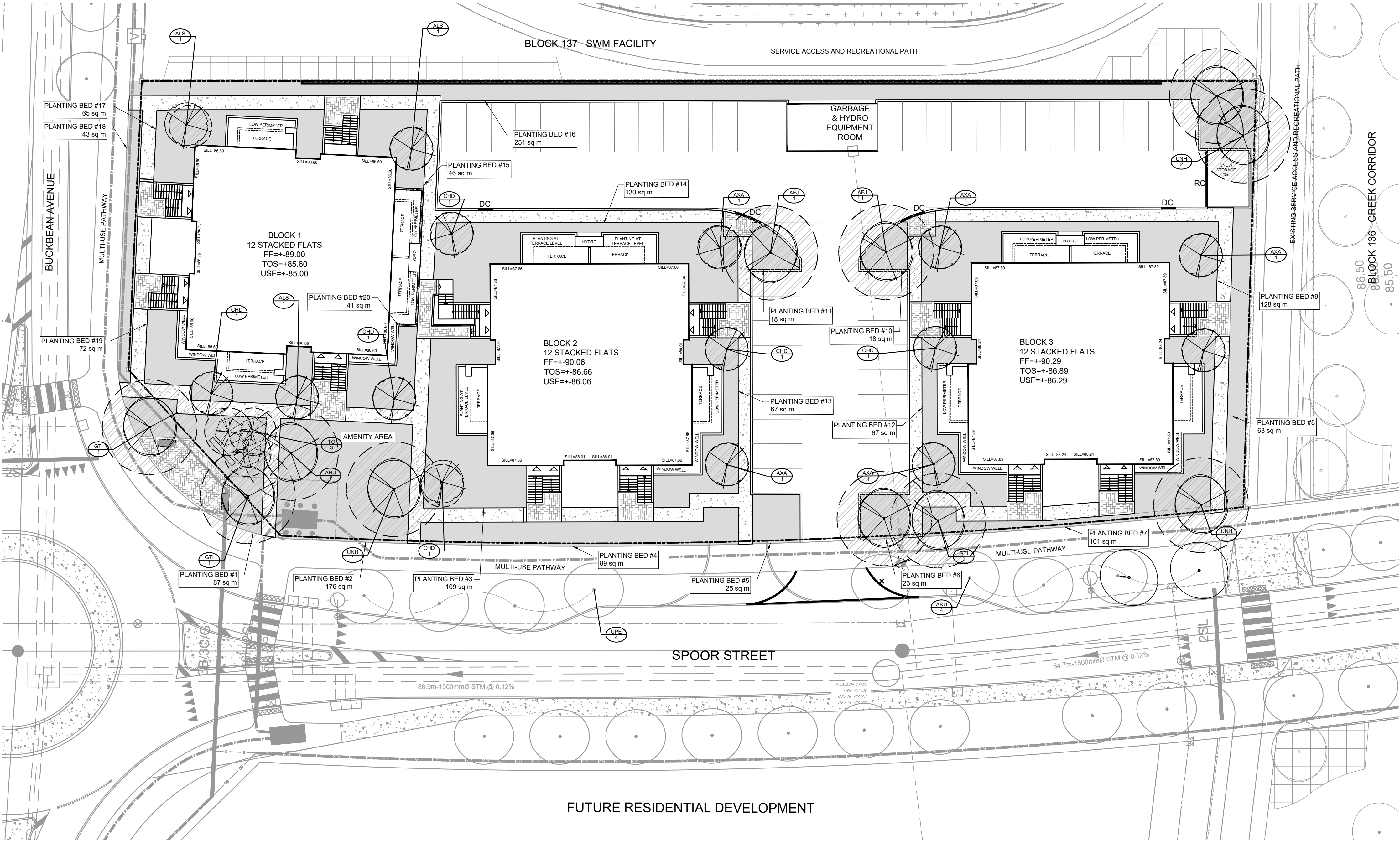

NOTE:
THE POSITION OF ALL POLE LINES, CONDUITS, WATERMANS, SEWERS AND OTHER UNDERGROUND AND OVERGROUND UTILITIES AND STRUCTURES IS NOT NECESSARILY SHOWN ON THE CONTRACT DRAWINGS, AND WHERE SHOWN, THE ACCURACY OF THE POSITION OF SUCH UTILITIES AND STRUCTURES IS NOT GUARANTEED. BEFORE STARTING WORK, DETERMINE THE EXACT LOCATION OF ALL SUCH UTILITIES AND STRUCTURES AND ASSUME ALL LIABILITY FOR DAMAGE TO THEM.

Owner:
Uniform Developments
117 Centipede Drive, #300
Nepean, ON K2G 5X3
Phone: 613.225.0770

Engineer:
Novatech Engineers, Planners
& Landscape Architects
240 Michael Cowpland Drive,
Ottawa, ON, K2M 1P6
Phone: 613.254.9643

Architect:
Hobin Architecture INC.
Ottawa, ON K1S 3K7
Phone: 613.236.7200

Surveyor:
Annis, O'Sullivan, Vollebakk Ltd.
14 Concourse Gate, Suite 500
Nepean, ON K2E 7S6
Phone: 613.727.0850

DISCLAIMER:
The elements on this plan illustrate the design intent and general constructability of the proposed landscape which will support the associated development. This is to demonstrate how the canopy cover, urban design, health, and climate change objectives of the Official Plan will be met through tree planting and site design. This drawing is for City review only and is not intended for construction. Final detailed design and construction documentation is to be provided with certified 'Issued for Construction' drawings and specifications prior to construction.

No.	REVISION	DATE	BY
2.	REVISED PER COMPLETENESS REVIEW COMMENTS	MAY 09/25	SC
1.	ISSUED FOR SITE PLAN APPLICATION	MAR 21/25	SC

SCALE
1:250
0 2 4 6 8 10

DESIGN
SC
SC
TB
SC
SC

FOR REVIEW ONLY



NOVATECH
Engineers, Planners & Landscape Architects
Suite 200, 240 Michael Cowpland Drive
Ottawa, Ontario, Canada K2M 1P6

Telephone (613) 254-9643
Facsimile (613) 254-5867
Website www.novatech-eng.com

LOCATION COPPERWOOD FLATS, 1101 SPOOR ST, KANATA STACKED APARTMENTS - BLOCK 125	
DRAWING NAME CANOPY COVER AND SOIL PLAN	
PROJECT No. 122144	REV # 2
DRAWING No. 122144-125-L3	

M:\2025\122144\BLOCK 307\CAD\Landscape\122144-BLK125-L.dwg, L3, May 15, 2025 - 9:22am, barale

PLANT.DWG

#00000

D07-12-25-0039