

PROPOSED PLANT LIST

QTY.
KEY

KEY	QTY.	BOTANICAL NAME	COMMON NAME	SIZE	CONDITION	REMARKS	NATIVE SPECIES
TREES							
BW	3	Tilia americana	Basswood	50mm cal.	B&B		YES
FM	4	Acer x freemanii	Freeman's Maple	50mm cal.	B&B		YES
HB	2	Celtis occidentalis	Hackberry	50mm cal.	B&B		YES
RM	5	Acer rubrum	Red Maple	50mm cal.	B&B		YES
SI	2	Acer saccharinum	Silver Maple	50mm cal.	B&B		YES

SHRUBS

DW	28	Cornus sericea	Red Osier Dogwood	800mm ht.	Potted		YES
----	----	----------------	-------------------	-----------	--------	--	-----

NOTE: ALL TREES ARE PROPOSED ON PRIVATE PROPERTY

PROPOSED TREE COMPENSATION AREA PLANT LIST

QTY	BOTANICAL NAME	COMMON NAME	SIZE	CONDITION	SPACING
DECIDUOUS TREES					
85	Acer rubrum	Red Maple	35mm cal.	Potted	5m o.c. random layout
85	Betula papyrifera	White Birch	35mm cal.	Potted	5m o.c. random layout
84	Populus balsamifera	Balsam Poplar	35mm cal.	Potted	5m o.c. random layout
84	Populus tremuloides	Trembling Aspen	35mm cal.	Potted	5m o.c. random layout
CONIFEROUS TREES					
85	Picea glauca	White Spruce	1.0m HT.	Potted	5m o.c. random layout
85	Thuja occidentalis	Eastern White Cedar	1.0m HT.	Potted	5m o.c. random layout

APPROVED

By Adam Brown at 11:47 am, May 12, 2025

ADAM BROWN
MANAGER, DEVELOPMENT REVIEW - RURAL
PLANNING, REAL ESTATE & ECONOMIC DEVELOPMENT
DEPARTMENT, CITY OF OTTAWA

CLIENT

AVENUE 31 CAPITAL INC.
801-365 CITY CENTER OTTAWA, ON K1R 6K7
Tel: 833-283-3131

CONSULTANTS

ARCHITECTS:

MICROBIE
ARCHITECTS + INTERIOR DESIGNERS
SUITE 100, 86 QUEEN STREET, OTTAWA, ON K1P 5G6
Tel: (613) 238-2072CIVIL
ENGINEERS:LRL ENGINEERING
440 KENNEDY ROAD OTTAWA, ON K1J 9G2
Tel: (613) 842-5434

LEGEND

- PROPERTY LINE
- PROPOSED TREE COMPENSATION AREA #7 OF TCR
- PROPOSED TREE COMPENSATION AREA TO BE SEED FOR EROSION PROTECTION
- PROPOSED TREE COMPENSATION AREA TO BE MULCHED
- EXISTING VEGETATION TO REMAIN
- STORMWATER RETENTION POND (REFER TO CIVIL)
- PROPOSED SEED GRASS AREA
- PROPOSED DECIDUOUS TREE w/ 30m³ SOIL VOLUME
- PROPOSED SHRUBS
- PROPOSED GRAVEL SURFACE
- PROPOSED ASPHALT
- PROPOSED RIVER WASHED GRAVEL
- TREE PROTECTION FENCE

11	PROJECT NUMBER ADDED TO PLAN	02/19/2025	ML	JL
10	REVISED PER CITY COMMENTS	11/19/2024	ML	JL
9	REVISED FOR SITE PLAN SUBMISSION	11/01/2024	CM	JL
8	ISSUED FOR SITE PLAN SUBMISSION	08/16/2024	ML	JL
7	ISSUED FOR DISCUSSION AND REVIEW	08/02/2024	ML	JL
6	ISSUED FOR DISCUSSION AND REVIEW	07/24/2024	ML	JL
5	ISSUED PER COMMENTS AND NEW TCR	05/16/2024	CM	JL
4	ISSUED FOR COMMENTS AND REVIEW	05/14/2024	WF	JL
3	ISSUED FOR COMMENTS AND REVIEW	05/13/2024	WF	JL
2	ISSUED FOR COMMENTS AND REVIEW	05/10/2024	WF	JL
1	ISSUED FOR COMMENTS AND REVIEW	06/01/2023	WF	JL
No.	Issue	Date	ML	CK

JAMES B. LENNOX & ASSOCIATES INC.
LANDSCAPE ARCHITECTS
3332 CARLING AVE. OTTAWA, ONTARIO K2H 5A8
Tel: (613) 722-5168 Fax: (613) 722-5168

PROJECT

THUNDER ROAD INDUSTRIAL PARK
6180 THUNDER ROAD AND 5368 BOUNDARY ROAD,
OTTAWA ON

DRAWING

LANDSCAPE & TREE COMPENSATION
PLAN

STAMP



SCALE

AS SHOWN

START DATE

SEPTEMBER, 2021

PROJECT NO.

21MS2191

PROJECT NORTH

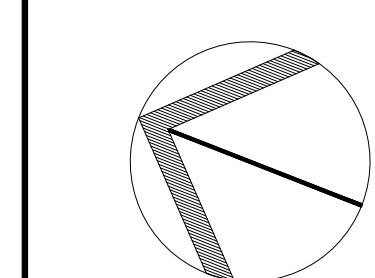

DRAWING NO.

TCP-01

PLOT SIZE ARCH-D

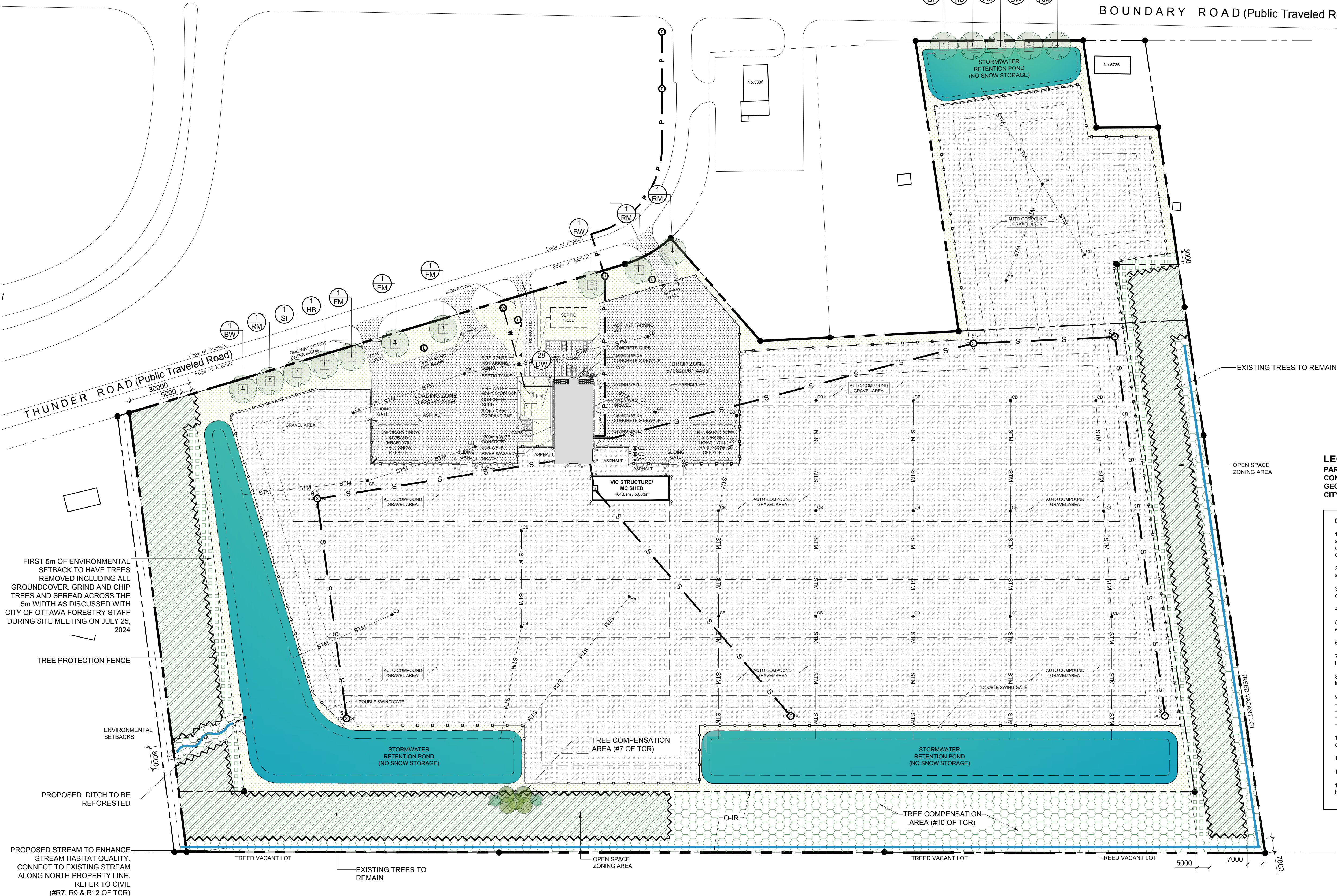

LEGAL DESCRIPTION:

PART OF LOT 1
CONCESSION 9 (OTTAWA FRONT)
GEOGRAPHIC TOWNSHIP OF GLOUCESTER,
CITY OF OTTAWA

GENERAL NOTES:

- It is the responsibility of the appropriate contractor or official to report any errors, omissions or discrepancies on this plan with actual site conditions to the Landscape Architect before proceeding with construction.
- The contractor is to notify all utility companies and authorities prior to any excavation and ascertain locations of underground services.
- The contractor is to reinstate all areas and items damaged as a result of construction activity.
- The contractor is to comply with all pertinent codes and by-laws.
- The contractor is to maintain a positive surface run-off throughout the entire construction period.
- The Landscape Architect is not responsible for subsurface conditions.
- The contractor is to identify all existing trees to remain on site with the Landscape Architect prior to construction.
- The contractor is to stake the proposed location of all plant material in conjunction with the Landscape Architect prior to excavation.
 - Minimum distances for selected deciduous trees are as follows:
 - Building Foundations 7.5m
 - Sidewalks 1.5m
 - Public Streets 2.5m
 - Underground Infrastructure 2.0m
- All trees within 1m of underground utility trenches are to be excavated by hand.
- Remove all protective wrapping from tree trunks after installation.
- Staking of trees shall only be performed if necessary.
- Ensure that mulch is pulled back a min. distance of 75mm from base of tree trunk.

1 LANDSCAPE & TREE COMPENSATION PLAN
TCP-01 SCALE 1:10001:1000
0 10 20 30 40m

#19187

#D07-12-21-0205