

### EXISTING TREE LIST

KEY	QTY.	BOTANICAL NAME	COMMON NAME	SIZE	CONDITION	REMARKS	OWNERSHIP	QTY. KEY
AG	1	<i>Acer ginnala</i>	Amur Maple	150mm DBH	GOOD	To be removed	5546 Albion Road South	
AR	1	<i>Acer rubrum</i>	Red Maple	180-200mm DBH	POOR-GOOD	To remain	5546 Albion Road South	
AP	6	<i>Pinus nigra</i>	Austrian Pine	100-250mm DBH	GOOD	To be removed	5546 Albion Road South	
FR	3	<i>Fraxinus americana</i>	White Ash	200-250mm DBH	GOOD	To be removed	5546 Albion Road South	
PG	9	<i>Picea glauca</i>	White Spruce	100-300mm DBH	GOOD	See plan	5546 Albion Road South	
PP	3	<i>Picea pungens</i>	Colorado Spruce	100-300mm DBH	GOOD	To be removed	5546 Albion Road South	
PS	4	<i>Pinus sylvestris</i>	Scots Pine	150-250mm DBH	POOR-GOOD	To remain	5546 Albion Road South	

### PROPOSED PLANT LIST

KEY	QTY.	BOTANICAL NAME	COMMON NAME	SIZE	CONDITION	REMARKS	NATIVE
<b>TREES</b>							
BH	2	<i>Carya cordiformis</i>	Bitternut Hickory	50mm ø	B&B	Single Leader	YES
FM	2	<i>Acer x freemanii</i>	Freeman's Maple	50mm ø	B&B		YES
HL	4	<i>Celtis occidentalis</i>	Hackberry	50mm ø	B&B		YES
JL	3	<i>Syringa reticulata</i>	Japanese Tree Lilac	50mm ø	B&B	Single leader	NO
SM	2	<i>Acer saccharum</i>	Sugar Maple	50mm ø	B&B		YES
HA	1	<i>Crataegus crus-galli</i> var. <i>inermis</i>	Thornless Cockspur Hawthorn	50mm ø	B&B		NO
RO	2	<i>Quercus rubra</i>	Red Oak	50mm ø	B&B		YES
WA	2	<i>Juglans nigra</i>	Black Walnut	50mm ø	B&B		YES
WS	9	<i>Picea glauca</i>	White Spruce	2.0m ht.	B&B		YES
<b>SHRUBS</b>							
BB	100	<i>Euonymus alatus</i> 'Compactus'	Dwarf Burning Bush	600mm ht.	Potted	Space 1000mm O.C.	NO
JH	24	<i>Juniperus sabina</i> 'Tamaniscolifolia'	Tamarix Juniper	600mm ht.	Potted	Space 1000mm O.C.	NO
RA	16	<i>Ribes alpinum</i>	Alpine Currant	800mm ht.	Potted	Space 1000mm O.C.	NO
RR	26	<i>Rosa rugosa</i>	Rugosa Rose	800mm ht.	Potted	Space 1000mm O.C.	NO
SF	70	<i>Sobaria sorbifolia</i> 'Sem'	Sem False Spirea	600mm ht.	Potted	Space 1000mm O.C.	NO

### GENERAL NOTES:

- IT IS THE RESPONSIBILITY OF THE APPROPRIATE CONTRACTOR OR OFFICIAL TO REPORT ANY ERRORS, OMISSIONS OR DISCREPANCIES ON THIS PLAN WITH ACTUAL SITE CONDITIONS TO THE LANDSCAPE ARCHITECT BEFORE PROCEEDING WITH CONSTRUCTION.
- THE CONTRACTOR IS TO NOTIFY ALL UTILITY COMPANIES AND AUTHORITIES PRIOR TO ANY EXCAVATION AND ASCERTAIN LOCATIONS OF UNDERGROUND SERVICES.
- THE CONTRACTOR IS TO REINSTATE ALL AREAS AND ITEMS DAMAGED AS A RESULT OF CONSTRUCTION ACTIVITY.
- THE CONTRACTOR IS TO COMPLY WITH ALL PERTINENT CODES AND BY-LAWS.
- THE CONTRACTOR IS TO MAINTAIN A POSITIVE SURFACE RUN-OFF THROUGHOUT THE ENTIRE CONSTRUCTION PERIOD.
- THE LANDSCAPE ARCHITECT IS NOT RESPONSIBLE FOR SUBSURFACE CONDITIONS.
- THE CONTRACTOR IS TO IDENTIFY ALL EXISTING TREES TO REMAIN ON SITE WITH THE LANDSCAPE ARCHITECT PRIOR TO CONSTRUCTION.
- THE CONTRACTOR IS TO STAKE THE PROPOSED LOCATION OF ALL PLANT MATERIAL IN CONJUNCTION WITH THE LANDSCAPE ARCHITECT PRIOR TO EXCAVATION.
- MINIMUM DISTANCES FOR SELECTED DECIDUOUS TREES ARE AS FOLLOWS:
  - BUILDING FOUNDATIONS - 7.5M
  - SIDEWALKS - 1.5M
  - PUBLIC STREETS - 2.5M
  - UNDERGROUND INFRASTRUCTURE - 2.0M
- ALL TREES WITHIN 1M OF UNDERGROUND UTILITY TRENCHES ARE TO BE EXCAVATED BY HAND.
- REMOVE ALL PROTECTIVE WRAPPING FROM TREE TRUNKS AFTER INSTALLATION.
- STAKING OF TREES SHALL ONLY BE PERFORMED IF NECESSARY.
- ENSURE THAT MULCH IS PULLED BACK A MINIMUM DISTANCE OF 75MM FROM BASE OF TREE TRUNK.

Bearings are grid, derived from Can-Net 2016 Real Time Network GPS observations, MTM Zone 9 (76°30' West Longitude) NAD-83 (original).  
For bearing comparisons, a rotation of 1°04'10" counter-clockwise was applied to bearings on P1, P2, P3 & P4.

**TOPOGRAPHICAL PLAN OF SURVEY  
PART OF LOT 30  
CONCESSION 3 (RIDEAU FRONT)  
GEOGRAPHIC TOWNSHIP OF GLOUCESTER  
CITY OF OTTAWA**  
Surveyed by Annis, O'Sullivan, Vollebek Ltd.

Scale 1: 250

Metric  
DIMENSIONS SHOWN ON THIS PLAN ARE IN METRES AND CAN BE CONVERTED TO FEET BY DIVIDING BY 0.3048

### Surveyor's Certificate

- CERTIFY THAT
- This survey and plan are correct and in accordance with the Survey Act and the Survey Regulations and the Land Use Act and the regulations made under them.
  - The survey was completed on the 7th day of April, 2022.

APR 12, 2022  
Date  
E. H. [Signature]  
Chairman and Surveyor

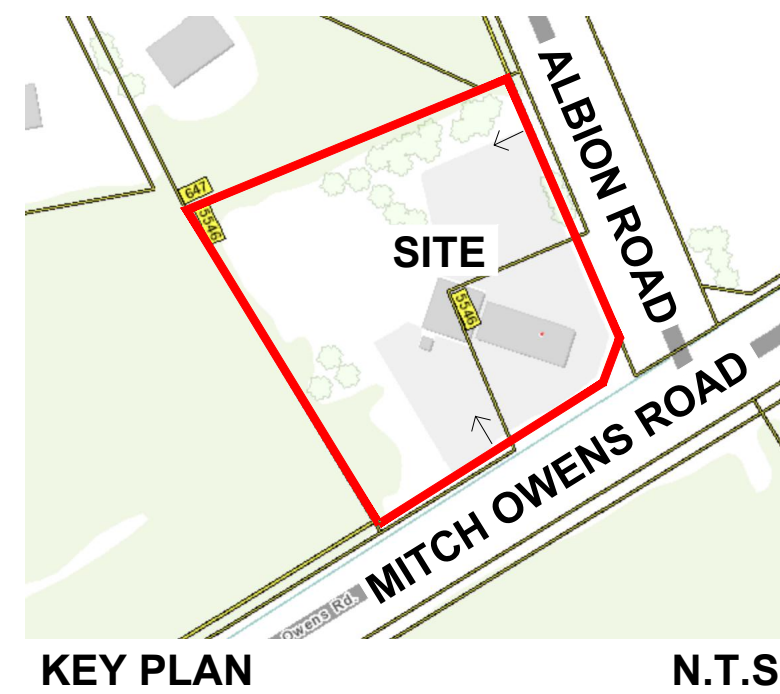

KEY PLAN

N.T.S.

APPROVED

By Adam Brown at 3:51 pm, Apr 23, 2025

ADAM BROWN  
MANAGER, DEVELOPMENT REVIEW - RURAL  
PLANNING, REAL ESTATE & ECONOMIC DEVELOPMENT  
DEPARTMENT, CITY OF OTTAWA

### 1 TREE CONSERVATION REPORT & LANDSCAPE PLAN SCALE: 1:300

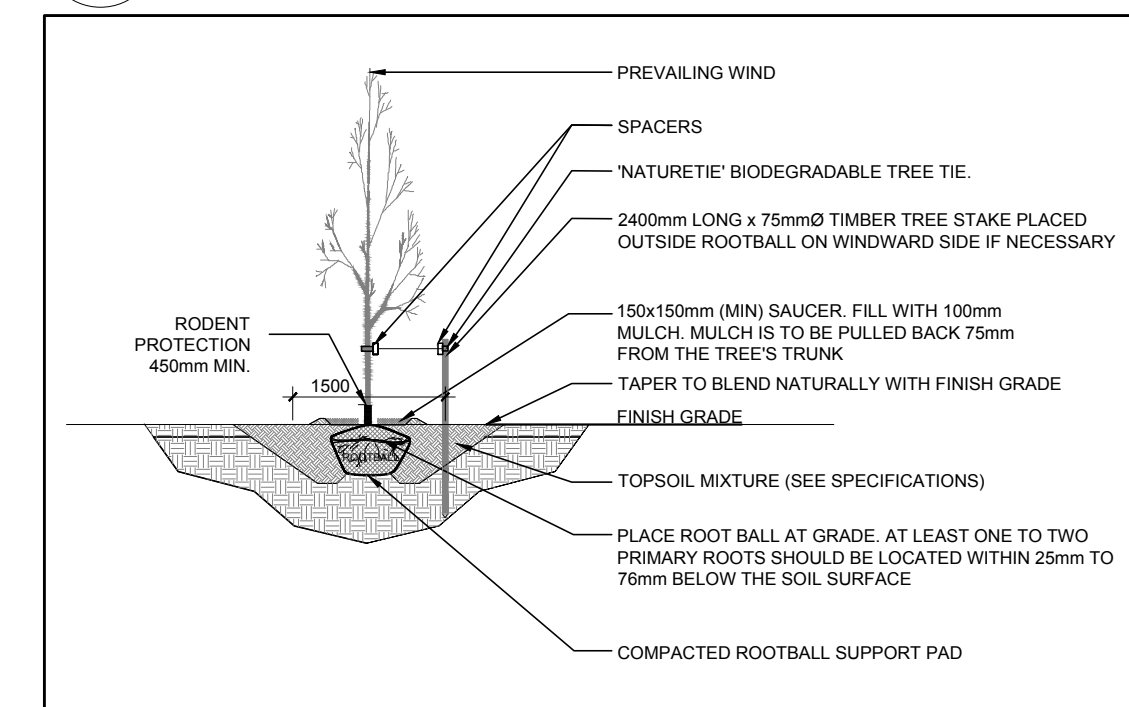

### 2 DECIDUOUS TREE PLANTING SCALE: NTS

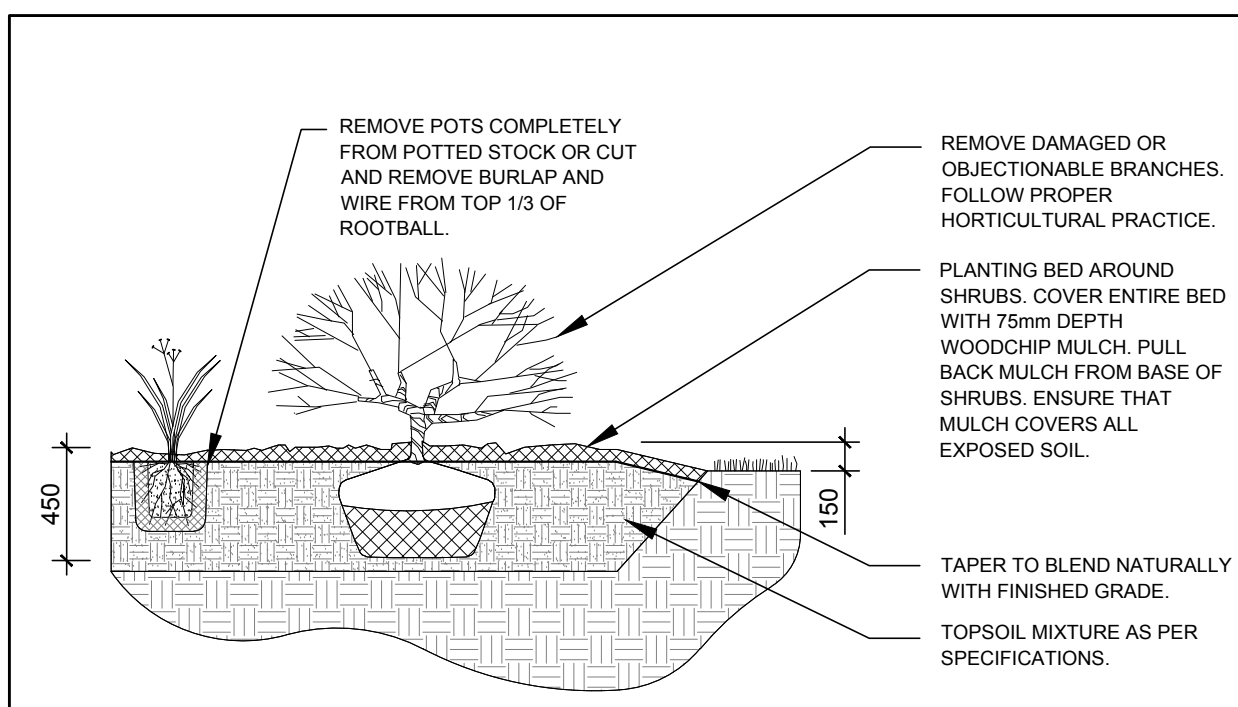

### 3 SHRUB PLANTING SCALE: NTS

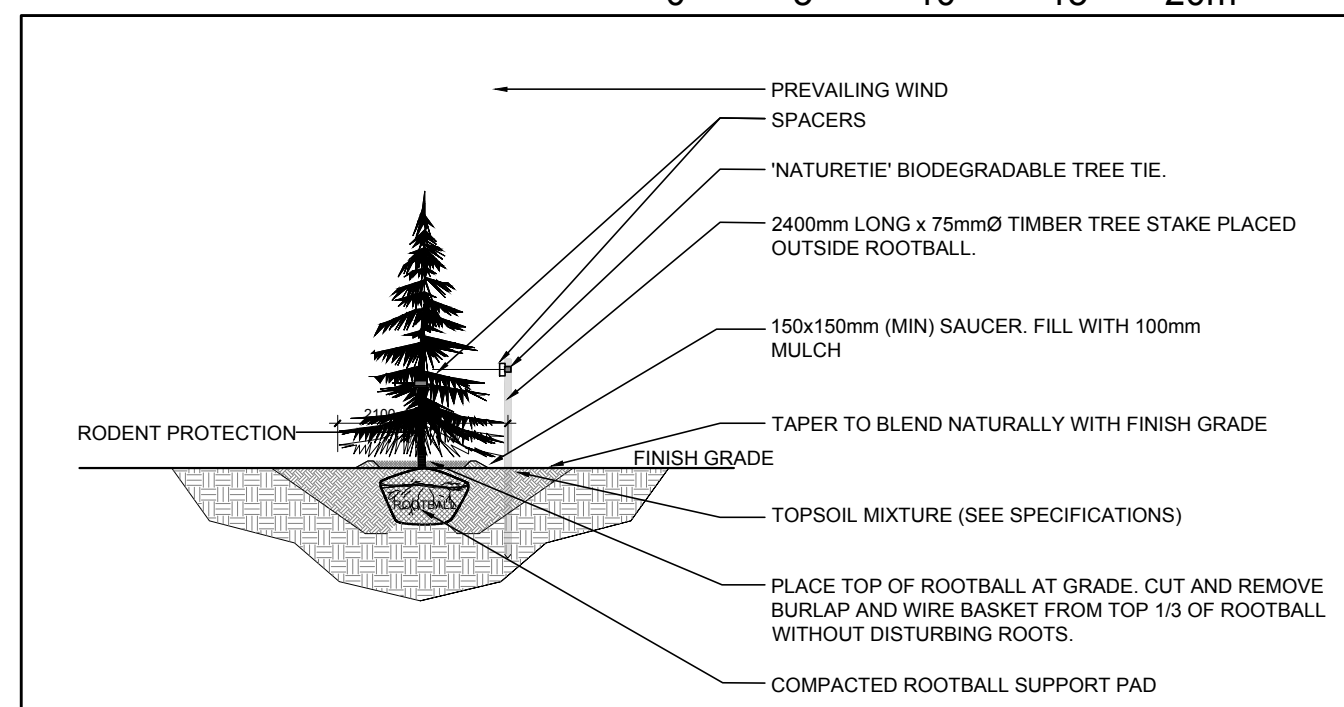

### 4 CONIFEROUS TREE PLANTING SCALE: NTS

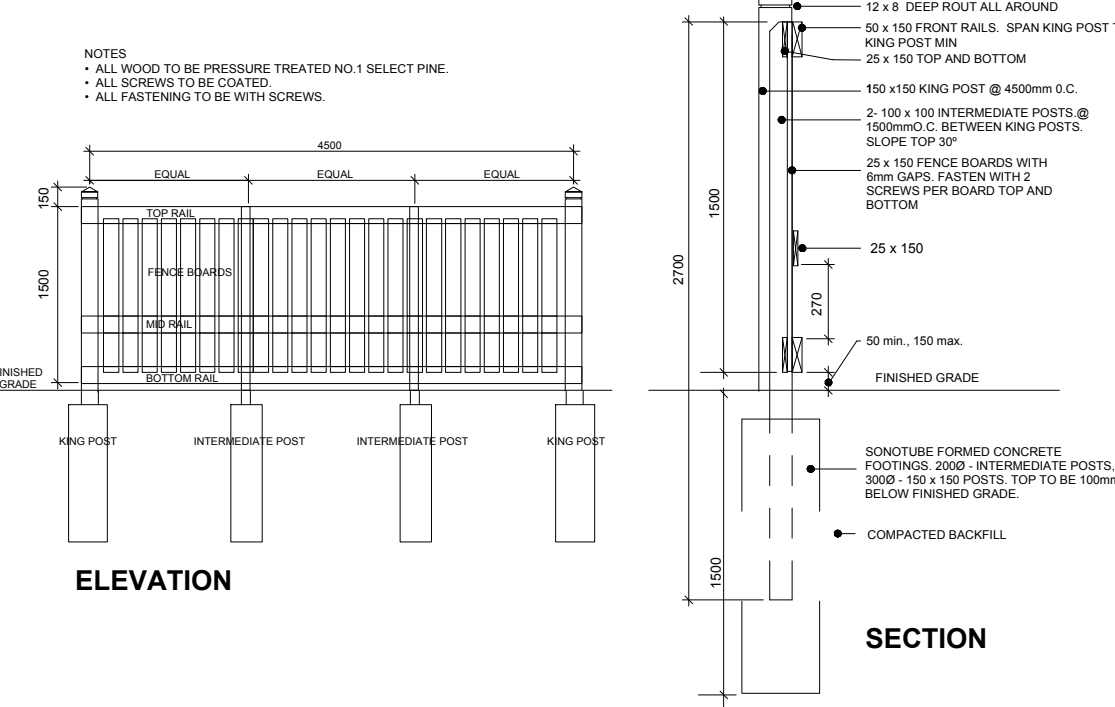

### 5 1.5m WOOD SCREEN FENCE SCALE: NTS

CLIENT  
**MACEWEN PETROLEUM INC.**  
18 Adelaide Street, Box 100,  
Maxville, ON K0C 1T0

CONSULTANTS  
CIVIL &  
GEOTECHNICAL  
ENGINEERS  
**L.R.J.**  
ENGINEERING | INGENIERIE  
5430 Carleton Road | Ottawa, ON K1J 9G2  
www.lrj.ca | (613) 842-3434

ARCHITECTS:  
**MCROBIE**  
Architects + Interior Designers Inc.  
66 Queen St #100, Ottawa, ON K1P 5C6

**LEGEND**

- PROPOSED SODDED GRASS AREA
- EXISTING GRASS TO REMAIN
- 40 YEAR CANOPY PROJECTION
- PROPOSED DECIDUOUS TREE
- 30m3 SOIL VOLUME
- 40 YEAR CANOPY PROJECTION
- PROPOSED CONIFEROUS TREE
- 30m3 SOIL VOLUME
- PROPOSED SHRUBS
- EXISTING TREE TO REMAIN
- EXISTING TREE TO BE REMOVED
- PROPERTY LINE
- PROPOSED 1.5m WOOD SCREEN FENCE
- EXISTING VEGETATION ON ADJACENT PROPERTIES TO REMAIN

7	FIRE PROTECTION TANK REMOVED	03/12/2025	ML	JL
6	SIGN LOCATION REVISED	01/22/2025	ML	JL
5	SNOW STORAGE AREA REVISED	10/16/2024	ML	JL
4	REVISED PER CITY COMMENTS	08/13/2024	LC	JL
3	REVISED PER CITY COMMENTS	02/15/2024	LC	JL
2	REVISED PER CITY COMMENTS	11/29/2023	ML	JL
1	ISSUED FOR DISCUSSION AND REVIEW	08/24/2022	ML	JL
No.	Issue	Date	MM/DD/YY	DR CK

**JAMES B. LENNOX & ASSOCIATES INC.**  
**LANDSCAPE ARCHITECTS**  
3332 CARLING AVE. OTTAWA, ONTARIO K2H 5A8  
Tel: (613) 722-5168 Fax: (613) 722-5162

PROJECT  
SITE RE-DEVELOPMENT  
5546 ALBION RD S, GLOUCESTER ON

DRAWING  
TREE CONSERVATION REPORT &  
LANDSCAPE PLAN

STAMP  
ASSOCIATION OF LANDSCAPE ARCHITECTS  
MEMBER  
SCALE  
AS SHOWN

START DATE  
JULY 2022  
PROJECT NO.  
22MIS2267

PROJECT NORTH  
DRAWING NO.  
**L.1**  
PLOT SIZE ARCH-D