

PROJECT INFORMATION: DWG NAME: P:\PROJECTS\Morguard\500 Coventry\LANDSCAPE\DESIGN\DEVELOPMENT\PLANS\LANDSCAPE\500 Coventry - 2D.dwg PLOT DATE: 2025-05-15 12:59:39 PM SHEET SIZE: ISO (unboxed) A1 (940.00 x 640.00 mm) PLOTTED BY: Stuart Pearson LAST SAVED BY: gsp@fotenn.com

NOTES:

DO NOT SCALE DRAWINGS;

NOTES ARE APPLICABLE TO ALL DRAWINGS IN THE SET;

SITE PLAN SUPPLIED BY Turner Fleischer Architects Inc. SURVEY SUPPLIED BY Annis, O'Sullivan, Vollebakk Ltd. Fotenn Consultants Inc. IS NOT RESPONSIBLE FOR ACCURACY OF BASE INFORMATION;

REFER TO CIVIL ENGINEERING DRAWINGS (PROVIDED BY Egis) FOR GRADING & SITE SERVICING INFORMATION;

THE CONTRACTOR IS RESPONSIBLE FOR CONFIRMING SITE CONDITIONS AND REPORTING ANY DISCREPANCIES TO THE LANDSCAPE ARCHITECT;

THE CONTRACTOR IS RESPONSIBLE FOR CONFIRMING EXACT LOCATIONS OF ALL UNDERGROUND SERVICES AND OBTAINING CLEARANCE FROM ALL APPLICABLE UTILITIES. PROPOSED WORKS FOUND TO BE IN CONFLICT WITH UNDERGROUND SERVICES MAY BE ADJUSTED AT THE DIRECTION OF THE LANDSCAPE ARCHITECT;

LANDSCAPE ELEMENTS SHOWN ARE SUBJECT TO THE FINAL LOCATION OF UNDERGROUND SERVICES AND UTILITIES;

DO NOT INSTALL TREES ON PROPERTY / LOT LINES OR WITHIN DRAINAGE EASEMENTS;

PERFORM WORK IN ACCORDANCE WITH DETAILS AND SPECIFICATIONS;

ALL PLANT MATERIAL SHALL BE No. 1 NURSERY STOCK AND SHALL MEET OR EXCEED THE SPECIFICATION OF THE Canadian Standards for Nursery Stock, AS PUBLISHED BY The Canadian Nursery Landscape Association;

SPECIES SUBSTITUTIONS ARE NOT PERMITTED WITHOUT PRIOR WRITTEN APPROVAL OF THE LANDSCAPE ARCHITECT;

ALL UN-PAVED SURFACES TO RECEIVE 150mm DEPTH TOPSOIL & SOD.

STANDARDS FOR TREE PLANTING:

NO PLANTING ON CORNERS OR ANYWHERE WHERE IT WOULD CREATE A SIGHT LINE CONCERN;

MAINTAIN A MINIMUM DISTANCE OF 2.5m FROM THE CURB FOR DECIDUOUS TREES AND 4.5m FOR CONIFEROUS TREES;

MAINTAIN A MINIMUM DISTANCE OF 1.5m FOR DECIDUOUS (4.5m FOR CONIFERS) FROM ANY SIDEWALK OR PRIVATE WALKWAY;

MAINTAIN A MINIMUM DISTANCE OF 1.2m FROM ALL DRIVEWAYS;

MAINTAIN A MINIMUM DISTANCE OF 2.5m FROM COMMUNITY MAILBOXES, LIGHT STANDARDS, FIRE HYDRANTS AND NO PLANTING IN FRONT OF HYDRANTS;

MAINTAIN A MINIMUM DISTANCE OF 3.0m FROM ALL HYDRO TRANSFORMERS;

MAINTAIN A MINIMUM DISTANCE OF 1.0m FROM ALL UNDERGROUND SERVICES;

MAINTAIN A MINIMUM DISTANCE OF 1.0m FROM ALL BELL AND CABLE BOXES;

MAINTAIN A MINIMUM DISTANCE OF 10.0 FROM BUS SHELTERS

IMPORTANT NOTICE FOR CONTRACTOR:

THE CITY OF OTTAWA REQUIRES A Certificate of Completion (F1) Landscape Works TO BE SUBMITTED AND SEALED BY THE LANDSCAPE ARCHITECT. CONTRACTORS ARE RESPONSIBLE FOR FAMILIARIZING THEMSELVES WITH THE REQUIREMENTS OF THIS PROCESS AND PROVIDING SUFFICIENT NOTICE TO THE LANDSCAPE ARCHITECT TO CONDUCT SITE REVIEWS **DURING INSTALLATION** OF TREES. THE 1 YEAR WARRANTY PERIOD SHALL NOT COMMENCE UNTIL THE LANDSCAPE ARCHITECT HAS SUBMITTED THE F1 Certificate.

PRIOR TO INSTALLATION OF TREES, THE DEVELOPER WILL CONTACT THE PLANNING AND GROWTH MANAGEMENT AND FORESTRY SERVICES TO REVIEW THE SPECIES AND LOCATION OF TREES.

PLANTING SCHEDULE (L1)

KEY	QTY.	BOTANICAL NAME	COMMON NAME	NATIVE	SIZE / CONDITION
DECIDUOUS TREES					
CO	2	Celtis occidentalis 'prairie sentinel'	Prairie Sentinel Hackberry	YES	70mm cal. / W.B.
GB	4	Ginkgo biloba 'Princeton Sentry'	Princeton Sentry Ginkgo	NO	70mm cal. / W.B.
GT	4	Gleditsia triacanthos var. inermis 'Draves'	Street Keeper Honeylocust	NO	70mm cal. / W.B.
PT	6	Populus tremuloides	Trembling Aspen	YES	50mm cal. / W.B.
QM	2	Quercus macrocarpa	Bur Oak	YES	70mm cal. / W.B.
UA	3	Ulmus americana 'Princeton'	Princeton Elm	YES	60mm cal. / W.B.
	21				
DECIDUOUS SHRUBS					
Pod	12	Physocarpus opulifolius 'Darts Gold'	Darts' Gold Ninebark	YES	#2 pot / 100cm sp.
Sa	29	Symphoricarpos albus	Snowberry	YES	50cm ht. / 100cm sp.
VINES					
Ptr	11	Parthenocissus tricuspidata 'Robusta'	Robusta Boston Ivy	NO	#1 pot / 200cm sp.
RESTORATION SEEDLINGS, WHIP STOCK AND SHRUBS					
BP*	2	Betula papyrifera	Paper Birch	YES	40mm cal. / W.B.
PN*	3	Pinus nigra	Austrian Pine	NO	125cm ht. / W.B.
PG*	3	Picea glauca	White Spruce	YES	125cm ht. / W.B.
PT*	3	Populus tremuloides	Trembling Aspen	YES	
PS*	3	Prunus serotina	Black Cherry	YES	40mm cal. / W.B.
QA*	2	Quercus alba	White Oak	YES	40mm cal. / W.B.
QR*	4	Quercus rubra	Red Oak	YES	40mm cal. / W.B.
-	16	Amelanchier alnifolia	Saskatoon Berry	YES	2 yr seedling / potted
-	16	Aronia melanocarpa	Chokeberry	YES	2 yr seedling / potted
-	10	Betula papyrifera	Paper Birch	YES	90-125cm whip / potted
-	10	Betula alleghaniensis	Yellow Birch	YES	90-125cm whip / potted
-	12	Celtis occidentalis	Common Hackberry	YES	90-125cm whip / potted
-	16	Juniperus virginiana	Eastern Red Cedar	YES	2-2 yr transplant / potted
-	20	Larix laricina	Tamarack (Eastern Larch)	YES	2-2 yr transplant / potted
-	12	Pinus nigra	Austrian Pine	NO	2-2 yr transplant / potted
-	12	Picea glauca	White Spruce	YES	2-2 yr transplant / potted
-	16	Populus deltoides	Eastern Cottonwood	YES	90-125cm whip / potted
-	16	Prunus virginiana	Chokecherry	YES	2 yr seedling / potted
-	12	Quercus alba	White Oak	YES	90-125cm whip / potted
-	12	Quercus rubra	Red Oak	YES	90-125cm whip / potted
-	16	Rhus typhina	Staghorn Sumac	YES	2 yr seedling / potted
	216				

NOTES: PLANT MATERIAL IN NATURALIZED AREA TO BE SPACED AT APPROXIMATELY 200cm O.C. RANDOM LAYOUT TO BE APPROVED BY LANDSCAPE ARCHITECT

ALL PLANT MATERIAL IS LOCATED ON PRIVATE PROPERTY FOR THIS PHASE OF THE PROJECT

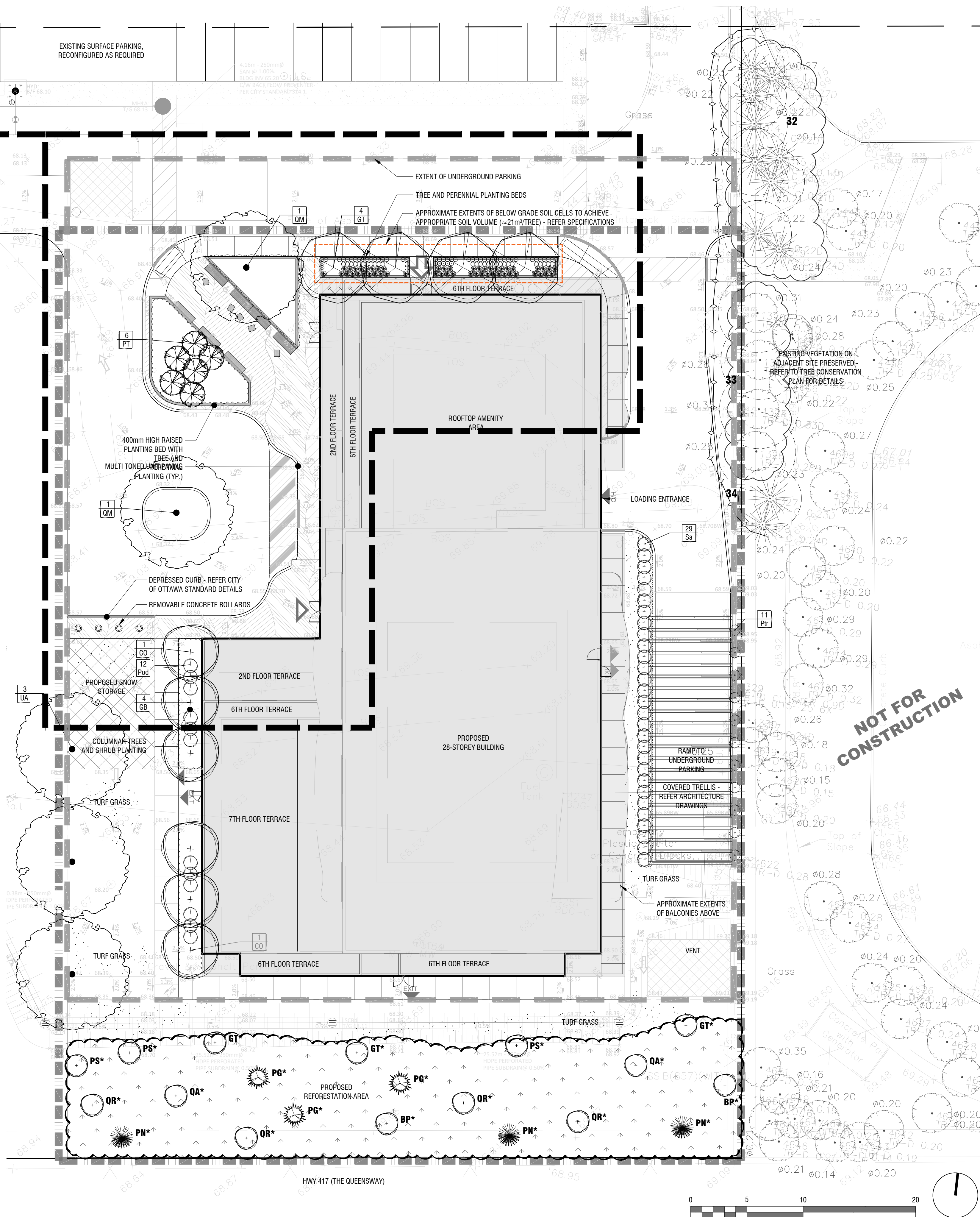

1 LANDSCAPE PLAN L1 1:200

Copyright Reserved
The Copyrights to all designs and drawings are the property of Fotenn Consultants Inc. Unauthorized reproduction or use is forbidden. DO NOT SCALE DRAWING

Copyright réservés
Les droits d'auteur à tous les modèles et dessins sont la propriété de Fotenn Consultants Inc. Reproduction ou utilisation non autorisée est interdite. NE PAS L'ÉCHELLE DE DESSIN

Client / Client

Morguard

key plan / plan repère

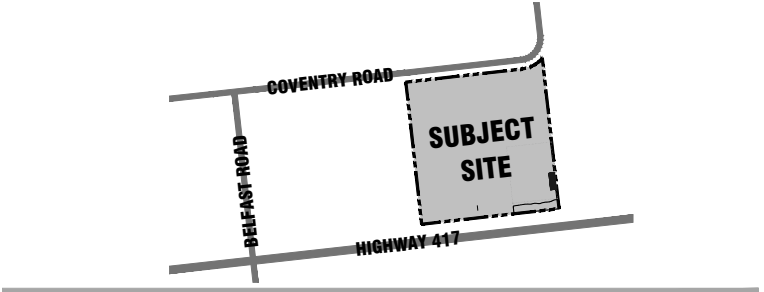

legend / légende

- APPROXIMATE SCOPE OF WORK
- EXISTING TREES AND HEDGEROW TREE-LINE AS SURVEYED - REFER TREE CONSERVATION PLANS FOR SPECIES AND HEALTH ASSESSMENTS
- EXISTING TREES NOT PICKED UP IN SURVEY
- CRITICAL ROOTING ZONE (CRZ) IDENTIFIED - REFER TO TABLE # FOR RADIUS OF CRZ
- TREE PROTECTION FENCING - REFER 1-TC2
- DECIDUOUS TREES (SEE PLANTING NOTES & SCHEDULE FOR SPECIES AND QUANTITIES)
- PROJECTED CANOPY COVERAGE IN GREEN
- CONIFEROUS TREES (SEE PLANTING SCHEDULE FOR SPECIES AND QUANTITIES)
- PERENNIAL & SHRUB PLANTING BEDS IN RAISED CONCRETE CURB (SEE PLANTING NOTES & SCHEDULE FOR SPECIES AND QUANTITIES)
- PLANT KEY
- CONCRETE UNIT PAVERS - REFER SPECIFICATIONS
- SITE FURNISHINGS BY OWNER - REFER SPECIFICATIONS
- NATURALIZED / REFORESTATION AREA (REFER TO SPECIFICATIONS AND PLANTING SCHEDULE FOR SPECIES AND QUANTITIES)

02	Updated per City comments	2025/03/12
01	Issue for submission	2024/11/14
00	Issue for Phase 2 Pre-Consultation	2023/12/22
rev'n	description / la description	yyyy/mm/dd

FOTENN Planning + Design
396 Cooper Street, Suite 300
Ottawa, ON, CANADA K2P 2H7
613.730.5709
fotenn.com

north / le nord



project / projet

500 COVENTRY ROAD
(LOT 1, REGISTERED PLAN 747, CITY OF OTTAWA)

drawing / dessin

LANDSCAPE PLAN

designed / conçu DF / SP	drawn / dessiné SP / DF	reviewed / examiné - / -
date	project number / No. du projet	

drawing number / No. du dessin

L1 of 4

PLOT INFORMATION: DWG NAME: P:\PROJECTS\Morguard\500 Coventry\LANDSCAPE\DESIGN\DEVELOPMENT\PLANS\m2\500 Coventry - 2D.mxd PLOT DATE: 2025-05-15 12:59:48 PM SHEET SIZE: ISO (unboxed) A1 (594.00 x 841.00 MM) PLOTTED BY: Stuart Pearson LAST SAVED BY: gsp@fotenn.com

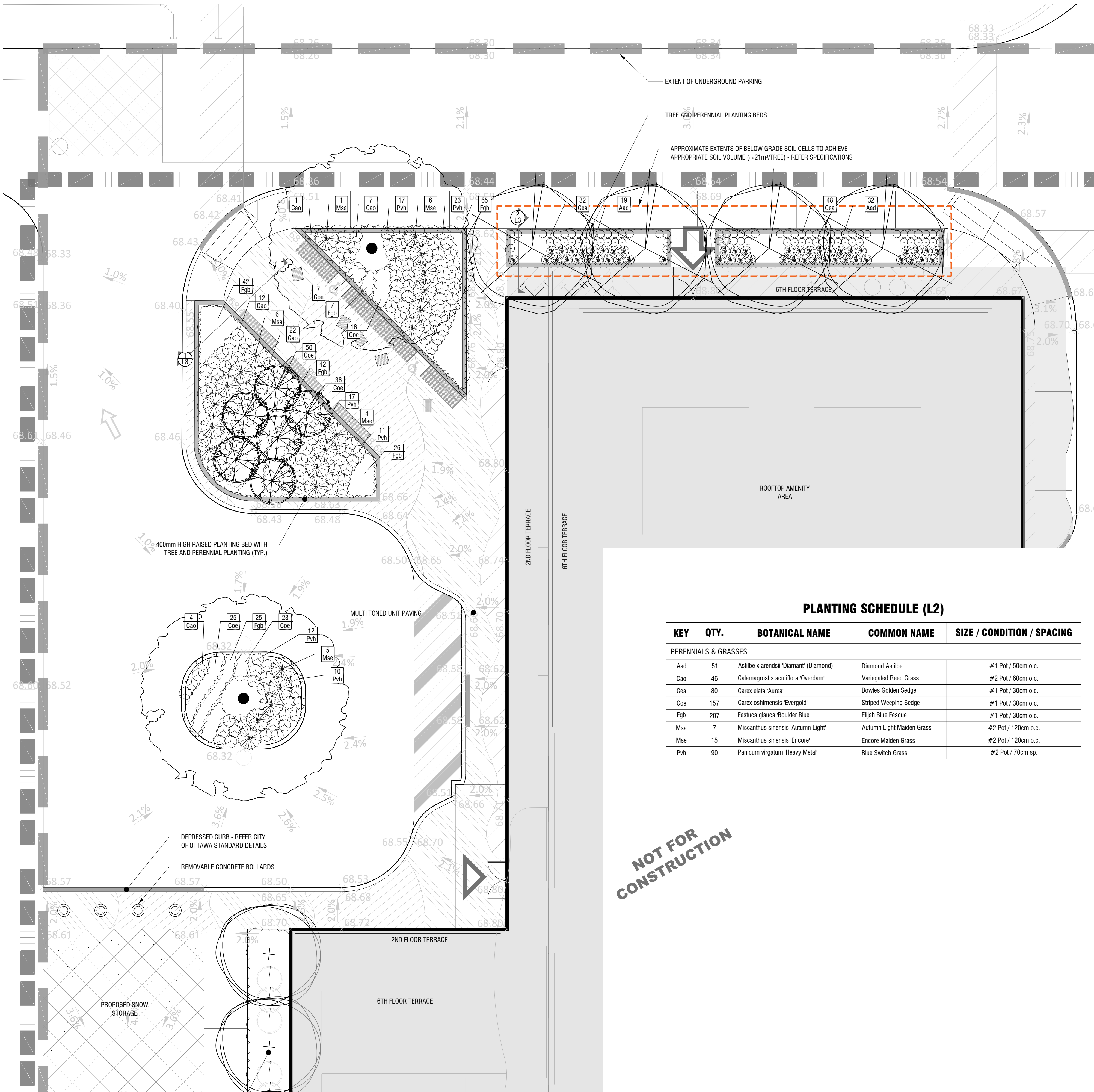

PLANTING SCHEDULE (L2)				
KEY	QTY.	BOTANICAL NAME	COMMON NAME	SIZE / CONDITION / SPACING
PERENNIALS & GRASSES				
Aad	51	Astilbe x arendsii 'Diamond' (Diamond)	Diamond Astilbe	#1 Pot / 50cm o.c.
Cao	46	Calamagrostis acutiflora 'Overdam'	Variegated Reed Grass	#2 Pot / 60cm o.c.
Cea	80	Carex elata 'Aurea'	Bowles Golden Sedge	#1 Pot / 30cm o.c.
Coe	157	Carex oshimensis 'Evergold'	Striped Weeping Sedge	#1 Pot / 30cm o.c.
Fgb	207	Festuca glauca 'Boulder Blue'	Elijah Blue Fescue	#1 Pot / 30cm o.c.
Msa	7	Miscanthus sinensis 'Autumn Light'	Autumn Light Maiden Grass	#2 Pot / 120cm o.c.
Mse	15	Miscanthus sinensis 'Encore'	Encore Maiden Grass	#2 Pot / 120cm o.c.
Pvh	90	Panicum virgatum 'Heavy Metal'	Blue Switch Grass	#2 Pot / 70cm sp.

NOT FOR CONSTRUCTION

Copyright Reserved
The Copyrights to all designs and drawings are the property of Fotenn Consultants Inc. Unauthorized reproduction or use is forbidden. DO NOT SCALE DRAWING
Copyright réservés
Les droits d'auteur à tous les modèles et dessins sont la propriété de Fotenn Consultants Inc. Reproduction ou utilisation non autorisée est interdite. NE PAS L'ÉCHELLE DE DESSIN

Client / Client



key plan / plan repère

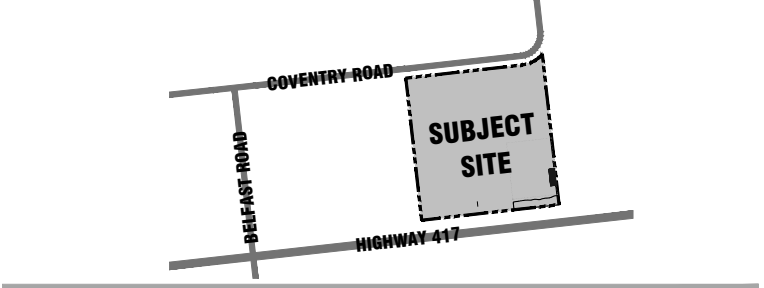

- legend / légende
- APPROXIMATE SCOPE OF WORK
 - EXISTING TREES AND HEDGEROW TREE-LINE AS SURVEYED - REFER TREE CONSERVATION PLANS FOR SPECIES AND HEALTH ASSESSMENTS
 - EXISTING TREES NOT PICKED UP IN SURVEY
 - CRITICAL ROOTING ZONE (CRZ) IDENTIFIED - REFER TO TABLE # FOR RADIUS OF CRZ
 - TREE PROTECTION FENCING - REFER 1-TC2
 - DECIDUOUS TREES (SEE PLANTING NOTES & SCHEDULE FOR SPECIES AND QUANTITIES)
 - PROJECTED CANOPY COVERAGE IN GREEN
 - CONIFEROUS TREES (SEE PLANTING SCHEDULE FOR SPECIES AND QUANTITIES)
 - PERENNIAL & SHRUB PLANTING BEDS IN RAISED CONCRETE CURB (SEE PLANTING NOTES & SCHEDULE FOR SPECIES AND QUANTITIES)
 - PLANT KEY
 - CONCRETE UNIT PAVERS - REFER SPECIFICATIONS
 - SITE FURNISHINGS BY OWNER - REFER SPECIFICATIONS
 - NATURALIZED / REFORESTATION AREA (REFER TO SPECIFICATIONS AND PLANTING SCHEDULE FOR SPECIES AND QUANTITIES)

rev'n	description / la description	yyyy/mm/dd
02	Updated per City comments	2025/03/12
01	Issue for submission	2024/11/14
00	Issue for Phase 2 Pre-Consultation	2023/12/22

FOTENN Planning + Design
396 Cooper Street, Suite 300
Ottawa, ON, CANADA K2P 2H7
613.730.5709
fotenn.com

north / le nord

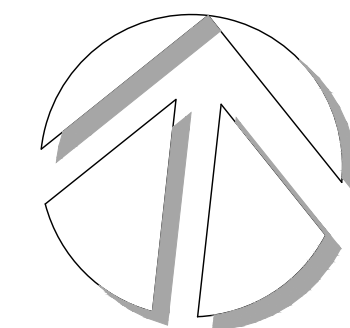

stamp / le cachet

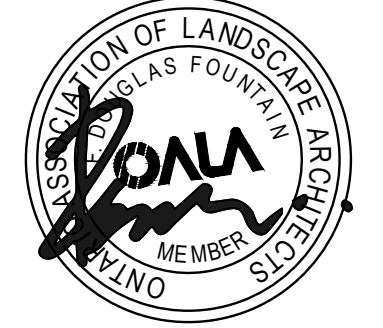

project / projet

500 COVENTRY ROAD
(LOT 1, REGISTERED PLAN 747, CITY OF OTTAWA)

drawing / dessin

AMENITY SPACE LAYOUT AND PLANTING PLAN

designed / conçu DF / SP	drawn / dessiné SP / DF	reviewed / examiné - / -
date	project number / No. du projet	

drawing number / No. du dessin

L2 of 4

1 AMENITY SPACE LAYOUT AND PLANTING PLAN
L2 1:100

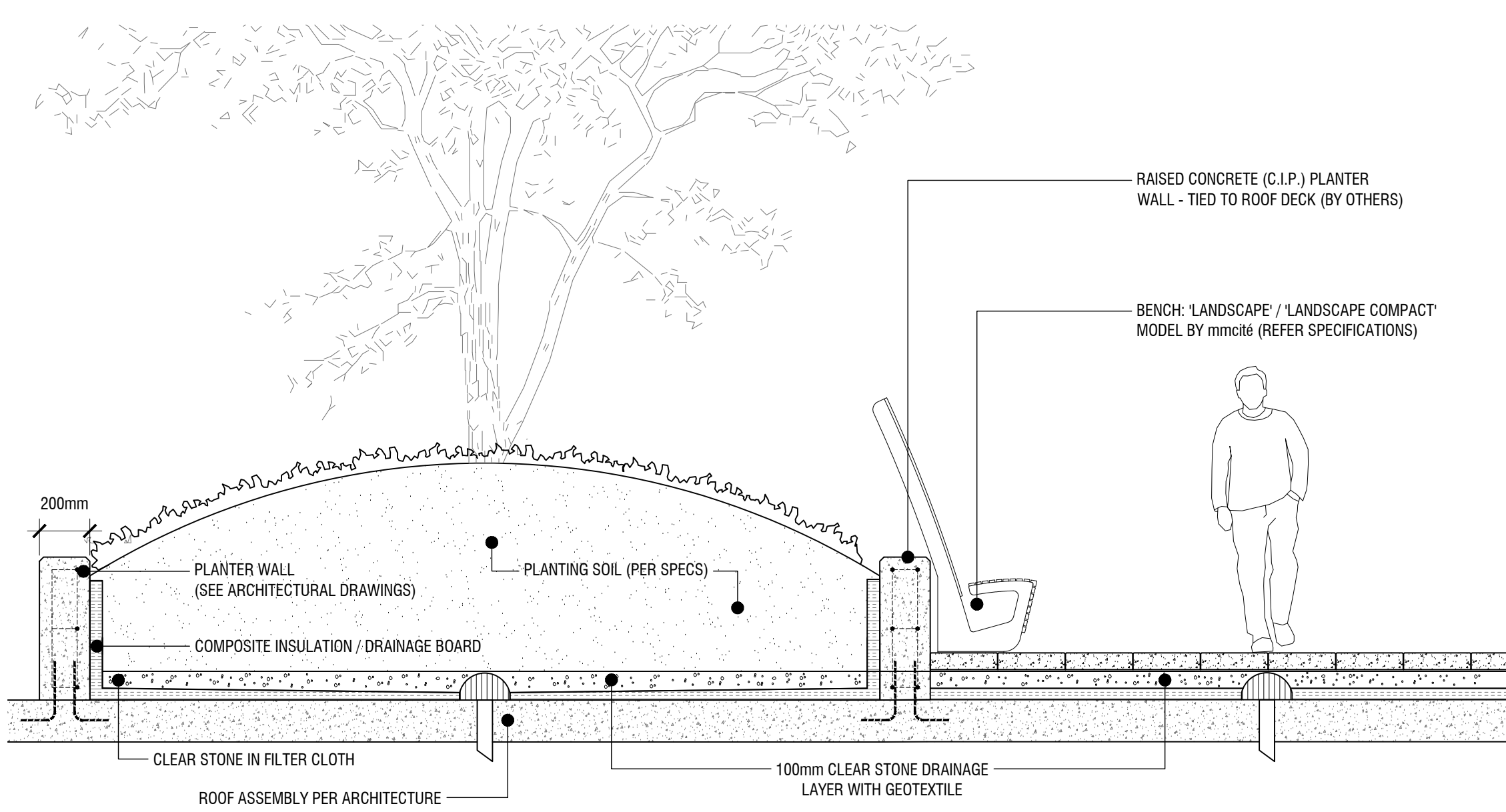

1 RAISED PLANTER SECTION / DETAIL

L3 n.t.s.

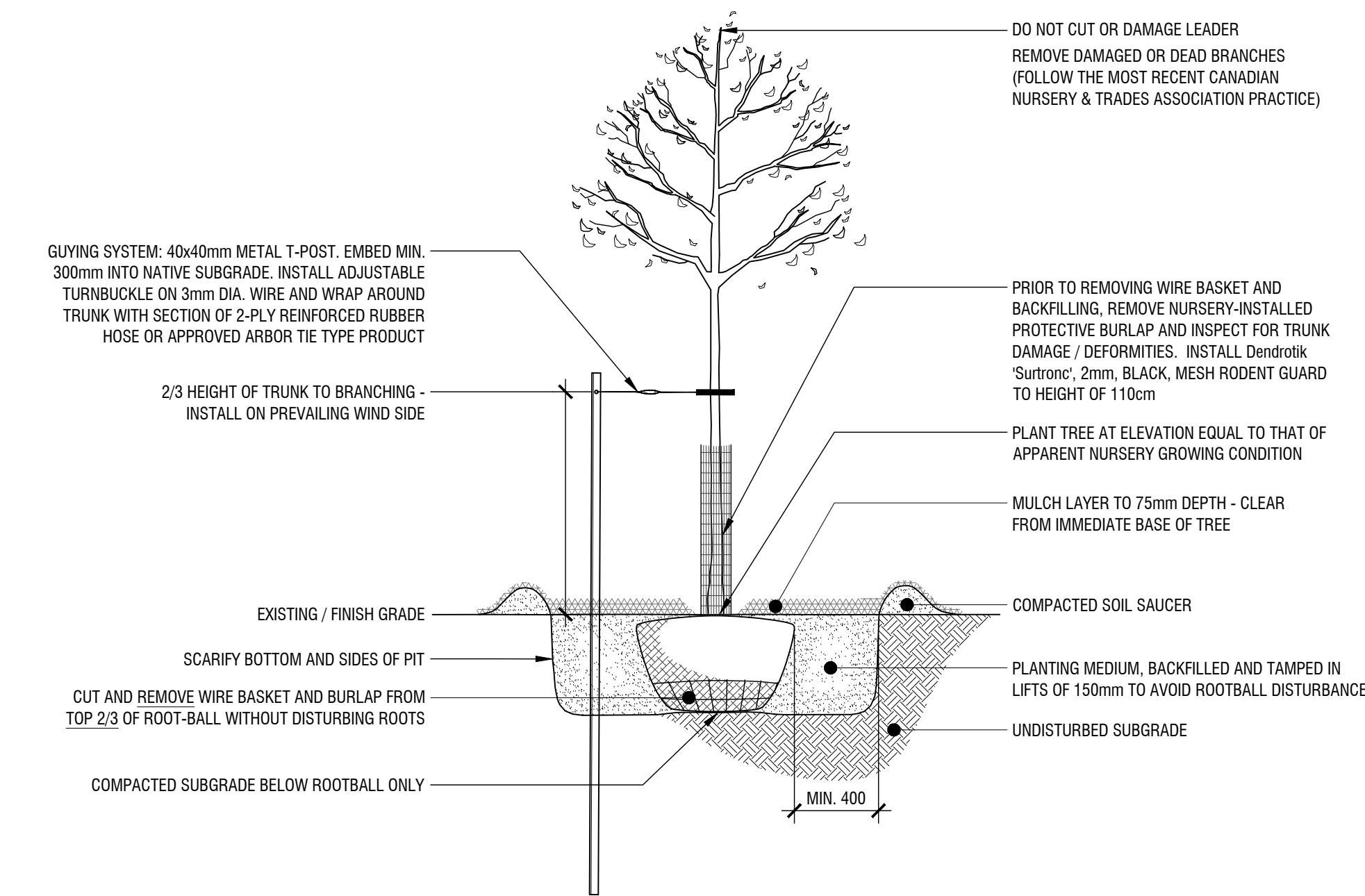

4 DECIDUOUS TREE PLANTING DETAIL

L3 n.t.s.

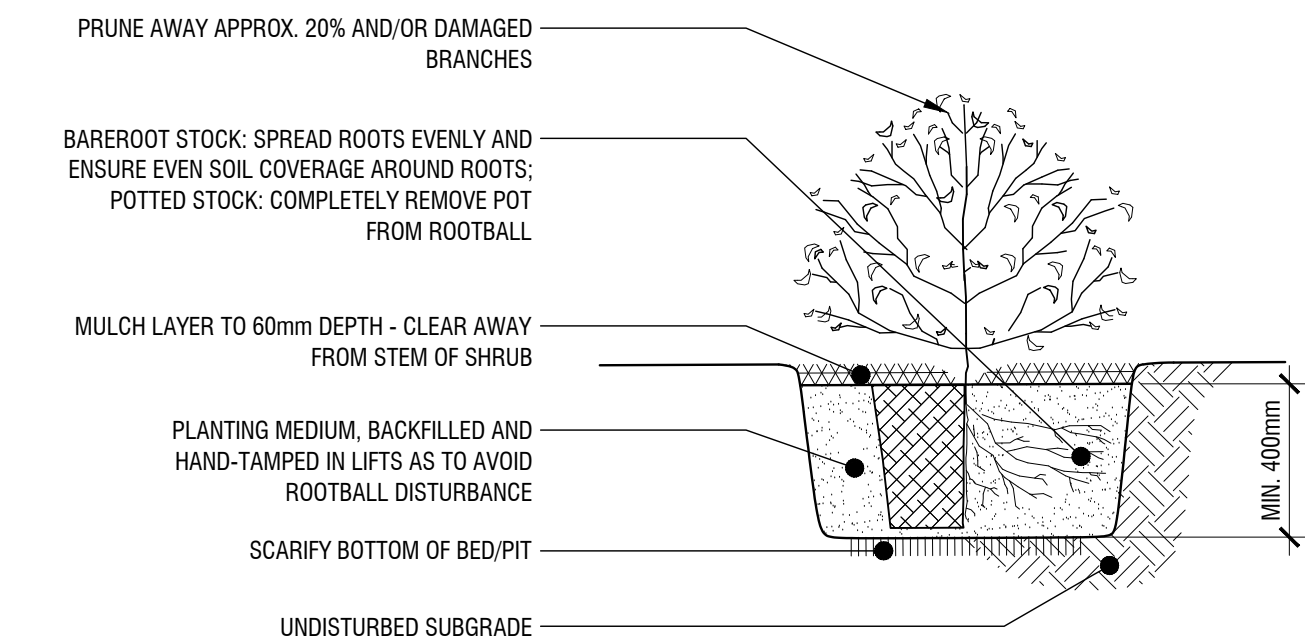

6 SHRUB PLANTING DETAIL

L3 n.t.s.

7 PERENNIAL PLANTING DETAIL

L3 n.t.s.

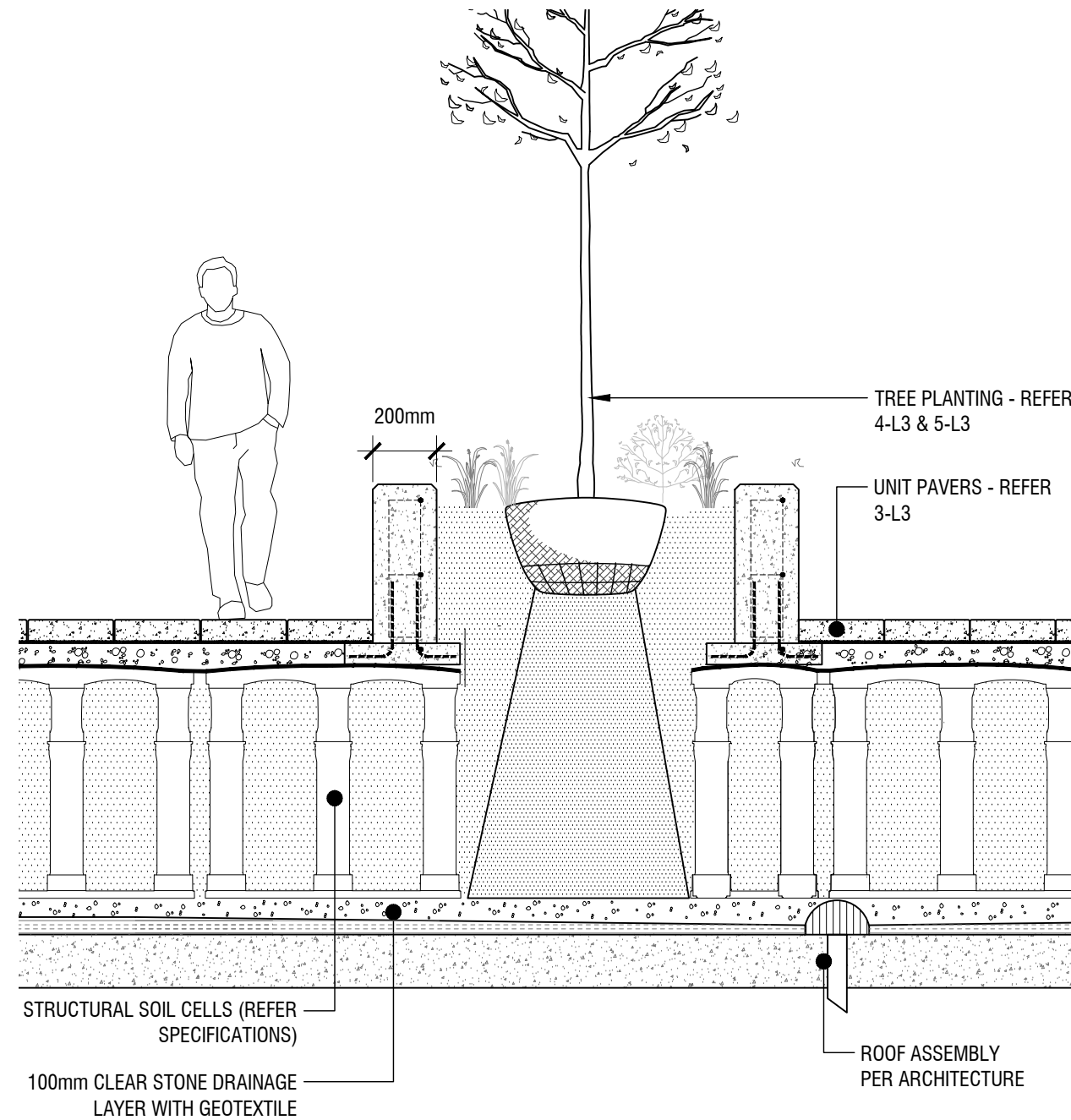
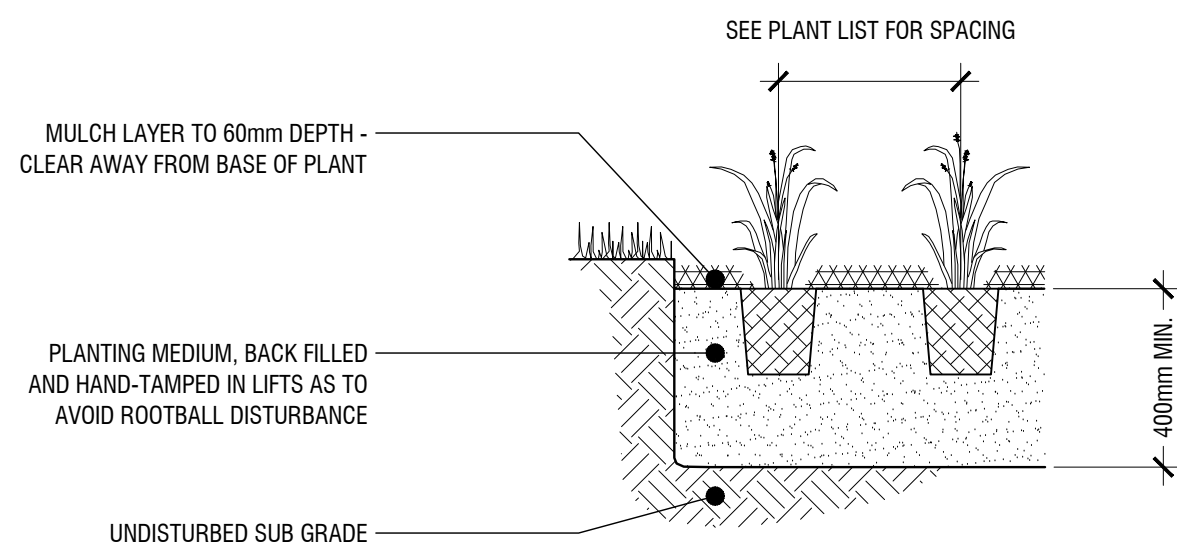

2 STRUCTURAL SOIL CELL DETAIL (TYPICAL)

L3 n.t.s.

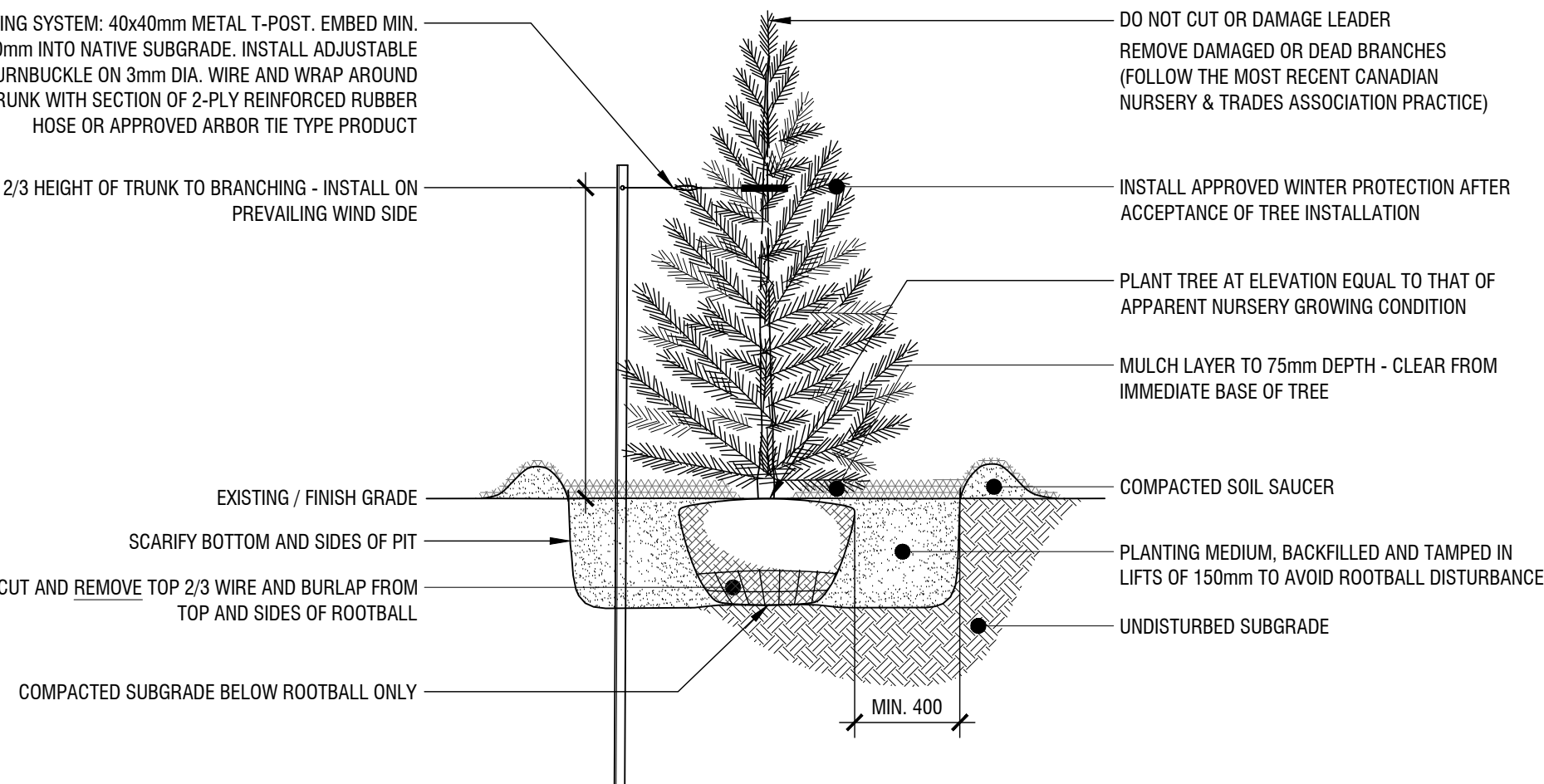

5 CONIFEROUS TREE PLANTING DETAIL

L3 n.t.s.

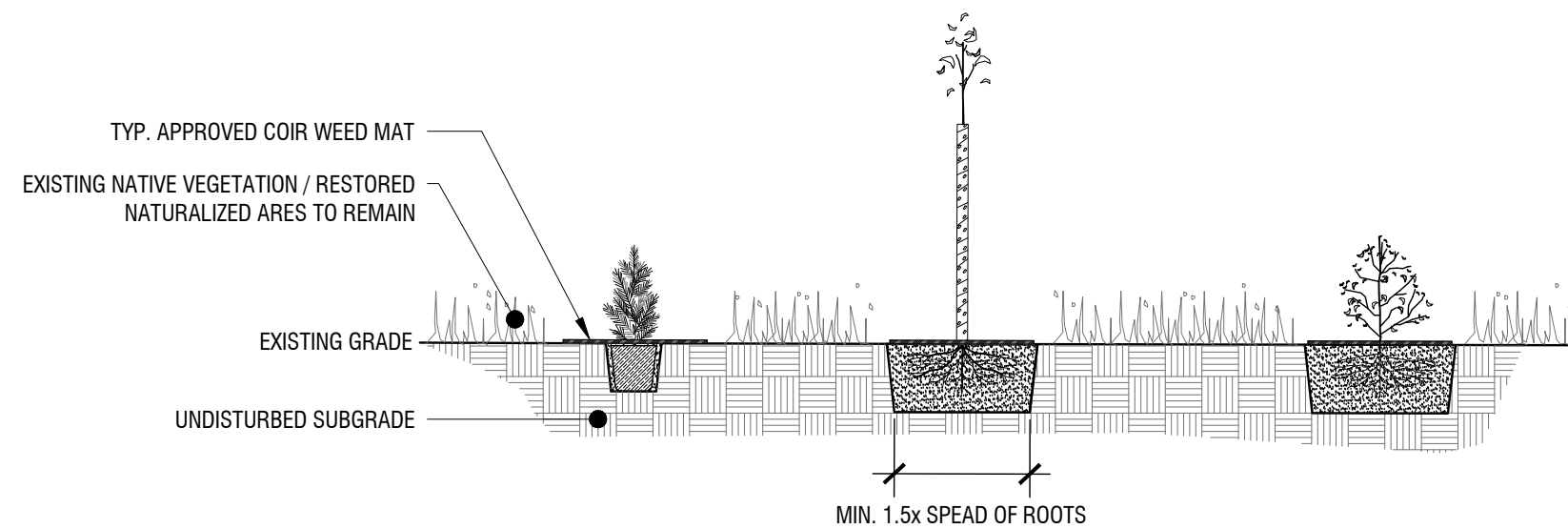

- NOTES:
1. LOCATIONS AND SPACING OF PLANTS WILL BE PROVIDED IN THE FIELD BY THE LANDSCAPE ARCHITECT / FORESTER;
 2. SCARIFY BOTTOM OF PLANTING PITS;
 3. SPREAD ROOTS OF BARE ROOT STOCK EVENLY AND ENSURE FULL SOIL COVERAGE AROUND ROOTS;
 4. BACKFILL PLANTING EXCAVATIONS WITH LOOSENED NATIVE SOIL. WHERE FOUND TO UN-SUITABLE, BLEND WITH APPROVED IMPORTED TOPSOIL;
 5. REMOVE NATIVE HERBACEOUS GROWTH FROM IMMEDIATE BASE OF PLANT. INSTALL APPROVED BIO-DEGRADABLE COIR MATS (MIN. 600 Ø x 10 THICK) AND FASTEN WITH 3 APPROVED BIO-DEGRADABLE STAKES;
 6. INSTALL APPROVED FINE WIRE MESH OR PERFORATED PLASTIC BARRIER ON WHIP STOCK TREES;
 7. REFER TO PLANTING SPECIFICATIONS FOR FURTHER DETAILS

8 REFORESTATION PLANTING DETAIL

L3 n.t.s.

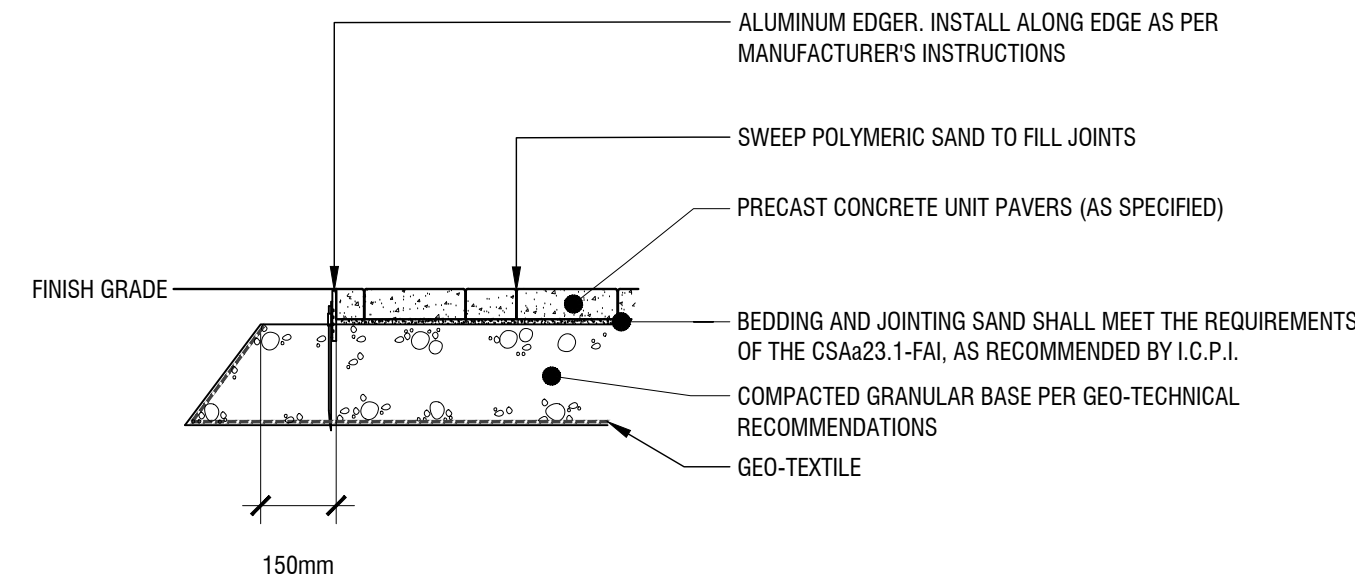

3 UNIT PAVER DETAIL

L3 n.t.s.

Copyright Reserved
The Copyrights to all designs and drawings are the property of Fotenn Consultants Inc. Unauthorized reproduction or use is forbidden. DO NOT SCALE DRAWING

Copyright réservés
Les droits d'auteur à tous les modèles et dessins sont la propriété de Fotenn Consultants Inc. Reproduction ou utilisation non autorisée est interdite. NE PAS L'ÉCHELLE DE DESSIN

Client / Client

Morguard

key plan / plan repère

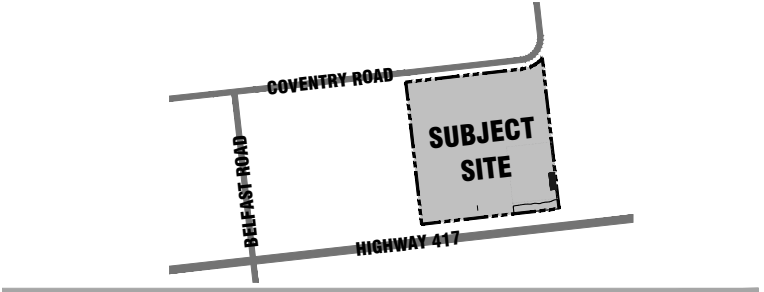

legend / légende

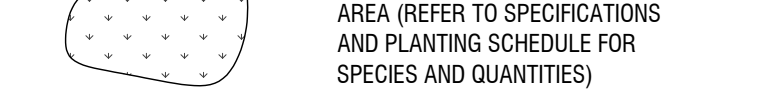
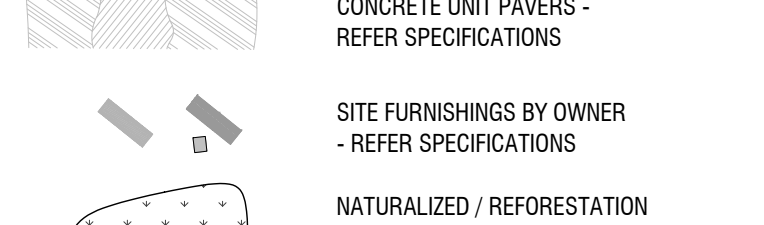
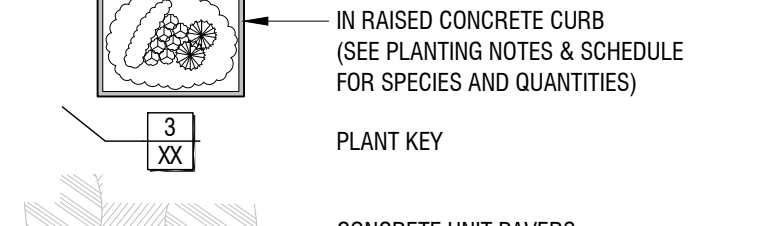
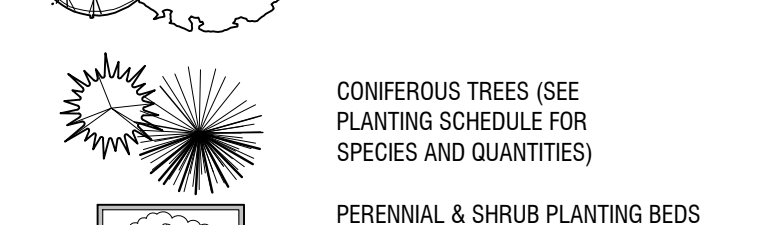
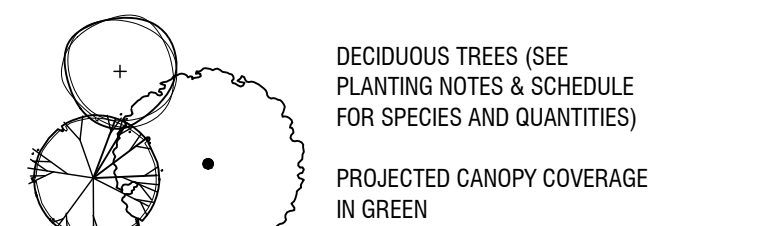
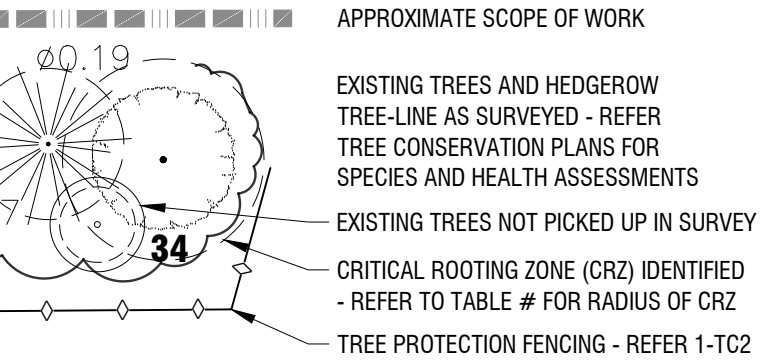

rev'n	description / la description	yyyy/mm/dd
02	Updated per City comments	2025/03/12
01	Issue for submission	2024/11/14
00	Issue for Phase 2 Pre-Consultation	2023/12/22

FOTENN Planning + Design
396 Cooper Street, Suite 300
Ottawa, ON, CANADA K2P 2H7
613.730.5709
fotenn.com

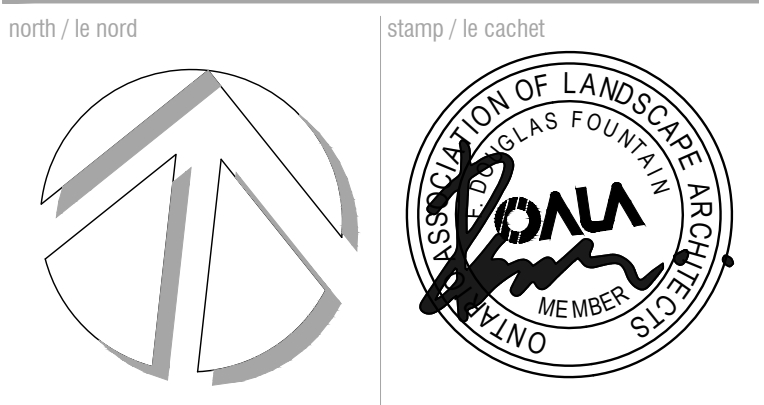

project / projet
500 COVENTRY ROAD
(LOT 1, REGISTERED PLAN 747, CITY OF OTTAWA)

CONSTRUCTION AND PLANTING DETAILS

designed / conçu	drawn / dessiné	reviewed / examiné
DF / SP	SP / DF	- / -
date	project number / No. du projet	

drawing number / No. du dessin

L3 of 4

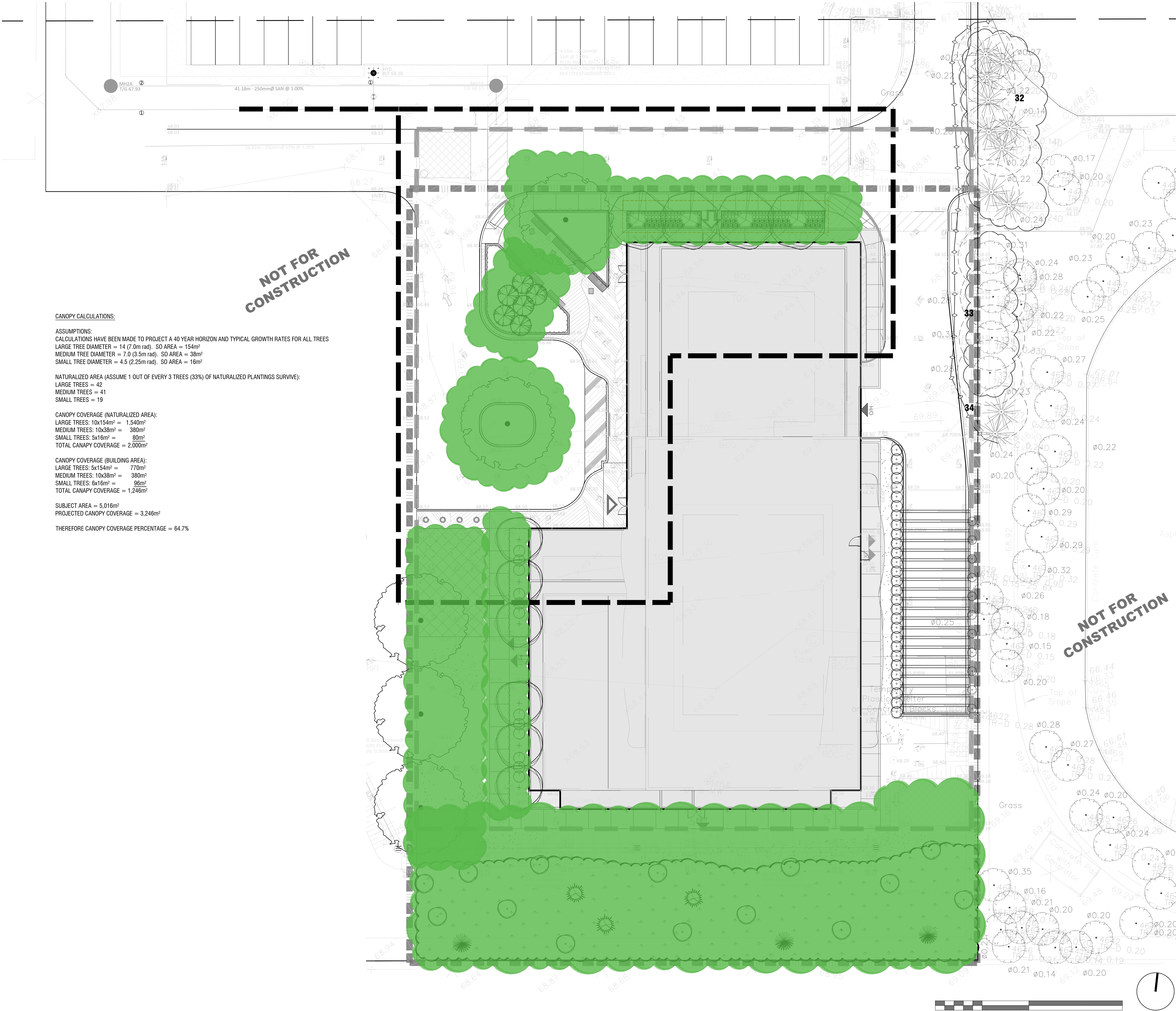

CANOPY CALCULATIONS:

ASSUMPTIONS:
CALCULATIONS HAVE BEEN MADE TO PROJECT A 40 YEAR HORIZON AND TYPICAL GROWTH RATES FOR ALL TREES
LARGE TREE DIAMETER = 14 (7.0m rad). SO AREA = 154m²
MEDIUM TREE DIAMETER = 7.0 (3.5m rad). SO AREA = 38m²
SMALL TREE DIAMETER = 4.5 (2.25m rad). SO AREA = 16m²

NATURALIZED AREA (ASSUME 1 OUT OF EVERY 3 TREES (33%) OF NATURALIZED PLANTINGS SURVIVE):
LARGE TREES = 42
MEDIUM TREES = 41
SMALL TREES = 19

CANOPY COVERAGE (NATURALIZED AREA):
LARGE TREES: 10x154m² = 1,540m²
MEDIUM TREES: 10x38m² = 380m²
SMALL TREES: 5x16m² = 80m²
TOTAL CANOPY COVERAGE = 2,000m²

CANOPY COVERAGE (BUILDING AREA):
LARGE TREES: 5x154m² = 770m²
MEDIUM TREES: 10x38m² = 380m²
SMALL TREES: 6x16m² = 96m²
TOTAL CANOPY COVERAGE = 1,246m²

SUBJECT AREA = 5,016m²
PROJECTED CANOPY COVERAGE = 3,246m²

THEREFORE CANOPY COVERAGE PERCENTAGE = 64.7%

1 **40 YEAR PROJECTED CANOPY COVERAGE PLAN**
L4 **1:200**

Copyright Reserved
The Copyrights to all designs and drawings are the property of Fotenn Consultants Inc. Unauthorized reproduction or use is forbidden. DO NOT SCALE DRAWING

Copyright réservés
Les droits d'auteur à tous les modèles et dessins sont la propriété de Fotenn Consultants Inc.
Reproduction ou utilisation non autorisée est interdite. NE PAS L'ÉCHELLE DE DESSIN

Client / Client



key plan / plan repère

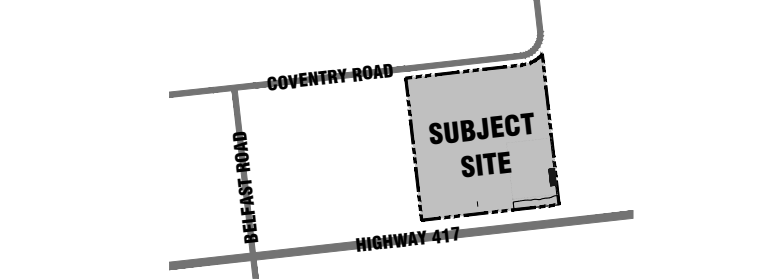

legend / légende

- APPROXIMATE SCOPE OF WORK
- EXISTING TREES AND HEDGEROW TREE-LINE AS SURVEYED - REFER TREE CONSERVATION PLANS FOR SPECIES AND HEALTH ASSESSMENTS
- EXISTING TREES NOT PICKED UP IN SURVEY
- CRITICAL ROOTING ZONE (CRZ) IDENTIFIED - REFER TO TABLE # FOR RADIUS OF CRZ
- TREE PROTECTION FENCING - REFER 1-TC2

DECIDUOUS TREES (SEE PLANTING NOTES & SCHEDULE FOR SPECIES AND QUANTITIES)

PROJECTED CANOPY COVERAGE IN GREEN

CONIFEROUS TREES (SEE PLANTING SCHEDULE FOR SPECIES AND QUANTITIES)

PERENNIAL & SHRUB PLANTING BEDS IN RAISED CONCRETE CURB (SEE RAISED NOTES & SCHEDULE FOR SPECIES AND QUANTITIES)

PLANT KEY

CONCRETE UNIT PAVERS - REFER SPECIFICATIONS

SITE FURNISHINGS BY OWNER - REFER SPECIFICATIONS

NATURALIZED / REFORESTATION AREA (REFER TO SPECIFICATIONS AND PLANTING SCHEDULE FOR SPECIES AND QUANTITIES)

02	Updated per City comments	2025/03/12
01	Issue for submission	2024/11/14
00	Issue for Phase 2 Pre-Consultation	2023/12/22

rev'n	description / la description	yyyy/mm/dd
-------	------------------------------	------------

FOTENN Planning + Design
396 Cooper Street, Suite 300
Ottawa, ON, CANADA K2P 2H7
613.730.5709
fotenn.com

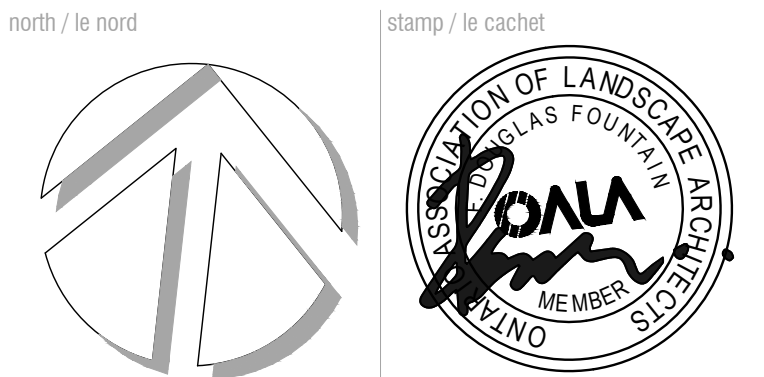

project / projet
500 COVENTRY ROAD
(LOT 1, REGISTERED PLAN 747, CITY OF OTTAWA)

drawing / dessin
40 YEAR CANOPY COVERAGE PROJECTIONS

designed / conçu
DF / SP
date

drawn / dessiné
SP / DF
project number / No. du projet

reviewed / examiné
- / -

drawing number / No. du dessin
L4 of 4