

**TOPOGRAPHIC INFORMATION**  
PROVIDED BY ANNIS, O'SULLIVAN, VOLLEBEKK LTD.  
DATED JULY 20, 2018

**JOB BENCHMARK**  
PROVIDED BY ANNIS, O'SULLIVAN, VOLLEBEKK LTD.  
NCC MONUMENT 01919680184  
NTM-NAD83 ZONE 9  
NORTHING=5040610.15  
EASTING=384736.57  
ELEVATION=52.68

**EXISTING LEGEND**

- OH OVERHEAD WIRES
- UP UTILITY POLE
- LS LIGHT STANDARD
- CB CATCHBASIN
- CBE CATCHBASIN ELBOW
- CBT CATCHBASIN TEE
- AD AREA DRAIN
- T/G TOP OF GRATE
- GM GAS METER
- MH MANHOLE (SANITARY OR STORM)
- G GAS MAIN
- V&VB VALVE AND VALVE BOX
- V&VC VALVE AND VALVE CHAMBER
- FH FIRE HYDRANT
- EX 250mm SAN STORM SEWER
- EX 300mm STM SANITARY SEWER
- EX 200mm WM WATERMAIN
- TREES
- FENCE
- ORIGINAL GROUND ELEVATION
- EXISTING CONTOUR
- OVERLAND FLOW ROUTE

**PROPOSED LEGEND**

- PROPERTY LINE
- 200mm SAN SANITARY SEWER
- 200mm STM STORM SEWER
- 200mm WM WATERMAIN
- CLAY SEAL
- STM MH 211 STORM MANHOLE
- SAN MH 104 SANITARY MANHOLE
- CB1 CATCHBASIN
- CBE CATCHBASIN ELBOW
- CBT CATCHBASIN TEE
- AD AREA DRAIN AND DECK DRAIN
- RD ROOF DRAIN
- V&VB VALVE AND VALVE BOX
- V&VC VALVE AND VALVE CHAMBER (W3)
- FH FIRE HYDRANT
- 45° 45° WATERMAIN BEND
- 22° 22.5° WATERMAIN BEND
- 11.25° 11.25° WATERMAIN BEND
- 200x150 WATERMAIN TEE (MAIN BRANCH)
- 200x200x200 WATERMAIN CROSS
- 200x150 WATERMAIN REDUCER
- WM WATER METER
- RM REMOTE WATER METER READER
- SC SIAMSESE CONNECTION
- FF FLOOR ELEVATION
- GRS GARAGE FLOOR SLAB ELEVATION
- P1 PARKING LEVEL FLOOR ELEVATION
- 3.0% SLOPE AND DIRECTION OF FLOW
- 54.75 FINAL GRADE
- H.P. HIGH POINT
- TERRACING
- T/G TOP OF GRATE ELEVATION
- T/F TOP OF FLANGE
- OVERLAND FLOW ROUTE
- PHASING LIMITS
- SILT FENCE
- BARRIER CURB (SC1.1)
- DC DEPRESSED BARRIER CURB LOCATION
- SWALE AND DIRECTION OF FLOW
- RETAINING WALL
- BLD BUILDING ENTRY LOCATION
- STR STRUCTURE TO BE ADJUSTED
- STR STRUCTURE TO BE RELOCATED

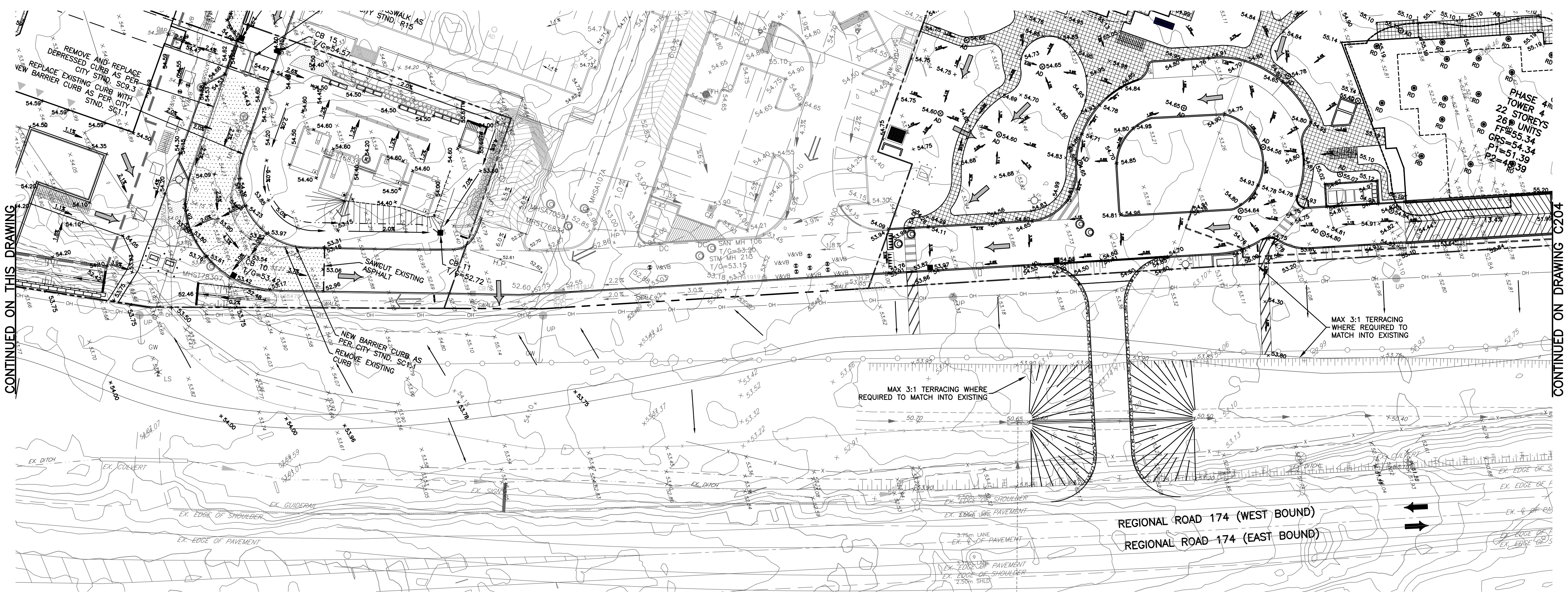

CONTINUED ON DRAWING C204

CONTINUED ON THIS DRAWING

**exp Services Inc.**  
2650 Queensway Drive, Unit 100, Ottawa, ON K2B 8H6  
T 613 688 1959 F 613 225 7330 www.exp.com

**exp architect(s)** INCORPORATED  
630, boulevard René-Lévesque O. Ste. étage, Montréal QC H3B 1S6  
T 514 947 1117 NEUF@architectes.com

**exp.**

BUILDINGS • EARTH & ENVIRONMENT • ENERGY • INDUSTRIAL • INFRASTRUCTURE • SUSTAINABILITY •

**BRIGIL**

98 Rue Lelièvre, Gatineau QC J8Y 3R7  
T 819 243 7392 www.brigil.com

**PETRIE'S LANDING I - PHASES 3-5**

EMPLOYMENT Location NO PROJECT NO  
OTTAWA, ON. OTT-00247308-A0

NO	REVISION	DATE (aa.mm.jj)
1	ISSUED FOR REVIEW	18.08.03
2	ISSUED FOR SITE PLAN APPROVAL	18.09.14
3	ISSUED FOR CLIENT REVIEW	19.04.05
4	ISSUED FOR SITE PLAN APPROVAL	19.05.10
5	ISSUED FOR SITE PLAN APPROVAL	19.05.22
6	ISSUED FOR SPA-CITY COMMENTS	19.07.22
7	REVISED PER CITY COMMENTS	19.07.30
8	UPDATED TOWER 4	20.02.12
9	PRE-IFC FOR BRIGIL REVIEW	20.09.14
10	ISSUED FOR CONSTRUCTION	20.11.10
11	ISSUED FOR TOWER 4 BUILDING PERMIT	21.12.10
12	ISSUED FOR PERMIT UPDATE	22.03.14
13	ISSUED FOR 80% REVIEW	22.04.21
14	ISSUED FOR PERMIT	22.07.15
15	ADDITIONAL WATER SERVICE TOWER 6	22.10.18
16	ISSUED FOR TENDER	22.12.05
17	ISSUED FOR RE-TENDER	23.03.10
18	ISSUED FOR COORDINATION	23.11.08
19	ISSUED FOR APPROVAL	24.06.24
20	UPDATED CITY NUMBER	25.02.10

DESIGNED BY: S.BUTLER  
CHECKED BY: B.THOMAS

DATE (aa.mm.jj) 18.07.18  
ECHELLE Scale 1:400

**MUP GRADING PLAN**