

LIGHT DUTY SILT FENCE INSIDE ASPHALT CUT DETAIL

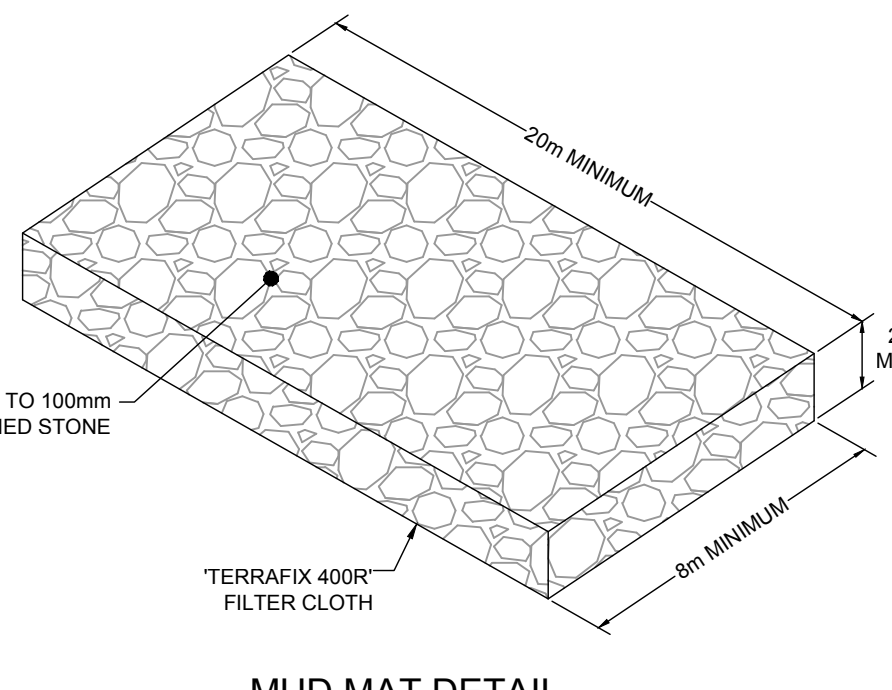

MUD MAT DETAIL N.T.S.

TEMPORARY CATCHBASIN INSERT DETAIL

N.T.S.  
NOTE: ALL EXISTING AND PROPOSED CATCHBASINS ARE TO HAVE AN INSERT UNTIL CONSTRUCTION OF SUBDIVISION IS COMPLETE.

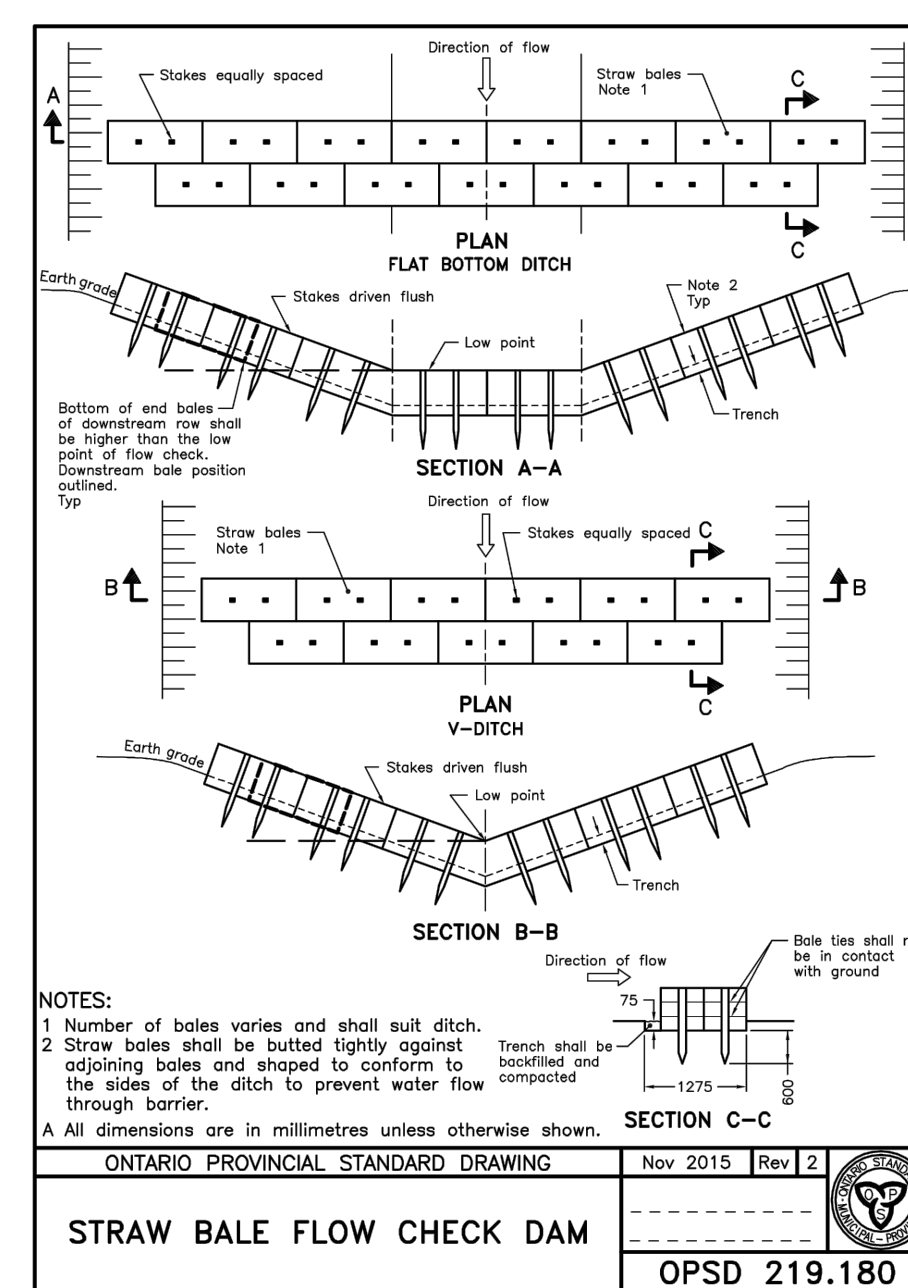

STRAW BALE FLOW CHECK DAM OPD 219.180

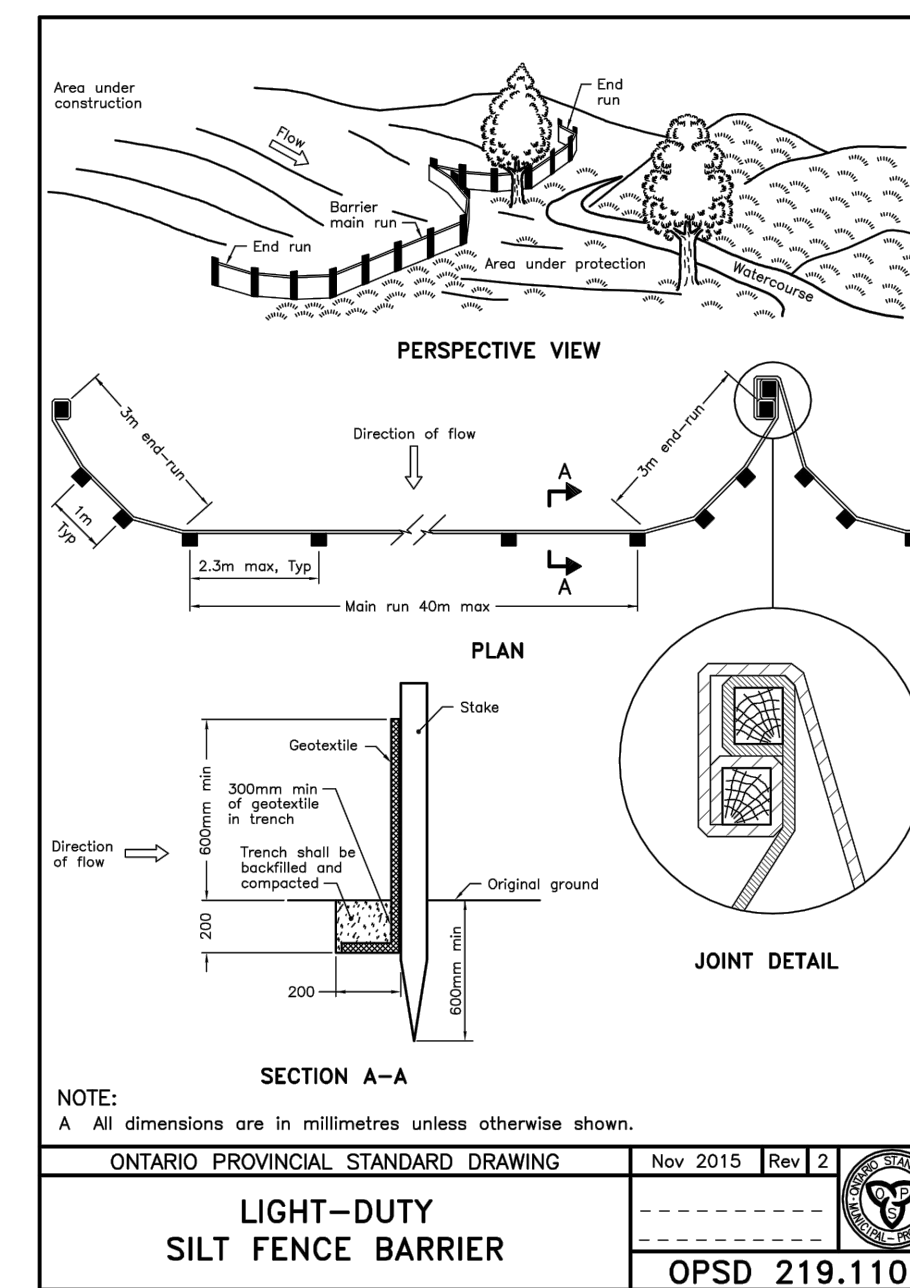

LIGHT-DUTY SILT FENCE BARRIER OPD 219.110

- LEGEND**
- SITE BOUNDARY
  - LIMIT OF SITE PLAN CONTROL APPLICATION
  - PROPOSED LIGHT DUTY SILT FENCE (AS PER O.P.S.D. 219.110)
  - PROPOSED STRAW BALE (AS PER O.P.S.D. 219.180)
  - EXISTING BARRIER CURB TO BE REMOVED
  - PROPOSED ASPHALT REMOVAL
  - PROPOSED ASPHALT REMOVAL - FULL DEPTH
  - PROPOSED MUD MAT
  - EXISTING LIGHT STANDARD ON CONCRETE BASE TO BE RELOCATED
  - EXISTING ADJACENT LEGAL LINE
  - EXISTING CULVERT
  - EXISTING STORM MANHOLE
  - EXISTING SATCHBASIN
  - EXISTING SANITARY MANHOLE
  - EXISTING HYDRANT
  - EXISTING VALVE & VALVE BOX
  - EXISTING CENTERLINE SWALE
  - EXISTING TOP OF GRATE ELEVATION
  - EXISTING INVERT ELEVATION
  - EXISTING OVERHEAD WIRES
  - EXISTING TRAFFIC MANHOLE
  - EXISTING UTILITY POLE
  - EXISTING UTILITY POLE ANCHOR
  - EXISTING TRAFFIC SIGNAL LIGHT
  - EXISTING LIGHT STANDARD ON CONCRETE BASE
  - EXISTING SIGN
  - EXISTING CONCRETE

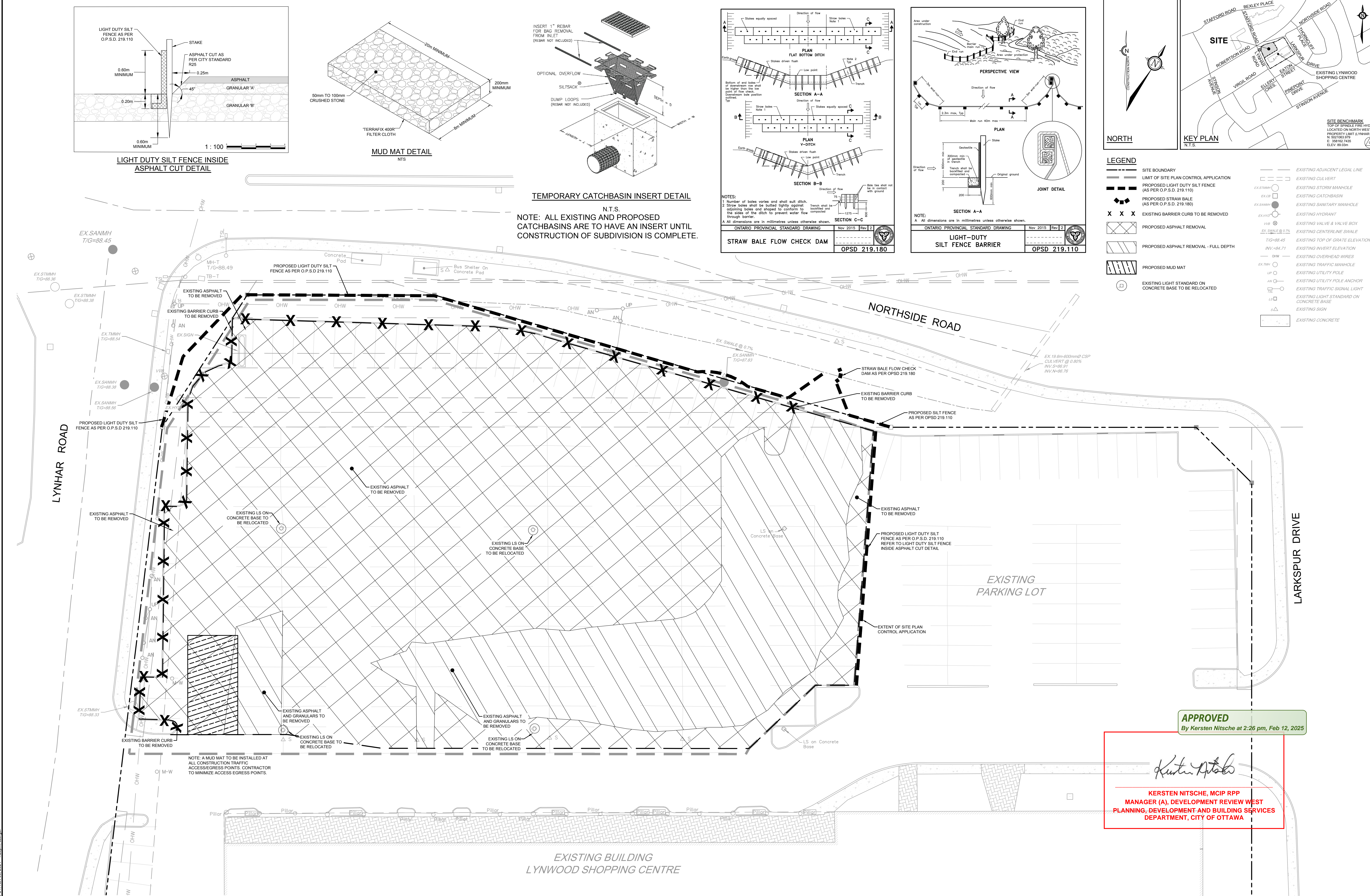

**APPROVED**  
By Kersten Nitsche at 2:26 pm, Feb 12, 2025

*Kersten Nitsche*  
**KERSTEN NITSCHKE, MCIP RPP**  
MANAGER (A), DEVELOPMENT REVIEW WEST  
PLANNING, DEVELOPMENT AND BUILDING SERVICES  
DEPARTMENT, CITY OF OTTAWA

REFER TO 106134-ND FOR ADDITIONAL NOTES AND DETAILS

NOTE:  
THE POSITION OF ALL POLE LINES, CONDUITS, WATERMANS, SEWERS AND OTHER UNDERGROUND AND OVERGROUND UTILITIES AND STRUCTURES IS NOT NECESSARILY SHOWN ON THE CONTRACT DRAWINGS, AND WHERE SHOWN, THE ACCURACY OF THE POSITION OF SUCH UTILITIES AND STRUCTURES IS NOT GUARANTEED. BEFORE STARTING WORK, DETERMINE THE EXACT LOCATION OF ALL SUCH UTILITIES AND STRUCTURES AND ASSUME ALL LIABILITY FOR DAMAGE TO THEM.

**PRELIMINARY  
NOT FOR  
CONSTRUCTION**

No.	REVISION	DATE	BY
6.	REVISED ASPHALT REMOVAL LIMITS	DEC 17/24	SAZ
5.	REVISED AS PER CITY OF OTTAWA COMMENTS	NOV 6/24	SAZ
4.	REVISED AS PER CITY OF OTTAWA COMMENTS	JUL 19/24	SAZ
3.	REVISED AS PER CITY OF OTTAWA COMMENTS	APR 19/24	SAZ
2.	REVISED AS PER CITY OF OTTAWA COMMENTS	NOV 17/23	SAZ
1.	ISSUED WITH SITE PLAN APPLICATION	MAR 3/23	SAZ

SCALE	DESIGN	CHECKED	DRAWN	APPROVED
1:200	SAZ	MSP	MTM	SAZ
0 2 4 6 8				MSP

FOR REVIEW ONLY	DESIGN	CHECKED	DRAWN	APPROVED
	SAZ	MSP	MTM	SAZ
				MSP

**NOVATECH**  
Engineers, Planners & Landscape Architects  
Suite 200, 240 Michael Cowpland Drive  
Ottawa, Ontario, Canada K2M 1P6  
Telephone: (613) 254-9643  
Facsimile: (613) 254-5867  
Website: www.novatech-eng.com

CITY OF OTTAWA  
1826 ROBERTSON ROAD  
LYNWOOD RETAIL PLAZA  
DRAWING NAME  
REMOVALS AND EROSION & SEDIMENT CONTROL PLAN

PROJECT NO.  
106134-00  
REV # 6  
DRAWING NO.  
106134-RM-ESC  
#19127