

**Statistics**

Description	Symbol	Avg	Max	Min	Max/Min	Avg/Min
Combined Pathway		1.4 fc	3.0 fc	0.2 fc	15.0:1	7.1:1
Exit Ramp Lighting	+	0.5 fc	1.1 fc	0.1 fc	11.0:1	5.0:1
Front Entrance DropOff	+	1.7 fc	2.3 fc	1.1 fc	2.1:1	1.5:1
Parking Rooftop	+	1.3 fc	5.2 fc	0.0 fc	N/A	N/A
Roadway Back Laneway	+	1.1 fc	2.6 fc	0.0 fc	N/A	N/A
Roadway Lifestyle Street	+	1.3 fc	2.7 fc	0.3 fc	9.0:1	4.3:1
Roadway March Entrance	+	1.0 fc	3.6 fc	0.2 fc	18.0:1	5.0:1
Walkway Courtyard	+	0.8 fc	6.5 fc	0.0 fc	N/A	N/A
Walkway Lifestyle Legget Park	+	1.7 fc	3.6 fc	0.1 fc	36.0:1	17.0:1
Walkway Lifestyle South	+	1.1 fc	2.6 fc	0.2 fc	13.0:1	5.5:1
Walkway Lifestyle North	+	0.7 fc	1.6 fc	0.1 fc	16.0:1	7.0:1
Walkway March Corner	+	1.4 fc	3.2 fc	0.2 fc	16.0:1	7.0:1

Symbol	Layer	Color	Quantity	Material	Category	Manufacturer	Notes	Quantity	Material	Category	Manufacturer	Notes
A2	2	Light Blue	1	Light Blue	Light Blue	Light Blue	Light Blue	1	Light Blue	Light Blue	Light Blue	Light Blue
A2B	2	Light Blue	1	Light Blue	Light Blue	Light Blue	Light Blue	1	Light Blue	Light Blue	Light Blue	Light Blue
A3	2	Light Blue	1	Light Blue	Light Blue	Light Blue	Light Blue	1	Light Blue	Light Blue	Light Blue	Light Blue
A3B	2	Light Blue	1	Light Blue	Light Blue	Light Blue	Light Blue	1	Light Blue	Light Blue	Light Blue	Light Blue
A4	2	Light Blue	1	Light Blue	Light Blue	Light Blue	Light Blue	1	Light Blue	Light Blue	Light Blue	Light Blue
A4B	2	Light Blue	1	Light Blue	Light Blue	Light Blue	Light Blue	1	Light Blue	Light Blue	Light Blue	Light Blue
A4-S	2	Light Blue	1	Light Blue	Light Blue	Light Blue	Light Blue	1	Light Blue	Light Blue	Light Blue	Light Blue
A5	2	Light Blue	1	Light Blue	Light Blue	Light Blue	Light Blue	1	Light Blue	Light Blue	Light Blue	Light Blue
B2	2	Light Blue	1	Light Blue	Light Blue	Light Blue	Light Blue	1	Light Blue	Light Blue	Light Blue	Light Blue

Symbol	Layer	Color	Quantity	Material	Category	Manufacturer	Notes	Quantity	Material	Category	Manufacturer	Notes
C2	2	Light Blue	1	Light Blue	Light Blue	Light Blue	Light Blue	1	Light Blue	Light Blue	Light Blue	Light Blue
C2-LV	2	Light Blue	1	Light Blue	Light Blue	Light Blue	Light Blue	1	Light Blue	Light Blue	Light Blue	Light Blue
C2B	2	Light Blue	1	Light Blue	Light Blue	Light Blue	Light Blue	1	Light Blue	Light Blue	Light Blue	Light Blue
C3	2	Light Blue	1	Light Blue	Light Blue	Light Blue	Light Blue	1	Light Blue	Light Blue	Light Blue	Light Blue
C3B	2	Light Blue	1	Light Blue	Light Blue	Light Blue	Light Blue	1	Light Blue	Light Blue	Light Blue	Light Blue
C3-LV	2	Light Blue	1	Light Blue	Light Blue	Light Blue	Light Blue	1	Light Blue	Light Blue	Light Blue	Light Blue
C4	2	Light Blue	1	Light Blue	Light Blue	Light Blue	Light Blue	1	Light Blue	Light Blue	Light Blue	Light Blue
C4-LV	2	Light Blue	1	Light Blue	Light Blue	Light Blue	Light Blue	1	Light Blue	Light Blue	Light Blue	Light Blue
D1	2	Light Blue	1	Light Blue	Light Blue	Light Blue	Light Blue	1	Light Blue	Light Blue	Light Blue	Light Blue

Symbol	Layer	Color	Quantity	Material	Category	Manufacturer	Notes	Quantity	Material	Category	Manufacturer	Notes
N2	2	Light Blue	1	Light Blue	Light Blue	Light Blue	Light Blue	1	Light Blue	Light Blue	Light Blue	Light Blue
N3	2	Light Blue	1	Light Blue	Light Blue	Light Blue	Light Blue	1	Light Blue	Light Blue	Light Blue	Light Blue
N4	2	Light Blue	1	Light Blue	Light Blue	Light Blue	Light Blue	1	Light Blue	Light Blue	Light Blue	Light Blue
LBX-WF	2	Light Blue	1	Light Blue	Light Blue	Light Blue	Light Blue	1	Light Blue	Light Blue	Light Blue	Light Blue
LBL-WF	2	Light Blue	1	Light Blue	Light Blue	Light Blue	Light Blue	1	Light Blue	Light Blue	Light Blue	Light Blue
CAT	2	Light Blue	1	Light Blue	Light Blue	Light Blue	Light Blue	1	Light Blue	Light Blue	Light Blue	Light Blue
P	2	Light Blue	1	Light Blue	Light Blue	Light Blue	Light Blue	1	Light Blue	Light Blue	Light Blue	Light Blue
W1	2	Light Blue	1	Light Blue	Light Blue	Light Blue	Light Blue	1	Light Blue	Light Blue	Light Blue	Light Blue
A	2	Light Blue	1	Light Blue	Light Blue	Light Blue	Light Blue	1	Light Blue	Light Blue	Light Blue	Light Blue

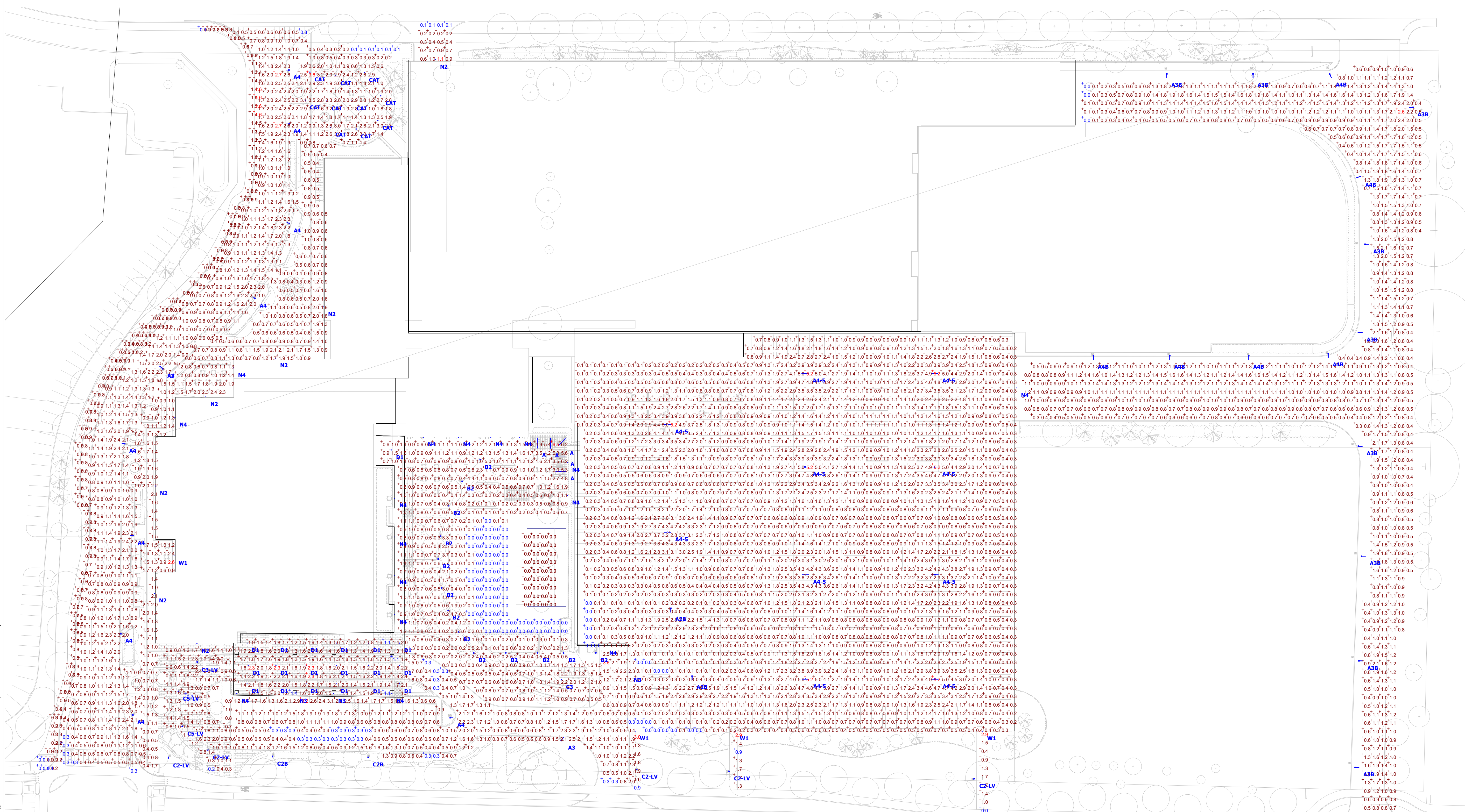

**NOKIA Ottawa Campus**  
 570 March Rd, Kanata/Ottawa ON K2K 2T6  
 BLOCK 6 AND PART OF BLOCK 1 REGISTERED PLAN 4M-642 AND PART OF LOTS 8 AND 9 CONCESSION 4

**Gensler**  
 5005 Greenville Ave  
 Dallas TX 75209  
 Tel 214-273-1500

Surveys: Anns, OSullivan, Volkobak Ltd.  
 Planning Consultant: G.Watson@nokiaottawacampus.com  
 Civil Engineering: F.Hawthorn@nokiaottawacampus.com  
 Mechanical Engineering: E.Hawthorn@nokiaottawacampus.com  
 Electrical Engineering: E.Hawthorn@nokiaottawacampus.com  
 Structural Engineering: E.Hawthorn@nokiaottawacampus.com  
 Landscape Planning: E.Hawthorn@nokiaottawacampus.com  
 CAD: E.Hawthorn@nokiaottawacampus.com  
 GIS: E.Hawthorn@nokiaottawacampus.com  
 A/E/C: E.Hawthorn@nokiaottawacampus.com  
 Construction Management: E.Hawthorn@nokiaottawacampus.com  
 Sustainability: E.Hawthorn@nokiaottawacampus.com

Date: 11/01/2024  
 Description: Issued for SPA Application

**Smith + Andersen**  
 1600 Carling Avenue, Suite 530 Ottawa Ontario K1Z 1G3  
 613 230 1186 | 613 230 2598 smithandandersen.com

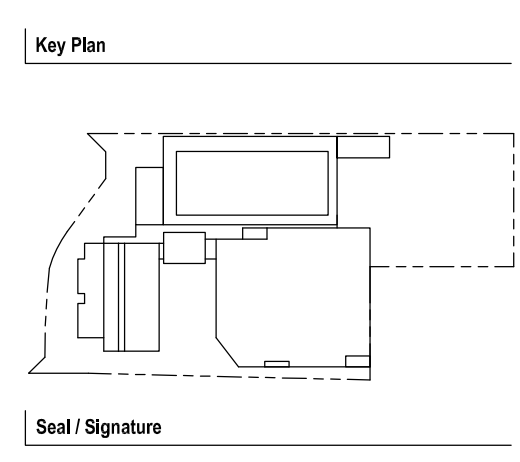

**NOT FOR CONSTRUCTION**

Project Name: Nokia Ottawa Campus  
 Project Number: 027.7946.000  
 Description: Lighting Simulation

Scale: N.T.S.

**E-301**  
 © 2021 Gensler #19202