

PLANNING DEVELOPMENT &
BUILDING SERVICES
DEPARTMENT

KEYPLAN
OR174 EB ON RAMP
NORTH OF ST JOSEPH
BOULEVARD

Transportation Engineering Services



Approved By:
Completed By: NOVATECH
Scale: N.T.S.
Date: DECEMBER 2024

Drawing No.:
RMA-2024
-TPD-035A

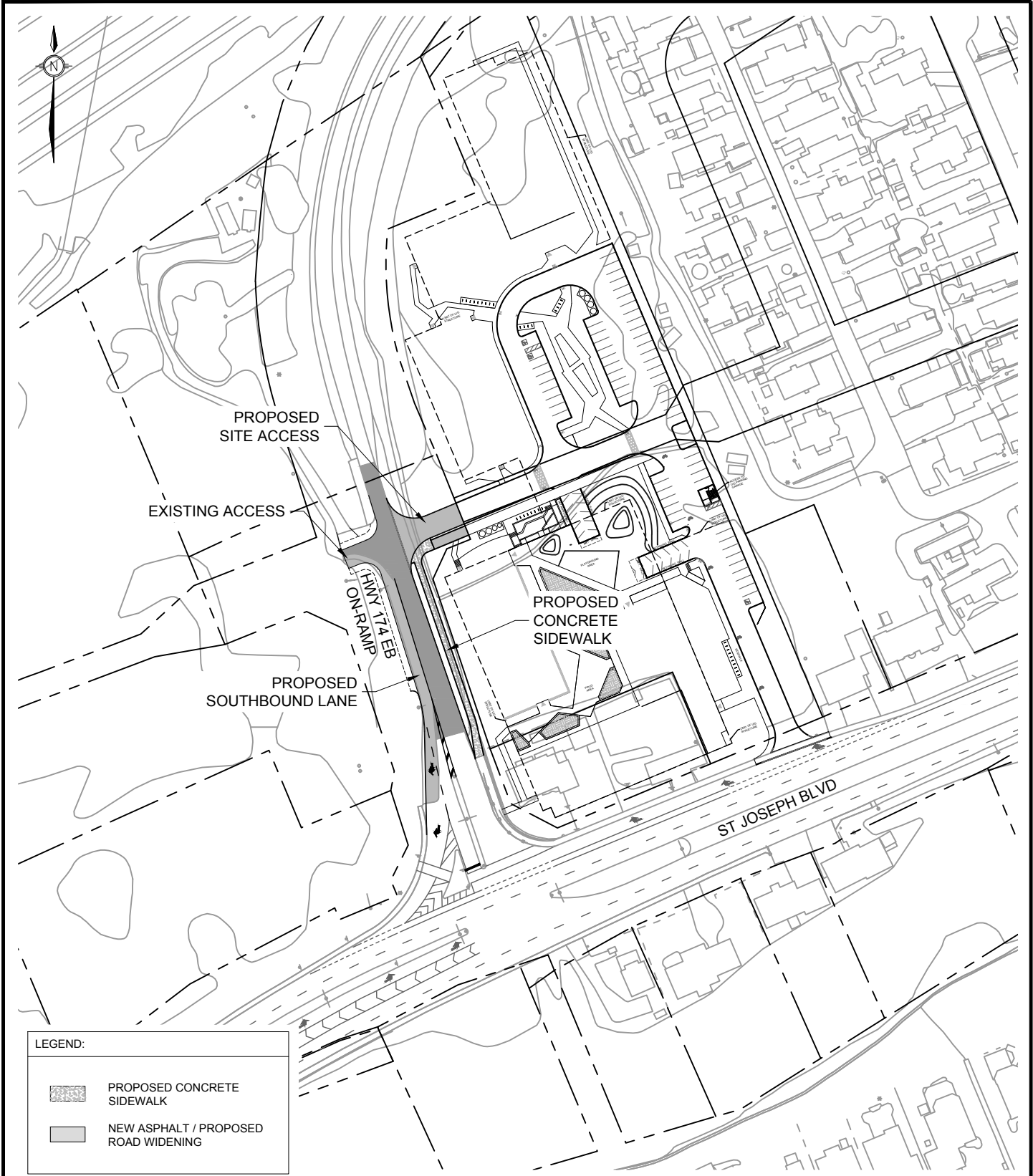
C:\temp\AcPublisher_19912113020-FD.dwg, RMA-DET, Nov 20, 2024 - 3:36pm, rthiller



LEGEND:

-  PROPOSED CONCRETE SIDEWALK
-  NEW ASPHALT / PROPOSED ROAD WIDENING



PLANNING DEVELOPMENT &
BUILDING SERVICES
DEPARTMENT

**PROPOSED ROADWAY
MODIFICATION**
**OR174 EB ON RAMP
NORTH OF ST JOSEPH
BOULEVARD**

Transportation Engineering Services

Approved By:		Drawing No.:
Completed By: NOVATECH		
Scale: N.T.S.	Date: DECEMBER 2024	

**RMA-2024
-TPD-035B**

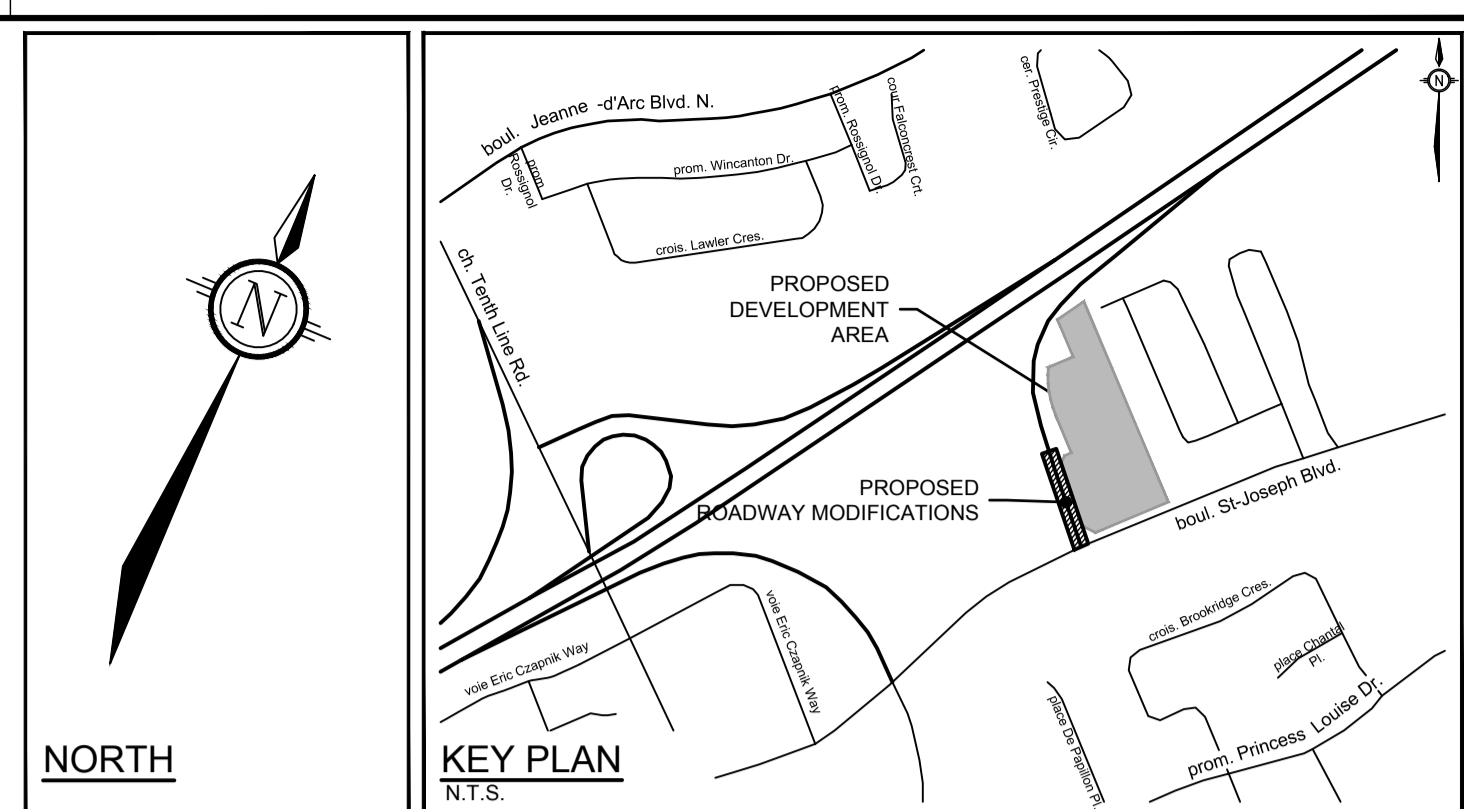
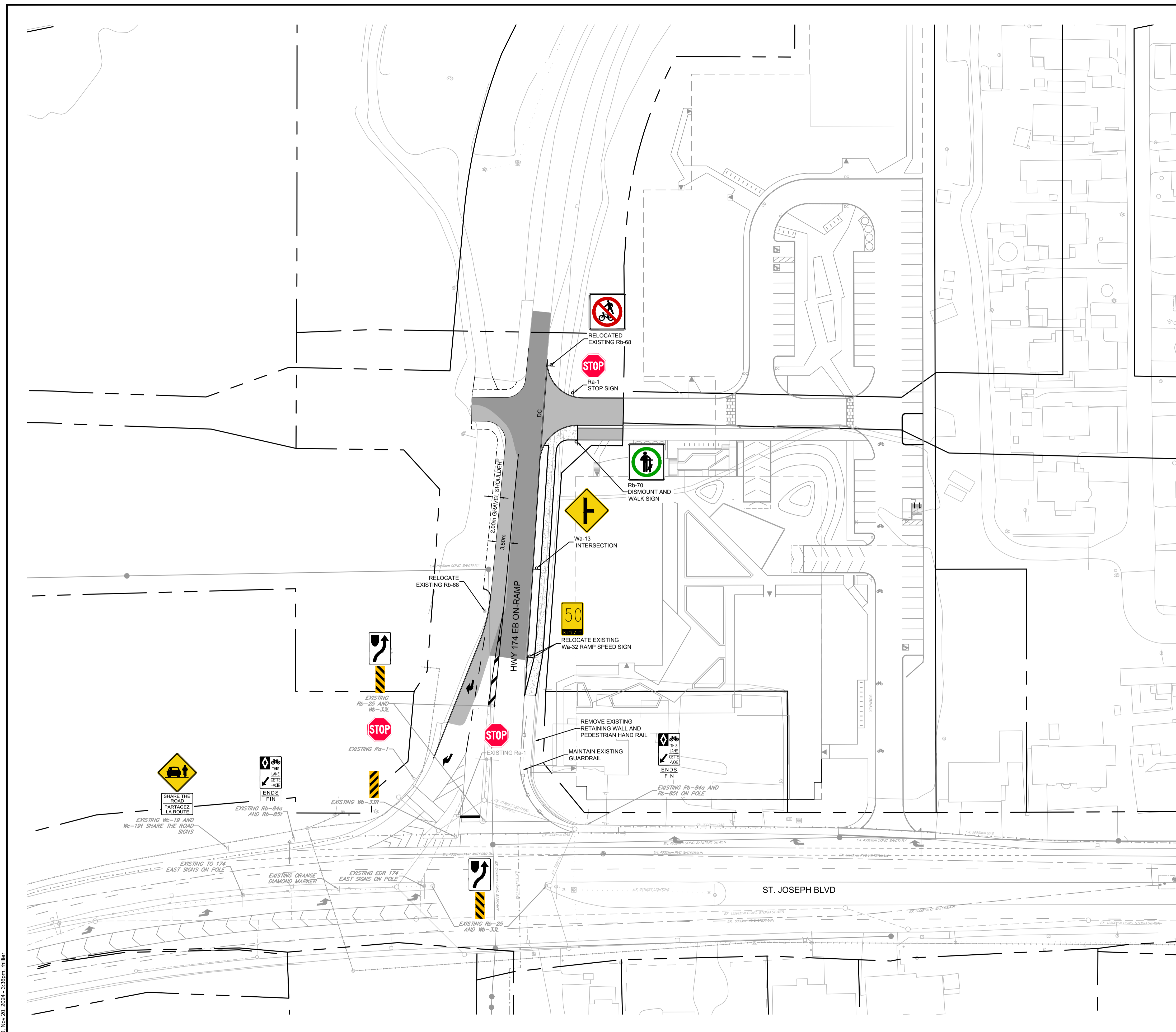

- LEGEND**
- PROPOSED ASPHALT WIDENING
 - PROPOSED ASPHALT REMOVAL AND REGRADING
 - PROPOSED CONCRETE
 - PROPOSED DEPRESSED CURB
 - EXISTING LIGHT STANDARD
 - EXISTING SANITARY MANHOLE
 - EXISTING STORM MANHOLE
 - EXISTING TRAFFIC MANHOLE
 - EXISTING CATCHBASIN
 - EXISTING TREE
 - EXISTING HYDRO DUCT
 - EXISTING BELL DUCT
 - EXISTING ROGERS DUCT
 - EXISTING GAS MAIN
 - EXISTING WATERMAIN
 - EXISTING STREET LIGHT DUCT
 - EXISTING GUIDERAIL

NOTE:
 THE POSITION OF ALL POLE LINES, CONDUITS, WATERMANS, SEWERS AND OTHER UNDERGROUND AND OVERGROUND UTILITIES AND STRUCTURES IS NOT NECESSARILY SHOWN ON THE CONTRACT DRAWINGS, AND WHERE SHOWN, THE ACCURACY OF THE POSITION OF SUCH UTILITIES AND STRUCTURES IS NOT GUARANTEED. BEFORE STARTING WORK, DETERMINE THE EXACT LOCATION OF ALL SUCH UTILITIES AND STRUCTURES AND ASSUME ALL LIABILITY FOR DAMAGE TO THEM.

No.	REVISION	DATE	BY
2.	REVISED PER CITY COMMENTS	NOV 20/24	BJB
1.	ISSUED FOR REVIEW	JUL 12/24	BJB

SCALE	
DESIGN	RCH
CHECKED	JRA
DRAWN	RCH
CHECKED	JRA
APPROVED	BJB

FOR REVIEW ONLY	

NOVATECH
 Engineers, Planners & Landscape Architects
 Suite 200, 240 Michael Cowpland Drive
 Ottawa, Ontario, Canada K2M 1P6
 Telephone: (613) 254-9643
 Facsimile: (613) 254-5867
 Website: www.novatech-eng.com

REFER TO _____ FOR ADDITIONAL NOTES

LOCATION
 CITY OF OTTAWA
 CHARTRO

DRAWING NAME
FUNCTIONAL DESIGN

PROJECT No. 113020
 REV # 2
 DRAWING No. 113020-FD

C:\temp\p\publish_10912\113020-FD.dwg, FD, Nov 20, 2024, - 3:36pm, rhillar