

REFER TO NOTES & SCHEDULES ON DRAWING C-4

**LEGEND**

DRAINAGE AREA

AREA (sq.m)

5 YEAR RUNOFF COEFFICIENT

DRAINAGE BOUNDARY

"A" CONCESSION (NEPEAN) (RIDEAU FRONT)

**KERSTEN NITSCHKE, MCIP RPP**  
MANAGER (A), DEVELOPMENT REVIEW WEST PLANNING, DEVELOPMENT AND BUILDING SERVICES DEPARTMENT, CITY OF OTTAWA

**APPROVED**  
By Kersten Nitschke at 8:36 am, Jan 29, 2025

**POST-DEVELOPMENT DRAINAGE PLAN**

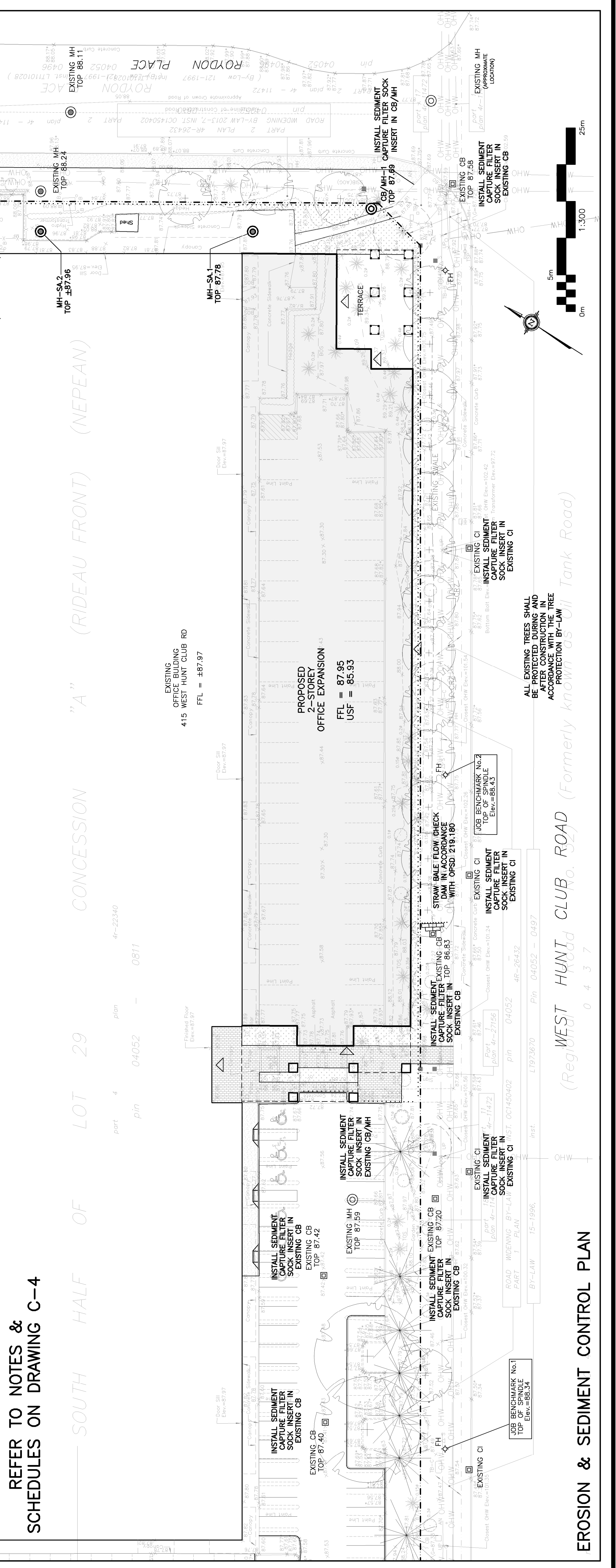

REFER TO NOTES & SCHEDULES ON DRAWING C-4

**EROSION & SEDIMENT CONTROL PLAN**

**LEGEND**

FIRST FLOOR ELEVATION

TOP OF FOUNDATION

UNDERSIDE OF FOOTING

PROPERTY LINE

CRITICAL ROOT ZONE

CATCH BASIN

CURB INLET CATCH BASIN

STORM MANHOLE

CATCH-BASIN/MANHOLE

SANITARY MANHOLE

FIRE HYDRANT

FIRE DEPARTMENT CONNECTION

EXISTING GRADE ELEVATION

PROPOSED GRADE ELEVATION

EXISTING SLOPE OF GRADE

PROPOSED SLOPE OF GRADE

CENTRELINE OF SWALE

150mm BARRIER CURB

DEPRESSED CURB

SILT FENCE BARRIER

CONCRETE

LANDSCAPE

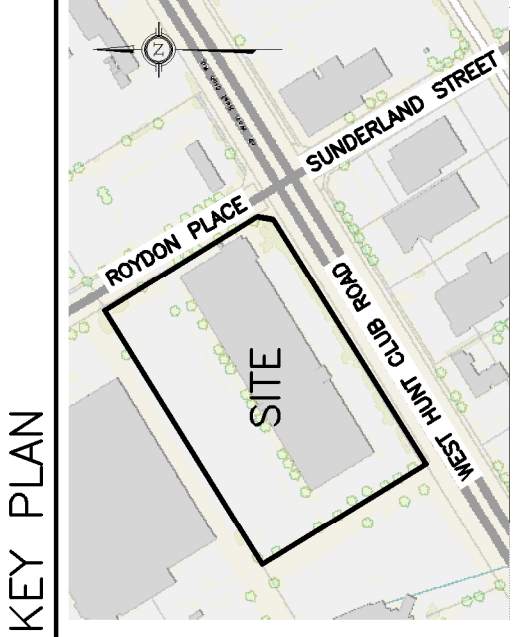

No.	DATE	REVISION
8	JUN 16-25	RE-ISSUED FOR APPROVAL
7	DEC 9-24	RE-ISSUED FOR APPROVAL
6	NOV 26-24	RE-ISSUED FOR APPROVAL
5	AUG 29-24	RE-ISSUED FOR APPROVAL
4	JUL 12-24	ISSUED FOR BUILDING PERMIT
3	JUN 19-24	RE-ISSUED FOR APPROVAL
2	DEC 21-23	ISSUED FOR APPROVAL
1	DEC 14-23	ISSUED FOR COORDINATION

**D.B. GRAY ENGINEERING INC.**  
Professional Engineers, Geologists & Planners, Limited  
700 Long Point Circle  
Ottawa, Ontario  
613-425-8044  
d.gray@dbgrayengineering.com

**PROPOSED 2-STORY OFFICE EXPANSION**  
415 WEST HUNT CLUB RD  
OTTAWA, ONTARIO

**POST-DEVELOPMENT PLAN & EROSION AND SEDIMENT CONTROL PLAN**

**PROFESSIONAL ENGINEER**  
D.B. GRAY  
OCT 10 1983  
CAN 16-253

Drawn: D.B.G.  
H. Scale  
V. Scale  
Date: DEC 14-23  
Job No.: 22893

Drawing No.: **C-3** of **4**

#19200

NOT VALID UNLESS SIGNED & DATED