

- TREE PROTECTION REQUIREMENTS**
- PRIOR TO ANY WORK ACTIVITY WITHIN THE CRITICAL ROOT ZONE (CRZ) - 10 X DIAMETER OF A TREE, TREE PROTECTION FENCING MUST BE INSTALLED SURROUNDING THE CRITICAL ROOT ZONE, AND REMAIN IN PLACE UNTIL THE WORK IS COMPLETE.
 - UNLESS PLANS ARE APPROVED BY CITY FORESTRY STAFF, FOR WORK WITHIN THE CRZ:
DO NOT PLACE ANY MATERIAL OR EQUIPMENT - INCLUDING OUTRIGGERS -
DO NOT ATTACH ANY SIGNS, NOTICES OR POSTERS TO ANY TREE,
DO NOT RAISE OR LOWER THE EXISTING GRADE,
DO NOT DAMAGE THE ROOT SYSTEM, TRUNK, OR BRANCHES OF ANY TREE,
DO NOT EXHAUST FUMES FROM ALL EQUIPMENT ARE NOT DIRECTED TOWARD ANY TREE CANOPY,
DO NOT EXTEND HARD SURFACE OR SIGNIFICANTLY CHANGE LANDSCAPING.
 - TREE PROTECTION FENCING MUST BE AT LEAST 1.2M IN HEIGHT, AND CONSTRUCTED OF RIGID OR FLEXIBLE MATERIALS (E.G. MODULOC-STEEL, PLYWOOD HOARDING, OR SNOW FENCE ON 4"x4" WOOD FRAMING) WITH POSTS 2.0M APART. SUCH THAT THE FENCE LOCATION CANNOT BE ALTERED. ALL SUPPORTS AND BRACING MUST BE APPROVED BY CITY FORESTRY STAFF PRIOR TO THE COMMENCEMENT OF WORK. SEE DETAIL.
 - THE LOCATION OF THE TREE PROTECTION FENCING MUST BE DETERMINED BY AN ARBORIST AND DETAILED ON ANY ASSOCIATED PLANS FOR THE SITE (E.G. TREE CONSERVATION REPORT, TREE INFORMATION REPORT, ETC). THE PLAN AND CONSTRUCTION OF FENCING MUST BE APPROVED BY CITY FORESTRY STAFF PRIOR TO THE COMMENCEMENT OF WORK.
 - IF THE EXISTING TREE PROTECTION AREA MUST BE MODIFIED TO FACILITATE CONSTRUCTION, MITIGATION MEASURES MUST BE PRESCRIBED BY AN ARBORIST AND APPROVED BY CITY FORESTRY STAFF. THESE MAY INCLUDE THE PLACEMENT OF PLYWOOD, WOOD CHIPS, OR STEEL PLATING OVER THE ROOTS FOR PROTECTION OR THE PROPER PRUNING AND CARE OF ROOTS WHERE ENCOUNTERED.
- THE CITY'S TREE PROTECTION BYLAW PROTECTS BOTH CITY-OWNED TREES, CITY-WIDE, AND PRIVATELY OWNED TREES WITHIN THE URBAN AREA. PLEASE REFER TO WWW.OTTAWA.CA/TREELAW FOR MORE INFORMATION ON HOW THE TREE BY-LAW APPLIES.
- ACCESSIBLE FORMATS AND COMMUNICATION SUPPORTS ARE AVAILABLE UPON REQUEST



TREE PROTECTION SPECIFICATION

TO BE IMPLEMENTED FOR RETAINED TREES, BOTH ON SITE AND ON ADJACENT SITES, PRIOR TO ANY TREE REMOVAL OR SITE WORKS AND MAINTAINED FOR THE DURATION OF WORK ACTIVITIES ON SITE.

SCALE: NTS
DATE: MARCH 2021
DRAWING NO.: 1 of 1

3 TREE PROTECTION FENCE
SCALE NTS

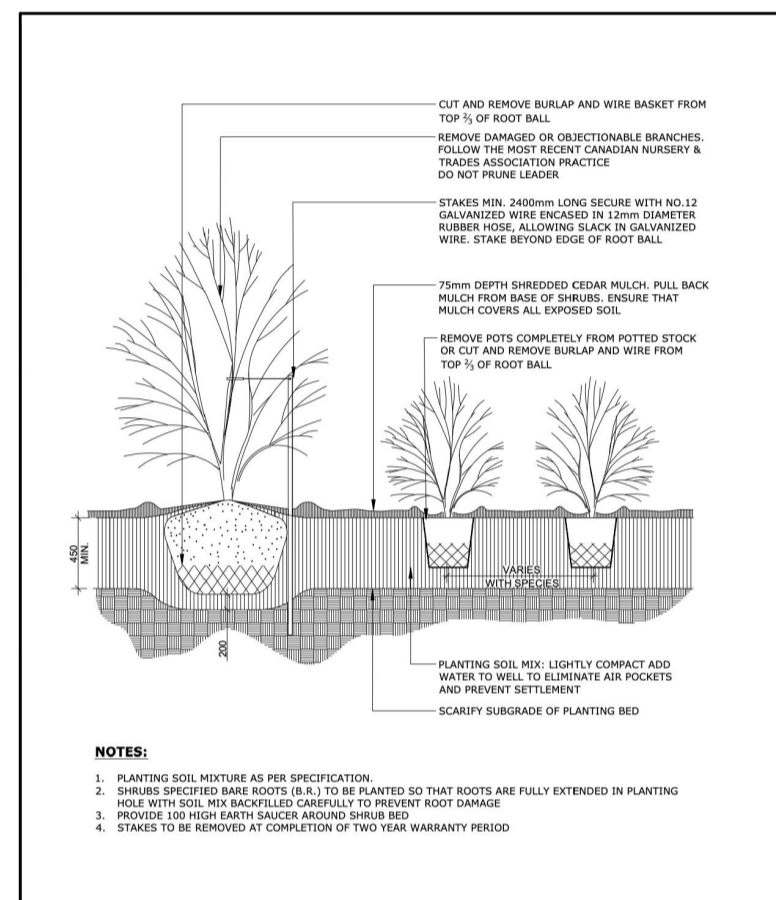
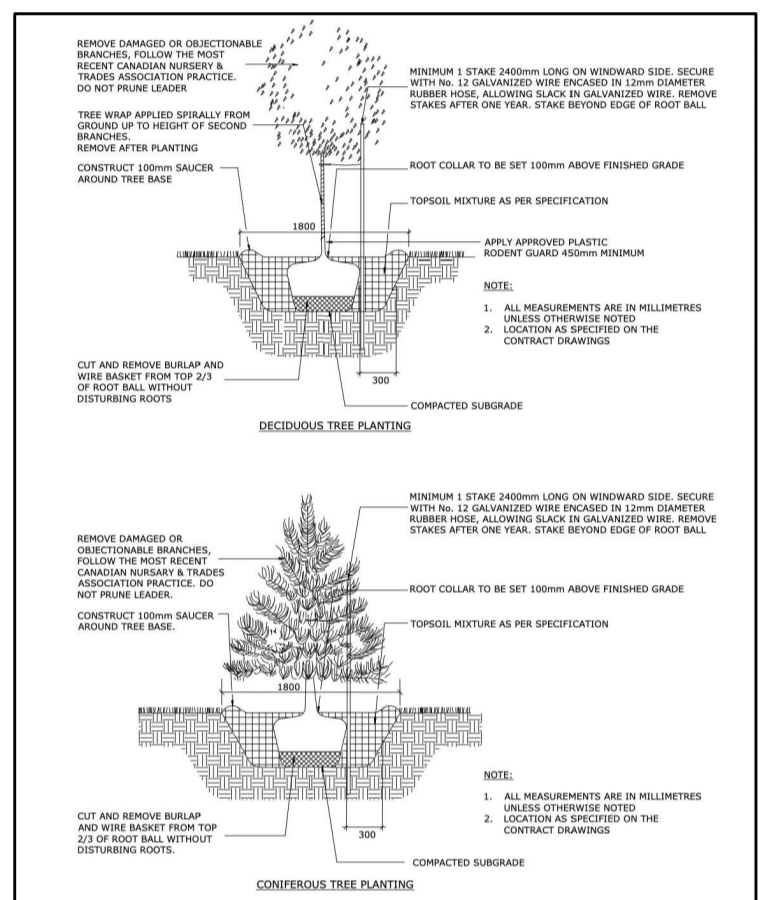

4 TREE PLANTING
SCALE NTS

DATE: MAY 2023
REV: JAN 2017
DRAW NO. L2

5 SHRUB / ORNAMENTAL GRASS PLANTING
SCALE NTS

DATE: FEB 2023
REV: FEB 2014
DRAW NO. L17

PROPOSED PLANT LIST

KEY	QTY	BOTANICAL NAME	COMMON NAME	SIZE	CONDITION	NOTES	ORIGIN
DECIDUOUS TREES							
AF	4	<i>Acer x freemanii</i>	Freeman's Maple	50mm cal.	B&B		Native
CO	4	<i>Celtis occidentalis</i>	Hackberry	50mm cal.	B&B		Native
GS	2	<i>Gleditsia tricanthos 'Skyline'</i>	Skyline Honey Locust	50mm cal.	B&B		Native
SHRUBS							
Ss	100	<i>Sorbaria sorbifolia 'Sem'</i>	Sem False Spirea	600mm HT	Potted	Space 800mm o.c.	Non-native
ORNAMENTAL GRASSES							
ca	40	<i>Calamagrostis x acutiflora 'Karl Foerster'</i>	Karl Foerster Grass	250mm pot	Potted	Space 800mm o.c.	Non-native

EXISTING TREE LIST

KEY	QTY	BOTANICAL NAME	COMMON NAME	SIZE	CONDITION	CRITICAL ROOT ZONE	ACTION	OWNERSHIP	COMMENTS
DECIDUOUS TREES									
1	1	<i>Acer x freemanii</i>	Freeman's Maple	150mm dbh	GOOD	1500mm	To Remain	City of Ottawa	
2	1	<i>Acer x freemanii</i>	Freeman's Maple	140mm dbh	GOOD	1400mm	To Remain	City of Ottawa	
3	1	<i>Acer x freemanii</i>	Freeman's Maple	140mm dbh	GOOD	1400mm	To Remain	City of Ottawa	
4	1	<i>Acer x freemanii</i>	Freeman's Maple	150mm dbh	GOOD	1500mm	To Remain	City of Ottawa	
5	1	<i>Acer x freemanii</i>	Freeman's Maple	100mm dbh	GOOD	1000mm	To Remain	City of Ottawa	
6	1	<i>Quercus rubra</i>	Red Oak	120mm dbh	GOOD	1200mm	To Remain	City of Ottawa	
7	1	<i>Quercus rubra</i>	Red Oak	160mm dbh	GOOD	1600mm	To Remain	City of Ottawa	
8	1	<i>Quercus rubra</i>	Red Oak	130mm dbh	GOOD	1300mm	To Remain	City of Ottawa	
9	1	<i>Juglans cinerea</i>	Butternut	300mm dbh	DEAD	3000mm	To be Removed	4 The Pkwy, Kanata	
10	1	<i>Syringa sp.</i>	Lilac	7x100-150mm dbh	GOOD	1000-1500mm	To Remain	4 The Pkwy, Kanata	Multi-stem
11	1	<i>Tilia americana</i>	American Basswood	6x150-270mm dbh	GOOD	1500-2700mm	To Remain	4 The Pkwy, Kanata	Multi-stem
12	1	<i>Tilia americana</i>	American Basswood	2x540-580mm dbh	FAIR	5400-5800mm	To Remain	4 The Pkwy, Kanata	Multi-stem
13	1	<i>Rhus typhina</i>	Staghorn Sumac	3x100-150mm dbh	DEAD	1000-1500mm	To be Removed	4 The Pkwy, Kanata	Multi-stem
14	1	<i>Fraxinus sp.</i>	Ash	2x290-410mm dbh	DEAD	2900-4100mm	To be Removed	4 The Pkwy, Kanata	Multi-stem
15	1	<i>Malus</i>	Crabapple	2x 120-180mm dbh	GOOD	1200-1800mm	To Remain	4 The Pkwy, Kanata	Multi-stem
16	1	<i>Acer spicata</i>	Amur Maple	5x 80-100mm dbh	GOOD	800-1000mm	To Remain	4 The Pkwy, Kanata	Multi-stem
17	1	<i>Acer platanoides</i>	Norway Maple	280mm dbh	GOOD	2800mm	To Remain	4 The Pkwy, Kanata	Multi-stem
18	1	<i>Acer platanoides</i>	Norway Maple	300mm dbh	GOOD	3000mm	To Remain	4 The Pkwy, Kanata	Multi-stem
19	1	<i>Acer platanoides</i>	Norway Maple	300mm dbh	FAIR, CANKER	3000mm	To Remain	4 The Pkwy, Kanata	Multi-stem
20	1	<i>Acer platanoides</i>	Norway Maple	300mm dbh	GOOD	3000mm	To Remain	4 The Pkwy, Kanata	Multi-stem
21	1	<i>Acer platanoides</i>	Norway Maple	300mm dbh	GOOD	3000mm	To Remain	4 The Pkwy, Kanata	Multi-stem
22	1	<i>Acer platanoides</i>	Norway Maple	2x220-260mm dbh	GOOD	2200-2600mm	To Remain	4 The Pkwy, Kanata	Multi-stem
23	1	<i>Malus sp.</i>	Crabapple	2x240-400mm dbh	GOOD	2400-4000mm	To Remain	4 The Pkwy, Kanata	Multi-stem
24	1	<i>Malus sp.</i>	Crabapple	120mm dbh	GOOD	1200mm	To Remain	4 The Pkwy, Kanata	Multi-stem
25	1	<i>Acer platanoides</i>	Norway Maple	3x130-420mm dbh	GOOD	1300-4200mm	To Remain	4 The Pkwy, Kanata	Multi-stem
26	1	<i>Pinus nigra</i>	Austrian Pine	420mm dbh	GOOD	4200mm	To Remain	4 The Pkwy, Kanata	Multi-stem
27	1	<i>Pinus nigra</i>	Austrian Pine	470mm dbh	GOOD	4700mm	To Remain	4 The Pkwy, Kanata	Multi-stem
28	1	<i>Gleditsia tricanthos</i>	Honey Locust	5x90-160mm dbh	GOOD	900-1600mm	To Remain	4 The Pkwy, Kanata	Multi-stem
29	1	<i>Juglans nigra</i>	Black Walnut	190mm dbh	GOOD	1900mm	To Remain	City of Ottawa	
30	1	<i>Quercus macrocarpa</i>	Burr Oak	140mm dbh	GOOD	1400mm	To Remain	City of Ottawa	
31	1	<i>Acer rubrum</i>	Red Maple	170mm dbh	GOOD	1700mm	To Remain	City of Ottawa	
32	1	<i>Acer saccharum</i>	Sugar Maple	150mm dbh	GOOD	1500mm	To Remain	4 The Pkwy, Kanata	80% canopy
33	1	<i>Celtis occidentalis</i>	Hackberry	200mm dbh	GOOD	2000mm	To Remain	City of Ottawa	
34	1	<i>Pinus strobus</i>	White Pine	170mm dbh	GOOD	1700mm	To Remain	4 The Pkwy, Kanata	
35	1	<i>Acer rubrum</i>	Red Maple	160mm dbh	GOOD	1600mm	To Remain	4 The Pkwy, Kanata	
36	1	<i>Quercus macrocarpa</i>	Burr Oak	110mm dbh	GOOD	1100mm	To Remain	City of Ottawa	

GENERAL NOTES:

- IT IS THE RESPONSIBILITY OF THE APPROPRIATE CONTRACTOR OR OFFICIAL TO REPORT ANY ERRORS, OMISSIONS OR DISCREPANCIES ON THIS PLAN WITH ACTUAL SITE CONDITIONS TO THE LANDSCAPE ARCHITECT BEFORE PROCEEDING WITH CONSTRUCTION.
- THE CONTRACTOR IS TO NOTIFY ALL UTILITY COMPANIES AND AUTHORITIES PRIOR TO ANY EXCAVATION AND ASCERTAIN LOCATIONS OF UNDERGROUND SERVICES.
- THE CONTRACTOR IS TO REINSTATE ALL AREAS AND ITEMS DAMAGED AS A RESULT OF CONSTRUCTION ACTIVITY.
- THE CONTRACTOR IS TO COMPLY WITH ALL PERTINENT CODES AND BY-LAWS.
- THE CONTRACTOR IS TO MAINTAIN A POSITIVE SURFACE RUN-OFF THROUGHOUT THE ENTIRE CONSTRUCTION PERIOD.
- THE LANDSCAPE ARCHITECT IS NOT RESPONSIBLE FOR SUBSURFACE CONDITIONS.
- THE CONTRACTOR IS TO IDENTIFY ALL EXISTING TREES TO REMAIN ON SITE WITH THE LANDSCAPE ARCHITECT PRIOR TO CONSTRUCTION.
- THE CONTRACTOR IS TO STAKE THE PROPOSED LOCATION OF ALL PLANT MATERIAL IN CONJUNCTION WITH THE LANDSCAPE ARCHITECT PRIOR TO EXCAVATION.
- MINIMUM DISTANCES FOR SELECTED DECIDUOUS TREES ARE AS FOLLOWS:
9.1. BUILDING FOUNDATIONS - 7.5M
9.2. SIDEWALKS - 1.5M
9.3. PUBLIC STREETS - 2.5M
9.4. UNDERGROUND INFRASTRUCTURE - 2.0M
- ALL TREES WITHIN 1M OF UNDERGROUND UTILITY TRENCHES ARE TO BE EXCAVATED BY HAND.
- REMOVE ALL PROTECTIVE WRAPPING FROM TREE TRUNKS AFTER INSTALLATION.
- STAKING OF TREES SHALL ONLY BE PERFORMED IF NECESSARY.
- ENSURE THAT MULCH IS PULLED BACK A MINIMUM DISTANCE OF 75MM FROM BASE OF TREE TRUNK.
- PROPOSED TREE SOIL VOLUME IS CALCULATED WITH A DEPTH OF 1.5m.

LEGEND:

- PROPOSED ASPHALT (AS PER ARCH)
- EXISTING CONCRETE TO REMAIN
- PROPOSED CONCRETE
- EXISTING GRASS TO REMAIN
- PROPOSED SOD
- TREE SOIL VOLUME (DEPTH OF 1.5m)
- PROPOSED BIKE RACK
- PROPOSED SHRUBS / PERENNIALS
- GROUP OF EXISTING TREES TO REMAIN
- EXISTING TREE TO REMAIN
- EXISTING TREE TO BE REMOVED
- PROPOSED DECIDUOUS TREE
- LIGHT STANDARD (SEE ARCH)
- PROPERTY LINE
- TREE PROTECTION FENCE

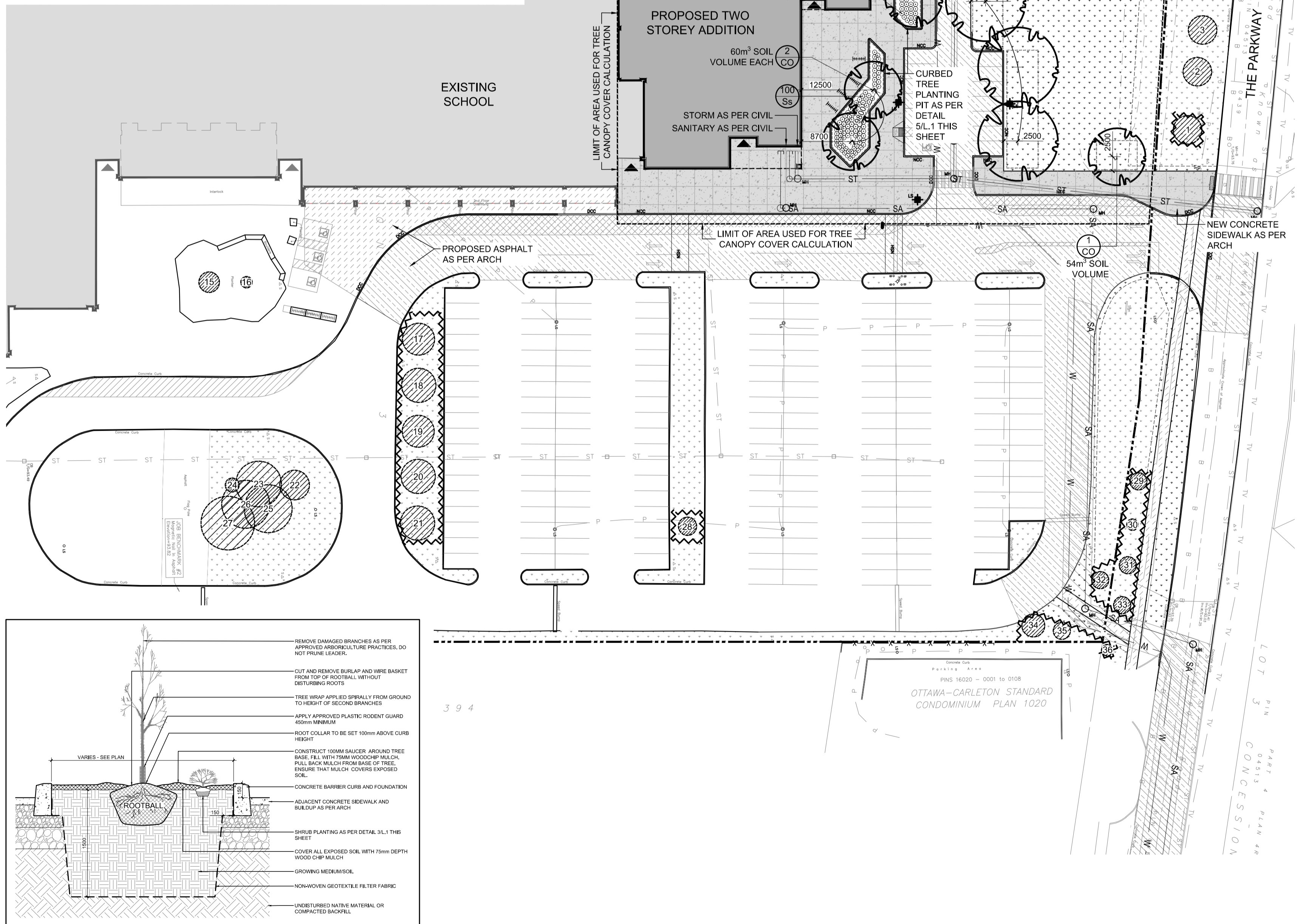

2 TREE CURBED PLANTING PIT
SCALE NTS

1 TREE CONSERVATION REPORT & LANDSCAPE PLAN
SCALE 1:500

OTTAWA-CARLETON DISTRICT SCHOOL BOARD

1	0	2024/12/12	ISSUED FOR SITE PLAN CONTROL
ISSUE NO.	REV. NO.	DATE	ISSUE

KEY PLAN

SCALE 1:15,000

CANOPY COVER DIAGRAM

NOTE:
PROPOSED TREES SHOWN AT 40-YEAR CANOPY PROJECTIONS:
- 3m CANOPY DIAMETER FOR SMALL TREES
- 10m CANOPY DIAMETER FOR MEDIUM TREES
- 14m CANOPY DIAMETER FOR LARGE TREES

40-YEAR PROJECTED TREE CANOPY CALCULATION CHART

PROPOSED TREE CANOPY COVERAGE TOTAL	1010m ²
EXISTING TREE CANOPY COVERAGE TOTAL	1709m ²
SITE AREA	14,044m ²
PROPOSED SITE CANOPY COVER	19.4%
CANOPY COVER TARGET	40%
EXISTING CANOPY COVER	12.2%

JAMES B. LENNOX & ASSOCIATES INC. LANDSCAPE ARCHITECTS
3332 CARLING AVE. OTTAWA, ONTARIO K2H 5A8
Tel: (613) 722-5168 Fax: (866) 343-3942

PROJECT TITLE
EARL OF MARCH SECONDARY SCHOOL ADDITION 2024
4 THE PARKWAY
KANATA, ON. K2K 1Y4

OTTAWA-CARLETON DISTRICT SCHOOL BOARD
133 GREENBANK RD, OTTAWA

DRAWING TITLE
TREE CONSERVATION REPORT AND LANDSCAPE PLAN

SCALE	AS SHOWN	PROJ. NO.	ISSUE NO.	REV. NO.
		24EJC2412	1	0
DRAWN BY	WF	DRAWING	L.1	
CHECKED BY	JL			
DATE	2024			