

**PATERSON
GROUP**

memorandum

re: Foundation Insulation Detail
Proposed Building Addition
158 Cardevco Road – Ottawa

to: Whelan Truck Repair

c/o: Pri-Tec Construction Ltd. – **Mr. Mike Watters** – mike@pritec.ca

date: October 6, 2022

file: PG6233-MEMO.01

Further to your request, Paterson has prepared the current memo to provide our recommended foundation insulation detail for the proposed building addition to be located at the aforementioned site. The foundation insulation detail is provided on the attached Figure 1.

This foundation insulation detail would apply where the soil cover from the underside of footing (USF) elevation to the finished grade is between 2.5 and 5 feet. Where the soil cover is greater than, or equal to, 5 feet above the USF elevation, this foundation insulation detail would not be required as sufficient soil cover would be in place.

We trust that this Information satisfies your immediate requirements.

Best Regards,

Paterson Group Inc.

Scott S. Dennis, P.Eng.



Ottawa Head Office
9 Auriga Drive
Ottawa – Ontario – K2E 7T9
Tel: (613) 226-7381

Ottawa Laboratory
28 Concourse Gate
Ottawa – Ontario – K2E 7T7
Tel: (613) 226-7381

Northern Office and Laboratory
63 Gibson Street
North Bay – Ontario – P1B 8Z4
Tel: (705) 472-5331



patersongroup.ca

FIGURE 1

**Typical Foundation Insulation
Cross Section**

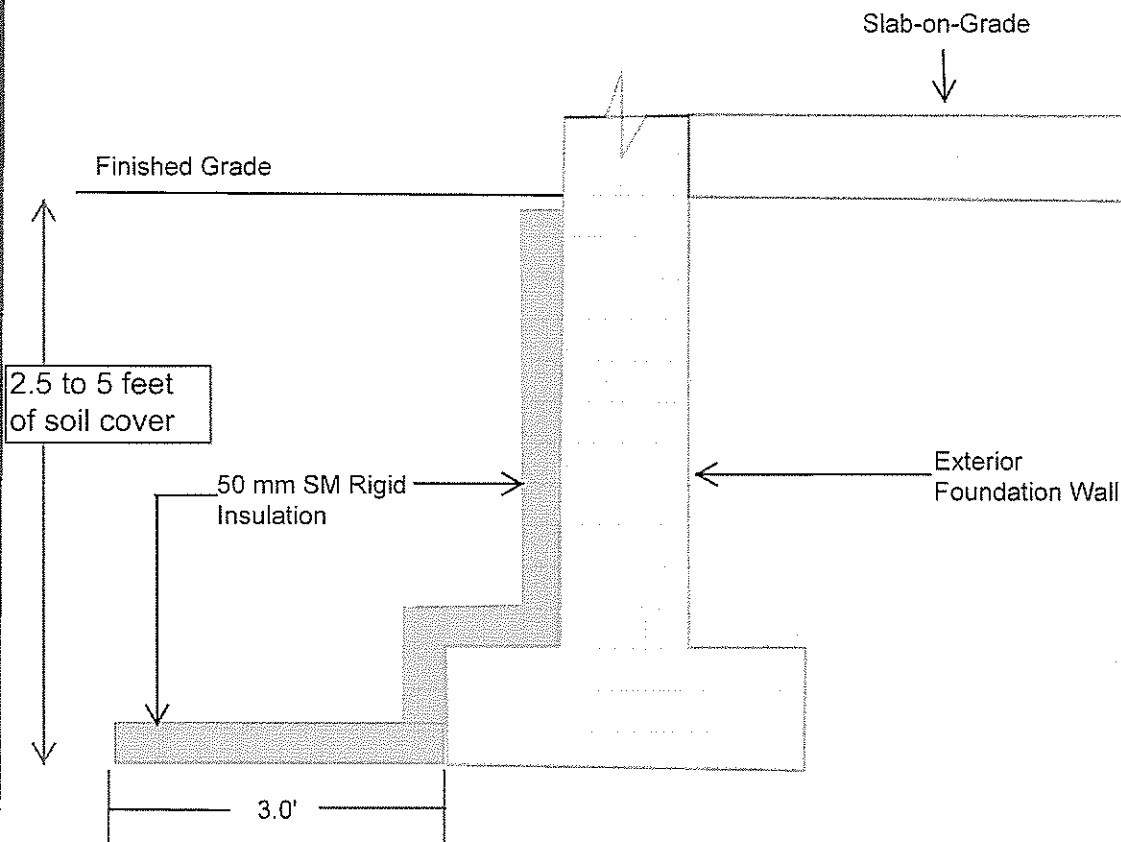

This detail applies where there is between 2.5 and 5 feet of soil cover above the underside of footing (USF) elevation. Where the soil cover is equal to, or greater than, 5 feet, the foundation insulation can be omitted.