

CLIENT
ROHIT COMMUNITIES

550 91 STREET SW #101, EDMONTON, AB T6X0V1

BLOCK-5 PIN NUMBER - 04273-1231

COPYRIGHT
This drawing has been prepared solely for the intended use, thus any reproduction or distribution for any purpose other than authorized by Arcadis is forbidden. Written dimensions shall have precedence over scaled dimensions. Contractors shall verify and be responsible for all dimensions and conditions on the job, and Arcadis shall be informed of any variations from the dimensions and conditions shown on the drawing. Shop drawings shall be submitted to Arcadis for general conformance before proceeding with fabrication.

Arcadis Professional Services (Canada) Inc.
is a part of Arcadis

ISSUES

No.	DESCRIPTION	DATE
1	ISSUED FOR SPA SUBMISSION	2023-12-18
2	ISSUED FOR SPA SUBMISSION	2024-02-21
3	ISSUED FOR SPA SUBMISSION	2024-04-30
4	ISSUED FOR SPA SUBMISSION	2024-08-09

LEGEND

	TOPSOIL AND SOD AS SPECIFIED
	MINIMUM 150mm TOPSOIL DEPTH
	CONCRETE PAVING
	PROPOSED TREE
	PROPOSED SHRUBS
	PROPOSED PERENNIALS
	PROPOSED ORNAMENTAL GRASSES
	PLANT SPECIES QUANTITY
	DETAIL NUMBER
	SHEET NUMBER
	EXISTING TREE TO REMAIN AND BE PROTECTED
	TREES TO BE TRANSPLANTED NEW LOCATION OF TRANSPLANTED TREE

REFER TO TRANSPLANT NOTES AND TREE TABLE ON THIS SHEET FOR MORE DETAILS

CONSULTANTS
CIVIL: ARCADIS PROFESSIONAL SERVICES (CANADA) INC.
LANDSCAPE: ARCADIS PROFESSIONAL SERVICES (CANADA) INC.
SURVEY: ANNS O. SULLIVAN, VOLLBERG LTD.
ARCHITECTURE: NORR ARCHITECTS & ENGINEERING LTD.
STRUCTURAL: CUNLIFFE & ASSOCIATES
MECHANICAL: GOODKEY, WEEDMARK & ASSOCIATES LTD.
ELECTRICAL: GOODKEY, WEEDMARK & ASSOCIATES LTD.
OWNER: ROHIT AT WATERIDGE 5 LTD.



PLANT SCHEDULE:

KEY	QTY.	BOTANICAL NAME	COMMON NAME	CALIPER SIZE (mm)	SIZE (cm)	CONDITION FORM	MIN. O.C. SPACING (m)	OWNERSHIP
TREES								
AI	3	<i>Acer × freemanii 'Inferno'</i>	Aulm Blue Maple	50	3 Gal	1	10	Private
Al	4	<i>Ametanchoer lasius</i>	Allegheny serviceberry	50	W. B.	6	6	Private
ARA	2	<i>Acer rubrum 'Armstrong'</i>	Armstrong Maple	50	W. B.	6	6	Private
LF	3	<i>Liriodendron tulipifera 'Fragrantella'</i>	Common Tulip Tree	50	W. B.	6	6	Private
PaB	5	<i>Platanus × acerifolia 'Bloodgood'</i>	Bloodgood Plane Tree	50	W. B.	10	10	Private
PpG	4	<i>Picea pungens 'var. glauca'</i>	Colorado Blue Spruce	150	W. B.	6	6	Private
Q	3	<i>Quercus alba</i>	Northern Red Oak	50	W. B.	10	10	Private
TOTAL:	24							
TRANSPLANTED TREES								
1	1	<i>Carpinus caroliniana 'Unbridge'</i>	Rising Fire Hornbeam					
2	1	<i>Carpinus caroliniana 'Unbridge'</i>	Rising Fire Hornbeam					
3	1	<i>Ulmus americana 'Princeton'</i>	Princeton Elm					
4	1	<i>Quercus macrocarpa 'JFS didgeronsoni'</i>	Northern Seabird Honeylocust					
5	1	<i>Quercus alba</i>	White Oak					
6	1	<i>Quercus alba</i>	White Oak					
SHRUBS								
HA	45	<i>Hydrangea aborescens 'Annabelle'</i>	Annabelle Hydrangea	60cm	3 Gal	1	1	Private
HdP	65	<i>Hydrangea paniculata 'Strawberry Sundae'</i>	Strawberry Sundae Hydrangea	60cm	3 Gal	1	1	Private
Js	51	<i>Juniperus sabina</i>	Savin Juniper	50cm	3 Gal	1	1	Private
SW	315	<i>Sorbaria japonica 'Walburna'</i>	Magic Carpet Sorbaria	40cm	3 Gal	0.5	0.5	Private
SmP	25	<i>Spring meyer 'Platin'</i>	Spring Meyer Lilac	60cm	3 Gal	1.5	1.5	Private
TmH	38	<i>Taxus cuspidata 'nana'</i>	Dwarf Japanese Yew	60cm	3 Gal	1	1	Private
ToE	35	<i>Taxus occidentalis 'Emerald'</i>	Emerald Cedar	175 cm	10 Gal	2	2	Private
WV	28	<i>Weigela florida 'Nana Variegata'</i>	Dwarf Variegated Weigela	50cm	3 Gal	1	1	Private
WV	54	<i>Weigela florida 'Vallberg'</i>	My Monet Weigela	50cm	3 Gal	1	1	Private
TOTAL:	656							
PERENNIALS & GRASSES								
CaK	185	<i>Calamagrostis acutiflora 'Karl Foerster'</i>	Karl Foerster Feather Reed Grass		1 Gal	0.5	0.5	Private
FgE	180	<i>Festuca glauca 'Elijah Blue'</i>	Blue Fescue		1 Gal	0.5	0.5	Private
Hs	130	<i>Heuchera × 'Berry Smoothie'</i>	Berry Smoothie Coral Bell		1 Gal	0.5	0.5	Private
HcF	110	<i>Heuchera × 'Cajun Fire'</i>	Cajun Fire Coral Bell		1 Gal	0.5	0.5	Private
Hg	305	<i>Heuchera × 'Guacamole'</i>	Guacamole Coral Bell		1 Gal	0.5	0.5	Private
Hs	452	<i>Hemerocallis 'Stella de Oro'</i>	Stella de Oro Daylily		1 Gal	0.5	0.5	Private
MaP	26	<i>Miscanthus sinensis 'Fire Dragon'</i>	Fire Dragon Flame Grass		1 Gal	0.5	0.5	Private
MaP	123	<i>Miscanthus sinensis 'Purpureascens'</i>	Flame Grass		1 Gal	0.5	0.5	Private
TOTAL:	1471							

LANDSCAPE NOTES:

- ALL WORK TO BE CARRIED OUT IN ACCORDANCE WITH BY-LAWS AND CODES HAVING JURISDICTION OVER SITE LOCATION.
- COMPLETE ALL WORK TO THE SATISFACTION OF THE LANDSCAPE ARCHITECT.
- REPORT ANY CHANGES, DISCREPANCIES OR SUBSTITUTIONS TO THE LANDSCAPE ARCHITECT FOR REVIEW. OBTAIN APPROVAL FROM THE LANDSCAPE ARCHITECT BEFORE PROCEEDING.
- IT IS THE CONTRACTOR'S RESPONSIBILITY TO DETERMINE EXISTING SERVICE LOCATIONS.
- EXACT LOCATIONS OF PLANT MATERIAL WILL BE DETERMINED BY PLACEMENT OF SITE SERVICES SUCH AS HYDRO VAULTS, METERS, UTILITIES ROOF RAIN WATER LEADERS, DRIVEWAYS, LIGHT STANDARDS, ETC.
- ALL PLANT MATERIAL LOCATIONS TO BE STAKED OR MARKED OUT AND APPROVED BY LANDSCAPE ARCHITECT PRIOR TO INSTALLATION.
- SUPPLY ALL PLANT MATERIAL IN ACCORDANCE WITH THE CANADIAN STANDARDS FOR NURSERY STOCK (8th Ed.).
- INSTALL PLANT MATERIAL ACCORDING TO DETAILS SHOWN.
- DISTURBED SOIL AREAS AROUND TREES AND SHRUBS ARE TO BE COVERED WITH SHREDDED CONIFER BARK MULCH SUCH AS 'CANADA RED' OR 'GRO-BARK' SPM MULCH, OR APPROVED EQUIVALENT. ALTERNATIVE MULCHES MUST BE APPROVED BY THE LANDSCAPE ARCHITECT.
- CONTRACTOR TO UTILIZE LAYOUT DIMENSIONS WHERE PROVIDED.
- PROVIDE PLANTING BED AREA AS NOTED ON THE DRAWING OR TO ACCOMMODATE MATURE SIZE OF PLANT MATERIAL.
- ALL SUPPORT SYSTEMS MUST BE REMOVED BY THE CONTRACTOR AT TIME OF FINAL ACCEPTANCE. NO EXTRAS WILL BE PAID TO COMPLETE THIS WORK.
- SUPPLY AND PLACE TOPSOIL IN ACCORDANCE WITH OPSS 570 TO A MINIMUM DEPTH OF 150mm UNLESS OTHERWISE SPECIFIED.
- SUPPLY AND PLACE SOD IN ACCORDANCE WITH OPSS 571 UNLESS OTHERWISE SPECIFIED.
- SUPPLY AND PLACE SEED IN ACCORDANCE WITH OPSS 572 UNLESS OTHERWISE SPECIFIED. ALL 5:1 OR GREATER SLOPES TO BE SEED WITH TACIFIER. CONTRACTOR TO PROVIDE NECESSARY EROSION CONTROL PROTECTION AS REQUIRED TO ENSURE SOIL STABILIZATION AND PROPER SEED GERMINATION.
- ALL DIMENSIONS IN METRES UNLESS OTHERWISE NOTED.
- IF DISCREPANCIES ARISE BETWEEN PLANT MATERIAL COUNT SHOWN ON DRAWING AND PLANT LIST, THE DRAWING SHALL BE CONSIDERED CORRECT.
- CONTRACTOR TO PROVIDE MINIMUM TWO (2) YEAR WARRANTY FROM DATE ACCEPTED ON ALL WORK UNLESS OTHERWISE SPECIFIED.
- ANY SITE PLAN OR GRADING AND SERVICING SHOWN IS FOR INFORMATION ONLY. REFER TO APPROVED DRAWINGS.
- NOT FOR CONSTRUCTION UNLESS STAMPED, SIGNED AND DATED BY LANDSCAPE ARCHITECT.
- DRAWINGS NOT TO BE REPRODUCED WITHOUT WRITTEN CONSENT FROM LANDSCAPE ARCHITECT.
- APPROVAL OF LANDSCAPE PLAN TO BE OBTAINED FROM MUNICIPALITY.
- FOR GRADING AND SERVICING INFORMATION REFER TO THE CONSULTING ENGINEERS DRAWINGS.
- FOR LIGHTING INFORMATION AND POWER DISTRIBUTION REFER TO THE ELECTRICAL CONSULTANTS DRAWINGS.

TRANSPLANT NOTES:

THE OWNER ACKNOWLEDGES AND AGREES TO TRANSPLANT 6 TREES FROM THE CITY OF OTTAWA RIGHT OF WAY, IN ADVANCE OF CONSTRUCTION TO A PROTECTED AREA OF THE PROPERTY TO COMPLETE SITE CONSTRUCTION. UPON COMPLETION OF CONSTRUCTION, THE TREES WILL BE TRANSPLANTED TO THEIR FINAL PLANTING LOCATION. IF ANY OF THE TREES DECLINE OR DIE WITHIN 2 YEARS OF THE FINAL PLANTING DATE, AS SHOWN IN THE LANDSCAPE PLAN PREPARED BY ARCADIS, DATED AUGUST 2024 COMPENSATION IN THE FORM OF 1:1 REPLACEMENT TREE PLANTING WILL BE REQUIRED. IF DECLINE OR DEATH OCCURS, THE OWNER SHALL PREPARE AND SUBMIT AN AMENDED LANDSCAPE PLAN PREPARED TO THE SATISFACTION OF THE DEVELOPMENT REVIEW MANAGER OF THE RELEVANT BRANCH WITHIN THE PLANNING, REAL ESTATE AND ECONOMIC DEVELOPMENT DEPARTMENT, OR HIS/HER DESIGNATE, SHOWING THE LOCATION, STOCK SIZE, AND SPECIES OF TREE BEING PLANTED AS A REPLACEMENT(S).

1 UNIT PAVING LP1 N.T.S.

LANDSCAPE AREA STATISTICS:

SITE AREA = 4174 m²

HARDSCAPE (7.9 % OF SITE AREA)	
CONCRETE	295 m ²
UNIT PAVEMENT	27 m ²
PEAGRAVEL	8 m ²
TOTAL	330 m ²
SOFTSCAPE (27.2 % OF SITE AREA)	
PLANT BEDS	646 m ²
SOD	488 m ²
TOTAL	1134 m ²

PRIME CONSULTANT

ARCADIS

410 Albert Street - Suite 101
Waterloo ON N2L 3V3 Canada
tel 519 585 2255
www.arcadis.com

PROJECT
ROHIT WATERIDGE VILLAGE BLOCK 5

OTTAWA, ON

PROJECT NO:
143934

DRAWN BY:
R.S.

CHECKED BY:
M.P.

PROJECT MGR:
M.P.

APPROVED BY:
T.M.

SHEET TITLE
LANDSCAPE PLAN

SHEET NUMBER
LP1

ISSUE
1

FILE NO. D07-12-24-0090 | PLAN NO. #19178

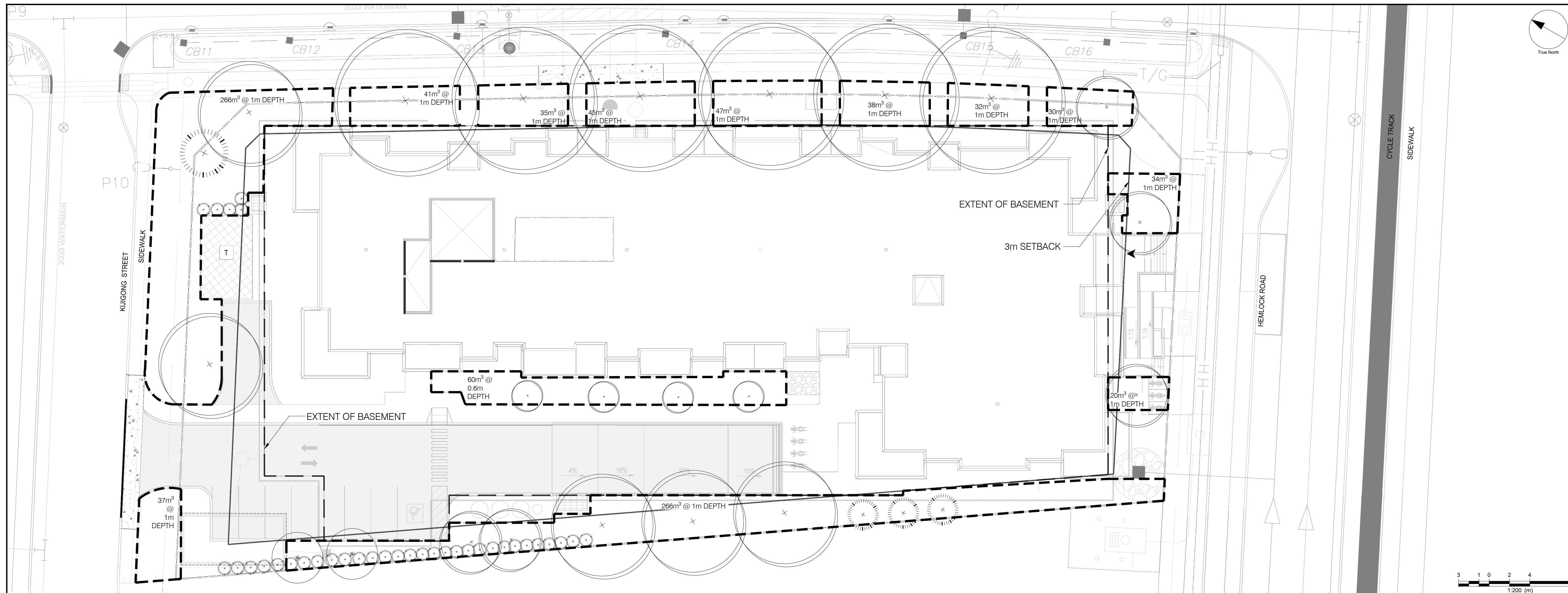

SOIL VOLUME PLAN FOR TREES

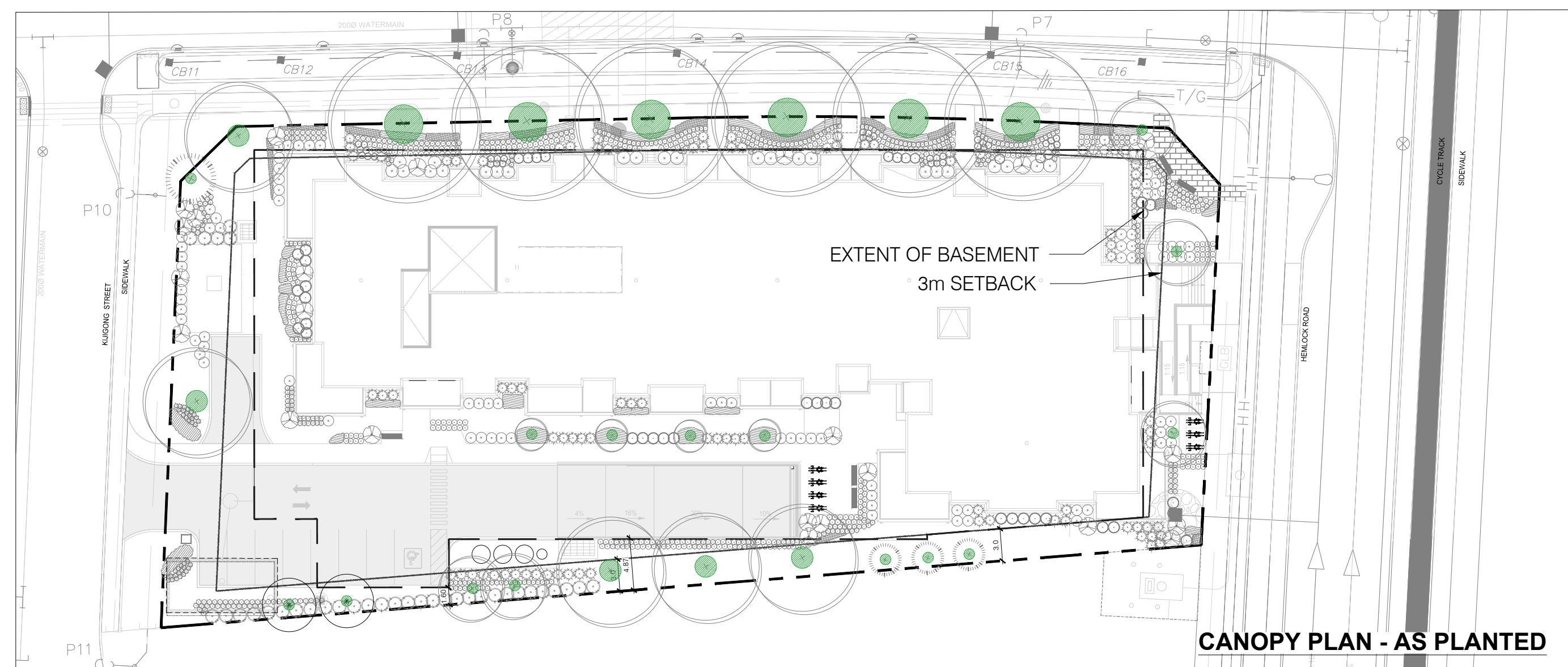

CANOPY PLAN - AS PLANTED

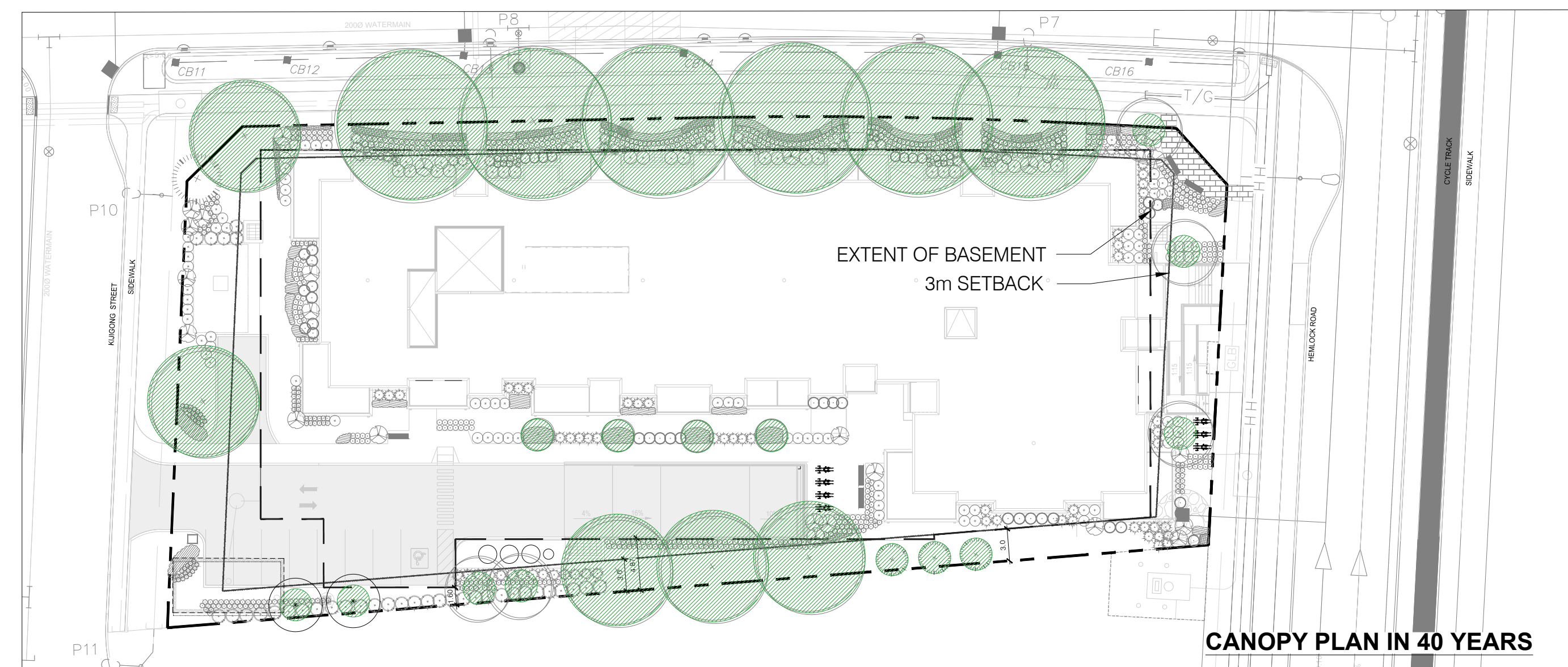

CANOPY PLAN IN 40 YEARS

CANOPY COVER CHART

KEY	BOTANICAL NAME	COMMON NAME	QTY.	CROWN AREA PER TREE WHEN PLANTED (m²)	CANOPY AREA SUBTOTAL WHEN PLANTED (m²)	CROWN AREA* PER TREE WHEN MATURE (m²)	CANOPY AREA SUBTOTAL WHEN MATURE (m²)	PERCENTAGE OF TOTAL CANOPY (%)	PERCENTAGE OF TOTAL GENUS (%)
LARGE STATURE TREES									
AU	<i>Acer x freemanii 'Jeffersred'</i>	Autumn Blaze Maple	3	4	12	154	462	31.7%	22.6%
Qr	<i>Quercus rubra</i>	Northern Red Oak	3	4	12	154	462	31.7%	9.7%
MEDIUM STATURE TREES									
PaB	<i>Platanus x acerifolia 'Bloodgood'</i>	Bloodgood Plane Tree	5	3	12.5	78.5	392.5	26.9%	16.1%
SMALL STATURE TREES									
Al	<i>Amelanchier laevis</i>	Allegheny serviceberry	7	1	7	7	49	3.4%	22.6%
AxA	<i>Acer rubrum 'Armstrong'</i>	Armstrong Maple	4	1	4	7	28	1.9%	
LIF	<i>Liriodendron tulipifera 'Fastigiata'</i>	Columnar Tulip Tree	3	1	3	7	21	1.4%	9.7%
PpG	<i>Picea pungens var. glauca</i>	Colorado Blue Spruce	4	1	4	7	28	1.9%	12.9%
2 transplanted trees within site									
	<i>Syringa species</i>	Lilac Species	2	1	2	7	14	1.0%	6.5%
TOTAL			31		56.5		1456.5	100.0%	100.0%
TOTAL SITE AREA (m²)							4375		
TOTAL TREE CANOPY PERCENTAGE WHEN PLANTED (%)							1.4%		
TOTAL MATURE TREE CANOPY PERCENTAGE (%)							34.9%		

* MATURE TREE CANOPY AREAS ARE DERIVED FROM OAKVILLE CANOPY COVER GUIDELINES

CLIENT
ROHIT COMMUNITIES

550 91 STREET SW #101, EDMONTON, AB
T6X0V1

BLOCK-5 PIN NUMBER - 04273-1231

COPYRIGHT
This drawing has been prepared solely for the intended use, thus any reproduction or distribution for any purpose other than authorized by Arcadis is forbidden. Written dimensions shall have precedence over scaled dimensions. Contractors shall verify and be responsible for all dimensions and conditions on the job, and Arcadis shall be informed of any variations from the dimensions and conditions shown on the drawing. Shop drawings shall be submitted to Arcadis for general conformance before proceeding with fabrication.

Arcadis Professional Services (Canada) Inc.
is a part of Arcadis

ISSUES	No.	DESCRIPTION	DATE
	1	ISSUED FOR SPA SUBMISSION	2023-12-18
	2	ISSUED FOR SPA SUBMISSION	2024-02-21
	3	ISSUED FOR SPA SUBMISSION	2024-04-30
	4	ISSUED FOR SPA SUBMISSION	2024-08-09

CONSULTANTS
 CIVIL: ARCADIS PROFESSIONAL SERVICES (CANADA) INC.
 LANDSCAPE: ARCADIS PROFESSIONAL SERVICES (CANADA)
 SURVEY: ANNIS, O SULLIVAN, VOLLEBECK LTD.
 ARCHITECTURE: NDRR ARCHITECTS & ENGINEERING LTD.
 STRUCTURAL: CUNIFFE & ASSOCIATES
 MECHANICAL: GOODKEY, WEEDMARK & ASSOCIATES LTD.
 ELECTRICAL: GOODKEY, WEEDMARK & ASSOCIATES LTD.
 OWNER: ROHIT AT WATERIDGE 5 LTD.



PRIME CONSULTANT
ARCADIS
 410 Albert Street - Suite 101
 Waterloo ON N2L 3V3 Canada
 tel 519 585 2255
 www.arcadis.com

PROJECT
ROHIT WATERIDGE VILLAGE
BLOCK 5
 OTTAWA, ON

PROJECT NO: 143934
DRAWN BY: R.S
PROJECT MGR: M.P.
CHECKED BY: M.P.
APPROVED BY: T.M.

SHEET TITLE
SOIL AND CANOPY PLAN

SHEET NUMBER LP2 **ISSUE** 1

TREE STAKING SCHEDULE:
 < 2500mm HT. - ONE STAKE
 > 2500mm HT. - TWO STAKES
 ONLY STAKE TREES WHEN NECESSARY DUE TO WIND LOAD

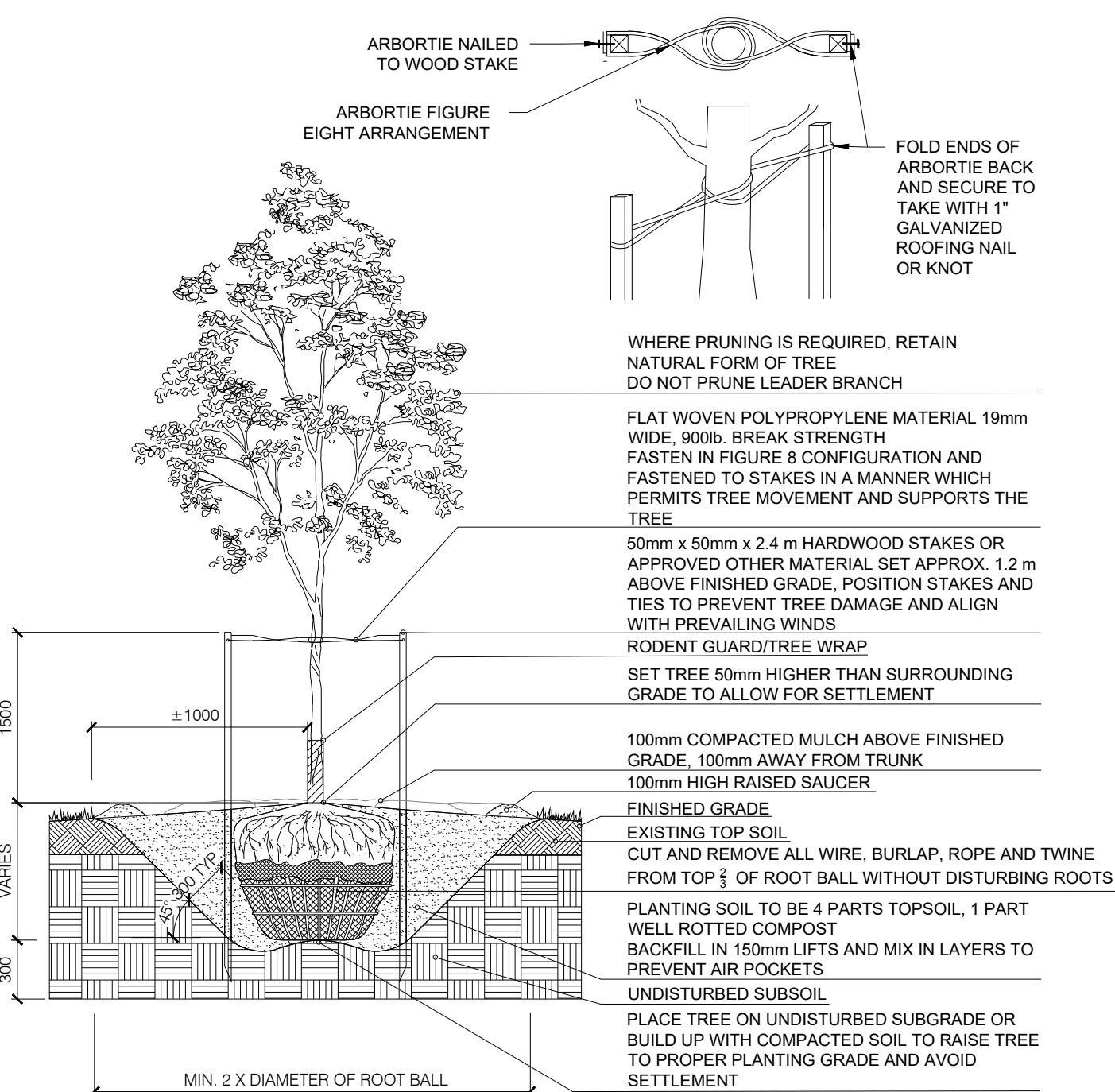

1 BALLED & BURLAPPED/WIRE BASKET DECIDUOUS/CONIFEROUS TREE
 LD1 N.T.S.

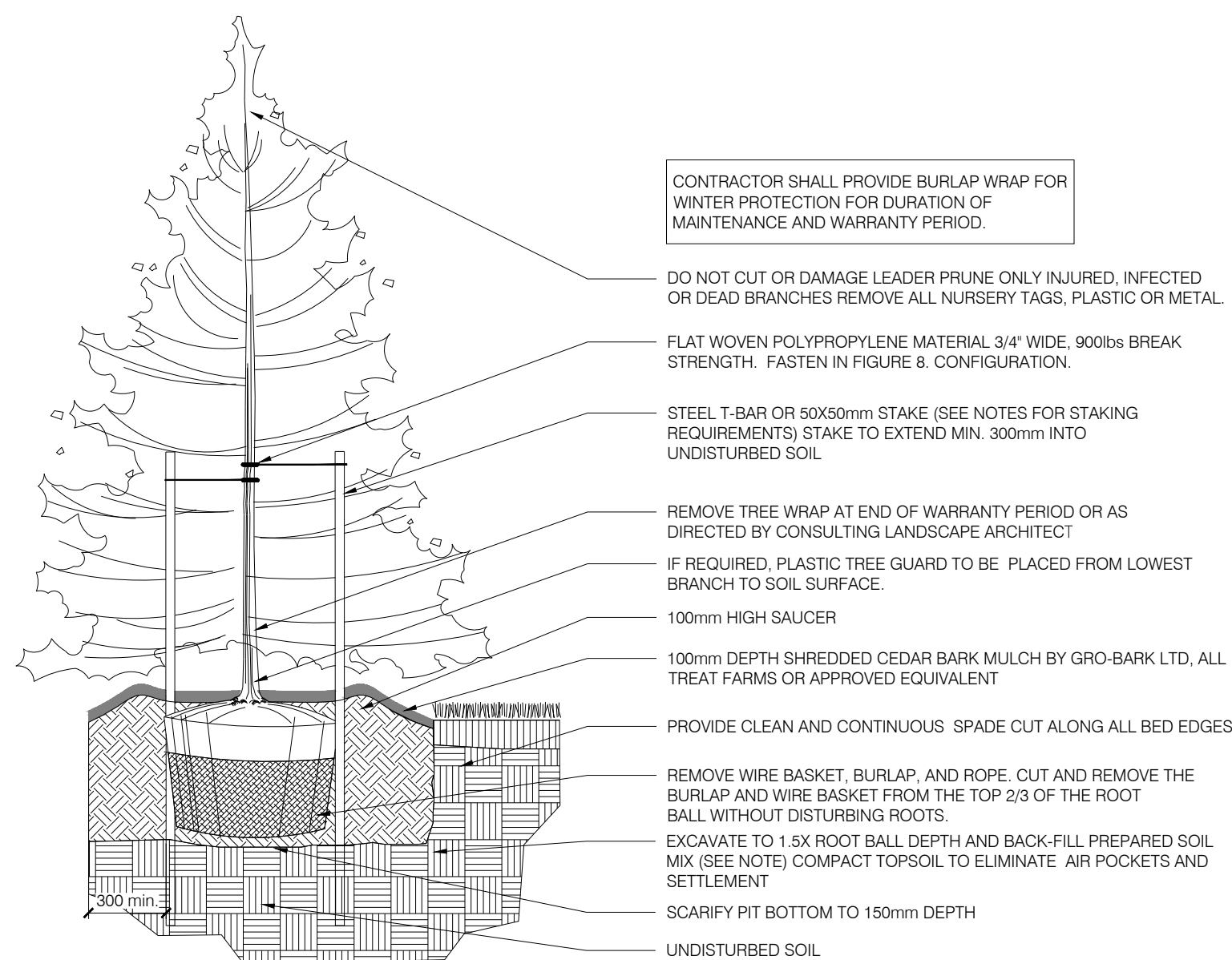

NOTES:

- SOIL MIXTURE: FOUR (4) PARTS NATIVE SOIL, ONE (1) PART WELL ROTTED COMPOST.
- SAUCER SHALL BE SOAKED WITH WATER AND MULCHED IMMEDIATELY FOLLOWING PLANTING.
- ALL DIMENSIONS ARE IN mm.
- STAKING SCHEDULE:
 < 2500mm HT. - ONE STAKE
 > 2500mm HT. - TWO STAKES
 SPRADED TREES - THREE STAKES OR GUY WIRES
 ALL SUPPORT SYSTEMS MUST BE REMOVED ONCE TREE IS ESTABLISHED.
- ALL TREES TO BE STAKED AND PLANTED VERTICALLY REGARDLESS OF SLOPE.
- TOP OF ROOT FLARE SHALL BE POSITIONED 50mm ABOVE GRADE.

FIGURE 8.

2 BALLED & BURLAPPED/WIRE BASKET CONIFEROUS TREE
 D-1 N.T.S.

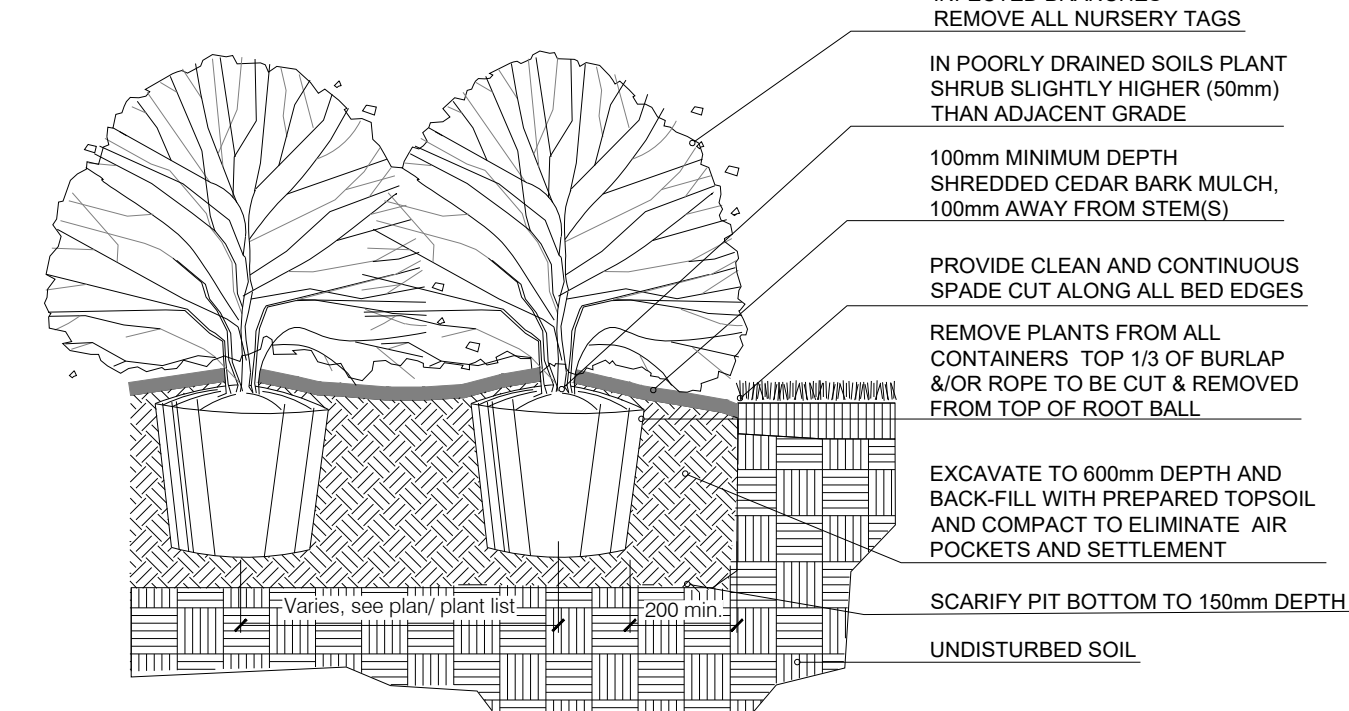

3 BALLED AND BURLAPPED/POTTED SHRUB
 LD1 N.T.S.

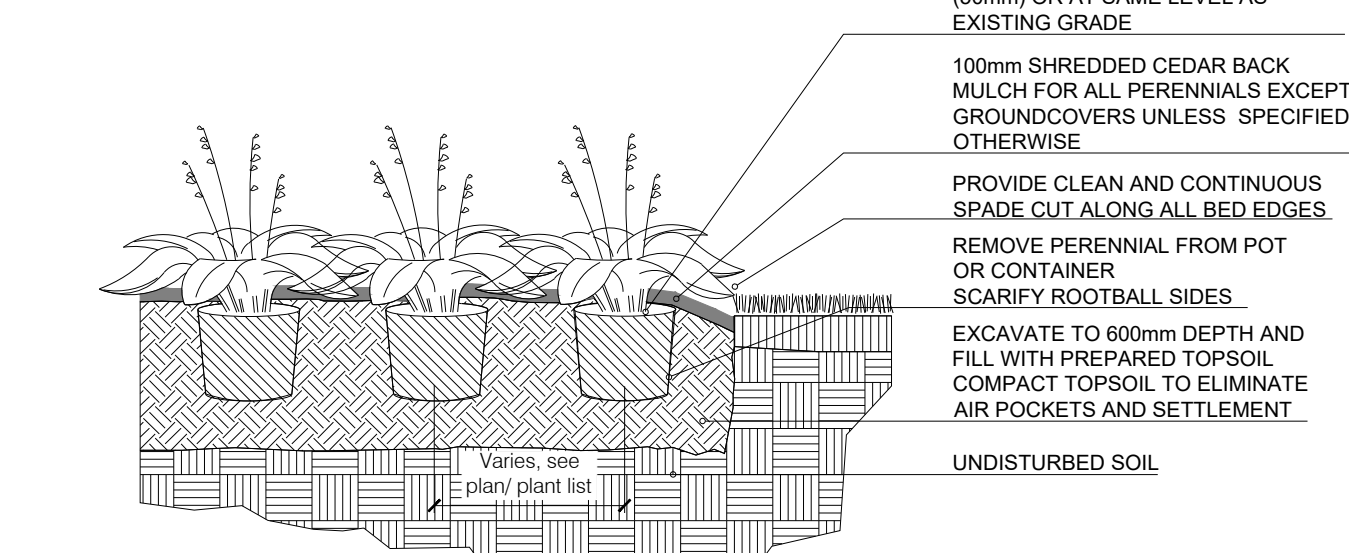

4 CONTAINER GROWN PERENNIAL/GRASS
 LD1 N.T.S.

GENERAL NOTES

- Any ambiguity in the drawings, specifications or details are to be reported to the Landscape Architect for direction. These drawings shall not be used for construction unless stamped and signed by the Landscape Architect. The Contractor is not to proceed in uncertainty. The limits of work are to be clearly understood by the Contractor prior to any work taking place on the site.
- All dimensions are in meters unless otherwise noted. The drawings may be scaled for approximate layout. The Contractor is to verify all dimensions on the drawing(s) and report any discrepancies to the Landscape Architect.
- The Contractor is to locate and mark all infrastructure and utilities prior to any excavation work or planting on the site. Do not plant directly above underground utilities or infrastructure unless approved by the Landscape Architect. Dig all holes by hand when closer than 1.0m to any underground power, telephone or gas utility. The Contractor is responsible for the coordination and maintenance of all utility/infrastructure locates for the duration of the Contract.
- The Contractor shall supply all materials in quantities sufficient to complete work shown on these drawings. The Contractor is not to substitute materials, products or quantities without prior written consent of the Landscape Architect.
- The Contractor is to take all necessary precautions to protect all existing site features unless specified for removal/demolition. This includes all survey bars, stakes, monuments and sediment barriers. The Contractor is responsible for any damages incurred during construction and must make all necessary restorations and repairs to original or better condition.
- All existing trees, shrubs, and herbaceous plants beyond the limit of work are to be protected from construction damage. This includes but is not limited to: not storing construction materials or fuel within the dripline of an existing tree, not altering existing grades or compacting soil around protected vegetation and taking care not to disturb or expose the roots of any existing trees. The Contractor is responsible for all protection or hoarding measures of all existing trees and vegetation to be preserved within or adjacent to construction work limits.
- Contractor is responsible for the removal of all debris, garbage and surplus materials on site related to their contract or work and must keep the site in a clean, safe, useable condition at all times or as directed by the Contract Administrator.

PLANTING NOTES

- The Contractor must notify the Landscape Architect prior to the commencement of any planting. The Contractor shall supply all plants and materials in quantities sufficient to complete the work shown on this drawing. Any discrepancies between quantities shall be reported to the Landscape Architect.
- All landscape works will be warrantied for a period of two years following inspection and written notice of start of warranty period as determined and provided by the Landscape Architect. Plant material, which is not in a healthy, vigorous growing condition at the end of the warranty period, shall be replaced to the satisfaction of the Landscape Architect / Owner.
- The Landscape Architect reserves the right to extend Contractor's warranty responsibilities for an additional year if, at the end of initial warranty period, leaf development and growth is not sufficient to ensure future survival as determined by the Landscape Architect.
- The Contractor is to identify with Landscape Architect/Owner any maintenance requirements necessary for warranty purposes.
- Plant materials specified for this project will conform to the Canadian Nursery Landscape Association (C.N.L.A.) for size, variety and condition as indicated on the plant schedule shown in these drawings. Any plant materials which do not conform will be promptly removed from the site and replaced by the Contractor at no additional cost to the project.
- The Landscape Architect is to be contacted for inspection and written approval prior to plant material arriving on site. The Landscape Architect reserved the right to reject any plant materials that have not been inspected and approved.
- The Landscape Architect reserves the right to refuse acceptance of any plant displaying poor growth habits, injury or disease. Any plant material that is rejected by the Landscape Architect will be promptly removed from the site and replaced with material of acceptable quality at no additional charge to the project.
- Plant materials collected from wild sources will not be accepted without written approval of the Landscape Architect. The Landscape Architect reserves the right to require that supplier invoices be submitted for inspection and approval prior to acceptance.
- On-site layout of the plant materials to be approved by the Landscape Architect prior to installation. Minor field adjustments to plant material locations may be necessary to respond to the locations of existing plants and site conditions. The Contractor to review with Landscape Architect where relocations are necessary. The Contractor must receive approval from Landscape Architect prior to installation.
- Plants are not to be installed during extreme heat, drought, or other undesirable conditions. Thoroughly water all plants immediately after installation. The Contractor shall regularly monitor site conditions and water as required to ensure healthy growth conditions throughout the duration of the warranty period.
- Do not plant directly in centerline of drainage swales or depression areas. Where proposed planting locations conflict with constructed swales or low-lying wet areas, contact Landscape Architect for direction.
- Supply and place topsoil in accordance with OPSS 802 to a minimum depth of 150mm in seed/sod areas and 600mm in planting beds unless otherwise specified. Each source of topsoil, imported or native to be approved by Landscape Architect prior to use. Submit topsoil analysis/test results to Landscape Architect prior to order or delivery to site. Testing to be in accordance with Contract specifications. Prepared topsoil shall be 4 parts topsoil to one part well-rotted compost.
- Mulch: to be spread uniformly around the base of trees and shrubs to a minimum depth of 100 mm. Do not place mulch in direct contact with trunk or stem(s). Allow a 100 mm mulch free zone at trunk/stems. Shrubs to be in continuously mulched planting beds unless otherwise specified.
- Supply and place seed in accordance with OPSS 804 unless otherwise specified. All 5:1 or greater slopes to be seeded with tackifier. All slopes greater than 3:1 shall be matted with an erosion control blanket. Supply and place sod in accordance with OPSS 803 unless otherwise specified.
- The Contractor is to remove dead or damaged branches on trees or shrubs. All pruning shall be performed in accordance with standard horticultural practices and appropriate timing for each species.
- All stakes and associated ties are to be removed after the first full growing season. Rodent guards are to be removed at the conclusion of the warranty period. If utilized, GatoBats are to be removed for winter months.

Ridgewood Bench With Arms
 PS-692-22-AL-72-WD3-WD3-A-BD

Our 'Ridgewood' bench with Armrests features an all-welded aluminum, powdercoated frame with 'ipe' tropical wood, envirowood, or aluminum slats. Available in a variety of sizes and finishes.



Width: 72" (182.9 cm)
 Depth: 24.43" (62.1 cm)
 Height: 30.18" (76.6 cm)
 Weight: 120.0 lb (54.5 kg)



5 HAUSER - RIDGEWOOD BENCH WITH ARMS
 LD1 N.T.S.

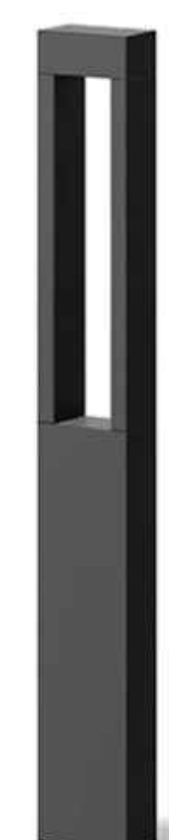

SPECIFICATIONS:
 SUPPLIER: LUMENS
 ITEM#: BE24H1342
 MFR ID: 72065-BLK
 PANEL HEIGHT: 914mm (3)
 SIZE: 3.5X 27.5"
 COLOUR: GRAPHITE
 INSTALLATION TYPE: IN GROUND
 WEBSITE: <https://www.lumens.com/>
 PHONE: (877) 445-4488

7 LUMENS - LIGHT BOLLARDS
 LD1 N.T.S.

Skyline Bike Rack With Tropical Wood Accent
 PS-78-102-21-AW Skyline Bike Rack

Our Skyline Bike Rack features an all-welded, powdercoated aluminum construction. Show here with our 'Pewter' powdercoat finish, and an 'ipe' tropical wood accent. Custom sizes available upon request.



Width: 30" (76.2 cm)
 Depth: 2" (5.1 cm)
 Height: 32" (81.3 cm)



6 HAUSER - SKYLINE BIKE RACK WITH TROPICAL WOOD ACCENT
 LD1 N.T.S.

8 PEA GRAVEL
 LD1 N.T.S.

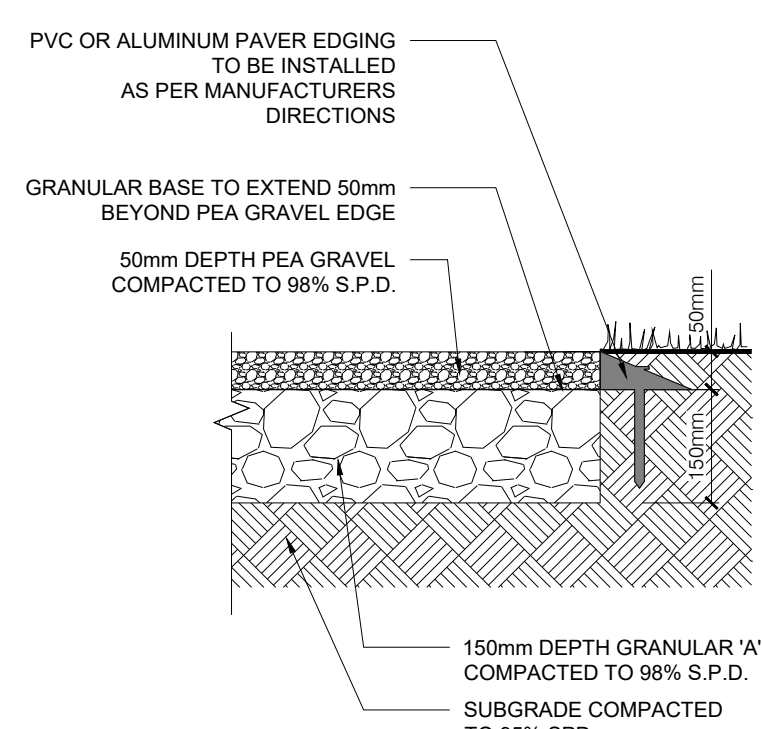

9 TREE PROTECTION FENCE
 LD1 N.T.S.

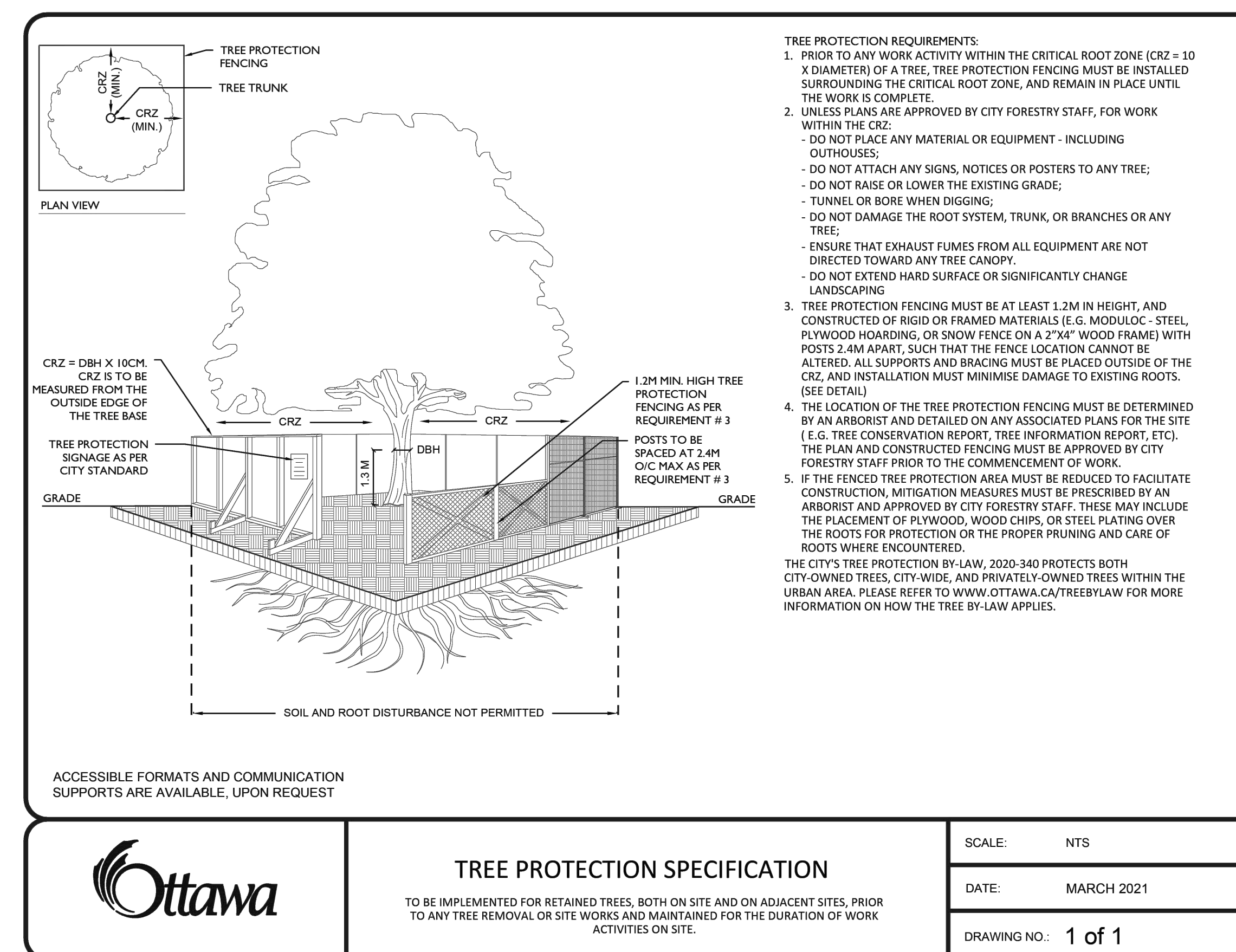

Ottawa

TREE PROTECTION SPECIFICATION

TO BE IMPLEMENTED FOR RETAINED TREES, BOTH ON SITE AND ON ADJACENT SITES, PRIOR TO ANY TREE REMOVAL OR SITE WORKS AND MAINTAINED FOR THE DURATION OF WORK ACTIVITIES ON SITE.

SCALE: NTS
 DATE: MARCH 2021
 DRAWING NO.: 1 of 1

CLIENT

ROHIT COMMUNITIES

550 91 STREET SW #101, EDMONTON, AB T6X0V1

BLOCK-5 PIN NUMBER - 04273-1231

COPYRIGHT

This drawing has been prepared solely for the intended use, thus any reproduction or distribution for any purpose other than authorized by Arcadis is forbidden. Written dimensions shall have precedence over scaled dimensions. Contractors shall verify and be responsible for all dimensions and conditions on the job, and Arcadis shall be informed of any variations from the dimensions and conditions shown on the drawing. Shop drawings shall be submitted to Arcadis for general conformance before proceeding with fabrication.

Arcadis Professional Services (Canada) Inc.
 is a part of Arcadis

ISSUES

No.	DESCRIPTION	DATE
1	ISSUED FOR SPA SUBMISSION	2023-12-18
2	ISSUED FOR SPA SUBMISSION	2024-02-21
3	ISSUED FOR SPA SUBMISSION	2024-04-30
4	ISSUED FOR SPA SUBMISSION	2024-08-09

CONSULTANTS
 CIVIL: ARCADIS PROFESSIONAL SERVICES (CANADA) INC.
 LANDSCAPE: ARCADIS PROFESSIONAL SERVICES (CANADA) INC.
 SURVEY: ANNIS, O SULLIVAN, VOLLEBECK LTD.
 ARCHITECTURE: NDR ARCHITECTS & ENGINEERING LTD.
 STRUCTURAL: CUNIFFE & ASSOCIATES
 MECHANICAL: GOODKEY, WEEDMARK & ASSOCIATES LTD.
 ELECTRICAL: GOODKEY, WEEDMARK & ASSOCIATES LTD.
 OWNER: ROHIT AT WATERIDGE 5 LTD.

SEAL



KEY PLAN

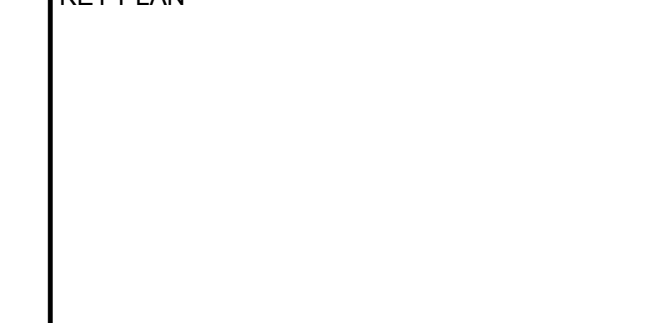

PRIME CONSULTANT

ARCADIS

410 Albert Street - Suite 101
 Waterloo ON N2L 3V3 Canada
 tel 519 585 2255
www.arcadis.com

PROJECT

ROHIT WATERIDGE VILLAGE
 BLOCK 5
 OTTAWA, ON

PROJECT NO:

143934

DRAWN BY:

R.S.

CHECKED BY:

M.P.

PROJECT MGR:

M.P.

APPROVED BY:

T.M.

SHEET TITLE

LANDSCAPE DETAILS

SHEET NUMBER

LD1

ISSUE

1