

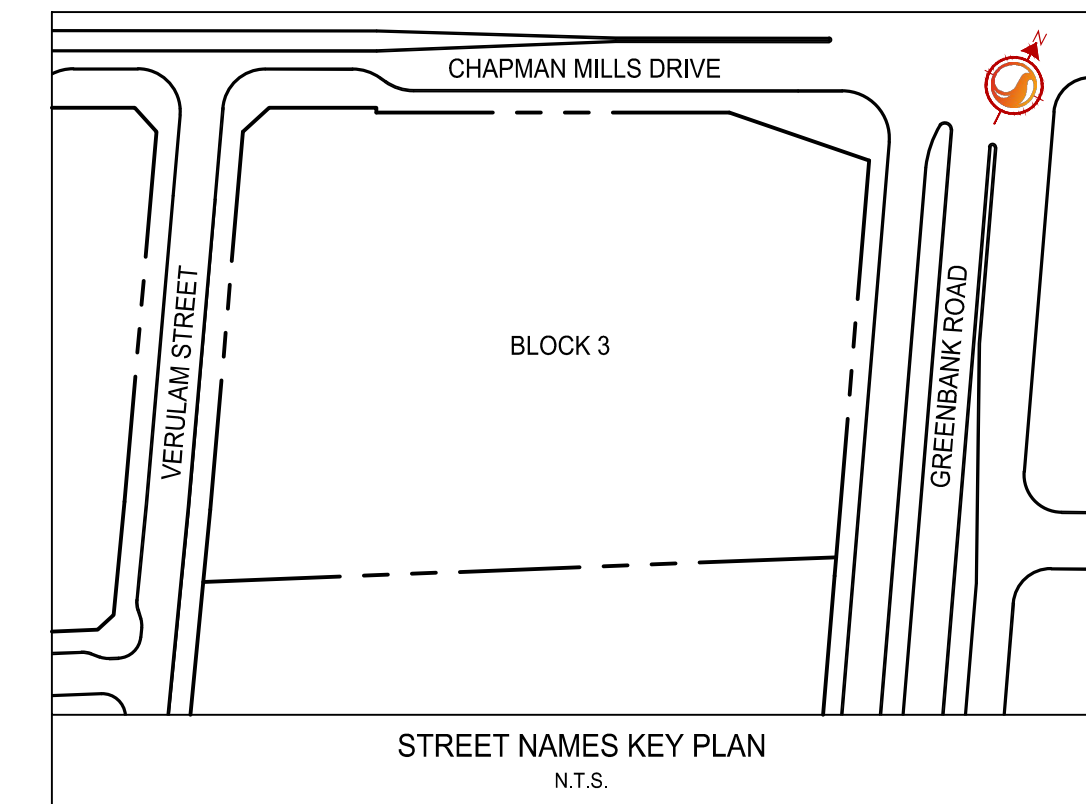

# CHAPMAN MILLS DRIVE

FUTURE FINAL DESIGN AND CONSTRUCTION OF CHAPMAN MILLS DRIVE BY OTHERS.

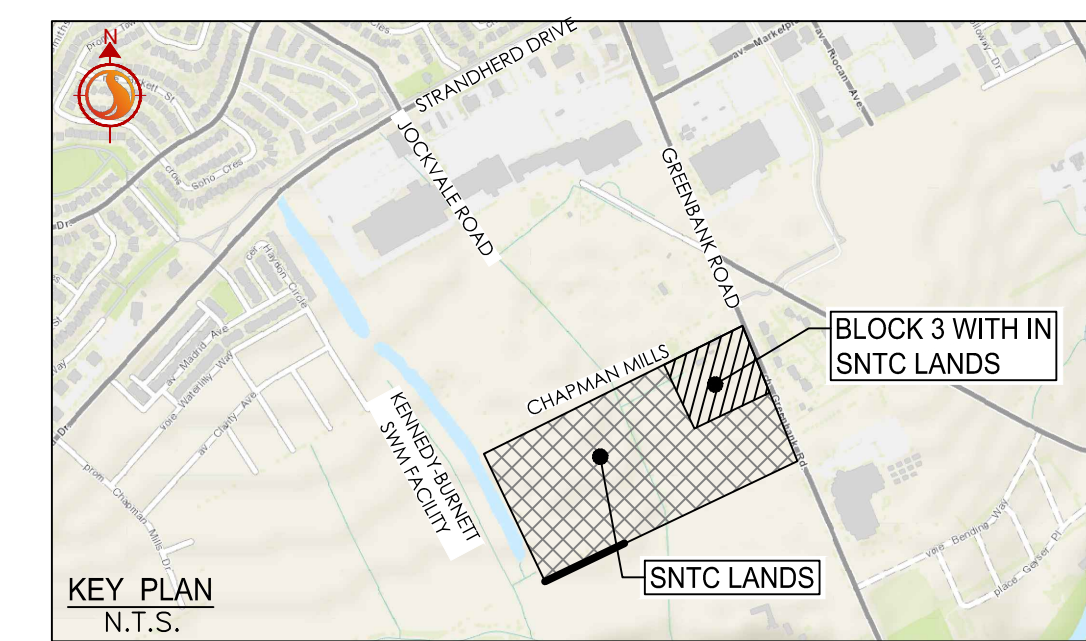

Stantec Consulting Ltd.  
400 - 1331 Clyde Avenue  
Ottawa ON  
Tel. 613.722.4420  
www.stantec.com

### Copyright Reserved

The Contractor shall verify and be responsible for all dimensions. DO NOT scale the drawing - any errors or omissions shall be reported to Stantec without delay. The Copyrights to all designs and drawings are the property of Stantec. Reproduction or use for any purpose other than that authorized by Stantec is forbidden.

### Legend

- SANITARY DRAINAGE AREA ID#
- POPULATION COUNT
- SANITARY DRAINAGE AREA No.
- SANITARY DRAINAGE AREA
- PROPOSED SANITARY SEWER
- EXISTING SANITARY SEWER

### Notes

5	REVISED AS PER SITE PLAN	ZW	KS	24.10.03	
4	ISSUED FOR APPROVAL	ZW	KS	24.08.26	
3	REVISED AS PER SITE PLAN AND CITY COMMENTS	MJS	KS	24.04.26	
2	REVISED AS PER SITE PLAN	MJS	KS	24.03.19	
1	ISSUED FOR REVIEW	WJL	KS	23.09.08	
Revision		By	Appd.	YY.MM.DD	
File Name: 160401845 BLK3 DB.dwg		MJS	KS	MJS	23.06.08
		Dwn.	Chkd.	Dgn.	YY.MM.DD

### Permit-Seal

Client/Project  
**NEPEAN TOWN CENTRE DEVELOPMENT CORPORATION**  
 2934 BASELINE ROAD, SUITE 302, OTTAWA, ON, K2H 1B2  
 PH: (613) 518-1864  
**SNTC LANDS**  
**BLOCK 3**  
 OTTAWA, ON

Title  
**SANITARY DRAINAGE PLAN**

Project No.	Scale	0 4 12 20m
160401845	1:400	
Drawing No.	Sheet	Revision
SA-1	7 of 7	3

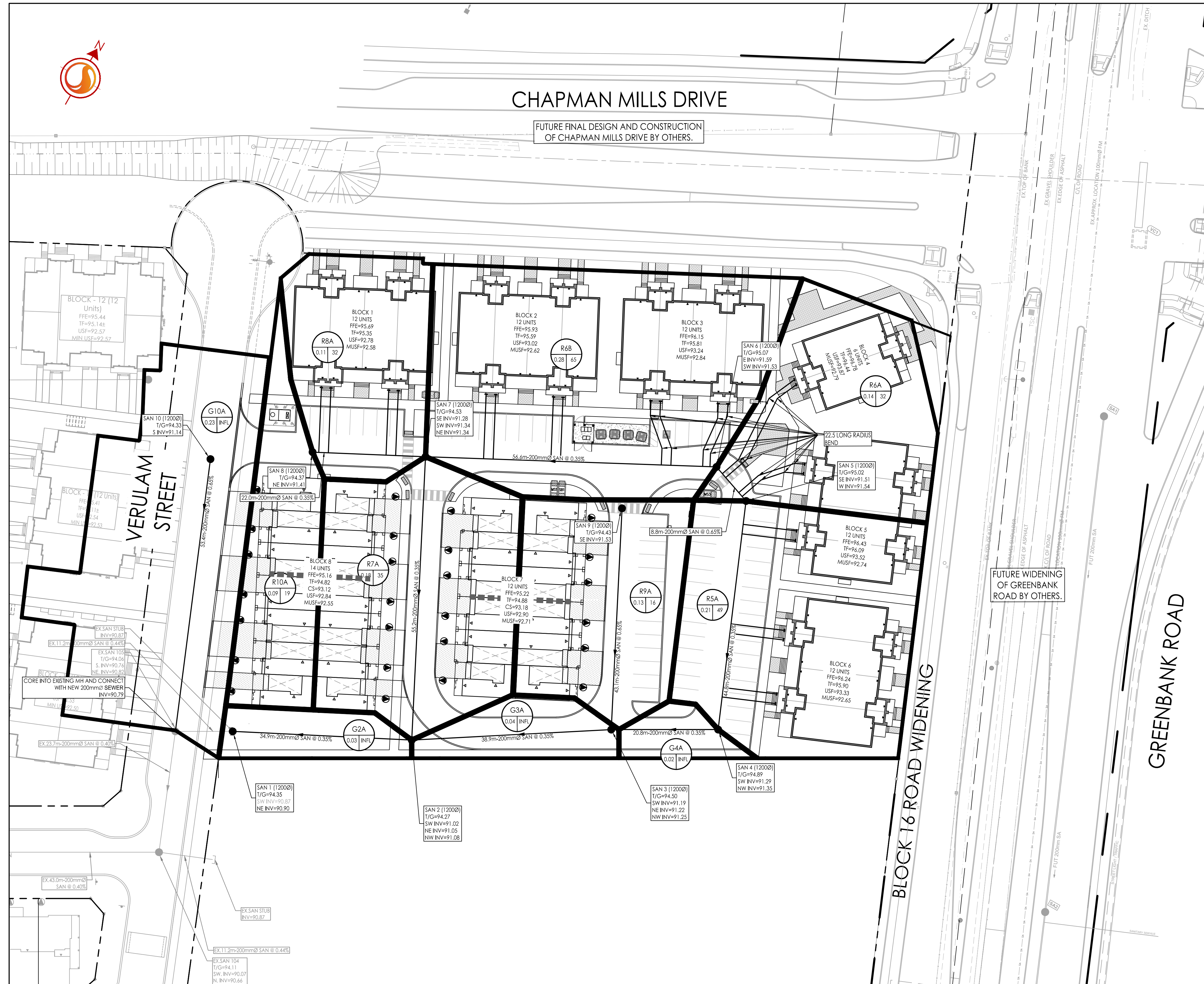

**APPROVED**  
 By Lily Xu at 3:37 pm, Oct 21, 2024

LILY XU, MCIP, RPP  
 MANAGER, DEVELOPMENT REVIEW SOUTH  
 PLANNING, DEVELOPMENT, AND BUILDING SERVICES  
 DEPARTMENT, CITY OF OTTAWA