

**SANITARY STATS**  
POPULATION COUNT - PHASE 2 & 3

284 - 1 BEDROOM APTS @ 1.4PPU = 400 PEOPLE
58 - 2 BEDROOM APTS @ 2.1PPU = 122 PEOPLE
<b>TOTAL POPULATION = 522</b>

**COMMERCIAL AREA**  
TOTAL COMMERCIAL SPACE = 950.85m<sup>2</sup> [0.095ha] @ 28,000 L/ha/day

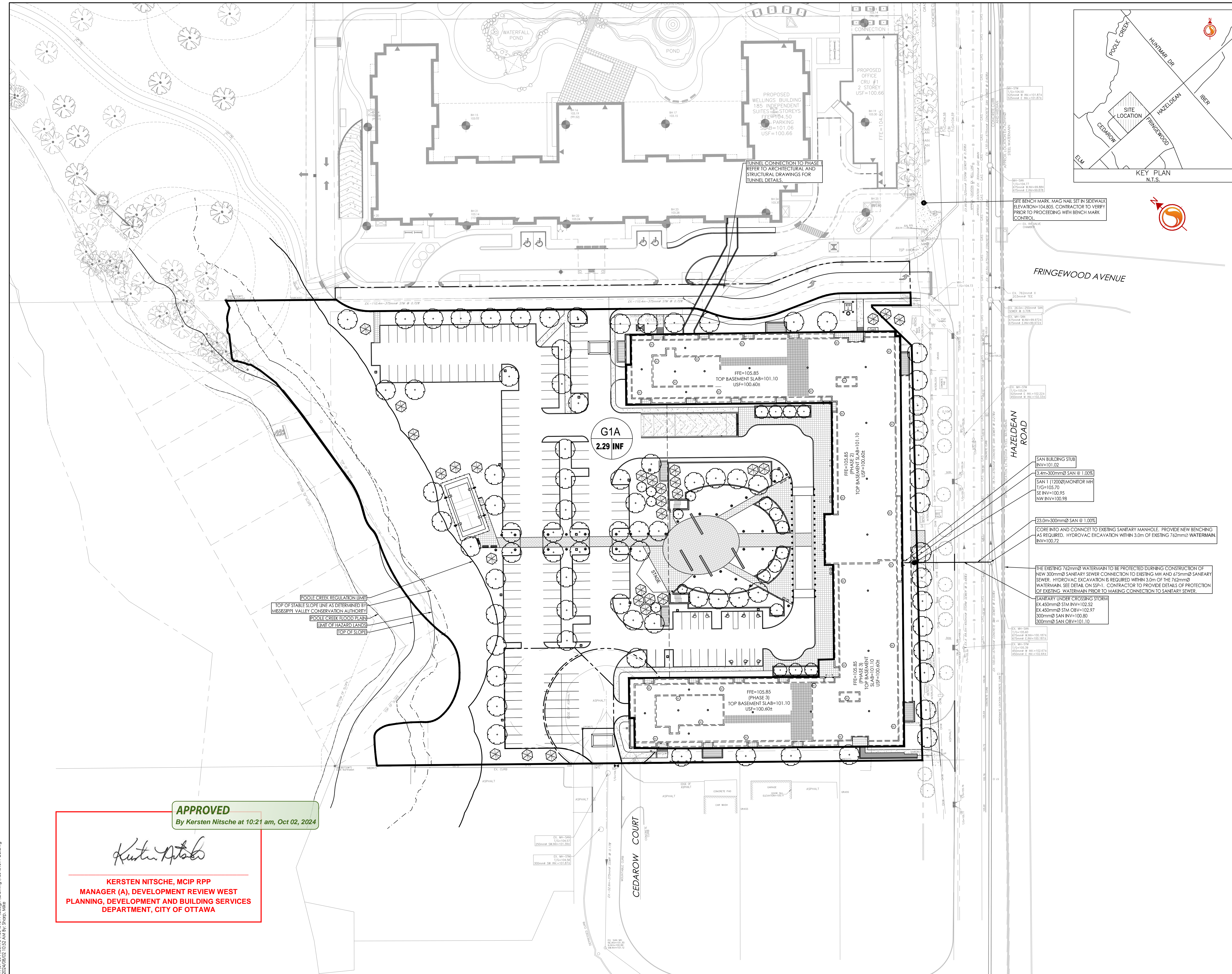
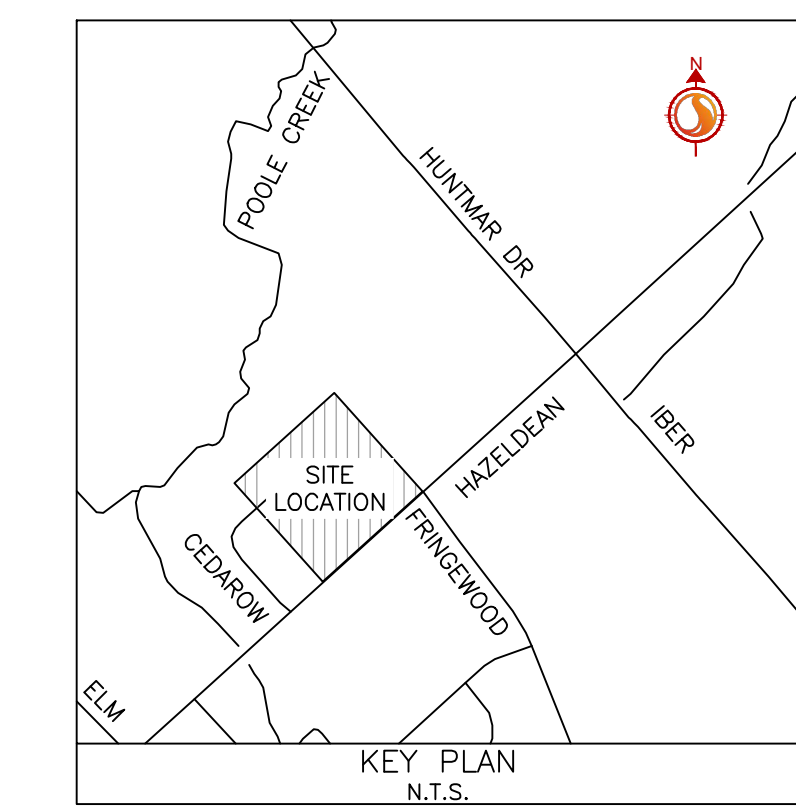

- SAN BUILDING STUB  
INV=101.02
- 3.4m-300mm $\varnothing$  SAN @ 1.00%
- SAN 1 (1200 $\varnothing$ ) MONITOR MH  
TC=105.70  
SE INV=100.95  
NW INV=100.98
- 23.0m-300mm $\varnothing$  SAN @ 1.00%
- CORE INTD AND CONNCT TO EXISTING SANITARY MANHOLE. PROVIDE NEW BENCHING AS REQUIRED. HYDROVAC EXCAVATION WITHIN 3.0m OF EXISTING 762mm $\varnothing$  WATERMAIN. INV=100.72
- THE EXISTING 762mm $\varnothing$  WATERMAIN TO BE PROTECTED DURING CONSTRUCTION OF NEW 300mm $\varnothing$  SANITARY SEWER CONNECTION TO EXISTING MH AND 675mm $\varnothing$  SANITARY SEWER. HYDROVAC EXCAVATION IS REQUIRED WITHIN 3.0m OF THE 762mm $\varnothing$  WATERMAIN. SEE DETAIL ON SSP-1. CONTRACTOR TO PROVIDE DETAILS OF PROTECTION OF EXISTING WATERMAIN PRIOR TO MAKING CONNECTION TO SANITARY SEWER
- SANITARY UNDER CROSSING STORM  
EX. 450mm $\varnothing$  STM INV=102.52  
EX. 450mm $\varnothing$  STM OBV=102.97  
300mm $\varnothing$  SAN INV=100.80  
300mm $\varnothing$  SAN CBV=101.10

13	REVISED AS PER SITE PLAN	MJS	DT	24.08.01
12	ISSUED FOR CONSTRUCTION	MJS	GR	23.11.21
11	REVISED AS PER CITY COMMENTS	MJS	DT	23.11.21
10	REVISED AS PER CITY COMMENTS	MJS	DT	23.09.01
9	REVISED AS PER CITY COMMENTS	MJS	DT	23.06.30
8	REVISED WATER SERVING	MJS	DT	23.03.10
7	REVISED ADS SYSTEM	MJS	DT	23.02.13
6	ISSUED FOR SPA AMENDMENT	MJS	DT	22.12.22
5	REVISED AS PER CITY COMMENTS	MJS	DT	22.07.14
4	REVISED AS PER CITY COMMENTS	MJS	DT	22.03.29
3	REVISED AS PER CITY COMMENTS	MJS	TR	21.09.02
2	ISSUED FOR GEOTECH REVIEW	MJS	DT	21.08.03
1	ISSUED TO CITY FOR SPA	MJS	DT	20.05.22

**Revision**

Rev	By	Appd.	YY.MM.DD
1	MJS	DT	20.05.22
2	MJS	DT	21.08.03
3	MJS	TR	21.09.02
4	MJS	DT	22.03.29
5	MJS	DT	22.07.14
6	MJS	DT	22.12.22
7	MJS	DT	23.02.13
8	MJS	DT	23.03.10
9	MJS	DT	23.06.30
10	MJS	DT	23.09.01
11	MJS	DT	23.11.21
12	MJS	GR	23.11.21
13	MJS	DT	24.08.01

**Permit-Seal**

File Name:	160401511-08	MJS	DT	MJS	19.09.05
		Dwn.	Chkd.	Dgn.	YY.MM.DD

Client/Project  
**NAUTICAL LANDS GROUP**  
2962 Carp Road

**WELLINGS OF STITTSVILLE PH 2**  
20 CEDAROW COURT  
OTTAWA, ON

Title  
**SANITARY DRAINAGE PLAN**

Project No.	160401511	Scale	1:500
Drawing No.	SA-1	Sheet	7 of 7
		Revision	13

**APPROVED**  
By Kersten Nitsche at 10:21 am, Oct 02, 2024

*Kersten Nitsche*

**KERSTEN NITSCHÉ, MCIP RPP**  
MANAGER (A), DEVELOPMENT REVIEW WEST  
PLANNING, DEVELOPMENT AND BUILDING SERVICES  
DEPARTMENT, CITY OF OTTAWA

V:\016040\active\160401511\design\drawing\160401511-08.dwg  
24/08/2024 10:52 AM By: shaps\_wae