

- ### LEGEND
- FFL FIRST FLOOR ELEVATION
 - TOF TOP OF FOUNDATION
 - BFL BASEMENT FLOOR ELEVATION
 - USF UNDERSIDE OF FOOTING
 - PROPERTY LINE
 - CB CATCH BASIN
 - MH MANHOLE
 - CB/MH CATCH BASIN/MANHOLE
 - MH SANITARY MANHOLE
 - FH FIRE HYDRANT
 - DS DOWNSPOUT
 - EXISTING GRADE ELEVATION
 - PROPOSED GRADE ELEVATION
 - +99.99
 - 2% (slope arrow)
 - EMERGENCY OVERLAND FLOW
 - 150mm BARRIER CURB
 - D.C. DEPRESSED CURB
 - LIGHT-DUTY PAVEMENT (diagonal lines)
 - HEAVY-DUTY PAVEMENT (cross-hatch)
 - CONCRETE (dots)
 - LANDSCAPE (stippled)

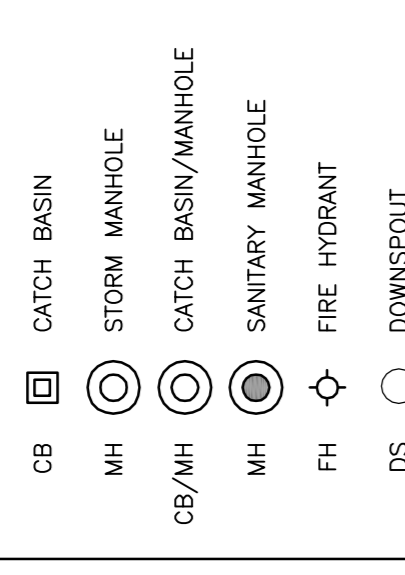

No.	DATE	REVISION
5	SEP 11-24	ISSUED FOR COORDINATION
4	MAY 6-24	ISSUED FOR APPROVAL
3	MAY 2-24	ISSUED FOR COORDINATION
2	DEC 21-23	ISSUED FOR APPROVAL
1	DEC 21-23	RE-ISSUED FOR COORDINATION

D. B. GRAY ENGINEERING INC.
Professional Engineer - Ontario
700 Long Point Circle
Ottawa, Ontario K1H 8S1
Tel: (416) 223-7000
d.gray@dbgrayengineering.com

PROJECT
STACKED TOWNS
BUILDING A - 20 UNITS
BUILDING B - 24 UNITS
2506 INNES ROAD
OTTAWA, ONTARIO

Drawing Title: **GRADING PLAN**

Engineer's Seal:

D.B.G.
H. Scale: 1:200
V. Scale: As Shown
Date: Dec 20-23
Job No.: 23087

Drawing No. **C-4** of **10**

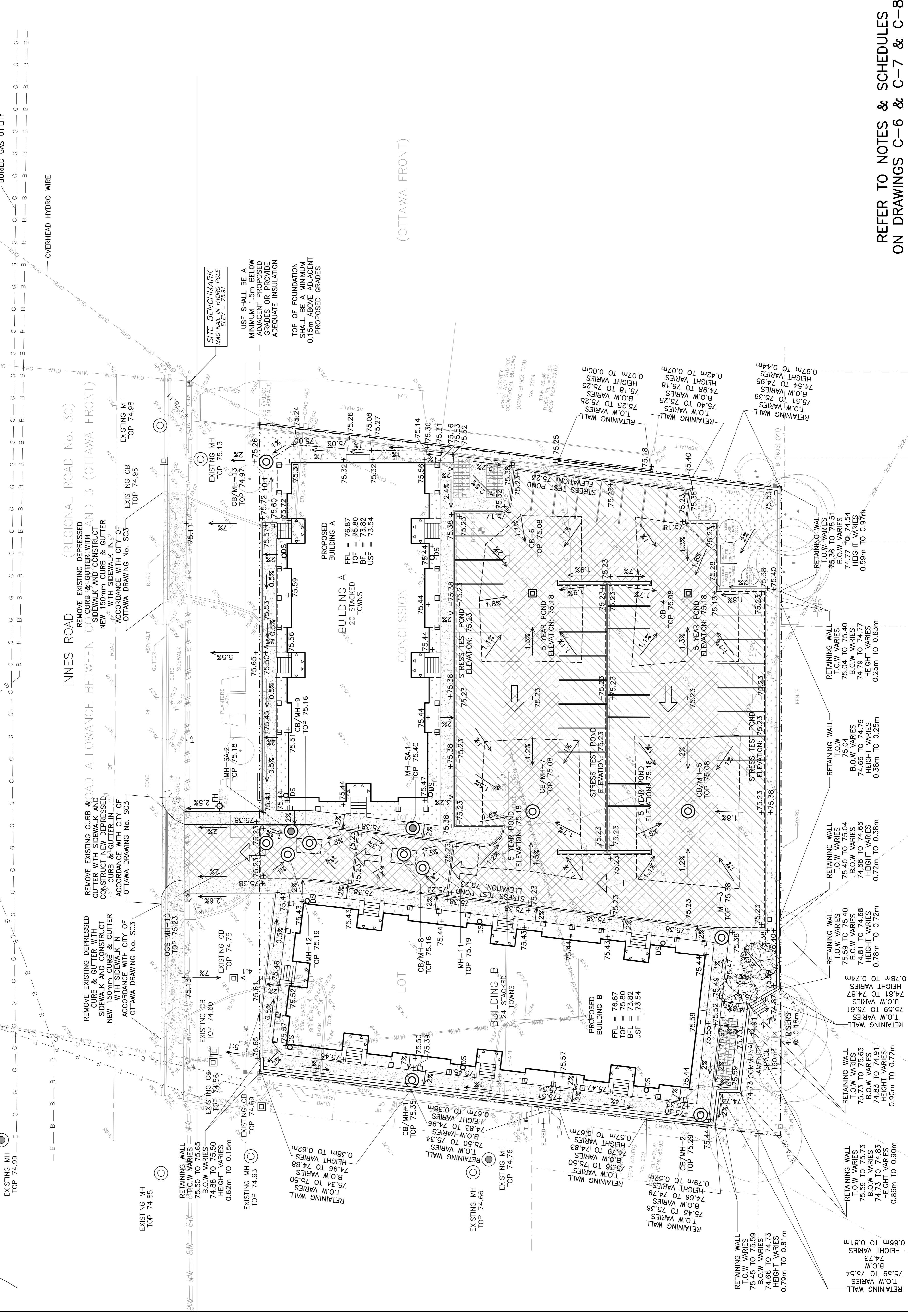

REMOVE EXISTING CURB & GUTTER WITH SIDEWALK AND CONSTRUCT NEW DEPRESSED CURB & GUTTER WITH SIDEWALK IN ACCORDANCE WITH CITY OF OTTAWA DRAWING No. SC3

REMOVE EXISTING DEPRESSED CURB & GUTTER WITH SIDEWALK AND CONSTRUCT NEW DEPRESSED CURB & GUTTER WITH SIDEWALK IN ACCORDANCE WITH CITY OF OTTAWA DRAWING No. SC3

USF SHALL BE A MINIMUM 1.5m BELOW ADJACENT PROPOSED GRADES OR PROVIDE ADEQUATE INSULATION

TOP OF FOUNDATION SHALL BE A MINIMUM 0.15m ABOVE ADJACENT PROPOSED GRADES

REFER TO NOTES & SCHEDULES ON DRAWINGS C-6 & C-7 & C-8