

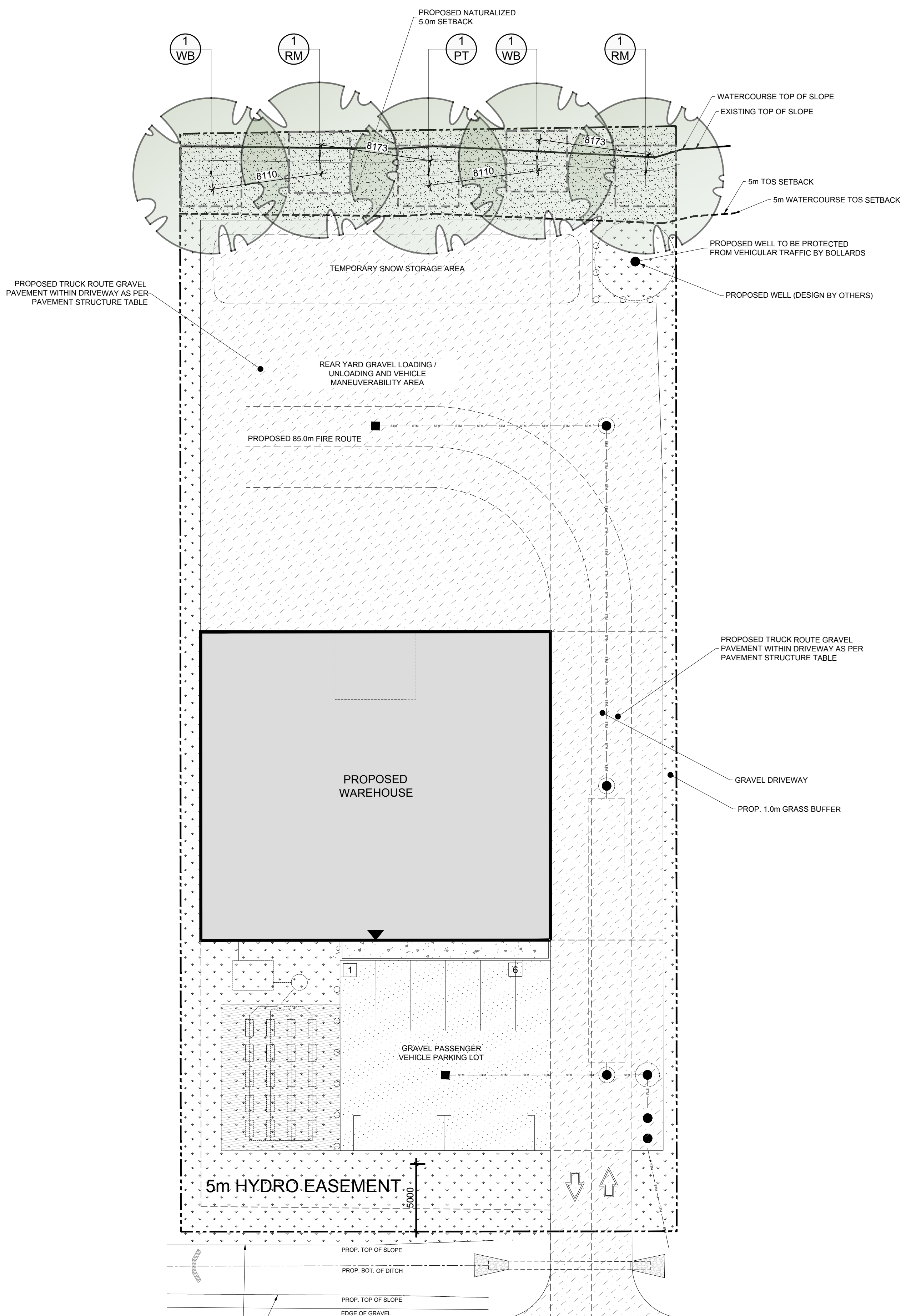

LEGEND

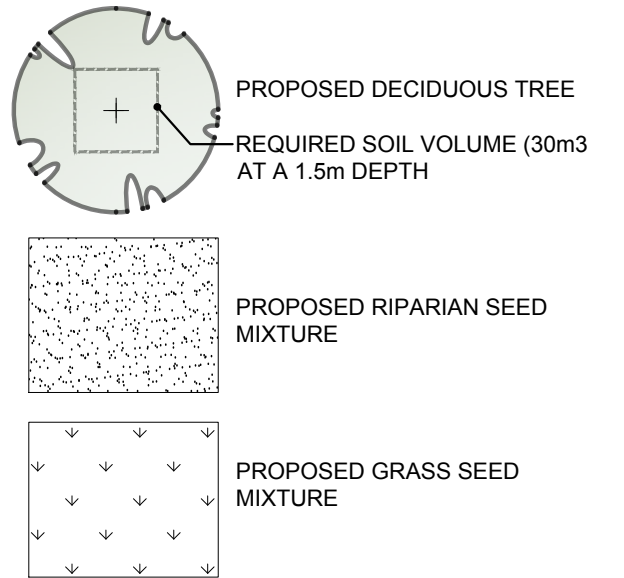

GENERAL NOTES:

- IT IS THE RESPONSIBILITY OF THE APPROPRIATE CONTRACTOR OR OFFICIAL TO REPORT ANY ERRORS, OMISSIONS OR DISCREPANCIES ON THIS PLAN WITH ACTUAL SITE CONDITIONS TO THE LANDSCAPE ARCHITECT BEFORE PROCEEDING WITH CONSTRUCTION.
- THE CONTRACTOR IS TO NOTIFY ALL UTILITY COMPANIES AND AUTHORITIES PRIOR TO ANY EXCAVATION AND ASCERTAIN LOCATIONS OF UNDERGROUND SERVICES.
- THE CONTRACTOR IS TO REINSTATE ALL AREAS AND ITEMS DAMAGED AS A RESULT OF CONSTRUCTION ACTIVITY.
- THE CONTRACTOR IS TO COMPLY WITH ALL PERTINENT CODES AND BY-LAWS.
- THE CONTRACTOR IS TO MAINTAIN A POSITIVE SURFACE RUN-OFF THROUGHOUT THE ENTIRE CONSTRUCTION PERIOD.
- THE LANDSCAPE ARCHITECT IS NOT RESPONSIBLE FOR SUBSURFACE CONDITIONS.
- THE CONTRACTOR IS TO STAKE THE PROPOSED LOCATION OF ALL PLANT MATERIAL IN CONJUNCTION WITH THE LANDSCAPE ARCHITECT PRIOR TO EXCAVATION.
- MINIMUM DISTANCES FOR SELECTED DECIDUOUS TREES ARE AS FOLLOWS:
 - 8.1. BUILDING FOUNDATIONS - 7.5M
 - 8.2. SIDEWALKS - 1.5M
 - 8.3. PUBLIC STREETS - 2.5M
 - 8.4. UNDERGROUND INFRASTRUCTURE - 2.0M
- ALL TREES WITHIN 1M OF UNDERGROUND UTILITY TRENCHES ARE TO BE EXCAVATED BY HAND.
- REMOVE ALL PROTECTIVE WRAPPING FROM TREE TRUNKS AFTER INSTALLATION.
- STAKING OF TREES SHALL ONLY BE PERFORMED IF NECESSARY.
- ENSURE THAT MULCH IS PULLED BACK A MINIMUM DISTANCE OF 75MM FROM BASE OF TREE TRUNK.

PROPOSED PLANT LIST

KEY	qty.	BOTANICAL NAME	COMMON NAME	SIZE	CONDITION	REMARKS	NATIVE SPECIES
TREES							
PT	1	Populus tremuloides	Trembling Aspen	50mm cal.	B&B		YES
RM	2	Acer rubrum	Red Maple	50mm cal.	B&B		YES
WB	2	Betula papyrifera	White Birch	50mm cal.	B&B		YES

NOTE: All 5 TREES ARE PROPOSED ON PRIVATE PROPERTY

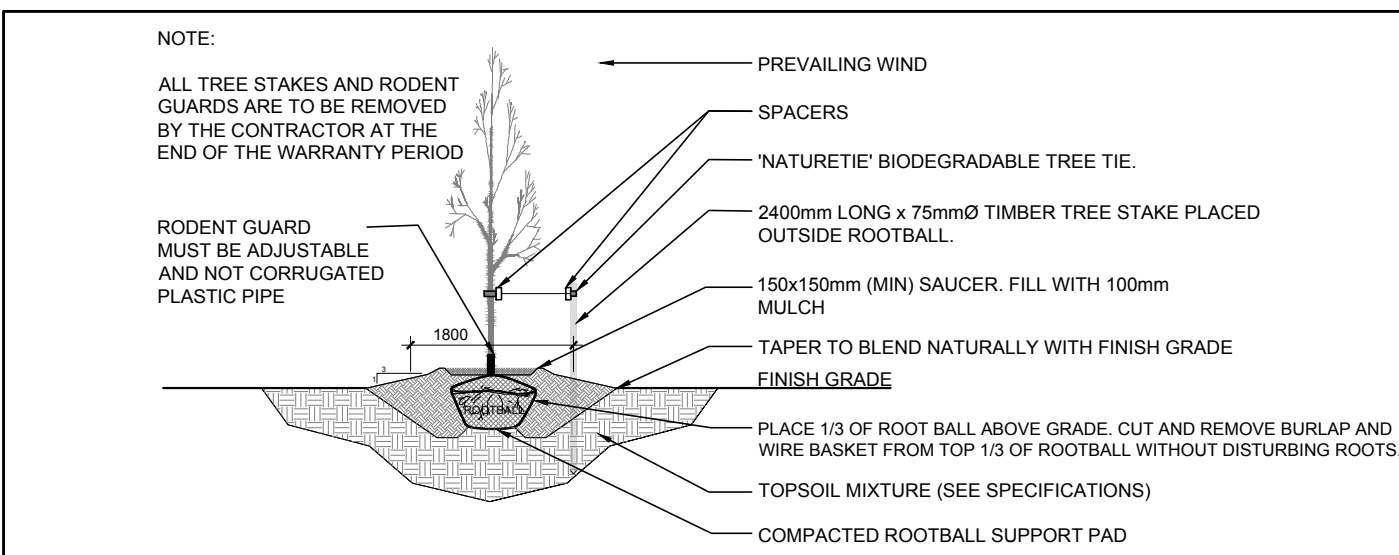

2 DECIDUOUS TREE PLANTING
SCALE: NTS

40 YEAR CANOPY CALCULATION:
-3002m2 site area
-5 Large deciduous trees proposed (154m2 ea.)
=1232m2 canopy cover =25.6% canopy cover
*Large deciduous tree calculated at 14m spread

NOTE RE: EXISTING TREES
PER SECTION 5.2 OF THE ENVIRONMENTAL IMPACT STATEMENT PREPARED BY KILGOUR & ASSOCIATES LTD. 2023-09-15 THE SITE IS "COMPLETELY DEVOID OF ANY VEGETATION"

1	ISSUED FOR SITE PLAN CONTROL	08/02/2024	ML	JL
No.	Issue	Date	DR	CK

JAMES B. LENNOX & ASSOCIATES INC.
LANDSCAPE ARCHITECTS
3332 CARLING AVE. OTTAWA, ONTARIO K2H 5A8
Tel. (613) 722-5168 Fax. (866) 343-3942

PROJECT
PROPOSED WAREHOUSE DEVELOPMENT
363 ENTREPRENEUR CRESCENT, OTTAWA ON

DRAWING
LANDSCAPE PLAN

STAMP	SCALE
	AS SHOWN
	START DATE
	PROJECT NO.

PROJECT NORTH	DRAWING NO.
	L.1
	PLOT SIZE ARCH-D

