

- ### LEGEND
- PROPERTY LIMIT
 - TREE PROTECTION FENCE
 - EXISTING TREE TO REMAIN, SYMBOL SIZE REFLECTS CRZ
 - EXISTING TREE TO REMOVE, SYMBOL SIZE REFLECTS CRZ
 - EXISTING TREE GROUP TO BE RETAINED
 - EXISTING TREE GROUP TO BE REMOVED
 - ANTICIPATED LIMIT OF EXCAVATION FOR UNDERGROUND GARAGE
- ### GENERAL
- Read and interpret this drawing/ drawing set in conjunction with all the contract details and specifications, including related civil, utility, structural, architectural, mechanical, electrical, environmental, geotechnical, and survey information.
 - The Contractor is to determine the exact location, size, material, and elevation of all existing utilities prior to commencing construction. Protect and assume responsibility for all existing utilities regardless of being shown on the drawings.
 - It is essential to use the plans and details in conjunction with the specifications and notes.
 - Do not scale drawings. Work to dimensions only.
 - Protect all existing and retained vegetation for the duration of construction according to the contract details and specifications.
 - Reinstate all areas and items damaged or disturbed, beyond the Limit of Work, because of construction activities, including but not limited to construction staging areas, haul roads, stockpile areas, etc. to the satisfaction of the Consultant. Unless otherwise noted, Contractor is to reinstate all areas to pre-construction condition or better to the satisfaction of the Contract Administrator.

- ### TREE PROTECTION
- The Landscape Architect or Certified Arborist is to determine the location of the tree protection fencing and detail on any associated plans for the site (e.g. tree conservation report, tree disclosure report, etc.).
 - Under the guidance of a Landscape Architect or Certified Arborist, erect a fence at the critical root zone (CRZ) of trees. Diameter at breast height (DBH) is the trunk diameter measured at 1.3m height on the tree trunk. The CRZ is calculated as DBH x 10. Refer to the Tree Protection Fence detail.
 - Refer to the Tree Protection Plan for fence location. City Forestry Staff are to approve both the plan and the installed fence prior to work commencement.
 - Do not place any material or equipment within 2m of the CRZ of any tree, including outhouses.
 - Do not attach any signs, notices, or posters to any tree.
 - Do not disturb, raise, or lower the existing grade within the CRZ without approval.
 - Only tunnel or bore when digging within the CRZ of a tree. Hand work only where required within the CRZ, absolutely no machinery permitted.
 - Do not damage the root system, trunk, or branches, or any tree.
 - Do not extend hard surface or significantly change landscaping.
 - Ensure that exhaust fumes from all equipment are directed away from any tree canopy.
 - When trees marked for removal overlap with the CRZ of trees marked for preservation, cut roots at the edge of the CRZ and grind down stumps after tree removals, do not pull out stumps. Ensure there is not root pulling or disturbance of the ground within the CRZ.
 - Prior to work taking place, notify and consult the Landscape Architect and City Forestry Staff if roots must be cut. Roots 20mm or larger should be cut at right angles with clean, sharp horticultural tools without tearing, crushing, or pulling. Refer to City of Ottawa Specification S.P. F-8011 Tree Protection, Excavation of Root Zone.
 - If damaged or objectionable branches are observed, consult the Landscape Architect, before any work is conducted. Do not prune leaders. Do not prune more than 1/4 of crown.
 - Set up a water and fertilizing program, if trees are being affected by site works, to the satisfaction of the Landscape Architect.
 - The Landscape Architect is to prescribe mitigation measures if the protected fenced area must be reduced to facilitate construction. Measures may include the placement of plywood, wood chips, or steel plating over the roots for protection. City Forestry Staff are to approve said measures prior to fence movement.
 - City of Ottawa By-law: Protects municipal trees and municipal natural areas in the City of Ottawa and trees on private property in the urban area of the City of Ottawa (2020-340).

| Legend | Condition | Action |
|--------|-----------|---|
| G | Good | Remove due to conflict with construction. |
| F | Fair | Remove due to tree health or invasive status. |
| P | Poor | PROTECT |
| VP | Very Poor | PROTECT |

EXISTING TREE INVENTORY - SINGLES

NOTE: INDIVIDUAL TREE LOCATIONS ARE APPROXIMATE. EXACT LOCATION TO BE DETERMINED ON SITE.

| Key | Botanical Name | Common Name | DBH (cm) | CRZ (m) | Condition | Owner | Remarks | Recomm. |
|-----|---------------------------|---------------------|----------|---------|-----------|----------|--|----------|
| 1 | <i>Acer rubrum</i> | Red Maple | 45.0 | 4.50 | F | Neighbor | Bare. Low vigor and several small cavities | PROTECT |
| 2 | <i>Picea glauca</i> | White Spruce | 21.0 | 2.10 | G | Neighbor | Mechanical damage | PROTECT |
| 3 | <i>Picea glauca</i> | White Spruce | 35.0 | 3.50 | F | Neighbor | Lean | PROTECT |
| 4 | <i>Picea glauca</i> | White Spruce | 0.0 | 0.00 | VP | Neighbor | Dead standing | PROTECT |
| 5 | <i>Larix laricina</i> | Tamarack | 36.0 | 3.60 | G | Neighbor | None | PROTECT |
| 6 | <i>Picea glauca</i> | White Spruce | 34.0 | 3.40 | VP | Neighbor | Tree topped at 5meters | PROTECT |
| 7 | <i>Thuja occidentalis</i> | Eastern White Cedar | 16.0 | 1.60 | P | Neighbor | One sided, nearly dead | PROTECT |
| 8 | <i>Pinus strobus</i> | Eastern White Pine | 39.0 | 3.90 | P | Neighbor | One stem dead | PROTECT |
| 9 | <i>Acer rubrum</i> | Red Maple | 12.0 | 1.20 | P | Neighbor | Target carker | PROTECT |
| 10 | <i>Acer negundo</i> | Manitoba Maple | 48.0 | 4.80 | VP | Neighbor | Multiple large wounds, internat rot | PROTECT |
| 11 | <i>Populus deltoides</i> | Eastern Cottonwood | 17.0 | 1.70 | G | Neighbor | None | PROTECT |
| 12 | <i>Populus deltoides</i> | Eastern Cottonwood | 28.0 | 2.80 | G | Neighbor | None | PROTECT |
| 13 | <i>Malus spp</i> | Crab Apple | 19.0 | 1.90 | VP | Neighbor | Granular placed on roots | PROTECT |
| 14 | <i>Acer negundo</i> | Manitoba Maple | 27.0 | 2.70 | VP | Neighbor | Spiral seam cavity. Mechanical damage. Granular placed on roots | PROTECT |
| 15 | <i>Acer saccharum</i> | Sugar Maple | 55.0 | 5.50 | P | Client | One sided, black bark, grass growing out of a cavity near a large branch union | Conflict |

EXISTING TREE INVENTORY - GROUPS

| Key | Botanical Name | Common Name | % Compos. | DBH Min-Max | DBH Avg | Owner | Remarks | Recomm. |
|-----------------------------|----------------------------|--------------------|-----------|-------------|---------|-----------------|---------|----------|
| Area A - Trees | | | | | | | | |
| A | <i>Acer saccharum</i> | Sugar Maple | 5% | 95 - 80 | 57.50 | Client | | Conflict |
| A | <i>Fraxinus americana</i> | White Ash | 10% | 40 - 50 | 45.00 | Client | | Conflict |
| A | <i>Populus deltoides</i> | Eastern Cottonwood | 80% | 15 | 10.00 | Client | | Conflict |
| A | <i>Juglans nigra</i> | Black Walnut | 5% | 40 - 50 | 45.00 | Client | | Conflict |
| Area A - Understorey | | | | | | | | |
| A | <i>Rhamnus cathartica</i> | European Buckthorn | 10% | 5.00 | 5.00 | Client | | Conflict |
| A | <i>Rhus typhina</i> | Staghorn Sumac | 85% | 5.00 | 5.00 | Client | | Conflict |
| Area B | | | | | | | | |
| B | <i>Rhamnus cathartica</i> | European Buckthorn | 10% | 5.00 | 5.00 | Client | | Conflict |
| B | <i>Rhus typhina</i> | Staghorn Sumac | 85% | 5.00 | 5.00 | Client | | Conflict |
| Area C | | | | | | | | |
| C | <i>Acer rubrum</i> | Red Maple | 5% | 95 - 80 | 57.50 | Client | | Conflict |
| C | <i>Acer saccharum</i> | Sugar Maple | 5% | 95 - 80 | 57.50 | Client | | Conflict |
| C | <i>Betula papyrifera</i> | Paper Birch | 85% | 10 | 10.00 | Client | | Conflict |
| C | <i>Cornus alternifolia</i> | Pagoda Dogwood | 5% | 5 | 5.00 | Client | | Conflict |
| C | <i>Pinus strobus</i> | Eastern White Pine | 15% | 30 - 40 | 36.00 | Client | | Conflict |
| C | <i>Salix sp.</i> | Willow | 5% | 15.00 | 15.00 | Client | | Conflict |
| Area D | | | | | | | | |
| D | <i>Betula papyrifera</i> | Paper Birch | 40% | 10.00 | 10.00 | Client/Neighbor | | PROTECT |
| D | <i>Populus deltoides</i> | Eastern Cottonwood | 60% | 15.00 | 15.00 | Client/Neighbor | | PROTECT |

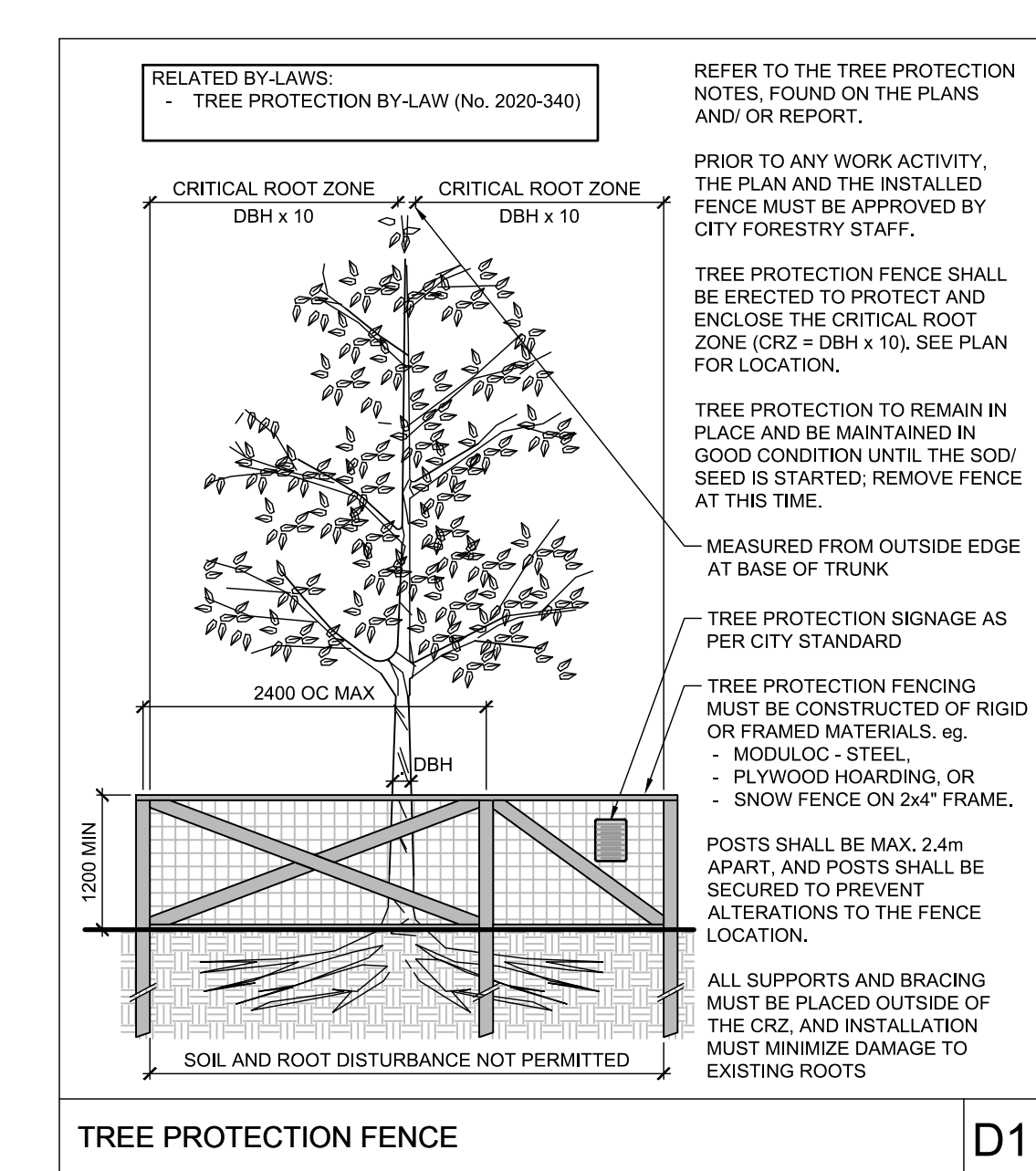

NOTE: THE POSITION OF ALL POLE LINES, CONDUITS, WATERMANS, SEWERS AND OTHER UNDERGROUND AND OVERGROUND UTILITIES AND STRUCTURES IS NOT NECESSARILY SHOWN ON THE CONTRACT DRAWINGS, AND WHERE SHOWN, THE ACCURACY OF THE POSITION OF SUCH UTILITIES AND STRUCTURES IS NOT GUARANTEED. BEFORE STARTING WORK, DETERMINE THE EXACT LOCATION OF ALL SUCH UTILITIES AND STRUCTURES AND ASSUME ALL LIABILITY FOR DAMAGE TO THEM.

NOT FOR CONSTRUCTION

OWNER INFORMATION
262576 ONTARIO INC.
231 BRITANNY DRIVE, SUITE D
OTTAWA, ONTARIO, K1K 0R8
LALIT AGGARWAL
PHONE: (613)-746-1647
lsa@manorparkcp.com

| No. | REVISION | DATE | BY |
|-----|------------------------------|------------|----|
| 4 | REVISED PER CITY COMMENTS | JUL 11/24 | RJ |
| 3 | REVISED PER CITY COMMENTS | FEB 28/24 | RJ |
| 2 | REVISED PER CITY COMMENTS | JUNE 13/23 | RJ |
| 1 | ISSUED FOR SITE PLAN CONTROL | JUNE 13/23 | RJ |

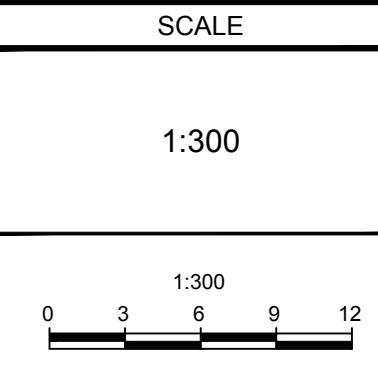

FOR REVIEW ONLY

| | |
|----------|----|
| DESIGN | RI |
| CHECKED | MT |
| DRAWN | RI |
| CHECKED | MT |
| APPROVED | RJ |



NOVATECH
Engineers, Planners & Landscape Architects
Suite 200, 240 Michael Cowland Drive
Ottawa, Ontario, Canada K2M 1P6
Telephone: (613) 254-9643
Facsimile: (613) 254-5867
Website: www.novatech-eng.com

LOCATION
CITY OF OTTAWA
3317 NAVAN ROAD

DRAWING NAME
TREE CONSERVATION REPORT

| | |
|-------------|------------|
| PROJECT No. | 118076 |
| REV | REV # 4 |
| DRAWING No. | 118076-TCR |

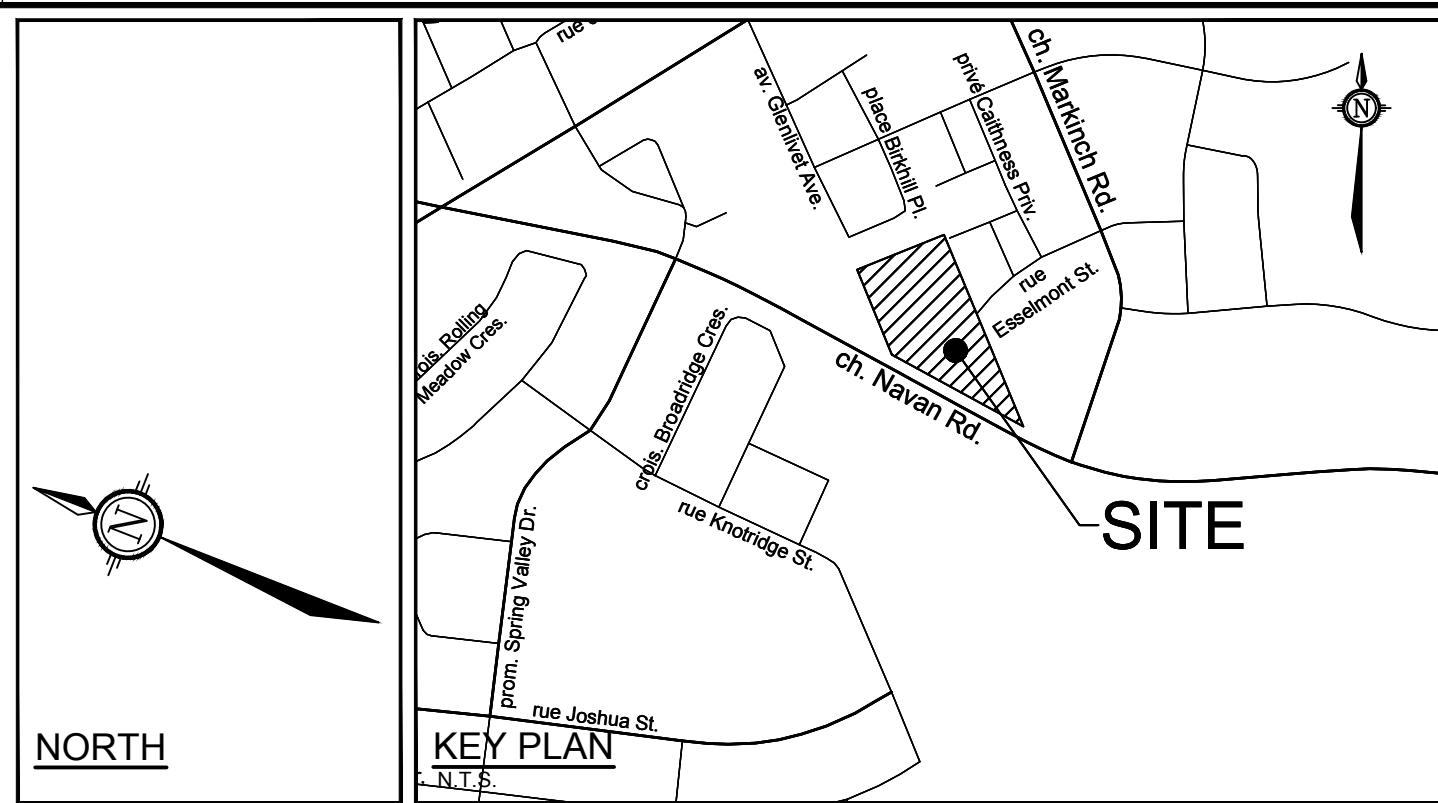
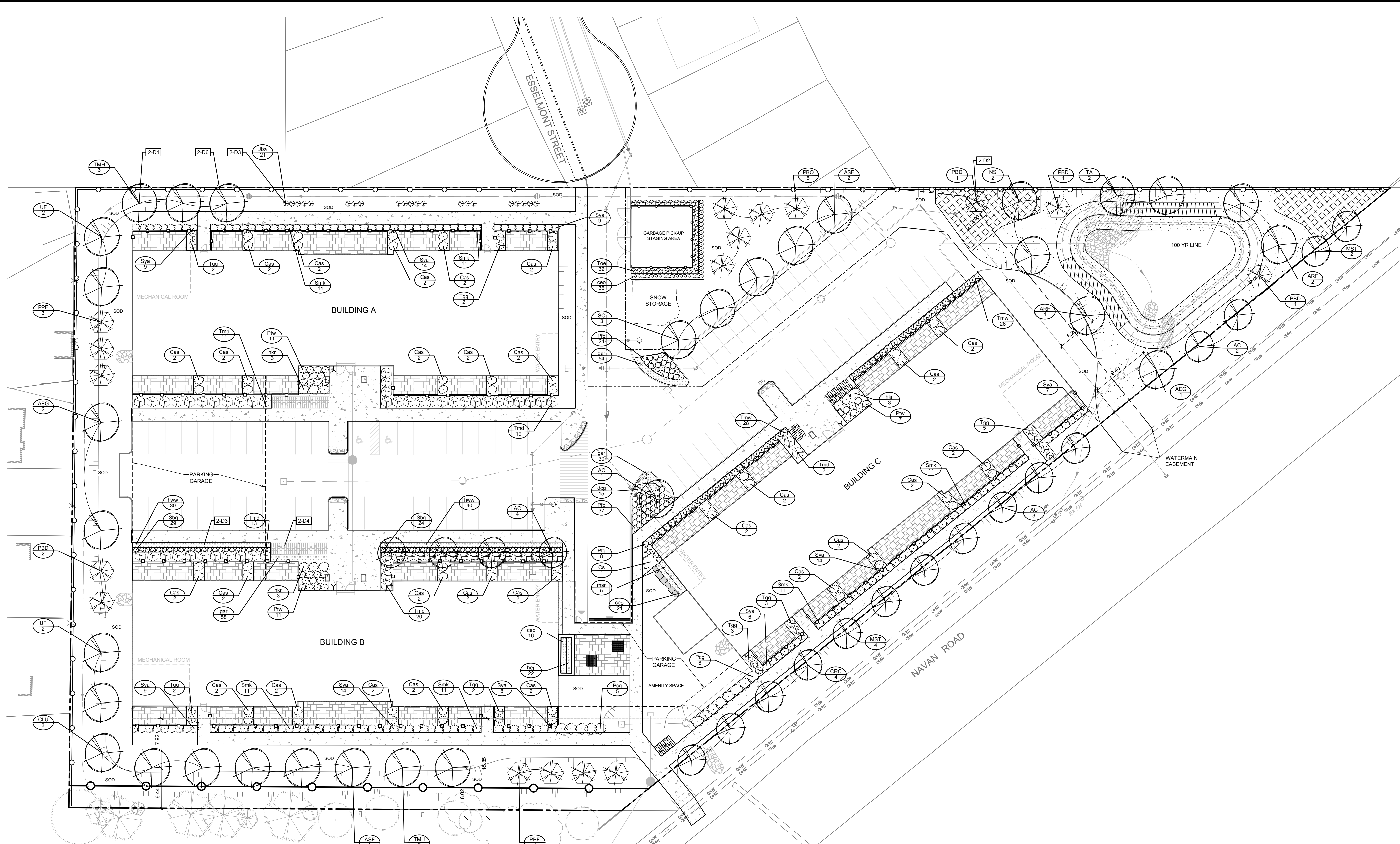

LEGEND

- 2-D1 DETAIL SHEET # NOVATECH OR CITY EG. L1, L2, ETC. - DETAIL NUMBER SEE LIST FOR CODE.
- PROPERTY LIMIT
- PROPOSED CONCRETE
- PROPOSED PAVERS
- SEED MIX A
- SEED MIX B
- NATIVE SHRUB MIX
- TABLE LAND SHRUB MIX (SMALL)
- PERENNIALS / GRASSES
- SHRUB MIX
- PROPOSED DECIDUOUS TREE
- PROPOSED CONIFEROUS TREE
- PROPOSED SHRUBS
- SPECIES (SEE PLANT LIST)
- QUANTITY
- ACCESSIBLE PICNIC TABLE
- BOULDERS
- TREE PROTECTION FENCE
- WOOD PRIVACY FENCE 1.8m HT
- DECORATIVE FENCE 1.2m HT
- ANTICIPATED LIMIT OF EXCAVATION FOR UNDERGROUND GARAGE

GENERAL

- Read and interpret this drawing/ drawing set in conjunction with all the contract details and specifications, including related civil, utility, architectural, mechanical, electrical, environmental, geotechnical, and survey information.
- The Contractor is to determine the exact location, size, material, and elevation of all existing utilities prior to commencing construction. Protect and assume responsibility for all existing utilities regardless of being shown on the drawings.
- It is essential to use the plans and details in conjunction with the specifications and notes.
- Do not scale drawings. Work to dimensions only.
- Protect all existing and retained vegetation for the duration of construction according to the contract details and specifications.
- Reinstatement of all areas and items damaged or disturbed, beyond the Limit of Work, because of construction activities, including but not limited to construction staging areas, haul roads, stockpile areas, etc. to the satisfaction of the Consultant. Unless otherwise noted, Contractor is to reinstate all areas to pre-construction condition or better to the satisfaction of the Contract Administrator.

PLANTING

- Plant material to be No. 1 Grade and is to comply with Canadian Standards for Nursery Stock (latest edition) published by the Canadian Nursery Landscape Association.
- Use structurally sound plant material with strong fibrous root system free of diseases, defects, and injuries. Use trees with straight trunks, well and characteristically branched for species. Obtain approval from consultant of plant material at source prior to digging. All trees and shrubs to be container grown, potted, W/B or B/B, as indicated on Plant List. Bare root plants are only acceptable for certain species and as approved by the Landscape Architect.
- Plant material substitutions are not permitted without the written approval from the Consultant, with 48 hours notice, prior to shipping plant material.
- Plant locations are schematic/ approximate only. Contractor is to stake out locations on site for approval by the Landscape Architect prior to installation.
- The illustrated number of plants shown in the Planting Plan supersedes the estimated number in the Plant List. Contractor to report any discrepancies to the Landscape Architect prior to installation. Contractor will assume full responsibility if the Landscape Architect is not notified.
- Ensure trees are thoroughly watered following planting. Monitor material and ensure adequate moisture until acceptance.
- In heavy clay or poorly drained soils, set root ball with root collar 75-100mm higher than finished grade.
- Approved topsoil depths are as follows:
 - Plant Beds - 450mm continuous depth. Applies to shrubs, perennials, vines, and groundcovers.
 - Sod/ Seed Areas - 100mm depth.
- Sod to be No. 1 Kentucky Bluegrass Sod grown from minimum mixture of 3 Kentucky Bluegrass cultivars. Quality and source are to comply with Canadian Standards for Nursery Stock, Section 17, (latest edition) published by the Canadian Nursery Landscape Nursery Landscape Association.
- Apply the following mineral fertilizer unless soil tests show other requirements:
 - Plant Beds - (8-32-16), i.e. 8% Nitrogen, 32% Phosphorus, 16% Potash per manufacturer specifications.
 - Sod Areas - (8-32-16), i.e. 8% Nitrogen, 32% Phosphorus, 16% Potash at a rate of 350kg/ha.
- Where applicable, for any plant species with a mix of species/ cultivars notes, Contractor is to cluster like plants in groups of 3-5 and evenly distribute these in the noted area.

CITY DETAILS

Related details from City of Ottawa Standard Tender Documents Volume No. 2 Standard Detail Drawings.

- SC4. Typical Concrete Sidewalk in Boulevard
- D2. Standard Coniferous Tree Planting
- D3. Shrub and Perennial Planting
- D4. Bike Layout
- D5. Boulder
- D6. Wood Privacy Fence

NOVATECH DETAILS

Found on Sheet L2.

- D1. Standard Deciduous Tree Planting
- D2. Standard Coniferous Tree Planting
- D3. Shrub and Perennial Planting
- D4. Bike Layout
- D5. Boulder
- D6. Wood Privacy Fence

PRODUCT INFORMATION

Install products as per manufacturer specifications. Shop drawings required.

PAVERS

- Edge of pavers to receive edge restraint.
- Metville 60 Pavers by Permacon
- Colour: TBD

FENCE

- Elegant Traditional Panel by Iron Eagle Industries
- Panel Height: 1219mm (42")
- Post Cap: Pyramid
- Colour: Black

SITE FURNITURE

Fasten all site furnishing to surface with stainless steel anti-vandal anchors.

PICNIC TABLES

- 200 Series - 210 Accessible Cluster Seating by Maglin
- Product Number: MTS-0210-00042
- Frame: Structural I-Beam
- Top: Wood Table Top and Attached Blacksteel Benches (2)
- Cedar Color
- Surface Mount, Wheelchair Accessible

WASTE RECEPTACLE

- 200 Series - 250 Trash Receptacle by Maglin
- Product Number: MTR-0250-00004
- Frame: H.S. Steel
- Metal Lid
- 32 Gallon

BOULDERS

Sizes: 1.0-1.5m L x 0.7-1.0m W x 0.6-0.8m H

SEED MIX AND APPLICATION

For areas steeper than 3:1. Contractor to apply erosion control blanket. Erosion control blanket to be machine woven mats made from natural wood, coco or cotton fiber, or combination depending on manufacturer, with stitching between two photo-degradable natural organic fiber nettings. Submit products for approval by Consultant. CPSS 804 applies except as may be amended and extended herein.

TREE PLANTING IN SENSITIVE CLAY

The landscape plans have been developed in accordance with the Geotechnical Report PG6582-1, Revision 1, Pattern Cap, Pyramid, January 29, 2024, that confirms the categories and locations of clay soils and tree planting restriction recommendations.

- The following City of Ottawa clay soils guideline applies: Guidelines for Tree Planting in Sensitive Marine Clay Soils (2017).
- The soil volumes provided are sufficient for a reasonable chance of tree survival. Unless otherwise noted, all new trees on City property meet the minimum soil volume requirements of the following, based on a depth of 1.5m below finished grade, and subtracting the volume of utility trenches.
 - Small tree (mature height up to 7.5m) - 25m³ minimum soil volume provided.
 - Medium tree (mature height 7.5-14m) - 30m³ minimum soil volume provided.
- Where trees share a continuous greenspace:
 - (2) Small trees - 15m³ minimum soil volume provided per tree.
 - (2) Medium trees - 18m³ minimum soil volume provided per tree.

NOTE: THE POSITION OF ALL POLE LINES, CONDUITS, WATERMANS, SEWERS AND OTHER UNDERGROUND AND OVERGROUND UTILITIES AND STRUCTURES IS NOT NECESSARILY SHOWN ON THE CONTRACT DRAWINGS, AND WHERE SHOWN, THE ACCURACY OF THE POSITION OF SUCH UTILITIES AND STRUCTURES IS NOT GUARANTEED. BEFORE STARTING WORK, DETERMINE THE EXACT LOCATION OF ALL SUCH UTILITIES AND STRUCTURES AND ASSUME ALL LIABILITY FOR DAMAGE TO THEM.

| NO. | REVISION | DATE | BY |
|-----|------------------------------|------------|----|
| 4. | REVISED PER CITY COMMENTS | JUL 11/24 | RJ |
| 3. | REVISED PER CITY COMMENTS | FEB 28/24 | RJ |
| 2. | REVISED PER CITY COMMENTS | NOV 13/23 | RJ |
| 1. | ISSUED FOR SITE PLAN CONTROL | JUNE 13/23 | RJ |

SHRUB MIXES

| % | QTY | BOTANICAL NAME | COMMON NAME | SIZE | COND | SPACING |
|-----|-----|--------------------------------|-----------------|---------|------|---------|
| 15% | 10 | <i>Andropogon scoparius</i> | Common Nutsedge | 10cm H | PT | 1.5m OC |
| 10% | 10 | <i>Hemerocallis virginiana</i> | Witch Hazel | 60cm H | PT | 1.5m OC |
| 20% | 21 | <i>Rhus typhina</i> | Staghorn Sumac | 60cm H | PT | 1.5m OC |
| 15% | 16 | <i>Rhus aromatica</i> | Fragrant Sumac | 0.60m H | PT | 1.5m OC |
| 20% | 21 | <i>Rosa carolina</i> | Pink Rose | 60cm H | PT | 1.5m OC |
| 20% | 21 | <i>Viburnum lentago</i> | Nannyberry | 60cm H | PT | 1.5m OC |

PLANT LIST

| KEY | QTY | BOTANICAL NAME | COMMON NAME | SIZE | COND | SPACING |
|-----|-----|-------------------------------------|--------------------------|---------|------|----------|
| PPF | 7 | <i>Picea pungens 'Fastigata'</i> | Upright Colorado Spruce | 150cm H | WB | As Shown |
| PBD | 4 | <i>Picea pungens 'Blue Diamond'</i> | Blue Diamond Blue Spruce | 200cm H | WB | As Shown |
| PBC | 6 | <i>Picea pungens 'Bony Blue'</i> | Bony Blue Spruce | 175cm H | WB | As Shown |

OWNER INFORMATION

2632576 ONTARIO INC.

231 BRITANNY DRIVE, SUITE D

OTTAWA, ONTARIO, K1K 0R8

LALIT AGGARWAL

PHONE: (613)-746-1647

lsa@manorparkcap.com

LOCATION

CITY OF OTTAWA

3317 NAVAN ROAD

DRAWING NAME

LANDSCAPE PLAN

Engineers, Planners & Landscape Architects

Suite 200, 240 Michael Cowland Drive

Ottawa, Ontario, Canada K2M 1P6

Telephone: (613) 254-9643

Facsimile: (613) 254-5867

Website: www.novatech-eng.com

FOR REVIEW ONLY

DATE: JUN 11 2024

SCALE: 1:300

PROJECT NO: 118076

REV # 4

DRAWING NO: 118076-L1

D07-12-23-0085

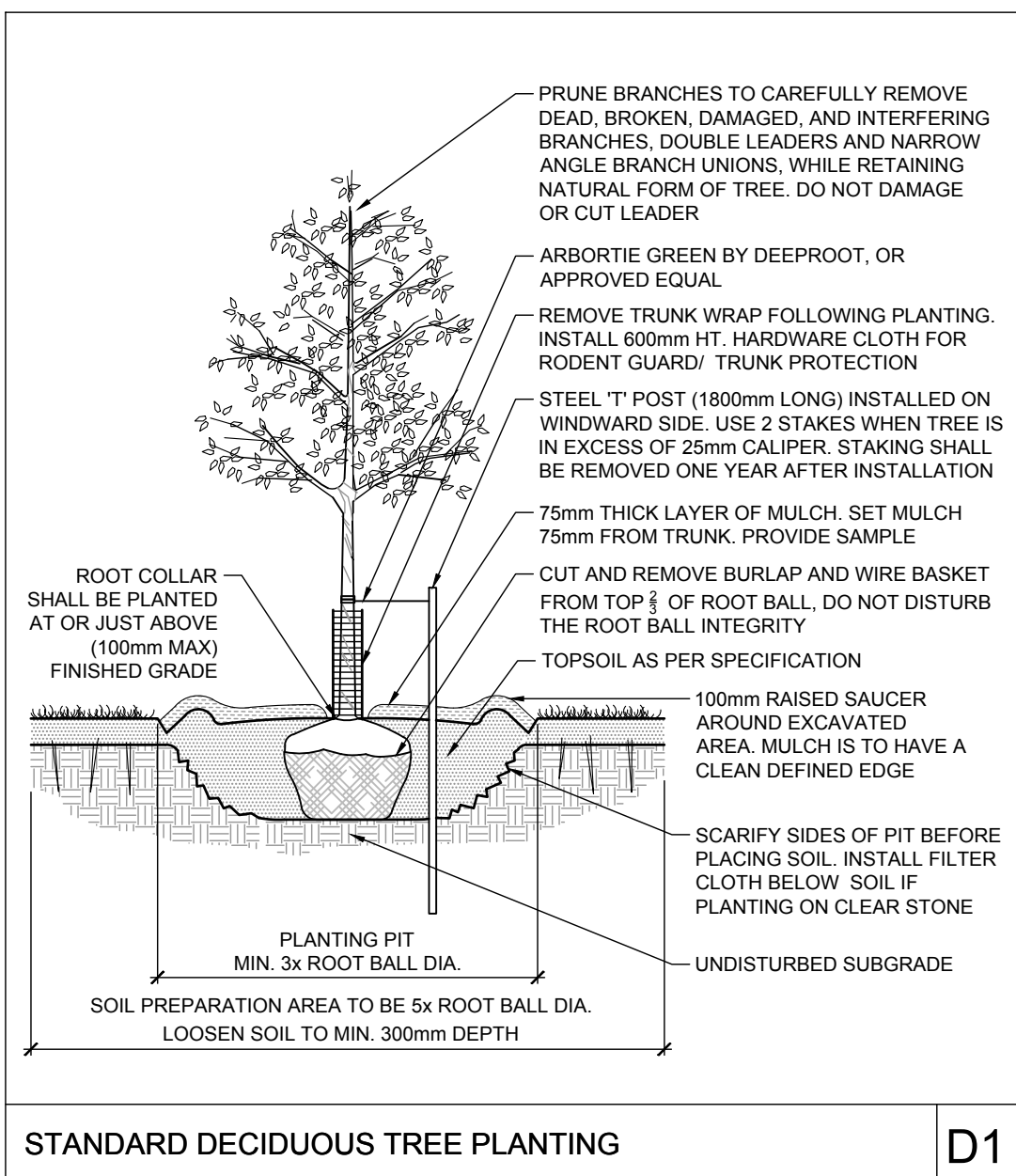

D1

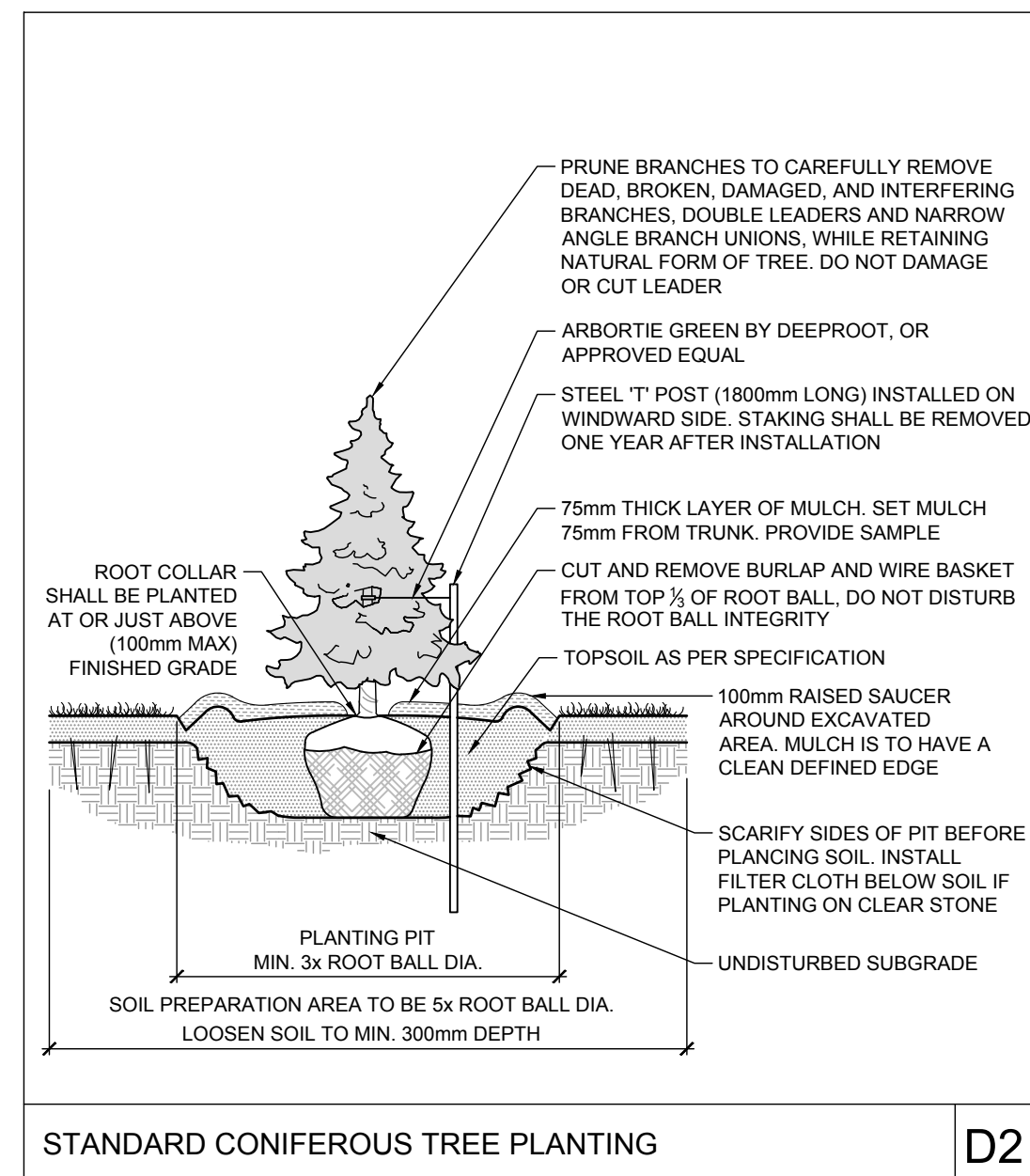

D2

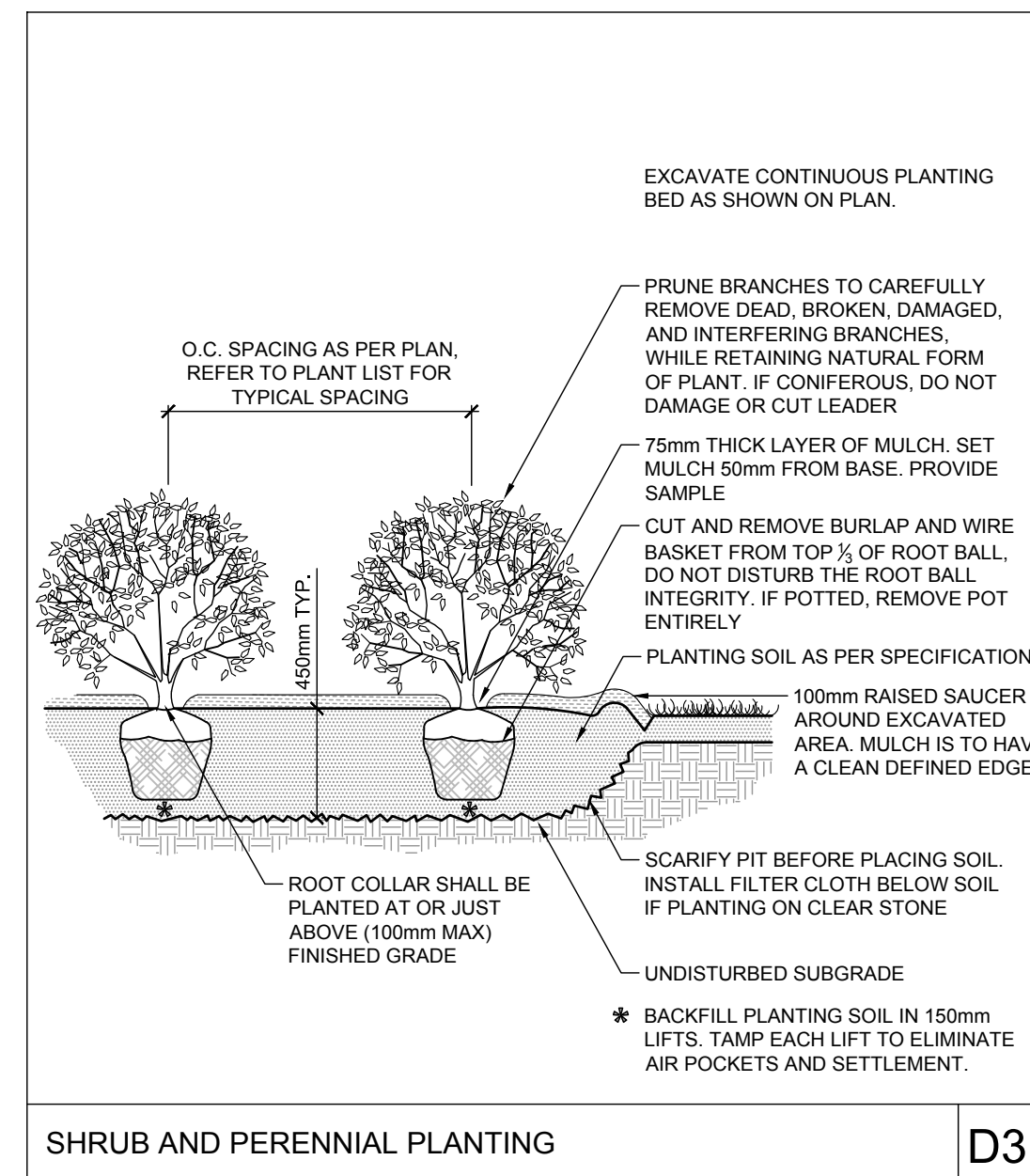

D3

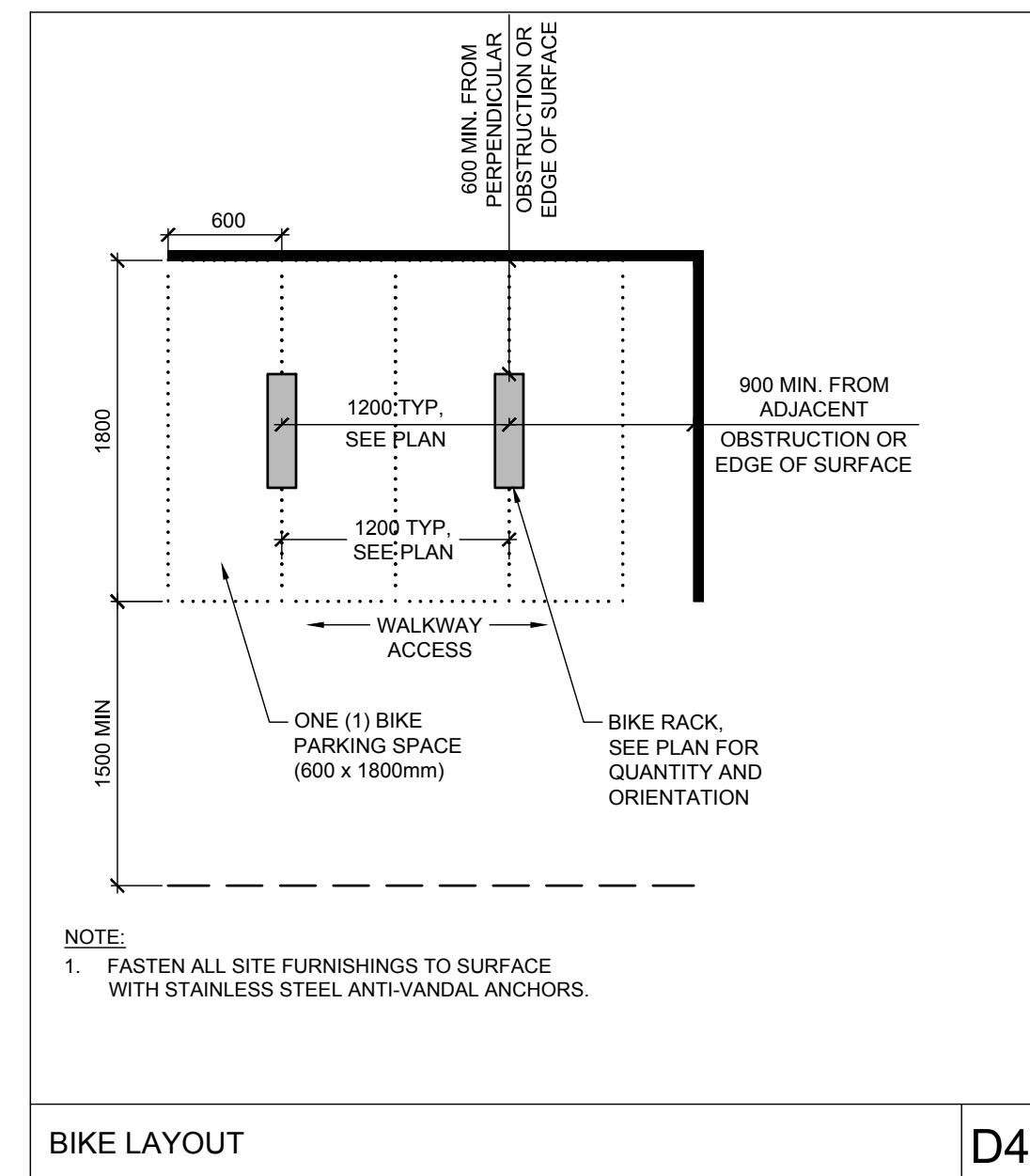

D4

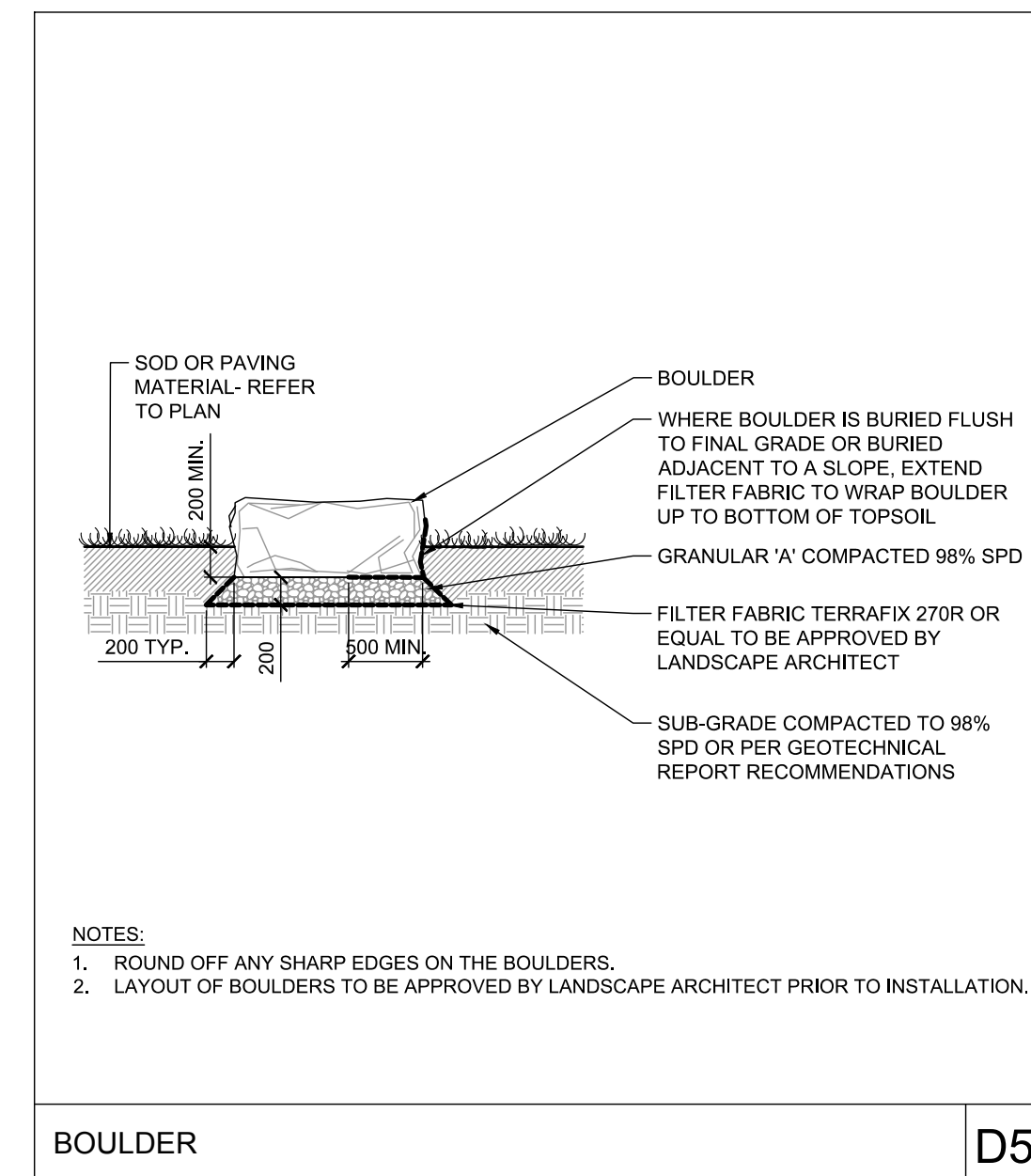

D5

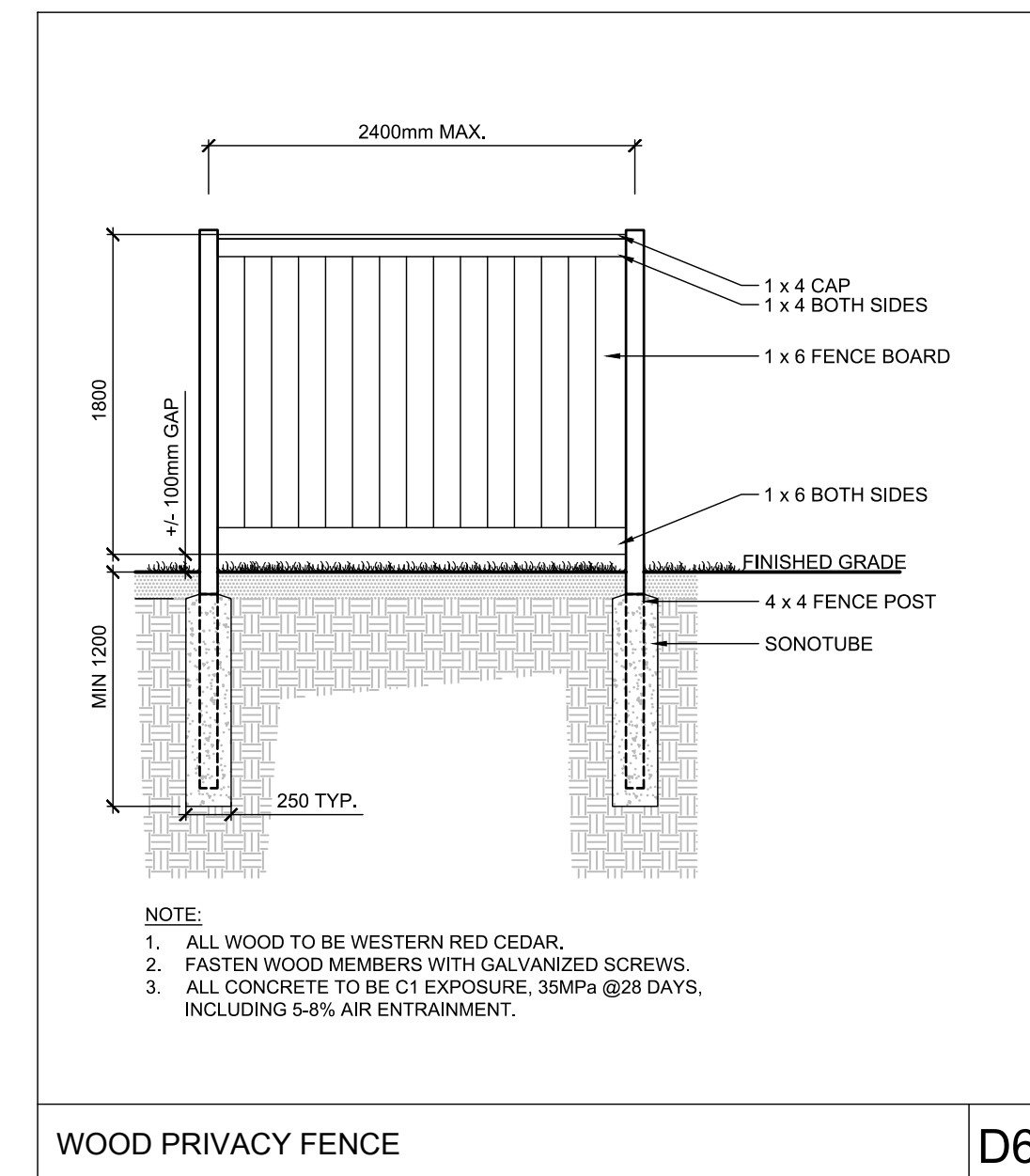

D6

NOTE:
THE POSITION OF ALL POLE LINES, CONDUITS, WATERMANS, SEWERS AND OTHER UNDERGROUND AND OVERGROUND UTILITIES AND STRUCTURES IS NOT NECESSARILY SHOWN ON THE CONTRACT DRAWINGS, AND WHERE SHOWN, THE ACCURACY OF THE POSITION OF SUCH UTILITIES AND STRUCTURES IS NOT GUARANTEED. BEFORE STARTING WORK, DETERMINE THE EXACT LOCATION OF ALL SUCH UTILITIES AND STRUCTURES AND ASSUME ALL LIABILITY FOR DAMAGE TO THEM.

NOT FOR CONSTRUCTION

OWNER INFORMATION
2625576 ONTARIO INC.
231 BRITTANY DRIVE, SUITE D
OTTAWA, ONTARIO, K1K 0R8
LALIT AGGARWAL
PHONE: (613)-746-1647
lsa@manorparkcap.com

| No. | REVISION | DATE | BY |
|-----|------------------------------|------------|----|
| 4. | REVISED PER CITY COMMENTS | JUL 11/24 | RJ |
| 3. | REVISED PER CITY COMMENTS | FEB 28/24 | RJ |
| 2. | REVISED PER CITY COMMENTS | NOV 13/23 | RJ |
| 1. | ISSUED FOR SITE PLAN CONTROL | JUNE 13/23 | RJ |

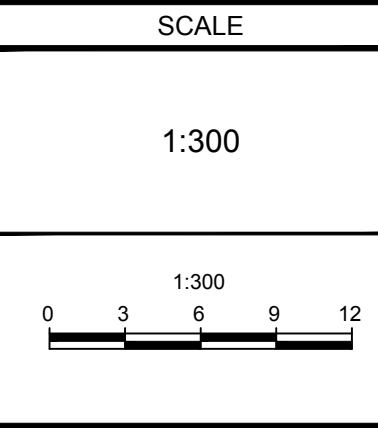

| | |
|----------|----|
| DESIGN | RI |
| CHECKED | RJ |
| DRAWN | RI |
| CHECKED | RJ |
| APPROVED | RJ |

FOR REVIEW ONLY

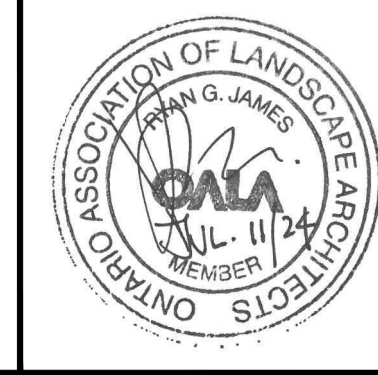

NOVATECH
Engineers, Planners & Landscape Architects
Suite 200, 240 Michael Cowpland Drive
Ottawa, Ontario, Canada K2M 1P6
Telephone: (613) 254-9643
Facsimile: (613) 254-5867
Website: www.novatech-eng.com

LOCATION
CITY OF OTTAWA
3317 NAVAN ROAD
DRAWING NAME
DETAILS

| | |
|-------------|-----------|
| PROJECT No. | 118076 |
| REV | REV # 4 |
| DRAWING No. | 118076-L2 |

C:\Users\118076\OneDrive\Documents\118076-L2.dwg, L2, Jul 11, 2024, 1:49pm, mlsh

#19008