

# WATERIDGE VILLAGE AT ROCKCLIFFE



333 Preston Street - Suite 500  
Ottawa ON K1S 5N4 Canada  
tel 613 225 1311  
[www.arcadis.com](http://www.arcadis.com)



100 Queen Street  
Ottawa, On  
K1P 1J9

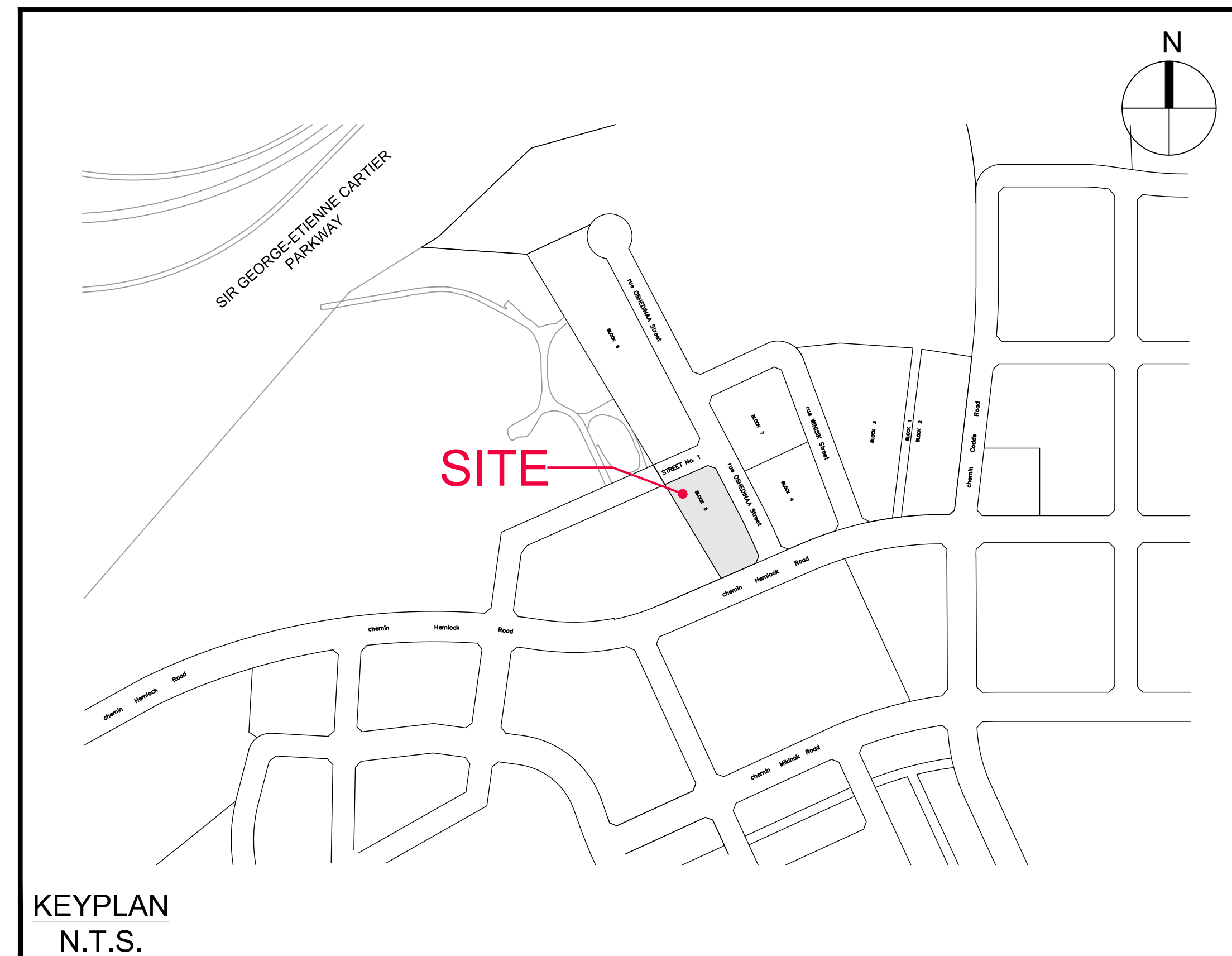

Sheet List Table

| Sheet Number | Sheet Title                       |
|--------------|-----------------------------------|
| C-000        | COVER                             |
| C-REM        | REMOVALS PLAN                     |
| C-010        | NOTES AND LEGEND                  |
| C-001        | GENERAL PLAN OF SERVICES          |
| C-200        | GRADING PLAN                      |
| C-500        | STORM DRAINAGE AREA PLAN          |
| C-900        | SEDIMENT AND EROSION CONTROL PLAN |

## PHASE 4 BLOCK 5

CONTRACT NO. 143934

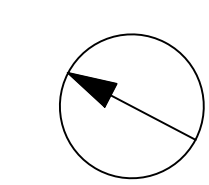
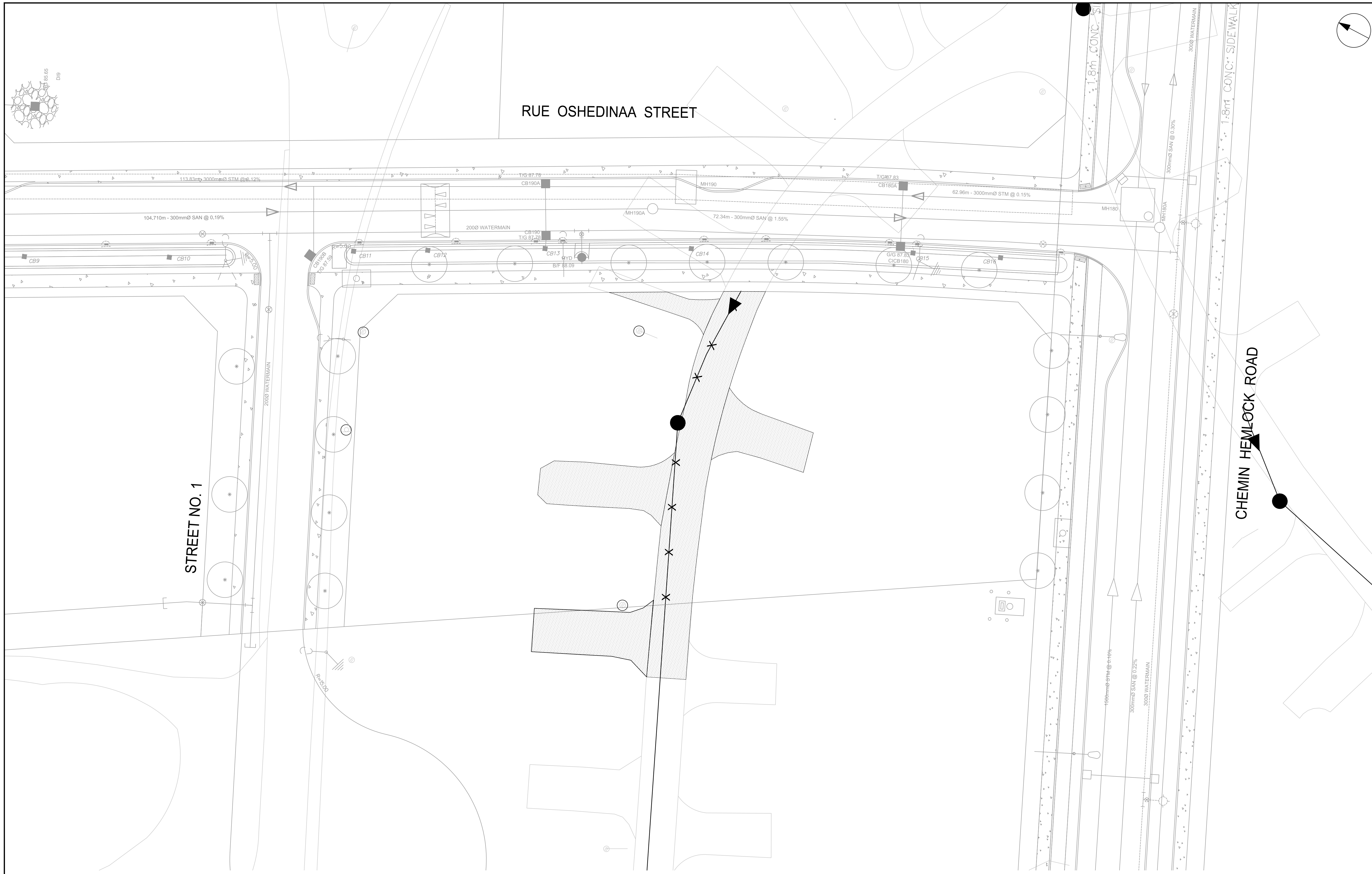

CLIENT  
**ROHIT GROUP**  
 15 FITZGERALD ROAD, NEPEAN, ON

COPYRIGHT  
 This drawing has been prepared solely for the intended use, thus any reproduction or distribution for any purpose other than authorized by Arcadis is forbidden. Written dimensions shall have precedence over scaled dimensions. Contractors shall verify and be responsible for all dimensions and conditions on the job, and Arcadis shall be informed of any variations from the dimensions and conditions shown on the drawing. Shop drawings shall be submitted to Arcadis for general conformance before proceeding with fabrication.

Arcadis Professional Services (Canada) Inc.  
 Formerly BSI Group Professional Services (Canada) Inc.

| ISSUES |                                 |            |
|--------|---------------------------------|------------|
| No.    | DESCRIPTION                     | DATE       |
| 1      | SUBMISSION NO.1 FOR CITY REVIEW | 2023-12-08 |
| 2      | SUBMISSION NO.2 FOR CITY REVIEW | 2024-03-04 |
| 3      | SUBMISSION NO.3 FOR CITY REVIEW | 2024-05-01 |
| 4      | NEW SITE PLAN                   | 2024-08-07 |
| 5      |                                 |            |
| 6      |                                 |            |
| 7      |                                 |            |
| 8      |                                 |            |

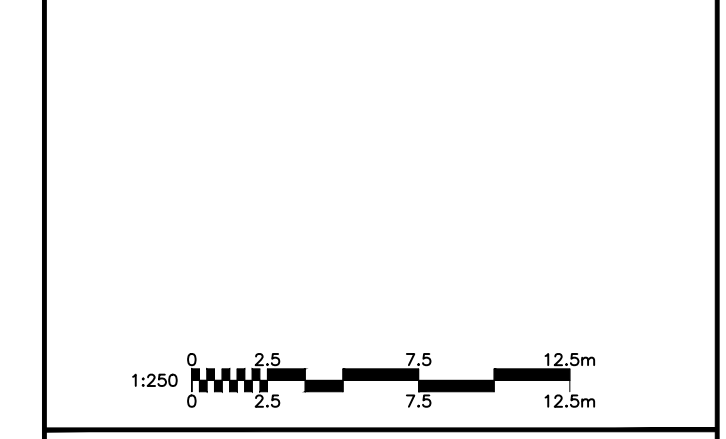
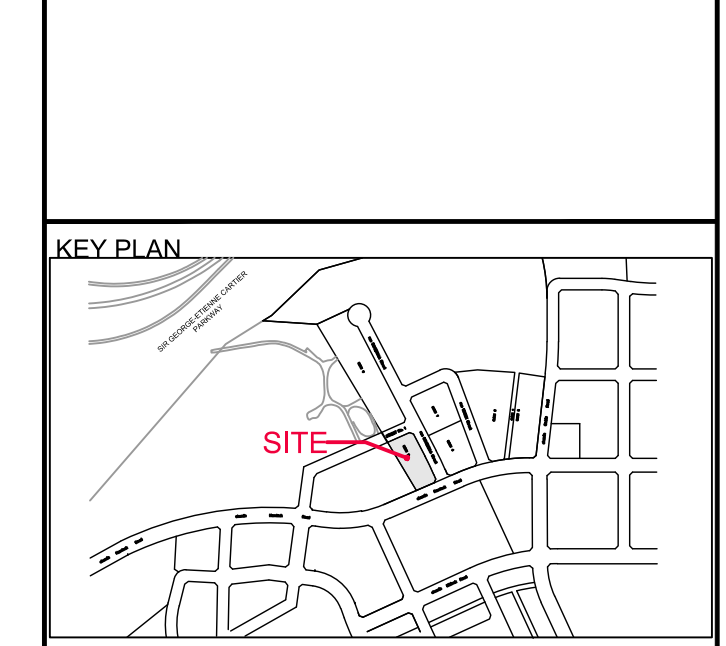

SEAL

PRIME CONSULTANT

333 Preston Street - Suite 500  
 Ottawa ON K1S 5N4 Canada  
 tel 613 225 1311  
 www.arcadis.com

PROJECT  
**WATERIDGE VILLAGE  
 AT ROCKCLIFFE**  
 PHASE 4 - BLOCK 5

PROJECT NO:  
 143934

DRAWN BY:  
**M.M.**

PROJECT MGR:  
**D.C.**

CHECKED BY:  
**D.C.**

APPROVED BY:  
**A.C.**

SHEET TITLE  
**REMOVALS PLAN**

SHEET NUMBER  
**C-REM**

ISSUE  
**4**

|   |   |   |   |
|---|---|---|---|
| ○ | REMOVAL   | ▨ | DRY GRIND EXISTING ASPHALT. AVERAGE DEPTH 50mm.           |
| ⊙ | ADJUST MANHOLE, VALVES                                    | ▩ | FULL DEPTH ASPHALT REMOVAL                                |
| ▣ | ADJUST CATCH BASIN  | ▧ | AREA TO BE CLEARED AND GRUBBED                            |
| ⊕ | ADJUSTMENT BY BELL OR HYDRO APPROVED CONTRACTOR           | ▤ | REMOVAL OF BUILDINGS, FOUNDATIONS, SEPTIC SYSTEM AND WELL |
| X | REMOVE OR ABANDON SEWER, WATERMAIN, UTILITY, CURB RETURNS | ▥ | REMOVALS OF CONCRETE/ ASPHALT SIDEWALK                    |
| ⌋ | PLUG  |   |   |

File Location: J:\143934\_Block\_5\_Phase\_4\7.0\_Production\7.03\_Design\04\_Civil\Sheet\C-REM REMOVALS PLAN-1.dwg Last Saved: April 30, 2024, by M.Milne Plotted: Wednesday, August 7, 2024 2:03:10 PM by Marian Milne  
 D07-XX-XX-XXXX  
 XXXXX

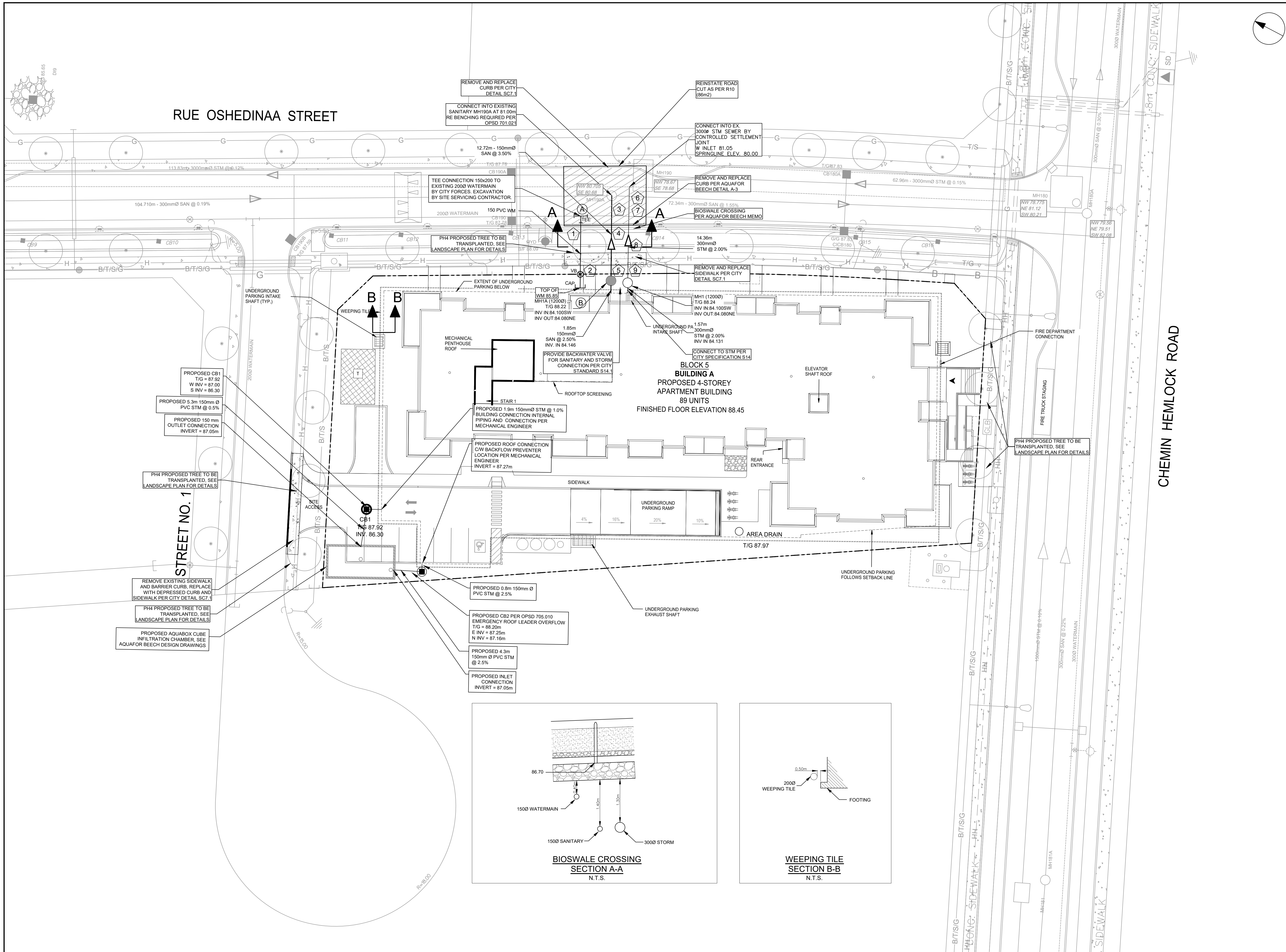

CLIENT  
**ROHIT GROUP**

15 FITZGERALD ROAD, NEPEAN, ON

COPYRIGHT  
This drawing has been prepared solely for the intended use, thus any reproduction or distribution for any purpose other than authorized by Arcadis is forbidden. Written dimensions shall have precedence over scaled dimensions. Contractors shall verify and be responsible for all dimensions and conditions on the job, and Arcadis shall be informed of any variations from the dimensions and conditions shown on the drawing. Shop drawings shall be submitted to Arcadis for general conformance before proceeding with fabrication.

**Arcadis Professional Services (Canada) Inc.**  
Formerly BSI Group Professional Services (Canada) Inc.

| ISSUES | No. | DESCRIPTION                     | DATE       |
|--------|-----|---------------------------------|------------|
|        | 1   | ISSUED FOR CLIENT REVIEW        | 2023-11-22 |
|        | 2   | SUBMISSION NO 1 FOR CITY REVIEW | 2023-12-08 |
|        | 3   | SUBMISSION NO 2 FOR CITY REVIEW | 2024-03-04 |
|        | 4   | SUBMISSION NO 3 FOR CITY REVIEW | 2024-05-01 |
|        | 5   | BIOSWALE CROSSING NOTE ADDED    | 2024-07-08 |
|        | 6   | NEW SITE PLAN                   | 2024-08-07 |
|        | 7   |                                 |            |
|        | 8   |                                 |            |

KEY PLAN

SCALE  
0 2.5 5 7.5 12.5m

SEAL

PRIME CONSULTANT  
**ARCADIS**  
333 Preston Street - Suite 500  
Ottawa ON K1S 5N4 Canada  
tel 613 225 1311  
www.arcadis.com

PROJECT  
**WATERIDGE VILLAGE AT ROCKCLIFFE**  
PHASE 4 - BLOCK 5

PROJECT NO:  
143934

|                      |                      |
|----------------------|----------------------|
| DRAWN BY:<br>M.M.    | CHECKED BY:<br>D.C.  |
| PROJECT MGR:<br>D.C. | APPROVED BY:<br>A.C. |

SHEET TITLE  
**GENERAL PLAN OF SERVICES**

|                              |                   |
|------------------------------|-------------------|
| SHEET NUMBER<br><b>C-001</b> | ISSUE<br><b>6</b> |
|------------------------------|-------------------|

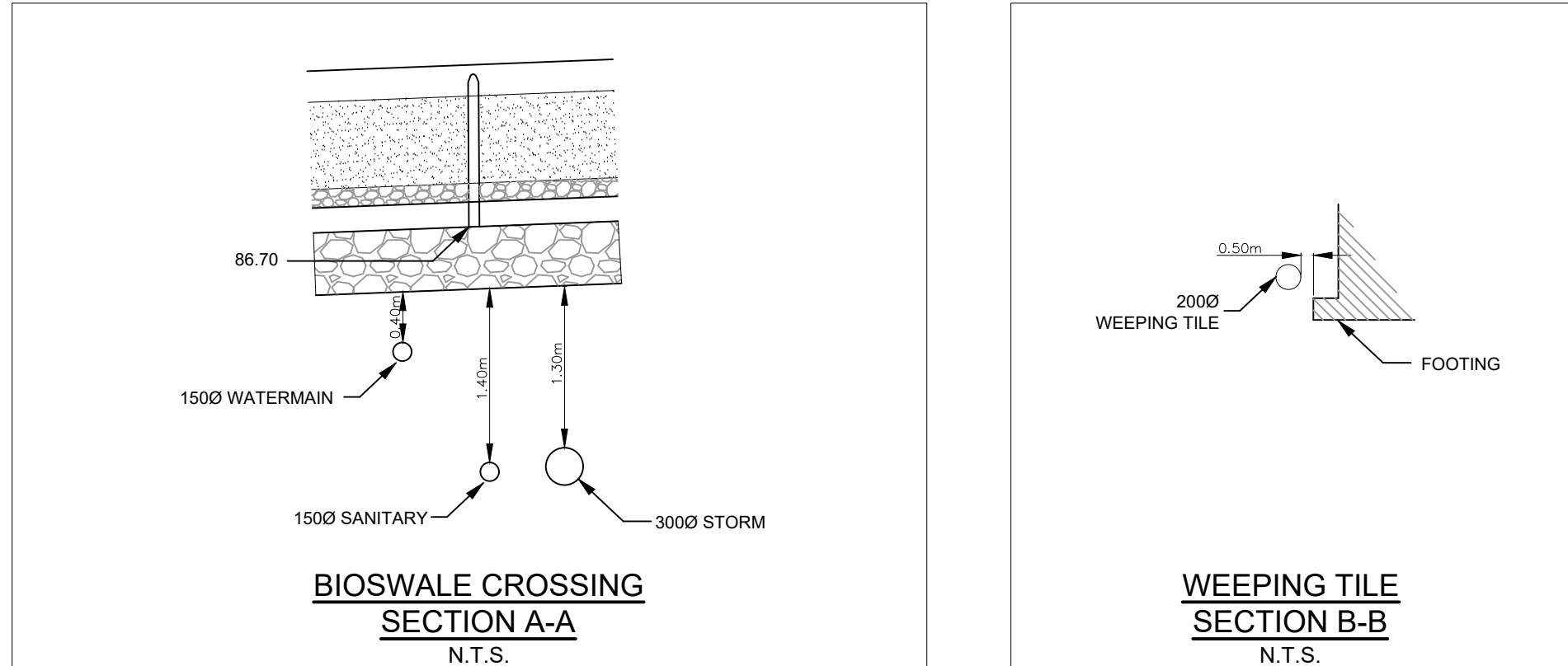

File Location: J:\143934\_01\Drawings\01\_General\01\_General\_Plan\_of\_Services.dwg  
 Last Saved: August 7, 2024, by M.Mline  
 Plotted: Monday, August 12, 2024, 4:17:17 PM by Sarantina Labadie  
 D07-XX-XX-XXXX  
 XXXXX  
 1 in

**GENERAL LEGEND**

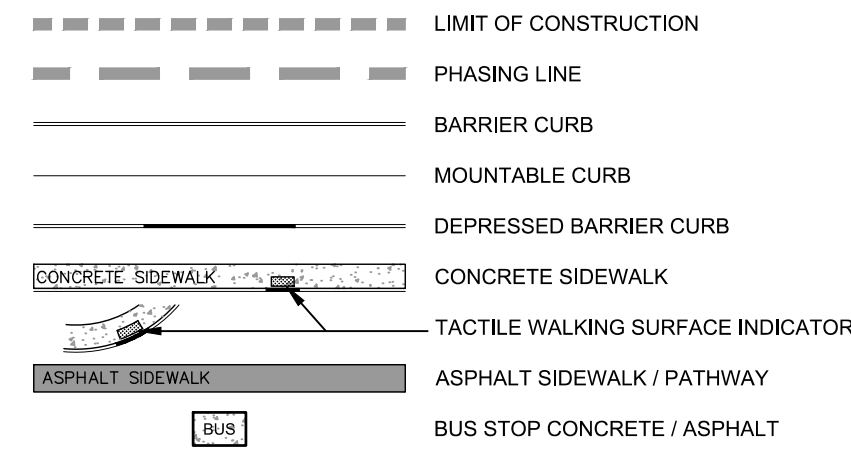

**SERVICING LEGEND**

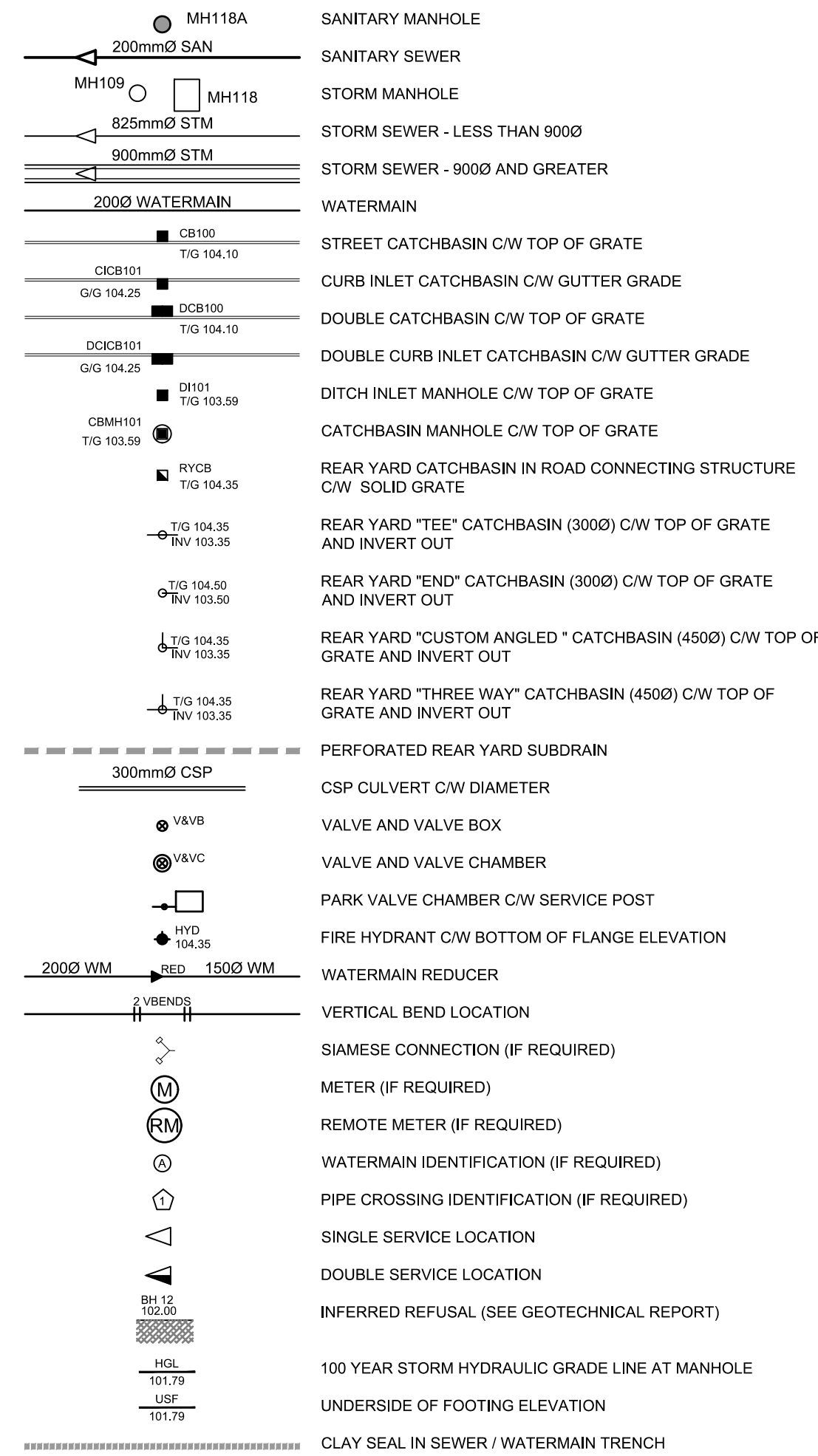

**UTILITY NOTES :**

- ALL MATERIALS AND CONSTRUCTION IS TO BE IN ACCORDANCE WITH THE CURRENT CITY OF OTTAWA STANDARD DRAWINGS & SPECIFICATIONS OR OPSD/OPSS IF CITY DRAWINGS AND SPECIFICATIONS DO NOT APPLY.
- THE POSITION OF UNDERGROUND AND ABOVEGROUND SERVICE, UTILITIES AND STRUCTURES ARE NOT NECESSARILY SHOWN ON THE CONTRACT DRAWINGS, AND WHERE SHOWN, THE ACCURACY OF THE POSITION OF SUCH SERVICE, UTILITIES AND STRUCTURES IS NOT GUARANTEED. THE CONTRACTOR IS RESPONSIBLE FOR DETERMINING THE EXACT LOCATION, SIZE, MATERIAL AND ELEVATION OF ALL EXISTING SERVICES AND UTILITIES PRIOR TO CONSTRUCTION.
- THE CONTRACTOR SHALL REPORT ALL CONFLICTS, DISCOVERIES OF ERROR AND DISCREPANCIES TO THE ENGINEER.
- THE CONTRACTOR SHALL BE RESPONSIBLE TO PROTECT AND ASSUME RESPONSIBILITY FOR ALL UTILITIES WHETHER OR NOT SHOWN ON THESE DRAWINGS.
- THESE DRAWINGS ARE NOT TO BE SCALED OR USED FOR LAYOUT PURPOSES.
- THE COMPOSITE UTILITY PLAN HAS BEEN REVIEWED BY ARCADIS FOR CONFORMITY TO THE DESIGN CONCEPT FOR THE DEVELOPMENT AND FOR GENERAL ARRANGEMENT ONLY AND AS SUCH SHALL NOT RELIEVE THE CONTRACTOR OF RESPONSIBILITY FOR ERRORS OR OMISSIONS IN EITHER LAYOUT OR WORKMANSHIP.
- THIS DRAWING IS A COMPILATION OF OTHER UTILITY DESIGNS AND DOES NOT INDICATE IN ANY WAY THAT THE PARTY SIGNING THIS DRAWING HAS DESIGNED OR APPROVED THE RESPECTIVE UTILITY PLANTS INDICATED ON THIS DRAWING. THE DRAWING WAS PREPARED TO BE USED AS REFERENCE ONLY AS PER REQUIREMENTS OF THE CITY OF OTTAWA. IT IS THE CONTRACTOR'S RESPONSIBILITY TO ENSURE IT HAS REVIEWED THE CURRENT AND EXISTING DESIGNS BY HYDRO, STREET LIGHTING, BELL, CANADA POST, O.C. TRANSPQ, CABLE TV AND ANY OTHER PARTIES INCLUDED BUT NOT MENTIONED AND COMPLETE THE INSTALLATION IN ACCORDANCE WITH THE REQUIREMENTS OF THE STAKEHOLDER UTILITY DESIGNS.
- CONTRACTOR TO ADVISE ENGINEER IN WRITING OF ANY DISCREPANCIES IN THE HYDRO, BELL, ROGERS, ENBRIDGE, AND STREETLIGHT DRAWINGS, AND THE CUP AHEAD OF INSTALLATION.
- HYDRO INSPECTOR IS TO BE NOTIFIED AND PRESENT AHEAD OF HYDRO INSTALLATION.
- BELL AND ROGERS VAULT EASEMENT SIZE AND LOCATION ARE AS SHOWN ON THE CUP. ANY LOCATION DISCREPANCIES ARE TO BE REPORTED TO THE ENGINEER IN WRITING AHEAD OF INSTALLATION.
- BELL AND ROGERS VAULTS ARE TO BE PLACED TO THE EXTENT POSSIBLE IN THE RIGHT OF WAY RESPECTING THE REQUIRED CLEARANCES FROM DUCTS IN THE JOINT UTILITY TRENCH. IF VAULTS ARE ON PRIVATE PROPERTY THEY MUST BE PLACED WITHIN THE EASEMENT. VERIFY VAULT CORNERS PRIOR TO FINAL INSTALLATION AND FIBRE LINE PLACEMENT. VAULTS INSTALLED IN THE WRONG LOCATION OR OUTSIDE THE EASEMENTS WILL BE RELOCATED AT THE COST OF BELL AND ROGERS.
- UTILITY EASEMENTS ARE TO BE STAKED - ALL 4 CORNERS WITH PROPOSED FINAL GRADES MARKED ON THE STAKES.
- STREETLIGHTS ARE TO BE INSTALLED AT THE OFFSETS FROM FACE OF CURB SHOWN ON THE APPROVED ROAD SECTIONS FOR THE PROJECT.
- CAD FILES OF THE CUP PROVIDED BY THE ENGINEER ARE AS A COURTESY ONLY TO ASSIST THE CONTRACTOR. LAYOUT OF THE UTILITIES IS THE RESPONSIBILITY OF THE CONTRACTOR AND LEGAL SURVEYOR.

**NOTES :**

- ALL MATERIALS AND CONSTRUCTION IS TO BE IN ACCORDANCE WITH THE CURRENT CITY OF OTTAWA STANDARD DRAWINGS & SPECIFICATIONS OR OPSD/OPSS IF CITY DRAWINGS AND SPECIFICATIONS DO NOT APPLY.
- THE POSITION OF UNDERGROUND AND ABOVEGROUND SERVICE, UTILITIES AND STRUCTURES ARE NOT NECESSARILY SHOWN ON THE CONTRACT DRAWINGS, AND WHERE SHOWN, THE ACCURACY OF THE POSITION OF SUCH SERVICE, UTILITIES AND STRUCTURES IS NOT GUARANTEED. THE CONTRACTOR IS RESPONSIBLE FOR DETERMINING THE EXACT LOCATION, SIZE, MATERIAL AND ELEVATION OF ALL EXISTING SERVICES AND UTILITIES PRIOR TO CONSTRUCTION.
- THE CONTRACTOR SHALL REPORT ALL CONFLICTS, DISCOVERIES OF ERROR AND DISCREPANCIES TO THE ENGINEER.
- THE CONTRACTOR SHALL BE RESPONSIBLE TO PROTECT AND ASSUME RESPONSIBILITY FOR ALL UTILITIES WHETHER OR NOT SHOWN ON THESE DRAWINGS.
- THE CONTRACTOR SHALL BE RESPONSIBLE TO PROTECT ALL LANDS BEYOND THE SITE LIMITS. ANY AREAS BEYOND THE SITE LIMITS, WHICH ARE DISTURBED DURING CONSTRUCTION, SHALL BE REPAIRED AND RESTORED TO ORIGINAL CONDITION OR BETTER. TO THE SATISFACTION OF THE ADJACENT LAND OWNER. THE OWNER, THE OWNERS REPRESENTATIVES AND/OR THE AUTHORITY HAVING JURISDICTION AT THE EXPENSE OF THE CONTRACTOR.
- WHERE NECESSARY, THE CONTRACTOR SHALL IMPLEMENT A TRAFFIC MANAGEMENT PLAN TO THE SATISFACTION OF THE CITY OF OTTAWA. ALL CONSTRUCTION SIGNAGE MUST CONFORM TO THE LATEST VERSION OF THE M.T.O. MANUAL OF UNIFORM TRAFFIC CONTROL DEVICES. ALL TEMPORARY TRAFFIC CONTROL MEASURES MUST BE REMOVED UPON THE COMPLETION OF THE WORKS.
- SHOULD ANY BURIED ARCHAEOLOGICAL REMAINS BE FOUND ON THE PROPERTY DURING CONSTRUCTION ACTIVITIES, THE CONTRACTOR SHALL NOTIFY THE OWNER TO CONTACT THE HERITAGE OPERATIONS UNIT OF THE ONTARIO MINISTRY OF CULTURE MUST BE NOTIFIED IMMEDIATE, AND WORK WITHIN THE AREA SHALL BE CEASED UNTIL FURTHER NOTICE.
- FOR GEOTECHNICAL INFORMATION REFER TO GEOTECHNICAL REPORT C0947.00 PREPARED BY TERRAPEX.
- FOR GEODETIC BENCHMARK AND GEOMETRIC LAYOUT OF STREET AND LOTS, REFER TO TOPOGRAPHICAL SURVEY AND PLAN OF SUBDIVISION PREPARED BY AOV 4M-1559 BENCHMARK BASED ON CAN-NET VIRTUAL REFERENCE SYSTEM NETWORK.
- FOR SITE PLAN INFORMATION, REFER TO SITE PLAN PREPARED BY NORR ARCHITECTS.
- THESE DRAWINGS ARE NOT TO BE SCALED OR USED FOR LAYOUT PURPOSES.
- THE CONTRACTOR SHALL IMPLEMENT THE EROSION AND SEDIMENT CONTROL PLAN PRIOR TO THE COMMENCEMENT OF ANY SITE CONSTRUCTION. ALL EROSION AND SEDIMENT CONTROL MEASURES SHALL BE INSTALLED TO THE SATISFACTION OF THE ENGINEER, OR ANY REGULATORY AGENCY. ALL EROSION AND SEDIMENT CONTROL MEASURES SHALL BE MAINTAINED UNTIL VEGETATION IS ESTABLISH OR UNTIL THE START OF A SUBSEQUENT PHASE.
- CONTRACTORS SHALL BE RESPONSIBLE FOR KEEPING CLEAN ALL ROADS WHICH BECOME COVERED IN DUST, DEBRIS AND/OR MUD AS A RESULT OF ITS CONSTRUCTION OPERATIONS.
- THE CONTRACTOR SHALL BE RESPONSIBLE FOR ANY ADDITIONAL BEDDING OR ADDITIONAL STRENGTH PIPE SHOULD THE MAXIMUM OPSD TRENCH WIDTH BE EXCEEDED.
- ALL PIPE, CULVERTS, STRUCTURES REFER TO NOMINAL INSIDE DIMENSIONS.
- UNLESS SPECIFICALLY NOTED OTHERWISE, PIPE MATERIALS SHALL BE AS FOLLOWS:  
-WATERMANS TO BE PVC DR18  
-SANITARY SEWER TO BE PVC DR35  
-PERFORATED STORM SEWERS IN REAR YARDS AND LANDSCAPE AREAS TO BE HDPE  
-STORM SEWERS 375mm DIAMETER AND LESS TO BE PVC DR35  
-STORM SEWERS 450mm DIAMETER AND GREATER TO BE CONCRETE, CLASS AS PER OPSD 807.010 OR 807.030, OR HIGHER FOR SHALLOW SEWERS, REFER TO CITY STANDARD S35.
- ALL CONNECTIONS TO EXISTING WATERMANS ARE TO BE COMPLETED BY CITY FORCES. CONTRACTOR IS TO EXCAVATE, BACKFILL, COMPACT AND REINSTATE.
- ANY WATERMAIN WITH LESS THAN 2.4m AND ANY SEWER WITH LESS THAN 2.0m DEPTH OF COVER REQUIRES THERMAL INSULATION AS PER CITY OF OTTAWA STANDARD W22 OR AS APPROVED BY THE ENGINEER.
- ALL STUBBED SEWERS SHALL HAVE PRE-MANUFACTURED CAPS INSTALLED.
- ALL CATCHBASINS SHALL HAVE A 600mm SUMP.
- ALL SANITARY MANHOLES SHALL BE EQUIPPED WITH A WATERTIGHT COVER.
- ALL LEADS FOR STREET CATCHBASINS AND CURB INLET CATCHBASINS CONNECTED TO MAIN SHALL BE 200mmØ PVC DR35 @ MIN 2% SLOPE UNLESS NOTED OTHERWISE. ALL LEADS FOR RVCB'S CONNECTED TO MAIN SHALL BE 200mmØ PVC DR35 @ MIN 1% SLOPE UNLESS NOTED OTHERWISE.
- UNLESS SPECIFICALLY NOTED OTHERWISE, ALL STREET CATCHBASINS SHALL BE INSTALLED WITH TWO - 3.0m MINIMUM SUBDRAINS INSTALLED LONGITUDINALLY, PARALLEL WITH THE CURB. ALL CATCHBASINS IN ASPHALT AREAS, NOT ADJACENT TO A CURB, SHALL BE INSTALLED WITH FOUR - 3.0m MINIMUM SUBDRAINS INSTALLED ORTHOGONALLY.
- INLET CONTROL DEVICES SHALL BE INSTALLED PRIOR TO COMPLETING THE ROAD BASE (GRANULAR A).
- ALL SEWER SERVICE LATERALS WITH MAINLINE CONNECTIONS DEEPER THAN 5.0m REQUIRE A CONTROLLED SETTLEMENT JOINT.
- EACH BUILDING SHALL BE EQUIPPED WITH A SANITARY AND STORM SEWER BACKWATER VALVE AND CLEAN-OUT ON ITS PRIMARY SERVICE, AS PER ONTARIO BUILDING CODE REQUIREMENTS (BY OTHERS).
- THE SUBGRADE OF ALL STRUCTURES, PIPE, ROADS, SIDEWALKS, WALKWAYS, AND BUILDINGS SHALL BE INSPECTED BY THE GEOTECHNICAL ENGINEER PRIOR TO PROCEEDING WITH CONSTRUCTION.
- TOP COURSE ASPHALT SHALL NOT BE PLACED UNTIL THE FINAL CCTV INSPECTION AND NECESSARY REPAIRS HAVE BEEN COMPLETED TO THE SATISFACTION OF THE ENGINEER AND THE CITY OF OTTAWA.
- ALL RETAINING WALLS GREATER THAN 0.6m IN HEIGHT REQUIRE A GUARD. ANY GUARD ON A RETAINING WALL GREATER THAN 1.0m IN HEIGHT SHALL BE DESIGNED BY THE QUALIFIED STRUCTURAL ENGINEER RESPONSIBLE FOR THE WALL DESIGN.
- ALL PROPOSED COVER FRAMES LOCATED IN A LANDSCAPE AREA (ESPECIALLY OVERFLOW STRUCTURES) NEED TO BE ANCHORED DIRECTLY TO THE TOP OF THE PRECAST CONCRETE TOP AS PER S. P. NO. F-4070 TO PREVENT DISPLACEMENT.

**WATERMAIN SCHEDULE**

| Station    | Description | Finished Grade | Top of Watermain | As Built Watermain |
|------------|-------------|----------------|------------------|--------------------|
| A 0+000.00 | 200x150 TEE | 87.894         | 85.494           |                    |
| 0+006.70   | 150 V&V     | 88.150         | 85.750           |                    |
| B 0+010.76 | 150 CAP     | 88.250         | 85.650           |                    |

**CROSSING SCHEDULE**

|   |              |        |                 |                |
|---|--------------|--------|-----------------|----------------|
| 1 | 150 mm Ø W/M | 1.13 m | CLEARANCE UNDER | 200 mm Ø STM   |
| 2 | 150 mm Ø W/M | 1.05 m | CLEARANCE UNDER | UTILITY TRENCH |
| 3 | 150 mm Ø SAN | 0.52 m | CLEARANCE UNDER | 200 mm Ø W/M   |
| 4 | 150 mm Ø SAN | 1.98 m | CLEARANCE UNDER | 200 mm Ø STM   |
| 5 | 150 mm Ø SAN | 0.58 m | CLEARANCE UNDER | UTILITY TRENCH |
| 6 | 300 mm Ø STM | 4.18 m | CLEARANCE OVER  | 300 mm Ø SAN   |
| 7 | 300 mm Ø STM | 0.48 m | CLEARANCE UNDER | 200 mm Ø W/M   |
| 8 | 300 mm Ø STM | 2.32 m | CLEARANCE UNDER | 200 mm Ø STM   |
| 9 | 300 mm Ø STM | 0.87 m | CLEARANCE UNDER | UTILITY TRENCH |

CLIENT  
**ROHIT GROUP**

15 FITZGERALD ROAD, NEPEAN, ON

**COPYRIGHT**  
This drawing has been prepared solely for the intended use, thus any reproduction or distribution for any purpose other than authorized by Arcadis is forbidden. Written dimensions shall have precedence over scale dimensions. Contractors shall verify and be responsible for all dimensions and conditions on the job, and Arcadis shall be informed of any variations from the dimensions and conditions shown on the drawing. Shop drawings shall be submitted to Arcadis for general conformance before proceeding with fabrication.

**Arcadis Professional Services (Canada) Inc.**  
formerly BSI Group Professional Services (Canada) Inc.

**ISSUES**

| No. | DESCRIPTION                     | DATE       |
|-----|---------------------------------|------------|
| 1   | SUBMISSION NO.1 FOR CITY REVIEW | 2023-12-08 |
| 2   | SUBMISSION NO.2 FOR CITY REVIEW | 2024-03-04 |
| 3   | SUBMISSION NO.3 FOR CITY REVIEW | 2024-05-01 |
| 4   | NEW SITE PLAN                   | 2024-08-07 |
| 5   |                                 |            |
| 6   |                                 |            |
| 7   |                                 |            |
| 8   |                                 |            |

**KEY PLAN**

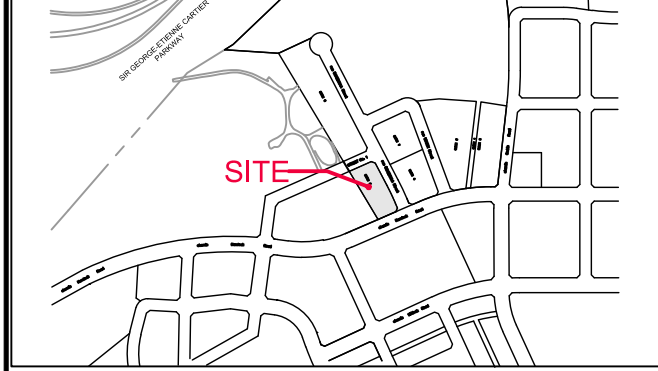

**SEAL**



**CONFIRM PRIME CONSULTANT**



**PROJECT**  
**WATERIDGE VILLAGE AT ROCKCLIFFE**  
PHASE 4 - BLOCK 5

**PROJECT NO:** 143934  
**DRAWN BY:** M.M.  
**PROJECT MGR:** PHASE 4 - BLOCK 5  
**CHECKED BY:** D.C.  
**APPROVED BY:** A.C.

**SHEET TITLE**  
**NOTES AND LEGEND**

**SHEET NUMBER** C-010 **ISSUE** 4

File Location: \\1143934\_03\_Design\04\_Civil\Sheet\010 NOTES AND LEGEND.dwg Last: August 7, 2024, by M.Mine Plot: Wednesday, August 7, 2024 2:03:33 PM by Marwan Mmine  
D07-XX-XX-XXXX  
XXXXX

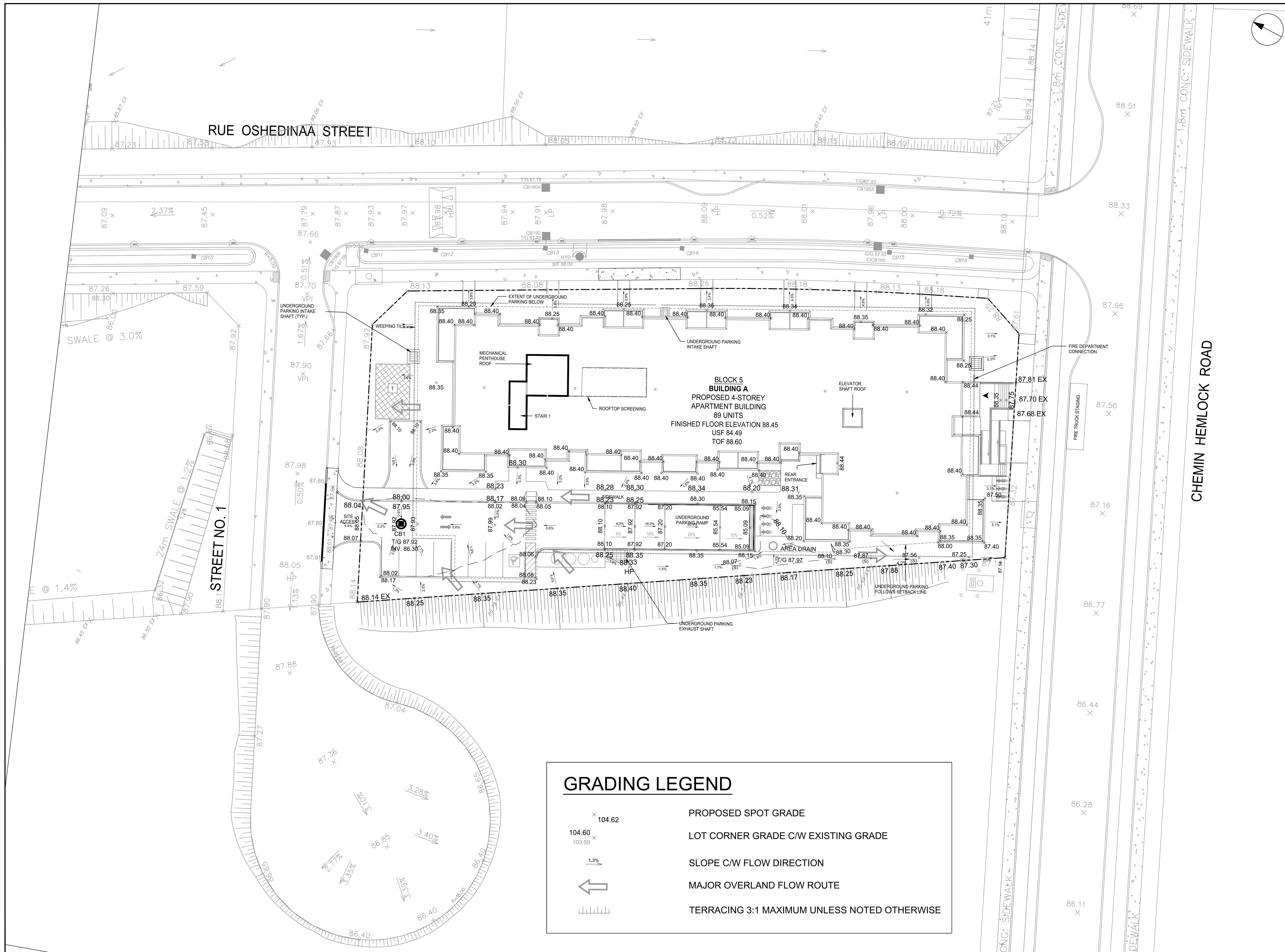

**CLIENT**  
**ROHIT GROUP**  
 15 FITZGERALD ROAD, NEPEAN, ON

**COPYRIGHT**  
 This drawing has been prepared solely for the intended use, thus any reproduction or distribution for any purpose other than authorized by Arcadis is forbidden. Written dimensions shall have precedence over scaled dimensions. Contractors shall verify and be responsible for all dimensions and conditions on the job, and Arcadis shall be informed of any variations from the dimensions and conditions shown on the drawing. Shop drawings shall be submitted to Arcadis for general conformance before proceeding with fabrication.

**Arcadis Professional Services (Canada) Inc.**  
 Formerly BSI Group Professional Services (Canada) Inc.

| ISSUES |                                 |            |
|--------|---------------------------------|------------|
| No.    | DESCRIPTION                     | DATE       |
| 1      | ISSUED FOR CLIENT REVIEW        | 2023-11-22 |
| 2      | SUBMISSION NO.1 FOR CITY REVIEW | 2023-12-08 |
| 3      | SUBMISSION NO.2 FOR CITY REVIEW | 2024-03-04 |
| 4      | SUBMISSION NO.3 FOR CITY REVIEW | 2024-05-01 |
| 5      | NEW SITE PLAN                   | 2024-08-07 |
| 6      |                                 |            |
| 7      |                                 |            |
| 8      |                                 |            |

**KEY PLAN**

**SCALE**

**SEAL**

**CONFIRM PRIME CONSULTANT**  
**ARCADIS**  
 333 Preston Street - Suite 500  
 Ottawa ON K1S 5N4 Canada  
 tel 613 225 1311  
 www.arcadis.com

**PROJECT**  
**WATERIDGE VILLAGE AT ROCKCLIFFE**  
 PHASE 4 - BLOCK 5

**PROJECT NO:**  
 143934

**DRAWN BY:** M.M.      **CHECKED BY:** D.C.  
**PROJECT MGR:** D.C.      **APPROVED BY:** A.C.

**SHEET TITLE**  
**GRADING PLAN**

**SHEET NUMBER** C-200      **ISSUE** 5

**GRADING LEGEND**

- PROPOSED SPOT GRADE
- LOT CORNER GRADE C/W EXISTING GRADE
- SLOPE C/W FLOW DIRECTION
- MAJOR OVERLAND FLOW ROUTE
- TERRACING 3:1 MAXIMUM UNLESS NOTED OTHERWISE

File Location: J:\143934\_Block\_5\_Plan\_4770\_Production\103\_Design\04\_Civil\Sheets\C-200 GRADING PLAN.dwg    Last Saved: August 7, 2024, by: M.Milne    Plotted: Wednesday, August 7, 2024 2:05:43 PM by: Marian Milne  
 D07-XX-XX-XXXX  
 XXXXX

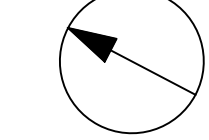
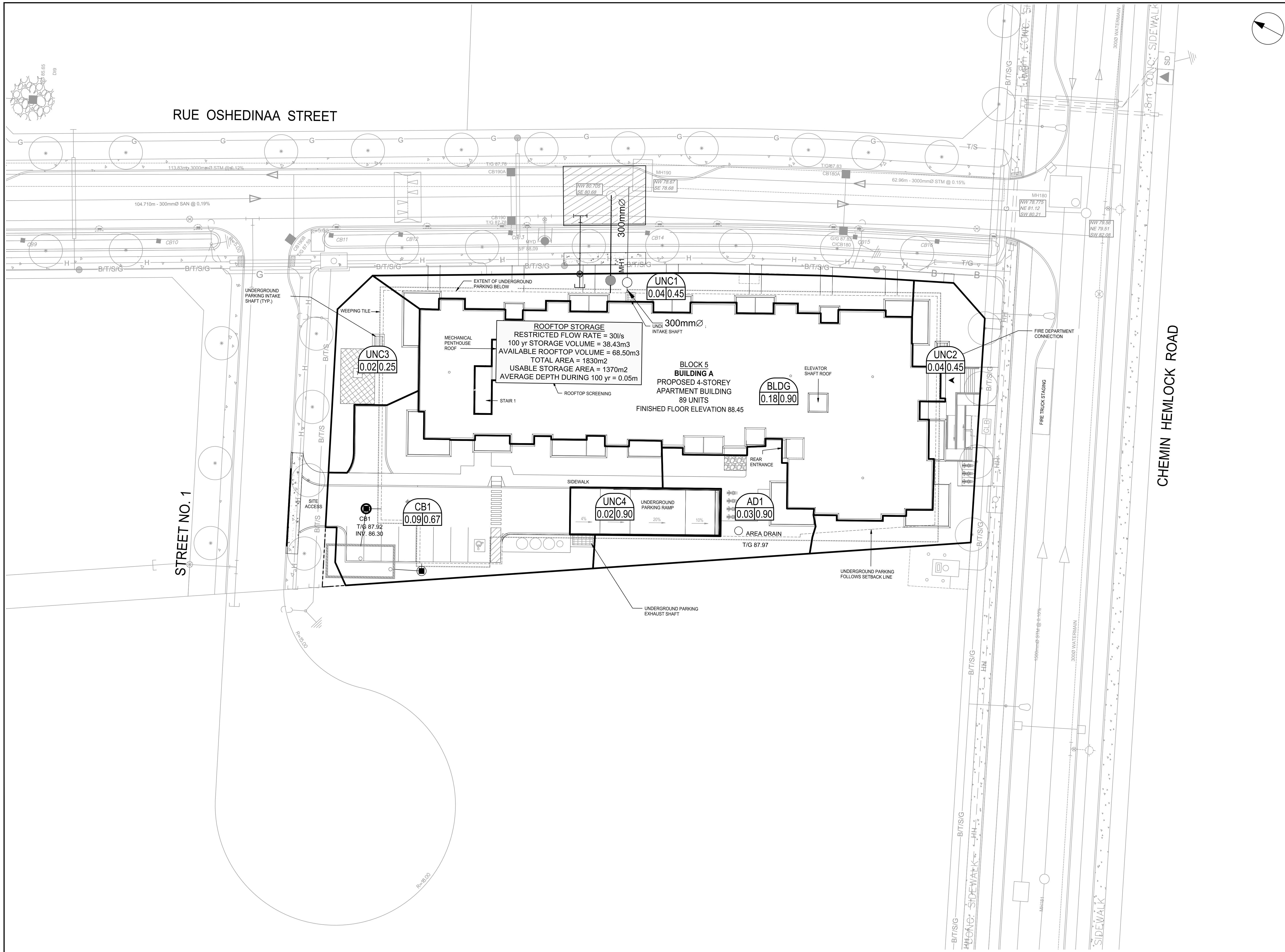

CLIENT  
**ROHIT GROUP**  
 15 FITZGERALD ROAD, NEPEAN, ON

COPYRIGHT  
 This drawing has been prepared solely for the intended use, thus any reproduction or distribution for any purpose other than authorized by Arcadis is forbidden. Written dimensions shall have precedence over scaled dimensions. Contractors shall verify and be responsible for all dimensions and conditions on the job, and Arcadis shall be informed of any variations from the dimensions and conditions shown on the drawing. Shop drawings shall be submitted to Arcadis for general conformance before proceeding with fabrication.

Arcadis Professional Services (Canada) Inc.  
 Formerly BSI Group Professional Services (Canada) Inc.

| No. | DESCRIPTION                     | DATE       |
|-----|---------------------------------|------------|
| 1   | SUBMISSION NO.1 FOR CITY REVIEW | 2023-12-08 |
| 2   | SUBMISSION NO.2 FOR CITY REVIEW | 2024-03-04 |
| 3   | SUBMISSION NO.3 FOR CITY REVIEW | 2024-05-01 |
| 4   | NEW SITE PLAN                   | 2024-08-07 |
| 5   |                                 |            |
| 6   |                                 |            |
| 7   |                                 |            |
| 8   |                                 |            |

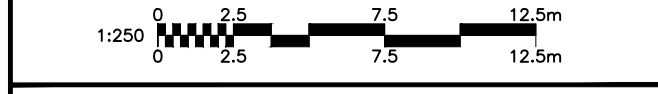
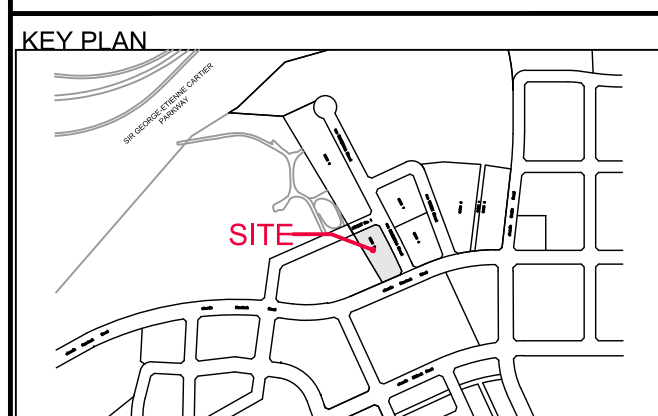

SEAL

PRIME CONSULTANT  
**ARCADIS**  
 333 Preston Street - Suite 500  
 Ottawa ON K1S 5N4 Canada  
 tel 613 225 1311  
 www.arcadis.com

PROJECT  
**WATERIDGE VILLAGE  
 AT ROCKCLIFFE**  
 PHASE 4 - BLOCK 5

PROJECT NO:  
 143934  
 DRAWN BY: **M.M.** CHECKED BY: **D.C.**  
 PROJECT MGR: **D.C.** APPROVED BY: **A.C.**

SHEET TITLE  
**STORM DRAINAGE AREA PLAN**

SHEET NUMBER **C-500** ISSUE **4**

File Location: J:\143934\_Block\_5\_Phase\_4\7\_0\_Production\7\_03\_Design\04\_Civil\Sheet\C-500\_DRAINAGE AREA PLAN.dwg Last Saved: August 7, 2024, by M.M. Plotted: Wednesday, August 7, 2024, 2:08:39 PM by Marian Mine  
 D07-XX-XX-XXXX  
 XXXXX

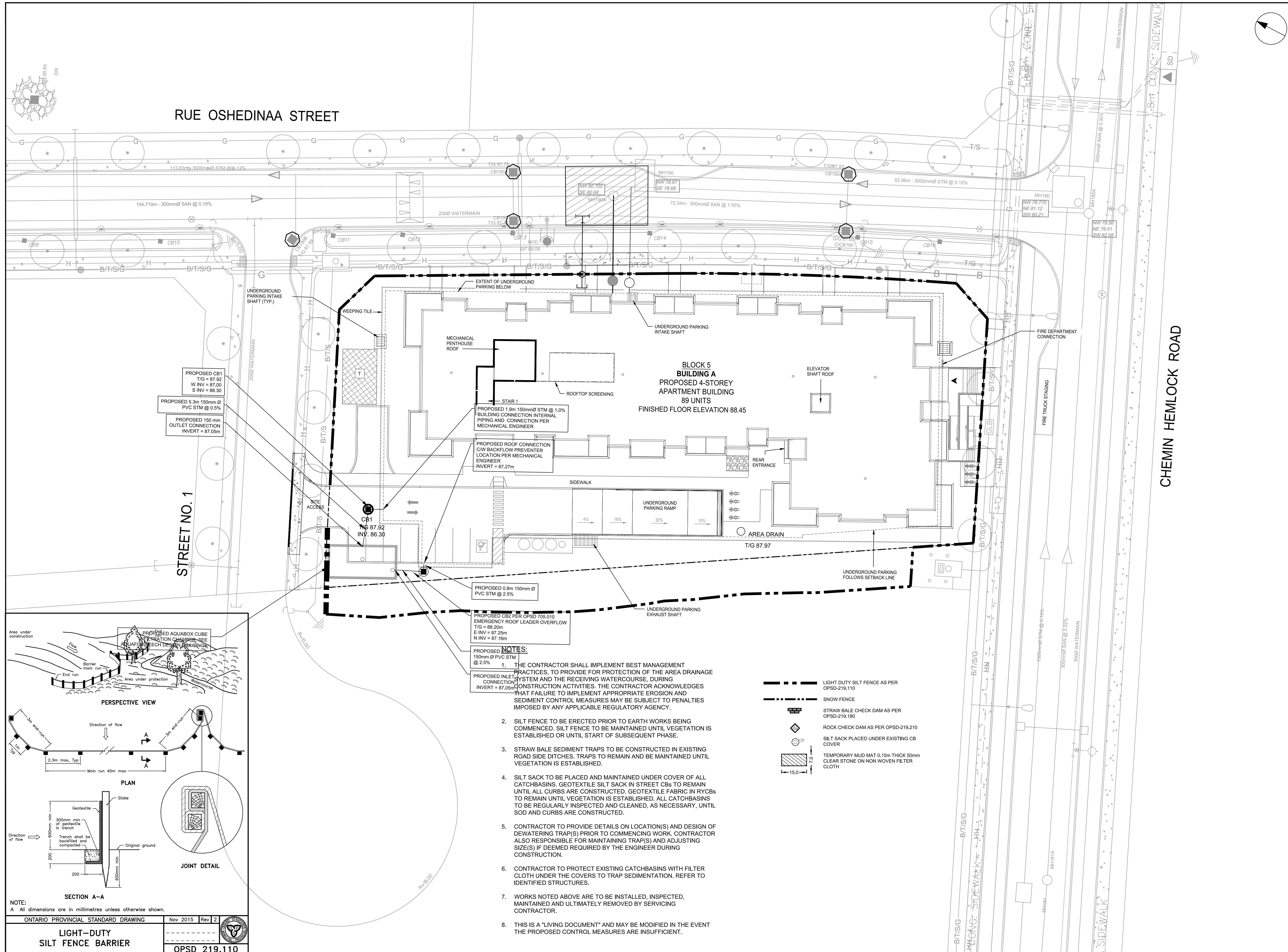

CLIENT  
**ROHIT GROUP**

15 FITZGERALD ROAD, NEPEAN, ON

**COPYRIGHT**  
This drawing has been prepared solely for the intended use, thus any reproduction or distribution for any purpose other than authorized by Arcadis is forbidden. Written dimensions shall have precedence over scaled dimensions. Contractors shall verify and be responsible for all dimensions and conditions on the job, and Arcadis shall be informed of any variations from the dimensions and conditions shown on the drawing. Shop drawings shall be submitted to Arcadis for general conformance before proceeding with fabrication.

**Arcadis Professional Services (Canada) Inc.**  
Formerly BSI Group Professional Services (Canada) Inc.

**ISSUES**

| No. | DESCRIPTION                     | DATE       |
|-----|---------------------------------|------------|
| 1   | SUBMISSION NO.1 FOR CITY REVIEW | 2023-12-08 |
| 2   | SUBMISSION NO.2 FOR CITY REVIEW | 2024-03-04 |
| 3   | SUBMISSION NO.3 FOR CITY REVIEW | 2024-05-01 |
| 4   | NEW SITE PLAN                   | 2024-08-07 |
| 5   |                                 |            |
| 6   |                                 |            |
| 7   |                                 |            |
| 8   |                                 |            |

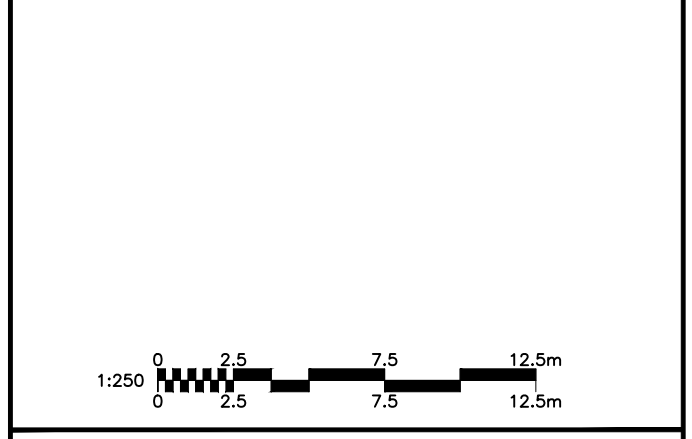
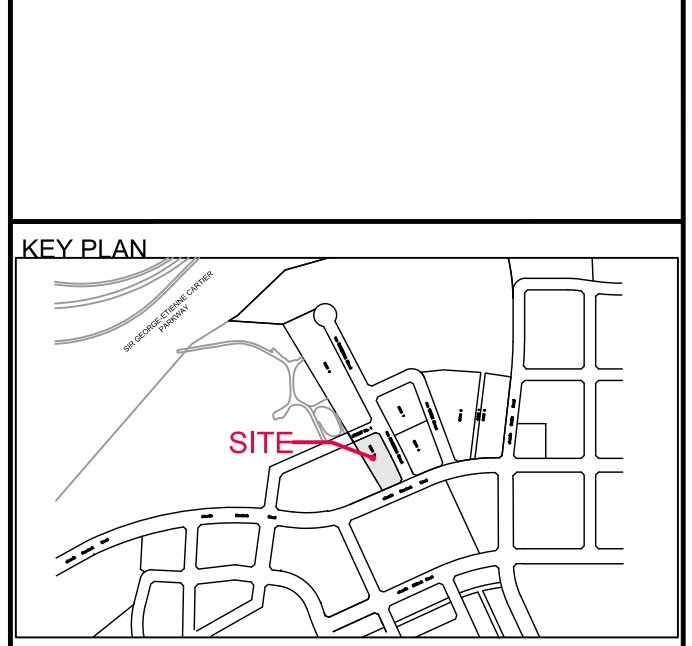

**PRIME CONSULTANT**

**ARCADIS**

333 Preston Street - Suite 500  
Ottawa ON K1S 5N4 Canada  
tel 613 225 1311  
www.arcadis.com

**PROJECT**

**WATERIDGE VILLAGE  
AT ROCKCLIFFE**

PHASE 4 - BLOCK 5

**PROJECT NO:**  
143934

**DRAWN BY:** M.M.      **CHECKED BY:** D.C.

**PROJECT MGR:** D.C.      **APPROVED BY:** A.C.

**SHEET TITLE**

**SEDIMENT AND EROSION  
CONTROL PLAN**

**SHEET NUMBER**      **ISSUE**

**C-900**      **4**

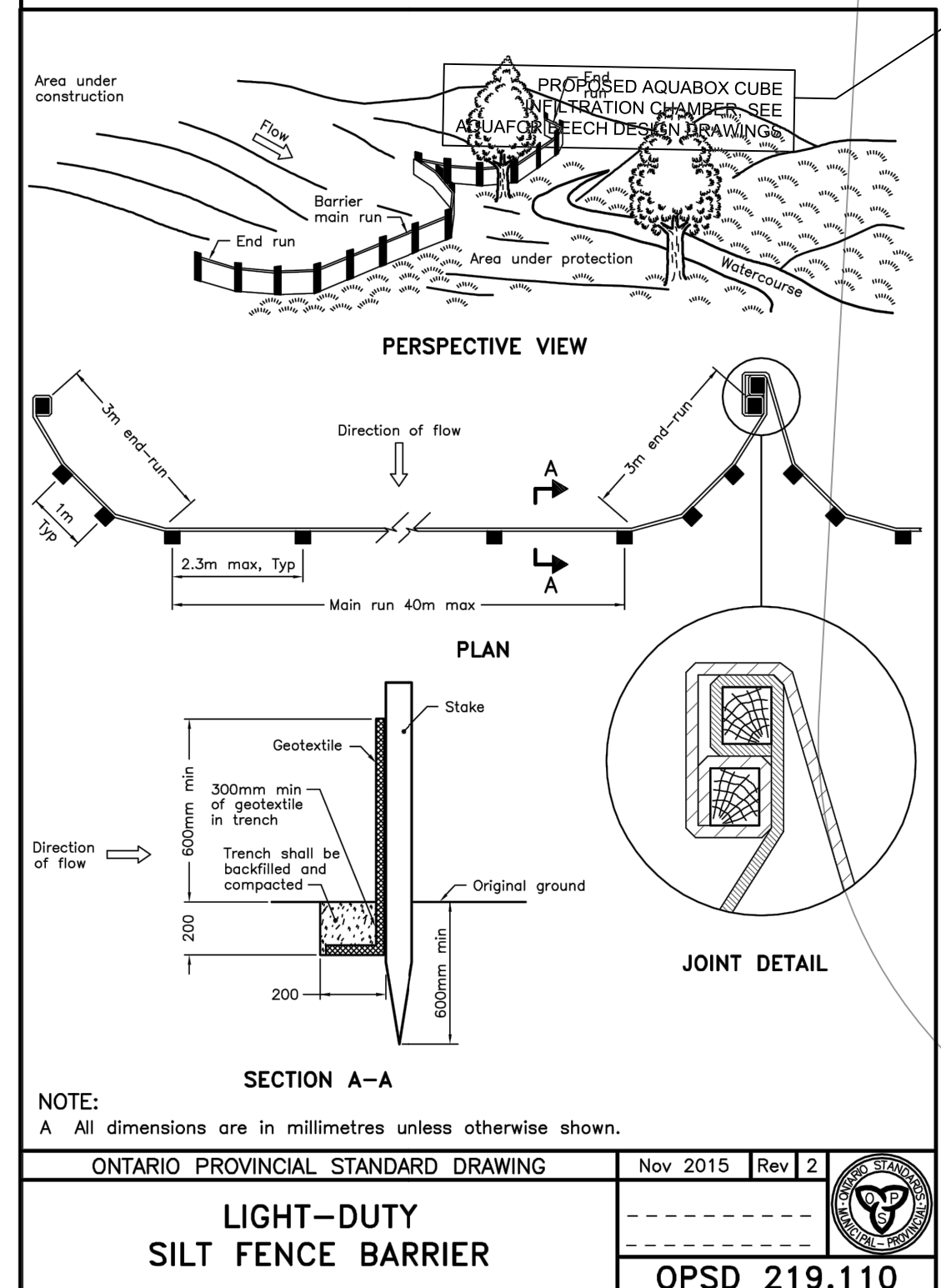

ONTARIO PROVINCIAL STANDARD DRAWING      Nov 2015      Rev 2

**LIGHT-DUTY  
SILT FENCE BARRIER**

OPSD 219.110

- PROPOSED NOTES:**
1. THE CONTRACTOR SHALL IMPLEMENT BEST MANAGEMENT PRACTICES, TO PROVIDE FOR PROTECTION OF THE AREA DRAINAGE SYSTEM AND THE RECEIVING WATERCOURSE, DURING CONSTRUCTION ACTIVITIES. THE CONTRACTOR ACKNOWLEDGES THAT FAILURE TO IMPLEMENT APPROPRIATE EROSION AND SEDIMENT CONTROL MEASURES MAY BE SUBJECT TO PENALTIES IMPOSED BY ANY APPLICABLE REGULATORY AGENCY.
  2. SILT FENCE TO BE ERRECTED PRIOR TO EARTH WORKS BEING COMMENCED. SILT FENCE TO BE MAINTAINED UNTIL VEGETATION IS ESTABLISHED OR UNTIL START OF SUBSEQUENT PHASE.
  3. STRAW BALE SEDIMENT TRAPS TO BE CONSTRUCTED IN EXISTING ROAD SIDE DITCHES. TRAPS TO REMAIN AND BE MAINTAINED UNTIL VEGETATION IS ESTABLISHED.
  4. SILT SACK TO BE PLACED AND MAINTAINED UNDER COVER OF ALL CATCHBASINS. GEOTEXTILE SILT SACK IN STREET CBS TO REMAIN UNTIL ALL CURBS ARE CONSTRUCTED. GEOTEXTILE FABRIC IN RYCBS TO REMAIN UNTIL VEGETATION IS ESTABLISHED. ALL CATCHBASINS TO BE REGULARLY INSPECTED AND CLEANED, AS NECESSARY, UNTIL SOD AND CURBS ARE CONSTRUCTED.
  5. CONTRACTOR TO PROVIDE DETAILS ON LOCATION(S) AND DESIGN OF DEWATERING TRAP(S) PRIOR TO COMMENCING WORK. CONTRACTOR ALSO RESPONSIBLE FOR MAINTAINING TRAP(S) AND ADJUSTING SIZE(S) IF DEEMED REQUIRED BY THE ENGINEER DURING CONSTRUCTION.
  6. CONTRACTOR TO PROTECT EXISTING CATCHBASINS WITH FILTER CLOTH UNDER THE COVERS TO TRAP SEDIMENTATION. REFER TO IDENTIFIED STRUCTURES.
  7. WORKS NOTED ABOVE ARE TO BE INSTALLED, INSPECTED, MAINTAINED AND ULTIMATELY REMOVED BY SERVICING CONTRACTOR.
  8. THIS IS A "LIVING DOCUMENT" AND MAY BE MODIFIED IN THE EVENT THE PROPOSED CONTROL MEASURES ARE INSUFFICIENT.

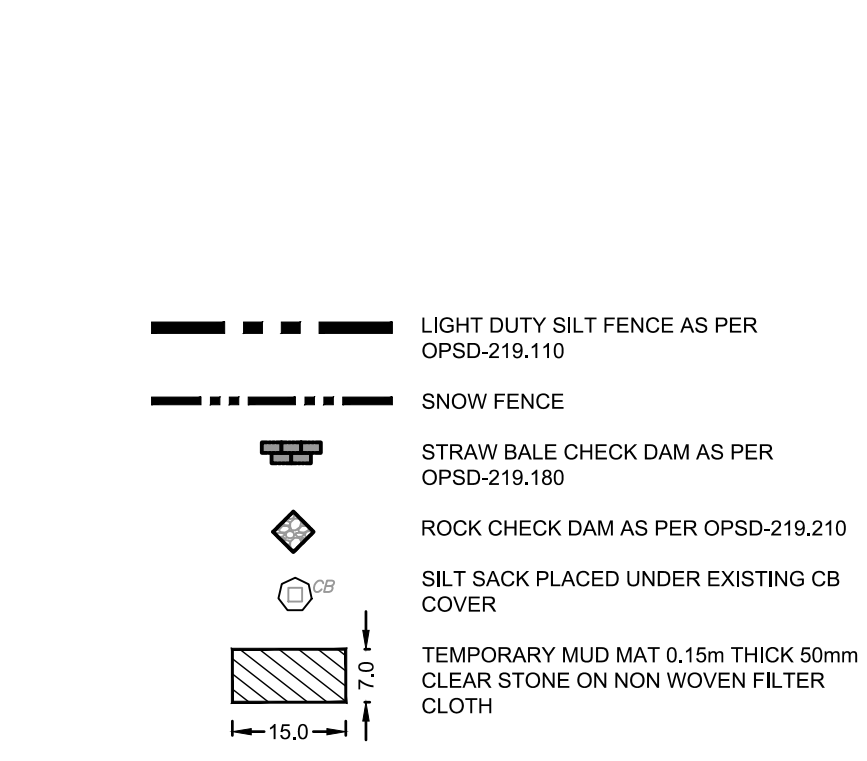

File Location: J:\143934\_Block\_5\_Phase\_4\0\_Production\203\_Design\03\_Civil\Sheet\C-900 EROSION AND SEDIMENT CONTROL PLAN.dwg      Last Saved: January 30, 2024, by: M.Miline      Plotted: Wednesday, August 7, 2024, 2:07:34 PM by: Marian Milne  
 1/16      D07-XX-XX-XXXX      XXXXX